

PRODUCT CODE: CGT12-HD
 PUBLICATION DATE: May 2021 v1.01

Heavy Duty Veneer Wall Tie

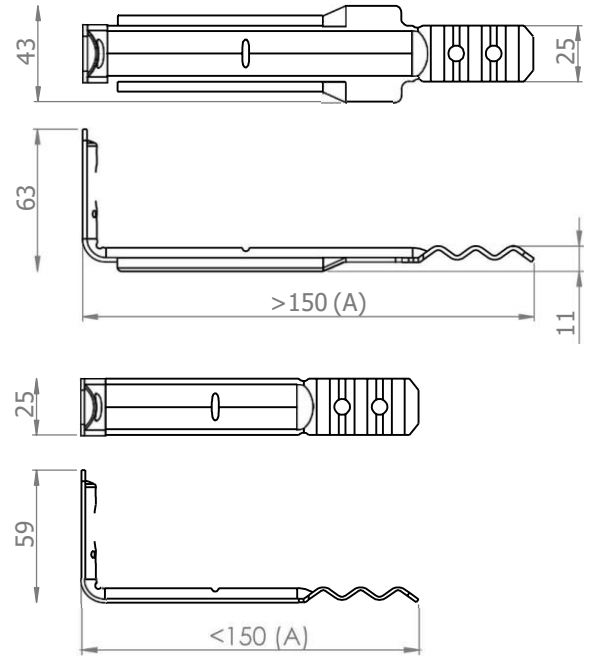

Datasheet

DESCRIPTION

Heavy duty veneer wall tie.

FEATURES

- Clay brick / block work
- For larger cavity construction
- Additional strengthening wings on ties over 150mm
- Multiple fixing options
- Universal applications
- Australian design & tested AS/NZS 2699.2:2020

SIZES

Standard Sizes : 150mm, 200mm, 250mm and 300mm

Special Order : 350mm, 400mm, 450mm and 500mm

FIXING REQUIREMENTS

- 60mm x 6mm dia AM premium concrete screw (Concrete)
- 32mm x 5mm dia Mushroom spikes head anchor (Concrete)
- S/Drilling hex head 10g X 25mm galvanised class 3 finished (Metal)

CORROSION CHARACTERISTICS

Galvanised Z600 (R2)

Stainless steel 316L (R4)

Conforms to corrosion resistance set by AS/NZS 2699.2:2020 / AS 3700.

ORDERING INFORMATION

When ordering please supply use with the part number and quantity you require

CGT12-HD-250-R4

PRODUCT CODE

LENGTH
A

MATERIAL
Specify

150	350	R2 for Galvanised Z600
200	400	R3 for Hot dipped galvanised
250	450	R4 for Stainless steel 316L
300	500	

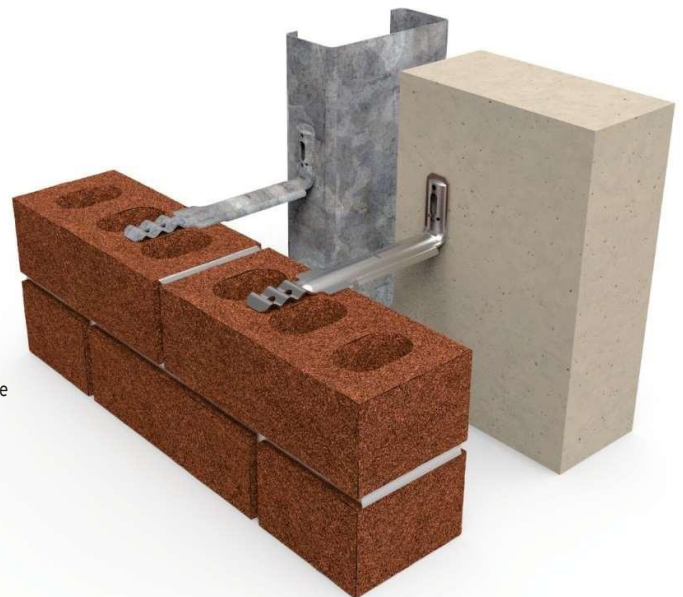

FOR SALES ENQUIRIES, PLEASE CONTACT ROGERS CS (QLD) OR SALES@ROGERSCS.COM.AU

UNIT 2, 19 HOOK STREET, CAPALABA QLD 4157 | T: 07 3823 2316 | HTTPS://ROGERSCS.COM.AU