



NORTH POINT CABINETS®

Thoughtfully Designed,
Carefully Crafted

Presented by:

Chris Rorke
Director of Field Sales





The NorthPoint Cabinetry Solution

NorthPoint Cabinetry features a wide array of **QuickBuild**[®] cabinet designs, providing value with a quality, custom look.

- Unique dovetail and pocket screw cabinet construction for sturdy and fast assembly
- Free freight on most orders
- Robust replacement parts program
- Dedicated customer service support

With 5 dedicated warehouses across the country, NorthPoint Cabinetry typically ships within 48 hours and arrives in 2–3 business days.

The Quick Advantage

Ships **QUICKLY**, Assembles **FAST**

NorthPoint Cabinetry offers a *quick* advantage for you and your customer by making it fast and easy to design, order, ship & assemble cabinets.

Why does this matter? With a reduction in time and labor, you can complete more jobs and see significant savings.



4 WAYS QUICK ADVANTAGE SAVES TIME & MONEY

- **Quick to Design**

Our cabinets are available in 2020 and ProKitchen software, making kitchen design fast and easy.

2020



- **Quick to Order**

Place an order for your cabinets with our quoting tool, on our website at NorthPointCabinetry.com, or by contacting a live customer service agent.

- **Quick to Ship**

With 5 dedicated warehouses across the country, orders typically ship within 48 hours and arrive in 2–3 business days.



- **Quick to Assemble**

With our **QuickBuild**® cabinets, the average assembly time per cabinet is 8 minutes*; you can build a medium sized kitchen in less than half a day.

**Specialty cabinets may take longer than average to assemble.*

What are **QuickBuild**® Cabinets?

Dovetail + Pocket Screws = QuickBuild®

- Simple assembly: slide the panels together and secure with pocket screws
- No extra fasteners needed to hold the panels in place
- Conveniently placed pocket screws reduce build time



How fast can you build a cabinet?

One of our cabinets takes about 8 minutes* to assemble (many do it in 4).
You can build a kitchen or bathroom in record time!



Quality Comes First

You can trust NorthPoint Cabinetry for your customers. Our cabinets and hardware have gone through rigorous third-party testing and meet the KCMA standards. With quality details throughout and the features your customer will appreciate, NorthPoint Cabinetry is built to last.



**It Starts with
Quality Wood**



**Thoughtful
Craftsmanship**



**Structural
Integrity**



**Sturdy
Shelves**



**Hardworking
Hardware**

**Premium
Drawer
Boxes**



**Pretty on
the Inside,
Too**



PREMIER

Collection



The Premier Collection features elegant upgrades like soft-close doors and drawers.

Door Styles: Catalina, Maui

- 3/4" solid wood face frame & shelves
- 1/2" plywood cabinet construction
- Beautiful, finished interior
- 5-Year limited lifetime warranty

Catalina Profile

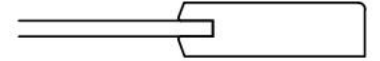

Maui Profile

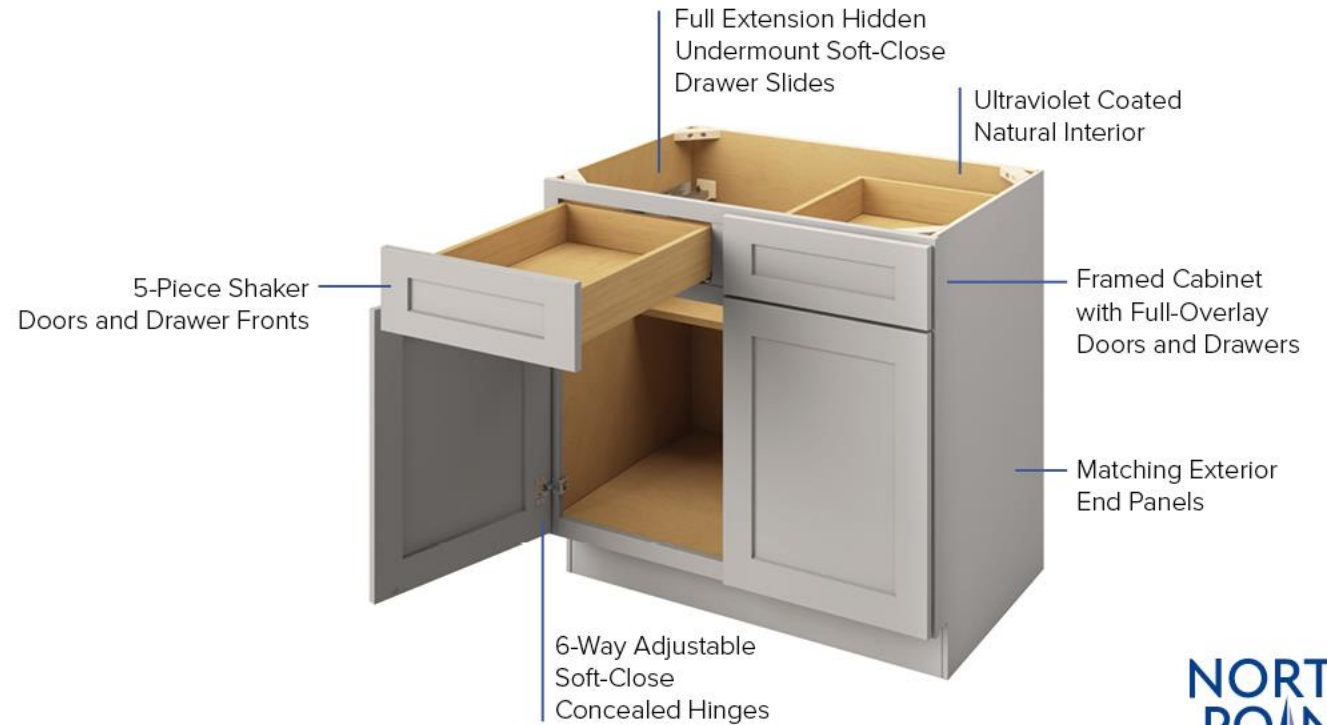

ESSENTIALS

Collection



The Essentials Collection delivers on style at an impressive value.

Door Style: Hatteras

- 3/4" solid wood face frame & shelves
- 1/2" plywood cabinet construction
- Beautiful, finished interior
- 1-Year limited lifetime warranty

Hatteras Profile

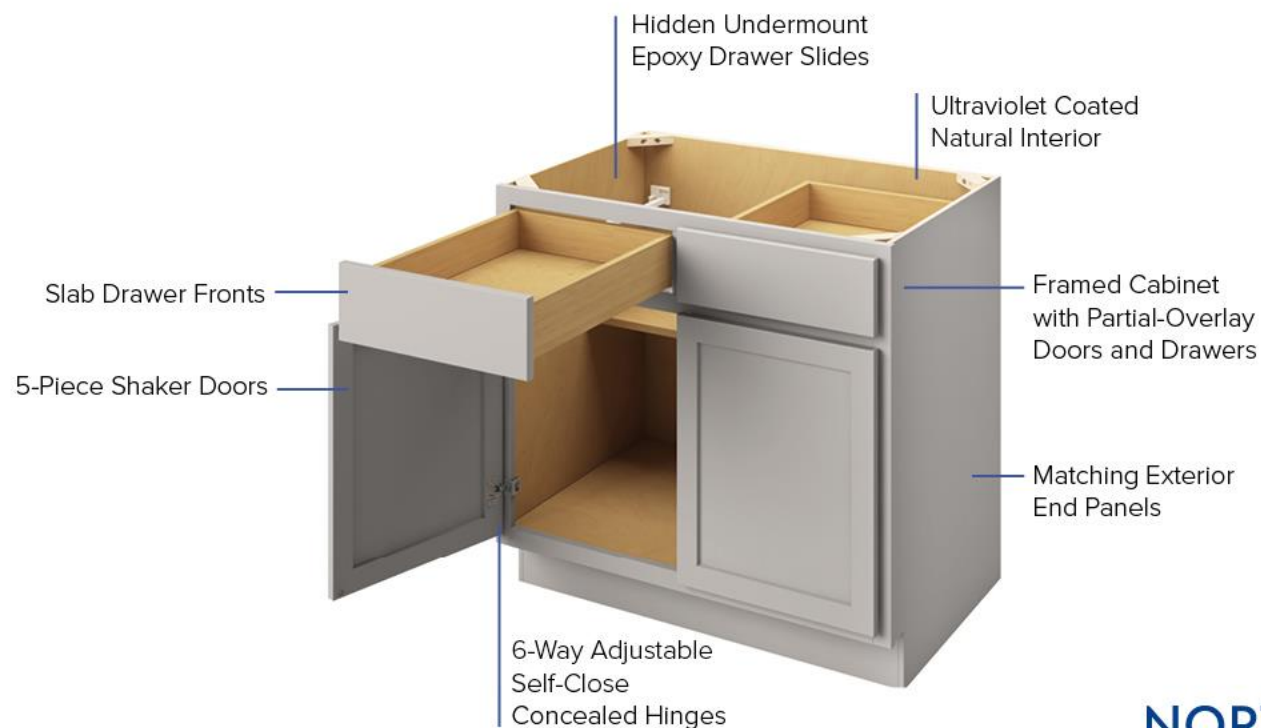
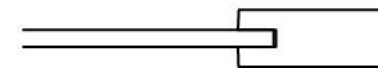

PREMIER COLLECTION: CATALINA

CATALINA FINISHES

More than modern. The Catalina door style features a full-overlay, Shaker style door and 5-piece drawer front.



POLAR WHITE



PEBBLE GREY



ESPRESSO



SLATE



PREMIER COLLECTION: MAUI

MAUI FINISHES

Sometimes the details make all the difference. The Maui door style features a full-overlay, transitional style door and 5-piece drawer front with a twist of character.



POLAR WHITE



PEBBLE GREY



ESPRESSO



SLATE



ESSENTIALS COLLECTION: HATTERAS

HATTERAS FINISHES

Simple and sleek. The Hatteras door style features a partial-overlay, Shaker style door and slab drawer front.



POLAR WHITE



PEBBLE GREY



ESPRESSO





Wine Bar

Cabinets for Any Space

The kitchen and bath are common spaces to install cabinetry. However, NorthPoint Cabinetry provides solutions for other spaces like the laundry room, mudroom, and entertainment areas. Cabinets make those areas more functional by providing additional storage and countertop work space.



Laundry Room



Mudroom

Cabinet Lineup

WALL CABINETS

12" deep except where noted
 42" high wall cabinets will have 3 shelves
 *39" and 42" widths will have a vertical center stile unless otherwise noted



Double Door
 12" Height
 30", 33", 36"
 or *39" Width

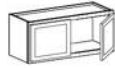

Double Door
 15" Height
 30", 33", 36"
 or *39" Width



Double Door
 18" Height
 21", 24", 30", 33", 36"
 or *39" Width



Double Door
 24" Height
 30", 33", 36" or *39" Width

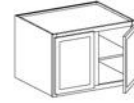

Deep Double Door
 18" or 24" Height - 24" Depth
 36" or *39" Width
 18" Height does not have shelf



Single Door
 30" Height
 9", 12", 15", 18" or 21" Width



Double Door
 30" Height
 24", 27", 30", 33",
 36", *39" or *42" Width



Single Door
 36" Height
 9", 12", 15", 18" or 21" Width



Double Door
 36" Height
 24", 27", 30", 33",
 36", *39" or *42" Width



Single Door
 42" Height
 9", 12", 15", 18" or 21" Width



Double Door
 42" Height
 24", 27", 30", 33",
 36", *39" or *42" Width



Single & Double Glass Door
 Matching Finish Color Interior
 30" Height
 15", 18", 30" or 36" Width



Single & Double Glass Door
 Matching Finish Color Interior
 36" Height
 15", 18", 30" or 36" Width



Single & Double Glass Door
 Matching Finish Color Interior
 42" Height
 15", 18", 30" or 36" Width

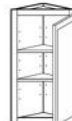

Wall End Single Door
 30", 36" or 42" Height
 12" Width

Glass door wall cabinets only available in the Premier collection

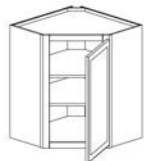

Diagonal Corner
 30", 36" or 42" Height
 12 or 15" Depth
 24" and 27" Width

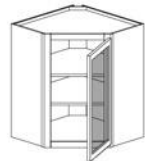

Diagonal Corner Glass Door
 Matching Finish Color Interior
 30", 36" or 42" Height
 12 or 15" Depth
 24" and 27" Width



Universal Blind Corner
 30", 36" or 42" Height
 30"-33" Width



Microwave Wall Cabinet
 Extended Shelf
 36" Height
 30" Width



Microwave Wall Cabinet
 Extended Shelf
 18" Height
 30" Width

Glass door wall cabinets only available in the Premier collection

BASE CABINETS

24" deep, 34-1/2" high
 except where noted

*39" and 42" widths will
 have a vertical center stile
 unless otherwise noted



Full Height Single Door
 9", 12", 15" or 18" Width



Single Door and Drawer
 12", 15", 18" or 21" Width



Double Door and Single Drawer
 24", 27" or 30" Width

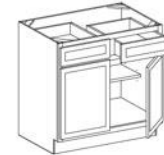

Double Door and Double Drawer
 33", 36", *39" or *42" Width



Double Drawer
 30" or 36" Width



Triple Drawer
 12", 15", 18", 21", 24", 30"
 or 36" Width

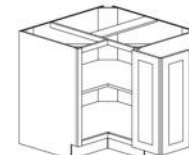

Base Corner Cabinet
 33" or 36" Width
 (Lazy Susan inserts available)



Universal Blind Base Corner
 39"-42", 42"-45" or
 *45-48" Width



Microwave Base Cabinet with Drawer
 30" Width

Cabinet Lineup

SINK BASE CABINETS

24" deep, 34-1/2" high except where noted.

*39" and 42" widths will have a vertical center stile unless otherwise noted

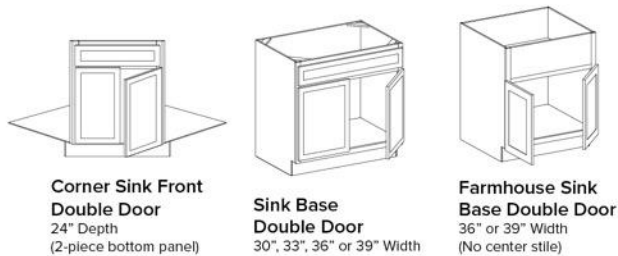

Corner Sink Front Double Door
24" Depth
(2-piece bottom panel)

Sink Base Double Door
30", 33", 36" or 39" Width

Farmhouse Sink Base Double Door
36" or 39" Width
(No center stile)

VANITY CABINETS

21" deep, 34-1/2" high except where noted

*42" widths will have a vertical center stile

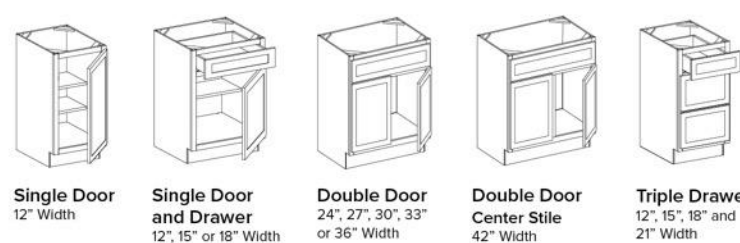

Single Door
12" Width

Single Door and Drawer
12", 15" or 18" Width

Double Door
24", 27", 30", 33" or 36" Width

Double Door Center Stile
42" Width

Triple Drawer
12", 15", 18" and 21" Width



Linen Single & Double Door
84" (6 shelves)
Single - 15" and 18" Width
Double - 24" Width

TALL CABINETS

24" deep except where noted.

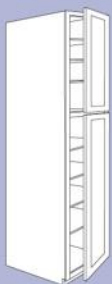

Utility/Pantry Single Door
84", 90" (6 shelves), or 96" Height (7 shelves)
18" Width

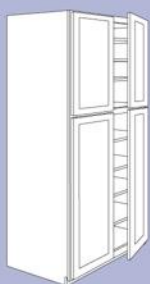

Utility/Pantry Double Door
84", 90" (6 shelves), or 96" Height (7 shelves)
24" or 30" Width

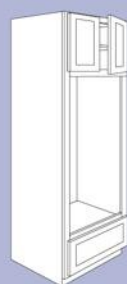

Oven Double Door, Single Drawer
84", 90" or *96" Height
33" Width
*Single shelf in 96" only
(Double Oven Overlay Panel available)

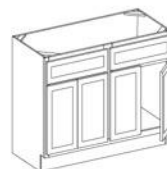

Two Double Door
48" Width



Double Door and Double Drawer
36", 42" or 48" Width

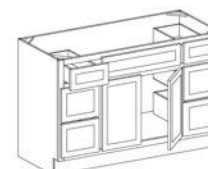

Double Door and Six Drawer
60" Width

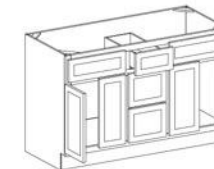

Two Double Door and Triple Drawer
60" Width

Complete the Look - Accessories

Add the finishing touch to your client's cabinets with our broad selection of cabinet accessories. Whether your client's ideal space is traditional, transitional, or contemporary, we have the selection available to transform the space from ordinary to extraordinary.



**OVERLAY
FILLERS**



**SPECIALTY
CABINETS**



MOULDING



**DECORATIVE
WOOD**



**DECORATIVE
PANELS**

Everything you need for a beautiful and organized kitchen, bath, closet and more



Add the finishing touches with these other products from Hardware Resources:

- Trashcan pullouts
- Drawer organizers
- Best-in-class pullouts
- Stainless steel sinks
- Easy-to-use linear lighting fixtures
- Tucked-away power strips
- Beautiful knobs and pulls to complete the look

KNOBS & PULLS

ORGANIZATION

SINKS

CABINETS

LED LIGHTING
& POWER

Largest Portfolio of Knob & Pull Brands

TK | TOP
KNOBS

atlas
HOMEWARES

JEFFREY ALEXANDER
by Hardware Resources

ELEMENTS
by Hardware Resources



Literature & Samples



Homeowner Catalog

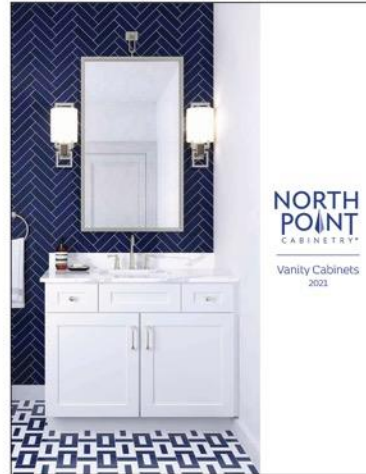

Vanity Catalog



Homeowner Selection Guide



Spec Book

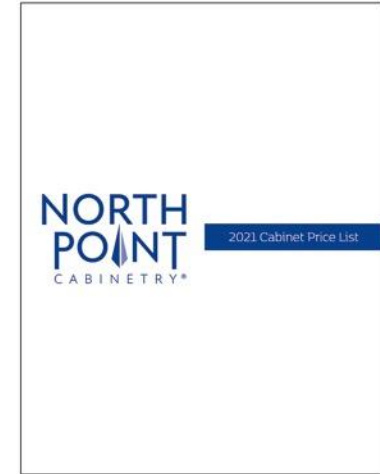

Price Book



Sample Door Kit



Mini Base Cabinets

- Miniature version of our base cabinets (Premier Series)
- Small footprint
- Demonstrates the quality and functionality of our cabinets

Also available: Touch Up Kits (not shown)



Competitive Advantages

- Strong array of SKU's
 - Same SKU array across both collections & door styles
- Multiple price points
- Total landed cost known at time of order
 - Freight included on orders over \$600.00
 - \$100.00 Freight on orders under \$600.00
- Bath vanity program
- Robust replacement parts program
- Dedicated customer service team
- Regular salesperson who you are used to
- Bills on your Hardware Resources account—no new payables or accounting needed