



# NORTH POINT CABINETRY®

Thoughtfully Designed,  
Carefully Crafted

Presented by:

Chris Rorke  
Director of Field Sales





# The NorthPoint Cabinetry Solution

---

NorthPoint Cabinetry features a wide array of **QuickBuild®** cabinet designs, providing value with a quality, custom look.

- Unique dovetail and pocket screw cabinet construction for sturdy and fast assembly
- Free freight on most orders
- Robust replacement parts program
- Dedicated customer service support

With 5 dedicated warehouses across the country, NorthPoint Cabinetry typically ships within 48 hours and arrives in 2–3 business days.

# The Quick Advantage

---

## Ships QUICKLY, Assembles FAST

NorthPoint Cabinetry offers a **quick** advantage for you and your customer by making it fast and easy to design, order, ship & assemble cabinets.

***Why does this matter?*** With a reduction in time and labor, you can complete more jobs and see significant savings.



# 4 WAYS QUICK ADVANTAGE SAVES TIME & MONEY

- **Quick to Design**

Our cabinets are available in 2020 and ProKitchen software, making kitchen design fast and easy.

2020



**ProKitchen**  
Professional Design Software

- **Quick to Order**

Place an order for your cabinets with our quoting tool, on our website at [NorthPointCabinetry.com](http://NorthPointCabinetry.com), or by contacting a live customer service agent.

- **Quick to Ship**

With 5 dedicated warehouses across the country, orders typically ship within 48 hours and arrive in 2–3 business days.



- **Quick to Assemble**

With our **QuickBuild®** cabinets, the average assembly time per cabinet is 8 minutes\*; you can build a medium sized kitchen in less than half a day.

*\*Specialty cabinets may take longer than average to assemble.*

# What are **QuickBuild®** Cabinets?

## **Dovetail + Pocket Screws = QuickBuild®**

- Simple assembly: slide the panels together and secure with pocket screws
- No extra fasteners needed to hold the panels in place
- Conveniently placed pocket screws reduce build time



### **How fast can you build a cabinet?**

One of our cabinets takes about 8 minutes\* to assemble (many do it in 4).  
You can build a kitchen or bathroom in record time!



# Quality Comes First

---

You can trust NorthPoint Cabinetry for your customers. Our cabinets and hardware have gone through rigorous third-party testing and meet the KCMA standards. With quality details throughout and the features your customer will appreciate, NorthPoint Cabinetry is built to last.



**It Starts with  
Quality Wood**

**Thoughtful  
Craftsmanship**



**Structural  
Integrity**



**Sturdy  
Shelves**



**Hardworking  
Hardware**

**Premium  
Drawer  
Boxes**



**Pretty on  
the Inside,  
Too**



# PREMIER

Collection



The Premier Collection features elegant upgrades like soft-close doors and drawers.

## Door Styles: Catalina, Maui

- 3/4" solid wood face frame & shelves
- 1/2" plywood cabinet construction
- Beautiful, finished interior
- 5-Year limited lifetime warranty

Catalina Profile



Maui Profile

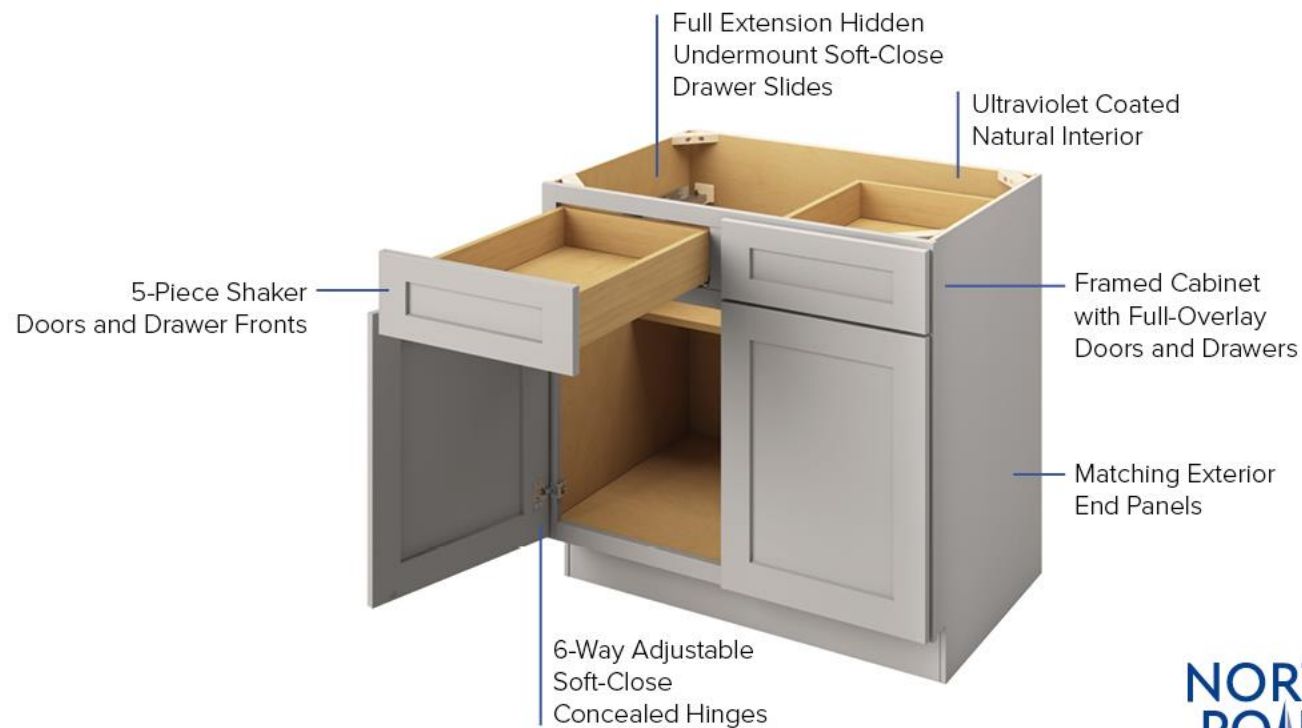

# ESSENTIALS

Collection



The Essentials Collection delivers on style at an impressive value.

## Door Style: Hatteras

- 3/4" solid wood face frame & shelves
- 1/2" plywood cabinet construction
- Beautiful, finished interior
- 1-Year limited lifetime warranty

### Hatteras Profile

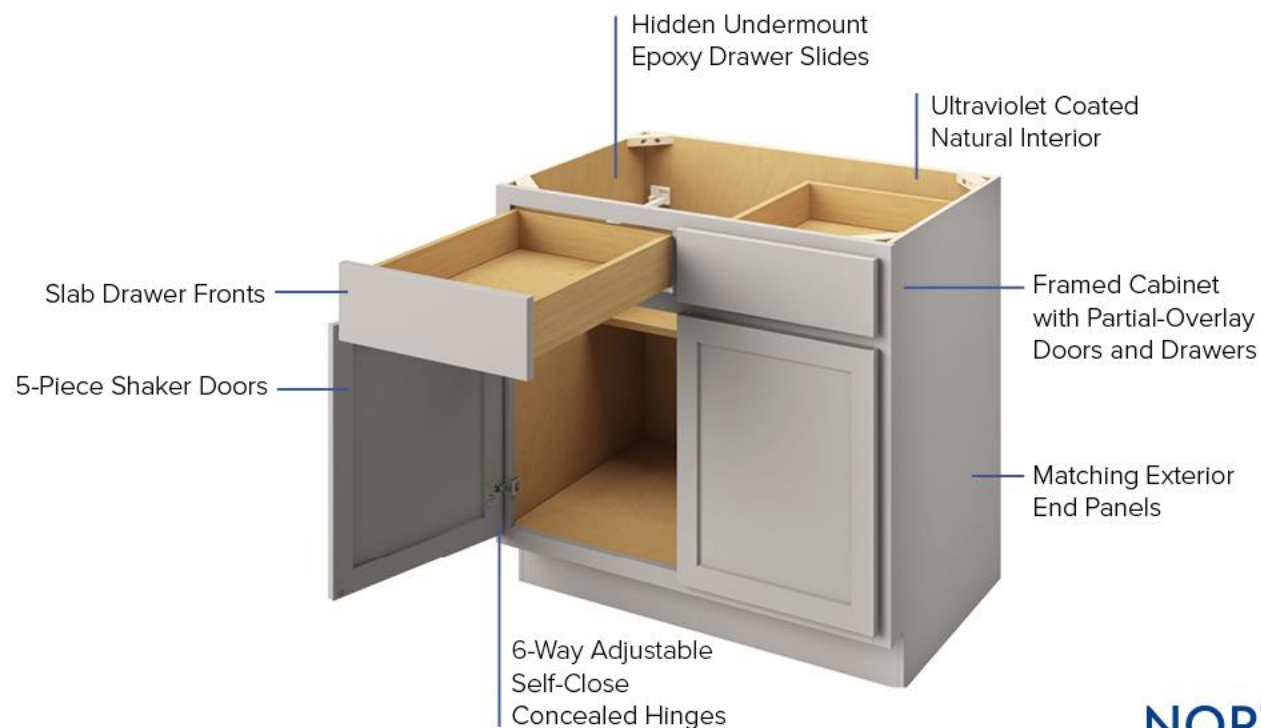
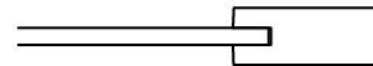

# PREMIER COLLECTION: CATALINA

## CATALINA FINISHES

More than modern. The Catalina door style features a full-overlay, Shaker style door and 5-piece drawer front.



POLAR WHITE



PEBBLE GREY



ESPRESSO



SLATE



# PREMIER COLLECTION: MAUI

## MAUI FINISHES

Sometimes the details make all the difference. The Maui door style features a full-overlay, transitional style door and 5-piece drawer front with a twist of character.



POLAR WHITE



PEBBLE GREY



ESPRESSO



SLATE



# ESSENTIALS COLLECTION: HATTERAS

## HATTERAS FINISHES

Simple and sleek. The Hatteras door style features a partial-overlay, Shaker style door and slab drawer front.



POLAR WHITE



PEBBLE GREY



ESPRESSO





Wine Bar

## Cabinets for Any Space

The kitchen and bath are common spaces to install cabinetry. However, NorthPoint Cabinetry provides solutions for other spaces like the laundry room, mudroom, and entertainment areas. Cabinets make those areas more functional by providing additional storage and countertop work space.



Laundry Room



Mudroom

# Cabinet Lineup

## WALL CABINETS

12" deep except where noted  
42" high wall cabinets will have 3 shelves  
\*39" and 42" widths will have a vertical center stile unless otherwise noted



**Double Door**  
12" Height  
30", 33", 36"  
or \*39" Width

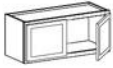

**Double Door**  
15" Height  
30", 33", 36"  
or \*39" Width



**Double Door**  
18" Height  
21", 24", 30", 33", 36"  
or \*39" Width



**Double Door**  
24" Height  
30", 33", 36" or \*39" Width

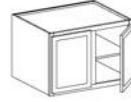

**Deep Double Door**  
18" or 24" Height • 24" Depth  
36" or \*39" Width  
18" Height does not have shelf



**Single Door**  
30" Height  
9", 12", 15", 18" or 21" Width



**Double Door**  
30" Height  
24", 27", 30", 33",  
36", \*39" or \*42" Width



**Single Door**  
36" Height  
9", 12", 15", 18" or 21" Width



**Double Door**  
36" Height  
24", 27", 30", 33",  
36", \*39" or \*42" Width



**Single Door**  
42" Height  
9", 12", 15", 18" or 21" Width



**Double Door**  
42" Height  
24", 27", 30", 33",  
36", \*39" or \*42" Width



**Single & Double Glass Door**  
Matching Finish Color Interior  
30" Height  
15", 18", 30" or 36" Width



**Single & Double Glass Door**  
Matching Finish Color Interior  
36" Height  
15", 18", 30" or 36" Width



**Single & Double Glass Door**  
Matching Finish Color Interior  
42" Height  
15", 18", 30" or 36" Width

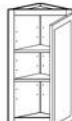

**Wall End Single Door**  
30", 36" or 42" Height  
12" Width

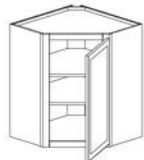

**Diagonal Corner**  
30", 36" or 42" Height  
12 or 15" Depth  
24" and 27" Width

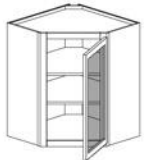

**Diagonal Corner Glass Door**  
Matching Finish Color Interior  
30", 36" or 42" Height  
12 or 15" Depth  
24" and 27" Width



**Universal Blind Corner**  
30", 36" or 42" Height  
30"-33" Width



**Microwave Wall Cabinet**  
36" Height  
30" Width



**Microwave Wall Cabinet**  
Extended Shelf  
18" Height  
30" Width

*Glass door wall cabinets only available in the Premier collection*

*Glass door wall cabinets only available in the Premier collection*

## BASE CABINETS

24" deep, 34-1/2" high  
except where noted

\*39" and 42" widths will  
have a vertical center stile  
unless otherwise noted



**Full Height Single Door**  
9", 12", 15" or 18" Width



**Single Door and Drawer**  
12", 15", 18" or 21" Width



**Double Door and Single Drawer**  
24", 27" or 30" Width

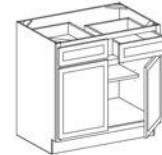

**Double Door and Double Drawer**  
33", 36", \*39" or \*42" Width



**Double Drawer**  
30" or 36" Width



**Triple Drawer**  
12", 15", 18", 21", 24", 30"  
or 36" Width

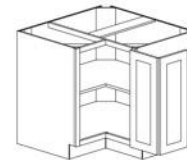

**Base Corner Cabinet**  
33" or 36" Width  
*(Lazy Susan inserts available)*



**Universal Blind Base Corner**  
39"-42", 42"-45" or  
\*45-48" Width



**Microwave Base Cabinet with Drawer**  
30" Width

# Cabinet Lineup

## SINK BASE CABINETS

24" deep, 34-1/2" high except where noted.

\*39" and 42" widths will have a vertical center stile unless otherwise noted

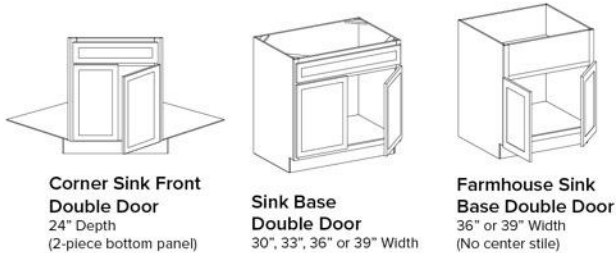

**Corner Sink Front Double Door**  
24" Depth  
(2-piece bottom panel)

**Sink Base Double Door**  
30", 33", 36" or 39" Width

**Farmhouse Sink Base Double Door**  
36" or 39" Width  
(No center stile)

## VANITY CABINETS

21" deep, 34-1/2" high except where noted

\*42" widths will have a vertical center stile

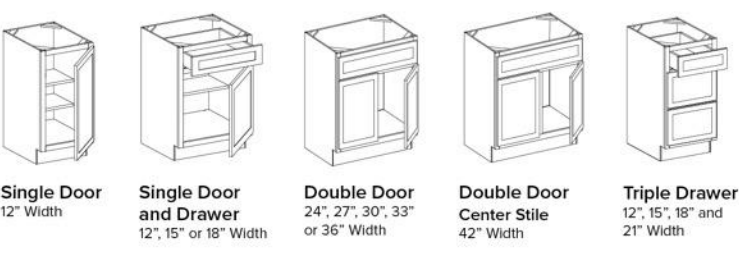

**Single Door**  
12" Width

**Single Door and Drawer**  
12", 15" or 18" Width

**Double Door**  
24", 27", 30", 33" or 36" Width

**Double Door Center Stile**  
42" Width

**Triple Drawer**  
12", 15", 18" and 21" Width

## TALL CABINETS

24" deep except where noted.



**Utility/Pantry Single Door**  
84", 90" (6 shelves), or 96" Height (7 shelves)  
18" Width

**Utility/Pantry Double Door**  
84", 90" (6 shelves), or 96" Height (7 shelves)  
24" or 30" Width

**Oven Double Door, Single Drawer**  
84", 90" or \*96" Height  
33" Width  
\*Single shelf in 96" only  
(Double Oven Overlay Panel available)



**Two Double Door**  
48" Width



**Double Door and Double Drawer**  
36", 42" or 48" Width

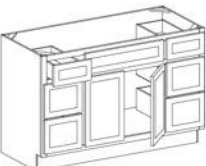

**Double Door and Six Drawer**  
60" Width

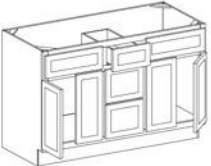

**Two Double Door and Triple Drawer**  
60" Width

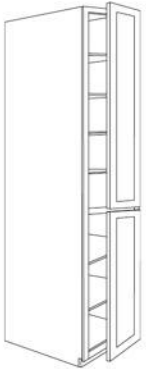

**Linen Single & Double Door**  
84" (6 shelves)  
Single - 15" and 18" Width  
Double - 24" Width

# Complete the Look - Accessories

---

Add the finishing touch to your client's cabinets with our broad selection of cabinet accessories. Whether your client's ideal space is traditional, transitional, or contemporary, we have the selection available to transform the space from ordinary to extraordinary.



**OVERLAY  
FILLERS**



**SPECIALTY  
CABINETS**



**MOULDING**



**DECORATIVE  
WOOD**



**DECORATIVE  
PANELS**

# Everything you need for a beautiful and organized kitchen, bath, closet and more



## Add the finishing touches with these other products from Hardware Resources:

- Trashcan pullouts
- Drawer organizers
- Best-in-class pullouts
- Stainless steel sinks
- Easy-to-use linear lighting fixtures
- Tucked-away power strips
- Beautiful knobs and pulls to complete the look

KNOBS & PULLS

ORGANIZATION

SINKS

CABINETRY

LED LIGHTING  
& POWER

# Largest Portfolio of Knob & Pull Brands

---

TK | TOP  
KNOBS

atlas  
HOMEWARES

JEFFREY ALEXANDER®  
by Hardware Resources

ELEMENTS®  
by Hardware Resources



# Literature & Samples



Homeowner Catalog

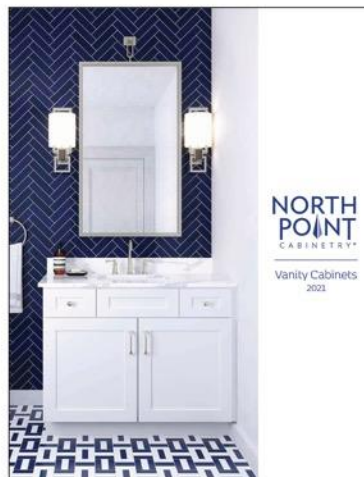

Vanity Catalog



Homeowner  
Selection Guide



Spec Book

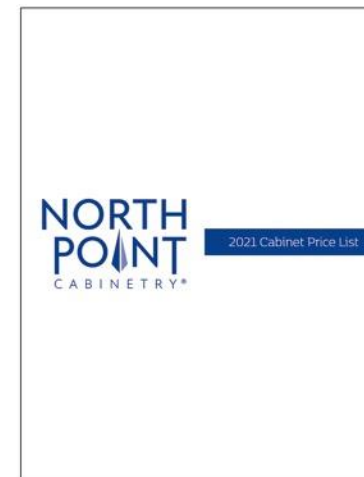

Price Book



Sample Door Kit



Mini Base Cabinets

- Miniature version of our base cabinets (Premier Series)
- Small footprint
- Demonstrates the quality and functionality of our cabinets

Also available: Touch Up Kits (not shown)



## Ordering Made Easy

---

3 convenient methods for easy order placement.

1. Online: [www.NorthPointCabinetry.com](http://www.NorthPointCabinetry.com)
2. Email: [Orders@NorthPointCabinetry.com](mailto:Orders@NorthPointCabinetry.com)
3. Fax: (318) 742-9513

Question about an order? Call Customer Service at (800) 463-0660 from 7 am to 6 pm Central Time.

*We recommend placing orders online for faster processing and delivery and to easily confirm products are in stock.*

# Design & Quoting Tools

NorthPoint Cabinetry products are available in ProKitchen and 2020 Design Software so that you have access to the right tools to create amazing spaces.



[www.ProKitchenSoftware.com](http://www.ProKitchenSoftware.com)



[www.2020spaces.com](http://www.2020spaces.com)



QUICK & EASY QUOTING  
DOWNLOAD OUR NEW  
QUOTING TOOL



## NorthPoint Cabinetry Proprietary Quoting Tool:

- Available for download
- In-house costing and customer-facing presentation



# Competitive Advantages

---

- Strong array of SKU's
  - Same SKU array across both collections & door styles
- Multiple price points
- Total landed cost known at time of order
  - Freight included on orders over \$600.00
  - \$100.00 Freight on orders under \$600.00
- Bath vanity program
- Robust replacement parts program
- Dedicated customer service team
- Regular salesperson who you are used to
- Bills on your Hardware Resources account—no new payables or accounting needed

# Want to know more?

---

Contact your local Hardware Resources  
Sales Representative for more info today!

## Ordering Made Easy

Online: [www.NorthPointCabinetry.com](http://www.NorthPointCabinetry.com)

Email: [Orders@NorthPointCabinetry.com](mailto:Orders@NorthPointCabinetry.com)

Fax: (318) 742-9513

Questions about your order call our  
friendly Customer Service Department at  
(800) 463-0660

