

## Type II Technical Chart

Used for Street Lighting, Parking Lot and Security Lighting, Recreational and Industrial Lighting

### Direct Embedment

CATALOG NUMBER SMOOTH GRAY	MOUNTING HEIGHT (Ft.)	POLE WEIGHT (Lbs.)	OVERALL LENGTH (Ft.)	POLE SIZE (In.)		EPA AT POLE TIP (Sq. Ft.)					ULTIMATE GROUNDLINE MOMENT (Ft. Lbs.)	BREAKING LOAD 2 Ft. FROM TIP (Lbs.)
				TIP	BUTT	90 MPH	110 MPH	130 MPH	140 MPH	160 MPH		
252002	20.5	1667	25.0	6.0	10.06	102	65	44	37	26	38,100	2,059
302002	25.0	2,220	30.0	6.0	10.88	88	55	36	30	20	43,100	1,873
352002	29.5	2,863	35.0	6.0	11.69	77	47	30	24	15	47,900	1,741
402002	34.0	3,601	40.0	6.0	12.50	68	40	25	19	11	52,900	1,653
452002	38.5	4,442	45.0	6.0	13.31	61	35	20	15	7	57,700	1,580
502002	43.0	5,392	50.0	6.0	14.13	54	29	15	10	3	62,500	1,524
552002	47.5	6,537	55.0	6.0	14.94	98	58	35	27	15	114,900	2,525
602002	52.0	7,732	60.0	6.0	15.75	94	55	32	27	12	127,000	2,540
652002	56.5	9,055	65.0	6.0	16.56	89	50	28	20	9	137,900	2,530
702002	61.0	10,514	70.0	6.0	17.38	84	45	24	16	5	147,700	2,503

### General Information

1. Different colors, finishes and exposed aggregates are available upon request.
2. Longer lengths of poles available upon request.
3. All corners are chamfered.
4. 7,000 PSI gray concrete is standard; higher strengths are available if required. The EPA's listed for poles using 7,000 psi concrete shall be reduced by 15% when decorative mixes are used.
5. STRENGTH: In most cases a higher ground line moment and a higher breaking strength and EPA can be attained without going to a larger pole.
6. EFFECTIVE PROJECTED AREA (EPA): Lonestar Prestress Mfg. concrete poles and mounting arms have been designed in accordance with accepted engineering practices to be structurally capable of withstanding wind loads and velocity pressure per ASCE 7-05. Poles to meet higher wind loads are available.
7. HOLES: Holes are precast to meet your specifications and requirements for mounting attachments, most any desired arrangement can be provided. Contact Lonestar Prestress Mfg. for any questions about field drilling light poles.
8. INSTALLATION: Lonestar Prestress Mfg. concrete poles are designed for setting directly into the ground, without the use of precast foundations, similar to the setting of wood poles. After the hole is drilled, the pole is set and plumbed, the earth is then backfilled and tamped. The depth is dependent on the nature of the soil and the anticipated load. Where it is impossible to embed the poles in the ground, such as on bridges or overpasses, a bolt down base plate is available.
9. To specify a base plate for base mounted poles add the suffix BP to catalog numbers. Customer to supply the bolt circle drawings or template.



STOCK CODE:  
DISTRIBUTOR:



8892 Hwy 159 E  
Bellville, TX 77418  
www.lonestarprestress.com  
Tel: (713) 896-0994  
Fax: (713) 896-0762

DWG. NO: \_\_\_\_\_ REV: \_\_\_\_\_  
CAT. NO: 252002 DATE: 7/10/14  
PROJECT: \_\_\_\_\_

APPROVED BY: \_\_\_\_\_ DATE: \_\_\_\_\_

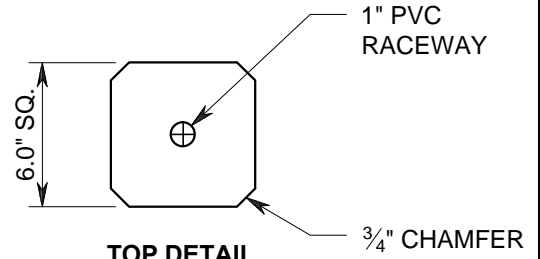
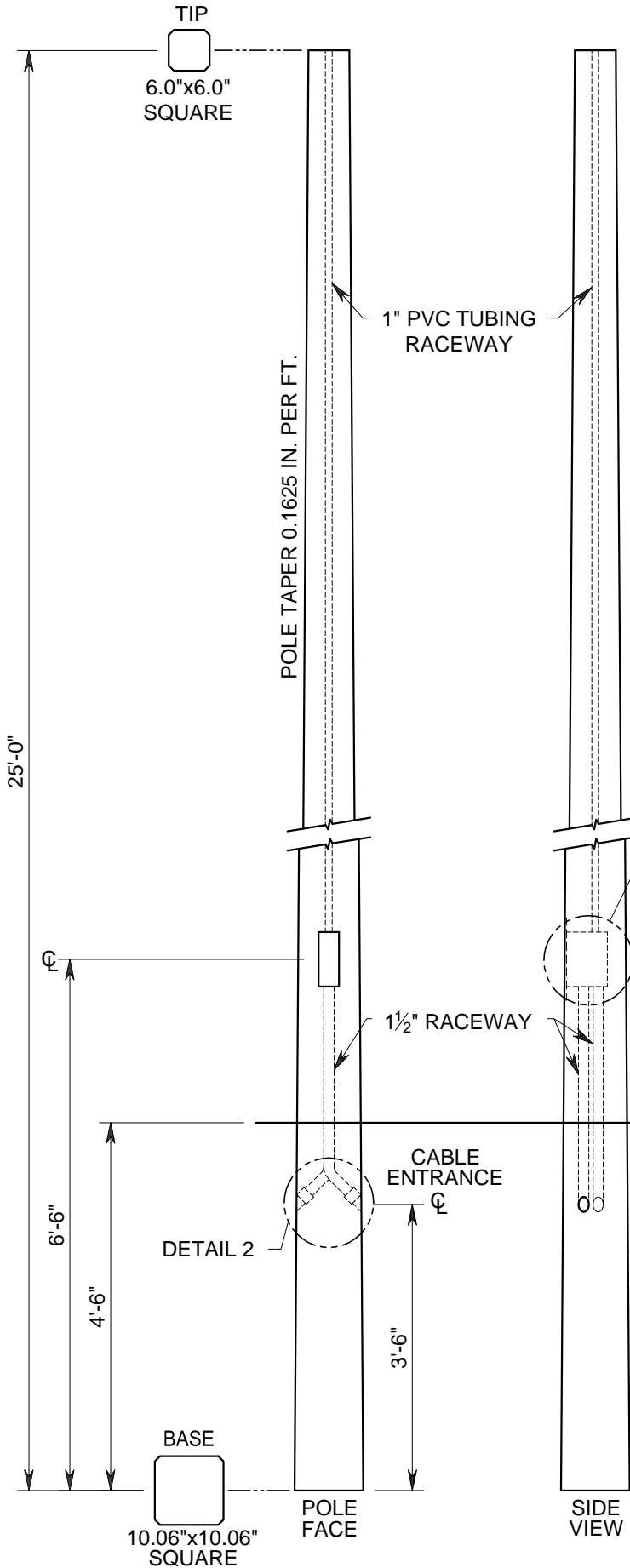

**TOP DETAIL  
TOP OF POLE**

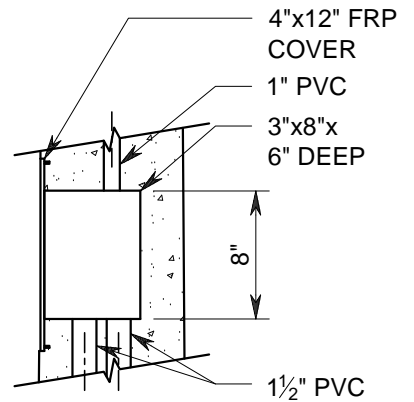

**DETAIL 1  
HAND HOLE WITH  
RECESSED COVER**

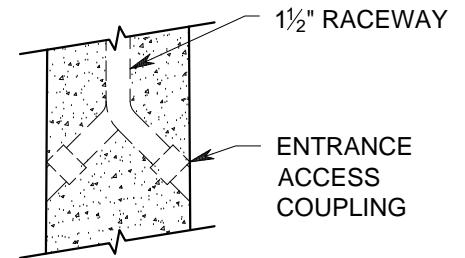

**DETAIL 2  
CABLE ENTRANCE**

\* Rule of Thumb: 10% of length of pole plus 2 feet.  
Actual depth of embedment to be determined by customer.

DESCRIPTION: **25'-0" TYPE II  
(SQ.) TOP MOUNT POLE**

TRUCK LOAD QTY:	QTY:
WEIGHT: 1,667 LBS.	
FINISH: SMOOTH FORM GRAY	



STOCK CODE:  
DISTRIBUTOR:



8892 Hwy 159 E  
Bellville, TX 77418  
www.lonestarprestress.com  
Tel: (713) 896-0994  
Fax: (713) 896-0762

DWG. NO: REV.  
CAT. NO: 352002 DATE: 7/10/14  
PROJECT:

APPROVED BY: DATE:

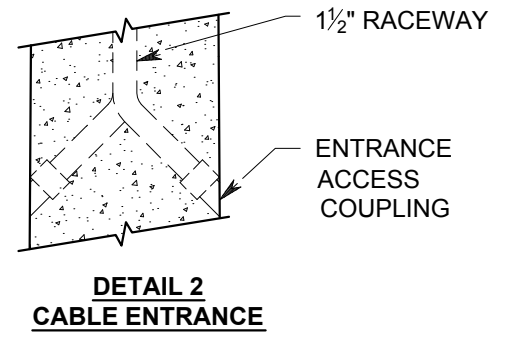
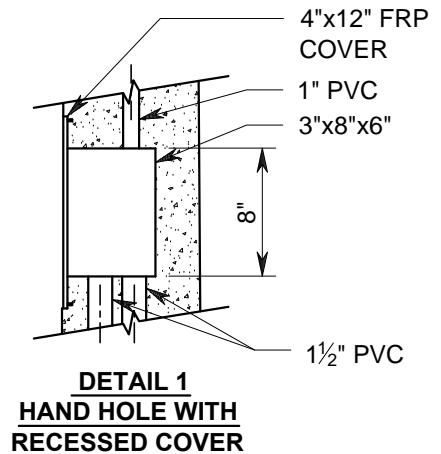
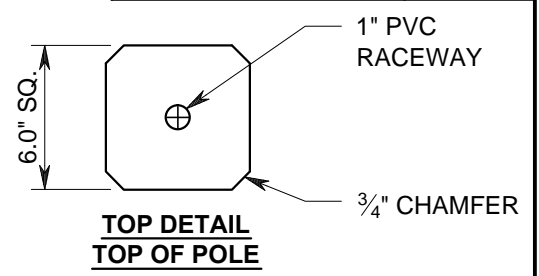
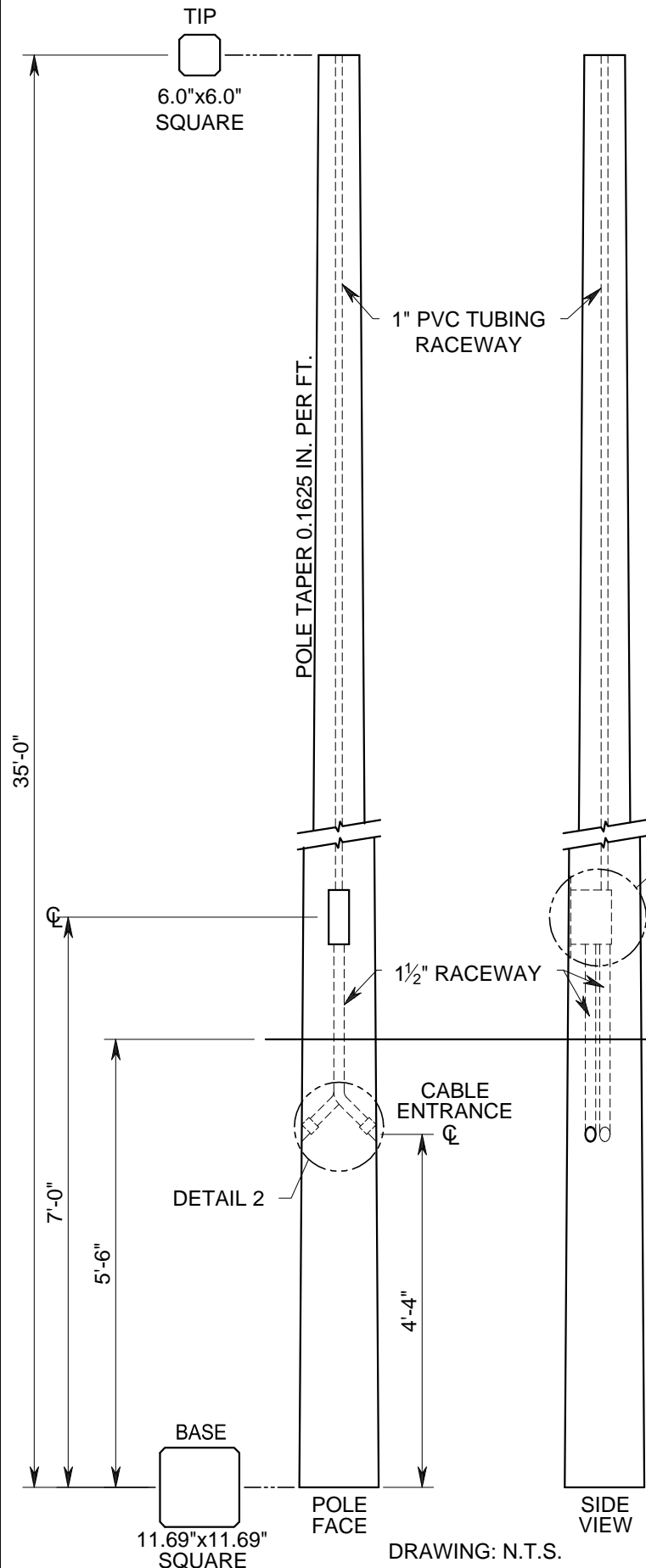

\* Rule of Thumb: 10% of length of pole plus 2 feet.  
Actual depth of embedment to be determined by customer.

DESCRIPTION: <b>35'-0" TYPE II (SQ.) TOP MOUNT POLE</b>	
TRUCK LOAD QTY:	QTY:
WEIGHT: 2,863 LBS.	
FINISH: SMOOTH FORM GREY	

DRAWING: N.T.S.

STOCK CODE:  
DISTRIBUTOR:



8892 Hwy 159 E  
Bellville, TX 77418  
www.lonestarprestress.com  
Tel: (713) 896-0994  
Fax: (713) 896-0762

DWG. NO: REV.  
CAT. NO: 402002 DATE: 7/21/14  
PROJECT:

APPROVED BY: DATE:

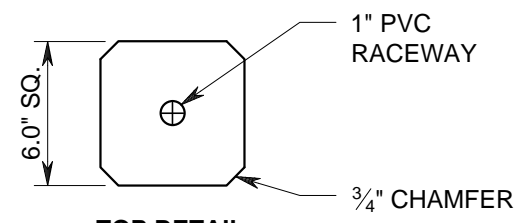
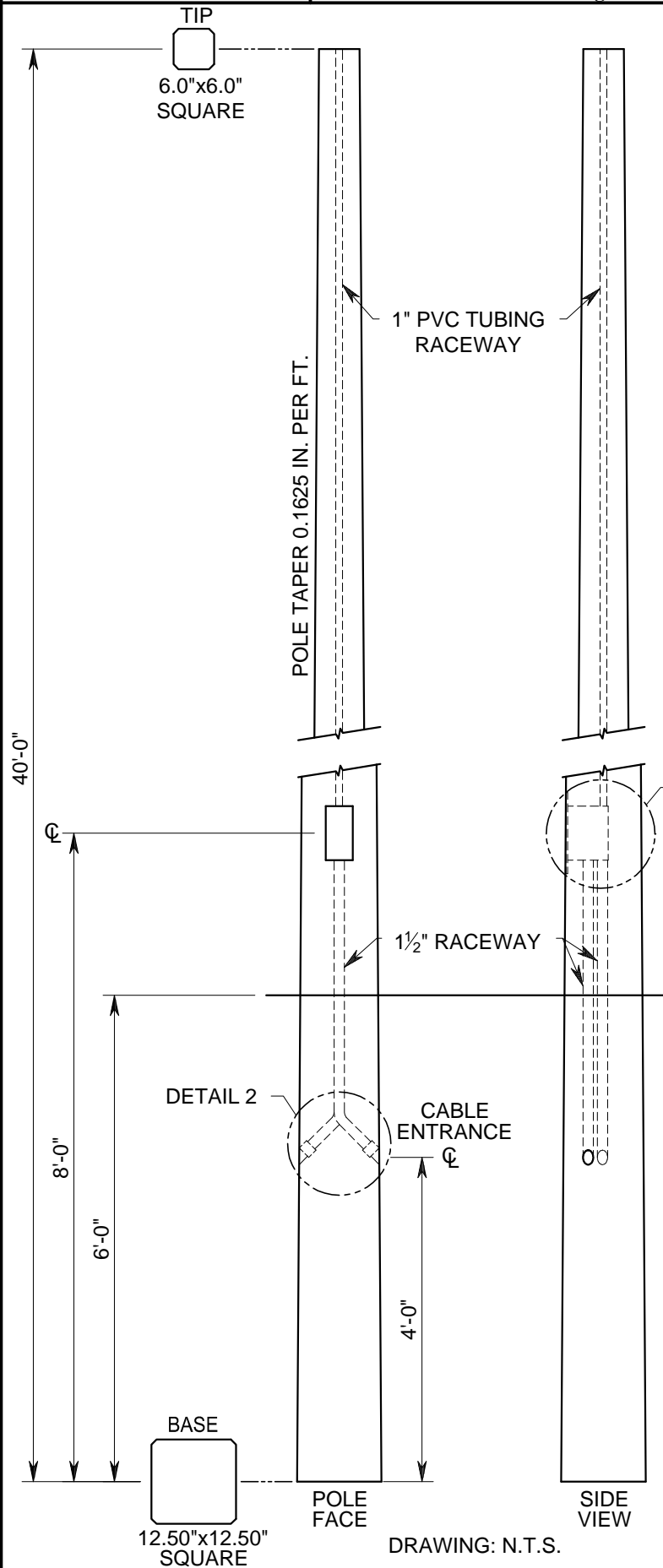

**TOP DETAIL  
TOP OF POLE**

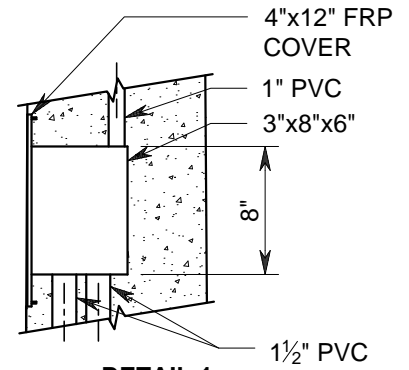

**DETAIL 1  
HAND HOLE WITH  
RECESSED COVER**

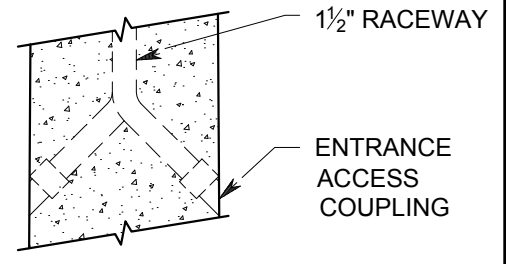

**DETAIL 2  
CABLE ENTRANCE**

\* Rule of Thumb: 10% of length of pole plus 2 feet.  
Actual depth of embedment to be determined by customer.

DESCRIPTION: **40'-0" TYPE II  
(SQ.) TOP MOUNT POLE**

TRUCK LOAD QTY:  
WEIGHT: 3,601 LBS.  
FINISH: SMOOTH FORM GREY

QTY:

DRAWING: N.T.S.

STOCK CODE:  
DISTRIBUTOR:



8892 Hwy 159 E  
Bellville, TX 77418  
www.lonestarprestress.com  
Tel: (713) 896-0994  
Fax: (713) 896-0762

DWG. NO: REV.  
CAT. NO: 452002 DATE: 7/21/14  
PROJECT:

APPROVED BY: DATE:

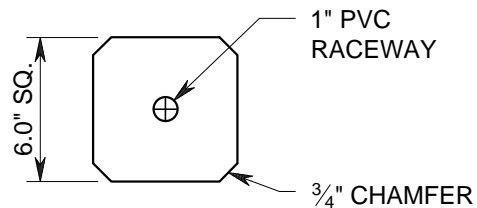
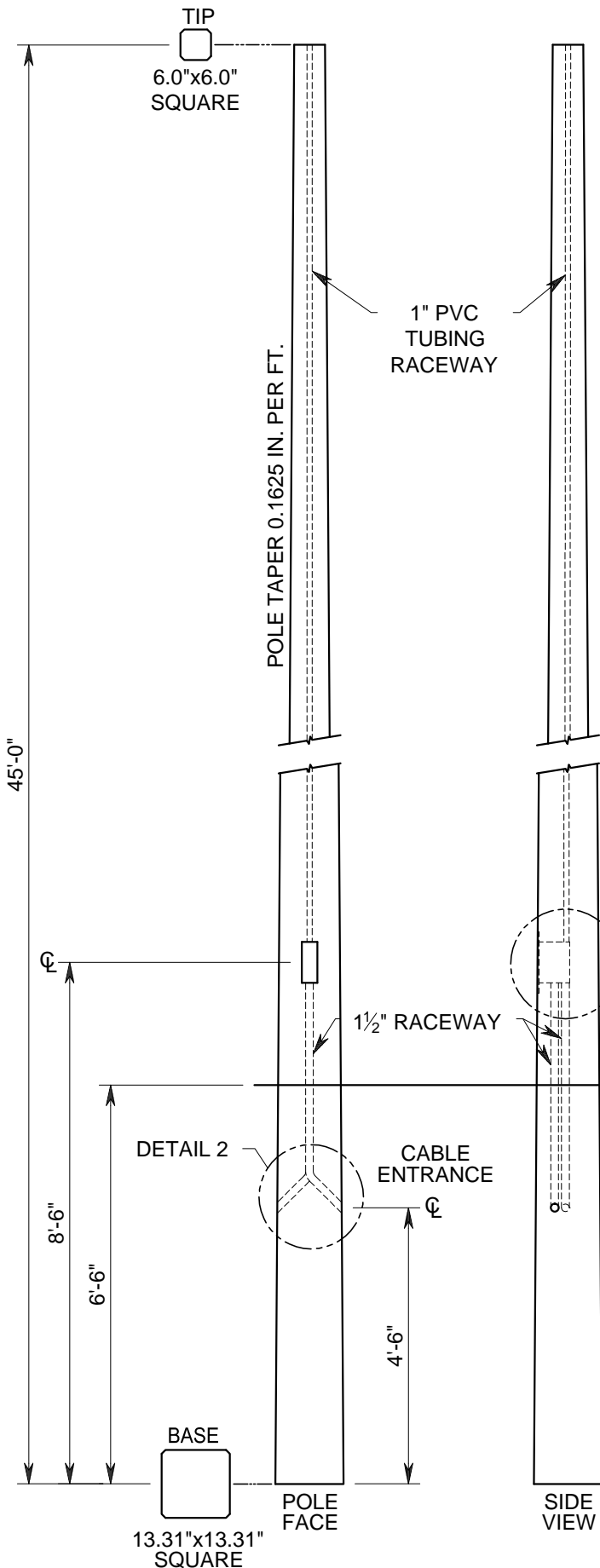

**TOP DETAIL  
TOP OF POLE**

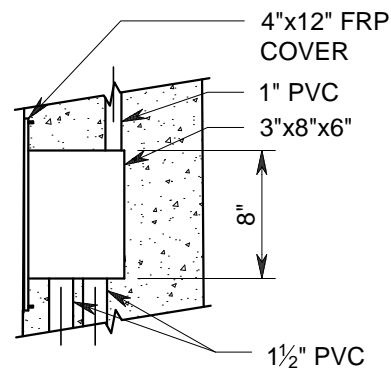

**DETAIL 1  
HAND HOLE WITH  
RECESSED COVER**

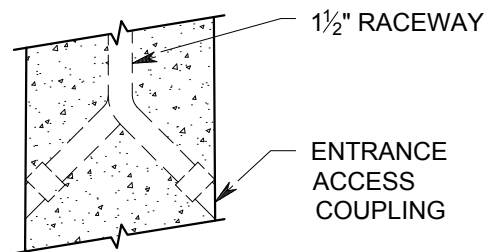

**DETAIL 2  
CABLE ENTRANCE**

Rule of Thumb: 10% of length of pole plus 2 feet.  
Actual depth of embedment to be determined by customer.

\*

DESCRIPTION: **45'-0" TYPE II  
(SQ.) TOP MOUNT POLE**

TRUCK LOAD QTY:	QTY:
WEIGHT: 4,442 LBS.	
FINISH: SMOOTH FORM GREY	

STOCK CODE:  
DISTRIBUTOR:



8892 Hwy 159 E  
Bellville, TX 77418  
www.lonestarprestress.com  
Tel: (713) 896-0994  
Fax: (713) 896-0762

DWG. NO:                      REV.  
CAT. NO:                      DATE:  
502002                      7/21/14  
PROJECT:

APPROVED BY:                      DATE:

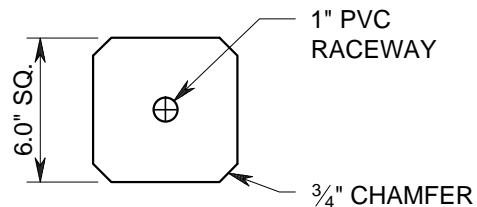
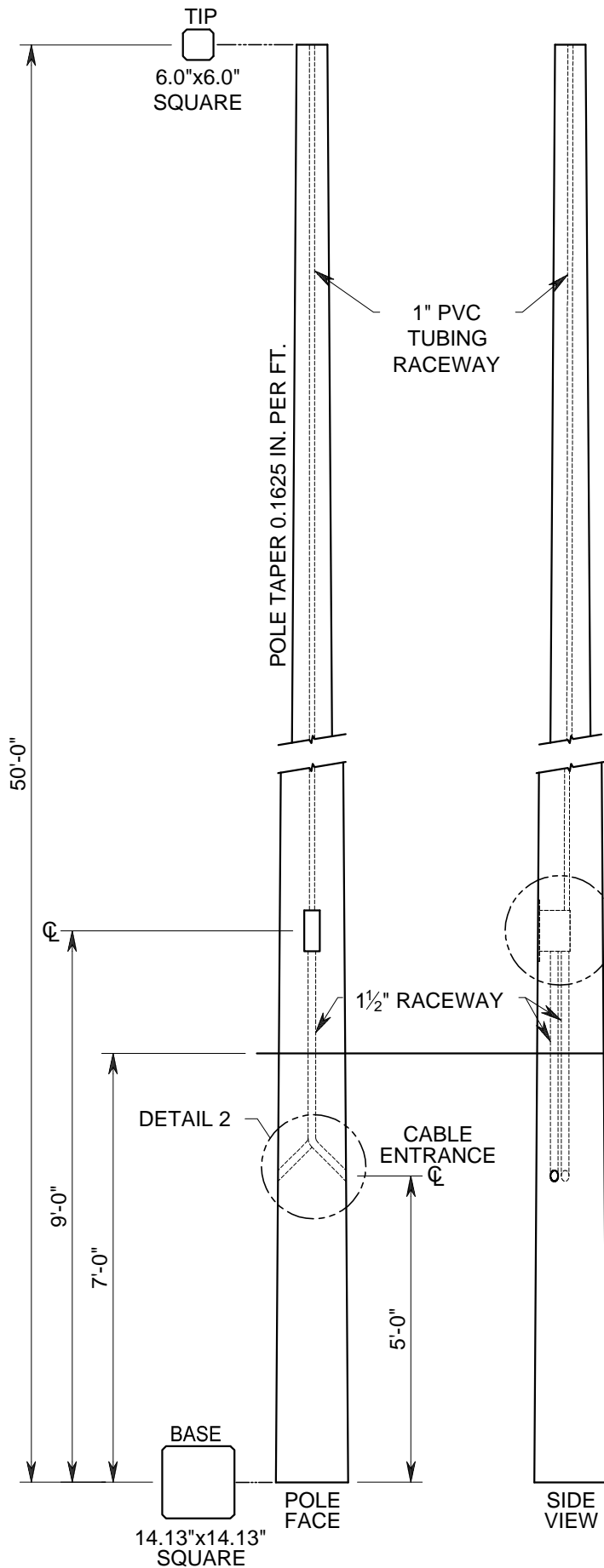

**TOP DETAIL  
TOP OF POLE**

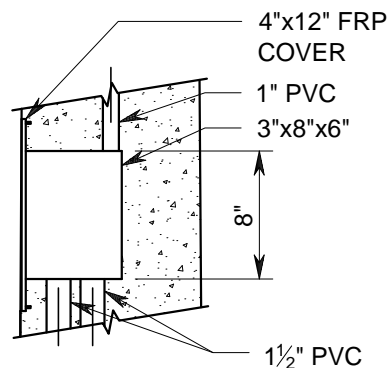

**DETAIL 1  
HAND HOLE WITH  
RECESSED COVER**

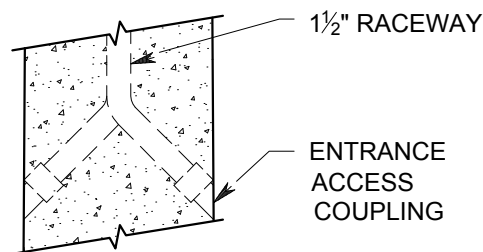

**DETAIL 2  
CABLE ENTRANCE**

\* Rule of Thumb: 10% of length of pole plus 2 feet.  
Actual depth of embedment to be determined by customer.

DESCRIPTION: **50'-0" TYPE II  
(SQ.) TOP MOUNT POLE**

TRUCK LOAD QTY:	QTY:
WEIGHT: 5,392 LBS.	
FINISH: SMOOTH FORM GREY	

STOCK CODE:  
DISTRIBUTOR:



8892 Hwy 159 E  
Bellville, TX 77418  
www.lonestarprestress.com  
Tel: (713) 896-0994  
Fax: (713) 896-0762

DWG. NO:                      REV.  
CAT. NO:                      DATE:  
552002                      7/21/14  
PROJECT:

APPROVED BY:                      DATE:

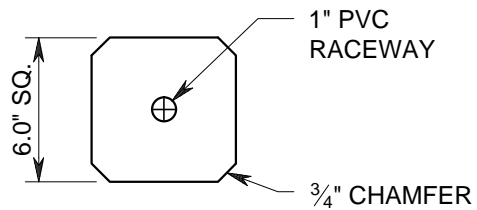
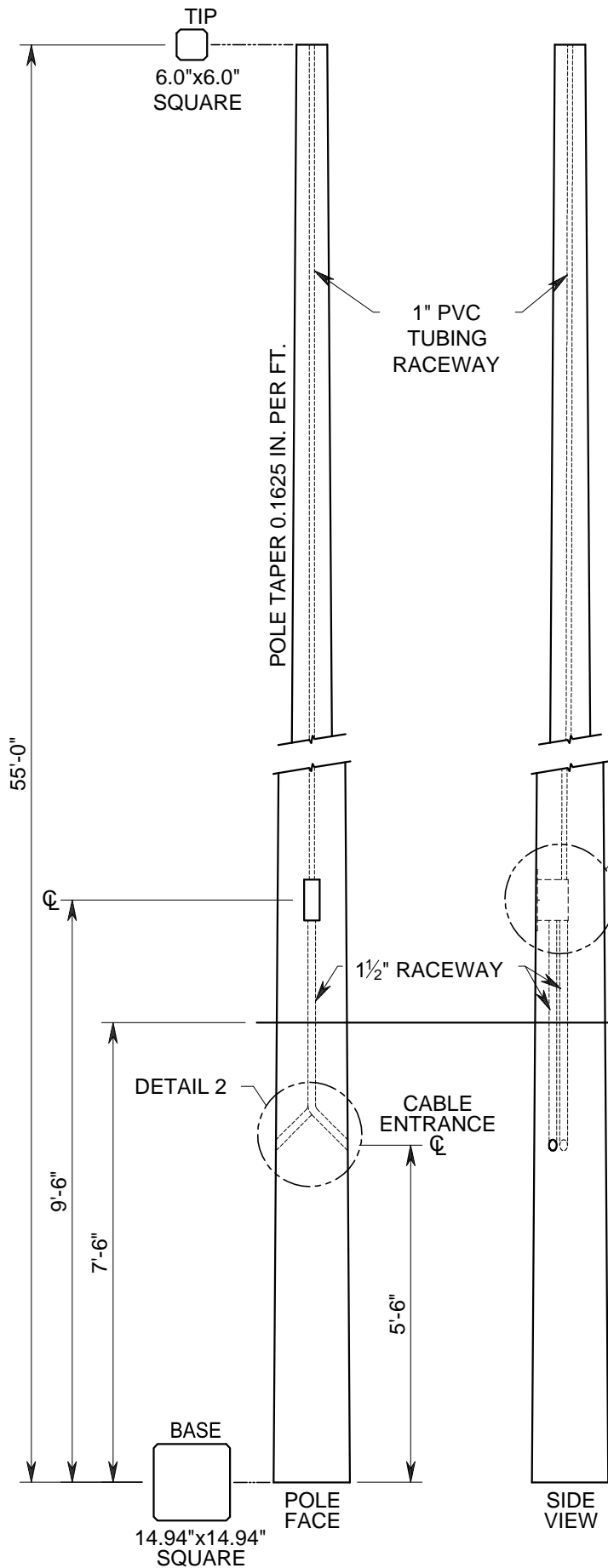

**TOP DETAIL  
TOP OF POLE**

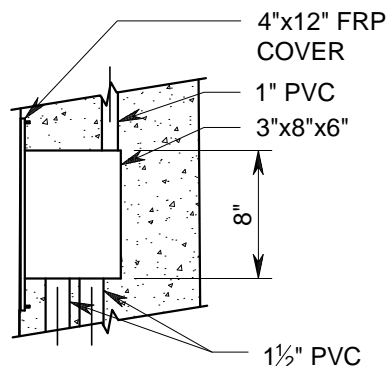

**DETAIL 1  
HAND HOLE WITH  
RECESSED COVER**

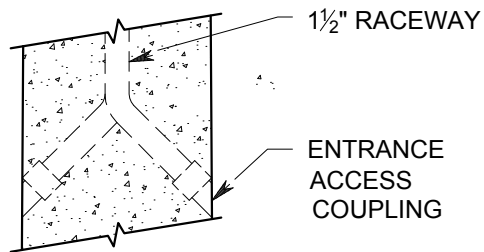

**DETAIL 2  
CABLE ENTRANCE**

\* Rule of Thumb: 10% of length of pole plus 2 feet.  
Actual depth of embedment to be determined by customer.

DESCRIPTION: **55'-0" TYPE II  
(SQ.) TOP MOUNT POLE**

TRUCK LOAD QTY:	QTY:
WEIGHT: 6,537 LBS.	
FINISH: SMOOTH FORM GREY	



STOCK CODE:  
DISTRIBUTOR:



8892 Hwy 159 E  
Bellville, TX 77418  
www.lonestarprestress.com  
Tel: (713) 896-0994  
Fax: (713) 896-0762

DWG. NO: REV.  
CAT. NO: 602002 DATE: 7/21/14  
PROJECT:

APPROVED BY: DATE:

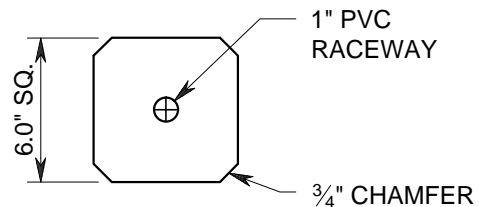
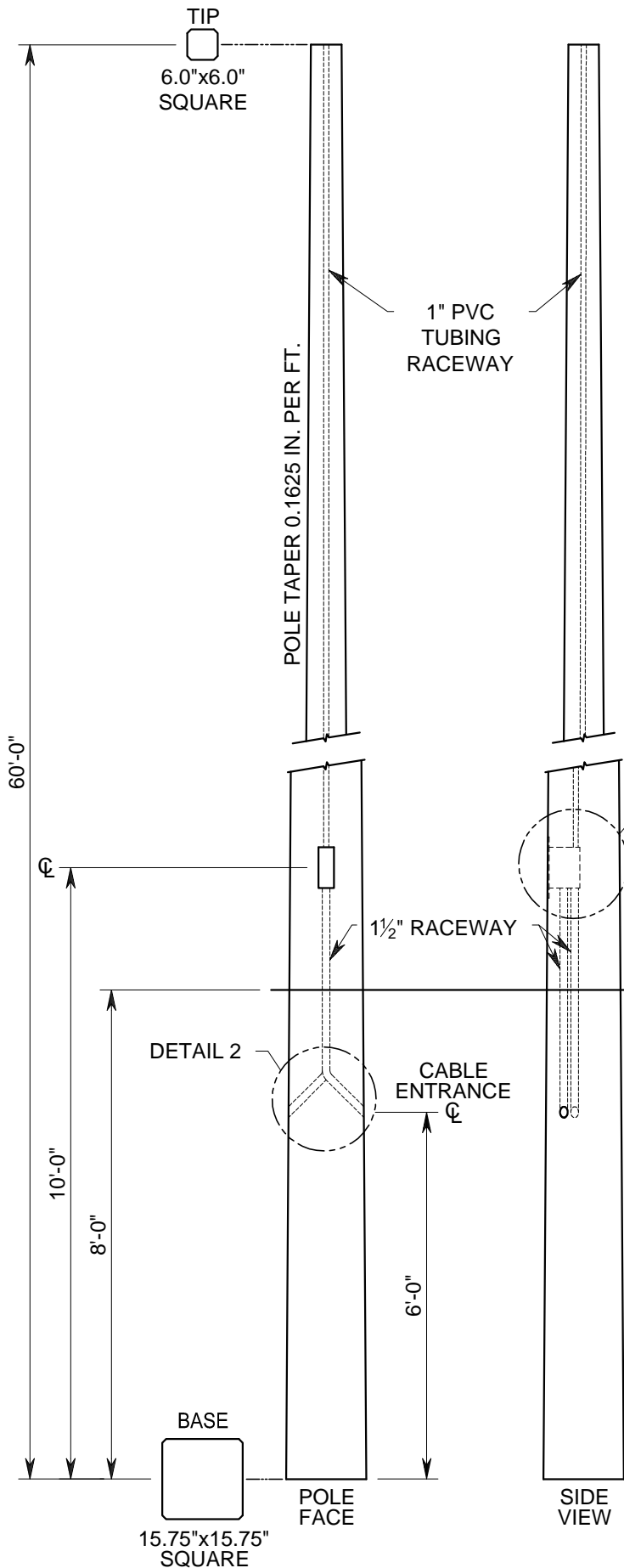

**TOP DETAIL  
TOP OF POLE**

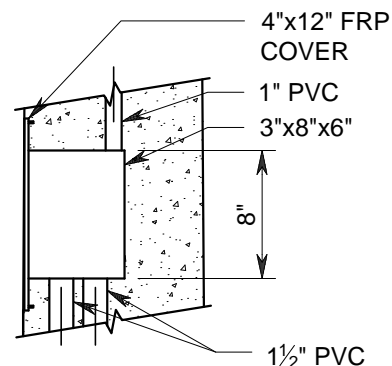

**DETAIL 1  
HAND HOLE WITH  
RECESSED COVER**

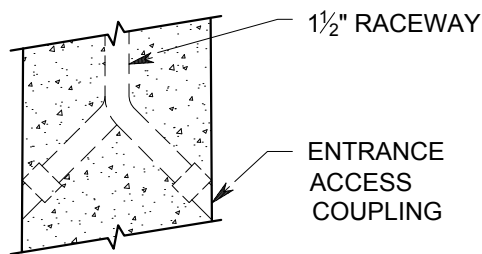

**DETAIL 2  
CABLE ENTRANCE**

\* Rule of Thumb: 10% of length of pole plus 2 feet.  
Actual depth of embedment to be determined by customer.

DESCRIPTION: <b>60'-0" TYPE II (SQ.) TOP MOUNT POLE</b>	
TRUCK LOAD QTY:	QTY:
WEIGHT: 7,732 LBS.	
FINISH: SMOOTH FORM GREY	

STOCK CODE:  
DISTRIBUTOR:



8892 Hwy 159 E  
Bellville, TX 77418  
www.lonestarprestress.com  
Tel: (713) 896-0994  
Fax: (713) 896-0762

DWG. NO: REV.  
CAT. NO: 652002 DATE: 7/21/14  
PROJECT:

APPROVED BY: DATE:

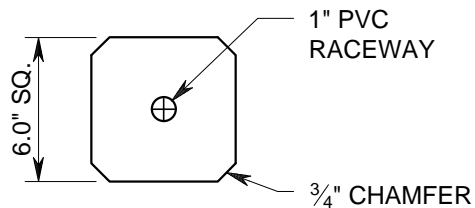
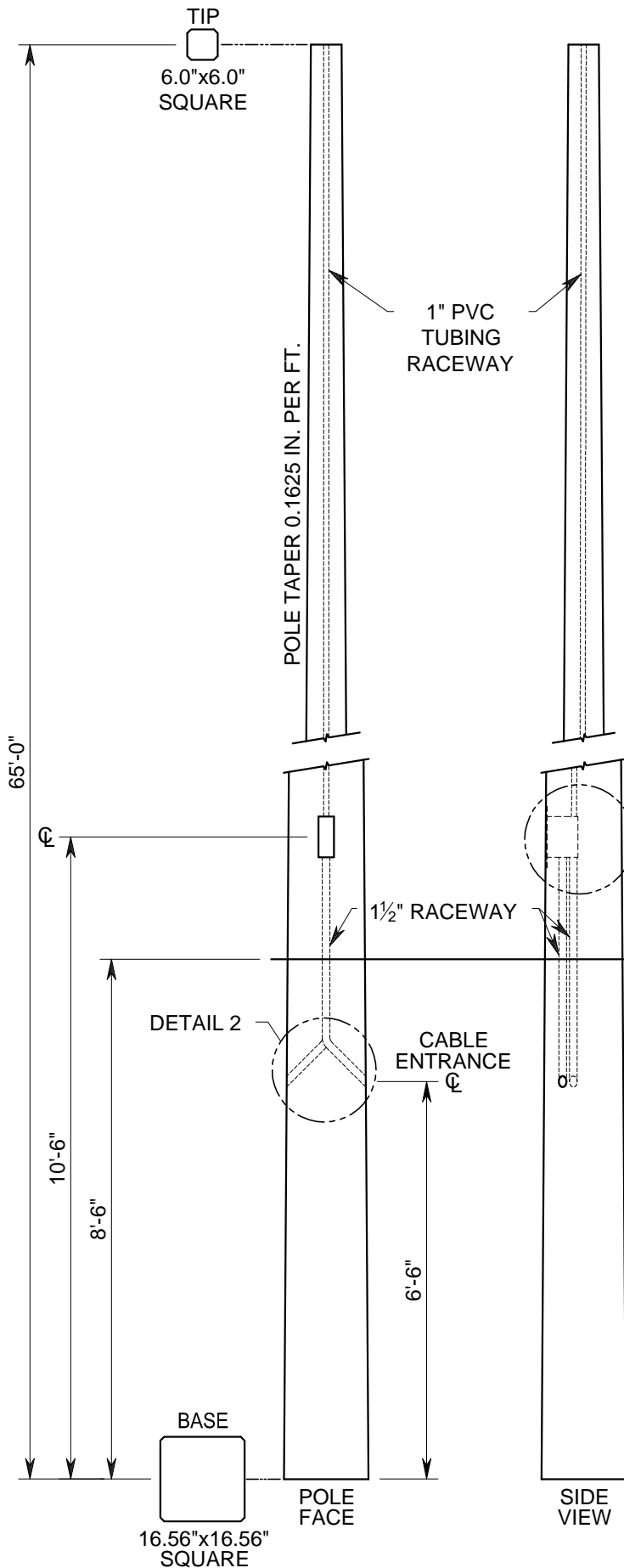

**TOP DETAIL  
TOP OF POLE**

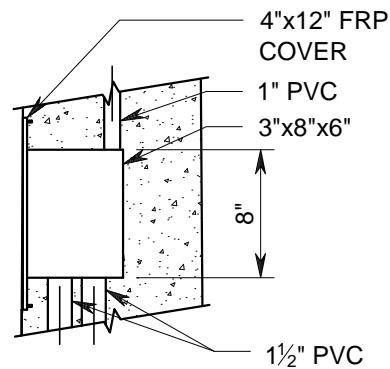

**DETAIL 1  
HAND HOLE WITH  
RECESSED COVER**

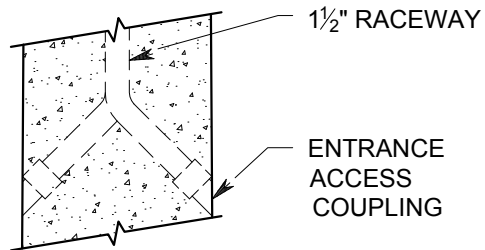

**DETAIL 2  
CABLE ENTRANCE**

ROT\* GROUND LINE

\* Rule of Thumb: 10% of length of pole plus 2 feet.  
Actual depth of embedment to be determined by customer.

DESCRIPTION: **65'-0" TYPE II  
(SQ.) TOP MOUNT POLE**

TRUCK LOAD QTY:	QTY:
WEIGHT: 9,055 LBS.	
FINISH: SMOOTH FORM GREY	

STOCK CODE:  
DISTRIBUTOR:



8892 Hwy 159 E  
Bellville, TX 77418  
www.lonestarprestress.com  
Tel: (713) 896-0994  
Fax: (713) 896-0762

DWG. NO: REV.  
CAT. NO: 702002 DATE: 7/21/14  
PROJECT:

APPROVED BY: DATE:

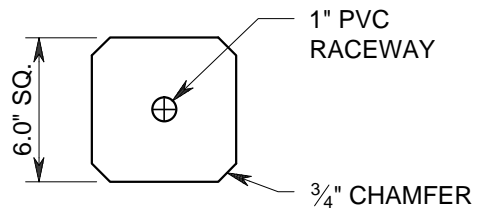
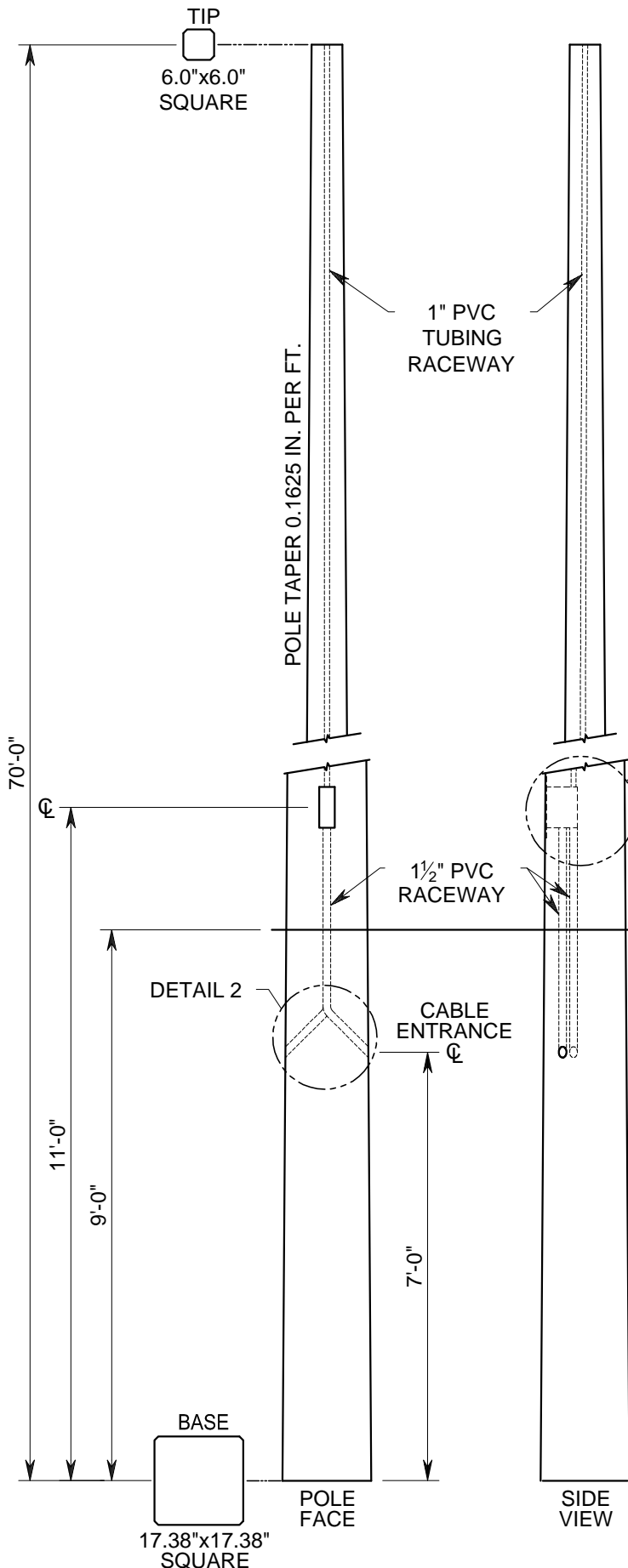

**TOP DETAIL  
TOP OF POLE**

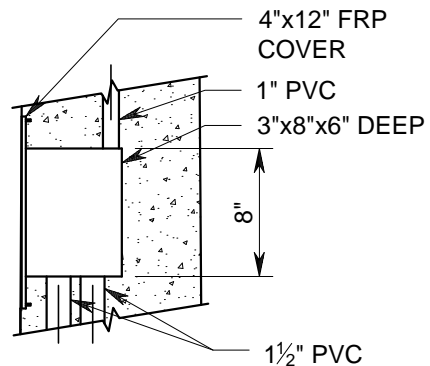

**DETAIL 1  
HAND HOLE WITH  
RECESSED COVER**

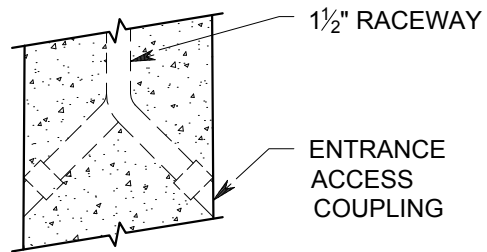

**DETAIL 2  
CABLE ENTRANCE**

\* Rule of Thumb: 10% of length of pole plus 2 feet.  
Actual depth of embedment to be determined by customer.

DESCRIPTION: **70'-0" TYPE II  
(SQ.) TOP MOUNT POLE**

TRUCK LOAD QTY:	QTY:
WEIGHT: 10,514 LBS.	
FINISH: SMOOTH FORM GREY	