

958912 PENTLAND BLDG O INTERIOR REFRESH

1 PENTLAND WAY
RIVERSIDE, CA 92507

CAAN #P5646



AGENCY APPROVAL



CLIENT



UNIVERSITY OF CALIFORNIA,
RIVERSIDE
900 UNIVERSITY AVE
RIVERSIDE, CA 92507

PROJECT NAME

PENTLAND BLDG O INTERIOR
REFRESH
1 PENTLAND WAY
RIVERSIDE, CA 92507

PROJECT NUMBER

958912

ARCHITECT

PBWS
Architects
100 West Villa Street, Suite 101
Pasadena, CA 91103
P: 626.432.5000
F: 626.432.5010
www.pbws.com

DESIGN CONSULTANT

REGISTRATION STAMP

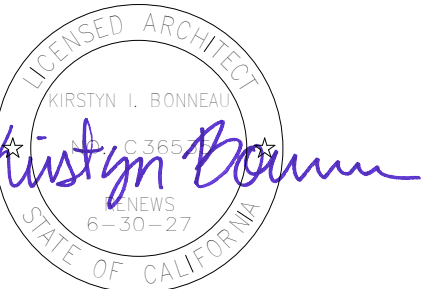

ISSUE

MARK	DATE	DESCRIPTION
△	04/03/2026	PLAN CHECK RESUBMITTAL
	02/27/2026	100% CD

DESIGNER PROJ. NO. 25016_00

DRAWN BY: KMc

CHECKED BY: KB

SCALE: As indicated

KEY PLAN

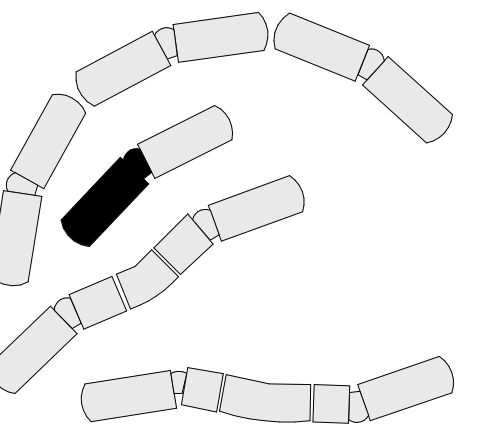

SHEET TITLE

PROJECT INFORMATION

SHEET NUMBER

G001

VICINITY MAP

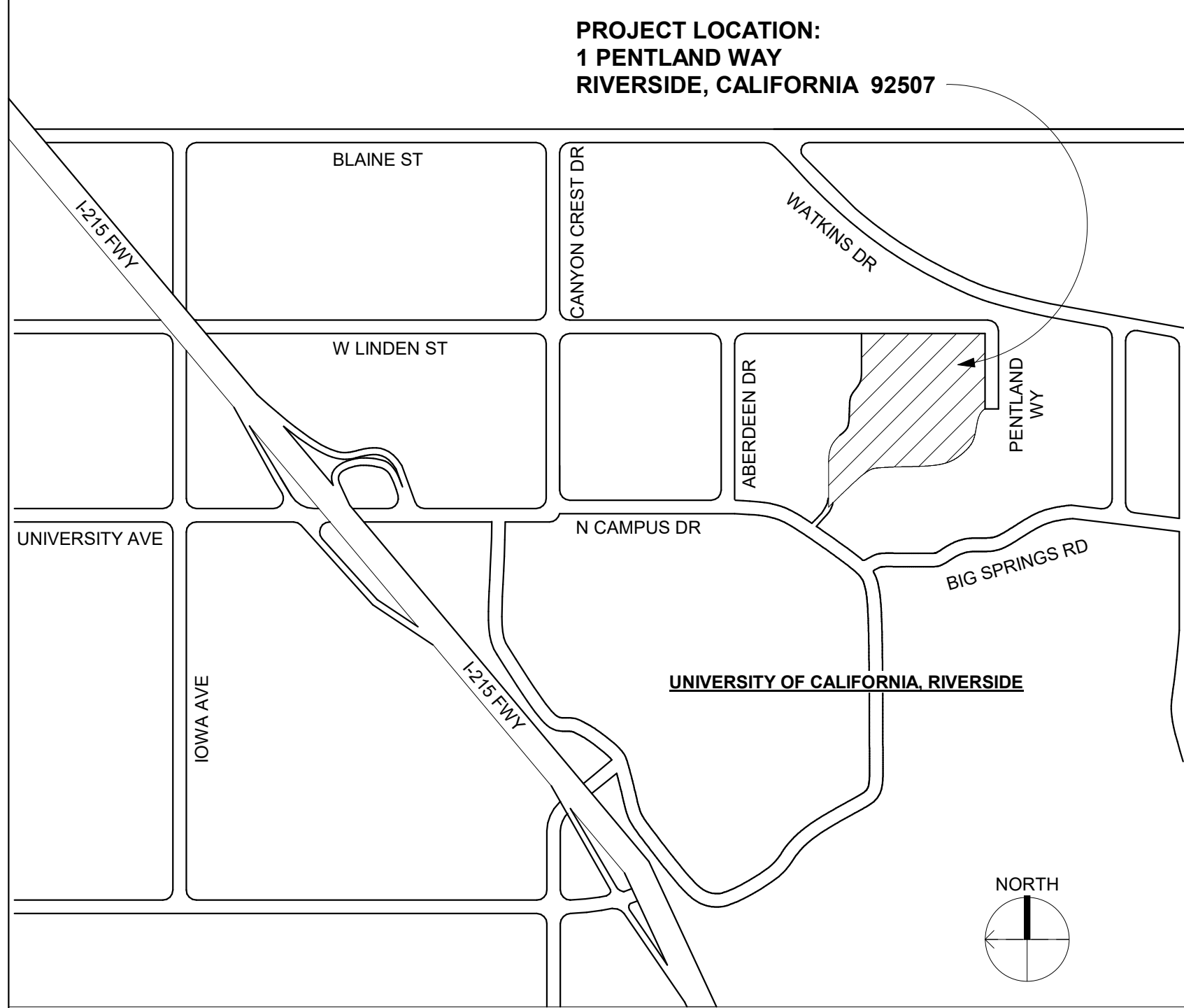

PROJECT DIRECTORY

OWNER: UNIVERSITY OF CALIFORNIA, RIVERSIDE
900 UNIVERSITY AVENUE
RIVERSIDE, CA 92507
CONTACT: SEAN HATFIELD
TELEPHONE: (951) 827-6736
E-MAIL: sean.hatfield@ucr.edu

ARCHITECT: PBWS ARCHITECTS
100 W VILLA ST, SUITE 101
PASADENA, CA 91103
CONTACT: KIRSTYN BONNEAU
TELEPHONE: (626) 432-5000
E-MAIL: kirstyn@pbws.com

STRUCTURAL ENGINEER: MIYAMOTO INTERNATIONAL
1901 EAST ALTON AVENUE, SUITE 160
SANTA ANA, CA 92705
CONTACT: JEFF CROSIER
TELEPHONE: (949) 579-1170
E-MAIL: jcrozier@miyamotointernational.com

SHEET INDEX

GENERAL
G001 PROJECT INFORMATION
G002 GENERAL INFORMATION
G101 SITE PLAN
3

ARCHITECTURAL - FIRST FLOOR PLANS
A201-10 BLDG O - FIRST FLOOR DEMOLITION PLAN
A201-1T TOWER - FIRST FLOOR DEMOLITION PLAN
A202-10 BLDG O - FIRST FLOOR CONSTRUCTION PLAN
A202-1T TOWER - FIRST FLOOR CONSTRUCTION PLAN
A203-10 BLDG O - FIRST FLOOR DEMOLITION REFLECTED CEILING PLAN
A203-1T TOWER - FIRST FLOOR DEMOLITION REFLECTED CEILING PLAN
A204-10 BLDG O - FIRST FLOOR CONSTRUCTION REFLECTED CEILING PLAN
A204-1T TOWER - FIRST FLOOR CONSTRUCTION REFLECTED CEILING PLAN
8

ARCHITECTURAL - SECOND FLOOR PLANS
A201-20 BLDG O - SECOND FLOOR DEMOLITION PLAN
A201-2T TOWER - SECOND FLOOR DEMOLITION PLAN
A202-20 BLDG O - SECOND FLOOR CONSTRUCTION PLAN
A202-2T TOWER - SECOND FLOOR CONSTRUCTION PLAN
A203-20 BLDG O - SECOND FLOOR DEMOLITION REFLECTED CEILING PLAN
A203-2T TOWER - SECOND FLOOR DEMOLITION REFLECTED CEILING PLAN
A204-20 BLDG O - SECOND FLOOR CONSTRUCTION REFLECTED CEILING PLAN
A204-2T TOWER - SECOND FLOOR CONSTRUCTION REFLECTED CEILING PLAN
8

ARCHITECTURAL - THIRD FLOOR PLANS
A201-30 BLDG O - THIRD FLOOR DEMOLITION PLAN
A201-3T TOWER - THIRD FLOOR DEMOLITION PLAN
A202-30 BLDG O - THIRD FLOOR CONSTRUCTION PLAN
A202-3T TOWER - THIRD FLOOR CONSTRUCTION PLAN
A203-30 BLDG O - THIRD FLOOR DEMOLITION REFLECTED CEILING PLAN
A203-3T TOWER - THIRD FLOOR DEMOLITION REFLECTED CEILING PLAN
A204-30 BLDG O - THIRD FLOOR CONSTRUCTION REFLECTED CEILING PLAN
A204-3T TOWER - THIRD FLOOR CONSTRUCTION REFLECTED CEILING PLAN
8

ARCHITECTURAL - ENLARGED PLANS, ELEVATIONS, AND DETAILS
A501-0 BLDG O - ENLARGED PLANS & ELEVATIONS
A761 INTERIOR DETAILS
A771 RESTROOM DETAILS
3

STRUCTURAL
S0.1 GENERAL NOTES
S1.1 DETAILS
S1.2 DETAILS
3

Total Number of Sheets: 33

SCOPE OF WORK

THE PROJECT PROVIDES UPDATED INTERIORS IN PENTLAND HILLS RESIDENT HALLS BUILDING O AND THE ELEVATOR TOWER BETWEEN BUILDING O AND BUILDING P.

BUILDING O CONTAINS 44 BEDROOM UNITS WHICH ARE ADJACENT TO 20 RESTROOMS AND 20 SEPARATE SHOWER AREAS. THE PROJECT ALSO INCLUDES MINOR STRUCTURAL REPAIRS TO SHEAR WALLS.

CODE SUMMARY

OCCUPANCY CLASSIFICATION: R-1, B
CONSTRUCTION TYPE: V
TOTAL SF: 15,670 SF
STORIES: 3
FIRE SPRINKLERED: YES
FIRE ALARMED: YES

SUMMARY OF GOVERNING REGULATIONS

CODE	TITLE	EDITION
ADMINISTRATIVE	CALIFORNIA BUILDING STANDARDS ADMINISTRATIVE CODE (PART 1, TITLE 24, CCR)	2025
BUILDING	CALIFORNIA BUILDING CODE (CBC) (PART 2, TITLE 24, CCR)	2025
ELECTRICAL	CALIFORNIA ELECTRICAL CODE (CEC) (PART 3, TITLE 24, CCR)	2025
MECHANICAL	CALIFORNIA MECHANICAL CODE (CMC) (PART 4, TITLE 24, CCR)	2025
PLUMBING	CALIFORNIA PLUMBING CODE (CPC) (PART 5, TITLE 24, CCR)	2025
ENERGY	CALIFORNIA ENERGY CODE (PART 6, TITLE 24, CCR)	2025
FIRE	CALIFORNIA FIRE CODE (CFC) (PART 9, TITLE 24, CCR)	2025
FIRE	NFPA 101 - LIFE SAFETY CODE	2021
FIRE	NFPA 13 - STANDARD FOR INSTALLATION OF FIRE SPRINKLER SYSTEMS	2025
FIRE	NFPA 24 - STANDARD FOR INSTALLATION OF PRIVATE FIRE SERVICE MAINS	2019
FIRE	NFPA 72 - NATIONAL FIRE ALARM AND SIGNALING CODE	2025



Table with 3 columns: MARK, DATE, DESCRIPTION



MATERIALS

Table listing materials with corresponding hatching patterns: EARTH, UNDISTURBED OR LOOSE FILL; EARTH, COMPACTED; GRAVEL OR POROUS FILL; SAND; CONCRETE; BRICK; CONCRETE BLOCK; PRECAST STONE; STEEL; ALUMINUM; WOOD, BLOCKING OR SHIM; WOOD FRAMING, CONTINUOUS; WOOD, FINISHED; PLYWOOD; INSULATION, LOOSE FILL; INSULATION, RIGID BOARD; GLASS; PLASTER WITH METAL LATH; GYPSUM BOARD OR SHEATHING; TILE; ACOUSTICAL CEILING TILE.

SYMBOLS

Table of symbols and their meanings: DETAIL REFERENCE (A101); BUILDING/WALL SECTION; BUILDING ELEVATION; INTERIOR ELEVATION; ROOM NAME / NUMBER (101); DOOR NUMBER (101); WALL NUMBER (11); KEYNOTE (07 3213 01); REVISION DELTA; DATUM ELEVATION (SECOND FLOOR 7'-0"); NORTH ARROW.

GENERAL NOTES

- 1. Access to the site shall be maintained for the fire department equipment and personnel during construction.
2. Drawings are not to be scaled, use referenced or noted dimensions only. Large scale details govern over smaller scale drawings and the project manual governs over the drawings.
3. Referencing of drawings is for convenience only and does not limit the application of any drawing or detail.
4. Contractor shall verify plans and existing dimensions and conditions on site and immediately notify the University in writing of any discrepancies before proceeding with the work.
5. Contractor shall protect all surfaces and improvements on site from being damaged during construction.
6. Protect in place all smoke and heat detectors, strobe lights, fire alarm boxes, thermostats, light fixtures, wall switches, outlets, and any other components that are not affected by this work.
7. All materials and equipment included in the demolition for this project shall be removed and disposed of in compliance with all local, state, and federal regulatory requirements.
8. Contractor shall verify in field the extent of work which may or may not be indicated on the drawings and notify the architect of any discrepancies immediately.
9. All items are to be provided as new unless noted as existing (E).
10. Contractor shall provide minimum eight (8) feet high temporary chain link fence barricades wherever necessary to maintain a safe environment and as directed by the owner and any other safety measures as required. Refer to plans and CAL/OSHA.
11. All work listed, shown, or implied on any construction documents shall be supplied and installed by the contractor, except where noted otherwise. The contractor shall closely coordinate the work with that of other sub-contractors or equipment vendors to assure that all schedules are met and that all work is done in conformance to manufacturers' requirements.
12. The Contractor shall patch, seal, and paint to match existing any demolition to existing walls and ceilings required to facilitate construction.
13. The Contractor shall provide and be responsible for protection and repair of adjacent existing surfaces, duct, areas, piping, conduit, and equipment which may be damaged as a result of demolition and/or new work. The Contractor shall not demolish or alter any work which is not a part of this contract without written permission from the University.
14. All tests and inspections shall conform to the latest edition of Title 24 of the California Code of Regulations and 2025 California Building Code.
15. The Contractor shall thoroughly clean and secure the area of construction after each day of work.
16. In cases where slope percentages and dimensions are identified on these plans for elements regulated by the Americans With Disabilities Act (ADA) and Chapter 11B of the California Building Code, the slope percentages and dimensions shown may be more stringent than required by Code. Dimensions and slope gradients allowed in Chapter 11B of the CBC shall be acceptable and deemed to be in compliance with these documents, provided that the dimensions or slope gradient variation does not introduce noncompliance to adjoining work.
17. The intent of these Drawings and Specifications is that the work of the alteration, rehabilitation, or reconstruction is to be in accordance with Title 24, CCR. Should any existing conditions such as the deterioration or non-complying construction be discovered which is not covered by the contract documents wherein the finished work will not comply with Title 24, CCR, a Construction Change Document (CCD), or a separate set of plans and specifications prepared by the Architect, detailing and specifying the required work shall be submitted to and approved by DSA before proceeding with the work. (Section 4-317(C), Part 1, Title 24, CCR.)
18. Storage within existing buildings of paints, sealants, or other hazardous materials shall not exceed quantities as identified in Tables 307.1(1) and 307.1(2) of 2025 IBC and 2025 California Amendments.
19. All dimensions shown are clear dimensions to face of finishes, unless noted otherwise.
20. Slope new surfaces as required to be flush with adjoining existing surfaces.
21. Contractor shall supply and maintain a remote equipment cleaning station. Contractor shall not use Owner plumbing fixtures - including showers, lavatories, and mop sinks - to clean equipment.
22. Refer to Sheet S0.1 for additional general notes, abbreviations, and requirements.

ABBREVIATIONS

Table of abbreviations: A ASPHALT CONCRETE; AC ABOVE FINISHED FLOOR; AL ALUMINUM; ANOD ANODIZED; B BLDG BUILDING; CFCI CONTRACTOR FURNISHED, CONTRACTOR INSTALLED; CIP CAST-IN-PLACE; CL CENTERLINE; CLG CEILING; CLR CLEAR (FINISH-TO-FINISH); CMU CONCRETE MASONRY UNIT; CONC CONCRETE; CONT CONTINUOUS; CTR CENTER; D DIA DIAMETER; DEG DEGREE(S); DET DETAIL; DF DRINKING FOUNTAIN; DIM DIMENSION; DWG DRAWING; E (E) EXISTING; EA EACH; EJ EXPANSION JOINT; ELEC ELECTRICAL; EQ EQUAL; EXT EXTERIOR; F FACP FIRE ALARM CONTROL PANEL; FD FLOOR DRAIN; FDC FIRE DEPARTMENT CONNECTION; FE FIRE EXTINGUISHER; FEC FIRE EXTINGUISHER CABINET; FOC FACE OF CONCRETE, FACE OF CURB; FOF FACE OF FINISH; FOM FACE OF MASONRY; FOS FACE OF STUD; FRP FIBERGLASS REINFORCING PLASTIC; G GA GAGE (GALUGE); GALV GALVANIZED; GL GLASS; GLZ GLAZING; GYP BO GYPSUM BOARD; H H HIGH; HSS HOLLOW STEEL SECTION; HT HEIGHT; I INSUL INSULATION; INT INTERIOR; L L STRUCTURAL STEEL ANGLE; M MATL MATERIAL; MAX MAXIMUM; MECH MECHANICAL; MFR MANUFACTURER; MIN MINIMUM; MO MASONRY OPENING; MTL METAL; N N/A NOT APPLICABLE; NIC NOT IN CONTRACT; NTS NOT TO SCALE; O OC ON CENTER; OD OUTSIDE DIAMETER; OFCI OWNER FURNISHED, CONTRACTOR INSTALLED; OFOI OWNER FURNISHED, OWNER INSTALLED; OFD OVERFLOW DRAIN; OPP OPPOSITE; P PLAM PLASTIC LAMINATE; PL PLATE; FT PRESSURE TREATED; R R RADIUS; RD ROOF DRAIN; REQD REQUIRED; RM ROOM; RO ROUGH OPENING; S SF SQUARE FEET (FOOT); SIM SIMILAR; SS STAINLESS STEEL; STL STEEL; STRUCT STRUCTURAL; SUSP SUSPENDED; T TOC TOP OF CONCRETE/ CURB; TOS TOP OF SLAB, TOP OF STEEL; TYP TYPICAL; U U.N.O. UNLESS NOTED OTHERWISE; V VIF VERIFY IN FIELD; W W/ WITH; WO WHERE OCCURS; WR WATER RESISTANT; X XFMR TRANSFORMER; SYMBOL ANGLE; ° DIAMETER; ' FEET (FOOT); " INCHES); # NUMBER, POUND(S); +/- PLUS OR MINUS.



AGENCY APPROVAL

APPROVED
 UC RIVERSIDE
 04/20/2026
 Office of the Campus Architect
 Signed CBO: *Charles Blumer*
 Building & Safety Department
 CAMPUS BUILDING PERMIT

CLIENT

UC RIVERSIDE
 UNIVERSITY OF CALIFORNIA,
 RIVERSIDE
 900 UNIVERSITY AVE
 RIVERSIDE, CA 92507

PROJECT NAME

PENTLAND BLDG O INTERIOR
 REFRESH
 1 PENTLAND WAY
 RIVERSIDE, CA 92507

PROJECT NUMBER

129921

ARCHITECT

PBWS Architects
 100 West Villa Street, Suite 101
 Pasadena, CA 91103
 P: 626.432.5000
 F: 626.432.5010
 www.pbws.com

DESIGN CONSULTANT

REGISTRATION STAMP

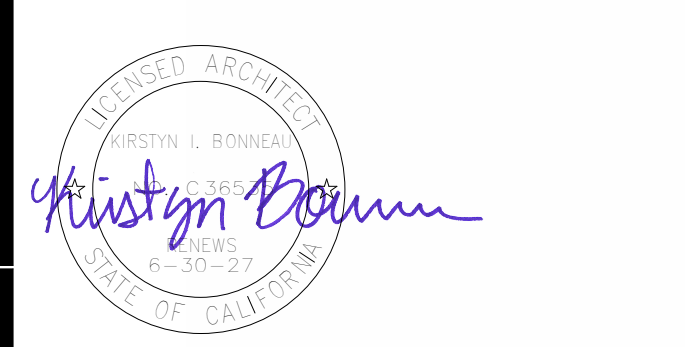

ISSUE

MARK	DATE	DESCRIPTION

04/03/2026 PLAN CHECK RESUBMITTAL
 02/27/2026 100% CD

DESIGNER PROJ. NO. 25016_00

DRAWN BY: KMc

CHECKED BY: KB

SCALE: 1" = 50'-0"

KEY PLAN

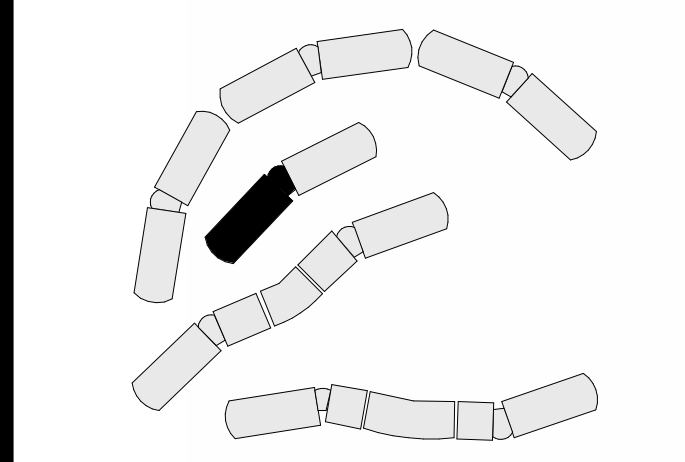

SHEET TITLE

SITE PLAN

SHEET NUMBER

G101

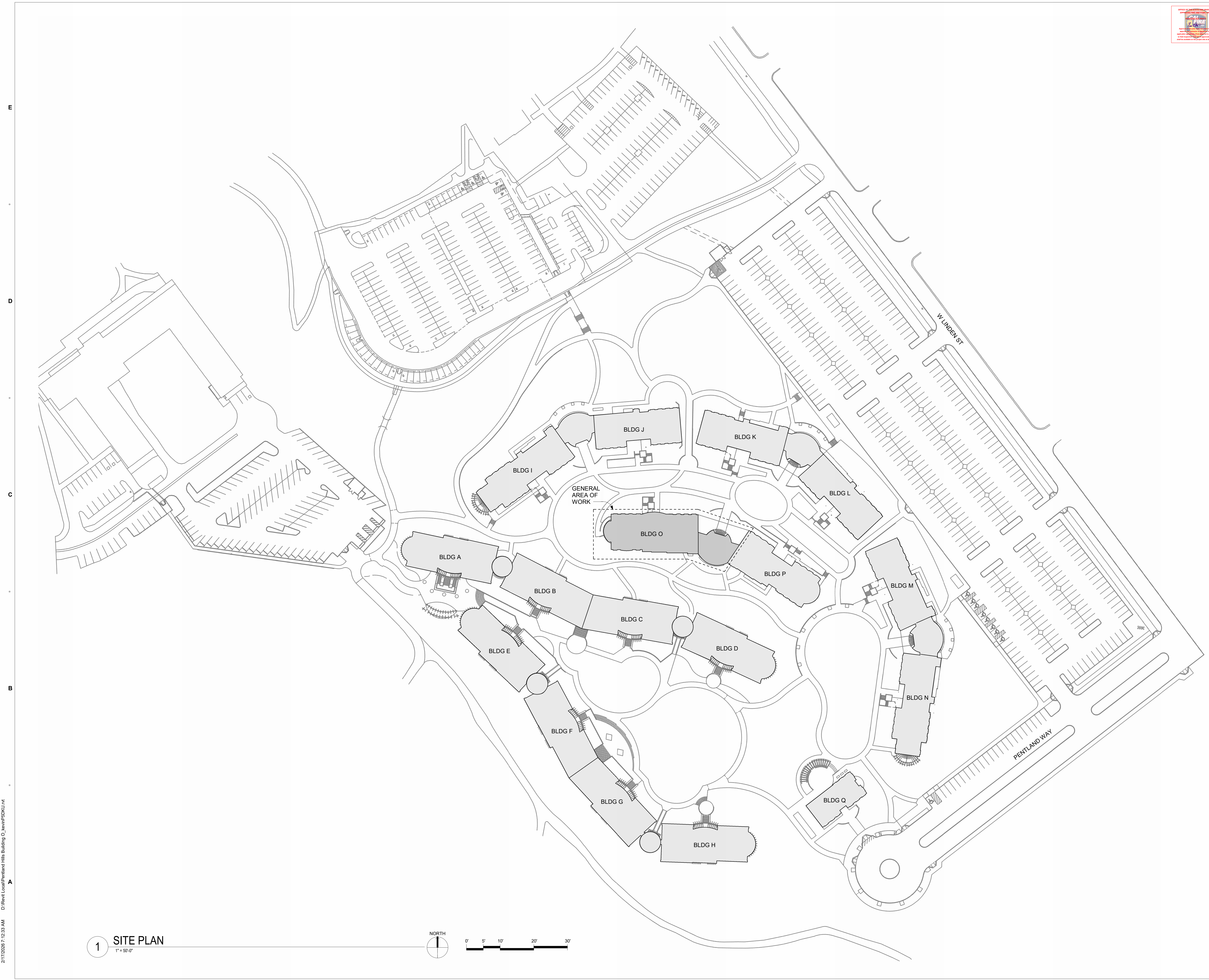

1 SITE PLAN
 1" = 50'-0"

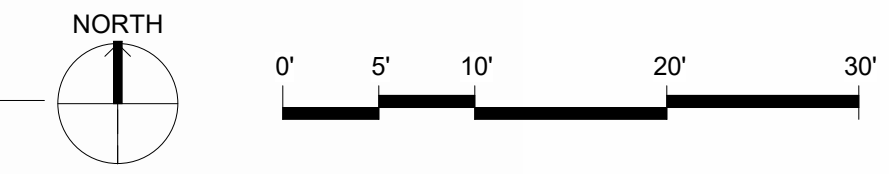

2/17/2026 7:12:33 AM D:\Revit\Local\Pentland HHS Building_O_levin\FBD\K1.rvt

DEMOLITION KEYNOTES

DEMOLISH THE FOLLOWING UNLESS NOTED OTHERWISE:

- 02 4100.01 CLOSET DOOR AND TRACK PER DETAIL 1/A761
- 02 4100.02 CAREFULLY REMOVE WALL-MOUNTED TOILET AND SALVAGE FOR RE-INSTALLATION
- 02 4100.03 LAVATORY AND COUNTER PER DETAIL 5/A771
- 02 4100.04 SHOWER FIXTURE AND HARDWARE INCLUDING HEAD, VALVE, HANDLE, AND FACEPLATE
- 02 4100.05 BENCH
- 02 4100.06 VERTICAL BLINDS
- 02 4100.07 SHOWER DOOR
- 02 4100.08 GRAB BAR

LEGEND

- DEMOLISH EXISTING CARPET AND RUBBER BASE
- DEMOLISH EXISTING CERAMIC FLOOR TILE
- DEMOLISH EXISTING VINYL FLOOR TILE AND RUBBER BASE
- AREA NOT IN SCOPE
- DEMOLISH EXISTING CERAMIC WALL TILE, TILE BASE, SHEATHING, AND/OR GYPSUM BOARD DOWN TO EXISTING STUDS

DEMOLITION GENERAL NOTES

1. PROTECT P-TRAPS AND CONDENSATE ATTACHMENT IN PLACE DURING THE COURSE OF DEMOLITION.
2. PLUG ALL DRAINS PRIOR TO DEMOLITION TO PREVENT DEBRIS AND DUST INFILTRATION.
3. NOTIFY ARCHITECT AND UNIVERSITY REPRESENTATIVE OF ANY EXISTING SHOWER CLEANOUTS UNCOVERED IN THE COURSE OF DEMOLITION.
4. DEMOLISH DAMAGED SHEAR PANELS AT TOILET AND SHOWER ROOMS. DO NOT DEMOLISH UNDAUNTED SHEAR PANELS. COORDINATE WITH THE ARCHITECT AND STRUCTURAL ENGINEER IF THE EXTENT OF DAMAGE IS UNCLEAR.
5. WHEN GRINDING CONCRETE:
 - A. USE A CONTAINMENT SYSTEM CAPABLE OF MITIGATING THE SPREAD OF DUST TO THE SATISFACTION OF THE UNIVERSITY REPRESENTATIVE.
 - B. COVER SMOKE ALARMS.



AGENCY APPROVAL

APPROVED

 04/20/2026
Office of the Campus Architect
 Signed CBO: *Charles Blument*
 Building & Safety Department
 CAMPUS BUILDING PERMIT

CLIENT



UNIVERSITY OF CALIFORNIA,
 RIVERSIDE
 900 UNIVERSITY AVE
 RIVERSIDE, CA 92507

PROJECT NAME

PENTLAND BLDG O INTERIOR
 REFRESH
 1 PENTLAND WAY
 RIVERSIDE, CA 92507

PROJECT NUMBER

958912

ARCHITECT

PBWSI
 Architects
 100 West Villa Street, Suite 101
 Pasadena, CA 91103
 P: 626.432.5000
 F: 626.432.5010
 www.pbwsi.com

DESIGN CONSULTANT

REGISTRATION STAMP



ISSUE

MARK	DATE	DESCRIPTION
▲	04/03/2026	PLAN CHECK RESUBMITTAL
	02/27/2026	100% CD
DESIGNER PROJ. NO. 25016_00		
DRAWN BY: KMc		
CHECKED BY: KB		
SCALE: As indicated		

KEY PLAN

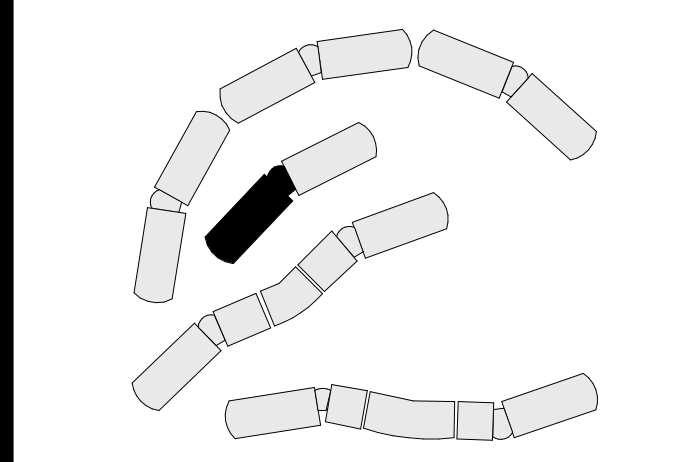

SHEET TITLE

BLDG O - FIRST FLOOR
 DEMOLITION PLAN

SHEET NUMBER

A201-10

E

D

C

B

A

3/19/2026 11:35:50 PM D:\Revit\Local\Pentland HHS Building_O_Revit\FDKU1.rvt

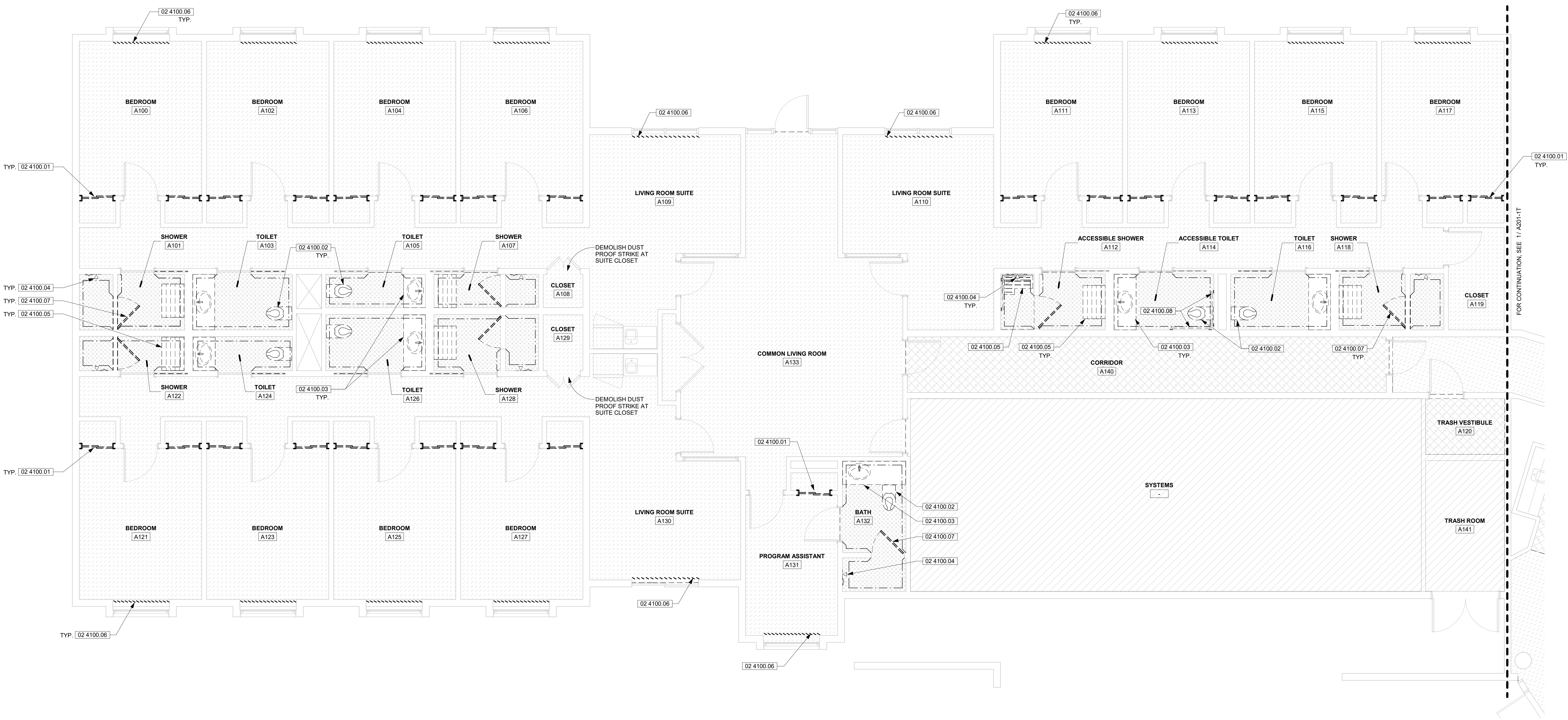

1 BUILDING O - FIRST FLOOR DEMOLITION PLAN
 1/4" = 1'-0"

DEMOLITION KEYNOTES

DEMOLISH THE FOLLOWING UNLESS NOTED OTHERWISE:

- 02 4100.01 CLOSET DOOR AND TRACK PER DETAIL 1/A761
- 02 4100.02 CAREFULLY REMOVE WALL-MOUNTED TOILET AND SALVAGE FOR RE-INSTALLATION
- 02 4100.03 LAVATORY AND COUNTER PER DETAIL 5/A771
- 02 4100.04 SHOWER FIXTURE AND HARDWARE INCLUDING HEAD, VALVE, HANDLE, AND FACEPLATE
- 02 4100.06 VERTICAL BLINDS
- 02 4100.07 SHOWER DOOR

LEGEND

- DEMOLISH EXISTING CARPET AND RUBBER BASE
- DEMOLISH EXISTING CERAMIC FLOOR TILE
- DEMOLISH EXISTING VINYL FLOOR TILE AND RUBBER BASE
- AREA NOT IN SCOPE
- DEMOLISH EXISTING CERAMIC WALL TILE, TILE BASE, SHEATHING, AND/OR GYPSUM BOARD DOWN TO EXISTING STUDS

DEMOLITION GENERAL NOTES

1. PROTECT P-TRAPS AND CONDENSATE ATTACHMENT IN PLACE DURING THE COURSE OF DEMOLITION.
2. PLUG ALL DRAINS PRIOR TO DEMOLITION TO PREVENT DEBRIS AND DUST INFILTRATION.
3. NOTIFY ARCHITECT AND UNIVERSITY REPRESENTATIVE OF ANY EXISTING SHOWER CLEANOUTS UNCOVERED IN THE COURSE OF DEMOLITION.
4. DEMOLISH DAMAGED SHEAR PANELS AT TOILET AND SHOWER ROOMS. DO NOT DEMOLISH UNDAMAGED SHEAR PANELS. COORDINATE WITH THE ARCHITECT AND STRUCTURAL ENGINEER IF THE EXTENT OF DAMAGE IS UNCLEAR.
5. WHEN GRINDING CONCRETE:
 - A. USE A CONTAINMENT SYSTEM CAPABLE OF MITIGATING THE SPREAD OF DUST TO THE SATISFACTION OF THE UNIVERSITY REPRESENTATIVE.
 - B. COVER SMOKE ALARMS.



1 ELEVATOR TOWER - FIRST FLOOR DEMOLITION PLAN
1/4" = 1'-0"

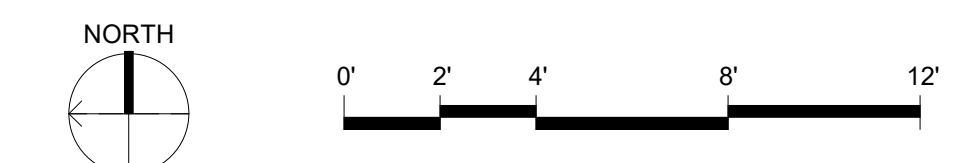

AGENCY APPROVAL



CLIENT

UC RIVERSIDE

UNIVERSITY OF CALIFORNIA,
RIVERSIDE
900 UNIVERSITY AVE
RIVERSIDE, CA 92507

PROJECT NAME

PENTLAND BLDG O INTERIOR
REFRESH
1 PENTLAND WAY
RIVERSIDE, CA 92507

PROJECT NUMBER

958912

ARCHITECT

PBWSI
Architects

100 West Villa Street, Suite 101
Pasadena, CA 91103

P: 626.432.5000
F: 626.432.5010
www.pbwsi.com

DESIGN CONSULTANT

REGISTRATION STAMP

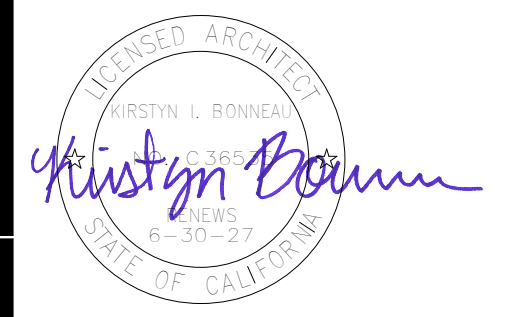

ISSUE

MARK	DATE	DESCRIPTION
△	04/03/2026	PLAN CHECK RESUBMITTAL
	02/27/2026	100% CD

DESIGNER PROJ. NO. 25016_00
DRAWN BY: KMc
CHECKED BY: KB
SCALE: As indicated

KEY PLAN

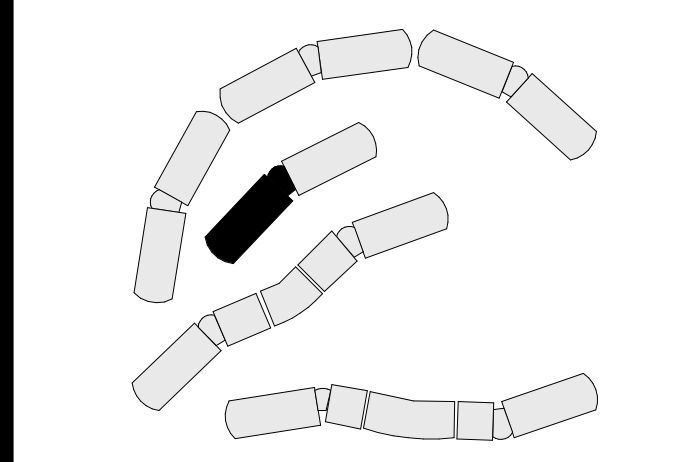

SHEET TITLE

TOWER - FIRST FLOOR
DEMOLITION PLAN

SHEET NUMBER

A201-1T

3/19/2026 11:35:50 PM D:\Revit Local\Pentland HHS Building_O_levin\FBDK1.txd

CONSTRUCTION KEYNOTES

- 08 0000.01 CASED OPENING PER DETAIL 2/A761
- 09 9000.03 PAINT (E) DOOR TRIM PT-2 PER FINISH SCHEDULE
- 09 9000.04 PAINT (E) WINDOW TRIM PT-2 PER FINISH SCHEDULE
- 12 2113.01 VERTICAL BLINDS AT SLIDING DOOR (TYPE V-1)
- 12 2113.02 VERTICAL BLINDS AT WINDOW (TYPE V-2)

LEGEND

- CFT-1: CERAMIC FLOOR TILE
- CPT-1: CARPET TILE AND RUBBER BASE (RBB-1)
- CPT-2: CARPET TILE AND RUBBER BASE (RBB-1)
- CPT-3: WALKOFF CARPET AND RUBBER BASE (RBB-1)
- CPT-4: WALKOFF CARPET AND RUBBER BASE (RBB-1)
- LVT-1: LUXURY VINYL TILE AND RUBBER BASE (RBB-2)
- VCT-1: VINYL COMPOSITION TILE AND RUBBER BASE (RBB-2)
- RSF-1: RESILIENT FLOORING AND RUBBER BASE (RBB-2)
- NIC: FLOOR / WALL FINISHES NOT IN SCOPE
- CERAMIC WALL TILE - 4'-0" HIGH WAINSCOT
- CERAMIC WALL TILE - FULL HEIGHT

CONSTRUCTION GENERAL NOTES

- WHERE EXISTING SHOWER CLEANOUTS ARE UNCOVERED, CONSTRUCT ACCESS PANEL PER DETAIL 3/ A761
- REPLACE DAMAGED SHEAR WALL PANELS AT TOILET AND SHOWER ROOMS PER STRUCTURAL DRAWINGS. EXISTING UNDAMAGED SHEAR PANELS TO REMAIN IN PLACE. COORDINATE WITH ARCHITECT AND STRUCTURAL ENGINEER IF EXTENT OF DAMAGE IS UNCLEAR. SEE NOTE 4 BELOW FOR FIRE SEALANT REQUIREMENTS AT WALLS.
- UNLESS NOTED OTHERWISE, PAINT TRIM FOR EACH DOOR AND WINDOW WITHIN AREA OF WORK PT-2 PER FINISH SCHEDULE. (E) FACTORY FINISH AT STOREFRONT DOORS ARE TO REMAIN UNPAINTED.
- EXISTING PARTITION WALLS AND FLOOR/CEILING ASSEMBLIES ARE FIRE RATED. PENETRATE EXISTING FLOOR/CEILING ASSEMBLIES PER DETAIL 17/ A761 (WALL PENETRATIONS, SIM) APPLY FIRE SEALANT AT WALLS PER DETAIL 19/ A761

ROOM NUMBER	ROOM NAME	FLOOR	BASE	WALL				CEILING
				NORTH	EAST	SOUTH	WEST	
A100	BEDROOM	CPT-1	RBB-1	PNT-1	PNT-1	PNT-1	PNT-1	PNT-1
A101	SHOWER	CFT-1	CWT-1	CWT-1 / PNT-1	CWT-1 / PNT-1	CWT-1 / PNT-1	CWT-1 / PNT-1	PNT-1
A102	BEDROOM	CPT-1	RBB-1	PNT-1	PNT-1	PNT-1	PNT-1	PNT-1
A103	TOILET	CFT-1	CWT-1	CWT-1 / PNT-1	CWT-1 / PNT-1	CWT-1 / PNT-1	CWT-1 / PNT-1	PNT-1
A104	BEDROOM	CPT-1	RBB-1	PNT-1	PNT-1	PNT-1	PNT-1	PNT-1
A105	TOILET	CFT-1	CWT-1	CWT-1 / PNT-1	CWT-1 / PNT-1	CWT-1 / PNT-1	CWT-1 / PNT-1	PNT-1
A106	BEDROOM	CPT-1	RBB-1	PNT-1	PNT-1	PNT-1	PNT-1	PNT-1
A107	SHOWER	CFT-1	CWT-1	CWT-1 / PNT-1	CWT-1 / PNT-1	CWT-1 / PNT-1	CWT-1 / PNT-1	PNT-1
A108	CLOSET	RSF-1	RBB-1	PNT-1	PNT-1	PNT-1	PNT-1	PNT-1
A109	LIVING ROOM SUITE	RSF-1	RBB-2	PNT-1	PNT-1	PNT-1	PNT-1	PNT-1
A110	LIVING ROOM SUITE	RSF-1	RBB-2	PNT-1	PNT-1	PNT-1	PNT-1	(E)
A111	BEDROOM	CPT-1	RBB-1	PNT-1	PNT-1	PNT-1	PNT-1	PNT-1
A112	ACCESSIBLE SHOWER	CFT-1	CWT-1	CWT-1 / PNT-1	CWT-1 / PNT-1	CWT-1 / PNT-1	CWT-1 / PNT-1	PNT-1
A113	BEDROOM	CPT-1	RBB-1	PNT-1	PNT-1	PNT-1	PNT-1	PNT-1
A114	ACCESSIBLE TOILET	CFT-1	CWT-1	CWT-1 / PNT-1	CWT-1 / PNT-1	CWT-1 / PNT-1	CWT-1 / PNT-1	PNT-1
A115	BEDROOM	CPT-1	RBB-1	PNT-1	PNT-1	PNT-1	PNT-1	PNT-1
A116	TOILET	CFT-1	CWT-1	CWT-1 / PNT-1	CWT-1 / PNT-1	CWT-1 / PNT-1	CWT-1 / PNT-1	PNT-1
A117	BEDROOM	CPT-1	RBB-1	PNT-1	PNT-1	PNT-1	PNT-1	PNT-1
A118	SHOWER	CFT-1	CWT-1	CWT-1 / PNT-1	CWT-1 / PNT-1	CWT-1 / PNT-1	CWT-1 / PNT-1	PNT-1
A119	CLOSET	RSF-1	RBB-2	PNT-1	PNT-1	PNT-1	PNT-1	PNT-1
A120	TRASH VESTIBULE	VCT-1	RBB-2	PNT-1	PNT-1	PNT-1	PNT-1	PNT-1
A121	BEDROOM	CPT-1	RBB-1	PNT-1	PNT-1	PNT-1	PNT-1	PNT-1
A122	SHOWER	CFT-1	CWT-1	CWT-1 / PNT-1	CWT-1 / PNT-1	CWT-1 / PNT-1	CWT-1 / PNT-1	PNT-1
A123	BEDROOM	CPT-1	RBB-1	PNT-1	PNT-1	PNT-1	PNT-1	PNT-1
A124	TOILET	CFT-1	CWT-1	CWT-1 / PNT-1	CWT-1 / PNT-1	CWT-1 / PNT-1	CWT-1 / PNT-1	PNT-1
A125	BEDROOM	CPT-1	RBB-1	PNT-1	PNT-1	PNT-1	PNT-1	PNT-1
A126	TOILET	CFT-1	CWT-1	CWT-1 / PNT-1	CWT-1 / PNT-1	CWT-1 / PNT-1	CWT-1 / PNT-1	PNT-1
A127	BEDROOM	CPT-1	RBB-1	PNT-1	PNT-1	PNT-1	PNT-1	PNT-1
A128	SHOWER	CFT-1	CWT-1	CWT-1 / PNT-1	CWT-1 / PNT-1	CWT-1 / PNT-1	CWT-1 / PNT-1	PNT-1
A129	CLOSET	RSF-1	RBB-1	PNT-1	PNT-1	PNT-1	PNT-1	PNT-1
A130	LIVING ROOM SUITE	RSF-1	RBB-2	PNT-1	PNT-1	PNT-1	PNT-1	(E)
A131	PROGRAM ASSISTANT	CPT-1	RBB-1	PNT-1	PNT-1	PNT-1	PNT-1	PNT-1
A132	BATH	CFT-1	CWT-1	CWT-1 / PNT-1	CWT-1 / PNT-1	CWT-1 / PNT-1	CWT-1 / PNT-1	PNT-1
A133	COMMON LIVING ROOM	CPT-3	RBB-1	PNT-1	PNT-1	PNT-1	PNT-1	PNT-1
A140	CORRIDOR	VCT-1	RBB-2	PNT-1	PNT-1	PNT-1	PNT-1	PNT-1
T106	KITCHEN	LVT-1	RBB-2	PNT-1	PNT-1	PNT-1	PNT-1	PNT-1
T108	COMMON AREA	CPT-2	RBB-1	PNT-1	PNT-1	PNT-1 / (E) FF	PNT-1	PNT-1

FINISH SCHEDULE NOTES

- ABBREVIATIONS:**
- FLOOR:**
- CFT-1: CERAMIC FLOOR TILE**
MANUFACTURER: MAXIMO
COLOR: REGENCY GREY
SIZE: 11" x 12" HEXAGON MOSAIC
RESPONSIBILITY: CFCI
 - CPT-1: CARPET**
MANUFACTURER: SHAW
STYLE: MANIFEST
COLOR: LEATHER (62500)
SIZE: 9' x 36" TILE
RESPONSIBILITY: OFCI
 - CPT-2: CARPET**
MANUFACTURER: SHAW
STYLE: HAND STITCH TILE
COLOR: MENDED DENIM (16504)
SIZE: 24" x 24" TILE
RESPONSIBILITY: OFCI
 - CPT-3: CARPET**
MANUFACTURER: SHAW
STYLE: JIVE (57412)
COLOR: STRIDE (12505)
SIZE: 24" x 24" TILE
RESPONSIBILITY: OFCI
 - CPT-4: CARPET**
MANUFACTURER: SHAW
STYLE: WELCOME II
COLOR: EBONY
RESPONSIBILITY: OFCI
 - LVT-1: LUXURY VINYL TILE**
MANUFACTURER: SHAW
STYLE: AMALGAM
COLOR: FAULT (13530)
SIZE: 12" x 12" TILE
RESPONSIBILITY: OFCI
 - VCT-1: VINYL COMPOSITION TILE**
MANUFACTURER: ARMSTRONG
STYLE: JUBILEE WHITE
COLOR: JUBILEE WHITE
SIZE: 12" x 12" TILE
RESPONSIBILITY: CFCI
 - RSF-1: RESILIENT FLOORING**
MANUFACTURER: SHAW
PRODUCT: BASSTONES
COLOR: COORDINATES (00410)
WELD ROD: WEL2009
RESPONSIBILITY: OFCI
 - CON-1: FINISHED CONCRETE**
FINISH: BROOM FINISH
RESPONSIBILITY: CFCI
- BASE:**
- RBB-1: RUBBER BASE**
MANUFACTURER: TARKETT
COLOR: GREY
SIZE: 4" STRAIGHT BASE IN 4'-0" STICKS
RESPONSIBILITY: CFCI
 - RBB-2: RUBBER BASE**
MANUFACTURER: ARMSTRONG
COLOR: METAL GRAY
SIZE: 4" COVE BASE IN 4'-0" STICKS
RESPONSIBILITY: OFCI
- WALL / CEILING:**
- CWT-1: CERAMIC WALL TILE**
MANUFACTURER: LA ROCCA
COLOR: MODELO GRAY II
SIZE: 12" x 24"
RESPONSIBILITY: CFCI
 - PNT-1: PAINT AT GYPSUM BOARD**
MANUFACTURER: DUNN EDWARDS
PRODUCT: ENDURACOE ENCT50-0-L-5
COLOR: MILK GLASS
SHEEN: EGGSHELL
RESPONSIBILITY: CFCI
- TRIM:**
- PNT-2: PAINT AT METAL TRIM**
MANUFACTURER: DUNN EDWARDS
PRIMER: ENDURAPRIME
PRODUCT: ENDURACOE ENCT30-0-L-5
COLOR: PLATINUM GRAY
SHEEN: SEMIGLOSS
RESPONSIBILITY: CFCI
- MISCELLANEOUS:**
- PNT-3: PAINT AT STEEL COLUMNS, RAILS, AND STRINGERS**
MANUFACTURER: DUNN EDWARDS
PRODUCT: ENDURACOE ENCT30-0M-1
COLOR: MYSTERIOUS BLUE
SHEEN: SEMIGLOSS
RESPONSIBILITY: CFCI
- (E) FF: EXISTING FACTORY FINISH AT STOREFRONT MULLIONS**
- NOTES:**
- UNLESS NOTED OTHERWISE, FINISH ENTIRE SURFACE INDICATED IN SCHEDULE, INCLUDING WHERE EXPOSED UNDER CASEWORK AND FIXTURES.
 - INSTALL RUBBER TRANSITIONS BETWEEN DIFFERENT FLOORING TYPES TO ENSURE A SMOOTH AND SAFE TRANSITION BETWEEN MATERIALS. REFER TO DETAIL 5/ A761 FOR ADDITIONAL INFORMATION.
 - CONFIRM SELF-LEVELING UNDERLAYMENT IS COMPLETELY LEVEL BEFORE FINISH FLOOR INSTALLATION.
 - UNLESS NOTED OTHERWISE, APPLY WATER-BASED URETHANE COATING OVER VCT-1.
A. PRODUCT: EPIC
B. MANUFACTURER: ULTRA DURABLE TECHNOLOGIES

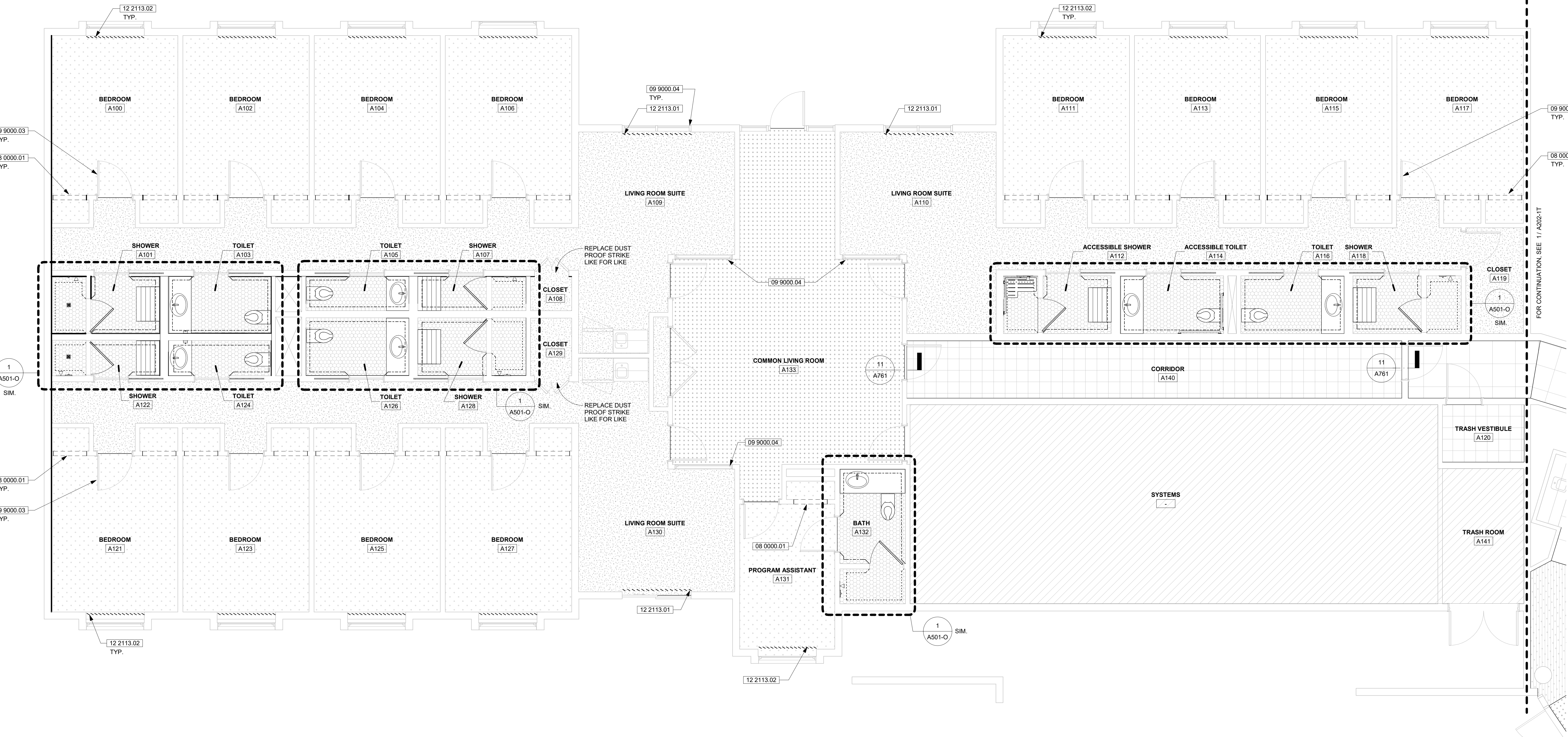

BUILDING O - FIRST FLOOR CONSTRUCTION PLAN
1/4" = 1'-0"



CLIENT



UNIVERSITY OF CALIFORNIA,
RIVERSIDE
900 UNIVERSITY AVE
RIVERSIDE, CA 92507

PROJECT NAME

PENTLAND BLDG O INTERIOR
REFRESH
1 PENTLAND WAY
RIVERSIDE, CA 92507

PROJECT NUMBER

958912

ARCHITECT

PBWSI Architects
100 West Villa Street, Suite 101
Pasadena, CA 91103
P: 626.432.5000
F: 626.432.5010
www.pbwsi.com

DESIGN CONSULTANT

REGISTRATION STAMP

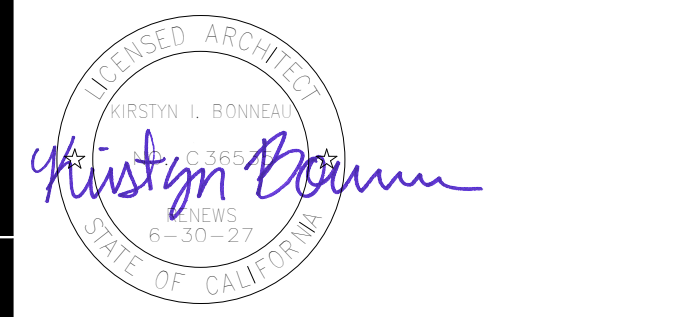

ISSUE

MARK	DATE	DESCRIPTION
▲	04/03/2026	PLAN CHECK RESUBMITTAL
	02/27/2026	100% CD
DESIGNER PROJ. NO. 25016_00		
DRAWN BY: KMc		
CHECKED BY: KB		
SCALE: As indicated		

KEY PLAN

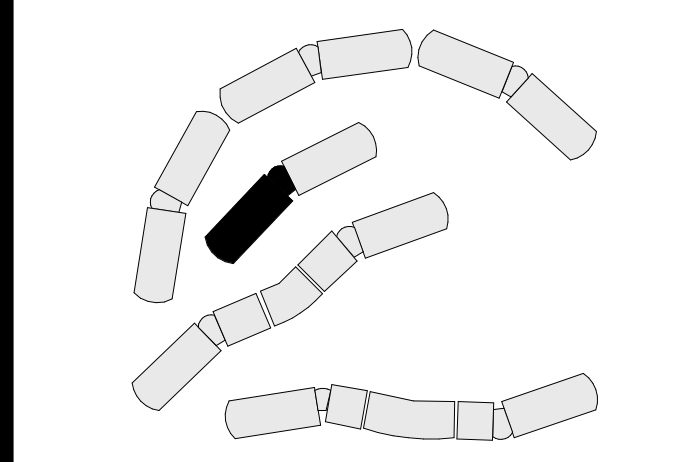

SHEET TITLE

BLDG O - FIRST FLOOR
CONSTRUCTION PLAN

SHEET NUMBER

A202-10

DEMOLITION KEYNOTES

DEMOLISH THE FOLLOWING UNLESS NOTED OTHERWISE:

- 02 4100.06 VERTICAL BLINDS
- 02 4100.09 DOWNLIGHT, BALLAST, AND BACKUP BATTERIES; PREPARE (E) ROUGH-IN FOR NEW WORK
- 02 4100.10 WALL-MOUNTED LIGHT; PREPARE (E) ROUGH-IN FOR NEW WORK
- 02 4100.11 CAREFULLY REMOVE (E) MECHANICAL GRILLE AND SALVAGE FOR NEW WORK

LEGEND

- (E) ACOUSTIC CEILING TILE
- (E) GYPSUM CEILING BOARD
- NIC: CEILING NOT IN SCOPE
- DOWNLIGHT TO BE DEMOLISHED
- LED LIGHT FIXTURE TO BE DEMOLISHED
- MECHANICAL GRILLE TO BE REMOVED AND SALVAGED FOR NEW WORK
- MECHANICAL GRILLE TO BE REMOVED AND SALVAGED FOR NEW WORK

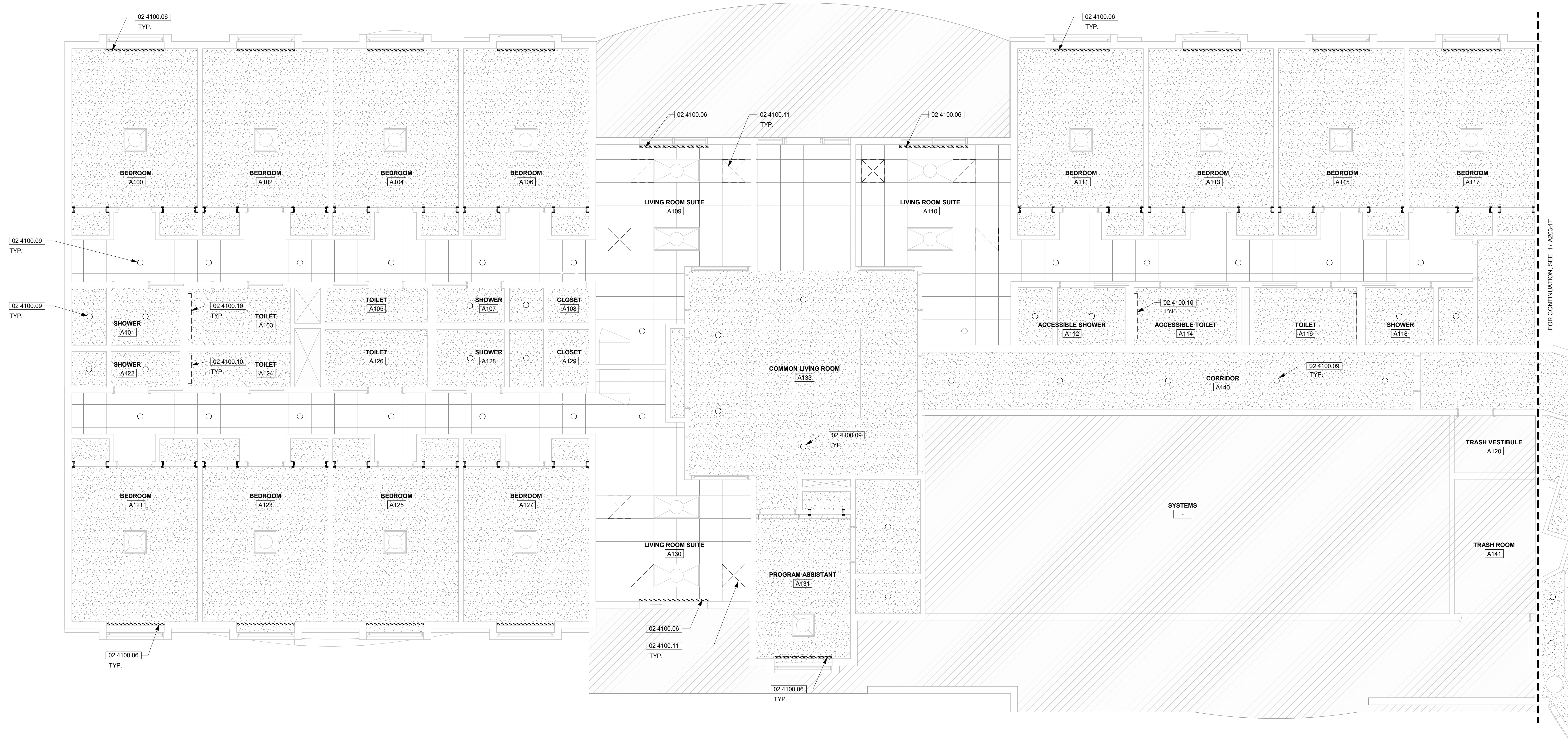

1 BLDG O - FIRST FLOOR DEMOLITION REFLECTED PLAN
1/4" = 1'-0"

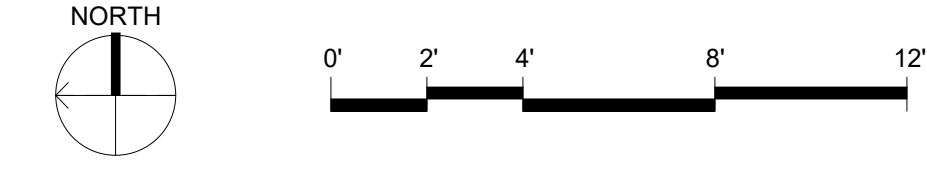

FOR CONTINUATION SEE 11/A203-1T

3/19/2026 1:35:53 PM D:\Revit\Local\Perland HHS Building O_levin\FDKU\14



AGENCY APPROVAL

APPROVED
 UC RIVERSIDE
 04/20/2026
 Office of the Campus Architect
 Signed CBO: Charles Blumer
 Building & Safety Department
 CAMPUS BUILDING PERMIT

CLIENT



UNIVERSITY OF CALIFORNIA,
 RIVERSIDE
 900 UNIVERSITY AVE
 RIVERSIDE, CA 92507

PROJECT NAME

PENTLAND BLDG O INTERIOR
 REFRESH
 1 PENTLAND WAY
 RIVERSIDE, CA 92507

PROJECT NUMBER

958912

ARCHITECT

PBWSI
 Architects
 100 West Villa Street, Suite 101
 Pasadena, CA 91103
 P: 626.432.5000
 F: 626.432.5010
 www.pbwsi.com

DESIGN CONSULTANT

REGISTRATION STAMP

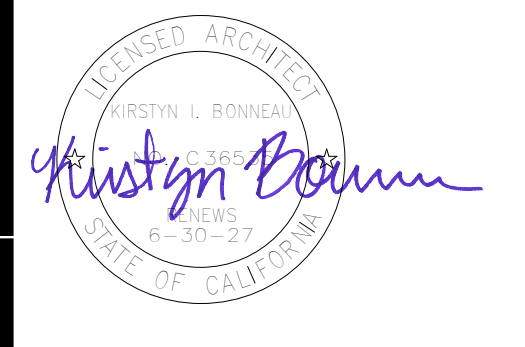

ISSUE

MARK	DATE	DESCRIPTION
△	04/03/2026	PLAN CHECK RESUBMITTAL
	02/27/2026	100% CD
DESIGNER PROJ. NO. 25016_00		
DRAWN BY: KMc		
CHECKED BY: KB		
SCALE: 1/4" = 1'-0"		

KEY PLAN

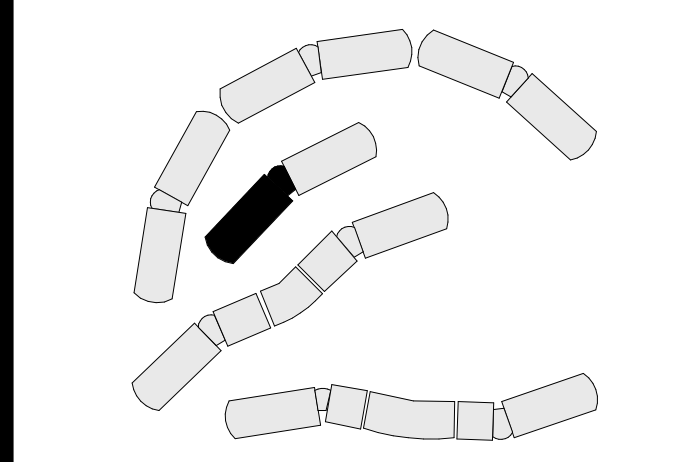

SHEET TITLE

BLDG O - FIRST FLOOR
 DEMOLITION REFLECTED CEILING
 PLAN

SHEET NUMBER

A203-10

DEMOLITION KEYNOTES

DEMOLISH THE FOLLOWING UNLESS NOTED OTHERWISE:

- 02 4100.06 VERTICAL BLINDS
- 02 4100.09 DOWNLIGHT, BALLAST, AND BACKUP BATTERIES; PREPARE (E) ROUGH-IN FOR NEW WORK
- 02 4100.11 CAREFULLY REMOVE (E) MECHANICAL GRILLE AND SALVAGE FOR NEW WORK

LEGEND

- (E) ACOUSTIC CEILING TILE
- (E) GYPSUM CEILING BOARD
- NIC: CEILING NOT IN SCOPE
- DOWNLIGHT TO BE DEMOLISHED
- LED LIGHT FIXTURE TO BE DEMOLISHED
- MECHANICAL GRILLE TO BE REMOVED AND SALVAGED FOR NEW WORK
- MECHANICAL GRILLE TO BE REMOVED AND SALVAGED FOR NEW WORK

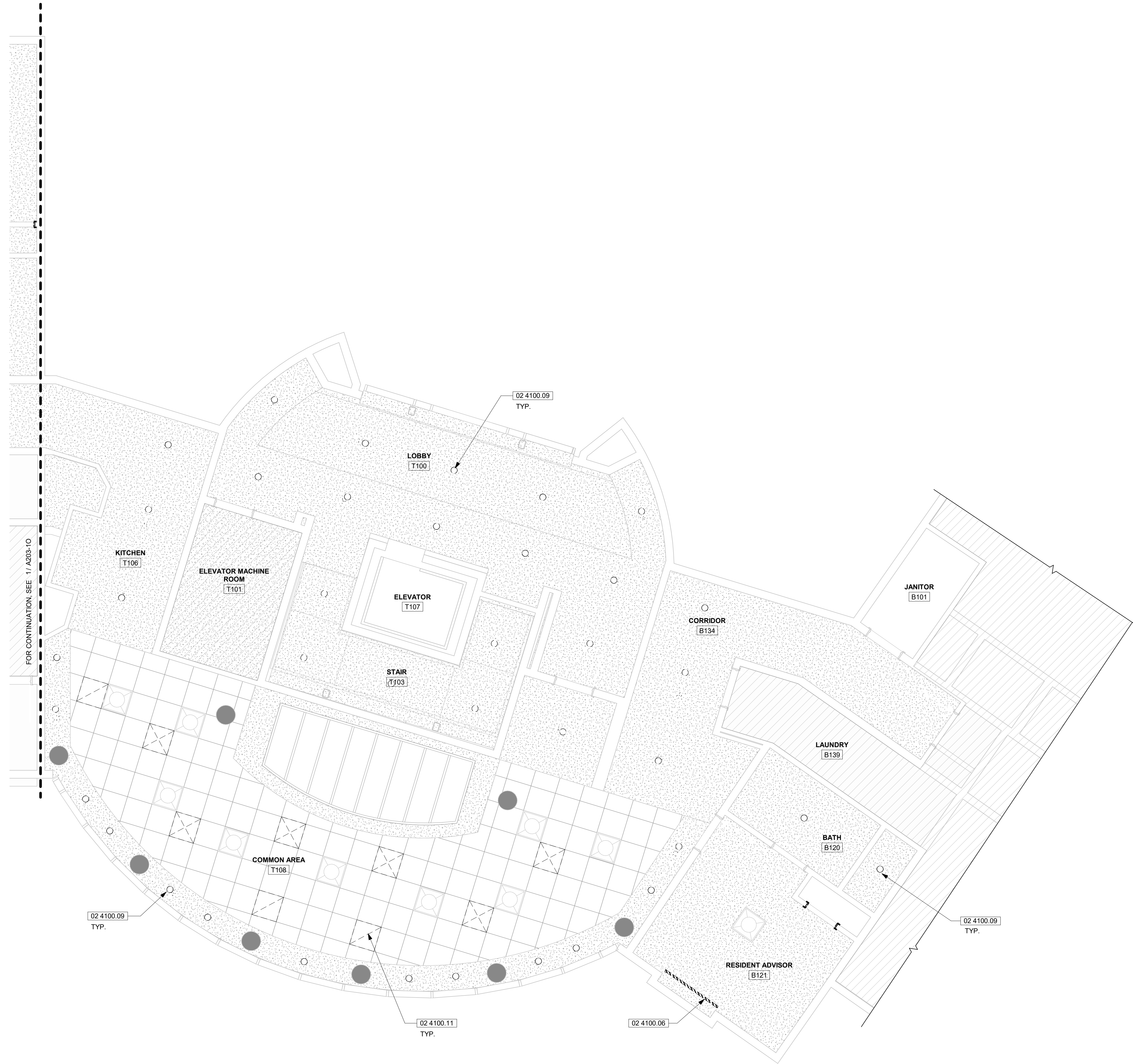

1 TOWER - FIRST FLOOR DEMOLITION REFLECTED PLAN
1/4" = 1'-0"

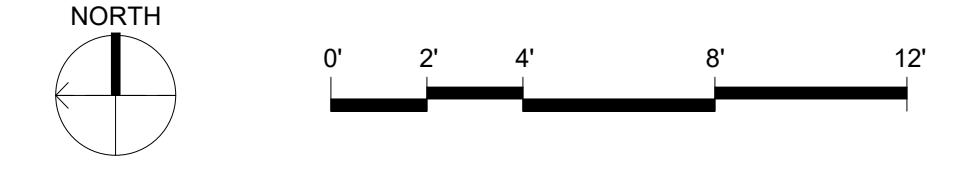

AGENCY APPROVAL

APPROVED
 UC RIVERSIDE
 04/20/2026
 Office of the Campus Architect
 Signed CBO: Charles Blumer
 Building & Safety Department
 CAMPUS BUILDING PERMIT

CLIENT



UNIVERSITY OF CALIFORNIA,
 RIVERSIDE
 900 UNIVERSITY AVE
 RIVERSIDE, CA 92507

PROJECT NAME

PENTLAND BLDG O INTERIOR
 REFRESH
 1 PENTLAND WAY
 RIVERSIDE, CA 92507

PROJECT NUMBER

958912

ARCHITECT

PBWSI
 Architects
 100 West Villa Street, Suite 101
 Pasadena, CA 91103
 P: 626.432.5000
 F: 626.432.5010
 www.pbws.com

DESIGN CONSULTANT

REGISTRATION STAMP

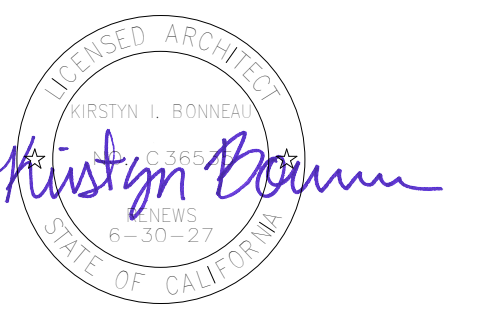

ISSUE

MARK	DATE	DESCRIPTION

04/03/2026 PLAN CHECK RESUBMITTAL
 02/27/2026 100% CD

DESIGNER PROJ. NO. 25016_00

DRAWN BY: KMc

CHECKED BY: KB

SCALE: 1/4" = 1'-0"

KEY PLAN

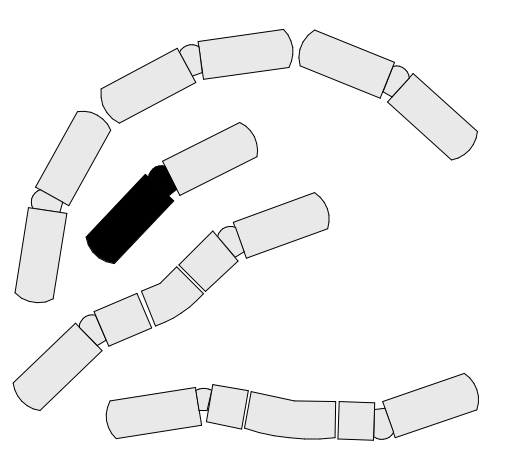

SHEET TITLE

TOWER - FIRST FLOOR
 DEMOLITION REFLECTED CEILING
 PLAN

SHEET NUMBER

A203-1T

3/19/2026 11:35:4 PM D:\Revit\Local\Pentland HHS Building_O_levin\FBDK\1.t

CONSTRUCTION KEYNOTES

- 09 9000.05 PAINT (E) MECHANICAL GRILLE PNT-1 PER FINISH SCHEDULE AND REINSTALL IN (E) ACOUSTIC CEILING
- 12 2113.01 VERTICAL BLINDS AT SLIDING DOOR (TYPE V-1)
- 12 2113.02 VERTICAL BLINDS AT WINDOW (TYPE V-2)
- 26 0000.01 EQUIP DOWNLIGHT WITH LED EMERGENCY DRIVER, MFR: PORTOR MODEL: PT-EMG-9W

LEGEND

- (E) ACOUSTIC CEILING TILE
- PNT-1: PAINTED GYPSUM CEILING BOARD (REFER TO FINISH SCHEDULE ON FLOOR PLANS)
- NIC: CEILING NOT IN SCOPE
- L-1: DOWNLIGHT PER FIXTURE SCHEDULE
- L-1: DOWNLIGHT PER FIXTURE SCHEDULE EQUIPPED WITH LED EMERGENCY DRIVER
- L-2a: LED WRAPAROUND PER FIXTURE SCHEDULE
- L-2b: LED WRAPAROUND PER FIXTURE SCHEDULE
- PNT-1: MECHANICAL GRILLE (REFER TO FINISH SCHEDULE ON FLOOR PLANS)
- PNT-1: MECHANICAL GRILLE (REFER TO FINISH SCHEDULE ON FLOOR PLANS)

LIGHTING FIXTURE SCHEDULE

MARK	MANUFACTURER	MODEL	DESCRIPTION	COUNT (V.I.F.)
L-1	PORTOR	PT CDL2 8i 5C3P	8" LED RETROFIT DOWNLIGHT	164
L-2a	LITHONIA	FMLWL	48" LED WRAPAROUND	14
L-2b	LITHONIA	FMLWL	24" LED WRAPAROUND	6

LIGHTING SCHEDULE NOTES

- INSTALL LIGHTING FIXTURES NOTED IN SCHEDULE USING EXISTING ROUGH-INS.
- FIELD VERIFY QUANTITY OF FIXTURES TO BE REPLACED THROUGHOUT SUITE HALLWAYS, ELEVATOR TOWER CORRIDORS, AND SHOWER ROOMS. CONTACT UNIVERSITY REPRESENTATIVE IF SCOPE IS UNCLEAR.
- EQUIP L-1 FIXTURES WITH EMERGENCY DRIVERS AS NOTED IN PLAN.

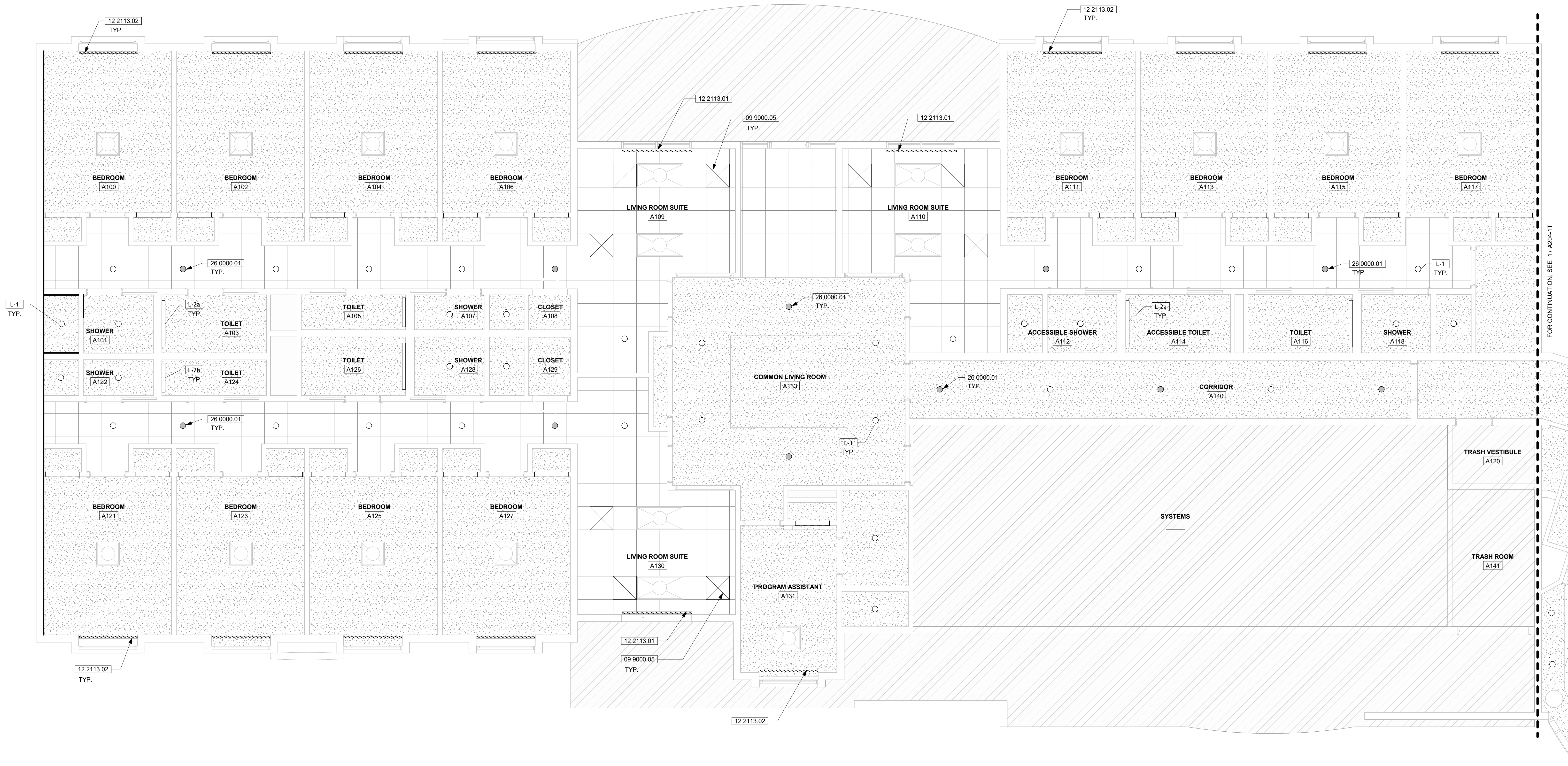

1 BLDG O - FIRST FLOOR CONSTRUCTION REFLECTED PLAN

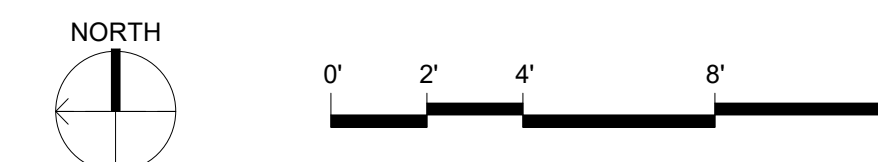

FOR CONTINUATION SEE 11 A204-1T



AGENCY APPROVAL



CLIENT



UNIVERSITY OF CALIFORNIA,
RIVERSIDE
900 UNIVERSITY AVE
RIVERSIDE, CA 92507

PROJECT NAME

PENTLAND BLDG O INTERIOR
REFRESH
1 PENTLAND WAY
RIVERSIDE, CA 92507

PROJECT NUMBER

958912

ARCHITECT

PBWSI
Architects
100 West Villa Street, Suite 101
Pasadena, CA 91103
P: 626.432.5000
F: 626.432.5010
www.pbwsi.com

DESIGN CONSULTANT

REGISTRATION STAMP

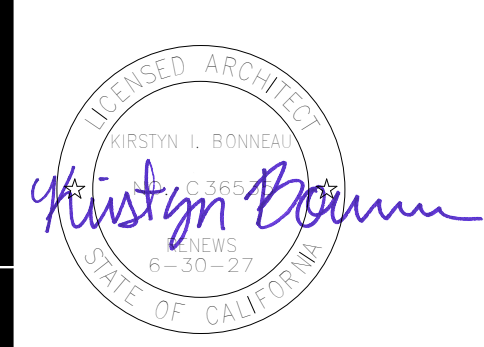

ISSUE

MARK	DATE	DESCRIPTION
▲	04/03/2026	PLAN CHECK RESUBMITTAL
	02/27/2026	100% CD

DESIGNER PROJ. NO. 25016_00
DRAWN BY: KMc
CHECKED BY: KB
SCALE: As indicated

KEY PLAN

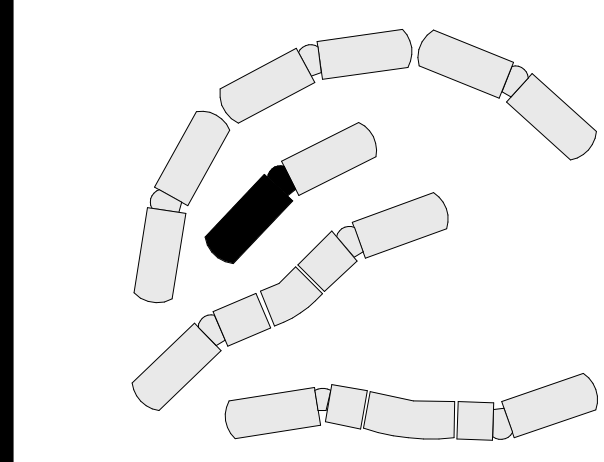

SHEET TITLE

BLDG O - FIRST FLOOR
CONSTRUCTION REFLECTED
CEILING PLAN

SHEET NUMBER

A204-10



AGENCY APPROVAL



CLIENT



UNIVERSITY OF CALIFORNIA, RIVERSIDE
900 UNIVERSITY AVE
RIVERSIDE, CA 92507

PROJECT NAME

PENTLAND BLDG O INTERIOR REFRESH
1 PENTLAND WAY
RIVERSIDE, CA 92507

PROJECT NUMBER

958912

ARCHITECT

PBWSI Architects
100 West Villa Street, Suite 101
Pasadena, CA 91103
P: 626.432.5000
F: 626.432.5010
www.pbwsi.com

DESIGN CONSULTANT

REGISTRATION STAMP

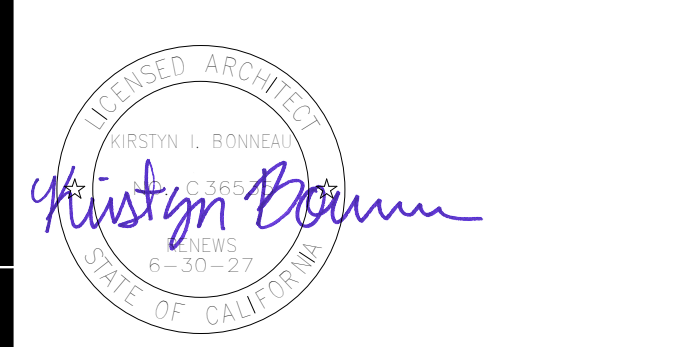

ISSUE

NO.	DATE	DESCRIPTION

04/03/2026 PLAN CHECK RESUBMITTAL

02/27/2026 100% CD

MARK DATE DESCRIPTION

DESIGNER PROJ. NO. 25016_00

DRAWN BY: KMc

CHECKED BY: KB

SCALE: As indicated

KEY PLAN

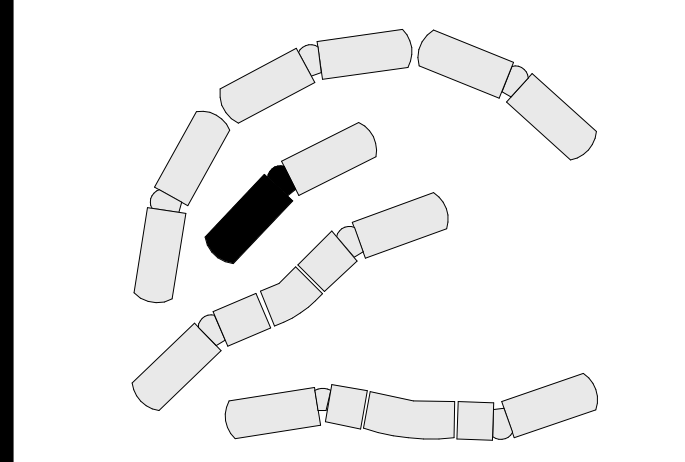

SHEET TITLE

TOWER - FIRST FLOOR CONSTRUCTION REFLECTED CEILING PLAN

SHEET NUMBER

A204-1T

CONSTRUCTION KEYNOTES

- 09 9000.01 PAINT COLUMN PT-3 PER FINISH SCHEDULE
- 09 9000.05 PAINT (E) MECHANICAL GRILLE PNT-1 PER FINISH SCHEDULE AND REINSTALL IN (E) ACOUSTIC CEILING
- 12 2113.02 VERTICAL BLINDS AT WINDOW (TYPE V-2)

LEGEND

- (E) ACOUSTIC CEILING TILE
- PNT-1: PAINTED GYPSUM CEILING BOARD (REFER TO FINISH SCHEDULE ON FLOOR PLANS)
- NIC: CEILING NOT IN SCOPE
- L-1: DOWNLIGHT PER FIXTURE SCHEDULE
- L-1: DOWNLIGHT PER FIXTURE SCHEDULE EQUIPPED WITH LED EMERGENCY DRIVER

LIGHTING FIXTURE SCHEDULE

MARK	MANUFACTURER	MODEL	DESCRIPTION	COUNT (V.I.F.)
L-1	PORTOR	PT CDL2 B1 5C3P	8" LED RETROFIT DOWNLIGHT	82

LIGHTING SCHEDULE NOTES

- INSTALL LIGHTING FIXTURES NOTED IN SCHEDULE USING EXISTING ROUGH-INS.
- FIELD VERIFY QUANTITY OF FIXTURES TO BE REPLACED THROUGHOUT SUITE HALLWAYS, ELEVATOR TOWER CORRIDORS, AND SHOWER ROOMS. CONTACT UNIVERSITY REPRESENTATIVE IF SCOPE IS UNCLEAR.
- EQUIP L-1 FIXTURES WITH EMERGENCY DRIVERS AS NOTED IN PLAN.

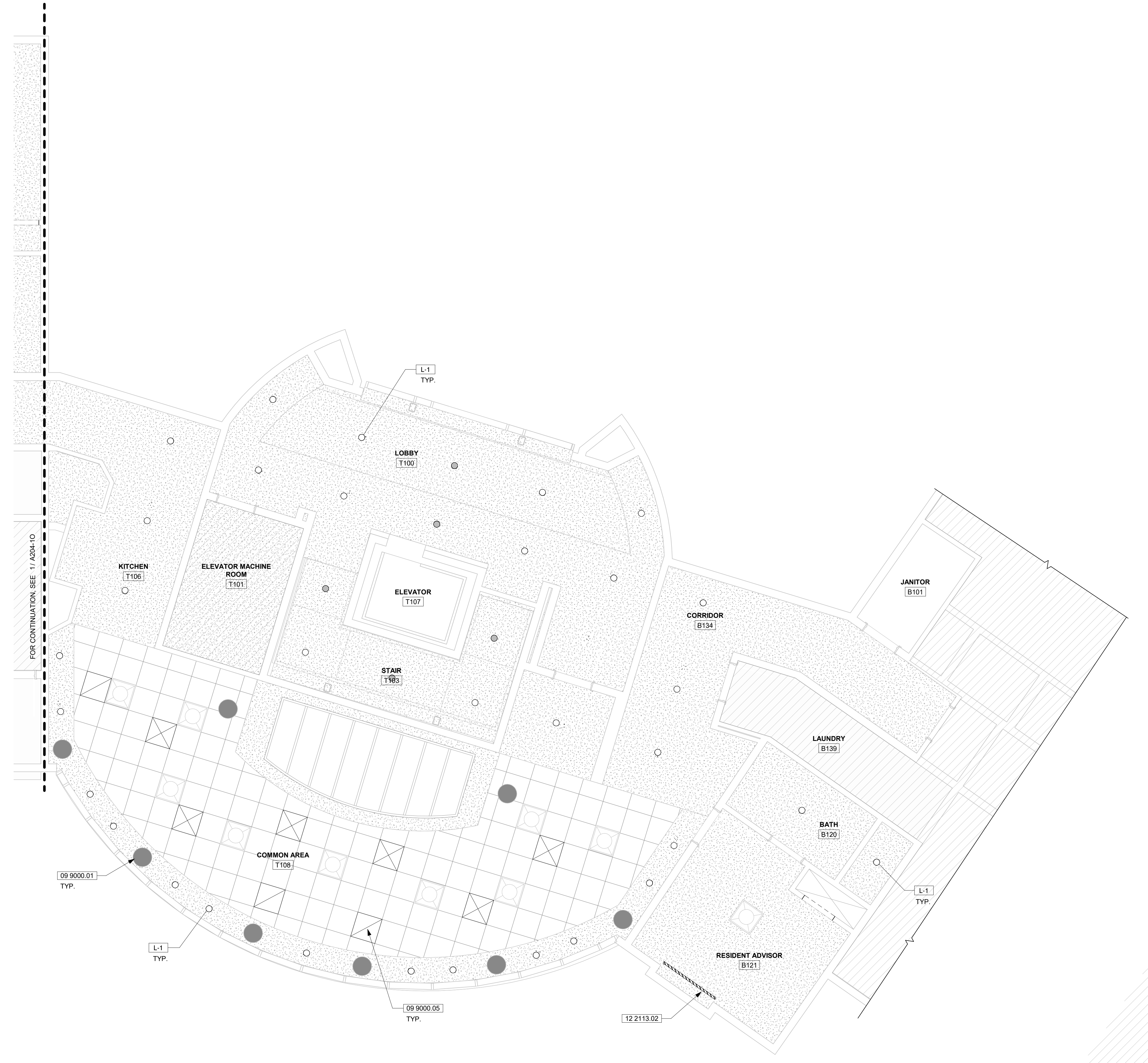

1 TOWER - FIRST FLOOR CONSTRUCTION REFLECTED CEILING PLAN

1/4" = 1'-0"

DEMOLITION KEYNOTES

DEMOLISH THE FOLLOWING UNLESS NOTED OTHERWISE:

- 02 4100.01 CLOSET DOOR AND TRACK PER DETAIL 1/A761
- 02 4100.02 CAREFULLY REMOVE WALL-MOUNTED TOILET AND SALVAGE FOR RE-INSTALLATION
- 02 4100.03 LAVATORY AND COUNTER PER DETAIL 5/A771
- 02 4100.04 SHOWER FIXTURE AND HARDWARE INCLUDING HEAD, VALVE, HANDLE, AND FACEPLATE
- 02 4100.05 BENCH
- 02 4100.06 VERTICAL BLINDS
- 02 4100.07 SHOWER DOOR
- 02 4100.08 GRAB BAR
- 12 0000.01 OFCI WALL-MOUNTED FOLDING DRESSING BENCH PER DETAIL 2/A771

LEGEND

- DEMOLISH EXISTING CARPET, RUBBER BASE AND LIGHTWEIGHT CONCRETE SUBFLOOR
- DEMOLISH EXISTING CERAMIC FLOOR TILE AND LIGHTWEIGHT CONCRETE SUBFLOOR
- DEMOLISH EXISTING VINYL FLOOR TILE, RUBBER BASE, AND LIGHTWEIGHT CONCRETE SUBFLOOR
- AREA NOT IN SCOPE
- DEMOLISH EXISTING CERAMIC WALL TILE, TILE BASE, SHEATHING, AND/OR GYPSUM BOARD DOWN TO EXISTING STUDS

DEMOLITION GENERAL NOTES

1. PROTECT P-TRAPS AND CONDENSATE ATTACHMENT IN PLACE DURING THE COURSE OF DEMOLITION.
2. PLUG ALL DRAINS PRIOR TO DEMOLITION TO PREVENT DEBRIS AND DUST INFILTRATION.
3. NOTIFY ARCHITECT AND UNIVERSITY REPRESENTATIVE OF ANY EXISTING SHOWER CLEANOUTS UNCOVERED IN THE COURSE OF DEMOLITION.
4. DEMOLISH DAMAGED SHEAR PANELS AT TOILET AND SHOWER ROOMS. DO NOT DEMOLISH UNDAUNTED SHEAR PANELS. COORDINATE WITH THE ARCHITECT AND STRUCTURAL ENGINEER IF THE EXTENT OF DAMAGE IS UNCLEAR.
5. WHEN GRINDING CONCRETE:
 - A. USE A CONTAINMENT SYSTEM CAPABLE OF MITIGATING THE SPREAD OF DUST TO THE SATISFACTION OF THE UNIVERSITY REPRESENTATIVE.
 - B. COVER SMOKE ALARMS.



AGENCY APPROVAL

APPROVED

 04/20/2026
Office of the Campus Architect
 Signed CBO: *Charles Blum*
 Building & Safety Department
CAMPUS BUILDING PERMIT

CLIENT



UNIVERSITY OF CALIFORNIA,
 RIVERSIDE
 900 UNIVERSITY AVE
 RIVERSIDE, CA 92507

PROJECT NAME

PENTLAND BLDG O INTERIOR
 REFRESH
 1 PENTLAND WAY
 RIVERSIDE, CA 92507

PROJECT NUMBER

958912

ARCHITECT

PBWSI
 Architects
 100 West Villa Street, Suite 101
 Pasadena, CA 91103
 P: 626.432.5000
 F: 626.432.5010
 www.pbwsi.com

DESIGN CONSULTANT

REGISTRATION STAMP

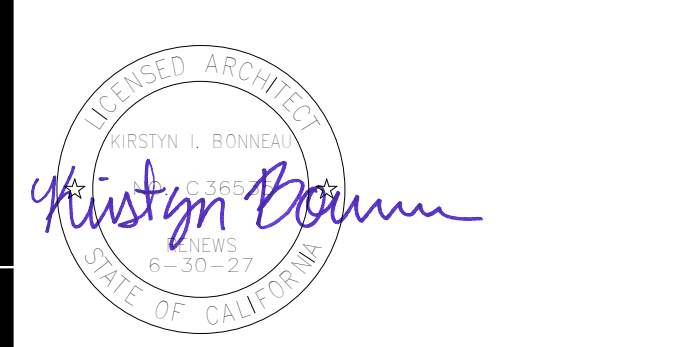

ISSUE

MARK	DATE	DESCRIPTION
▲	04/03/2026	PLAN CHECK RESUBMITTAL
	02/27/2026	100% CD
		DESIGNER PROJ. NO. 25916_00
		DRAWN BY: KMc
		CHECKED BY: KB
		SCALE: As indicated

KEY PLAN

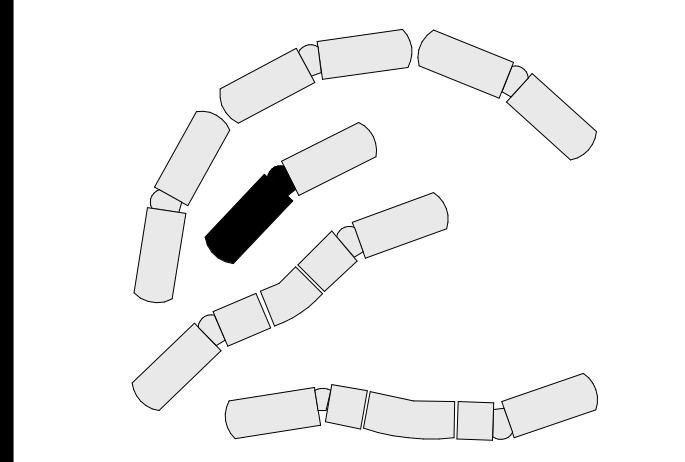

SHEET TITLE

BLDG O - SECOND FLOOR
 DEMOLITION PLAN

SHEET NUMBER

A201-20

E

D

C

B

A

3/19/2026 11:35:58 PM D:\Revt\Local\Pentland HHS Building O_levin\FDK\1.rvt

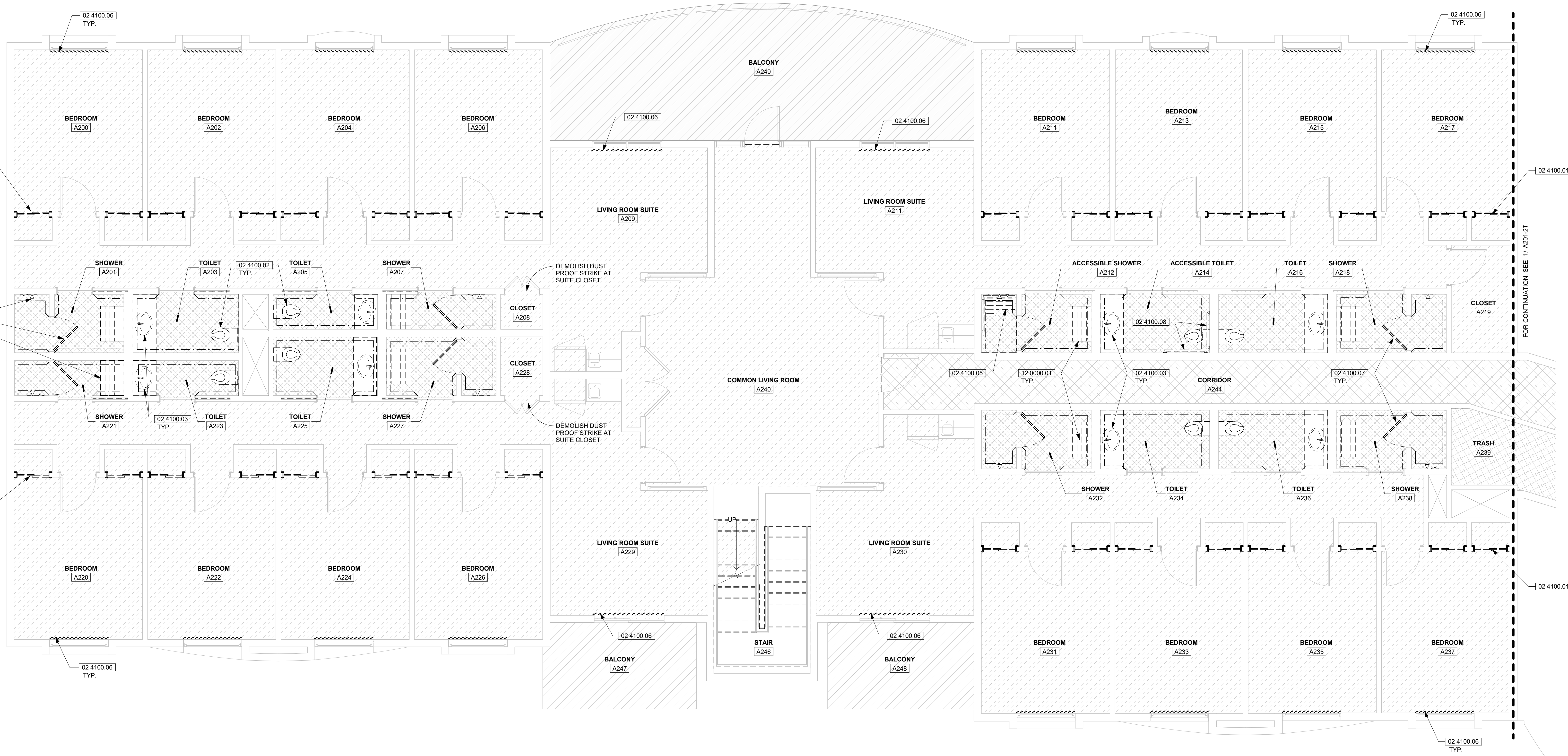



1 BUILDING O - SECOND FLOOR DEMOLITION PLAN
 1/4" = 1'-0"

DEMOLITION KEYNOTES

DEMOLISH THE FOLLOWING UNLESS NOTED OTHERWISE:

LEGEND

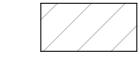
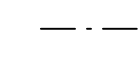
-  DEMOLISH EXISTING CARPET, RUBBER BASE AND LIGHTWEIGHT CONCRETE SUBFLOOR
-  DEMOLISH EXISTING CERAMIC FLOOR TILE AND LIGHTWEIGHT CONCRETE SUBFLOOR
-  DEMOLISH EXISTING VINYL FLOOR TILE, RUBBER BASE, AND LIGHTWEIGHT CONCRETE SUBFLOOR
-  AREA NOT IN SCOPE
-  DEMOLISH EXISTING CERAMIC WALL TILE, TILE BASE, SHEATHING, AND/OR GYPSUM BOARD DOWN TO EXISTING STUDS

DEMOLITION GENERAL NOTES

1. PROTECT P-TRAPS AND CONDENSATE ATTACHMENT IN PLACE DURING THE COURSE OF DEMOLITION.
2. PLUG ALL DRAINS PRIOR TO DEMOLITION TO PREVENT DEBRIS AND DUST INFILTRATION.
3. NOTIFY ARCHITECT AND UNIVERSITY REPRESENTATIVE OF ANY EXISTING SHOWER CLEANOUTS UNCOVERED IN THE COURSE OF DEMOLITION.
4. DEMOLISH DAMAGED SHEAR PANELS AT TOILET AND SHOWER ROOMS. DO NOT DEMOLISH UNDAMAGED SHEAR PANELS. COORDINATE WITH THE ARCHITECT AND STRUCTURAL ENGINEER IF THE EXTENT OF DAMAGE IS UNCLEAR.
5. WHEN GRINDING CONCRETE:
 - A. USE A CONTAINMENT SYSTEM CAPABLE OF MITIGATING THE SPREAD OF DUST TO THE SATISFACTION OF THE UNIVERSITY REPRESENTATIVE.
 - B. COVER SMOKE ALARMS.



1 ELEVATOR TOWER - SECOND FLOOR DEMOLITION PLAN
1/4" = 1'-0"



AGENCY APPROVAL



CLIENT



UNIVERSITY OF CALIFORNIA,
RIVERSIDE
900 UNIVERSITY AVE
RIVERSIDE, CA 92507

PROJECT NAME

PENTLAND BLDG O INTERIOR
REFRESH
1 PENTLAND WAY
RIVERSIDE, CA 92507

PROJECT NUMBER

958912

ARCHITECT

PBWSI
Architects
100 West Villa Street, Suite 101
Pasadena, CA 91103
P: 626.432.5000
F: 626.432.5010
www.pbws.com

DESIGN CONSULTANT

REGISTRATION STAMP

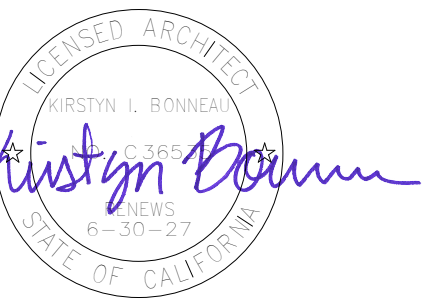

ISSUE

MARK	DATE	DESCRIPTION

04/03/2026 PLAN CHECK RESUBMITTAL
02/27/2026 100% CD

DESIGNER PROJ. NO. 25016_00

DRAWN BY: KMc

CHECKED BY: KB

SCALE: As indicated

KEY PLAN

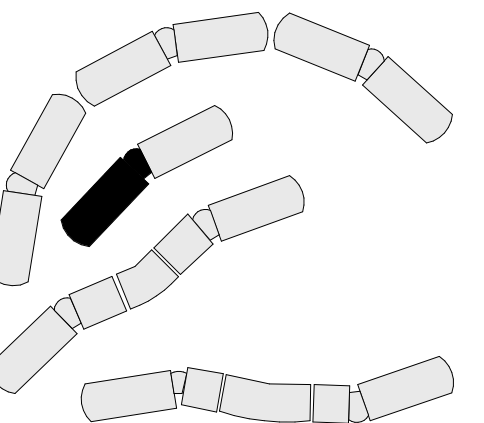

SHEET TITLE

TOWER - SECOND FLOOR
DEMOLITION PLAN

SHEET NUMBER

A201-2T