



HACIENDA LA PUENTE UNIFIED SCHOOL DISTRICT

PURCHASING DEPARTMENT
15959 E. GALE AVENUE • CITY OF INDUSTRY, CA 91745
(626) 933-3930

*Joel Duarte,
Director Purchasing & Warehouse*

BID NO. 2024-25.10
WILSON HIGH SCHOOL: MEDIA CENTER UPGRADE
February 11, 2025
ADDENDUM NO.01

The following changes, additions, deletions, or corrections shall become a part of the Contract Documents for the project named above and all other conditions shall remain the same. The bidders shall be responsible for transmitting this information to all affected subcontractors and suppliers prior to the closing of bids. Acknowledge receipt of this Addendum in spaces provided on the Bid Form. Failure to acknowledge may subject Bidder to disqualification.

BID FORMS REPLACED

- None

REVISIONS TO BIDDING REQUIREMENTS

- The day and time for which Bids are due and will be opened is hereby changed, any and all references in the original bid shall be revised to reflect the new DUE DATE OF:

FEBRUARY 18, 2025 at 3:00 PM

REVISIONS TO SPECIFICATIONS

None

REVISIONS TO DRAWINGS

- See attached included in **ADDENDUM 01 Details**

RESPONSES TO BID RFI

- See attached, **Wilson HS Media_Pre-bid RFI's Responses**

CLARIFICATIONS

- Bid Alternate No.1 should ONLY include the amount necessary for that portion of work associated for the work called out in the Bid and Addenda, it is NOT CUMULATIVE OF THE ENTIRE SCOPE INCLUDING THAT WHICH IS CALLED OUT IN THE ALTERNATE.

ATTACHMENTS

- **ADDENDUM 01 Details** (which includes new attached Drawings: A-0, A-7, A-9, A-13, E-0.1, E-2.0, E-2.1, E-3.1)
- **Wilson HS Media_Pre-bid RFI's Responses**
- **2025 Wilson HS Media Center-Library - Asbestos and Lead Survey Rpt**

END OF ADDENDUM NO.1

Vision Statement:

The Hacienda La Puente Unified School District is a community committed to developing lifelong learners who value themselves and the diversity of all people; apply decision-making skills leading to responsible actions; and use creativity, critical thinking, and problem solving in meeting the challenges of a changing society.

Date: February 11, 2025

ADDENDUM 01 Details

RE: Project Bidding Documents for:

**WILSON HIGH SCHOOL
MEDIA CENTER REMODEL
HACIENDA LA PUENTE UNIFIED SCHOOL DISTRICT**

tBP Project No. 21211.00

tBP/ARCHITECTURE
4611 Teller Avenue
Newport Beach, CA 92660
949-673-0300

TO: PROSPECTIVE BIDDERS

This Addendum forms a part of the Contract Documents and modifies the original approved Bidding Drawings and Specifications dated November 21, 2024. Acknowledge receipt of this Addendum in space provided on the Bid Form. Failure to acknowledge may subject Bidder to disqualification.

CHANGES TO DRAWINGS

Architectural

1. SHEET A-0 SITE DEMO AND REMODEL PLAN
 - a. Site Demo Plan - Revised demolition Keynote #7 to add the height of the existing brick wall for Bid Alt # 1.
 - b. Site Demo Plan - Revised Keynotes #6 and #7 have been labeled as "Typical" on the Site Demo Plan.
 - c. Site Plan - Keynotes # 9 and #11 have been labeled as "Typical" on the Site Plan.
 - d. Replace Sheet A-0 Site Demo and Remodel plan in its entirety issued with this addendum.

2. SHEET A-7 INTERIOR ELEVATIONS
 - a. Remodel Keynote # 10 was modified to include a projection screen mounting detail 20/A-9 and revise mounting height to
 - b. Replace Sheet A-7 Interior Elevation sheet in its entirety issued with this addendum.

3. SHEET A-9 INTERIOR DETAILS
 - a. Added Detail 20 /A-9 for the mounting of the motorized projection screen.
 - b. Replace Sheet A-9 Interior Detail sheet in its entirety issued with this addendum.

WILSON HIGH SCHOOL
MEDIA CENTER REMODEL
HACIENDA LA PUENTE UNIFIED SCHOOL DISTRICT

ADDENDUM 01 Details

4. SHEET A-13 FURNITURE SCHEDULE
 - a. Added a note: "ALL FURNISHINGS ARE TO BE OWNER FURNISHED AND CONTRACTOR INSTALLED."
 - b. Replace Sheet A-13 Furniture Schedule sheet in its entirety issued with this addendum.

5. SHEET E-0.1 GENERAL NOTES, SYMBOLS & SCHEDULES
 - a. Revise Panel Schedule KLB to include (N) AV Rack.
 - b. Replace Sheet E-01 General Notes, Symbols & Schedules in its entirety issued with this addendum.

6. SHEET E2.0 REMODEL POWER PLAN
 - a. Added location of new AV Cabinet and power to Panel KLB.
 - b. Replace Sheet E-2.0 Remodel Power Plan in its entirety issued with this addendum.

7. SHEET E-2.1 REMODEL SIGNAL PLAN
 - a. Added location of new AV cabinet.
 - b. Replace Sheet E-2.1 Remodel Signal Plan in its entirety issued with this addendum.

8. SHEET E3.1 ELECTRICAL DETAILS
 - a. Revise Details 8, 9, 13, 14, & 15.
 - b. Replace Sheet E-3.1 Electrical Details in its entirety issued with this addendum.

ATTACHMENTS

The following attachments are a part of Addendum 01:

1. **Full Size Documents (30" x 42") Drawings: (Total 8)**
 - A-0
 - A-7
 - A-9
 - A-13
 - E-0.1
 - E-2.0
 - E-2.1
 - E-3.1

Date: February 11, 2025

**WILSON HIGH SCHOOL
MEDIA CENTER REMODEL
HACIENDA LA PUENTE UNIFIED SCHOOL DISTRICT**

tBP Proj. No. 21211.00

tBP/ARCHITECTURE
4611 Teller Avenue
Newport Beach, CA 92660
949-673-0300

TO: PROSPECTIVE BIDDERS

RESPONSES TO PRE-BID RFI'S

1. Sheet A-13
The furniture schedule on Sheet A-13 is for reference only. Please confirm all interior and exterior furnishings are not part of this project.
Response – The district will have the furnishings indicated on sheet A-13 to be “Owner Furnished and Contractor Installed.” Plan is attached to this addendum.
2. General
Is there an Engineer's Estimate for this project?
Response – \$650,000
3. General
Are there any prequalification requirements? GC? MEP subcontractors?
Response – There is no prequalification requirement for the GC or subcontractors.
4. General
Are there any DBE/DVBE requirements?
Response – See Information for Bidders #23.
5. General
Are there estimated start and completion dates?
Response – The estimated start date is April 1, 2025. The estimated completion date is May 30, 2025.
6. General
Is this project subject to Davis-Bacon? If this project is subject to Davis-Bacon, please provide Federal wage determination.
Response – This project is not subject to Davis-Bacon.
7. General
Part A: Is there a statute or regulation that would impose STW requirements as an enforceable commitment for this project, in accordance with Public Contract Code Sections 2600 - 2603?
Part B: If the answer to question #1 is “yes,” which specific statute or regulation mandates STW as an enforceable commitment for this project?

Response – STW are not applicable to this project.

8. Sheet A-0

Is the entire brick wall around the outdoor area to be removed (as an alt) or only the south wall with the rest remaining? Is the fence alt to replace the North, South, and West walls with fence, terminating at the building along the East perimeter?

Response – Bid Alternate No.1 indicates the removal the entire masonry wall and foundation and replace it with new foundation and fencing and shall be excluded from the base bid and listed separately. Demolition keynote #7 “Bid Alt No.1” has been modified to indicate the wall height and is noted as typical for all sides of the masonry wall, and keynote #6 is noted as typical for all sides of the masonry wall. Site Plan keynote #11 “Bid Alt No. 1” and keynote #9 is typical for all sides of the masonry wall. Plan A-0 is attached to this addendum.

9. General

As discussed verbally during the job walk, contractors should account for PLA wages in their pricing. Please confirm, is this project submit to PLA (project labor agreement), While as per Bid documents the project is submit to PW (Prevailing Wages)?

Response – This Project is subject to the District’s Continuity of Work Agreement (CWA) included in the bid documents. The CWA does not negate or supplant the Prevailing Wage requirement.

10. Sheet A-7

Please clarify the mounting details for the projection screens. Keynote #10 on sheet A-7 says to use 8/A-9 however that detail is for a motorized window shade. Please clarify and provide an updated detail.

Response – New projection screen mounting detail 20/A9 is provided for mounting of the screen. Plan A-7 and A-9 are attached to this addendum.

11. Specification Section 11 52 13

Please provide a model for the projection screens that should be provided under section 115213. This was not included in the specs and not shown on the plans.

Response – Basis of Design: Dal-Lite Tension Contour Electrol -16:10 Wide Format, 123” diagonal, model #29928LS, Parallax Stratos 1.0, or equal. Mount the bottom of the screen case at 10’-0” above floor and align projector lens to minimize parallax and image distortion.

12. Specification Section 11 52 16

Please provide a model number for the flat panel displays that should be provided under section 115216. This display was mentioned in the specs, but no model number was provided. Also not provided on the plans.

Response – Basis of Design: Sony Model #KDL70R550A, 70-inch, 1080P, LED, HDTV monitor, or equal.

13. AV Wiring Diagram

Please provide the missing AV wiring diagram that shows how the AV systems should be connected.

Response – Refer to sheet E3.1, detail #13 for A/V wiring diagram. (A&F Engineering Group, Inc.)

14. Sheet E-2.1

Sheet E-2.1 is showing (2) projectors and (5) flat panel displays but there is no indication if this is all one system or multiple. Please clarify.

Response – Refer to sheet E3.1, A/V Outlet Diagrams and A/V Wiring Diagrams for system requirements. Projectors shall be interconnected and all flat panel displays are to be individually controlled. Projectors are to be mounted at a suitable height for the lenses to be aligned correctly to minimize parallax and image distortion.

15. Specification Section 27 13 46

The AV equipment called out in the 271346 specs are not reflected on the plans. Please clarify what spaces this section applies to and provide updated drawings that match.

Response – Refer to sheet E3.1, A/V Outlet Diagrams and A/V Wiring Diagrams for system requirements. (A&F Engineering Group, Inc.)

16. Sheet E-2.1

Plan note #7 on sheet E2.1 calls out for an assistive listening system to be provided however it is not clear if each AV system should be provided with their own separate assistive listening systems. Please clarify how many ALS should be provided.

Response – Note #7 indicates to provide quantities equal to 4% of the seating capacity, but in no case less than two receivers are to be provided. Refer to Architectural seating capacity to obtain quantities to be provided with a minimum of two receivers to be provided. Assistive listening devices shall be integrated into ceiling speakers. (A&F Engineering Group, Inc.)

17. Specification Section 27 13 46

The Teach Logic #CS-2 speakers are no longer available. Please provide an alternate.

Response – The Teach Logic #CS-2 is package of two (2) #SP-628 speakers with wire. Individual speaker model number is #SP-628. (A&F Engineering Group, Inc.)

18. Sheet -E2.2

Plans call to remove and reinstall fire pathways and devices. What is current manufacturer of the existing fire system?

Response – Existing fire alarm system is Silent Knight. (A&F Engineering Group, Inc.)

19. Information for Bidders

Per the “information for Bidders” Page 1, The District may receive requests for the Contract Documents from plan rooms. Please note: Prospective Bidders who choose to review the Contract Documents at a plan room must contact the District to obtain the required Contract Documents. We obtained our documents from ARC Costa Mesa’s plan room. Do we need anything else directly from the District?

Response –The District has used ARC/Planwell for all project bid documents: https://customer.e-arc.com/arcEOC/PWELL_Main.asp?mem=29 with District

20. General

Please confirm whether the Project Labor Agreement (PLA) is mandatory for this bid or if Prevailing Wage alone will be acceptable per the bid documents. Given the project's small scope and budget, enforcing PLA provisions is anticipated to increase the costs by 40% to 60% and significantly limit the pool of subcontractors suited for a project of this size. Clarification on this matter will help ensure accurate and competitive bidding.

Response – See response for RFI #9.

21. Sheet ED2.0

Where is the nearest IDF located for the network cabling?

Response – Refer to sheet ED2.0, plan #2 for location of nearest existing IDF.

22. General

Please advise where the laydown area will be for both material and parking, as the project develops.

Response – The laydown area will be determined after the contract is awarded. Its location will be selected in coordination with the needs of the awarded contractor, as well as the limitations and requirements of the school and the District's Facilities Department.

23. General

Has a hazardous material survey been completed for the area of work, if so, please provide the report?

Response – Attached as part of this Addendum No.1.

24. General

The abatement of any material identified in the District's Asbestos & Lead Based Paint Inspection Report will be done by the District.

25. Detail 13/E3.1

In the attached drawing, please clarify the intent of the following items:

- a. Priority page sensor, is this provided by the customer and we are just proving the #22 cable to the amplifiers and terminating to our amplifier?
- b. Internet TV, is this provided by the customer? If not, what are the specs and requirements needed?
- c. Microphone antenna, what are the specs and requirements needed?
- d. Splitter, what is the purpose of having two splitters on the same wire?

Response- a. Priority page sensor to be provided by Contractor.

b. Not required.

c. Not required

d. Refer to the revised wiring diagram on Sheet E3.1 attached to the addendum.

Refer to clouded areas on revised sheets E-0.1 General Notes, Symbols & schedules, E2.0 Remodel Power Plan, E-2.1 Remodel Signal Plan and E3.1 Electrical Details, for additional revised AV system information.

26. What is the objective of the audio system? Knowing the intent of the system will help our team develop and design the proper system that will adhere to the request.

Response - Audio system shall integrate with projectors and 3rd party connections to projectors. Individual TV stations shall utilize the speaker of the TV. Contractor to confirm with the District their requirements and provide a complete and operable

system upon completion.

27. Please advise on the speaker symbol icons in the print. What is the difference between the circle speaker icon and the square speaker icon?

Response – Disregard speaker symbol enclosed in a circle as that would have been part of the PA system, but the PA system is remaining as existing for this area. Provide the speaker enclosed in a square and that speaker will be for the projector screen interface.

28. Please provide all applicable information available for the existing fire alarm system, including equipment location.

Response- Fire alarm scope is limited to lifting existing wire-mold and sliding new material behind the fire alarm elements with the re-installation of the existing wire-mold on the new surface. All fire alarm equipment affected within the scope of work is indicated on the demolition sheet ED-2.0, plan #2 and sheet E-2.2, plan #1. The existing fire alarm system is a VEVAC system manufactured by Silent Knight.

29. During the job walk, it was noted that a DSA inspector will oversee the project. However, there is no DSA case number, permit, or approval process under Title 24 Standards, and the Bid documents don't specify the inspector's role. Please advise will a specific DSA permit be issued to allow the supervising inspector to enforce compliance with the approved plans? If no DSA permit will be issued, please advise how the DSA inspector's supervisory role will be managed, particularly in the absence of DSA standards specified in the plans.

Response – No DSA permit will be issued. The inspector's responsibility will be to ensure that the work is being carried out in accordance with the project plans and specifications. The inspector will also monitor the quality of the contractor's workmanship and provide regular reports to the District.

30. Is there a minimum self-performance threshold for prime contractors?

Response- There is no minimum threshold.



ASBESTOS & LEAD-BASED PAINT INSPECTION REPORT

For

**WILSON HIGH SCHOOL
MEDIA CENTER-LIBRARY**
16455 Wedgeworth Drive
Hacienda Heights, California 91745

Prepared For



HACIENDA LA PUENTE UNIFIED SCHOOL DISTRICT

15959 E. Gale Avenue
City of Industry, California 91745

Prepared By



16700 Valley View Avenue, Suite 100, La Mirada, California 90638
(714) 523- 9811 • Fax (714) 523-9810
www.encorp.net

January 21, 2025
ENCORP PROJECT NUMBER P25033.H21



TABLE OF CONTENTS

I. ASBESTOS & LEAD-BASED PAINT INSPECTION REPORT

II. SAMPLE ANALYSIS

IIA. SAMPLE ANALYSIS – ASBESTOS

IIB. SAMPLE ANALYSIS - LEAD

III. CERTIFICATIONS

IV. FIELD INSPECTION DATA

V. LIMITATIONS

**I. ASBESTOS & LEAD-BASED PAINT
INSPECTION REPORT**

ASBESTOS & LEAD-BASED PAINT INSPECTION REPORT

FACILITIES:**WILSON HIGH SCHOOL**
MEDIA CENTER-LIBRARY
16455 Wedgeworth Drive
Hacienda Heights, California 91745

INSPECTION DATE:.....January 21, 2025

INTRODUCTION

The **HACIENDA LA PUENTE UNIFIED SCHOOL DISTRICT** retained **ENCORP** to conduct an asbestos and lead-based paint inspection of the **MEDIA CENTER-LIBRARY** at **WILSON HIGH SCHOOL** located at 16455 Wedgeworth Drive, Hacienda Heights, California 91745. The inspection scope of work was to perform a complete inspection for suspect Asbestos Containing Materials (ACM's) and Lead-Based Painted Materials (LBPM's) of the exterior and interior of the building. The inspection results that follow summarize the components tested and the results.

Asbestos is a general term applied to a group of naturally occurring minerals which separate into fibers. This fibrous material (e.g., Amosite, Chrysotile, Crocidolite, Tremolite, Anthophyllite, and Actinolite) are composed of silicates of aluminum, magnesium and other metals which are incombustible and very difficult to destroy or degrade. Asbestos has a tendency to break into a dust of tiny fibers which can float in the air and be inhaled or swallowed. Asbestos inhalation exposure has been shown to increase the risk of developing lung cancer, mesothelioma (cancer of the lining of the lung and/or abdomen.) and asbestosis (chronic lung disease), as well as other damage to the lungs. Exposure occurs by breathing asbestos fibers produced as a fine dust when asbestos is handled during fabrication, installation or removal. By definition Asbestos Containing Materials (ACM) are any materials or products which contain greater than 1 percent (1%) asbestos. CAL/OSHA further regulates the content of asbestos in materials or products that contain greater than 1 tenth of a percent (0.1%) of asbestos requiring work to be performed by a licensed abatement contractor, and asbestos containing material containing 0.1% or less of asbestos requiring notification and training for the purpose of worker protection.

ENCORP's Certified Site Surveillance Technician and Lead Sampling Technician, Mr. Angel Jimenez (CSST No. 15-5431, LRC-00002763) completed the site inspections. Sampling was performed under the direction of Certified Asbestos Consultant and Lead Inspector/Assessor, Mr. Howard Baba (CAC No. 95-1791, LRC-00003404). Prior to sample collection, ENCORP's representative conducted a visual investigation of the property to identify and quantify all suspect asbestos containing and lead painted building materials. Upon completion of the visual investigation, building materials were grouped into homogeneous categories and samples were collected from the suspect ACM's previously identified.

SAMPLING METHODOLOGY – ASBESTOS

ENCORP used a modified random sampling protocol to collect the samples of the suspect ACM's. Each of the suspect samples collected for this report were given a unique sample identification number and sealed inside leak proof containers for shipment to the laboratory for analysis.

Asbestos bulk samples collected during this inspection were analyzed by ENCORP Environmental Laboratory. ENCORP Environmental Laboratory is accredited by NIST/NVLAP for analysis of asbestos fibers in bulk. PLM Bulk samples were analyzed by Polarized Light Microscopy (PLM)/Dispersion Staining (EPA/600/R-93/116). ENCORP NVLAP Lab Code 200878-0, 16700 Valley View Ave, Suite 100, La Mirada, CA 90638, 714-523-9811.

Because fibers with a diameter less than one micron will not be seen using PLM, a possibility exists that the asbestos content of materials with low asbestos percentages (such as floor tiles and soils) could actually be higher when analyzed by TEM, SEM, or X-ray diffraction.

INSPECTION RESULTS -- ASBESTOS

The following contains the summary of the suspect asbestos containing materials sampled during this inspection, including the location and laboratory analysis. Positive ACM's are distinguished in "**bold**". Samples collected and found not to contain asbestos are classified as being None Detected "ND". The complete sampling results can be found in the attachment section of this report.

SUMMARY OF SUSPECT MATERIALS TESTED						
Sample No.	Building Component	Location of Material	Condition	Friability	Estimated Quantity	% and type of Asbestos
1 2 3	6" Black Cove Base / Mastic / Glue	Building B Media Center/Library Throughout Interior	G	NF	180 sq ft	Cove base = ND Mastic = <0.1% Tremolite by 1000 point count analysis
4 5 6	Carpet Glue	Building B Media Center/Library Throughout Interior	G	NF	4000 sq ft	ND
7 8 9	Carpet Mastic	Building B Media Center/Library Interior Sporadic Under Carpet	G	NF	1500 sq ft	
10 11 12	Vinyl Floor Tile / Mastic	Building B Media Center/Library Interior Sporadic Under Carpet	G	NF	500 sq ft	Tile = ND Mastic = ND
13 14 15	Leveling Compound	Building B Media Center/Library Interior Sporadic Under Carpet	G	NF	200 sq ft	ND
16 17 18	Walk-On Mat Adhesive	Building B Media Center/Library Interior Entryways	G	NF	100 sq ft	ND
19 20 21	12"x12" Grey Floor Tile / Mastic	Building B Media Center/Library Conference/Storage Room	G	NF	300 sq ft	Tile = ND Mastic = ND
22 23 24	Carpet Pad / Adhesive	Building B Media Center/Library Below Older Perimeter Carpet	G	NF	60 sq ft	Pad = ND Adhesive = ND
25 26 27	Wall Panel Insulation	Building B Media Center/Library Wall Partitions	G	F	1600 sq ft	ND
28 29 30	Ceiling Panel Insulation	Building B Media Center/Library Throughout Interior	G	F	4000 sq ft	ND
31 32 33	Ceiling Space Roofing Debris	Building B Media Center/Library Above Suspended Ceiling	G	F	2000 sq ft	ND
34 35 36	Pipe Run Insulation	Building B Media Center/Library Above Suspended Ceiling	G	F	60 sq ft	ND
37 38 39	HVAC Insulation	Building B Media Center/Library Above Suspended Ceiling	G	F	40 sq ft	ND
40 41 42	Steel Beam Caulking	Building B Media Center/Library Interior / Exterior	G	NF	120 sq ft	ND
43 44 45	Brick / Mortar	Building B Media Center/Library Interior / Exterior	G	NF	5000 sq ft	Brick = ND Mortar = ND
46 47 48 49 50	Stucco Overhang	Building B Media Center/Library Exterior	G	NF	3000 sq ft	Skim Coat = ND Stucco = ND
51 52 53	Overhang Panel Insulation	Building B Media Center/Library Exterior	G	F	1300 sq ft	ND

Conditions of materials are identified as follows: Good (G), Damaged (D), or Significantly Damaged (SD), Friable (F), Non-friable (NF).

The quantities listed are for budgetary purposes only. Contractors completing proposals for the removal of asbestos containing materials are responsible for verifying the location, quantity, degree of difficulty and necessity for removing the identified materials.

DISCUSSIONS AND RECOMMENDATIONS (ASBESTOS)

A trace amount (<0.1%) of asbestos was identified in the cove base adhesive of this scope of work.

Materials found to be below 0.1% require disturbance by asbestos trained personnel in accordance with CAL/OSHA 1529 and 5208. A notification for rule 1403 is not required and asbestos abatement license registration is also not required by the California Department of Occupational Safety and health (CAL DOSH). OSHA training requirements apply to all asbestos related work regardless of the asbestos content of impacted materials.

ENCORP also recommends that a California Certified Asbestos Consultant/Site Surveillance Technician oversee the project to ensure that proper methods are being utilized.

Additional asbestos-containing may be present at this site. Care should be taken when demolishing materials that will open wall cavities or sealed ceiling areas. Any additional suspect asbestos material encountered during demolition that is not shown in this report should be sampled and analyzed prior to disturbance. Asbestos containing materials (ACM) should be removed by a California trained and licensed abatement contractor in accordance with all governing regulations. If any additional known, assumed, or suspected asbestos-containing materials are discovered during renovation, remodeling or demolition activities, contact an environmental consultant to determine the proper course of action.

INSPECTION RESULTS -- LEAD (XRF Analysis)

The Niton XRF Spectrum Analyzer was utilized for the analysis of suspect lead-based painted materials. In this method of analysis, the material is exposed to X-Rays or other high-energy radiation (such as gamma rays), which causes lead to emit X-Rays with a characteristic frequency. The intensity of this radiation is measured by the instrument's detector and is then converted into a number that represents the amount of lead in the material per unit area, usually milligrams per square centimeter (mg/cm²).

The HUD and OSHA have set a lead level of 1.0 mg/cm² as being a regulated lead-containing material. All components with results of >0.7 mg/cm² are considered lead-based paint based on the location of the subject property in Los Angeles County, the "abatement" level" (threshold) setting of 0.7 mg/cm² was chosen for the inspection. Analytical sensitivity of the XRF measurement methodology reports positive lead-based content results at or above 0.7 mg/cm², presence of lead content result between 0.1 and 0.6 mg/cm², and results below the detection limit at less than 0.1 mg/cm². CAL/OSHA considers all lead surface levels to be of concern.

Listed below is a summary of the materials sampled. Items found positive for lead-based paint using XRF analyses at these buildings are highlighted in **BOLD RED**, along with the location and estimated quantity. A complete listing of all components tested can be found in Section IIB of this report. Results are reported as Below Level of Detection = BLD, Lead Containing Paint = LCP, **Lead-Based Paint = LBP.**

SUMMARY OF LEAD-CONTAINING COMPONENTS TESTED							
Sample No	Color	Substrate	Component	Location	Results	Mg/cm2	QTY
4	Tan	Stucco	Overhang Trim	Media Center Exterior	BLD	0.0	-
5	Tan	Stucco	Overhang Trim	Media Center Exterior	BLD	0.0	-
6	Tan	Metal	Overhang Panel	Media Center Exterior	BLD	0.0	-
7	Tan	Metal	Overhang Panel	Media Center Exterior	BLD	0.0	-
8	Red	Metal	Door	Media Center Exterior	BLD	0.0	-
9	Black	Metal	Door Frame	Media Center Exterior	BLD	0.0	-
10	Black	Metal	Window Frame	Media Center Exterior	BLD	0.0	-
11	Red	Metal	Window Panel	Media Center Exterior	BLD	0.0	-
12	Red	Metal	Door	Media Center Interior	BLD	0.0	-
13	Black	Metal	Door Frame	Media Center Interior	BLD	0.0	-
14	White	Metal	Wall Panel	Media Center Interior	BLD	0.0	-
15	White	Metal	Wall Panel	Media Center Interior	BLD	0.0	-
16	White	Metal	Wall Panel	Media Center Interior	BLD	0.0	-
17	White	Metal	Wall Panel	Media Center Interior	BLD	0.0	-
18	Black	Steel	Beam	Media Center Interior	BLD	0.0	-
19	White	Wood	Door	Media Center Interior	BLD	0.0	-
20	Black	Metal	Door Frame	Media Center Interior	BLD	0.0	-
21	Tan	Metal	Wall Panel	Media Center Interior	BLD	0.0	-
22	Grey	Wood	Door	Media Center Interior	BLD	0.0	-
23	Red	Brick	Wall	Media Center Interior	BLD	0.0	-
24	Red	Brick	Wall	Media Center Interior	BLD	0.0	-
25	Red	Brick	Wall	Media Center Exterior	BLD	0.0	-
26	Red	Brick	Wall	Media Center Exterior	BLD	0.0	-

Note: The quantities listed are for budgetary purposes only. Contractors completing proposals for the removal of lead containing materials are responsible for verifying the location, quantity, degree of difficulty and necessity for removing the identified materials. Results are reported as Below Level of Detection = BLD, Lead Containing Paint = LCP, Lead-Based Paint = LBP.

DISCUSSIONS AND RECOMMENDATIONS (LEAD)

Lead-Based Paint was NOT identified in this scope of work.

All components with results of ≥ 0.7 mg/cm² are considered lead-based paint in Los Angeles County. A trained lead-based paint contractor should perform the paint film stabilization, loose and flaky paint, and any preparations of lead bearing levels of surfaces for repainting.

Minor disturbance to lead-based painted components such as coring or drilling can be performed by a certified trained contractor with a minimum OSHA Lead Awareness Operations and Maintenance Training, and EPA Lead Renovators (EPA Renovate, Repair and Painting Rule training). This work classification is used as an adequate alternative for trade work involving electrical, lighting, plumbing, painting and miscellaneous disturbances where work is likely to disturb lead containing components as part of construction activities other than lead abatement purposes.

Any material containing any detectable level of lead is subject to the OSHA's Lead Exposure in Construction Rule, 29 Code of Federal Regulation (CFR) 1926. All removal of lead-based painted (LBP) should be performed by a state-licensed contractor, using CDPH-certified workers with at least one CDPH-certified Supervisor.

CONCLUSION

A trace amount (<0.1%) of asbestos was identified in the cove base adhesive of this scope of work.

Materials found to be below 0.1% require disturbance by asbestos trained personnel in accordance with CAL/OSHA 1529 and 5208. A notification for rule 1403 is not required and asbestos abatement license registration is also not required by the California Department of Occupational Safety and health (CAL DOSH). OSHA training requirements apply to all asbestos related work regardless of the asbestos content of impacted materials.

ENCORP also recommends that a California Certified Asbestos Consultant/Site Surveillance Technician oversee the project to ensure that proper methods are being utilized. Sampling was limited to only areas and materials indicated as being impacted.

Any suspect asbestos material encountered during demolition that is not shown in this report should be sampled and analyzed prior to disturbance.

Lead-Based Paint was NOT identified in this scope of work.

All components with results of ≥ 0.7 mg/cm² are considered lead-based paint in Los Angeles County. A trained lead-based paint contractor should perform the paint film stabilization, loose and flaky paint, and any preparations of lead bearing levels of surfaces for renovation/repair/repainting.

Minor disturbance to lead-based painted components such as coring or drilling can be performed by a certified trained contractor with a minimum OSHA Lead Awareness Operations and Maintenance Training, and EPA Lead Renovators (EPA Renovate, Repair and Painting Rule training). This work classification is used as an adequate alternative for trade work involving electrical, lighting, plumbing, painting and miscellaneous disturbances where work is likely to disturb lead containing components as part of construction activities other than lead abatement purposes.

Any material containing any detectable level of lead is subject to the OSHA's Lead Exposure in Construction Rule, 29 Code of Federal Regulation (CFR) 1926. All removal of lead-based painted (LBP) should be performed by a state-licensed contractor, using CDPH-certified workers with at least one CDPH-certified Supervisor.

Additional asbestos-containing and lead-based painted materials may be present at this site. Care should be taken when demolishing materials that will open wall cavities or sealed ceiling areas. If any additional known, assumed, or suspected asbestos-containing materials or lead-based painted components are discovered during renovation, remodeling or demolition activities, contact an environmental consultant to determine the proper course of action.

Should you have any questions concerning this report, please contact me at (714) 523-9811. Thank you.

Respectfully submitted,



Howard Baba
Operations Manager, ENCORP
Certified Asbestos Consultant No. 95-1791
Lead Inspector/Risk Assessor No. LRC-00003404

II. SAMPLE ANALYSIS

IIA. SAMPLE ANALYSIS - ASBESTOS

Client Name: HACIENDA LA PUENTE Reference Batch Number: 064174 Project Number: P25033 · H21
 Client Address: 350 N. HACIENDA BLVD. Sampled Date: 1/21/2025 Date Received: 1/21/2025
 Facility Name: Wilson HS Media Center-Library Analyzed By: ANGEL JIMENEZ Date Analyzed: 1/31/2025
 Facility Address: 16455 Wedgeworth Drive
Hacienda Heights, CA 91745

LABORATORY TEST REPORT FOR BULK ASBESTOS FIBER ANALYSIS (PLM)

Sample Number	Field/ Client Number	SAMPLE DESCRIPTION			Friable or Non-	CVE Asbestos	Non Asbestos (%)
		Sample Location/Activity	Color	Material			
822931A	001A	BLDG. B - MEDIA CENTER INT.	BLACK	(HOMOGENEOUS) 6" BLACK COVE BASE	NF	NONE DETECTED	100% MATRIX
822931B	001B	BLDG. B - MEDIA CENTER INT.	BROWN	(HOMOGENEOUS) MASTIC	NF	<1% TREMOLITE	100% MATRIX
822931C	001C	BLDG. B - MEDIA CENTER INT.	BEIGE	(HOMOGENEOUS) GLUE	NF	NONE DETECTED	100% MATRIX
822931P	001P	BLDG. B - MEDIA CENTER INT.	BROWN	(HOMOGENEOUS) MASTIC	NF	<0.1%CHRYSYOTILE	99.9%MATRIX
822932A	002A	BLDG. B - MEDIA CENTER INT.	BLACK	(HOMOGENEOUS) 6" BLACK COVE BASE	NF	NONE DETECTED	100% MATRIX
822932B	002B	BLDG. B - MEDIA CENTER INT.	BROWN	(HOMOGENEOUS) MASTIC	NF	<1% TREMOLITE	100% MATRIX
822932C	002C	BLDG. B - MEDIA CENTER INT.	BEIGE	(HOMOGENEOUS) GLUE	NF	NONE DETECTED	100% MATRIX
822932P	002P	BLDG. B - MEDIA CENTER INT.	BROWN	(HOMOGENEOUS) MASTIC	NF	<0.1 TREMOLITE	99.9%MATRIX

-NOTES: ND=None Detected Asbestos is not quantifiable below the method detection limit of one (1) percent. Amphibole asbestos includes amosite, crocidolite, anthophyllite, tremolite and actinolite. (FR) = Friable, (NF) = Non-Friable. Condition of sample is as received by the laboratory. Our policy is to retain all samples for a period of thirty days. Accredited by the National Voluntary Laboratory Accreditation Program and Environmental Laboratory Certification for the specific scope of accreditation under NVLAP Lab Code 200878-0. This report applies only to the items as received. Results are representative of the samples submitted and may not represent the entire materials from which the samples were collected. This report is submitted for the exclusive use of the client to whom it is addressed. Any reproduction of this report or use of this Laboratory's name for advertising or publicity purposes without prior written authorization is prohibited. In addition, this report is not to be used to claim product endorsement by NVLAP, or any agency of the U.S. Government. Where applicable, layers or "sub-samples" are reported and the Total Asbestos % represents the composite percentage of all sample layers. These samples were quantified using a calibrated visual estimate. Bulk sample(s) submitted were analyzed in accordance with the procedures EPA 600/R-93/116: Method for the Determination of Asbestos in Bulk Building Materials, EPA - 40 CFR, Appendix E to Subpart E of Part 763, Interim Method of the Determination of Asbestos in Bulk Insulation Samples.

ENCORP ENVIRONMENTAL MANAGEMENT AND SERVICES

16700 VALLEY VIEW AVE. STE. 100 LA MIRADA, CALIFORNIA 90638
 714) 523-9811 · FAX (714) 523-9810 · MAIN@ENCORP.NET · WWW.ENCORP.NET

Client Name: HACIENDA LA PUENTE
 Client Address: 350 N. HACIENDA BLVD.
CITY OF INDUSTRY, CA 91716-0002
 Facility Name: Wilson HS Media Center-Library
 Facility Address: 16455 Wedgeworth Drive
Hacienda Heights, CA 91745

Reference Batch Number: 064174
 Sampled Date: 1/21/2025
 Sampled By: ANGEL JIMENEZ
 Analyzed By: KRISTINA MARTINEZ

Project Number: P25033 · H21
 Date Received: 1/21/2025
 Date Analyzed: 1/31/2025

LABORATORY TEST REPORT FOR BULK ASBESTOS FIBER ANALYSIS (PLM)

Sample Number	Field/ Client Number	SAMPLE DESCRIPTION			Friable or Non-	CVE Asbestos	Non Asbestos (%)
		Sample Location/Activity	Color	Material			
822933A	003A	BLDG. B - MEDIA CENTER INT.	BLACK	(HOMOGENEOUS) 6" BLACK COVE BASE	NF	NONE DETECTED	100% MATRIX
822933B	003B	BLDG. B - MEDIA CENTER INT.	BROWN	(HOMOGENEOUS) MASTIC	NF	<1% TREMOLITE	100% MATRIX
822933C	003C	BLDG. B - MEDIA CENTER INT.	BEIGE	(HOMOGENEOUS) GLUE	NF	NONE DETECTED	100% MATRIX
822933P	003P	BLDG. B - MEDIA CENTER INT.	BROWN	(HOMOGENEOUS) MASTIC	NF	<0.1% TREMOLITE	99.9% MATRIX
822934	004	BLDG. B - MEDIA CENTER INT.	BEIGE	(HOMOGENEOUS) CARPET GLUE	NF	NONE DETECTED	100% MATRIX
822935	005	BLDG. B - MEDIA CENTER INT.	BEIGE	(HOMOGENEOUS) CARPET GLUE	NF	NONE DETECTED	100% MATRIX
822936	006	BLDG. B - MEDIA CENTER INT.	BEIGE	(HOMOGENEOUS) CARPET GLUE	NF	NONE DETECTED	100% MATRIX
822937	007	BLDG. B - MEDIA CENTER INT.	BROWN	(HOMOGENEOUS) CARPET MASTIC	NF	NONE DETECTED	100% MATRIX

-NOTES: ND=None Detected Asbestos is not quantifiable below the method detection limit of one (1) percent. Amphibole asbestos includes amosite, crocidolite, anthophyllite, tremolite and actinolite. (FR) = Friable, (NF) = Non-Friable. Condition of sample is as received by the laboratory. Our policy is to retain all samples for a period of thirty days. Accredited by the National Voluntary Laboratory Accreditation Program and Environmental Laboratory Certification for the specific scope of accreditation under NVLAP Lab Code 200878-0. This report applies only to the items as received. Results are representative of the samples submitted and may not represent the entire materials from which the samples were collected. This report is submitted for the exclusive use of the client to whom it is addressed. Any reproduction of this report or use of this Laboratory's name for advertising or publicity purposes without prior written authorization is prohibited. In addition, this report is not to be used to claim product endorsement by NVLAP, or any agency of the U.S. Government. Where applicable, layers or "sub-samples" are reported and the Total Asbestos % represents the composite percentage of all sample layers. These samples were quantified using a calibrated visual estimate. Bulk sample(s) submitted were analyzed in accordance with the procedures EPA 600/R-93/116: Method for the Determination of Asbestos in Bulk Building Materials, EPA - 40 CFR Appendix E to Subpart E of Part 763, Interim Method of the Determination of Asbestos in Bulk Insulation Samples.

Client Name: HACIENDA LA PUENTE
Client Address: 350 N. HACIENDA BLVD.
CITY OF INDUSTRY, CA 91716-0002
Facility Name: Wilson HS Media Center-Library
Facility Address: 16455 Wedgeworth Drive
Hacienda Heights, CA 91745

Reference Batch Number: 064174 **Project Number:** P25033 **H21**
Sampled Date: 1/21/2025 **Date Received:** 1/21/2025
Sampled By: ANGEL JIMENEZ **Date Analyzed:** 1/31/2025
Analyzed By: KRISTINA MARTINEZ

LABORATORY TEST REPORT FOR BULK ASBESTOS FIBER ANALYSIS (PLM)

Sample Number	Field/ Client Number	SAMPLE DESCRIPTION		Friable or Non-	CVE Asbestos	Non Asbestos (%)
		Sample Location/Activity	Color			
822938	008	BLDG. B - MEDIA CENTER INT.	BROWN	(HOMOGENEOUS) CARPET MASTIC	NF	NONE DETECTED 100% MATRIX
822939	009	BLDG. B - MEDIA CENTER INT.	BROWN	(HOMOGENEOUS) CARPET MASTIC	NF	NONE DETECTED 100% MATRIX
822940A	010A	BLDG. B - MEDIA CENTER INT.	WHITE	(HOMOGENEOUS) VINYL FLOOR TILE	NF	NONE DETECTED 100% MATRIX
822940B	010B	BLDG. B - MEDIA CENTER INT.	BLACK	(HOMOGENEOUS) MASTIC	NF	NONE DETECTED 100% MATRIX
822941A	011A	BLDG. B - MEDIA CENTER INT.	WHITE	(HOMOGENEOUS) VINYL FLOOR TILE	NF	NONE DETECTED 100% MATRIX
822941B	011B	BLDG. B - MEDIA CENTER INT.	BLACK	(HOMOGENEOUS) MASTIC	NF	NONE DETECTED 100% MATRIX
822942A	012A	BLDG. B - MEDIA CENTER INT.	WHITE	(HOMOGENEOUS) VINYL FLOOR TILE	NF	NONE DETECTED 100% MATRIX
822942B	012B	BLDG. B - MEDIA CENTER INT.	BLACK	(HOMOGENEOUS) MASTIC	NF	NONE DETECTED 100% MATRIX

-NOTES: ND=None Detected Asbestos is not quantifiable below the method detection limit of one (1) percent. Amphibole asbestos includes amosite, crocidolite, anthophyllite, tremolite and actinolite. (FR) = Friable, (NF) = Non-Friable. Condition of sample is as received by the laboratory. Our policy is to retain all samples for a period of thirty days. Accredited by the National Voluntary Laboratory Accreditation Program and Environmental Laboratory Certification for the specific scope of accreditation under NVLAP Lab Code 200879-0. This report applies only to the items as received. Results are representative of the samples submitted and may not represent the entire materials from which the samples were collected. This report is submitted for the exclusive use of the client to whom it is addressed. Any reproduction of this report or use of this Laboratory's name for advertising or publicity purposes without prior written authorization is prohibited. In addition, this report is not to be used to claim product endorsement by NVLAP, or any agency of the U.S. Government. Where applicable, layers or "sub-samples" are reported and the Total Asbestos % represents the composite percentage of all sample layers. These samples were quantified using a calibrated visual estimate. Bulk sample(s) submitted were quantified in accordance with the procedures EPA 600/R-93/116: Method for the Determination of Asbestos in Bulk Building Materials, EPA - 40 CFR Appendix E to Subpart E of Part 763, Interim Method of the Determination of Asbestos in Bulk Insulation Samples.

ENCORP ENVIRONMENTAL MANAGEMENT AND SERVICES

16700 VALLEY VIEW AVE. STE. 100 LA MIRADA, CALIFORNIA 90638
 714) 523-9811 · FAX (714) 523-9810 · MAIN@ENCORP.NET · WWW.ENCORP.NET

Client Name: HACIENDA LA PUENTE
 Client Address: 350 N. HACIENDA BLVD.
CITY OF INDUSTRY, CA 91716-0002
 Facility Name: Wilson HS Media Center-Library
 Facility Address: 16455 Wedgeworth Drive
Hacienda Heights, CA 91745

Reference Batch Number: 064174
 Sampled Date: 1/21/2025
 Sampled By: ANGEL JIMENEZ
 Analyzed By: KRISTINA MARTINEZ

Project Number: P25033 · H21
 Date Received: 1/21/2025
 Date Analyzed: 1/31/2025

LABORATORY TEST REPORT FOR BULK ASBESTOS FIBER ANALYSIS (PLM)

Sample Number	Field/ Client Number	SAMPLE DESCRIPTION		Friable or Non-	CVE Asbestos	Non Asbestos (%)
		Sample Location/Activity	Color			
822943	013	BLDG. B - MEDIA CENTER INT.	YELLOW	(HOMOGENEOUS) LEVELING COMPOUND	NF	NONE DETECTED 100% MATRIX
822944	014	BLDG. B - MEDIA CENTER INT.	YELLOW	(HOMOGENEOUS) LEVELING COMPOUND	NF	NONE DETECTED 100% MATRIX
822945	015	BLDG. B - MEDIA CENTER INT.	YELLOW	(HOMOGENEOUS) LEVELING COMPOUND	NF	NONE DETECTED 100% MATRIX
822946	016	BLDG. B - MEDIA CENTER INT.	YELLOW	(HOMOGENEOUS) WALK ON MAT ADHESIVE	NF	NONE DETECTED 100% MATRIX
822947	017	BLDG. B - MEDIA CENTER INT.	YELLOW	(HOMOGENEOUS) WALK ON MAT ADHESIVE	NF	NONE DETECTED 100% MATRIX
822948	018	BLDG. B - MEDIA CENTER INT.	YELLOW	(HOMOGENEOUS) WALK ON MAT ADHESIVE	NF	NONE DETECTED 100% MATRIX
822949A	019A	BLDG. B - MEDIA CENTER INT.	GRAY	(HOMOGENEOUS) 12X12 GRAY VFT	NF	NONE DETECTED 100% MATRIX
822949B	019B	BLDG. B - MEDIA CENTER INT.	BLACK	(HOMOGENEOUS) MASTIC	NF	NONE DETECTED 100% MATRIX

-NOTES: ND=None Detected Asbestos is not quantifiable below the method detection limit of one (1) percent. Amphibole asbestos includes amosite, crocidolite, anthophyllite, tremolite and actinolite. (FR) = Friable, (NF) = Non-Friable. Condition of sample is as received by the laboratory. Our policy is to retain all samples for a period of thirty days. Accredited by the National Voluntary Laboratory Accreditation Program and Environmental Laboratory Certification for the specific scope of accreditation under NVLAP Lab Code 200878-0. This report applies only to the items as received. Results are representative of the samples submitted and may not represent the entire materials from which the samples were collected. This report is submitted for the exclusive use of the client to whom it is addressed. Any reproduction of this report or use of this Laboratory's name for advertising or publicity purposes without prior written authorization is prohibited. In addition, this report is not to be used to claim product endorsement by NVLAP, or any agency of the U.S. Government. Where applicable, layers or "sub-samples" are reported and the Total Asbestos % represents the composite percentage of all sample layers. These samples were quantified using a calibrated visual estimate. Bulk sample(s) submitted were analyzed in accordance with the procedures EPA 600/R-93/116: Method for the Determination of Asbestos in Bulk Building Materials, EPA - 40 CFR Appendix E to Subpart E of Part 763, Interim Method of the Determination of Asbestos in Bulk Insulation Samples.

ENCORP ENVIRONMENTAL MANAGEMENT AND SERVICES

16700 VALLEY VIEW AVE. STE. 100 LA MIRADA, CALIFORNIA 90638
 714) 523-9811 · FAX (714) 523-9810 · MAIN@ENCORP.NET · WWW.ENCORP.NET

Client Name: HACIENDA LA PUENTE
 Client Address: 350 N. HACIENDA BLVD.
CITY OF INDUSTRY, CA 91716-0002
 Facility Name: Wilson HS Media Center-Library
 Facility Address: 16455 Wedgeworth Drive
Hacienda Heights, CA 91745

Reference Batch Number: 064174
 Sampled Date: 1/21/2025
 Sampled By: ANGEL JIMENEZ
 Analyzed By: KRISTINA MARTINEZ

Project Number: F25033 · H21
 Date Received: 1/21/2025
 Date Analyzed: 1/31/2025

LABORATORY TEST REPORT FOR BULK ASBESTOS FIBER ANALYSIS (PLM)

Sample Number	Field/ Client Number	SAMPLE DESCRIPTION		Color	Friable or Non-	CVE Asbestos	Non Asbestos (%)
		Sample Location/Activity	Material				
822950A	020A	BLDG. B - MEDIA CENTER INT.	(HOMOGENEOUS) 12X12 GRAY VFT	GRAY	NF	NONE DETECTED	100% MATRIX
822950B	020B	BLDG. B - MEDIA CENTER INT.	(HOMOGENEOUS) MASTIC	BLACK	NF	NONE DETECTED	100% MATRIX
822951A	021A	BLDG. B - MEDIA CENTER INT.	(HOMOGENEOUS) 12X12 GRAY VFT	GRAY	NF	NONE DETECTED	100% MATRIX
822951B	021B	BLDG. B - MEDIA CENTER INT.	(HOMOGENEOUS) MASTIC	BLACK	NF	NONE DETECTED	100% MATRIX
822952A	022A	BLDG. B - MEDIA CENTER INT.	(FIBROUS) CARPET PAD	BROWN	NF	NONE DETECTED	95% SYNTHETIC FIBER 5% MATRIX
822952B	022B	BLDG. B - MEDIA CENTER INT.	(HOMOGENEOUS) ADHESIVE	BEIGE	NF	NONE DETECTED	100% MATRIX
822953A	023A	BLDG. B - MEDIA CENTER INT.	(FIBROUS) CARPET PAD	BROWN	NF	NONE DETECTED	95% SYNTHETIC FIBER 5% MATRIX
822953B	023B	BLDG. B - MEDIA CENTER INT.	(HOMOGENEOUS) ADHESIVE	BEIGE	NF	NONE DETECTED	100% MATRIX

-NOTES: ND=None Detected Asbestos is not quantifiable below the method detection limit of one (1) percent. Amphibole asbestos includes amosite, crocidolite, anthophyllite, tremolite and actinolite. (FR) = Friable, (NF) = Non-Friable. Condition of sample is as received by the laboratory. Our policy is to retain all samples for a period of thirty days. Accredited by the National Voluntary Laboratory Accreditation Program and Environmental Laboratory Certification for the specific scope of accreditation under NVLAP Lab Code 200878-0. This report applies only to the items as received. Results are representative of the samples submitted and may not represent the entire materials from which the samples were collected. This report is submitted for the exclusive use of the client to whom it is addressed. Any reproduction of this report or use of this Laboratory's name for advertising or publicity purposes without prior written authorization is prohibited. In addition, this report is not to be used to claim product endorsement by NVLAP, or any agency of the U.S. Government. Where applicable, layers or "sub-samples" are reported and the Total Asbestos % represents the composite percentage of all sample layers. These samples were quantified using a calibrated visual estimate. Bulk sample(s) submitted were analyzed in accordance with the procedures EPA 600/R-93/116; Method for the Determination of Asbestos in Bulk Building Materials, EPA - 40 CFR Appendix E to Subpart E of Part 763, Interim Method of the Determination of Asbestos in Bulk Insulation Samples.

ENCORP ENVIRONMENTAL MANAGEMENT AND SERVICES

16700 VALLEY VIEW AVE. STE. 100 LA MIRADA, CALIFORNIA 90638
 714) 523-9811 · FAX (714) 523-9810 · MAIN@ENCORP.NET · WWW.ENCORP.NET

Client Name: HACIENDA LA PUENTE
 Client Address: 350 N. HACIENDA BLVD.
CITY OF INDUSTRY, CA 91716-0002
 Facility Name: Wilson HS Media Center-Library
 Facility Address: 16455 Wedgeworth Drive
Hacienda Heights, CA 91745

Reference Batch Number: 064174
 Sampled Date: 1/21/2025
 Sampled By: ANGEL JIMENEZ
 Analyzed By: KRISTINA MARTINEZ

Project Number: P25033 · H21
 Date Received: 1/21/2025
 Date Analyzed: 1/31/2025

LABORATORY TEST REPORT FOR BULK ASBESTOS FIBER ANALYSIS (PLM)

Sample Number	Field/ Client Number	SAMPLE DESCRIPTION		Friable or Non-	CVE Asbestos	Non Asbestos (%)
		Sample Location/Activity	Material			
822954A	024A	BLDG. B - MEDIA CENTER INT.	(FIBROUS) CARPET PAD	NF	NONE DETECTED	95% SYNTHETIC FIBER 5% MATRIX
822954B	024B	BLDG. B - MEDIA CENTER INT.	(HOMOGENEOUS) ADHESIVE	NF	NONE DETECTED	100% MATRIX
822955	025	BLDG. B - MEDIA CENTER INT.	(FIBROUS) WALL PANEL INSULATION	FR	NONE DETECTED	2% CELLULOSE 98% MATRIX
822956	026	BLDG. B - MEDIA CENTER INT.	(FIBROUS) WALL PANEL INSULATION	FR	NONE DETECTED	2% CELLULOSE 98% MATRIX
822957	027	BLDG. B - MEDIA CENTER INT.	(FIBROUS) WALL PANEL INSULATION	FR	NONE DETECTED	2% CELLULOSE 98% MATRIX
822958	028	BLDG. B - MEDIA CENTER INT.	(FIBROUS) CEILING PANEL INSULATION	FR	NONE DETECTED	25% CELLULOSE 65% FIBROUS GLASS 10% MATRIX
822959	029	BLDG. B - MEDIA CENTER INT.	(FIBROUS) CEILING PANEL INSULATION	FR	NONE DETECTED	25% CELLULOSE 65% FIBROUS GLASS 10% MATRIX
822960	030	BLDG. B - MEDIA CENTER INT.	(FIBROUS) CEILING PANEL INSULATION	FR	NONE DETECTED	25% CELLULOSE 65% FIBROUS GLASS 10% MATRIX

-NOTES: ND=None Detected Asbestos is not quantifiable below the method detection limit of one (1) percent. Amphibole asbestos includes amosite, crocidolite, anthophyllite, tremolite and actinolite. (FR) = Friable, (NF) = Non-Friable. Condition of sample is as received by the laboratory. Our policy is to retain all samples for a period of thirty days. Accredited by the National Voluntary Laboratory Accreditation Program and Environmental Laboratory Certification for the specific scope of accreditation under NVLAP Lab Code 200878-0. This report applies only to the items as received. Results are representative of the samples submitted and may not represent the entire materials from which the samples were collected. This report is submitted for the exclusive use of the client to whom it is addressed. Any reproduction of this report or use of this Laboratory's name for advertising or publicity purposes without prior written authorization is prohibited. In addition, this report is not to be used to claim product endorsement by NVLAP, or any agency of the U.S. Government. Where applicable, layers or "sub-samples" are reported and the Total Asbestos % represents the composite percentage of all sample layers. These samples were quantified using a calibrated visual estimate. Bulk sample(s) submitted were analyzed in accordance with the procedures EPA 600/R-93/116: Method for the Determination of Asbestos in Bulk Building Materials, EPA - 40 CFR Appendix E to Subpart E of Part 763, Interim Method of the Determination of Asbestos in Bulk Insulation Samples.

ENCORP ENVIRONMENTAL MANAGEMENT AND SERVICES

16700 VALLEY VIEW AVE. STE. 100 LA MIRADA, CALIFORNIA 90638
 714) 523-9811 · FAX (714) 523-9810 · MAIN@ENCORP.NET · WWW.ENCORP.NET

Client Name: HACIENDA LA PUENTE
 Client Address: 350 N. HACIENDA BLVD.
CITY OF INDUSTRY, CA 91716-0002
 Facility Name: Wilson HS Media Center-Library
 Facility Address: 16455 Wedgeworth Drive
Hacienda Heights, CA 91745

Reference Batch Number: 064174
 Sampled Date: 1/21/2025
 Sampled By: ANGEL JIMENEZ
 Analyzed By: KRISTINA MARTINEZ

Project Number: P25033 · H21
 Date Received: 1/21/2025
 Date Analyzed: 1/31/2025

LABORATORY TEST REPORT FOR BULK ASBESTOS FIBER ANALYSIS (PLM)

Sample Number	Field/ Client Number	SAMPLE DESCRIPTION			Friable or Non-	CVE Asbestos	Non Asbestos (%)
		Sample Location/Activity	Color	Material			
822961A	031A	BLDG. B - MEDIA CENTER INT.	BLACK	(FIBROUS) CEILING SPACE ROOFING DEBRIS	NF	NONE DETECTED	10% FIBROUS GLASS 90% MATRIX
822961B	031B	BLDG. B - MEDIA CENTER INT.	BLACK	(HOMOGENEOUS) MASTIC	NF	NONE DETECTED	100% MATRIX
822961C	031C	BLDG. B - MEDIA CENTER INT.	BROWN	(FIBROUS) INSULATION	FR	NONE DETECTED	75% CELLULOSE 25% MATRIX
822961D	031D	BLDG. B - MEDIA CENTER INT.	YELLOW	(HOMOGENEOUS) FOAM	NF	NONE DETECTED	100% MATRIX
822962A	032A	BLDG. B - MEDIA CENTER INT.	BLACK	(FIBROUS) CEILING SPACE ROOFING DEBRIS	NF	NONE DETECTED	10% FIBROUS GLASS 90% MATRIX
822962B	032B	BLDG. B - MEDIA CENTER INT.	BLACK	(HOMOGENEOUS) MASTIC	NF	NONE DETECTED	100% MATRIX
822962C	032C	BLDG. B - MEDIA CENTER INT.	BROWN	(FIBROUS) INSULATION	FR	NONE DETECTED	75% CELLULOSE 25% MATRIX
822962D	032D	BLDG. B - MEDIA CENTER INT.	YELLOW	(HOMOGENEOUS) FOAM	NF	NONE DETECTED	100% MATRIX

-NOTES: ND=None Detected Asbestos is not quantifiable below the method detection limit of one (1) percent. Amphibole asbestos includes amosite, crocidolite, anthophyllite, tremolite and actinolite. (FR) = Friable, (NF) = Non-Friable. Condition of sample is as received by the laboratory. Our policy is to retain all samples for a period of thirty days. Accredited by the National Voluntary Laboratory Accreditation Program and Environmental Laboratory Certification for the specific scope of accreditation under NVLAP Lab Code 200878-0. This report applies only to the items as received. Results are representative of the samples submitted and may not represent the entire materials from which the samples were collected. This report is submitted for the exclusive use of the client to whom it is addressed. Any reproduction of this report or use of this Laboratory's name for advertising or publicity purposes without prior written authorization is prohibited. In addition, this report is not to be used to claim product endorsement by NVLAP, or any agency of the U.S. Government. Where applicable, layers or "sub-samples" are reported and the Total Asbestos % represents the composite percentage of all sample layers. These samples were quantified using a calibrated visual estimate. Bulk sample(s) submitted were analyzed in accordance with the procedures EPA 600/R-93/116: Method for the Determination of Asbestos in Bulk Building Materials, EPA - 40 CFR Appendix E to Subpart E of Part 763, Interim Method of the Determination of Asbestos in Bulk Insulation Samples.

ENCORP ENVIRONMENTAL MANAGEMENT AND SERVICES

16700 VALLEY VIEW AVE. STE. 100 LA MIRADA, CALIFORNIA 90638
 714) 523-9811 · FAX (714) 523-9810 · MAIN@ENCORP.NET · WWW.ENCORP.NET

Client Name: HACIENDA LA PUENTE
Client Address: 350 N. HACIENDA BLVD.
 CITY OF INDUSTRY, CA 91716-0002
Facility Name: Wilson HS Media Center-Library
Facility Address: 16455 Wedgeworth Drive
 Hacienda Heights, CA 91745

Reference Batch Number: 064174
Sampled Date: 1/21/2025
Sampled By: ANGEL JIMENEZ
Analyzed By: KRISTINA MARTINEZ

Project Number: P25033 · H21
Date Received: 1/21/2025
Date Analyzed: 1/31/2025

LABORATORY TEST REPORT FOR BULK ASBESTOS FIBER ANALYSIS (PLM)

Sample Number	Field/ Client Number	SAMPLE DESCRIPTION		Friable or Non-	CVE Asbestos	Non Asbestos (%)
		Sample Location/Activity	Color			
822963A	033A	BLDG. B - MEDIA CENTER INT.	BLACK	(FIBROUS) CEILING SPACE ROOFING DEBRIS	NF	NONE DETECTED 10% FIBROUS GLASS 90% MATRIX
822963B	033B	BLDG. B - MEDIA CENTER INT.	BLACK	(HOMOGENEOUS) MASTIC	NF	NONE DETECTED 100% MATRIX
822963C	033C	BLDG. B - MEDIA CENTER INT.	BROWN	(FIBROUS) INSULATION	FR	NONE DETECTED 75% CELLULOSE 25% MATRIX
822963D	033D	BLDG. B - MEDIA CENTER INT.	YELLOW	(HOMOGENEOUS) FOAM	NF	NONE DETECTED 100% MATRIX
822964	034	BLDG. B - MEDIA CENTER INT.	YELLOW/BROWN	(FIBROUS) PIPE RUN INSULATION	NF	NONE DETECTED 30% CELLULOSE 65% FIBROUS GLASS 5% MATRIX
822965	035	BLDG. B - MEDIA CENTER INT.	YELLOW/BROWN	(FIBROUS) PIPE RUN INSULATION	NF	NONE DETECTED 30% CELLULOSE 65% FIBROUS GLASS 5% MATRIX
822966	036	BLDG. B - MEDIA CENTER INT.	YELLOW/BROWN	(FIBROUS) PIPE RUN INSULATION	NF	NONE DETECTED 30% CELLULOSE 65% FIBROUS GLASS 5% MATRIX
822967	037	BLDG. B - MEDIA CENTER INT.	BROWN	(FIBROUS) HVAC INSULATION	FR	NONE DETECTED 100% FIBROUS GLASS

-NOTES: ND=None Detected Asbestos is not quantifiable below the method detection limit of one (1) percent. Amphibole asbestos includes amosite, crocidolite, anthophyllite, tremolite and actinolite. (FR) = Friable, (NF) = Non-Friable. Condition of sample is as received by the laboratory. Our policy is to retain all samples for a period of thirty days. Accredited by the National Voluntary Laboratory Accreditation Program and Environmental Laboratory Certification for the specific scope of accreditation under NVLAP Lab Code 200878-0. This report applies only to the items as received. Results are representative of the samples submitted and may not represent the entire materials from which the samples were collected. This report is submitted for the exclusive use of the client to whom it is addressed. Any reproduction of this report or use of this Laboratory's name for advertising or publicity purposes without prior written authorization is prohibited. In addition, this report is not to be used to claim product endorsement by NVLAP, or any agency of the U.S. Government. Where applicable, layers or "sub-samples" are reported and the Total Asbestos % represents the composite percentage of all sample layers. These samples were quantified using a calibrated visual estimate. Bulk sample(s) submitted were analyzed in accordance with the procedures EPA 600/R-93/116: Method for the Determination of Asbestos in Bulk Building Materials, EPA - 40 CFR Appendix E to Subpart E of Part 763, Interim Method of the Determination of Asbestos in Bulk Insulation Samples.

ENCORP ENVIRONMENTAL MANAGEMENT AND SERVICES

16700 VALLEY VIEW AVE. STE. 100 LA MIRADA, CALIFORNIA 90638
 714) 523-9811 · FAX (714) 523-9810 · MAIN@ENCORP.NET · WWW.ENCORP.NET

Client Name: HACIENDA LA PUENTE
 Client Address: 350 N. HACIENDA BLVD.
CITY OF INDUSTRY, CA 91716-0002
 Facility Name: Wilson HS Media Center-Library
 Facility Address: 16455 Wedgeworth Drive
Hacienda Heights, CA 91745

Reference Batch Number: 064174
 Sampled Date: 1/21/2025
 Sampled By: ANGEL JIMENEZ
 Analyzed By: KRISTINA MARTINEZ

Project Number: P25033 · H21
 Date Received: 1/21/2025
 Date Analyzed: 1/31/2025

LABORATORY TEST REPORT FOR BULK ASBESTOS FIBER ANALYSIS (PLM)

Sample Number	Field/ Client Number	SAMPLE DESCRIPTION		Friable or Non-	CVE Asbestos	Non Asbestos (%)
		Sample Location/Activity	Color			
822968	038	BLDG. B - MEDIA CENTER INT.	BROWN	(FIBROUS) HVAC INSULATION	FR	NONE DETECTED 100% FIBROUS GLASS
822969	039	BLDG. B - MEDIA CENTER INT.	BROWN	(FIBROUS) HVAC INSULATION	FR	NONE DETECTED 100% FIBROUS GLASS
822970	040	BLDG. B - MEDIA CENTER INT.	GRAY	(HOMOGENEOUS) STEEL BEM CAULKING	NF	NONE DETECTED 100% MATRIX
822971	041	BLDG. B - MEDIA CENTER INT.	GRAY	(HOMOGENEOUS) STEEL BEM CAULKING	NF	NONE DETECTED 100% MATRIX
822972	042	BLDG. B - MEDIA CENTER EXT	GRAY	(HOMOGENEOUS) STEEL BEM CAULKING	NF	NONE DETECTED 100% MATRIX
822973A	043A	BLDG. B - MEDIA CENTER EXT	RED	(HOMOGENEOUS) BRICK	NF	NONE DETECTED 100% MATRIX
822973B	043B	BLDG. B - MEDIA CENTER EXT	GRAY	(HOMOGENEOUS) MORTAR	NF	NONE DETECTED 100% MATRIX
822974A	044A	BLDG. B - MEDIA CENTER EXT	RED	(HOMOGENEOUS) BRICK	NF	NONE DETECTED 100% MATRIX

-NOTES: ND=None Detected Asbestos is not quantifiable below the method detection limit of one (1) percent. Amphibole asbestos includes amosite, crocidolite, anthophyllite, tremolite and actinolite. (FR) = Friable, (NF) = Non-Friable. Condition of sample is as received by the laboratory. Our policy is to retain all samples for a period of thirty days. Accredited by the National Voluntary Laboratory Accreditation Program and Environmental Laboratory Certification for the specific scope of accreditation under NVLAP Lab Code 200878-0. This report applies only to the items as received. Results are representative of the samples submitted and may not represent the entire materials from which the samples were collected. This report is submitted for the exclusive use of the client to whom it is addressed. Any reproduction of this report or use of this Laboratory's name for advertising or publicity purposes without prior written authorization is prohibited. In addition, this report is not to be used to claim product endorsement by NVLAP, or any agency of the U.S. Government. Where applicable, layers or "sub-samples" are reported and the Total Asbestos % represents the composite percentage of all sample layers. These samples were quantified using a calibrated visual estimate. Bulk sample(s) submitted in accordance with the procedures EPA 600/R-93/116: Method for the Determination of Asbestos in Bulk Building Materials, EPA - 40 CFR Appendix E to Subpart E of Part 763, Interim Method of the Determination of Asbestos in Bulk Insulation Samples.

ENCORP ENVIRONMENTAL MANAGEMENT AND SERVICES

16700 VALLEY VIEW AVE. STE. 100 LA MIRADA, CALIFORNIA 90638
 714) 523-9811 · FAX (714) 523-9810 · MAIN@ENCORP.NET · WWW.ENCORP.NET

Client Name: HACIENDA LA PUENTE
 Client Address: 350 N. HACIENDA BLVD.
CITY OF INDUSTRY, CA 91716-0002
 Facility Name: Wilson HS Media Center-Library
 Facility Address: 16455 Wedgeworth Drive
Hacienda Heights, CA 91745

Reference Batch Number: 064174
 Sampled Date: 1/21/2025
 Sampled By: ANGEL JIMENEZ
 Analyzed By: KRISTINA MARTINEZ

Project Number: P25033 · H21
 Date Received: 1/21/2025
 Date Analyzed: 1/31/2025

LABORATORY TEST REPORT FOR BULK ASBESTOS FIBER ANALYSIS (PLM)

Sample Number	Field/ Client Number	SAMPLE DESCRIPTION			Friable or Non-	CVE Asbestos	Non Asbestos (%)
		Sample Location/Activity	Color	Material			
822974B	044B	BLDG. B - MEDIA CENTER EXT	GRAY	(HOMOGENEOUS) MORTAR	NF	NONE DETECTED	100% MATRIX
822975A	045A	BLDG. B - MEDIA CENTER EXT	RED	(HOMOGENEOUS) BRICK	NF	NONE DETECTED	100% MATRIX
822975B	045B	BLDG. B - MEDIA CENTER EXT	GRAY	(HOMOGENEOUS) MORTAR	NF	NONE DETECTED	100% MATRIX
822976A	046A	BLDG. B - MEDIA CENTER EXT	BEIGE	(HOMOGENEOUS) SKIM COAT	NF	NONE DETECTED	100% MATRIX
822976B	046B	BLDG. B - MEDIA CENTER EXT	GRAY	(HOMOGENEOUS) STUCCO OVERHANG	NF	NONE DETECTED	100% MATRIX
822977A	047A	BLDG. B - MEDIA CENTER EXT	BEIGE	(HOMOGENEOUS) SKIM COAT	NF	NONE DETECTED	100% MATRIX
822977B	047B	BLDG. B - MEDIA CENTER EXT	GRAY	(HOMOGENEOUS) STUCCO OVERHANG	NF	NONE DETECTED	100% MATRIX
822978A	048A	BLDG. B - MEDIA CENTER EXT	BEIGE	(HOMOGENEOUS) SKIM COAT	NF	NONE DETECTED	100% MATRIX

-NOTES: ND=None Detected Asbestos is not quantifiable below the method detection limit of one (1) percent. Amphibole asbestos includes amosite, crocidolite, anthophyllite, tremolite and actinolite. (FR) = Friable, (NF) = Non-Friable. Condition of sample is as received by the laboratory. Our policy is to retain all samples for a period of thirty days. Accredited by the National Voluntary Laboratory Accreditation Program and Environmental Laboratory Certification for the specific scope of accreditation under NVLAP Lab Code 200878-0. This report applies only to the items as received. Results are representative of the samples submitted and may not represent the entire materials from which the samples were collected. This report is submitted for the exclusive use of the client to whom it is addressed. Any reproduction of this report or use of this Laboratory's name for advertising or publicity purposes without prior written authorization is prohibited. In addition, this report is not to be used to claim product endorsement by NVLAP, or any agency of the U.S. Government. Where applicable, layers or "sub-samples" are reported and the Total Asbestos % represents the composite percentage of all sample layers. These samples were quantified using a calibrated visual estimate. Bulk sample(s) submitted were analyzed in accordance with the procedures EPA 600/R-93/116: Method for the Determination of Asbestos in Bulk Building Materials, EPA - 40 CFR Appendix E to Subpart E of Part 763, Interim Method of the Determination of Asbestos in Bulk Insulation Samples.

ENCORP ENVIRONMENTAL MANAGEMENT AND SERVICES

16700 VALLEY VIEW AVE. STE. 100 LA MIRADA, CALIFORNIA 90638
 714) 523-9811 · FAX (714) 523-9810 · MAIN@ENCORP.NET · WWW.ENCORP.NET

Client Name: HACIENDA LA PUENTE
 Client Address: 350 N. HACIENDA BLVD.
CITY OF INDUSTRY, CA 91716-0002
 Facility Name: Wilson HS Media Center-Library
 Facility Address: 16455 Wedgeworth Drive
Hacienda Heights, CA 91745

Reference Batch Number: 064174
 Sampled Date: 1/21/2025
 Sampled By: ANGEL JIMENEZ
 Analyzed By: KRISTINA MARTINEZ

Project Number: P25033 · H21
 Date Received: 1/21/2025
 Date Analyzed: 1/31/2025

LABORATORY TEST REPORT FOR BULK ASBESTOS FIBER ANALYSIS (PLM)

Sample Number	Field/ Client Number	SAMPLE DESCRIPTION			Friable or Non-	CVE Asbestos	Non Asbestos (%)
		Sample Location/Activity	Color	Material			
822978B	048B	BLDG. B - MEDIA CENTER EXT	GRAY	(HOMOGENEOUS) STUCCO OVERHANG	NF	NONE DETECTED	100% MATRIX
822979A	049A	BLDG. B - MEDIA CENTER EXT	BEIGE	(HOMOGENEOUS) SKIM COAT	NF	NONE DETECTED	100% MATRIX
822979B	049B	BLDG. B - MEDIA CENTER EXT	GRAY	(HOMOGENEOUS) STUCCO OVERHANG	NF	NONE DETECTED	100% MATRIX
822980A	050A	BLDG. B - MEDIA CENTER EXT	BEIGE	(HOMOGENEOUS) SKIM COAT	NF	NONE DETECTED	100% MATRIX
822980B	050B	BLDG. B - MEDIA CENTER EXT	GRAY	(HOMOGENEOUS) STUCCO OVERHANG	NF	NONE DETECTED	100% MATRIX
822981	051	BLDG. B - MEDIA CENTER EXT	BROWN	(FIBROUS) OVERHANG PANEL INSULATION	FR	NONE DETECTED	100% FIBROUS GLASS
822982	052	BLDG. B - MEDIA CENTER EXT	BROWN	(FIBROUS) OVERHANG PANEL INSULATION	FR	NONE DETECTED	100% FIBROUS GLASS
822983	053	BLDG. B - MEDIA CENTER EXT	BROWN	(FIBROUS) OVERHANG PANEL INSULATION	FR	NONE DETECTED	100% FIBROUS GLASS

-NOTES: ND=None Detected Asbestos is not quantifiable below the method detection limit of one (1) percent. Amphibole asbestos includes amosite, crocidolite, anthophyllite, tremolite and actinolite. (FR) = Friable, (NF) = Non-Friable. Condition of sample is as received by the laboratory. Our policy is to retain all samples for a period of thirty days. Accredited by the National Voluntary Laboratory Accreditation Program and Environmental Laboratory Certification for the specific scope of accreditation under NVLAP Lab Code 200878-0. This report applies only to the items as received. Results are representative of the samples submitted and may not represent the entire materials from which the samples were collected. This report is submitted for the exclusive use of the client to whom it is addressed. Any reproduction of this report or use of this Laboratory's name for advertising or publicity purposes without prior written authorization is prohibited. In addition, this report is not to be used to claim product endorsement by NVLAP, or any agency of the U.S. Government. Where applicable, layers or "sub-samples" are reported and the Total Asbestos % represents the composite percentage of all sample layers. These samples were quantified using a calibrated visual estimate. Bulk sample(s) submitted were analyzed in accordance with the procedures EPA 600/R-93/116: Method for the Determination of Asbestos in Bulk Building Materials, EPA - 40 CFR Appendix E to Subpart E of Part 763, Interim Method of the Determination of Asbestos in Bulk Insulation Samples.

ENCORP ENVIRONMENTAL MANAGEMENT AND SERVICES

16700 VALLEY VIEW AVE. STE. 100 LA MIRADA, CALIFORNIA 90638
 714) 523-9811 · FAX (714) 523-9810 · MAIN@ENCORP.NET · WWW.ENCORP.NET

Client Name: HACIENDA LA PUENTE
 Client Address: 350 N. HACIENDA BLVD.
CITY OF INDUSTRY, CA 91716-0002
 Facility Name: Wilson HS Media Center-Library
 Facility Address: 16455 Wedgeworth Drive
Hacienda Heights, CA 91745

Reference Batch Number: 064174
 Sampled Date: 1/21/2025
 Sampled By: ANGEL JIMENEZ
 Analyzed By: KRISTINA MARTINEZ

Project Number: P25033 · H21
 Date Received: 1/21/2025
 Date Analyzed: 1/31/2025

LABORATORY TEST REPORT FOR BULK ASBESTOS FIBER ANALYSIS (PLM)

Sample Number	Field/ Client Number	SAMPLE DESCRIPTION			Friable or Non-	CVE Asbestos	Non Asbestos (%)
		Sample Location/Activity	Color	Material			

Notes: P-1000 POINT COUNT

APPROVED SIGNATURE

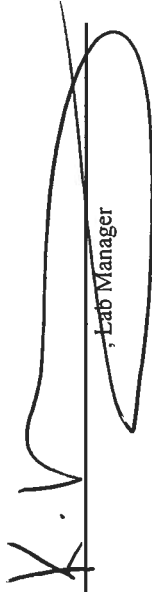

K.V.
Lab Manager

-NOTES: ND=None Detected Asbestos is not quantifiable below the method detection limit of one (1) percent. Amphibole asbestos includes amosite, crocidolite, anthophyllite, tremolite and actinolite. (FR) = Friable, (NF) = Non-Friable. Condition of sample is as received by the laboratory. Our policy is to retain all samples for a period of thirty days. Accredited by the National Voluntary Laboratory Accreditation Program and Environmental Laboratory Certification for the specific scope of accreditation under NVLAP Lab Code 200878-0. This report applies only to the items as received. Results are representative of the samples submitted and may not represent the entire materials from which the samples were collected. This report is submitted for the exclusive use of the client to whom it is addressed. Any reproduction of this report or use of this Laboratory's name for advertising or publicity purposes without prior written authorization is prohibited. In addition, this report is not to be used to claim product endorsement by NVLAP, or any agency of the U.S. Government. Where applicable, layers or "sub-samples" are reported and the Total Asbestos % represents the composite percentage of all sample layers. These samples were quantified using a calibrated visual estimate. Bulk sample(s) submitted were analyzed in accordance with the procedures EPA 600/R-93/116; Method for the Determination of Asbestos in Bulk Building Materials, EPA - 40 CFR Appendix E to Subpart E of Part 763, Interim Method of the Determination of Asbestos in Bulk Insulation Samples.



064174

CHAIN OF CUSTODY FORM

16700 Valley View Avenue, Suite 100
La Mirada, California 90638
Tel: (714) 523-9811
Fax: (714) 523-9810
www.encorp.net

Asbestos Bulk Analysis: PLM Bulk 1000 Point Count
Turn-around Time: RUSH 24 HRS 48 HRS 72 HRS Standard

CLIENT: Hacienda La Puente USD DATE: 1/21/25 PAGE: 1 OF 6
JOB NO: P25033.421 INSPECTORS: Ariel Jimenez
LOCATION: Wilson HS Media Center

SAMPLE NO.	LAB ID #	SAMPLE LOCATION	MATERIAL DESCRIPTION	CONDITION	QUANTITY	% ASBESTOS
1.	220331	BLDG B - media center Int	6" Black Corobase/ mastic/ glue			
2.	220327					
3.	220333					
4.	220334		Carpet glue			
5.	220335					
6.	220336					
7.	220337		Carpet mastic			
8.	220338					
9.	220339					
10.	220340		Vinyl floor tile/ mastic			

ABBREVIATIONS:

TYPES OF MATERIALS:
 S = Surface Material
 TSI = Thermal Systems Insulation
 M = Miscellaneous Material
 Comments/special Instructions:

CONDITION:
 G = Good
 D = Damaged
 SD = Significantly Damaged

OTHER:
 S.F. = Square Feet
 L.F. = Linear Feet

CHAIN OF CUSTODY

Sampled by/Relinquished: Ariel Jimenez Date/Time: 1/21/25 1500
 Relinquished/Received By: AS Bullock Date/Time: 10/21/25 @ 330pm
 Relinquished/Received By: _____ Date/Time: _____

ENCORP Laboratory Services · 16700 Valley View Avenue, Suite 100 · La Mirada, California 90638
 Office (714) 523-9811 · Fax (714) 523-9810



064174 CHAIN OF CUSTODY FORM

16700 Valley View Avenue, Suite 100
 La Mirada, California 90638
 Tel: (714) 523-9811
 Fax: (714) 523-9810
 www.encorp.net

Asbestos Bulk Analysis: PLM Bulk 1000 Point Count
 Turn-around Time: RUSH 24 HRS 48 HRS 72 HRS Standard

CLIENT: Hacienda La Puente USD DATE: 1/21/25 PAGE: 2 OF 6
 JOB NO: P25033.421 INSPECTORS: Angel Jimenez
 LOCATION: Wilson HS Media Center

SAMPLE NO.	LAB ID #	SAMPLE LOCATION	MATERIAL DESCRIPTION	CONDITION	QUANTITY	% ASBESTOS
1	822041					
2	822042					
3	822043		Leveling compound			
4	822044					
5	822045					
6	822046		walk on mat Adhesive			
7	822047					
8	822048					
9	822049		12x12 Grey VPT/mastic			
20	822050					

ABBREVIATIONS:

OTHER: S.F. = Square Feet, L.F. = Linear Feet

CONDITION: G = Good, D = Damaged, SD = Significantly Damaged

Types of Materials: S = Surface Material, TSI = Thermal Systems Insulation, M = Miscellaneous Material

Comments/Special Instructions:

CHAIN OF CUSTODY

Sampled by/Relinquished: Angel Jimenez Date/Time: 1/21/25 1500
 Relinquished/Received BY: AS Baker Date/Time: 10/21/25 @ 330pm
 Relinquished/Received By:

ENCORP Laboratory Services - 16700 Valley View Avenue, Suite 100 - La Mirada - California 90638
 Office: (714) 523-9811 - Fax: (714) 523-9810
 Z:\Public\FORM\FORMS\Current Field Forms\Bulk Sample Forms



064174 CHAIN OF CUSTODY FORM

16700 Valley View Avenue, Suite 100
 La Mirada, California 90638
 Tel: (714) 523-9811
 Fax: (714) 523-9810
 www.encorp.net

Asbestos Bulk Analysis: PLM Bulk 1000 Point Count
 Turn-around Time: RUSH 24 HRS 48 HRS 72 HRS Standard

CLIENT: Hacienda La Puente USD DATE: 1/21/25 PAGE: 3 OF 6

JOB NO: P25033.421 INSPECTORS: Angel Jimenez

LOCATION: Wilson HS Media Center

SAMPLE NO.	LAB ID #	SAMPLE LOCATION	MATERIAL DESCRIPTION	CONDITION	QUANTITY	% ASBESTOS
2 1.	22051					
2 2.	22052		Carpet Pad/Adhesive			
2 3.	22053					
2 4.	22054					
2 5.	22055		Wall Panel Insulation			
2 6.	22056					
2 7.	22057					
2 8.	22058		Ceiling Panel Insulation			
2 9.	22059					
3 0.	22060					

ABBREVIATIONS:

OTHER: S.F. = Square Feet
 L.F. = Linear Feet
 G = Good
 D = Damaged
 SD = Significantly Damaged

Comments/special instructions:

CHAIN OF CUSTODY

Sampled by/Relinquished: Angel Jimenez Date/Time: 1/21/25 1500

Relinquished/Received By: AS Baker Date/Time: 1021.025 @ 330 pm

Relinquished/Received By: _____ Date/Time: _____

ENCORP Laboratory Services - 16700 Valley View Avenue, Suite 100 - La Mirada, California 90638
 Office (714) 523-9811 - Fax (714) 523-9810
 Z:\Public\FORMS\Field Forms\Current Field Forms\Bulk Sample Forms



064174

CHAIN OF CUSTODY FORM

16700 Valley View Avenue, Suite 100
 La Mirada, California 90638
 Tel: (714) 523-9811
 Fax: (714) 523-9810
 www.encorp.net

Asbestos Bulk Analysis: PLM Bulk 1000 Point Count
 Turn-around Time: RUSH 24 HRS 48 HRS 72 HRS Standard

CLIENT: Hacienda La Puente USD DATE: 1/21/25 PAGE: 4 OF 6

JOB NO: P25033.421 INSPECTORS: Angel Jimenez

LOCATION: Wilson HS media Center

SAMPLE NO.	LAB ID #	SAMPLE LOCATION	MATERIAL DESCRIPTION	CONDITION	QUANTITY	% ASBESTOS
3 1.	22.61		Ceiling space Roofing debris			
3 2.	22.62					
3 3.	22.63					
3 4.	22.64		pipe run insulation			
3 5.	22.65					
3 6.	22.66		HVAC insulation			
3 7.	22.67					
3 8.	22.68					
3 9.	22.69					
4 0.	22.70		steel beam caulking			

ABBREVIATIONS:

OTHER:

CONDITION:

OTHER:

S = Surface Material
 TS = Thermal Systems Insulation
 M = Miscellaneous Material
 SD = Significantly Damaged

Comments/special instructions:

Sampled by/Relinquished: Angel Jimenez Date/Time: 1/21/25 1520

Relinquished/Received By: AS Baker Date/Time: 10/21/25 @ 330 pm

Relinquished/Received By:

Comments/special instructions:

ENCORP Laboratory Services - 16700 Valley View Avenue, Suite 100, La Mirada, California 90638

Office (714) 523-9811 Fax (714) 523-9810



064174 CHAIN OF CUSTODY FORM

16700 Valley View Avenue, Suite 100
 La Mirada, California 90638
 Tel: (714) 523-9811
 Fax: (714) 523-9810
 www.encorp.net

Asbestos Bulk Analysis: PLM Bulk 1000 Point Count
 Turn-around Time: RUSH 24 HRS 48 HRS 72 HRS Standard

CLIENT: Hacienda La Puente USD DATE: 1/21/25 PAGE: 5 OF 6
 JOB NO: P25033.421 INSPECTORS: Angel Jimenez
 LOCATION: Wilson HS Media Center

SAMPLE NO.	LAB ID #	SAMPLE LOCATION	MATERIAL DESCRIPTION	CONDITION	QUANTITY	% ASBESTOS
41.	822071					
42.	822072	- Media Center Ext				
43.	822073		Brick / mortar			
44.	822074					
45.	822075					
46.	822076		Stucco Overhang			
47.	822077					
48.	822078					
49.	822079					
50.	822080					

ABBREVIATIONS:

CONDITION: G = Good, D = Damaged, SD = Significantly Damaged

OTHER: S.F. = Square Feet, L.F. = Linear Feet

Types of Materials: S = Surface Material, TSI = Thermal Systems Insulation, M = Miscellaneous Material

Comments/special instructions:

CHAIN OF CUSTODY

Sampled by/Relinquished: Angel Jimenez Date/Time: 1/21/25 1500

Relinquished/Received By: AS Baker Date/Time: 1-21-25 @ 330 pm

Relinquished/Received By: _____ Date/Time: _____

ENCORP Laboratory Services - 16700 Valley View Avenue, Suite 100 - La Mirada - California 90638
 Office (714) 523-9811 - Fax (714) 523-9810



064174 CHAIN OF CUSTODY FORM

16700 Valley View Avenue, Suite 100
 La Mirada, California 90638
 Tel: (714) 523-9811
 Fax: (714) 523-9810
 www.encorp.net

Asbestos Bulk Analysis: PLM Bulk 1000 Point Count
 Turn-around Time: RUSH 24 HRS 48 HRS 72 HRS Standard

CLIENT: Hacienda La Puente USD DATE: 1/21/25 PAGE: 6 OF 6

JOB NO: P25033.421 INSPECTORS: Angel Jimenez

LOCATION: Wilson HS Media Center

SAMPLE NO.	LAB ID #	SAMPLE LOCATION	MATERIAL DESCRIPTION	CONDITION	QUANTITY	% ASBESTOS
51.	822081		Overhang Panel Insulation			
52.	822082					
53.	822083					
4.						
5.						
6.						
7.						
8.						
9.						
0.						

ABBREVIATIONS:

TYPES OF MATERIALS:

S = Surface Material
 TS = Thermal Systems Insulation
 M = Miscellaneous Material
 Comments/Special Instructions:

CONDITION: G = Good, D = Damaged, SD = Significantly Damaged

OTHER: S.F. = Square Feet, L.F. = Linear Feet

CHAIN OF CUSTODY:

Sampled by/Relinquished: Angel Jimenez Date/Time: 1/21/25 1500

Relinquished/Received By: AS Baker Date/Time: 1/21/25 @ 330 pm

Relinquished/Received By: _____ Date/Time: _____

ENCORP Laboratory Services - 16700 Valley View Avenue, Suite 100 - La Mirada, California 90638
 Office (714) 523-9811 - Fax (714) 523-9810
 7_PublicFORM\FORM\Current Field Forms\Bulk Sample Forms

IIB. SAMPLE ANALYSIS - LEAD

ENCORP LEAD BASED PAINT INSPECTION WORKSHEET

CLIENT: Hacienda La Puente USD	ADDRESS: Wilson Hts
SCOPE OF PROJECT:	DATE: 1/21/25
INSPECTOR: Angel Jimenez	XRF SERIAL #:
PROJECT NUMBER: P25033-H21	

SAMPLE NUMBER	K-SHELL READING	PAINT COLOR	SUBSTRATE	COMPONENT	CONDITION	LOCATION	QUANTITY	COMMENTS
1.	1.10	Red	Test	Paint Sheet		Confirmation		
2.	1.00							
3.	1.00							
4.	0.00	Tan	Stucco	Overhang Trim		Media Center - Ext		
5.	0.00							
6.	0.00		Metal	Overhang Panel				
7.	0.00							
8.	0.00	Red		Door				
9.	0.00	Black		Doorframe				
10.	0.00			Window Frame				
11.	0.00	Red		Window Panel				
12.	0.00			Door		- Int		
13.	0.00	Black		Doorframe				
14.	0.00	White		Wall Panel				
15.	0.00							
16.	0.00							
17.	0.00							
18.	0.00	Black	Steel	Steel Beam				
19.	0.00	White	Wood	Door				
20.	0.00	Black	Metal	Doorframe				
21.	0.00	Tan		Wall Panel				
22.	0.00	Green	Wood	Door				
23.	0.00	Red	Brick	Wall		Int		
24.	0.00							
25.	0.00					-Ext		
26.	0.00							
27.	1.10	Red	Test	Paint Sheet		Confirmation		
28.	1.10							
29.	1.00							
30.	.							

By: _____

Title: _____

III. CERTIFICATIONS





STATE OF CALIFORNIA
DEPARTMENT OF PUBLIC HEALTH



LEAD-RELATED CONSTRUCTION CERTIFICATE

INDIVIDUAL:	CERTIFICATE TYPE:	NUMBER:	EXPIRATION DATE:
 Angel Jimenez	Lead Sampling Technician	LRC-00002763	9/15/2025

Disclaimer: This document alone should not be relied upon to confirm certification status. Compare the individual's photo and name to another valid form of government issued photo identification. Verify the individual's certification status by searching for Lead-Related Construction Professionals at www.cdph.ca.gov/programs/clppb or calling (800) 597-LEAD





STATE OF CALIFORNIA
DEPARTMENT OF PUBLIC HEALTH



LEAD-RELATED CONSTRUCTION CERTIFICATE

INDIVIDUAL:	CERTIFICATE TYPE:	NUMBER:	EXPIRATION DATE:
 Howard Baba	Lead Inspector/Assessor	LRC-00003404	10/3/2025
	Lead Supervisor	LRC-00011254	5/25/2025

Disclaimer: This document alone should not be relied upon to confirm certification status. Compare the individual's photo and name to another valid form of government issued photo identification. Verify the individual's certification status by searching for Lead-Related Construction Professionals at www.cdph.ca.gov/programs/clppb or calling (800) 597-LEAD

IV. FIELD INSPECTION DATA

HOMOGENEOUS MATERIALS INSPECTION FORM

Date: 11/21/25 Project Name: Acu Project # P25033.H21

Project Address: Wilson High School

Inspector(s): Angel Jimenez Page: 1 of 3

Building: _____ Building Code: _____

Material Description	Locations	Individual Sq Ft	Total Sq Ft	Condition	Qty of Samples	Sample #'s
6" Black Covebase/ Mastic/ Glue	BLDG B Media Center throughout - Interior		1800 0	G	3	1-3
Carpet Glue			4000 0			4-6
Carpet Mastic	- Interior Sporadic Undercarpet		1500 0			7-9
Vinyl Floor Tile/Mastic			500 0			10-12
Leveling Compound			200 0			13-15
walk on Mat Adhesive	- Exterior Entryways		100 0			16-18
12x12 Grey Vinyl Floor Tile/Mastic	- Conference/ Storage Room		300 0			19-21

HOMOGENEOUS MATERIALS INSPECTION FORM

Date: 1/21/25 Project Name: Acu Project # P25033.H21

Project Address: Wilson High School

Inspector(s): Angel Jimenez Page: 2 of 3

Building: _____ Building Code: _____

Material Description	Locations	Individual Sq Ft	Total Sq Ft	Condition	Qty of Samples	Sample #'s
Carpet Pad/ Adhesive	- below older perimeter carpet		600	G	3	22-24
Wall Panel Insulation	- wall partitions		16000			25-27
Ceiling Panel Insulation	- Throughout Interior		4000			28-30
Ceiling Space Roofing Debris	- Above Drop Ceiling		2000	SD		31-33
Pipe Run Insulation			600	G		34-36
HVAC Insulation			400			37-39
Steel Beam caulking	- Int / Ext		1200			40-42

Elbow not observed in scap area

HOMOGENEOUS MATERIALS INSPECTION FORM

Date: 1/21/25 Project Name: Acu Project # P25033.H21

Project Address: Wilson High School

Inspector(s): Angel Jimenez Page: 3 of 3

Building: _____ Building Code: _____

Material Description	Locations	Individual Sq Ft	Total Sq Ft	Condition	Qty of Samples	Sample #'s
Brick/ Mortar	- Int/Ext		5000 0	G	3	43-45
Stucco Overhang	- Ext		3000 0		5	46-50
Overhang Panel Insulation			1300 0		3	51-53

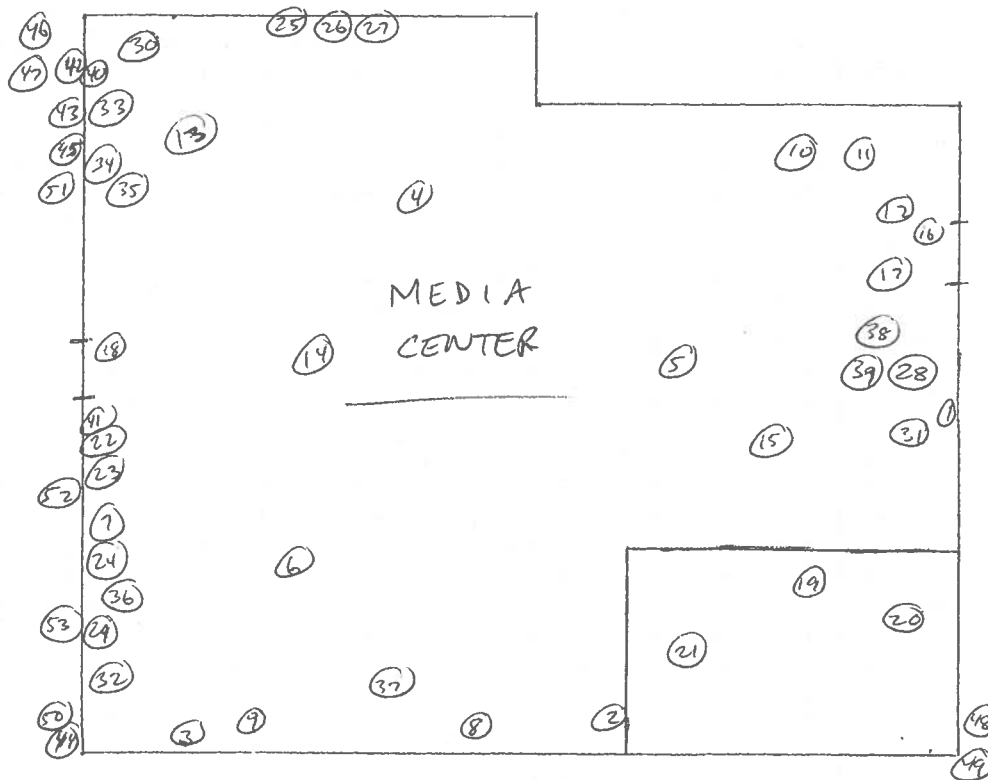

N ↑

(#) = PLM

NO XRF POSITIVES

DESCRIPTION: Wilson HS

JOB NAME: acm/lead Survey

JOB NUMBER: P25033.H21

DRAWN BY: Angel Jimenez

DATE: 1/21/25

ENCORP
Engineering our Environment

16700 Valley View Ave., Suite 100
La Mirada, CA 90638
(714) 523-9811 FAX(714) 523-9810

V. LIMITATIONS

LIMITATIONS

Conditions described in this report are as found at the time of investigation, unless otherwise stated.

ENCORP analyzed only the substances, conditions, and locations described in this report at the time indicated. No inferences regarding other substances, conditions, location or time can be made unless specifically stated in this report. ENCORP's inspection was limited to accessible materials only for the purpose of this survey.

This report is intended for the use listed in the section of this report titled "INTRODUCTION." The use of this report in any manner other than that listed in the Introduction requires the written consent of ENCORP and the TORRANCE UNIFIED SCHOOL DISTRICT. This report must be presented in its entirety.

The conclusions and recommendations presented are based on the agreed upon scope of work outlined in this report. ENCORP makes no warranties or guarantees as to the accuracy or completeness of information obtained from information provided or compiled by others. Note that information exists beyond the scope of this investigation. Additional information, which was outside this scope of work, not found, or available to ENCORP at the time of writing this report, may result in a modification of the conclusions and recommendations presented. This report is not a legal opinion. The services performed by ENCORP have been conducted in a manner consistent with a level of care ordinarily exercised by members of our profession currently practicing under similar conditions. No other warranty, expressed or implied, is made.