

Drawing name: K:\BGC_IP710\099441014 - Laguna Bus Shelter Design\Design\CADD\Currents\Bus Shelter Design sheets\CV-01.dwg CV-01 Sep 26, 2025 12:15pm by: Brynne Creagudo

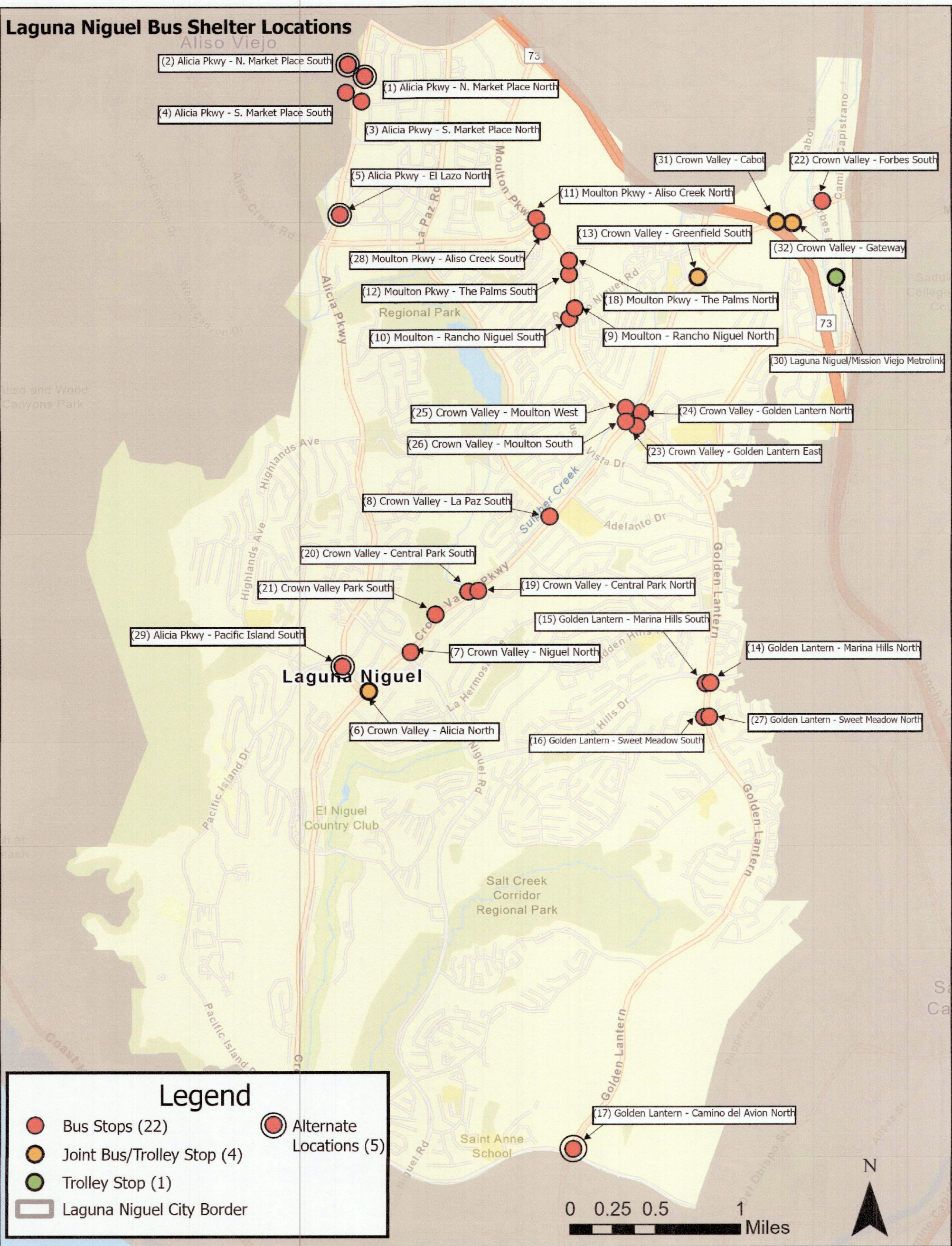

LOCATION MAP

LAGUNA NIGUEL BUS SHELTER REPLACEMENT PROJECT CASH CONTRACT NO. 24-08

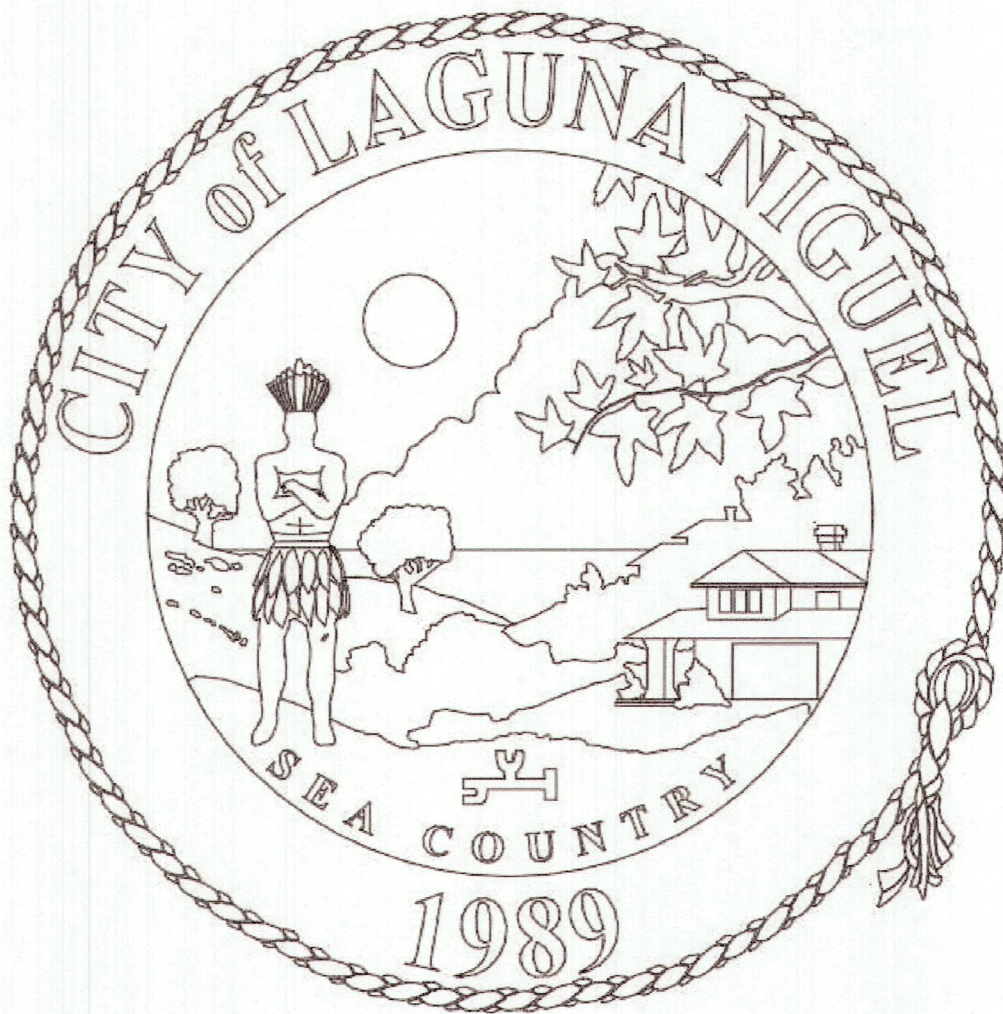

ABBREVIATIONS:

NONE

BENCH MARK:

NONE

OUTSIDE/UTILITY AGENCIES:

NONE

BASIS OF BEARINGS:

NONE

INDEX OF DRAWINGS

SHEET NO.	DESCRIPTION
1	TITLE SHEET
2-17	BUS SHELTER PLANS
18-19	SHELTER DETAILS
APPENDIX	RENDERINGS

LEGEND:

---	RIGHT OF WAY
---	EX. SIDEWALK JOINTS
[Hatched Box]	PROPOSED 6" PORTLAND CEMENT CONCRETE (P.C.C.)
[Dotted Box]	PROPOSED 5" PORTLAND CEMENT CONCRETE (P.C.C.)
[Symbol]	EX. SIGN
[Symbol]	REMOVED SIGN
[Symbol]	RELOCATED SIGN

CONSTRUCTION NOTES:

- FURNISH AND INSTALL NEW BUS SHELTER, BENCH, AND TRASH RECEPTACLE OPTION 1 PER SHEET 18 AND PER DETAIL A ON SHEET 19.
- CONSTRUCT 6" CONCRETE SIDEWALK PANEL PER OCPW SPPWC STANDARD PLAN 1204 MODIFIED AS SHOWN ON SHEET 19 (CONCRETE DEPTH AS NOTED PER PLAN).
- CONSTRUCT 5" CONCRETE SIDEWALK PANEL PER OCPW SPPWC STANDARD PLAN 1204 (CONCRETE DEPTH AS NOTED PER PLAN).
- PROTECT IN PLACE EXISTING OCTA BUS STOP SIGN AND FOUNDATION.
- PROTECT EXISTING PULL BOX IN PLACE AND ADJUST TO GRADE.
- REINSTALL EXISTING OCTA BUS STOP SIGN AND POST.
- PROTECT EXISTING MANHOLE IN PLACE AND ADJUST TO GRADE.
- FURNISH AND INSTALL NEW BUS SHELTER, BENCH, AND TRASH RECEPTACLE OPTION 2 PER SHEET 18 AND PER DETAIL A ON SHEET 19.
- REMOVE EXISTING OCTA BUS STOP SIGN AS SHOWN PER PLAN.
- PROTECT EXISTING AT&T BOX IN PLACE AND ADJUST TO GRADE.
- PROTECT IN PLACE EXISTING STREET LIGHT POLE AND EXISTING OCTA BUS STOP SIGN.
- PROTECT IN PLACE EXISTING UTILITY STRUCTURE.

DISPOSITION NOTES:

- (A) PROTECT/MODIFY/RELOCATE EXISTING IRRIGATION AS DIRECTED.
- (B) CONTRACTOR TO REMOVE EXISTING BENCH AND TRASH RECEPTACLE AND DELIVER TO CITY YARD AT LAGUNA NIGUEL/MISSION VIEJO METROLINK STATION.
- (C) REMOVE CONFLICTING PORTIONS OF PCC AND SOIL TO MATCH REQUIRED DEPTH, SAWCUT ALL JOINS.
- (D) REMOVAL AND DISPOSAL OF EXISTING TRASH RECEPTACLE BY OTHERS.
- (E) PROTECT PARKWAY CULVERT IN PLACE

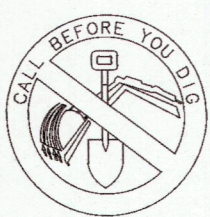

Underground Service Alert
of Southern California

CALL: TOLL FREE 1-800-422-4133
OR 811

TWO WORKING DAYS
BEFORE YOU DIG

NOTICE TO CONTRACTOR

PURSUANT TO ASSEMBLY BILL 3019, NO EXCAVATION PERMIT IS VALID UNLESS THE CONTRACTOR CONTACTS AND OBTAINS AN INQUIRY I.D. NUMBER FROM UNDERGROUND SERVICE ALERT (1-800-422-4133) AT LEAST TWO WORKING DAYS PRIOR TO COMMENCING EXCAVATION.

8					
7					
6					
5					
4					
3					
2					
1					
NO.	DATE	REVISIONS	APPROVED BY	DATE	

PLAN PREPARED BY:

Kimley»Horn

© 2025 KIMLEY-HORN AND ASSOCIATES, INC.
180 E. Ocean Boulevard, Suite 1200
Long Beach, California 90802

SEAL

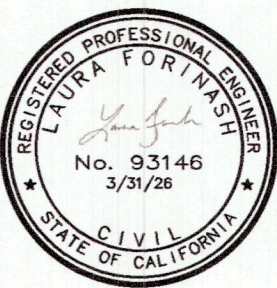

DESIGN ENGINEER

7/25/2025
DATE

REVIEWED BY:
ARDURRA

Kenneth H. ROSENFELD R.C.E. NO. 33496 DATE 9/11/25

ACCEPTED BY:
PUBLIC WORKS DIRECTOR/CITY ENGINEER

MARY SCOTT R.C.E. NO. 64056 DATE 10/9/25

RECOMMENDED BY:
ENGINEERING SERVICES MANAGER

MARY KELLEY R.C.E. NO. 78924 DATE 10/31/25

BUS SHELTER REPLACEMENT PROJECT

CITY OF LAGUNA NIGUEL
BUS SHELTER PLANS

CITY OF LAGUNA NIGUEL
PUBLIC WORKS DEPARTMENT

SHEET

1
OF
19

Drawing name: K:\LBC\TPO\089441014 -- Laguna Bus Shelter Design\CADD\Currents\Bus Shelter Design sheets\1-Alicia at N Market\P N-Alicia at N Market\P S.dwg Sht 01 Sep 08, 2025 2:17pm by: Bryant.Oceguera

CONSTRUCTION NOTES (THIS SHEET ONLY)

- 1
- FURNISH AND INSTALL NEW BUS SHELTER, BENCH, AND TRASH RECEPTACLE OPTION 1 PER SHEET 18 AND PER DETAIL A ON SHEET 19.
- 2
- CONSTRUCT 6" CONCRETE SIDEWALK PANEL PER OCPW SPPWC STANDARD PLAN 1204 MODIFIED AS SHOWN ON SHEET 19 (CONCRETE DEPTH AS NOTED PER PLAN).
- 3
- CONSTRUCT 5" CONCRETE SIDEWALK PANEL PER OCPW SPPWC STANDARD PLAN 1204 (CONCRETE DEPTH AS NOTED PER PLAN).
- 4
- PROTECT IN PLACE EXISTING OCTA BUS STOP SIGN AND FOUNDATION.
- 11
- PROTECT IN PLACE EXISTING STREET LIGHT POLE AND EXISTING OCTA BUS STOP SIGN.

DISPOSITION NOTES (THIS SHEET ONLY)

- C
- REMOVE CONFLICTING PORTIONS OF PCC AND SOIL TO MATCH REQUIRED DEPTH, SAWCUT ALL JOINS.

LEGEND

- RIGHT OF WAY
- EX. SIDEWALK JOINTS
- PROPOSED 6" PORTLAND CEMENT CONCRETE (P.C.C.)
- PROPOSED 5" PORTLAND CEMENT CONCRETE (P.C.C.)
- EX. SIGN
- REMOVED SIGN
- RELOCATED SIGN

CALL BEFORE YOU DIG

Underground Service Alert
of Southern California

CALL: TOLL FREE 1-800-422-4133
OR 811

TWO WORKING DAYS
BEFORE YOU DIG

NOTICE TO CONTRACTOR

PURSUANT TO ASSEMBLY BILL 3019 NO EXCAVATION PERMIT IS VALID UNLESS THE CONTRACTOR CONTACTS AND OBTAINS AN INQUIRY ID NUMBER FROM "UNDERGROUND SERVICE ALERT" (1-800-422-4133) AT LEAST TWO WORKING DAYS PRIOR TO COMMENCING EXCAVATION.

1. ALICIA PKWY - N. MARKET PLACE NORTH

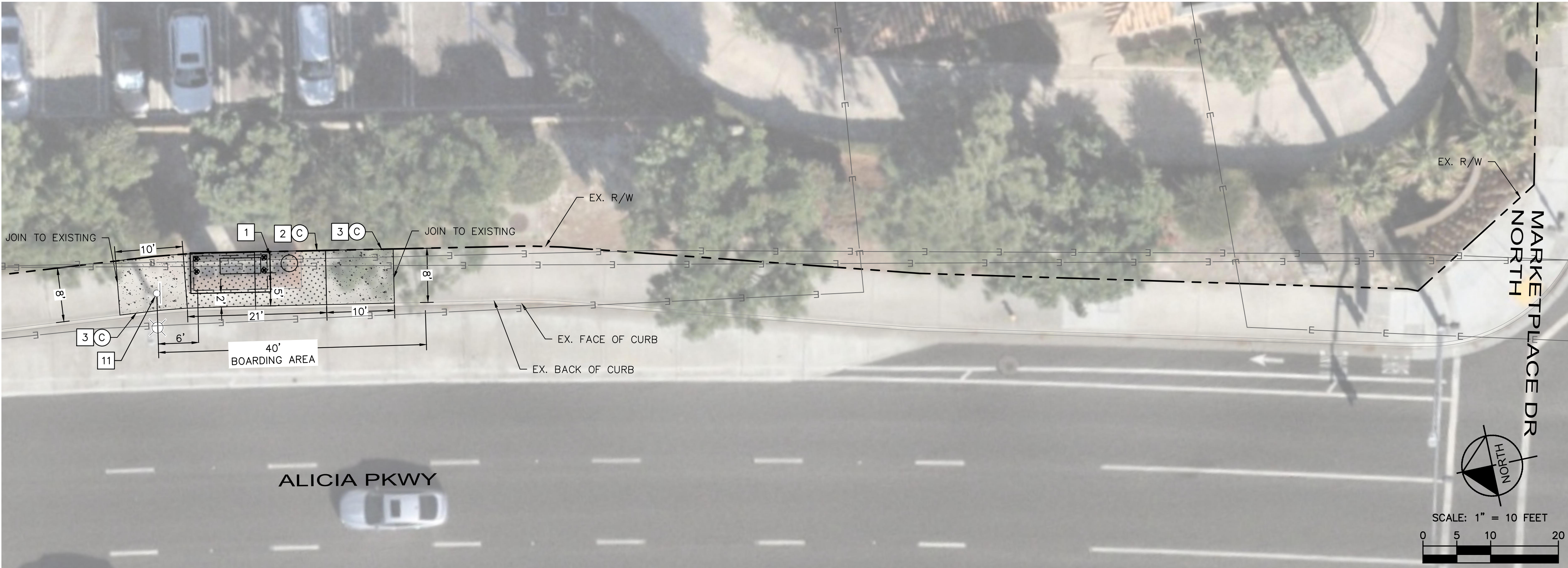

2. ALICIA PKWY - N. MARKET PLACE SOUTH

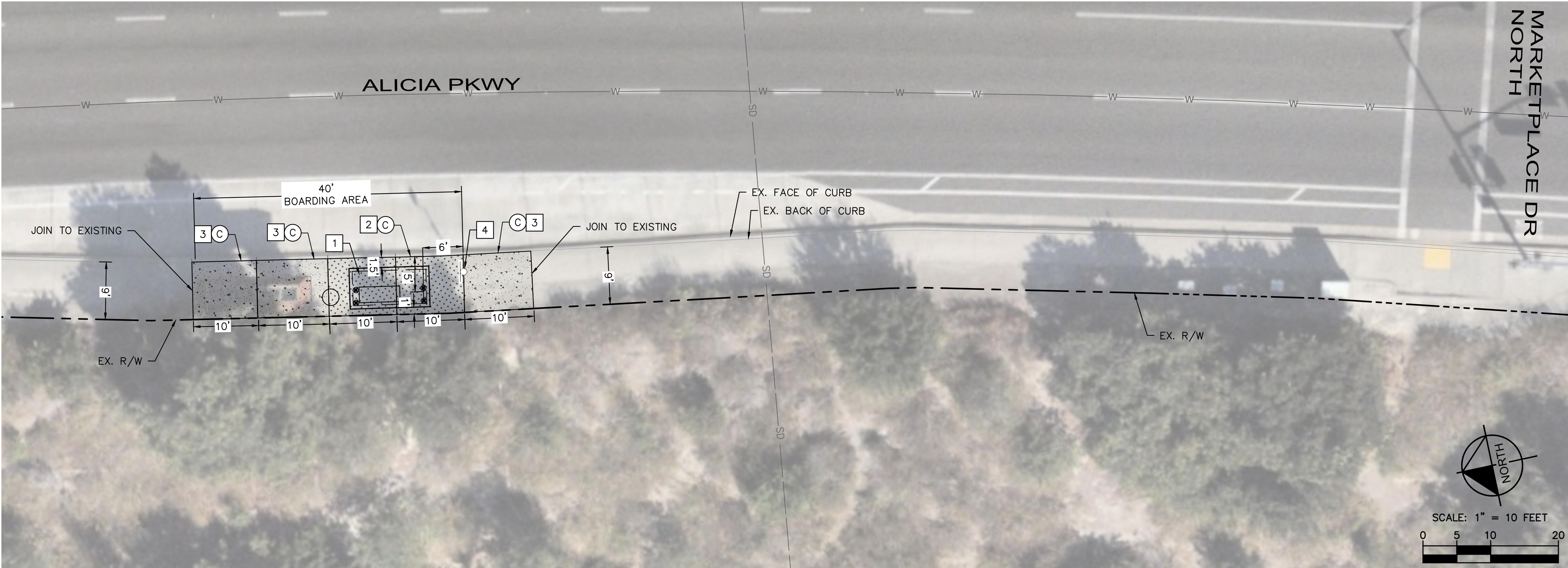

8					
7					
6					
5					
4					
3					
2					
1					
NO.	DATE	REVISIONS	APPROVED BY	DATE	

PLAN PREPARED BY:

KimleyHorn

© 2025 KIMLEY-HORN AND ASSOCIATES, INC.
180 E. Ocean Boulevard, Suite 1200
Long Beach, California 90802

7/25/2025

DESIGN ENGINEER

SEAL

REGISTERED PROFESSIONAL ENGINEER
No. 93146
3/31/26
CIVIL
STATE OF CALIFORNIA

REVIEWED BY:

ARDURRA

KENNETH H. ROSENFELD

R.C.E. NO. 33496

DATE

ACCEPTED BY:

PUBLIC WORKS DIRECTOR/CITY ENGINEER

JACKI SCOTT

R.C.E. NO. 64056

DATE

RECOMMENDED BY:

SENIOR CIVIL ENGINEER

HARRISON MARTIN

R.C.E. NO. 92944

DATE

BUS SHELTER REPLACEMENT PROJECT

ALICIA PKWY - N. MARKETPLACE NORTH &
ALICIA PKWY - N. MARKETPLACE SOUTH

CITY OF LAGUNA NIGUEL
PUBLIC WORKS DEPARTMENT

SHEET

2

OF

19

ALICIA PKWY

SOUTH MARKETPLACE

EX. R/W

EX. FACE OF CURB

EX. BACK OF CURB

JOIN TO EXISTING

40' BOARDING AREA

83'

10' 10' 10' 10' 10'

6' 8'

2 C 3 C 3 C 2 C 1 6 9

0 5 10 20

SCALE: 1" = 10 FEET

NORTH

ALICIA PKWY

SOUTH MARKETPLACE

EX. FACE OF CURB

EX. BACK OF CURB

JOIN TO EXISTING

EX. R/W

40' BOARDING AREA

16'

7.5'

11'

10'

8'

5'

9'

6'

11'

10'

9'

5'

4'

3'

2'

1'

0.2'

EX. R/W

JOIN TO EXISTING

1"

0 5 10 20

SCALE: 1" = 10 FEET

NORTH

- 1 FURNISH AND INSTALL NEW BUS SHELTER, BENCH, AND TRASH RECEPTACLE OPTION 1 PER SHEET 18 AND PER DETAIL A ON SHEET 19.
- 2 CONSTRUCT 6" CONCRETE SIDEWALK PANEL PER OCPW SPPWC STANDARD PLAN 1204 MODIFIED AS SHOWN ON SHEET 19 (CONCRETE DEPTH AS NOTED PER PLAN).
- 3 CONSTRUCT 5" CONCRETE SIDEWALK PANEL PER OCPW SPPWC STANDARD PLAN 1204 (CONCRETE DEPTH AS NOTED PER PLAN).
- 4 PROTECT IN PLACE EXISTING OCTA BUS STOP SIGN AND FOUNDATION.
- 5 PROTECT EXISTING PULL BOX IN PLACE AND ADJUST TO GRADE.
- 6 RELOCATE EXISTING OCTA BUS STOP SIGN AND POST.
- 9 REMOVE EXISTING OCTA BUS STOP SIGN AND POST AS SHOWN PER PLAN.

③ REMOVE CONFLICTING PORTIONS OF PCC AND SOIL TO MATCH REQUIRED DEPTH, SAWCUT ALL JOINS.

RIGHT OF WAY

EX. SIDEWALK JOINTS

PROPOSED 6" PORTLAND CEMENT CONCRETE (P.C.C.)

PROPOSED 5" PORTLAND CEMENT CONCRETE (P.C.C.)

EX. SIGN

REMOVED SIGN

REINSTALLED SIGN



CALL: TOLL FREE 1-800-422-4133
OR 811
TWO WORKING DAYS
BEFORE YOU DIG

PURSUANT TO ASSEMBLY BILL 3019 NO EXCAVATION PERMIT IS VALID UNLESS THE CONTRACTOR CONTACTS AND OBTAINS AN INQUIRY I.D. NUMBER FROM "UNDERGROUND SERVICE ALERT" (1-800-422-4133) AT LEAST TWO WORKING DAYS PRIOR TO COMMENCING EXCAVATION.

8				
7				
6				
5				
4				
3				
2				
1				
NO.	DATE	REVISIONS	APPROVED BY	DATE

Kimley»Horn
© 2025 KIMLEY-HORN AND ASSOCIATES, INC.
180 E. Ocean Boulevard, Suite 1200
Long Beach, California 90802



KENNETH H. ROSENFELD R.C.E. NO. 33496 DATE

JACKI SCOTT R.C.E. NO. 64056 DATE

HARRISON MARTIN	B.C.E. NO. 92944	DATE
-----------------	------------------	------

ALICIA PKWY - S. MARKETPLACE NORTH &
ALICIA PKWY - S. MARKETPLACE SOUTH

CITY OF LAGUNA NIGUEL
PUBLIC WORKS DEPARTMENT

3

F

9

Drawing name: K:\LEG_TPD\089441014 - Laguna Bus Shelter Design\CADD\Currents\Bus Shelter Design sheets\3-Alicia at El Lazo N.dwg Sht 03 Sep 08, 2025 2:18pm by: Bryant.Osegueda

CONSTRUCTION NOTES (THIS SHEET ONLY)

- 1
- FURNISH AND INSTALL NEW BUS SHELTER, BENCH, AND TRASH RECEPTACLE OPTION 1 PER SHEET 18 AND PER DETAIL A ON SHEET 19.
- 2
- CONSTRUCT 6" CONCRETE SIDEWALK PANEL PER OCPW SPPWC STANDARD PLAN 1204 MODIFIED AS SHOWN ON SHEET 19 (CONCRETE DEPTH AS NOTED PER PLAN).
- 3
- CONSTRUCT 5" CONCRETE SIDEWALK PANEL PER OCPW SPPWC STANDARD PLAN 1204 (CONCRETE DEPTH AS NOTED PER PLAN).
- 4
- PROTECT IN PLACE EXISTING OCTA BUS STOP SIGN AND FOUNDATION.
- 6
- RELOCATE EXISTING OCTA BUS STOP SIGN AND POST.
- 9
- REMOVE EXISTING OCTA BUS STOP SIGN AND POST AS SHOWN PER PLAN.

DISPOSITION NOTES (THIS SHEET ONLY)

- C
- REMOVE CONFLICTING PORTIONS OF PCC AND SOIL TO MATCH REQUIRED DEPTH, SAWCUT ALL JOINS.

LEGEND

- RIGHT OF WAY
- SIDEWALK JOINTS
- PROPOSED 6" PORTLAND CEMENT CONCRETE (P.C.C.)
- PROPOSED 5" PORTLAND CEMENT CONCRETE (P.C.C.)
- EX. SIGN
- REMOVED SIGN
- REINSTALLED SIGN



Underground Service Alert
of Southern California

CALL: TOLL FREE 1-800-422-4133
OR 811
TWO WORKING DAYS
BEFORE YOU DIG

NOTICE TO CONTRACTOR

PURSUANT TO ASSEMBLY BILL 3019 NO EXCAVATION PERMIT IS VALID UNLESS THE CONTRACTOR CONTACTS AND OBTAINS AN INQUIRY ID NUMBER FROM "UNDERGROUND SERVICE ALERT" (1-800-422-4133) AT LEAST TWO WORKING DAYS PRIOR TO COMMENCING EXCAVATION.

5. ALICIA PKWY - EL LAZO NORTH

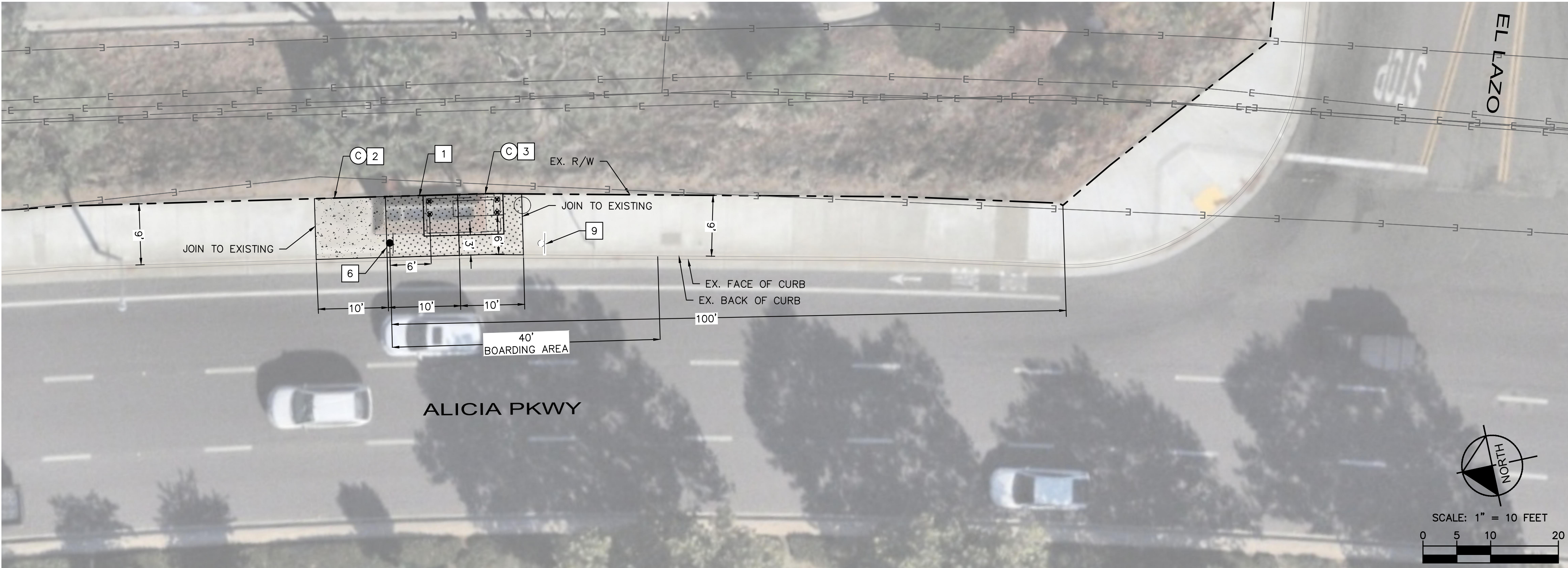

6. CROWN VALLEY - ALICIA NORTH



8					
7					
6					
5					
4					
3					
2					
1					
NO.	DATE	REVISIONS	APPROVED BY	DATE	

PLAN PREPARED BY:

Kimley»Horn

© 2025 KIMLEY-HORN AND ASSOCIATES, INC.
180 E. Ocean Boulevard, Suite 1200
Long Beach, California 90802

7/25/2025

SEAL

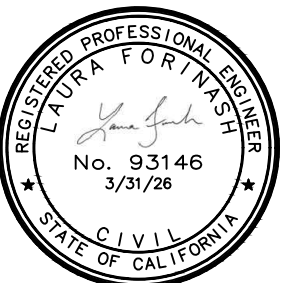

REVIEWED BY:

ARDURRA

KENNETH H. ROSENFELD R.C.E. NO. 33496 DATE

ACCEPTED BY:

PUBLIC WORKS DIRECTOR/CITY ENGINEER

JACKI SCOTT R.C.E. NO. 64056 DATE

RECOMMENDED BY:
SENIOR CIVIL ENGINEER

HARRISON MARTIN R.C.E. NO. 92944 DATE

BUS SHELTER REPLACEMENT PROJECT

ALICIA PKWY - EL LAZO NORTH &
CROWN VALLEY - ALICIA NORTH

CITY OF LAGUNA NIGUEL
PUBLIC WORKS DEPARTMENT

SHEET

4

OF

19

Drawing name: K:\LBC\TPO\089441014 - Laguna Bus Shelter Design\CAD\Currents\Bus Shelter Design sheets\6-Crown Valley at Niguel N -Crown Valley at Niguel S.dwg Sht. 6 Sep. 08, 2025 2:18pm by: Bryant Osqueda

CONSTRUCTION NOTES (THIS SHEET ONLY)

- 1
- FURNISH AND INSTALL NEW BUS SHELTER, BENCH, AND TRASH RECEPTACLE OPTION 1 PER SHEET 18 AND PER DETAIL A ON SHEET 19.
- 2
- CONSTRUCT 6" CONCRETE SIDEWALK PANEL PER OCPW SPPWC STANDARD PLAN 1204 MODIFIED AS SHOWN ON SHEET 19 (CONCRETE DEPTH AS NOTED PER PLAN).
- 3
- CONSTRUCT 5" CONCRETE SIDEWALK PANEL PER OCPW SPPWC STANDARD PLAN 1204 (CONCRETE DEPTH AS NOTED PER PLAN).
- 4
- PROTECT IN PLACE EXISTING OCTA BUS STOP SIGN AND FOUNDATION.

DISPOSITION NOTES (THIS SHEET ONLY)

- C
- REMOVE CONFLICTING PORTIONS OF PCC AND SOIL TO MATCH REQUIRED DEPTH, SAWCUT ALL JOINS.

LEGEND

- RIGHT OF WAY
- EX. SIDEWALK JOINTS
- PROPOSED 6" PORTLAND CEMENT CONCRETE (P.C.C.)
- PROPOSED 5" PORTLAND CEMENT CONCRETE (P.C.C.)
- EX. SIGN
- REMOVED SIGN
- REINSTALLED SIGN



Underground Service Alert
of Southern California

CALL: TOLL FREE 1-800-422-4133
OR 811
TWO WORKING DAYS
BEFORE YOU DIG

NOTICE TO CONTRACTOR

PURSUANT TO ASSEMBLY BILL 3019 NO EXCAVATION PERMIT IS VALID UNLESS THE CONTRACTOR CONTACTS AND OBTAINS AN INQUIRY ID. NUMBER FROM "UNDERGROUND SERVICE ALERT" (1-800-422-4133) AT LEAST TWO WORKING DAYS PRIOR TO COMMENCING EXCAVATION.

8					
7					
6					
5					
4					
3					
2					
1					
NO.	DATE	REVISIONS	APPROVED BY	DATE	

PLAN PREPARED BY:

Kimley»Horn

© 2025 KIMLEY-HORN AND ASSOCIATES, INC.
180 E. Ocean Boulevard, Suite 1200
Long Beach, California 90802

7/25/2025

SEAL



REVIEWED BY:

ARDURRA

KENNETH H. ROSENFELD R.C.E. NO. 33496 DATE

ACCEPTED BY:

PUBLIC WORKS DIRECTOR/CITY ENGINEER

JACKI SCOTT R.C.E. NO. 64056 DATE

RECOMMENDED BY:
SENIOR CIVIL ENGINEER

HARRISON MARTIN R.C.E. NO. 92944 DATE

BUS SHELTER REPLACEMENT PROJECT

CROWN VALLEY - NIGUEL NORTH &
CROWN VALLEY PKWY - LA PAZ SOUTH

CITY OF LAGUNA NIGUEL
PUBLIC WORKS DEPARTMENT

SHEET

5

OF

19

7. CROWN VALLEY - NIGUEL NORTH

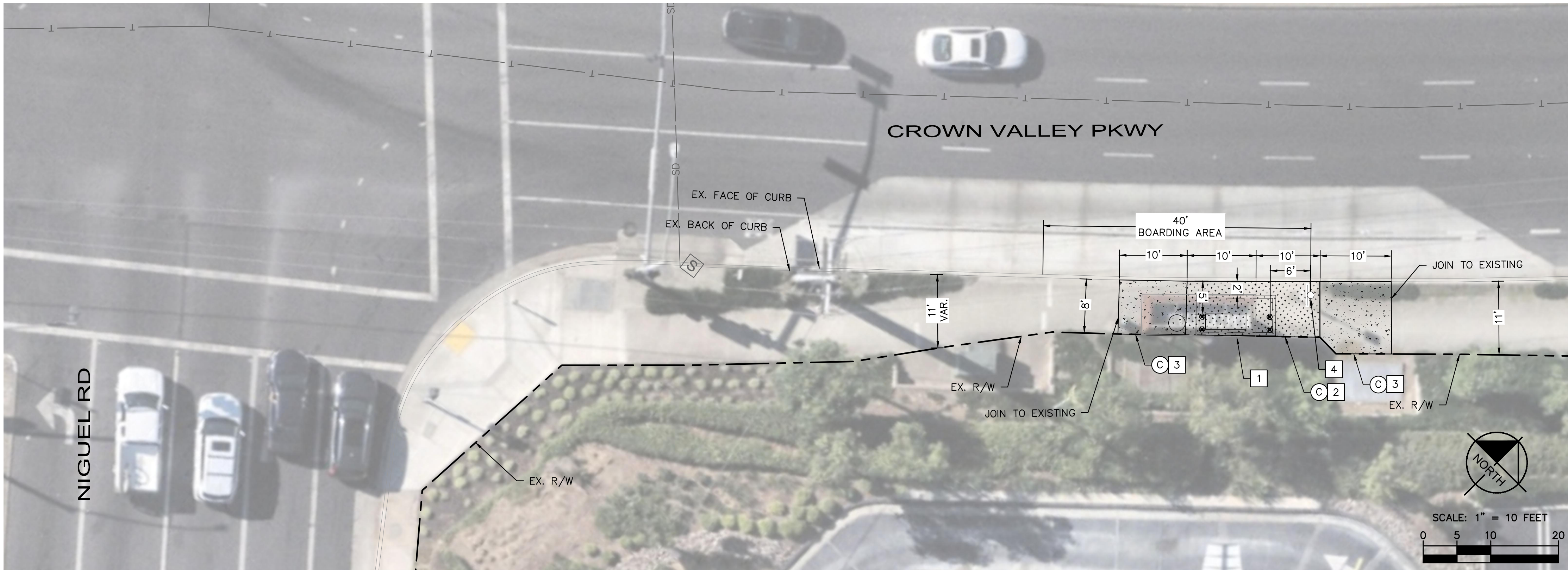

8. CROWN VALLEY PKWY - LA PAZ SOUTH

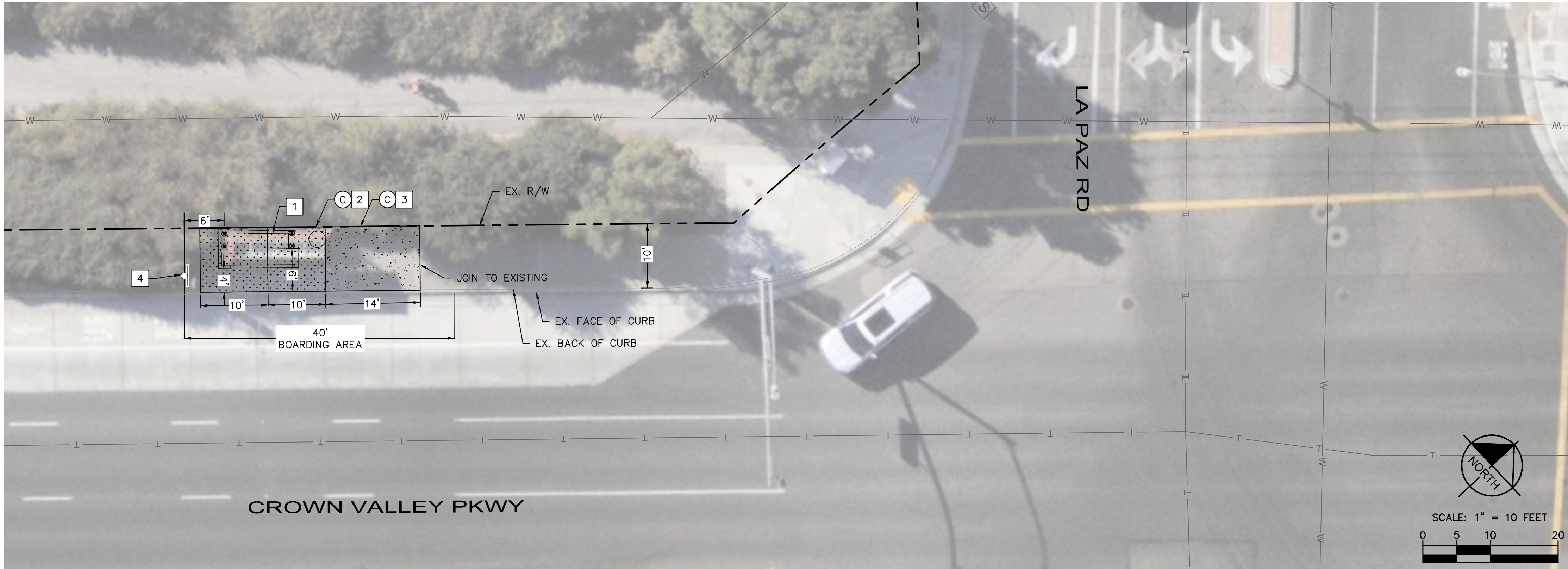

Drawing name: K:\LBC\TPO\089441014 - Laguna Bus Shelter Design\CADD\Currents\Bus Shelter Design sheets\8-Moulton at Rancho N S-Moulton at Rancho N N.dwg Sht 08 Sep 09, 2025 4:30pm by: Bryant Oreguena

CONSTRUCTION NOTES (THIS SHEET ONLY)

- 1

FURNISH AND INSTALL NEW BUS SHELTER, BENCH, AND TRASH RECEPTACLE OPTION 1 PER SHEET 18 AND PER DETAIL A ON SHEET 19.
- 2

CONSTRUCT 6" CONCRETE SIDEWALK PANEL PER OCPW SPPWC STANDARD PLAN 1204 MODIFIED AS SHOWN ON SHEET 19 (CONCRETE DEPTH AS NOTED PER PLAN).
- 3

CONSTRUCT 5" CONCRETE SIDEWALK PANEL PER OCPW SPPWC STANDARD PLAN 1204 (CONCRETE DEPTH AS NOTED PER PLAN).
- 4

PROTECT IN PLACE EXISTING OCTA BUS STOP SIGN AND FOUNDATION.
- 6

RELOCATE EXISTING OCTA BUS STOP SIGN AND POST.
- 7

PROTECT EXISTING MANHOLE IN PLACE AND ADJUST TO GRADE.
- 9

REMOVE EXISTING OCTA BUS STOP SIGN AND POST AS SHOWN PER PLAN.

DISPOSITION NOTES (THIS SHEET ONLY)

- C

REMOVE CONFLICTING PORTIONS OF PCC AND SOIL TO MATCH REQUIRED DEPTH, SAWCUT ALL JOINS.

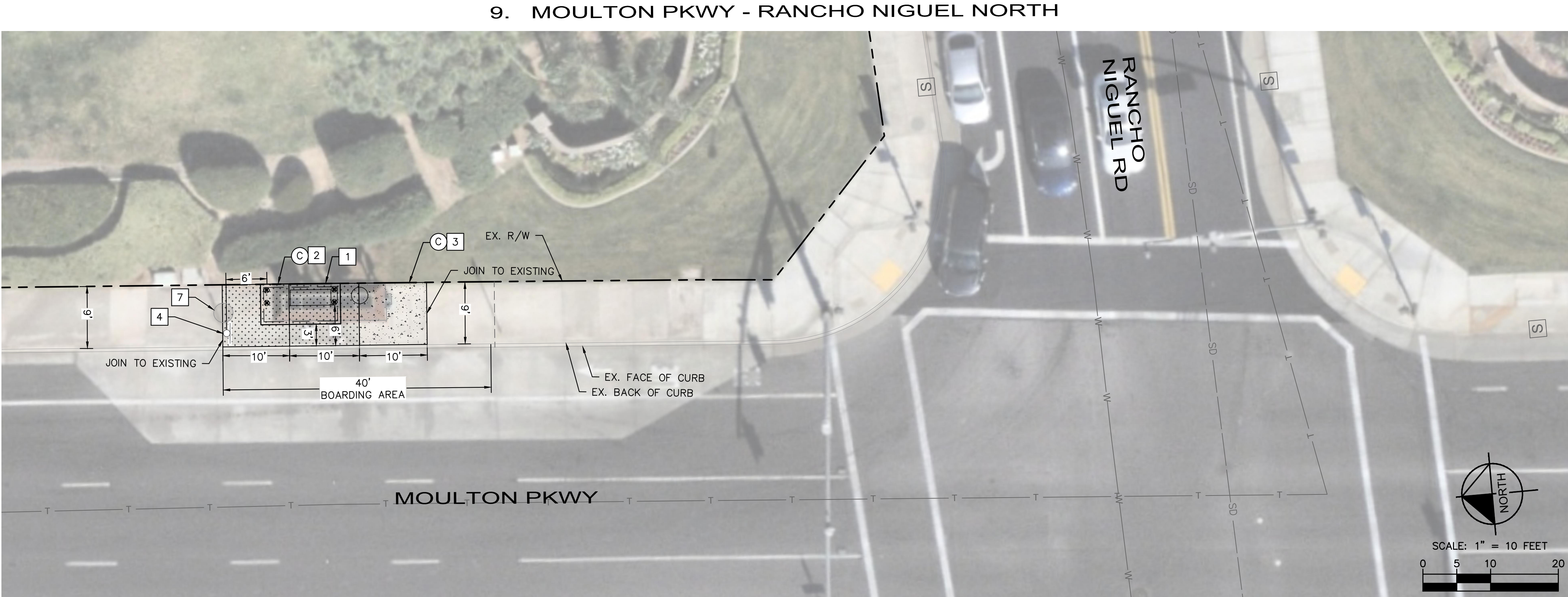

LEGEND

- RIGHT OF WAY
- EX. SIDEWALK JOINTS
- PROPOSED 6" PORTLAND CEMENT CONCRETE (P.C.C.)
- PROPOSED 5" PORTLAND CEMENT CONCRETE (P.C.C.)
- EX. SIGN
- REMOVED SIGN
- REINSTALLED SIGN

Underground Service Alert

of Southern California

CALL: TOLL FREE 1-800-422-4133

OR 811

TWO WORKING DAYS

BEFORE YOU DIG

NOTICE TO CONTRACTOR

PURSUANT TO ASSEMBLY BILL 3019 NO EXCAVATION PERMIT IS VALID UNLESS THE CONTRACTOR CONTACTS AND OBTAINS AN INQUIRY ID NUMBER FROM "UNDERGROUND SERVICE ALERT" (1-800-422-4133) AT LEAST TWO WORKING DAYS PRIOR TO COMMENCING EXCAVATION.

10. MOULTON PKWY - RANCHO NIGUEL SOUTH

8					
7					
6					
5					
4					
3					
2					
1					
NO.	DATE	REVISIONS	APPROVED BY	DATE	

PLAN PREPARED BY:

Kimley»Horn

© 2025 KIMLEY-HORN AND ASSOCIATES, INC.
180 E. Ocean Boulevard, Suite 1200
Long Beach, California 90802

7/25/2025

DESIGN ENGINEER

DATE

SEAL

REGISTERED PROFESSIONAL ENGINEER

LAURENCE FORTHUM

No. 93146

3/31/26

CIVIL

STATE OF CALIFORNIA

REVIEWED BY:

ARDURRA

KENNETH H. ROSENFELD

R.C.E. NO. 33496

DATE

ACCEPTED BY:

PUBLIC WORKS DIRECTOR/CITY ENGINEER

JACKI SCOTT

R.C.E. NO. 64056

DATE

RECOMMENDED BY:

SENIOR CIVIL ENGINEER

HARRISON MARTIN

R.C.E. NO. 92944

DATE

BUS SHELTER REPLACEMENT PROJECT

MOULTON PKWY - RANCHO NIGUEL NORTH &
MOULTON PKWY - RANCHO NIGUEL SOUTH

CITY OF LAGUNA NIGUEL
PUBLIC WORKS DEPARTMENT

SHEET

6

OF

19

Drawing name: K:\LBC\TPO\08944104 - Laguna Bus Shelter Design\CADD\Currents\Bus Shelter Design sheets\9-Moulton at Aliso Creek N-Moulton at Palms S.dwg Sht 09 Sep 09, 2025 7:11pm by: Bryant Creguado

CONSTRUCTION NOTES (THIS SHEET ONLY)

- 1

FURNISH AND INSTALL NEW BUS SHELTER, BENCH, AND TRASH RECEPTACLE OPTION 1 PER SHEET 18 AND PER DETAIL A ON SHEET 19.
- 2

CONSTRUCT 6" CONCRETE SIDEWALK PANEL PER OCPW SPPWC STANDARD PLAN 1204 MODIFIED AS SHOWN ON SHEET 19 (CONCRETE DEPTH AS NOTED PER PLAN).
- 3

CONSTRUCT 5" CONCRETE SIDEWALK PANEL PER OCPW SPPWC STANDARD PLAN 1204 (CONCRETE DEPTH AS NOTED PER PLAN).
- 4

PROTECT IN PLACE EXISTING OCTA BUS STOP SIGN AND FOUNDATION.
- 5

PROTECT EXISTING PULL BOX IN PLACE AND ADJUST TO GRADE.
- 6

RELOCATE EXISTING OCTA BUS STOP SIGN AND POST.
- 7

PROTECT EXISTING MANHOLE IN PLACE AND ADJUST TO GRADE.
- 9

REMOVE EXISTING OCTA BUS STOP SIGN AND POST AS SHOWN PER PLAN.

DISPOSITION NOTES (THIS SHEET ONLY)

- C

REMOVE CONFLICTING PORTIONS OF PCC AND SOIL TO MATCH REQUIRED DEPTH, SAWCUT ALL JOINS.
- E

PROTECT PARKWAY CULVERT IN PLACE

LEGEND

- RIGHT OF WAY
- SIDEWALK JOINTS
- PROPOSED 6" PORTLAND CEMENT CONCRETE (P.C.C.)
- PROPOSED 5" PORTLAND CEMENT CONCRETE (P.C.C.)
- EX. SIGN
- REMOVED SIGN
- REINSTALLED SIGN

CALL BEFORE YOU DIG

Underground Service Alert

of Southern California

CALL: TOLL FREE 1-800-422-4133

OR 811

TWO WORKING DAYS

BEFORE YOU DIG

NOTICE TO CONTRACTOR

PURSUANT TO ASSEMBLY BILL 3019 NO EXCAVATION PERMIT IS VALID UNLESS THE CONTRACTOR CONTACTS AND OBTAINS AN INQUIRY ID NUMBER FROM "UNDERGROUND SERVICE ALERT" (1-800-422-4133) AT LEAST TWO WORKING DAYS PRIOR TO COMMENCING EXCAVATION.

11. MOULTON PKWY - ALISO CREEK NORTH



12. MOULTON PKWY - THE PALMS SOUTH

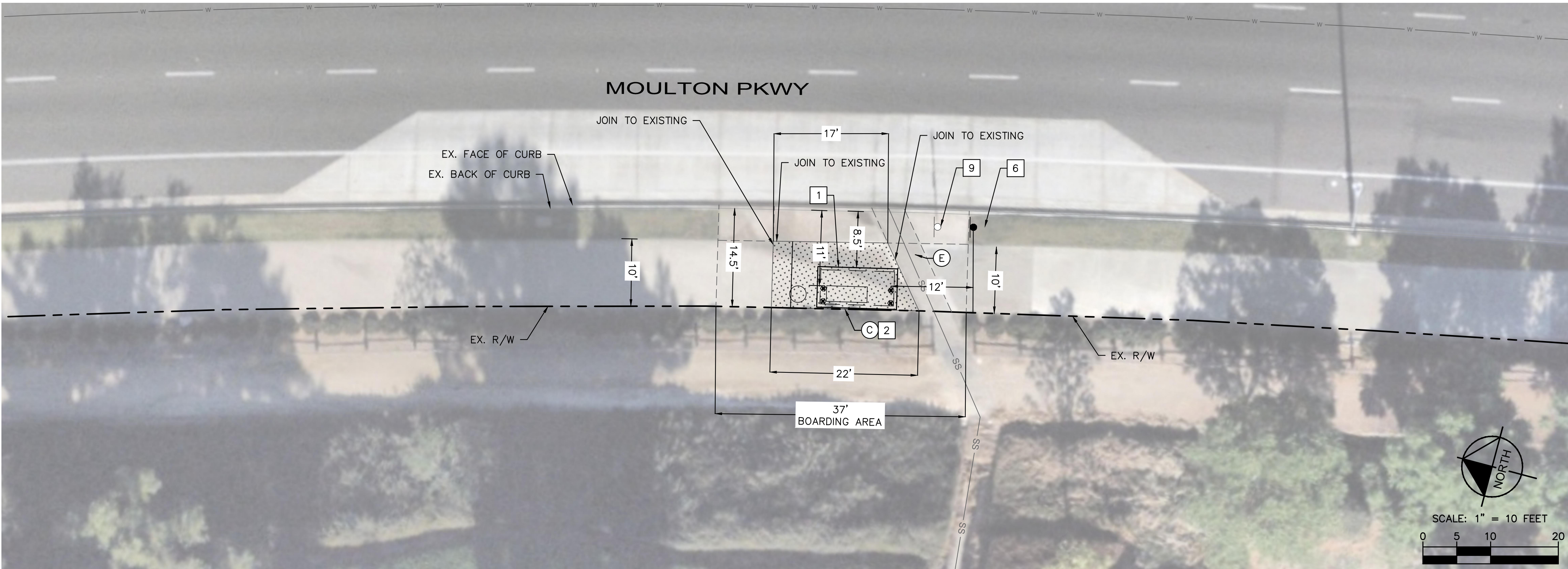

8					
7					
6					
5					
4					
3					
2					
1					
NO.	DATE	REVISIONS	APPROVED BY	DATE	

PLAN PREPARED BY:

Kimley»Horn

© 2025 KIMLEY-HORN AND ASSOCIATES, INC.
180 E. Ocean Boulevard, Suite 1200
Long Beach, California 90802

SEAL

REGISTERED PROFESSIONAL ENGINEER

LAGUNA FOR NIGUEL

No. 93146

3/31/26

CIVIL

STATE OF CALIFORNIA

DESIGN ENGINEER

7/25/2025

DATE

REVIEWED BY:

ARDURRA

KENNETH H. ROSENFELD

R.C.E. NO. 33496

DATE

ACCEPTED BY:

PUBLIC WORKS DIRECTOR/CITY ENGINEER

JACKI SCOTT

R.C.E. NO. 64056

DATE

RECOMMENDED BY:

SENIOR CIVIL ENGINEER

HARRISON MARTIN

R.C.E. NO. 92944

DATE

BUS SHELTER REPLACEMENT PROJECT

MOULTON PKWY - ALISO CREEK NORTH &
MOULTON PKWY - PALMS SOUTH

CITY OF LAGUNA NIGUEL
PUBLIC WORKS DEPARTMENT

SHEET

7
OF
19