



STORY RENTALS EVENT SPACE DETAILS

Story' guests are welcome to use anything in Story aside from the espresso machine/coffee equipment. We've tried to account for everything here and to keep this document current, but if there is something you don't see you think we may have and don't see here, just ask!



BUILDING LAYOUT

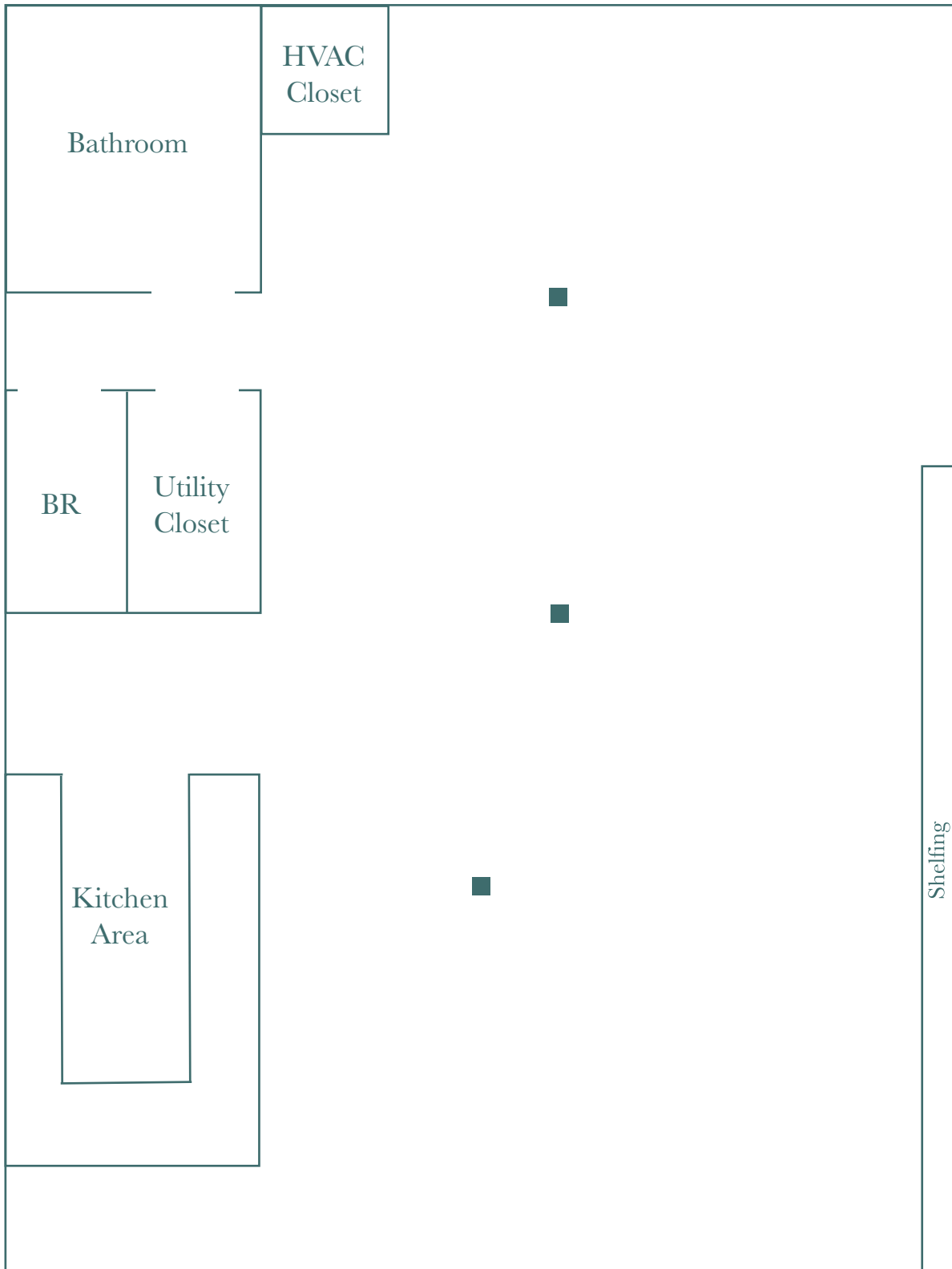

BUILDING LAYOUT

Story is roughly 1200square feet

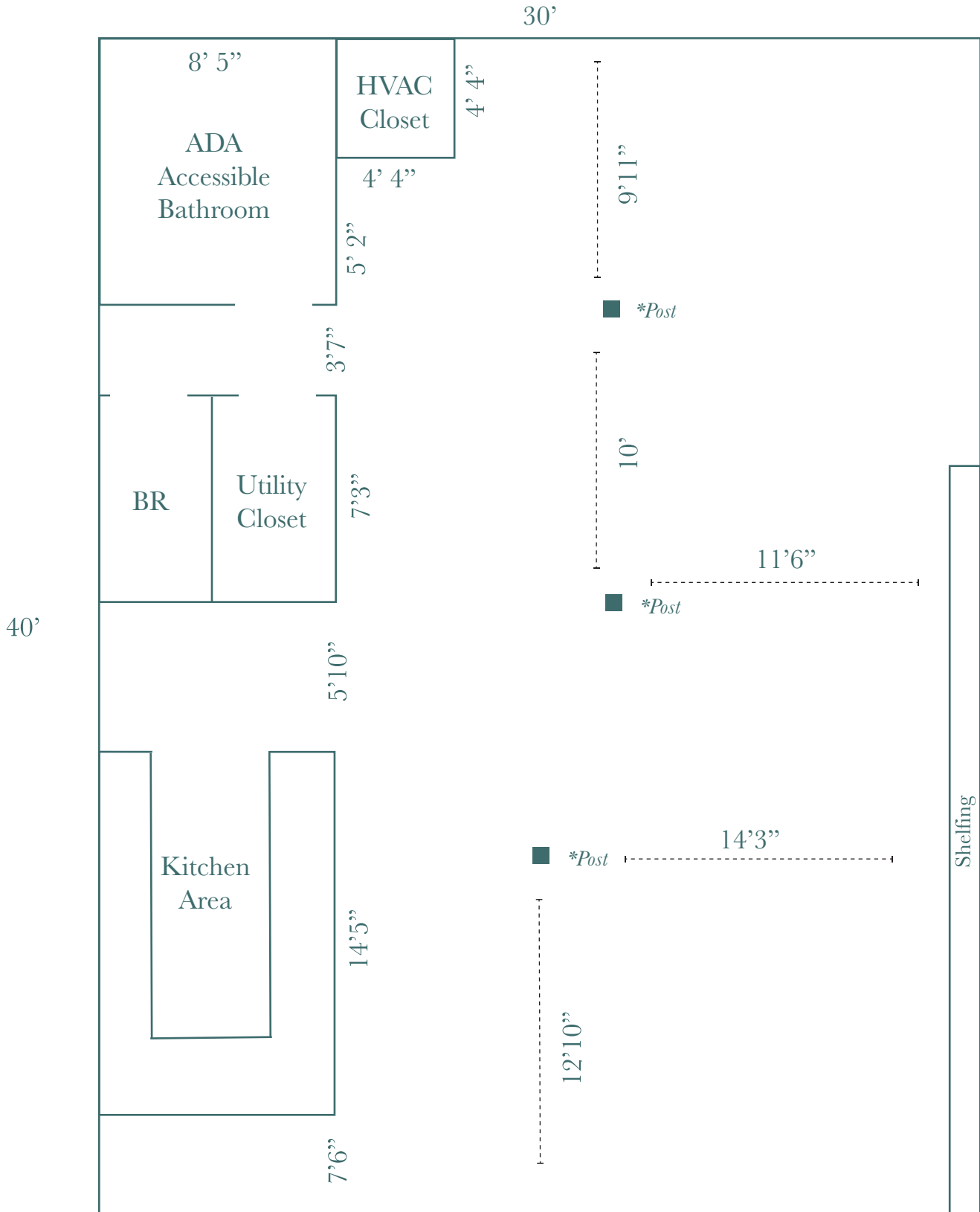

SEATING



Tables and chairs can be configured to guest preference either by asking for a certain layout prior to the event or by moving them themselves. Everything is easy to move - in fact one person can move everything except the couches which need two people to keep from dragging them across the floor. We ask that all furniture be picked UP to move and never drag.

Tables

- 6 white 4-6 top tables W 49 1/4" x 29 1/2"
+ 3 square wooden top tables 29 1/2" x 29 1/2" available upon request
- 6 bistro tables 24 in diameter
- 1 coffee table



Seating

- 12 wooden chairs
+ 6 additional available upon request
- 24 white chairs
- 2 velvet blue couches (4 seats)
- 2 window seats
- 8 black folding chairs

50 seats as is

*56 available when extra wooden chairs are requested



Total Seats Available:

60 seats as is (*4 of these are outside - 6 are inside/outside - see following page for details)

*66 seats available when extra wooden chairs are requested

Max capacity for an event: 75

THE PATIO



Outdoor/Indoor Seating

Outdoor couch seats at least 4
Square bistro tables with two folding chairs each for a total of 6
10 outdoor/indoor seats as is

THE KITCHEN

Three bay sink
Microwave
Toaster Oven
Two fridges
One Freezer
Ice Machine

WARES

36 big plates (white, black, and brown variety)
11 small plates
14 glasses
8 coffee mugs
10 blue plastic cups
6 green plastic cups
Silverware

*If you are planning to use our plates and glasses, you are responsible for washing them. Please let us know if you wish to use our wares so that we can do a recount and ensure we have enough for your party!



WARES PHOTOS



Plastic Cups



Coffee Mugs



Glasses



Big Plates



EXTRAS



Clear Plastic
Serving Platter



One plastic,
one glass pitcher



White
Ceramic Bowl



White Plastic
Serving Platter



*For size
reference



Square foam
connecting mats -
12 total
9 pictured



One extension
cord



Three trash cans,
plenty of trashbags
always stocked



Speakers

Story has two bluetooth speakers guests can use that pair to each other for providing music during your event. Guests should come with their own device such as a phone to play their desired playlist or station.



Projector Screen

Connect to our projector and play presentations or movies on the big screen - to connect you will need a computer or device with a HDMI port or an HDMI adapter.

Parking

15 spots on Story's property

Some are alongside the building along Gee Street and a few are behind the building accessible from Matthews Avenue.

*Empty lot across the street - we know the owner and have been given verbal permission that it won't be an issue for the foreseeable future. Please note we do not own this property and cannot guarantee anything regarding its continued use but we have a great relationship with property owner and expect that to continue. We ask you to treat it with the utmost respect so that our guests can continue to use it.