



Photo: Nancy Dobbs

# TIMBERLAKE TIMES

Timberlake Ranch Landowners Association

Summer 2022

## *President's Ponderings*

The hot summer days have swept in and will leave just as fast. I'm thankful for the rains we are having.

I want to say "thank you" to all the landowners that have joined us for our in-person meetings. And a big thanks to all that have joined remotely in the new world of Zoom meetings. I am working to bring our HOA together in different ways, to bring a better quality of life and communication to our beautiful community.

We are working on the roads with our partners, Cibola and McKinley counties and Ramah/Navajo, to improve road conditions. With that being said, let's all be mindful of our driving speed, driving on the slower side to keep our roads in better condition as higher speeds worsen the washboard effect.

And while you're driving, be on the lookout for the new road signs on Timberlake Road.

Enjoy the rest of your summer,

*Mary Ann Armijo*

## Upcoming Events

### Mystic Bluffs Fly-in

**Saturday, August 20**

**7 am to noon**

### August Board Meeting

**Sunday, August 21 at 2 pm**

Offsite attendance via Zoom is now available, please visit the TRLA website for signup details.

### Labor Day Barbeque and Silent Auction

**Sunday, September 4**

**4:30 – 7 pm**

Quilt raffle drawing and winners announced

### Ongoing at the Ranch House:

**Book Room:** Tuesdays, 1-4 pm  
The Timberlake Book Room has hundreds of books and DVD's. Come on down!

## 2022 TRLA BOARD MEMBERS

*The election results are in!*

**President**

**MARY ANN ARMIJO**

Phone: 505.783.4190  
maryarmijo611@gmail.com

**Vice President & Director**

**LINDA PEDERSON**

Phone: 505.783.0908  
pete137@juno.com

**Treasurer**

**STEVE STEVENS**

Phone: 923.580.4291  
trlatreasurer@gmail.com

**Roads**

**JOE MARTINEZ**

Phone: 602.677.9625  
trlaroads@gmail.com

**Secretary**

**JUDI-McCLELLAN MURPHY**

Phone: 505.236.4552  
trlasecretary@gmail.com

**Commons, Architectural & Maintenance**

**STEVE WILLS**

Phone: 505.783.0122  
trlacommons@gmail.com

**Communications, Architectural & Maintenance**

**JULIE FARRELL**

Phone: 602.920.1384  
julie.farrell923@gmail.com

TRLA Webmaster:

TRLANeighborhood Watch:

Timberlake Times Newsletter:

wayner@alternatejourney.com

timberlakewatch@gmail.com

trlatimberlaketimes@gmail.com



## \* PLEASE READ! \* \*

### The following information may save you from losing your property in Timberlake!

Provided by Linda Pederson

Prompt and expeditious notification to landowners cannot occur if the TRLA Board does not have current phone numbers or emails. The TRLA Board is in the process of trying to communicate how important this is, as it saved three lots from being auctioned off on May 18<sup>th</sup>. **Regretfully, TRLA was unable to reach the owners of three other properties, and those went to auction.**

#### Property Taxes

- McKinley County property tax statements are mailed in October
- Cibola County property tax statements are mailed in November

If you do not receive a statement, **there is a problem**. Contact your county treasurer's office as soon as possible to get it corrected. Keep checking the Treasurer's website over time to make sure it gets updated.

#### Both Cibola and McKinley counties offer online tax payment services.

In order to pay online, you'll need your property tax code. Property tax codes can be obtained from TRLAacc5@gmail.com when given HOA Account number, which is your unit/block/lot.

#### Warranty Deeds

A Warranty Deed is recorded at the closing of escrow. **IMPORTANT:** Make sure that your address on the deed is correct before this information is recorded in your county! This process can take up to three months. **If the address was wrong on deed or you move, property tax statements will be returned undeliverable to Treasurer's Office.**



#### Delinquent Property Taxes and Auctions

After three years of nonpayment of property taxes, the NM Delinquent Property Tax Bureau takes charge and auctions will be scheduled according to the county. The state will issue a deed to the successful bidder.

This past May, both McKinley County and Cibola County auctions occurred after a long hiatus due to COVID. If you are interested in these auctions or want to make sure your property isn't listed, use this link: <https://www.tax.newmexico.gov/businesses/property-tax-overview/delinquent-property-tax-auctions>

### THERE IS NO RECOURSE FOR THE LANDOWNER.

Please take a moment to e-mail TRLA and contact your county treasurer's office with your correct mailing address and contact information.

**Cibola County**  
Treasurer's Office:  
[CLICK HERE](#)

**McKinley County**  
Treasurer's Office:  
[CLICK HERE](#)

### Community Events

#### 2022's "In the Ditch" pickup was a big success!

32 landowners participated on Saturday, June 25. All 38 miles of Timberlake side roads were covered, along with the main road from Highway 53 to the Box S, and both sides of Ramah Lake.



#### Ice Cream Social, July 3



**Random TRLA trivia:**  
**What is this?**  
 What was the purpose of this sandstone tower?  
 Answer on last page.

# LOOK AT THIS BEAUTIFUL QUILT!



The Timberlake Stitchers & Crafters have done it again!  
Handmade “Card Trick” block pattern quilt

Raffle drawing will take place at the  
Labor Day barbeque on Sunday, September 4.

*Quilt raffle tickets:* \$5 each or 3 for \$10

*Lap quilt raffle tickets:* \$1 each



To purchase raffle tickets, or to find out more about the Stitchers & Crafters group, please e-mail Barb Stevens: [sestevens1@gmail.com](mailto:sestevens1@gmail.com)

## Makers of Timberlake

by Rachel Schali, contact: [rachel.schali@gmail.com](mailto:rachel.schali@gmail.com) with suggestions for future "Makers of Timberlake" interviews

This month's interview is with Claire Schali, who is a designer and architecture student.

### Q. Who or what inspires you?

A. There's a lot of Japanese influence, the minimalist movement is really compelling and there's a long history of it in Asia. I'm also more influenced by more indigenous forms of architecture, the pueblo architecture, there's also similar forms of architecture coming out of Israel and Northern Africa, extremely ancient architecture. With urban design, it's kind of Asian minimalism and Scandinavian design. Also the great modernists, their work is extremely beautiful so I have to take inspiration from it. Tadeo Ando is pretty amazing as an architect, there's Mies Van der Rohe, oh, and the Eames have some fun work, Charles and Ray, also Alvar Alto.

### Q. Has growing up in challenging times affected how you design or your design philosophy?

A. I definitely want to be able to design for an atypical client. It would be fun to design for people with all the money in the world, but design is about developing solutions to problems and they're not the ones with the biggest problems right now. Hopefully in my future career I'll be able to do more altruistic work.

I also think that it's extremely important to be environmentally sensitive, be thoughtful about your material choices and your design choices, I need to think about what materials I use. How I design the building, so it uses less energy once it's running, so it's comfortable for the people without a lot extra happening. I want it to last a long time, so it doesn't become waste in a decade. Those things are all important, and those are values I've developed because of the current environmental issues.

### Q. What are some of your favorite projects?

A. The second semester [in an architecture degree] is fun. You've learned enough to create something compelling, and the school or the world doesn't expect you to create something that's possible, or even plausible. The site was in Marfa Texas, where the minimalist Donald Judd developed and kept a lot of his work. The downtown is a very quiet southwestern downtown. We were given a site right in the middle of it.

I had memories of growing up in a very quiet small town and being bored out of my mind, so I wanted to create something for children who live in Marfa. The requirement was that it would be an art gallery and would also house visiting artists. My proposal was that the visiting artists would also be art instructors.

I created this building that was a play of light, glass brick intermingled with clay brick. The facade would let light into the gallery space in a dappled way. There would be a more secluded basement level that would be a workshop for the students and the workshop would have an open courtyard. The model I built for it was really compelling, visually. It will always sit in my mind as ideas.



front of Marfa gallery model

## Makers of Timberlake (continued)

### Q. What are some of your favorite projects? (continued)

A: For my interior design stuff, my ex and I designed a couch together, a daybed really. It's heavily inspired by early modernist furniture with very clean sharp square lines. I did this move where the legs of the couch kind of wrap around the corners so at certain angles it's a bit floating in appearance. It's surprisingly comfortable for being uncomfortable looking (laughter).

It's all in the mattress, because it's a daybed. You can get away with it because of that. I designed it within 2 or 3 days, my ex fabricated it. He was in a welding class when he put it together. It feels like one of my more polished furniture pieces, like a completely thoughtful design. It was our couch for several years so that was kind of fun.



floating couch

### Q. How about one more architectural project.

A. It was strange project. It was part nuclear history museum and part workspace for government-employed philosophers. It was in downtown Albuquerque. I was heavily inspired by a project called Habitat 67. It's a project in Canada. It was a modular apartment building. There are block units that stack together, each unit has a private outdoor area. That was actually a student project a grad student designed. That one inspired me, and the Brutalist period inspired me. It's this period of building where you use monolithic concrete forms, and the presence of the building is very heavy and overpowering. It's kind of above you, top heavy. I created this building, where buildings are built against each other. It starts off as shallow concrete platforms on the ground, huge ones, and it builds up. It spills over the buildings on either side, in a heavy brutalist feeling. It's partially to mimic the shape of a mushroom cloud, and the interior was about using texture and light reflectivity. So much of the initial experience of the nuclear bomb was people describing intense black and the intense white, the deprivation of color and these extreme forms of light. I wanted to evoke some of that when walking through the museum.



diagram of nuclear museum interior light qualities

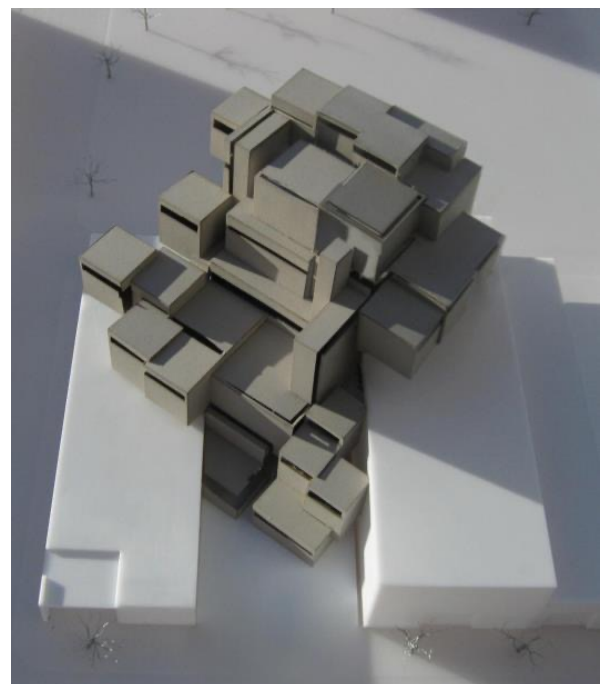

nuclear museum exterior model

# TIMBERLAKE VOLUNTEER FIRE DEPARTMENT



Sign up to automatically be notified of fire and emergency evacuation info by the incident/unified command personnel. The alert can go to a landline, cell or email. All types of emergencies (amber alerts, power outages, etc.) are included.

This system is the fastest and most efficient way to communicate to all landowners. Please register by clicking on your county:

[McKinley County](#)  
[Cibola County](#)



**Air Support** for the Banderas fire



**Driver Training:** Practicing for upcoming tests



**Engine training:** Rick Farrell, Bill Sanders, Wade Aubuchon



**Ladder practice,** Wade and Melinda Aubuchon test their optical illusion skills. Pretty good!

## ! PLEASE NOTE

When calling 9-1-1, tell the dispatcher that you need

**STATION 55**

to be dispatched.

Otherwise, first responders could be dispatched all the way from Grants.

- **Chainsaw usage** is permitted **before 10am and after 4pm**, provided water is on hand to put out any sparks or flames.
- **No burn permits**—This could change as drought conditions improve.
- The Timberlake burn pile is **NOW OPEN!** No stumps or logs.

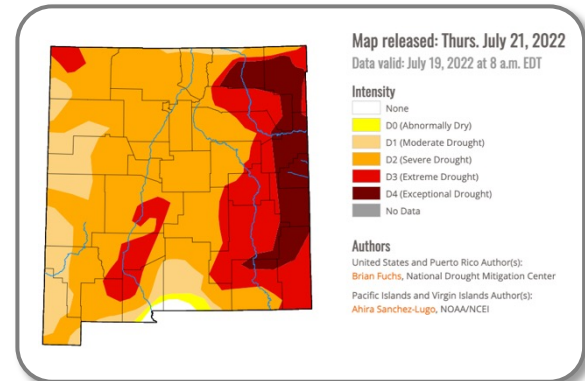



# Who's singing?



## Merlin Bird ID can tell you!

This free app is a great way to identify and learn more about the birds around you. If you hear a bird but can't see it, you can record and listen to the birds all around you. Merlin Bird ID shows real-time suggestions for who's singing, based on species likely to be in your area. Great at capturing songs and calls both near and far.

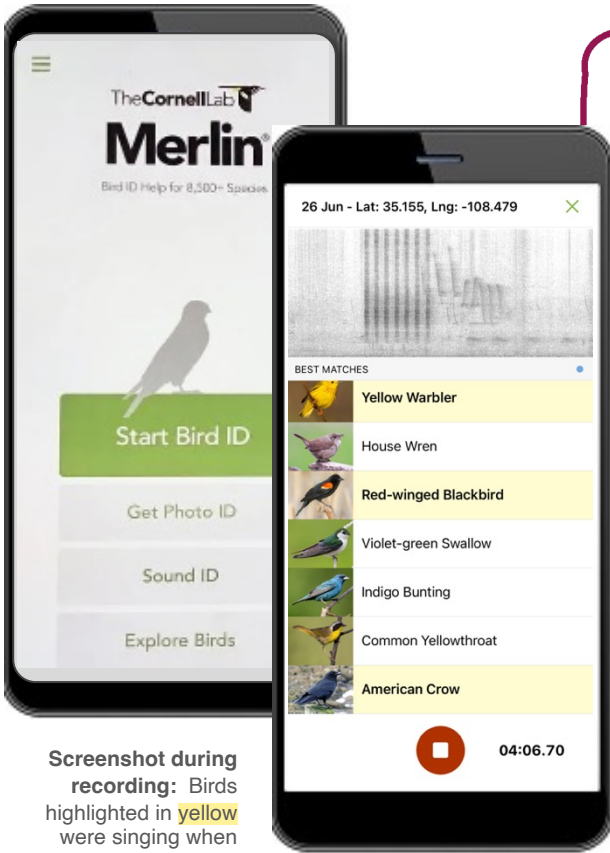

### These birds were all recorded in Timberlake!

	Cliff Swallow		Western Bluebird		Bullock's Oriole
	Barn Swallow		Common Raven		Hermit Thrush
	White-throated Swift		American Robin		Dark-eyed Junco
	Spotted Towhee		Cassin's Kingbird		House Finch
	Steller's Jay		Say's Phoebe		Lesser Goldfinch
	Pinyon Jay		Western Wood-Pewee		American Goldfinch
	Cedar Waxwing		Ash-throated Flycatcher		Song Sparrow
	Mourning Dove		Cassin's Vireo		Chipping Sparrow
	American Pipit		Plumbeous Vireo		Grace's Warbler
	Northern Flicker		Hepatic Tanager		Yellow-rumped Warbler
	Hairy Woodpecker		Black-headed Grosbeak		Orange-crowned Warbler
	Black-chinned Hummingbird		Mountain Chickadee		Red-faced Warbler
	Broad-tailed Hummingbird		Black-capped Chickadee		Western Meadowlark
	Rufous Hummingbird		White-breasted Nuthatch		Least Bittern
					Osprey

Screenshot during recording: Birds highlighted in yellow were singing when screenshot was taken.

### Identify Birds by description

Describe the bird, as shown in the steps below.

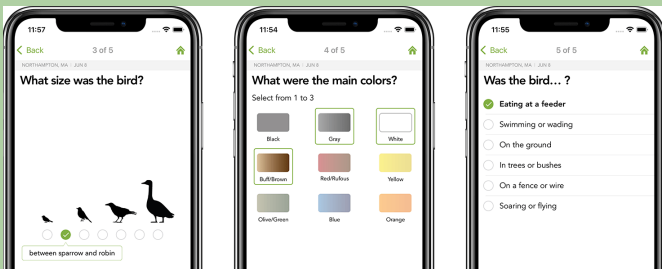

Merlin can identify 35,000 bird species worldwide.

### Learn more HERE:

<https://merlin.allaboutbirds.org/>

Or snap a photo of a bird, or pull one in from your camera roll, and Photo ID will offer a short list of possible matches. Photo ID works offline, so you can identify birds in the photos you take, no matter where you are.

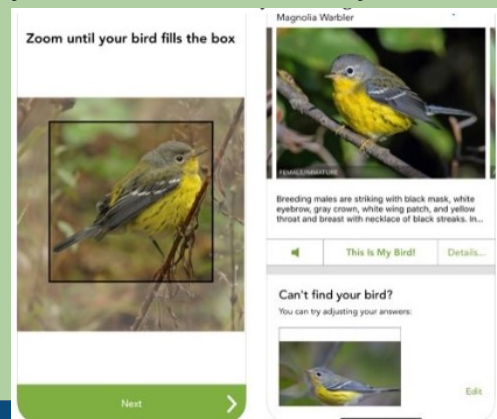

## BEAR AWARENESS

In the last several weeks, bears have been spotted in Timberlake and one bear has been captured and relocated after repeated encounters. The forest service does not like relocating bears because they do not usually survive.

**Unsecured garbage is the primary cause of most bear visits.**

### To discourage bears:

- Do not feed the birds during summer months
- Secure pet food and garbage in bear-resistant containers
- Travel in groups
- Keep your kids close and your pets leashed
- Make noise
- Carry bear spray
- Never approach or follow bears
- Don't block a bear's line of travel
- Maintain a safe distance
- Bring small pets in at night



**Keeping Bears  
Alive and  
Yourself Safe**

Guide to Living and  
Visiting Bear Country

[CLICK TO LEARN MORE](#)



TRLA BULLETIN BOARD



Random TRLA trivia:

What IS this?

Answer: A water heater!

This **very ominous-looking** photo was taken in the late 70s/early 80s and shows a large metal tank sitting on top of the sandstone structure next to the windmill.

According to ranch hands for the Cloh Chin Toh (Dent) Ranch, woodfires within the sandstone structure heated water for bathing. The tank was removed in the 90s and taken to the Dome house in Woodland Lakes by Chuck Lasley. Final location is unknown at this time.

Source: Linda Pederson

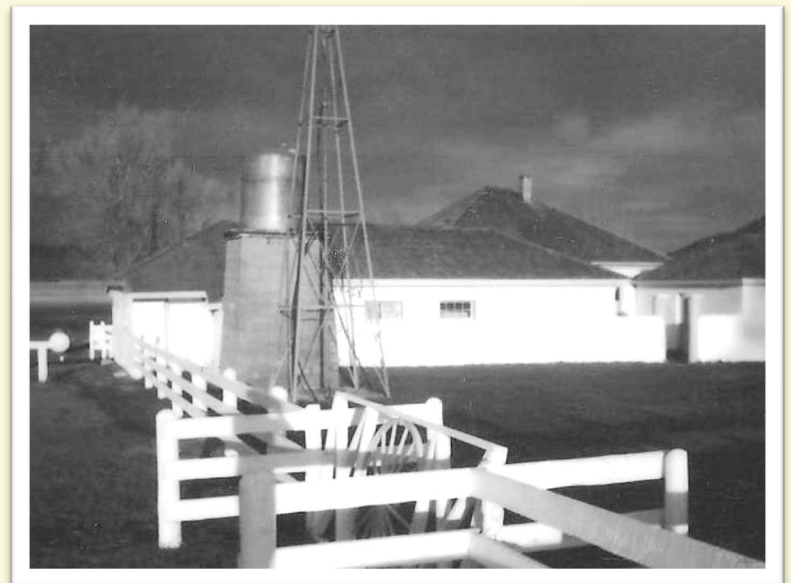

Stay Connected!

TRLA Website:  
<http://www.trnews.info/>

Timberlake Times Editors:  
[trlatimberlaketimes@gmail.com](mailto:trlatimberlaketimes@gmail.com)