

HP+™ Wall System E Series

Patent pending

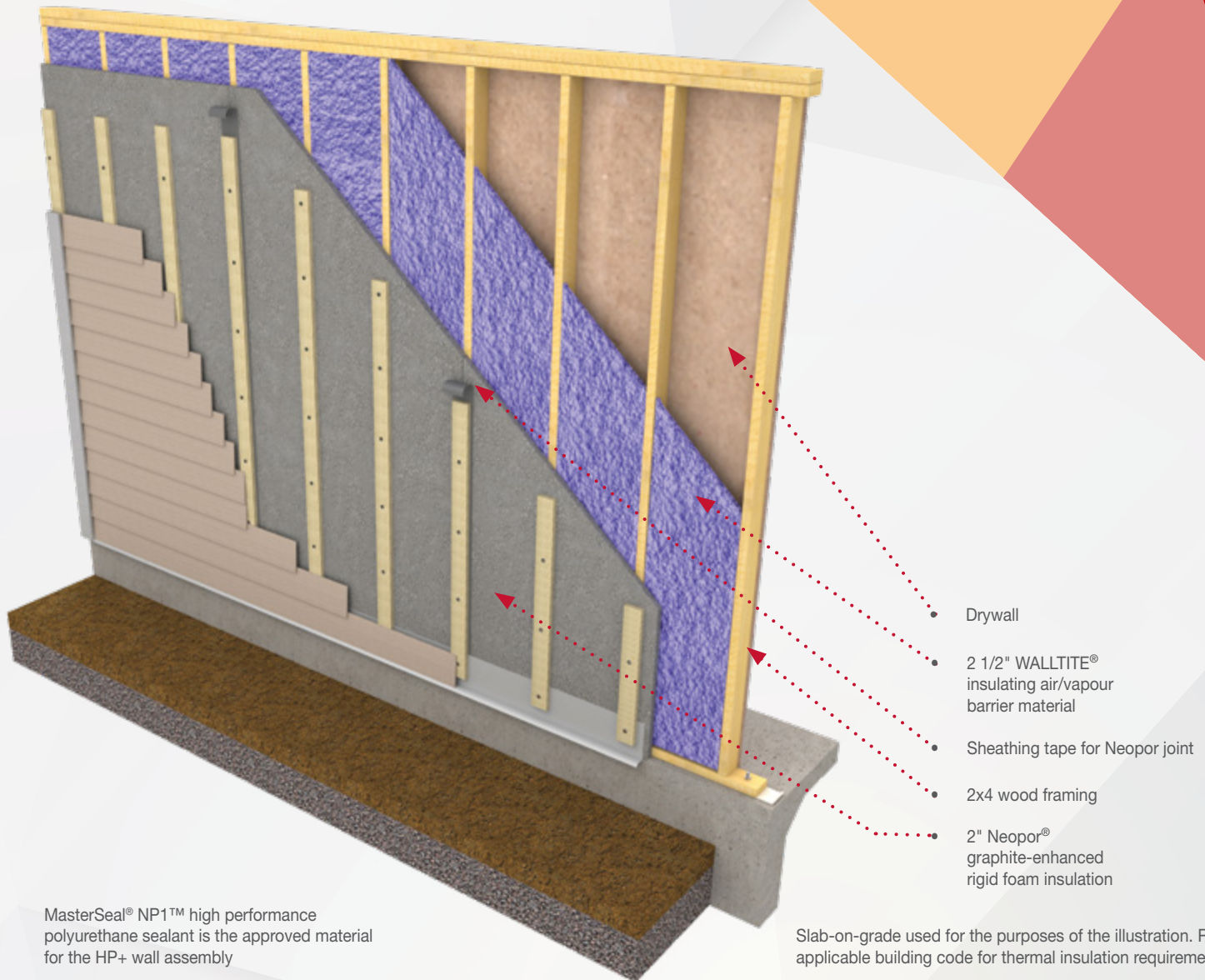

• Drywall

• 2 1/2" WALLTITE®
insulating air/vapour
barrier material

• Sheathing tape for Neopor joint

• 2x4 wood framing

• 2" Neopor®
graphite-enhanced
rigid foam insulation

MasterSeal® NP1™ high performance polyurethane sealant is the approved material for the HP+ wall assembly

Slab-on-grade used for the purposes of the illustration. Refer to applicable building code for thermal insulation requirements.

HP+ Wall System E Series is a strong structural assembly that meets or exceeds codes with a minimum nominal insulation R-value of R-25 up to R-32 with 2x4 wood framing. The E Series offers exceptional energy and cost efficiencies.

Build Stronger: Create a stronger wall assembly and use less wood than traditional construction

Build Smarter: Construct a wall assembly that incorporates continuous insulation and an air/vapour barrier system without the need for a conventional vapour or weather resistive barrier

Build Sustainable: Minimize energy loss with reduced air leakage and high R-values

 **BASF**

We create chemistry

Systematic Success.

The HP+™ Wall System E Series is designed to deliver a smart new way to build affordable, high performance homes.

The wall assembly features the following:

- 2x4 wood framing at 16" or 24" on center construction
- 2" Neopor® graphite-enhanced rigid thermal foam insulation. Also available in different thicknesses and R-values to fit your climate zone needs and code requirements
- MasterSeal® NP1™
- 2 1/2" WALLTITE® insulating air/vapour barrier material
- Extra room to add more WALLTITE for an increased R-value

The HP+ Wall System E Series is just one of the offerings in our growing portfolio of HP+™ Wall Systems to complete our groundbreaking BEYOND.High Performance® approach to construction. With BEYOND.High Performance, BASF provides you with the expertise and solutions you need to meet new and changing codes and build affordable, sustainable high performance homes.

Visit us at www.walltite.com
or call 1-866-474-3538 to learn more.

Data presented in this document is based on tests and information, which we believe to be reliable. This document is provided for information purposes only and without any representation, warranty or condition, expressed or implied, regarding its accuracy or completeness. Whether or not this data is used or relied upon is within the sole discretion and judgment of user. Since BASF Canada Inc. has no control over the conditions of handling, storage, use and disposal of the products, BASF Canada Inc., does not assume any responsibility or liability and expressly disclaims all liability for any claim, loss, damage, injury or expense resulting therefrom.

BEYOND.High Performance™ is a registered service mark of BASF.
HP+™ Wall System is a registered trademark of BASF Corporation. Patent pending.
WALLTITE® is a registered trademark of BASF Canada Inc.
Neopor® is a registered trademark of BASF SE, used with permission by BASF Canada.
MasterSeal® is a registered trademark of BASF SE, used with permission by BASF Canada.

© 2020 BASF Canada Inc.

+ Strength in Numbers

By combining 2x4 framing with foam sheathing and spray polyurethane foam in a composite design, the HP+ Wall System E Series can increase structural integrity while reducing lumber content and eliminating the need for plywood or OSB sheathing. When properly designed and installed, the HP+ Wall System can offer one of the best values available for residential construction. Benefits include:

- Can reduce lumber content by eliminating wood sheathing (plywood, OSB)
- Stronger wall with an increased lateral load resistance compared to a typical wall (studs and exterior wood sheathing)
- Improved moisture management that can mitigate thermal and structural issues; reducing potential builder callbacks

+ Build a Better Barrier: Thermal, Air, Water and Vapour Drive

With integrated thermal, air, water and vapour flow management in a single system, the HP+Wall System E Series provides an effective building envelope against severe Canadian climates.

- Provides higher thermal performance in 2 x 4 wood framing and interior square footage without increasing the building's footprint
- Reduces thermal bridging through continuous insulation which can also perform as a weather resistive barrier
- Creates a superior air and vapour barrier using WALLTITE and MasterSeal NP1

+ Tested wall assembly. Increased peace of mind.

The HP+ Wall System E Series has been tested by third party laboratories and reviewed by an independent engineering firm.

- The Technical Evaluation Report (TER) provides installation guidelines to build the HP+ Wall E Series assembly to meet the National Building Code of Canada's (2010 and 2015) structural and seismic load requirements
- The energy performance of the HP+ Wall E Series total assembly has been tested as per ASTM Standards
- HP+ Wall E Series total assembly has been tested for air leakage as per Standard CAN/ULC-S742

NOTE: To perform as per the Technical Evaluation Report (TER) the HP+ Wall System E series MUST follow the installation guidelines described in the TER.