

Dual-Air®

*The world's ONLY
Adjustable Oral Airway*

When time is critical, the Dual-Air® Adjustable Oral Airway offers the most choices:

- Easy and simple to measure, insert, and adjust
- Three airways replace eight OPAs
- More comfortable for the patient
- Does Not stimulate a gag reflex

Ventilation improved by:

- creating an enlarged opening
- decreasing bag-valve-mask (BVM) pressure
- decreasing gastric distention/insufflation
- allowing effortless suctioning of the back of the throat
- providing hands-free secure airway and/or bite block

FDA Registered

CONTACT US

www.nuzonemedical.com

dan@nuzonemedical.com

nuzonemedical@gmail.com

Patent # 8,297,275 B2

Patent # 8,931,477 B2

Cage Code

6JA31

DAPA SPO200-12-H-0014

*Scan the QR code to check
out our YouTube!*

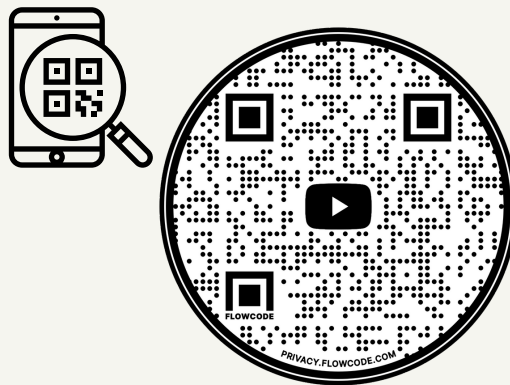

**NUZONE
MEDICAL**

It's time for a new tool in airway management! The **Dual-Air®** Adjustable Oral Airway's innovative patented design offers clinicians more options than traditional airways.

Experience the Dual-Air® difference in airway management.

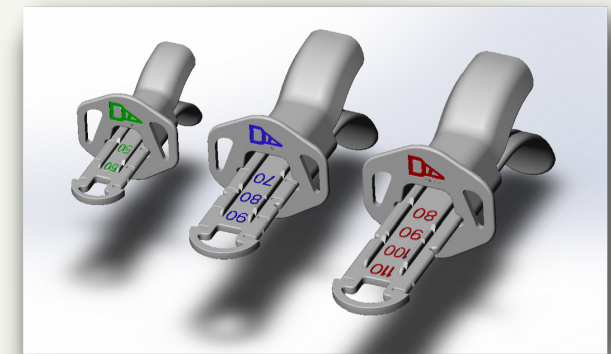

www.nuzonemedical.com

Why did we create the Dual-Air®?

Hello,

For years we have watched clinicians struggle with traditional airways. Many have stopped utilizing them altogether.

We at NuZone Medical, following American Heart Association (AHA) recommendations, felt it was time for a new airway. One you could actually work with!

We observed the current airways to be difficult to size correctly and insert; making them uncomfortable for the patient. Additionally, they do not allow for easy airway clearance.

In addition, if the patient's Level of Consciousness (LOC) improves, the traditional airways stimulate a gag reflex, making it necessary to remove the airway.

The Dual-Air® Adjustable Oral Airway provides solutions to many of the above mentioned situations and does so without stimulating a gag reflex in most patients.

Please visit our website for an instructional video which explores all of the Dual-Air's enhancements.

Sincerely,

Dan Ogilvie RRT, NPS, EMT, Inventor/ CEO

Beata Zawadzka RN-BSN, MBA, Inventor/CFO



The Dual-Air® comes in three sizes:

ALL ADJUST AND CLICK INTO THE FOLLOWING SIZES:

ADULT – 70, 80, 90, 100 mm
*with 5 mm half steps



PEDIATRIC – 50, 60, 70 mm
*with 5 mm half steps



EXTRA LARGE - 90, 100, 110, 120 mm
*also with 5 mm half steps

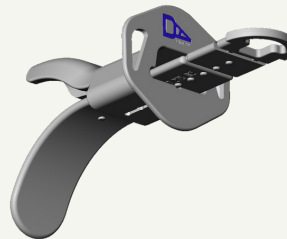

*The Dual-Air® Adjustable Oral Airway System replaces the current 8 piece array, allowing for less inventory, resolving storage issues, and improving accessibility.

How is this airway different than others?

IMPROVED VENTILATION:

The large opening of the Dual-Air® Adjustable Oropharyngeal Airway improves laminar airflow, reducing the amount of pressure needed to ventilate. This advancement decreases mask pressure in order to establish an adequate seal.

IMPROVED SUCTIONING CAPABILITIES:

The Dual-Air's® revolutionary design provides a large channel for suctioning which allows easy access for secretion management. This helps to eliminate the hazards of pulmonary aspiration. A 14fr suction catheter passes easily through the Dual-Air® Adjustable Oral Airway opening, as well as a Yaunker, bypassing the tongue and teeth.

NO GAG STIMULATION:

The main tongue deflector pulls the root of the tongue forward out of the Gag Zone. The Dual-Air® may be utilized on unconscious, semi-conscious, and alert patients.

