

NORCAR A7750 (TRACKED) MINI LOADER (SOCOTEC HOLDING 1NO.)

The Norcar a7750 design includes a centred lifting boom, and rubber tracks for minimum ground disturbance. Its centre articulation allows for tight manoeuvring and is the ideal support plant for any site investigation.

- Roll bar ROPS/FOPS, seatbelt
- Led work lights, front (roof)
- Float on the lifting boom
- Hand throttle / Foot throttle
- Digital display 4,3" dashboard information
- Suspension seat with armrest
- 1200mm forks fitted as standard
- Up to a 1200kg -1500kg lifting capacity (depending on counter weights)
- Track system fitted to reduce ground pressure and improve traction (wheels can be fitted on request).
- Can be supplied with operator, 4x4 and plant trailer
- A variety of attachments for the unit are available on request



| Contact: salesuk@socotec.com



NORCAR A7750 (TRACKED) MINI LOADER(SOCOTEC HOLDING 1NO.)

When being transported	
Length	3.75m
Width	1.60m
Height	2.28m
Maximum working	
Length	5.60m
Width	1.60m (depending on load/attachments)
Height	3.54m (depending on load/attachments)
Weight: 2600kg -2900kg (The above dose not include load/attachments)	

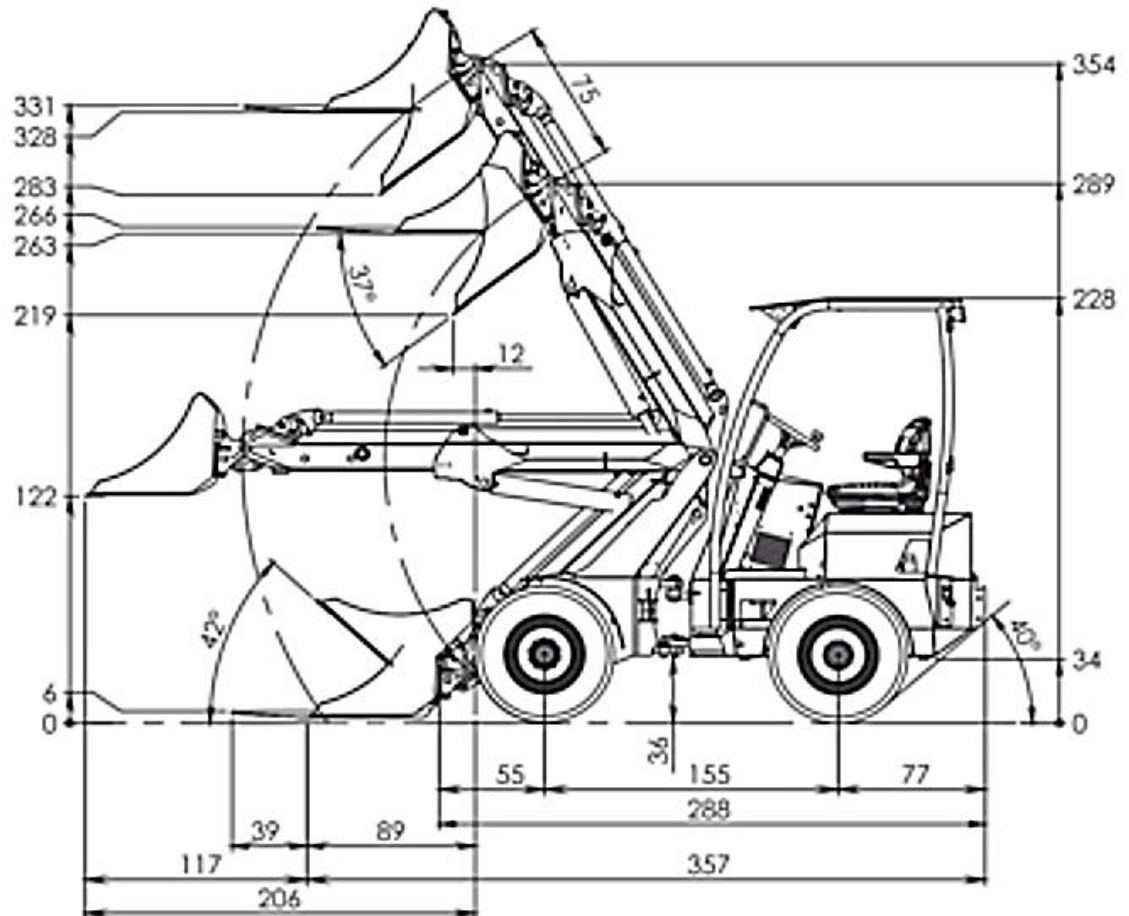

Contact: salesuk@socotec.com



WILDCAT CONCRETE CORING DRILL RIG

The Wildcat coring unit, crafted in-house, offers concrete coring capabilities with diameters reaching up to 450mm as a standard feature. Compatible with barrel lengths ranging from 200mm to 1m, it can operate using an integrated water tank or an external one, allowing for coring at various positions without frequent refills. It's an incredibly effective tool for all your concrete coring requirements on site.

Specifications include:

- ▶ Available with Chalwynne Valve and Spark arrestor for forecourt and refinery use.
- ▶ Inbuilt water pump for flush removal/barrel cooling.
- ▶ 2 stage mast for cuts up to 1m deep , also available with extension rods.
- ▶ Self propelled and mobilised to site in a 3.5t van.
- ▶ 800mm width for easy access through alleyways and doorways.
*with external water tank removed.
- ▶ Powered by a 30kW Diesel Hatz engine.
- ▶ Auxiliary hydraulic connections for use with breakers etc...
- ▶ 2 speed motor for barrels between 60mm and 450mm
- ▶ Can be adapted to suit non standard 600mm diameter barrels.



TRACK MOUNTED WATER CART

The Marooka tracked water carrier, equipped with rubber tracks, effortlessly transports up to 5700L of water across any site terrain. Designed for filling at ground-level, it eliminates the need for climbing or overreaching. Transport soakaway or flush water to your trial pit or borehole confidently, without the concerns of bogging common with traditional wheeled vehicles or 4x4s.

Capabilities include:

- ▶ Wide tracks for ground bearing pressure.
- ▶ Rubber tracks for use on site roads.
- ▶ Easy fill points that can be reached from ground level.
- ▶ Can be plumbed straight to the drill rig or used to fill flush tanks etc...



VACUUM EXCAVATION UNIT

This compact vacuum excavation unit is tailor-made for operation beneath forecourt canopies or in tight, challenging spaces. It's engineered for the safe excavation of pre-drilling inspection pits and is also suitable for positively identifying services and digging small trenches. Mounted on a 3.5-ton flatbed van, it's readily mobilisable to any required location. Equipped with an onboard water lance and compatible with an air compressor and air pick, this unit offers versatile functionality.

Specification includes:

- ▶ Inbuilt water tank and water lance.
- ▶ Tipping function to empty onto a soil pile or low sided skip.
- ▶ Low height for use on forecourts.
- ▶ Excavate up to 3m depth. *material dependant.
- ▶ Chalwynne valve and spark arrestor for use on forecourts and refineries.



COUNTER BALANCE TELEHANDLER

The compact design of this JCB telehandler makes it perfectly suited for sites with limited access, enabling quick and safe movement of equipment. It can be mobilised with qualified operator and is the ideal support plant for any medium to large scale site investigation.

Capabilities include:

- ▶ 2000kg lift capacity.
- ▶ 3m extending boom.
- ▶ Normal, crab and 4 wheel steer driving modes.
- ▶ Can be road registered and taxed for use on highways
- ▶ Auxiliary connections for use with road sweeps and other attachments.

