

# NORCAR A7750 (TRACKED) MINI LOADER (SOCOTEC HOLDING 1NO.)

The Norcar a7750 design includes a centred lifting boom, welded frame and metal engine hood and covers. Fitted with a 50 hp Stage V diesel engine, the Norcar a7750 provides superior pulling force and hydraulic power.

- Roll bar ROPS/FOPS, seatbelt
- Led work lights, front (roof)
- Float on the lifting boom
- Hand throttle / Foot throttle
- Digital display 4,3" dashboard information
- Suspension seat with armrest
- 1200mm forks fitted as standard
- Up to a 1200kg -1500kg lifting capacity (depending on counter weights)
- Track system fitted to reduce ground pressure and improve traction (wheels can be fitted on request).
- Can be supplied with operator, 4x4 and plant trailer
- A variety of attachments for the unit are available on request



| Contact: [salesuk@socotec.com](mailto:salesuk@socotec.com)



# NORCAR A7750 (TRACKED) MINI LOADER(SOCOTEC HOLDING 1NO.)

## When being transported

Length	3.75m
Width	1.60m
Height	2.28m

## Maximum working

Length	5.60m
Width	1.60m (depending on load/attachments)
Height	3.54m (depending on load/attachments)

**Weight: 2600kg -2900kg**  
(The above dose not include load/attachments)

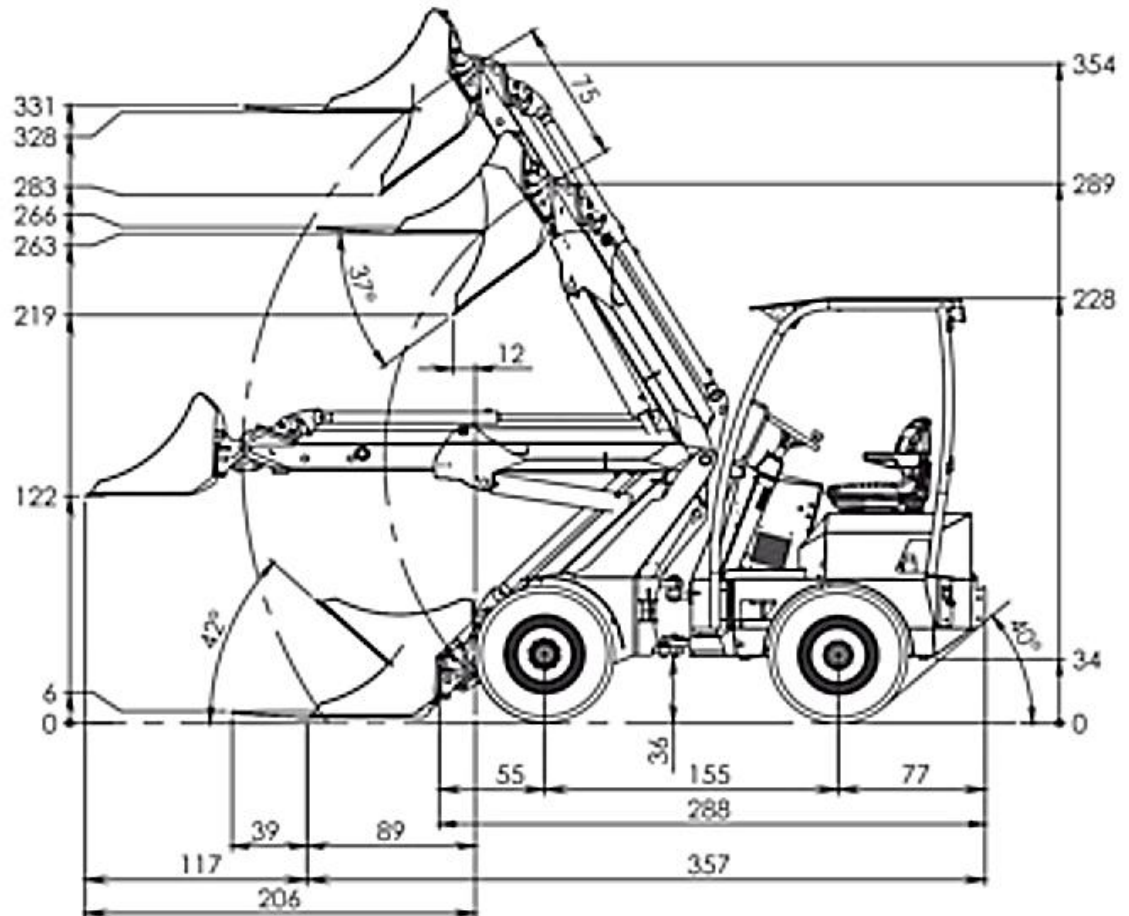

Contact: [salesuk@socotec.com](mailto:salesuk@socotec.com)