

Archaeological Watching Brief at Moat Lane, Ash, Kent

INVICTA ARCHAEOLOGICAL



S E R V I C E S L T D

IAS Report No: 11

Date: 16/09/2021

Invicta Archaeological Services Ltd

Tel: 07395941091

info@invictaarchaeology.com

www.invicta-archaeology.co.uk

Revision	Date	Author	Reason	Checked by
V1	03/09/2021	EB	Internal review	VB
V2	09/09/2021	EB	Edits	EEB
V3	12/04/2022	EB	Final draft	EEB

This report is confidential to the client. Invicta Archaeological Services Ltd accepts no responsibility or liability to any third party to whom this report, or any part of it, is made known. Any such party relies upon this report entirely at their own risk. No part of this report may be reproduced by any means without permission.

Contents

SUMMARY	1
1. INTRODUCTION	1
SITE BACKGROUND	1
PLANNING AND LEGISLATIVE FRAMEWORK	2
PLANNING BACKGROUND	2
ORIGIN AND SCOPE OF THE REPORT	2
2. ARCHAEOLOGICAL BACKGROUND	2
3. GEOLOGICAL/TOPOGRAPHICAL BACKGROUND	3
4. AIMS AND OBJECTIVES	3
5. METHODOLOGY	3
6. RESULTS	4
7. DISCUSSION	5
8. PUBLICATION AND ARCHIVING	5
9. PROJECT TEAM AND ACKNOWLEDGMENTS	5
10. REFERENCES	5
Appendix 1 – HER Summary sheet	13
Figure 1 – Site plan with area watched 1:500	
Figure 2 – Proposed development plan	
Plate 1 – General view of PDA, facing southwest	
Plate 2 – Trench section, facing east	
Plate 3 – General view of trenches, facing south	
Plate 4 – General view of trenches, facing north-north-west	
Plate 5 – General view of trenches, facing east-south-east	
Table 1 – Site archive quantification	

SUMMARY

An archaeological watching brief was carried out during groundworks for the erection of a single detached dwelling on land on the west side of Moat Lane, Ash. No archaeological features or deposits were encountered.

PROJECT LOCATION: Land on the west side of Moat Lane, Ash, Kent, CT3 2DG.

PROJECT DATE: 1st-2nd September 2021

NGR: TR 2893 68331

PLANNING REFERENCE: DOV/18/00643 & DOV/21/01732

1. INTRODUCTION

- 1.1 Invicta Archaeological Services Ltd carried out an archaeological watching brief in September 2021 at land west of Moat Lane, Ash, Kent on behalf of the landowner.
- 1.2 Dover District Council has granted permission for the erection of a single detached dwelling with paving to vehicle access and hard standing gravel driveway (DOV/18/00643) and the erection of a garage (DOV/21/01732).
- 1.3 The watching brief was carried out in accordance with Archaeological Specification compiled by Invicta Archaeological Services Ltd (2020), and the Institute of Field Archaeologists' Standards and Guidance for Archaeological Watching Briefs (CIfA 2014).

SITE BACKGROUND

- 1.4 The watching brief took place at land west of Moat Lane, Ash and hereafter called 'the site'. The site is located between Guilton and Each End south of the village of Ash. The centre of the site is at OS National Grid Reference (NGR) TR 2893 68331. The site lies at 17.98m OD, c.43m north east of the site on The Street. The site code is MLA-WB-21.

LEGISLATIVE AND PLANNING FRAMEWORK

- 1.5 The legislative and planning framework in which the archaeological exercise took place was summarised in the specification which formed the project design for the archaeological investigation (IAS 2020).
- 1.6 Due to the property being close to the proposed route of the Roman road from Canterbury to Richborough and within an area of archaeological importance, an archaeological watching brief was warranted to ensure that archaeological features and deposits are properly examined and recorded, and for any appropriate mitigation strategy to be designed and implemented.
- 1.7 The proposed development area (PDA) consisted of twelve foundation trenches. The maximum depth of the trenches cut was 2.30m, the natural geology being encountered at an average depth of 0.26-0.80m.

ORIGIN AND SCOPE OF THE REPORT

- 1.8 This report was commissioned by the landowner and produced by Invicta Archaeological Services Ltd (IAS). The report has been prepared within the terms of the relevant Standard specified by the Chartered Institute of Field Archaeologists (CifA 2014).
- 1.9 The purpose of the present report is to analyse the results of the watching brief against the original research aims, and to suggest what further work, including analysis or publication (if any), should now take place.

2. ARCHAEOLOGICAL BACKGROUND

- 2.1 A brief summary of the archaeological and historical background to the site was detailed in the WSI (2020) and is presented in brief below, having consulted the Heritage Gateway which records data held at the NMR Excavation Index and Kent Historic Environment Record (KHER) and the National Heritage List for England (NHLE).
- 2.2 Roman activity is known in the area of the PDA. In particular, a documented Roman road runs from Durovernum Cantiacorum (Canterbury) to Rutupiae (Richborough), which travels through the village of Ash, almost parallel to The Street before branching off north-east close to Hills Court

towards Richborough (Fig 2). This roman road lies approximately 90m to the North of the proposed development site (PDA). A Roman cremation cemetery and Anglo Saxon cemetery is also known c.740m to the west of the PDA near Gilton Mill (HER: TR 25NE270).

2.3 Later finds in the area include a large 18th or 19th century pit in the garden of Gilton Mill (HER:TR 25NE270).

2.4 The Church of St Nicholas, a Grade I listed building (TR 25 NE 89) is situated approximately 140 metres to the west of the PDA. The main construction periods of the church were 1170-1899, although it is currently unknown if there are earlier structures on the site. Predominantly of Norman architecture, Roman brick has been identified in the fabric of the building.

2.5 The National Heritage List for England (NHLE) have 46 listed buildings within 100m of the PDA. Predominantly Grade II listed buildings, all of these, except one, are to the north of the site, running alongside The Street on both sides, the closest being c.46m from the PDA. Approximately 117m to the south-west of the PDA, to the south side of Moat Lane, is Moat Farmhouse (TR25NE153), a Grade II listed building dating from 1500-1799AD.

3 GEOLOGICAL/TOPOGRAPHICAL BACKGROUND

3.1 The mapping of the British Geological Survey (BGS 2020) shows the solid geology of the site is Thanet Formation – Sand, Silt and Clay. Sedimentary bedrock formed approximately 56-59 million years ago in the Palaeogene period. The local environment was previously dominated by shallow seas. There are no recorded superficial deposits.

4 AIMS AND OBJECTIVES

4.1 The general aim of the watching brief, as set out in the specification, was to ascertain the extent, depth below ground surface, character, significance and condition of any archaeological remains in order to provide an assessment of the likely archaeological impact of the scheme.

5 METHODOLOGY

5.1 Elissia Burrows (BA Hons, MSc) attended site September 1st – 2nd 2021.

5.2 The fieldwork followed the methodology outline in the specification (WSI) by Invicta Archaeology Services Ltd. A competent archaeologist observed and controlled all intrusive groundworks. The foundations were excavated with an 8-tonne machine with a 0.60m flat bladed bucket. Entrance within the trenches was not undertaken due to their substantial depths.

5.3 Where archaeological deposits were encountered, machine excavation ceased and the deposits were hand excavated by the archaeologist. A written, photographic and graphic record was completed on IAS pro forma recording sheets, in accordance with CifA (2014) guidance. Spoil from the excavations was inspected by the attending archaeologist in order to recover any artefacts of archaeological interest.

5.4 The archive is currently being held at the IAS offices. A summary of the project information will be entered into the Heritage Environment Record (HER) database. The contents of the archive are tabulated below (Table 1).

Table 1 Quantification of the site archive

Number of contexts	2
Number of paper records	2
Digital photographs	20
Plan and section drawings	0
Environmental samples	0
Finds	0

6 RESULTS

6.1 The groundworks for the dwelling comprised of 12 trenches at varying lengths and depths. The trenches to the north and west were excavated to depths of 2m30 due to their proximity to a hawthorn tree.

6.2 No archaeological finds or features were encountered. The topsoil across the site had been stripped due to the previous construction debris and waste on the site.

6.3 A common stratigraphy was found across the site consisting of subsoil (100), dark grey silty clay with occasional construction debris and small chalk lumps. The subsoil capped the natural (101) which consisted of medium yellow/light grey silty clay with occasional natural flint nodules.

6.4 The groundworks for the detached garage did not impact the archaeological horizon as the base was floating on the topsoil and so no archaeological works were required.

7 DISCUSSION

7.1 No archaeological features or deposits were encountered. No finds were retrieved from the subsoil.

8 PUBLICATION AND ARCHIVING

8.1 Information on the results of the excavation will be made publicly available by means of a database in digital form, to permit inclusion of the site data in any future academic research into the development of Kent.

8.2 The site archive containing original records and finds will be stored in accordance with the terms of the specification (IAS 2020) within 12 months of the end of the excavation.

9 PROJECT TEAM AND ACKNOWLEDGMENTS

9.1 Fieldwork and the report was undertaken by Elissia Burrows (BA Hons, MSc, PhD Researcher).

The report was edited by Emily Brown (BA Hons). Invicta Archaeological Services Ltd would like to thank Mr Febery for allowing us access to the site.

REFERENCES

Historic Map National Library of Scotland

Historic Environment Record (HER).

CifA (2014) Standards and Guidance for Archaeological Watching Briefs.

CifA (2014) Standard and guidance for archaeological excavation.

© Invicta Archaeological Services Ltd

Cifa (2014) Standard and guidance for the creation, compilation, transfer and deposition of archaeological archives.

Cifa (2019) Code of Conduct.

Invicta Archaeological Services Ltd (November 2020) specification for a watching brief at land south of Moat Lane, Ash, Kent.

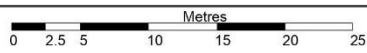
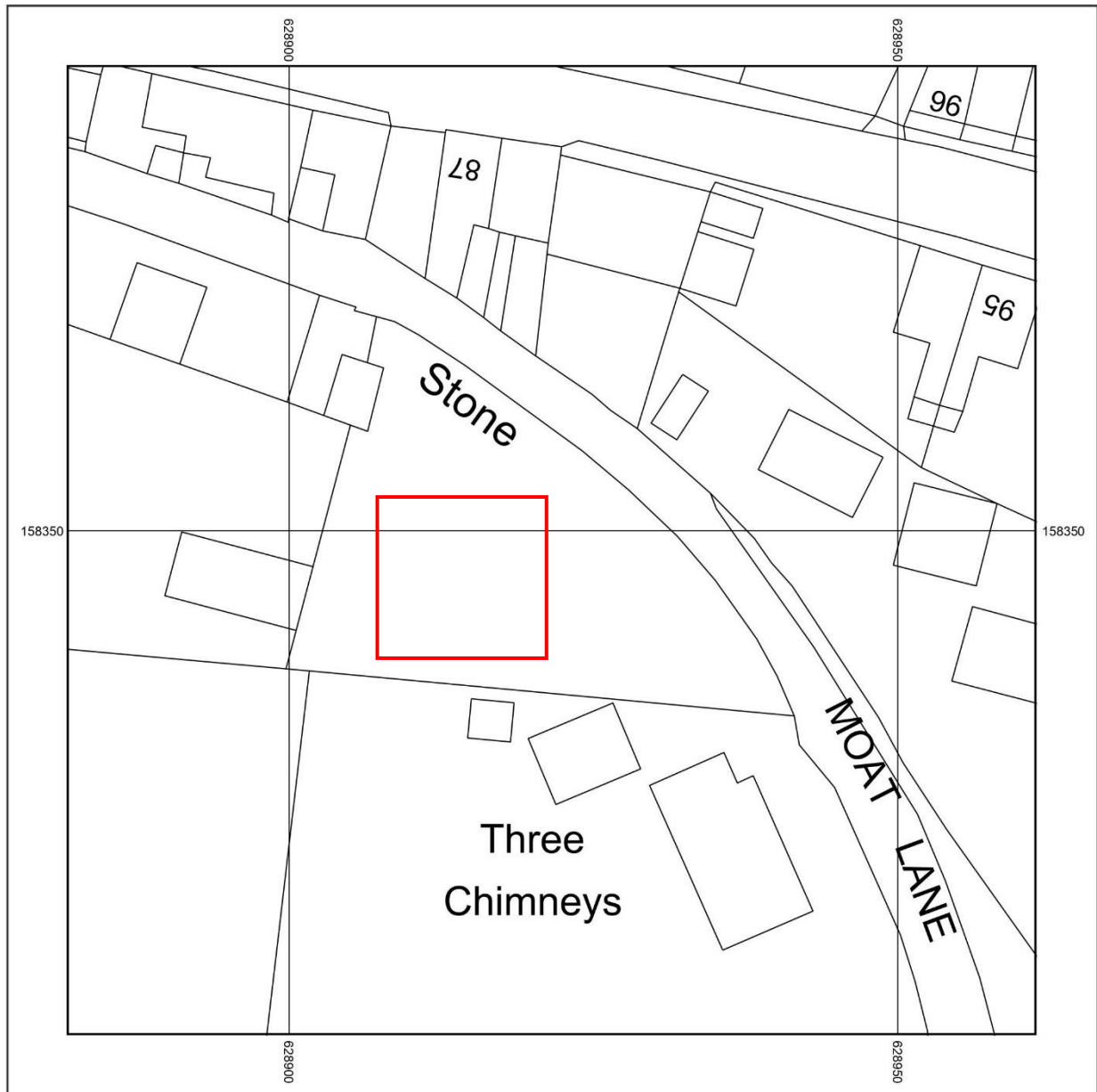

Scale: 1:500



Supplied by: National Map Centre
License number: 100031961
Produced: 14/09/2021
Serial number: 77150

LAND WEST OF MOAT LANE
ASH
CT3 2DG

Plot centre co-ordinates: 628922,158349
Download file:
Project name: Invicta_MoatLane_500

© Crown copyright and database rights 2021. OS 100031961

Figure 1 Site location with area watched in red

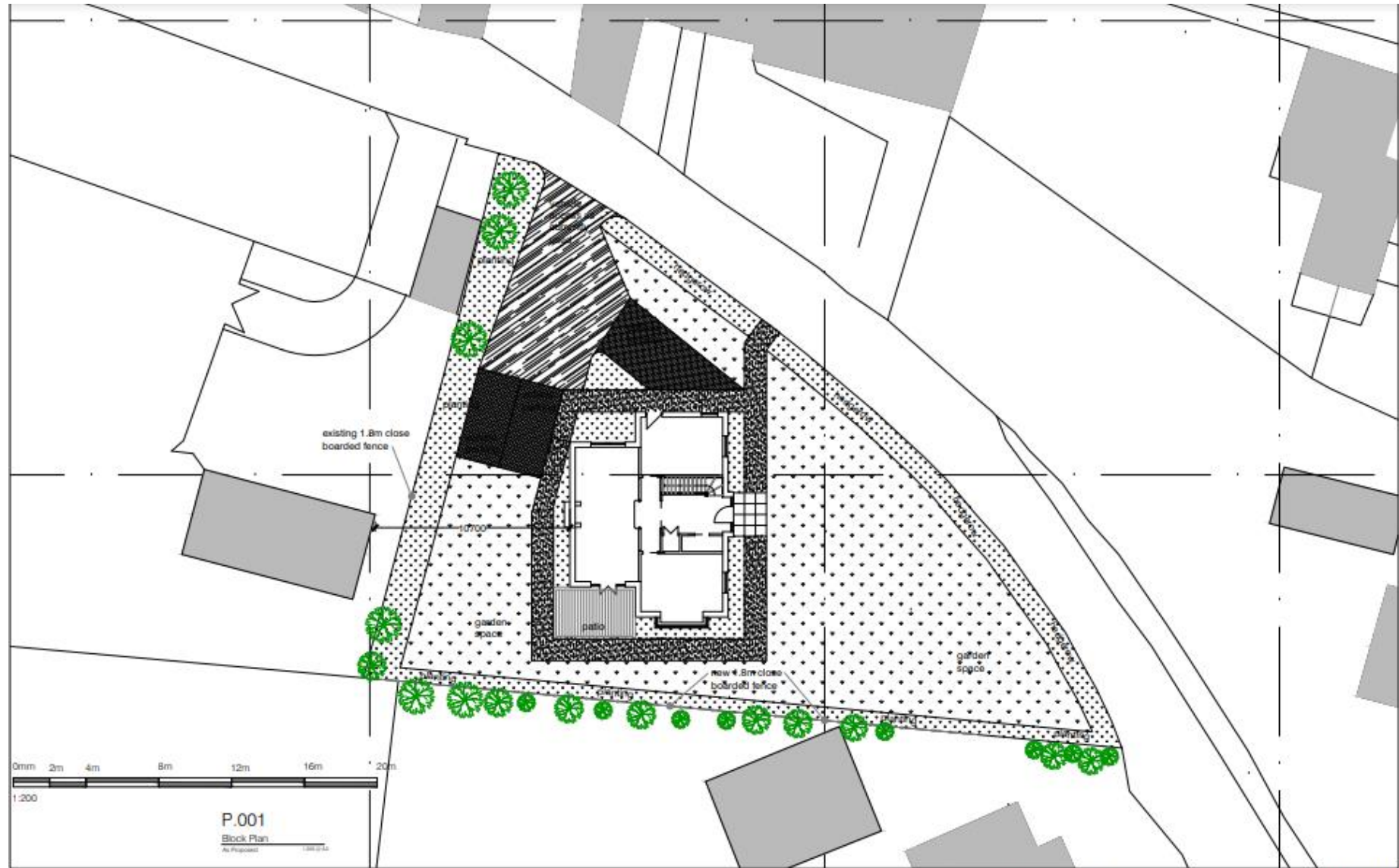

Figure 2 Proposed development plan (NFA Architects)

Rev	Date	Comments

Approved by Client, date.

Job No 5019
 Land between Holly House
 & Three Chimneys
 Most Lane, Ash, Kent

Planning
 Proposed Site Plan
 As Shown @ A3
 Drawing No
 5019-P-011



Plate 1 General view of PDA looking south-west



Plate 2 Trench section, facing east



Plate 1 General view of trenches, facing south



Plate 2 General view of trenches, facing north-north-west



Plate 3 General view of trenches facing east-south-east

Appendix 1 – HER Summary sheet

Fieldwork type.	Watching Brief
Site type.	N/A
Date of fieldwork.	1 st -2 nd September 2021
Sponsor/client.	Mr Mark Febery
Project manager.	Elissia Burrows
Project supervisor.	Elissia Burrows
Period summary	N/A
Project summary. (100-word max)	An archaeological watching brief was undertaken by Invicta Archaeological Services Ltd to monitor groundworks associated with a single detached dwelling on land west of Moat Lane, Ash, Kent. The watching brief revealed no archaeological features or deposits.