

New External Wall Construction

300mm Overall construction fire stopped at eaves comprising:
 Outer leaf to be 100mm Stone block to match existing.
 100mm cavity Full filled with Ultimate 32 Dnitherm cavity insulation continued at least 150mm below top of floor insulation. Detail complies with Robust detail 4.14

Inner leaf to be 100mm Celcon Solar standard block to achieve minimum unfinished mass of 120kg/m2.

Cavity closers around openings to provide 30min fire resistance & to provide thermal resistance path of 0.45sqmK/W. Overlap closer with frame by min 30mm and apply sealant to front & back of frame/sills. Detail complies with Robust detail 4.12

New wall to be connected existing using Stalfix Universal Wall starter system.

Internal Finishes -

External walls to be dry-lined with a 12.5mm plasterboard on dabs and 2.5mm skim finish (25mm overall thickness) or 12.5 base coat and 3mm plaster skim.

Construction achieves 0.28W/sqmK.

Wall Ties -

250mm lg Ancon ST1 wall ties to be provided at max.750mm horizontal and 450mm vertical c/s (reduce to 225mm c/s at opening reveals, movement joints and verges)

Damp Proof Courses -

All horizontal and vertical dpc's to be in accordance with current British Standards, and provided as necessary & as indicated on working & timber frame specialists drawings. External leaf dpc to be minimum 150mm above adjacent ground level. Where ground level is higher, an additional horizontal dpc is to be provided where shown on elevations, 150mm above main dpc

Proprietary closers to doors and windows to have minimum thermal resistance path of 0.45m2K/W

Provide Code 4 lead flashings and soakers to all roof/wall abutments. Stepped cavity trays to be pre-formed proprietary type with stop ends and weep holes, where steps in buildings occur

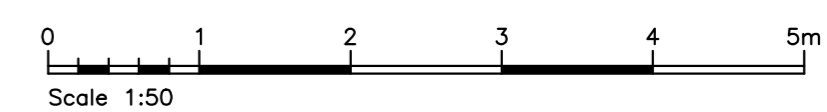
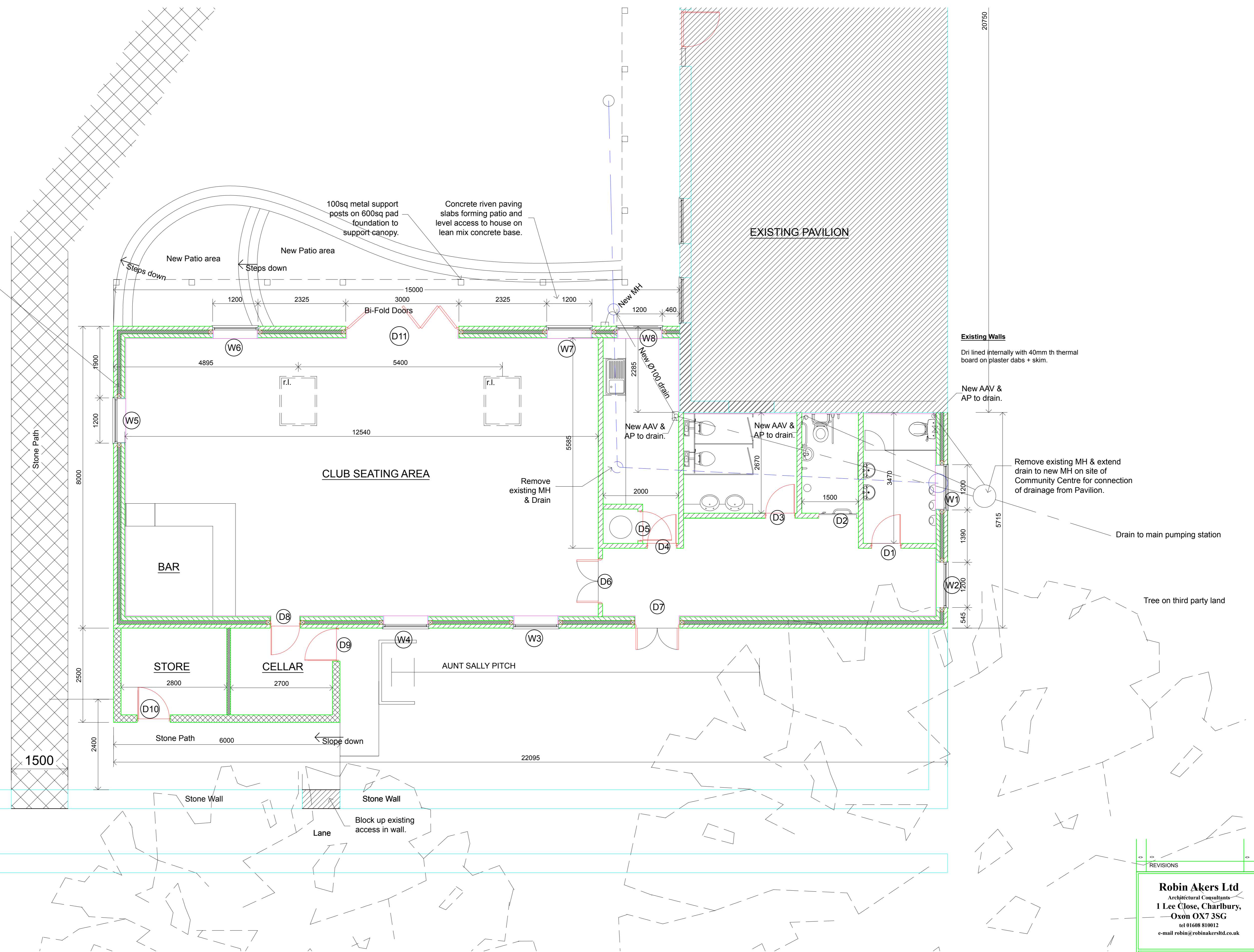

| | |
|---|---------------------------|
| Robin Akers Ltd Architectural Consultants 1 Lee Close, Charlbury, Oxon OX7 3SG tel 01608 810012 e-mail robin@robinkersltd.co.uk | |
| JOB: Extension to Pavilion Nine Acres Playing Fields Charlbury | |
| DRAWING: Floor Plan | |
| DRAWN: SCALES: 1:50@A1 | CHECKED: DATE: 8.12.17 |
| JOB No. | DRAWING No. REV. BR1 |