

MasterSeal® 974, 975 and 976

Polypropylene drain board systems

FORMERLY SONOSHIELD® DBS 2000, 6200, AND 9000

PACKAGINGMASTERSEAL 974 AND 975
4 by 50 ft (1.2 by 15.2 m) rollsMASTERSEAL 976
6 by 50 ft (1.8 by 15.2 m) rolls**YIELD**MASTERSEAL 974 AND 975
200 ft² (18 m²) per 4 by 50 ft
(1.2 by 15.2 m) rollMASTERSEAL 976
300 ft² (27 m²) per 6 by 50 ft
(1.8 by 15.2 m) roll**COLOR**

Black

DESCRIPTION

MasterSeal 974, 975 and 976 constitute a series of polypropylene drain board systems that significantly reduce the amount of water coming into contact with the waterproofing membranes, relieve hydrostatic pressure, and extend the life of the waterproofing system.

MASTERSEAL 974

A cost-effective, high-strength polymeric core and non-woven geotextile filter fabric for vertical installations at shallower depths where moderate compressive strengths and flow capacity are adequate.

MASTERSEAL 975

Offers vertical drain solutions, incorporating a plastic sheet adhered to the back surface of the drain core. This offers a protective layer that prevents die cutting of the waterproofing membrane.

MASTERSEAL 976

A high-strength drain board ideally suited for horizontal applications. It utilizes a high-strength woven monofilament filter fabric that offers ideal drainage and support under concrete, soil and beddings.

PRODUCT HIGHLIGHTS

- High-impact polypropylene core provides the toughest drain system available
- Dimpled core construction helps produce high water-flow rates
- Fully bonded geotextile fabric prevents blockage of the core
- Water-flow control relieves hydrostatic pressure on buildings and extends the life of waterproofing systems

APPLICATIONS**MASTERSEAL 974**

- Retaining walls
- Tunnel construction
- Bridge abutments
- Vertical substrates

MASTERSEAL 975

- Foundation walls
- Plaza decks
- Planter boxes
- Lagging walls
- Below grade with MasterSeal HLM 5000
- Vertical and horizontal substrates

MASTERSEAL 976

- Horizontal substrates
- Plaza decks
- Planter boxes
- Garden roofs and terraces
- Split-slab construction
- Parking decks

Technical Data

Typical Properties

| PROPERTY | VALUE |
|---------------------------------|---------------|
| Roll weight, lbs (kg) | |
| MasterSeal 974 | 56 (25) |
| MasterSeal 975 | 64 (29) |
| MasterSeal 976 | 70 (32) |
| Material (filter fabric) | |
| MasterSeal 974 | Nonwoven PP * |
| MasterSeal 975 | Nonwoven PP * |
| MasterSeal 976 | Woven PP * |

* PP - Polypropylene

Test Data

| PROPERTY | RESULTS | TEST METHOD |
|---|--------------|-----------------------|
| Core weight, oz/ft² (g/m²) | | ASTM D 3776 |
| MasterSeal 974 | 2.45 (750) | |
| MasterSeal 975 | 2.75 (830) | |
| MasterSeal 976 | 3.05 (930) | |
| Compressive strength, psf (kN/m²) | | ASTM D 1621, modified |
| MasterSeal 974 | 11,000 (550) | |
| MasterSeal 975 | 15,100 (723) | |
| MasterSeal 976 | 18,000 (862) | |
| Thickness, in (mm) | | ASTM D 1777 |
| MasterSeal 974 | 0.40 (10) | |
| MasterSeal 975 | 0.40 (10) | |
| MasterSeal 976 | 0.40 (10) | |

FILTER FABRIC PROPERTIES—MINIMUM AVERAGE ROLL VOLUME

| PROPERTY | RESULTS | TEST METHOD |
|--|-------------|-------------|
| Grab tensile, lbs (N) | | ASTM D 4632 |
| MasterSeal 974 | 110 (0.49) | |
| MasterSeal 975 | 110 (0.49) | |
| MasterSeal 976 | 365 (1.62) | |
| Elongation, % | | ASTM D 4632 |
| MasterSeal 974 | 50 | |
| MasterSeal 975 | 50 | |
| MasterSeal 976 | 24 | |
| Trapezoidal tear, lbs (N) | | ASTM D 4533 |
| MasterSeal 974 | 50 (0.22) | |
| MasterSeal 975 | 50 (0.22) | |
| MasterSeal 976 | 115 (0.511) | |
| Puncture strength, lbs (N) | | ASTM D 4833 |
| MasterSeal 974 | 65 (0.29) | |
| MasterSeal 975 | 65 (0.29) | |
| MasterSeal 976 | 105 (0.47) | |
| Mullen burst, psi (kPa) | | ASTM D 3786 |
| MasterSeal 974 | 215 (1,482) | |
| MasterSeal 975 | 215 (1,482) | |
| MasterSeal 976 | 480 (3,304) | |
| Apparent opening size, sieve size (mm) | | ASTM D 4751 |
| MasterSeal 974 | 70 (0.21) | |
| MasterSeal 975 | 70 (0.21) | |
| MasterSeal 976 | 40 (0.42) | |
| Permittivity, sec⁻¹ (sec⁻¹) | | ASTM D 4491 |
| MasterSeal 974 | 2.0 (2.0) | |
| MasterSeal 975 | 2.0 (2.0) | |
| MasterSeal 976 | 1.36 (1.36) | |
| Water flow rate, gpm/ft² (L/min/m²) | | ASTM D 4491 |
| MasterSeal 974 | 140 (5690) | |
| MasterSeal 975 | 140 (5690) | |
| MasterSeal 976 | 100 (4074) | |
| Weight typical, oz/yd² (g/m²) | | ASTM D 5261 |
| MasterSeal 974 | 4.0 (135) | |
| MasterSeal 975 | 4.0 (135) | |
| MasterSeal 976 | 6.5 (216) | |

Test Data (continued)

FILTER FABRIC PROPERTIES—MINIMUM AVERAGE ROLL VOLUME

| PROPERTY | RESULTS | TEST METHOD |
|-----------------------------------|---------|-------------|
| UV resistance, % (500 hrs) | | ASTM D 4355 |
| MasterSeal 974 | 70 | |
| MasterSeal 975 | 70 | |
| MasterSeal 976 | 70 | |

COMPOSITE SYSTEM

| PROPERTY | RESULTS | TEST METHOD |
|--|----------|-------------|
| Water-flow rate (V), gal/min/ft (L/min/m) | | ASTM D 4716 |
| MasterSeal 974 | 18 (223) | |
| MasterSeal 975 | 18 (223) | |
| MasterSeal 976 | 27 (334) | |
| Water-flow rate (H), gal/min/ft (L/min/m) | | ASTM D 4716 |
| MasterSeal 975 | 3.2 (40) | |
| MasterSeal 976 | 5.4 (67) | |

HOW TO APPLY

SURFACE PREPARATION

Surfaces to receive drain board should be relatively smooth and free of sharp or protruding objects.

INSTALLATION

INSTALLATION ON VERTICAL SURFACES— MASTERSEAL 974 AND 975

1. Install MasterSeal 974 and 975 with the filter fabric side facing away from the wall so that backfill will be placed against the fabric. Cut panels to appropriate size using utility knife or scissors.
2. To install all panels, use a suitable bonding system that is compatible with the substrate. Typical installation of MasterSeal 974 and 975 over a cured waterproof membrane requires using an adhesive, two-sided mastic tape or a suitable MasterSeal sealant to hold the board in place. Backfilling at the end of installation completes the permanent placement.
3. To install panels longitudinally, start the first lift of drain panel at the bottom of the application area to ensure sound drainage. Install the next lift of drain panel by overlapping the panel's flat tab section onto the previously installed drain board. Complete the attachment by pulling the excess filter fabric down over the previously installed panel. This installation method will automatically create a step-down (shingle fashion) lap to properly drain water. Enclose all ends of the drainage panel with the attached fabric. Wrap the fabric over top drain board to prevent earth infiltration. The bottom of the panel should be placed behind the discharge pipe.

4. To install panels vertically, follow the same procedure for overlapping the panels. Work from one side of the application area to the other, keeping the fabric side out and the lap consistent.
5. Ensure that fabric covers all exposed core edges.
6. Place backfill as soon as possible after installation. Take care not to damage the drain panels during backfilling.

INSTALLATION ON HORIZONTAL SURFACES— MASTERSEAL 975 AND 976

1. The substrate below the MasterSeal 975 and 976 panels should have a minimum 2% slope.
2. Install drain panel with the filter fabric side up.
3. Adhere the drain panel at 10 ft (3.3 m) centers using two-sided mastic tape when necessary.
4. Overlap the sheets using the flat tab sections of each. Overlap the fabric onto the preceding panel and adhere the overlapped fabric with adhesive tape if necessary to prevent soil, sand, and concrete from entering the panel during construction.
5. Start the installation at the lowest point to ensure sound drainage and to create a shingling effect in the installation.
6. Overlapping of MasterSeal 975 and 976 panels in horizontal installations must take slope and water flow into account. Drain panels must be shingled in the direction of the water flow using sound waterproofing practices.
7. Ensure that fabric covers all exposed core edges.
8. Place backfill as soon as possible after installation. Take care not to damage the drain panels during backfilling.

FOR BEST PERFORMANCE

- Do not expose drain panel rolls to direct sunlight for prolonged periods.
- Ensure any exposed core area is covered with filter fabric.
- Repair tears or holes in the fabric by placing new cloth over damaged areas.
- In horizontal applications where reinforcing steel is to be placed, spread foot type rebar chairs or wide plastic bar holders are recommended. Repair any damage caused during steel installation.
- When the panels are cut around termination protrusions or planter installations, be sure to cover all cut areas with extra pieces of filter fabric to prevent intrusion. Cut sections generally require a 4–6" (100–150 mm) overlap.
- Use scissors or utility knives to cut drain panels. For cutting entire rolls, a cut-off saw with a carbide blade is recommended.
- Protect the installation's finished surface from damage by rocks or debris during construction and backfilling.
- Backfill should be placed as soon as possible after the drain panel installation.
- MasterSeal 974, 975 and 976 are made from highly chemical-resistant polypropylene and are suitable for use in a variety of applications. For specific chemical environments, contact BASF Technical Service to determine suitability.
- Proper application is the responsibility of the user. Field visits by BASF personnel are for the purpose of making technical recommendations only and not to supervise or provide quality control on the job site.

LIMITED WARRANTY NOTICE

BASF warrants this product to be free from manufacturing defects and to meet the technical properties on the current Technical Data Guide, if used as directed within shelf life. Satisfactory results depend not only on quality products but also upon many factors beyond our control. BASF MAKES NO OTHER WARRANTY OR GUARANTEE, EXPRESS OR IMPLIED, INCLUDING WARRANTIES OF MERCHANTABILITY OR FITNESS FOR A PARTICULAR PURPOSE WITH RESPECT TO ITS PRODUCTS. The sole and exclusive remedy of Purchaser for any claim concerning this product, including but not limited to, claims alleging breach of warranty, negligence, strict liability or otherwise, is the replacement of product or refund of the purchase price, at the sole option of BASF. Any claims concerning this product must be received in writing within one (1) year from the date of shipment and any claims not presented within that period are waived by Purchaser. BASF WILL NOT BE RESPONSIBLE FOR ANY SPECIAL, INCIDENTAL, CONSEQUENTIAL (INCLUDING LOST PROFITS) OR PUNITIVE DAMAGES OF ANY KIND.

Purchaser must determine the suitability of the products for the intended use and assumes all risks and liabilities in connection therewith. This information and all further technical advice are based on BASF's present knowledge and experience. However, BASF assumes no liability for providing such information and advice including the extent to which such information and advice may relate to existing third party intellectual property rights, especially patent rights, nor shall any legal relationship be created by or arise from the provision of such information and advice. BASF reserves the right to make any changes according to technological progress or further developments. The Purchaser of the Product(s) must test the product(s) for suitability for the intended application and purpose before proceeding with a full application of the product(s). Performance of the product described herein should be verified by testing and carried out by qualified experts.

HEALTH, SAFETY AND ENVIRONMENTAL

Read, understand and follow all Safety Data Sheets and product label information for this product prior to use. The SDS can be obtained by visiting www.master-builders-solutions.basf.us, e-mailing your request to basfbscst@basf.com or calling 1(800)433-9517. Use only as directed.

**For medical emergencies only,
call ChemTrec® 1(800) 424-9300.**

FOUNDATION WALLS

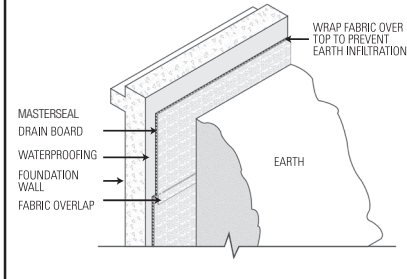

PLANTER

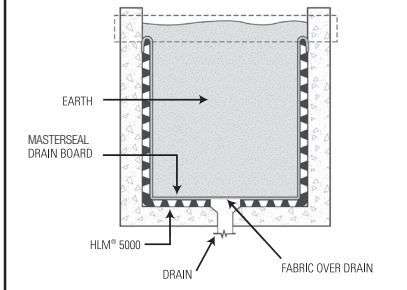

RETAINING WALL

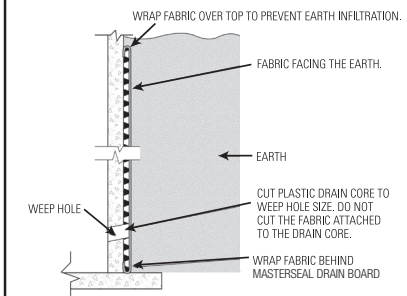

PLAZA DECKS

