

landscaping notes

Final location of all plant material and plant beds shall be approved in the field by the Owner or Architect.

All plant material (unless otherwise described) shall be planted in four (4) parts topsoil to one (1) part peat moss planting mix.

All ground cover beds shall be excavated 6" below proposed grade and replaced with 6" layer of one (1) part topsoil in one (1) part peat moss planting mix.

All shrub masses and ground cover shall be planted in staggered rows.

All plant beds shall be mulched with 4" minimum layer of shredded bark mulch except ground cover areas which shall be mulched with 2" layer of shredded bark. All areas to receive shredded bark mulch shall be treated with an approved pro-emergent weed killer to be applied as per manufacturers specifications.

All edging shall be metal edging; install flush with top of mulch and/or lawn areas as specified.

All areas denoted as Hydro-seed shall consist of a composition of 40% Kentucky Blend, 40 Rye.

All sod areas shall be fine graded and sodded with Class 'A' nursery sod. Seed composition of sod shall consist of 40 Creeping Red Fescue, and 20

All quantities listed on plans are figured as accurately as possible. It remains the Contractors responsibility to verify and provide quantities to complete the job as indicated on the drawings.

Automatic Lawn Irrigation System shall be installed in all areas noted as Hydro-seed, Sod, and Plant Bedding Areas.

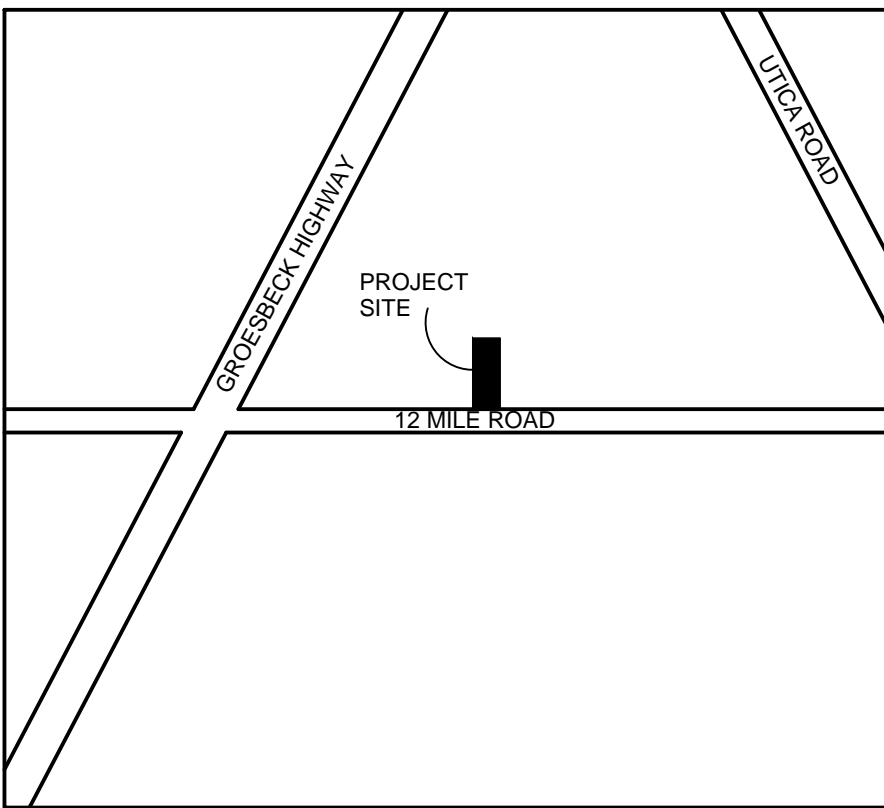

Note:

All lawn areas to be sodded and maintained.

All sodded and landscaped areas to be serviced by an irrigation system.

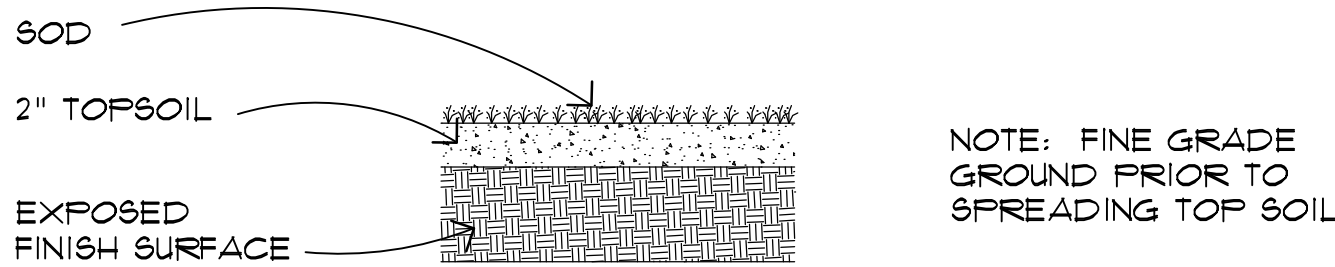

sod detail

no scale

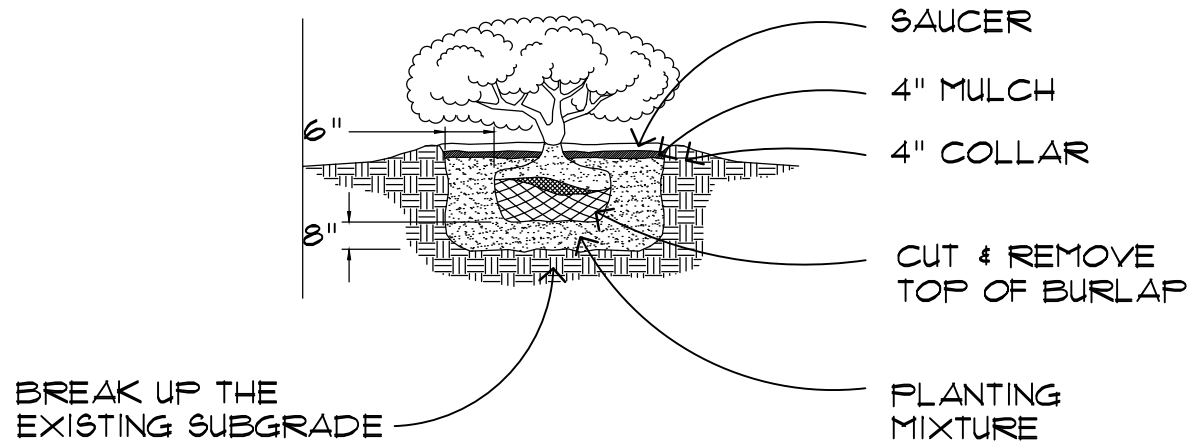

shrub planting detail

no scale

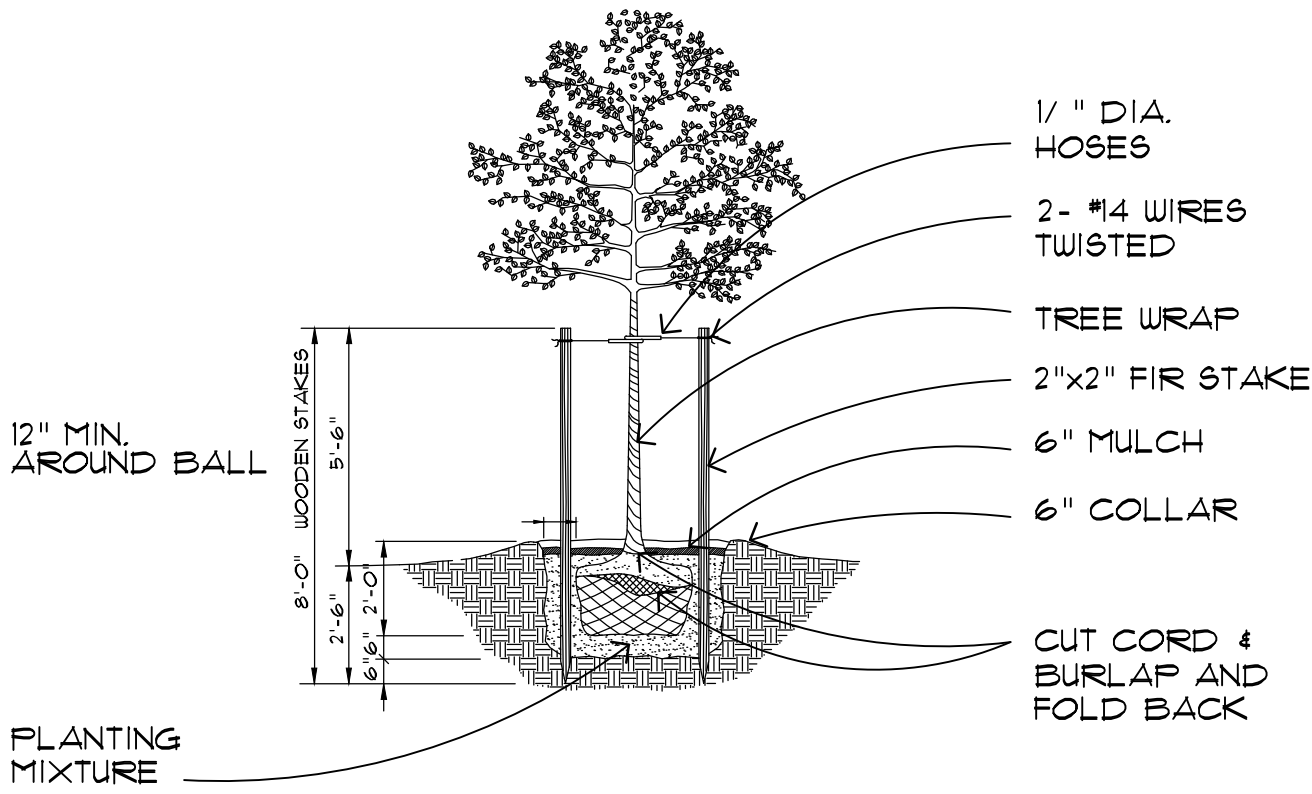

deciduous tree planting detail

no scale

Plant List

Key	Qty	Botanical / Common Name	Size	Spacing	Root	Mulch
<b>Trees</b>						
Ap	4	Acer platanoides 'Columnaris' Columnar Norway Maple	3 1/2" cal.	15' o.c. min.	B&B	4" depth
As	4	Acer saccharum 'Legacy' Legacy Sugar Maple	3 1/2" cal.	15' o.c. min.	B&B	4" depth
<b>Shrubs</b>						
To	6	Thuja occidentalis 'Arborvitae'	8' ht.	3' o.c.	B&B	4" depth
Ea	10	Euonymous alatus 'Compacta' Dwarf Burning Bush	36" min. ht.	3' o.c.	B&B.	4" depth
Jc	1015	Juniperus chinensis 'Sea Green' Sea Green Juniper	18" wide	4' o.c.	Cont.	4" depth

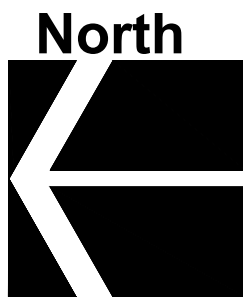
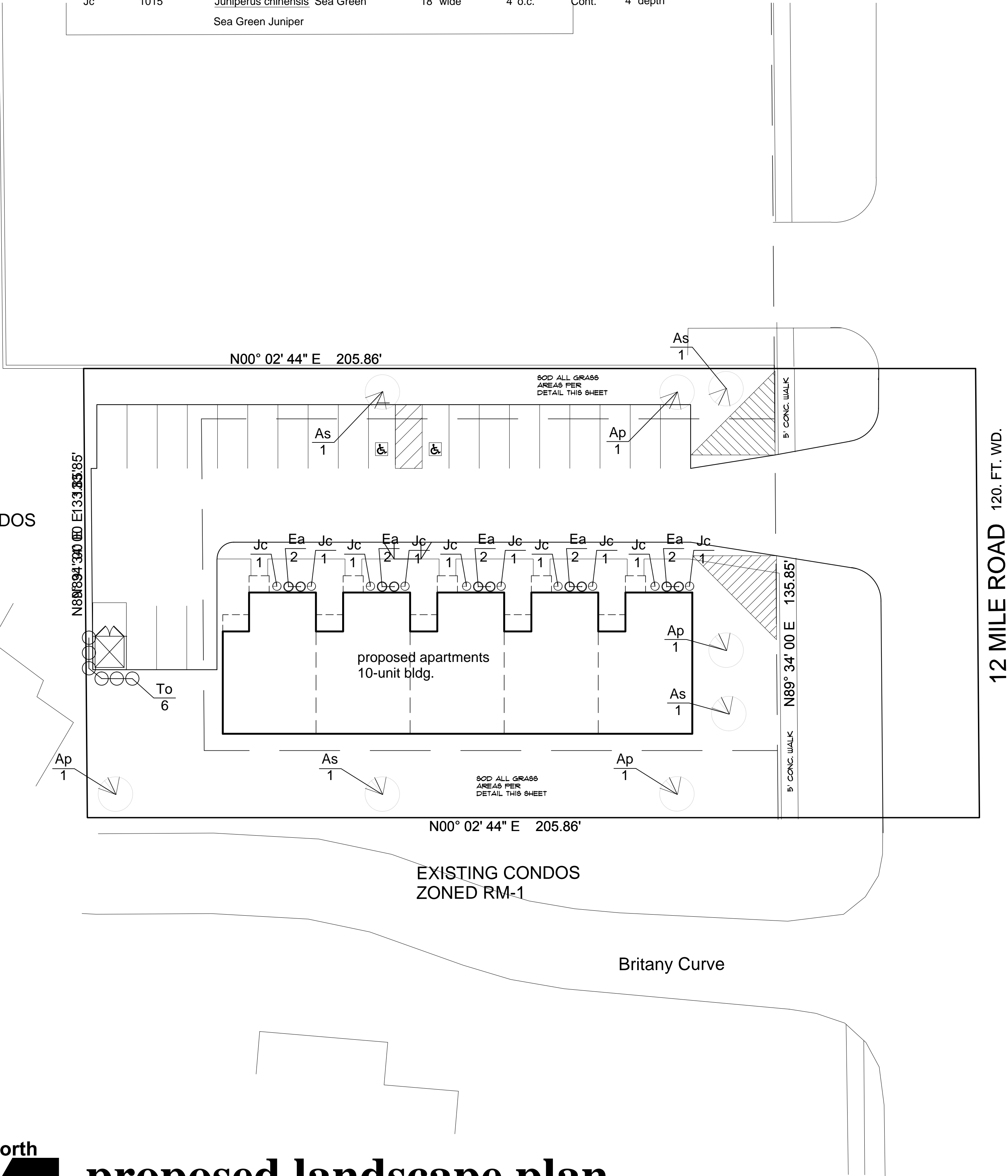

proposed landscape plan

1" = 20.0"

Legal Description

SEC. 1, T1N, R13E., COMMEN CITY AT THE S.E. CORNER OF SEC. 1; THENCE S. 89°34' W. 190.22' TO POINT OF BEGINNING; THENCE S. 89° 34' W. 133.85'; THENCE N. 00°02'44" E. 265.86'; THENCE N. 89°34' E. 133.85'; THENCE S. 00°02'45" W. 265.86' TO POINT OF BEGINNING.

Frank Salamone architects engineers planners

48701 hayes road shelby, mi 48315 566.254.1007

© 2015 - FRANK SALAMONE ARCHITECT INC. ALL RIGHTS RESERVED. THESE PLANS AND DRAWINGS ARE OWNED BY AND THE SOLE PROPERTY OF FRANK SALAMONE ARCHITECT INC. ANY REPRODUCTION, COPYING, REUSE, OR DISTRIBUTION OF THESE PLANS AND DRAWINGS IS STRICTLY PROHIBITED WITHOUT THE PRIOR WRITTEN CONSENT OF FRANK SALAMONE ARCHITECT INC.

Date Issued:

S.P.A.: 06/07/18

S.P.A.: 05/16/18

Project:

Proposed Apartment Complex Parcel I.D. 14-07-476-031

Client:

12 Mile Roseville L.L.C. 52457 Cheswick Ct. Shelby, MI 48315

Floral

Sheet Title:

PROPOSED LANDSCAPE PLAN

Project Number:

M05-245

Drawn By:

C.G.

Checked By:

F.S.

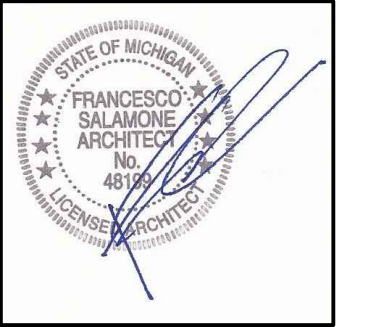

Issue:

preliminary construction record

Sheet Number:

L-1