

# DOOR & DRAWER COMBO UPRIGHT REACH-INS

## Top Mounted Condensing Unit

ER,ERF - Series



▲ ER74-1S2D



▲ ER126-2S2D



▲ ER126-2S4D



▲ ERF126-2S2D  
▲ (Dual Temp)



▲ ERF150-2S2D  
▲ (Dual Temp)

### Cabinet Construction

- Heavy duty stainless steel interior / exterior with rounded corners for a hazard-free workspace.
- Galvanized steel top, bottom and rear.
- 2.5" thick high density polyurethane insulation.
- Four 5" swivel casters with locks on front set. Leg stabilizers standard for model ER74-1S2D

### Refrigeration System

- Top mounted, self-contained and fully detachable Blizzard R290 condensing unit uses environmentally friendly, EPA-compliant R290 refrigerant with zero (0) Ozone Depletion Potential (ODP) and three (3) Global Warming Potential (GWP). Blizzard R290 is easily replaceable and requires no on-site brazing.
- Electronically commutated (ECM) fan motors achieve rapid cooling with less energy consumption.
- Full-length air duct system and airflow guard ensure optimal circulation of cold air.
- Time-initiated and temperature-terminated auto defrost cycle for seamless operation.
- Large capacity, corrosion-resistant condenser and evaporator coils.
- Self-maintaining, energy-efficient condensate drain pan requires no external drains or electric heaters.
- High performance, auto-reverse condenser fan motor supports compressor ventilation and condenser coil cleaning. Refer to owner's manual for full maintenance instructions.
- Pressure relief devices allow smooth access to cabinet interior when re-opening doors.
- Pre-wired and ready to plug, 240V/50Hz/1Ph, 10amp Australian plug

### Lighting

- Energy efficient silicone coated and shatter-proof LED lighting provides bright, high color illumination with low heat output.

### Doors

- Heavy duty stainless steel interior / exterior.
- 2.5" thick high density polyurethane insulation.
- Frame heaters prevent exterior moisture build up.
- Self-closing with adjustable torsion system for a positive seal.
- Thick gauge, stainless steel drawer frames with low-friction ball bearings.
- Snap-in magnetic door and drawer gaskets make cleaning and replacement an easy process.
- High strength, recessed door handles.
- Pre-installed door locks keep your items safe from theft (does not apply to drawers).

### Shelving

- Epoxy coated, steel wire shelves (see table for quantity).
- Height adjustable stainless steel clips.

### Temperature Control

- Multi-function digital controller with easy to read LED display.
- Factory preset temperature, 2°C for refrigerators and -20°C for freezers.
- Audible overheat protection alarm for compressor and condenser coil.

### Options

- Additional shelving.
- 3" swivel casters with locks.
- 3.5" – 6" height-adjustable and interchangeable legs.

## Dimensions

### ABS Legs



Two additional front adjustable stainless steel clad ABS legs for model ER74-1S2D to provide extra stability when opening and closing doors.



Equipped with 10amp Australian Plug

### Side View

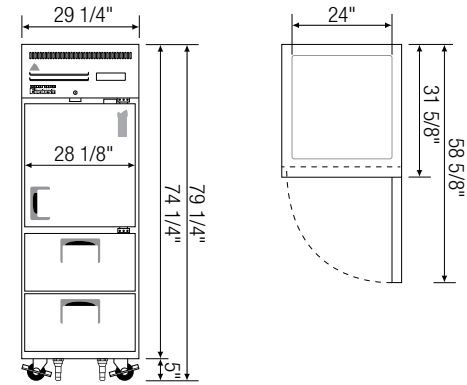
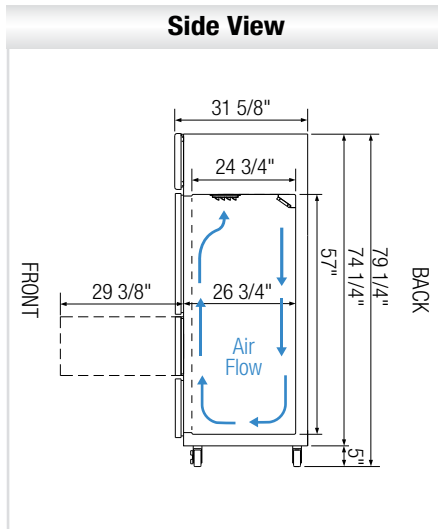

▲ ER74-1S2D

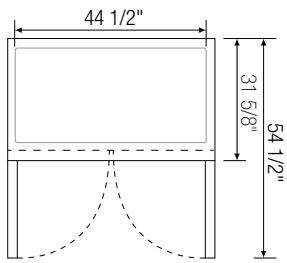

▲ ER126-2S2D

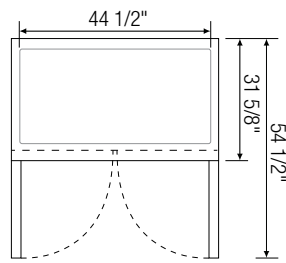

▲ ER126-2S4D

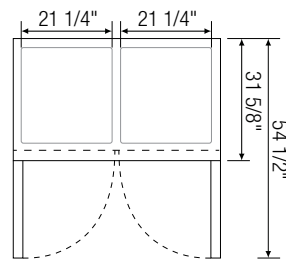

▲ ERF126-2S2D  
(Dual Temp)

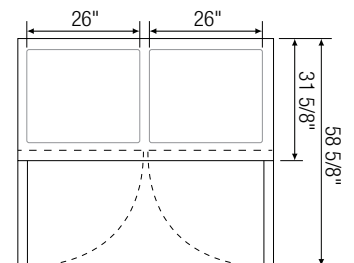

▲ ERF150-2S2D  
(Dual Temp)

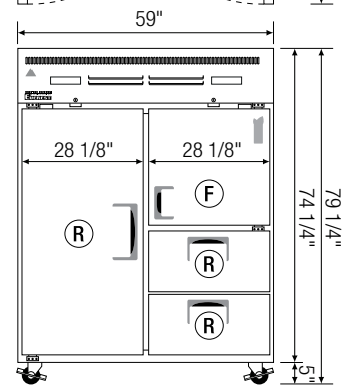
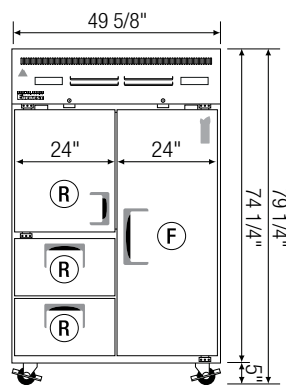
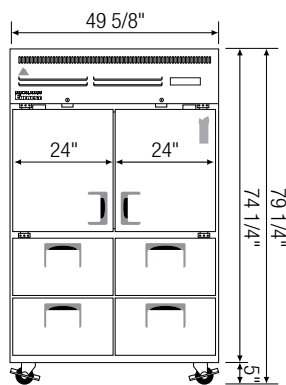
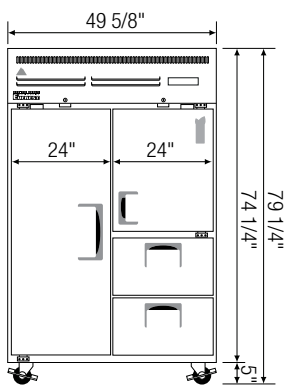

Model	Ref/ Frz/ Dual	# of Doors	Capacity <sup>†</sup> (Liters)	HP	BTU/HR <sup>†</sup>	Refrigerant	# of Shelves	Power (V-Hz-Ph)	Crated Weight (KG)	Exterior Dimensions (Inches)		
										L	D	H*
ER74-1S2D	Ref	1 (H) 2 (DR)	651	1/4+	1,926	R290	2	240-50-1	154	740	803	1910
ER126-2S2D	Ref	1 (FD) / 1 (H) 2 (DR)	1359	1/3	2,311	R290	5	240-50-1	210	1260	803	1910
ER126-2S4D	Ref	2 (H) 4 (DR)	1359	1/3	2,311	R290	4	240-50-1	217	1260	803	1910
ERF126-2S2D	Dual	1 (FD) / 1 (H) (R) / 2 (DR)	622 622(F) 1	1/4+ (R) 1/2 (F)	1,926 (R) 1,670 (F)	R290 R290	5	240-50-1	238	1260	803	1910
ERF150-2S2D	Dual	(FD) / 1 (H) 2 (DR)	1104 (R) 368 (F)	1/4+ (R) 1/3 (F)	1,926 (R) 2,311 (F)	R290 R290	4	240-50-1	252	1500	803	1910

\*: Height does not include 5" for casters.

†: Based on evaporating temperature of 23°F (-5°C) & condensing temperature of 131°F (55°C).

Ref = Refrigerator | Dual = Ref & Frz Combo  
(H) = Half Door | (FD) = Full Door | (DR) = Drawer

Specifications subject to change without notice.

Product dimensions are for general purposes and not absolute value. Product capacity (†) is calculated based on standard industry figures. Slight variations may exist. If dimensions and capacity are critical, please contact Austune Refrigeration.

Blizzard R290 replacement is at the sole discretion of Everest Refrigeration.



Please visit our website for more information  
<http://www.austunecommercial.com/>