

UPRIGHT REACH-IN REFRIGERATORS

Top Mounted Condensing Unit



ER SERIES

Upright Reach-Ins
(Top Mount)



▲ ER74-1



▲ ER74-2



▲ ER126-2



▲ ER126-4



▲ ER150-2



▲ ER190-3

Cabinet Construction

- Heavy duty stainless steel interior / exterior with rounded corners for a hazard-free workspace.
- Galvanized steel top, bottom and rear.
- 2.5" thick high density polyurethane insulation.
- Four 5" swivel casters with locks on front set.

Refrigeration System

- Top mounted, self-contained and fully detachable Blizzard R290 condensing unit uses environmentally friendly, EPA-compliant R290 refrigerant with zero (0) Ozone Depletion Potential (ODP) and three (3) Global Warming Potential (GWP). Blizzard R290 is easily replaceable and requires no on-site brazing.
- Electronically commutated (ECM) fan motors achieve rapid cooling with less energy consumption.
- Full-length air duct system and airflow guard ensure optimal circulation of cold air.
- Time-initiated and temperature-terminated auto defrost cycle for seamless operation.
- Large capacity, corrosion-resistant condenser and evaporator coils.
- Self-maintaining, energy-efficient condensate drain pan requires no external drains or electric heaters.
- High performance, auto-reverse condenser fan motor supports compressor ventilation and condenser coil cleaning. Refer to owner's manual for full maintenance instructions.
- Pressure relief devices allow smooth access to cabinet interior when re-opening doors.

Lighting

- Energy efficient silicone coated and shatter-proof LED lighting provides bright, high color illumination with low heat output.

Doors

- Heavy duty stainless steel interior / exterior.
- 2.5" thick high density polyurethane insulation.
- Frame heaters prevent exterior moisture build up.
- Self-closing with adjustable torsion system for a positive seal.
- Snap-in magnetic door gasket make cleaning and replacement an easy process.
- High strength, recessed door handles.
- Pre-installed door locks keep your items safe from theft.
- Field reversible (does not apply to model ER126-4).

Shelving

- Three epoxy coated, steel wire shelves per section.
- Height adjustable stainless steel clips.

Temperature Control

- Multi-function digital controller with easy to read LED display.
- Factory preset temperature, 2°C. Temperature setting range from 2-5°C
- Audible overheat protection alarm for compressor and condenser coil.

Options

- Additional shelving.
- 3" swivel casters with locks.
- 3.5" – 6" height-adjustable and interchangeable legs.
- Left hinged door (does not apply to model ER126-4).

Dimensions

ABS Legs



Two additional front adjustable stainless steel clad ABS legs for model ER74-1 and ER126-2 to provide extra stability when opening and closing doors, and one additional leg for ER190-3 for weight support.

Equipped with Australia 10amp plug for all models

Side View

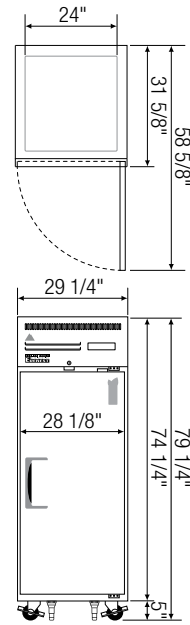
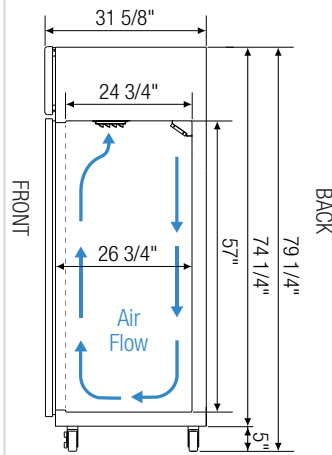

▲ ER74-1

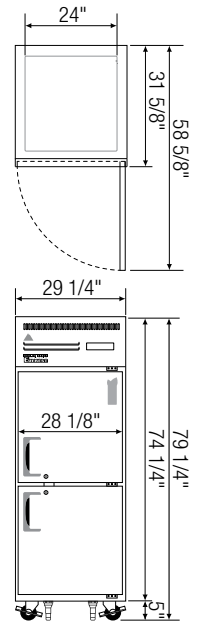

▲ ER74-2

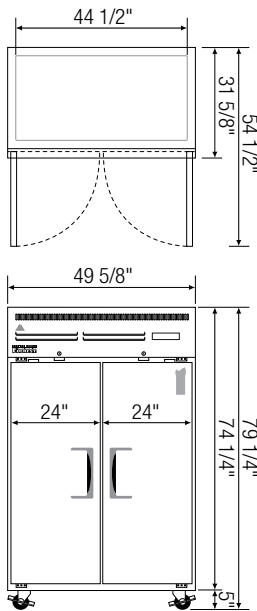

▲ ER126-2

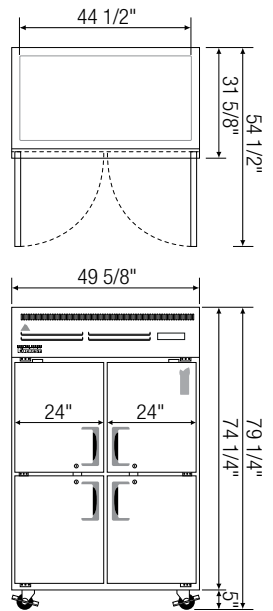

▲ ER126-4

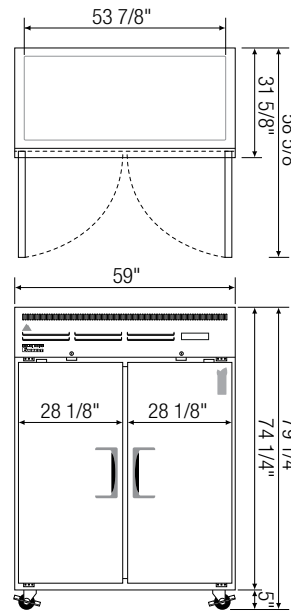

▲ ER150-2

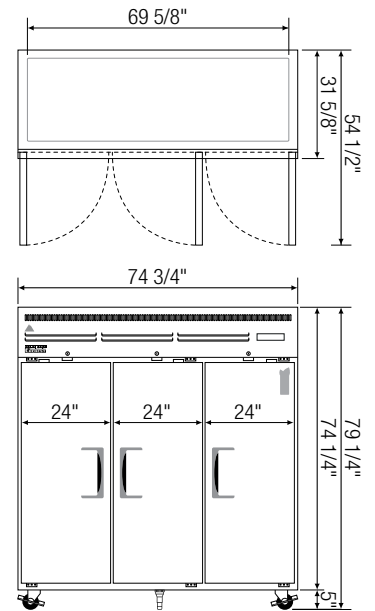

▲ ER190-3

Model	Ref/ Frz/ Dual	# of Doors	Capacity (Litres)	HP	BTU/HR [†]	Refrigerant	# of Shelves	Power (V-Hz-Ph)	Crated Weight (KG)	Exterior Dimensions (mm)		
										L	D	H*
ER74-1	Ref	1	557	1/4+	1,926	R290	3	240-50-1	134	740	803	1910
ER74-2	Ref	2 (H)	557	1/4+	1,926	R290	3	240-50-1	135	740	803	1910
ER126-2	Ref	2	1032	1/4+	1,926	R290	6	240-50-1	181	1260	803	1910
ER126-4	Ref	4 (H)	1032	1/4+	1,926	R290	6	240-50-1	183	1260	803	1910
ER150-2	Ref	2	1251	1/3	2,311	R290	6	240-50-1	206	1500	803	1910
ER190-3	Ref	3	1616	3/4	4,445	R290	9	240-50-1	261	1900	803	1910

*: Height does not include 5" for casters.

†: Based on evaporating temperature of 23°F (-5°C) & condensing temperature of 131°F (55°C).

Ref = Refrigerator | (H) = Half Door

Specifications subject to change without notice.

Product dimensions are for general purposes and not absolute value. Product capacity (P) is calculated based on standard industry figures. Slight variations may exist. If dimensions and capacity are critical, please contact Austune Refrigeration.

Blizzard R290 replacement is at the sole discretion of Everest Refrigeration.



Please visit our website for more information
<http://www.austunecommercial.com/>