

S = 3 3/8" (Small ADJ JD = 5 1/2" - 8 3/4")
 L = 4 7/8" (Large ADJ JD = 8 1/2" - 13 3/4")

PROFILE:

- 16 GA Galvanneal Steel (standard) or 18 GA (optional).
- For use with 1 3/4" thickness doors (steel or wood).
- Adjustable Jamb Depth size:
 Small ADJ - from 5 1/2" to 8 3/4";
 Large ADJ - from 8 1/2" to 13 1/4".
- Prepared for (3) 9/32" silencer holes. (Silencers supplied by others)
- Prepared to receive countersunk screws #7 X 2 1/2" (included).
- Prepared with 12 gauge ASA strike reinforcement.
- Prepared with three 4 1/2" standard weight 10 gauge hinge reinforcement
- Fire rated upto 1 1/2 hr. for following sizes:
 singles frames upto 4'0" X 8'0" Maximum
 double frames upto 8'0" X 8'0" Maximum

EXPANDABLE SINGLE FRAME

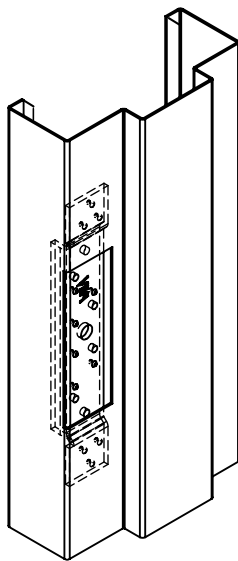

10 Gauge high frequency hinge reinforcing

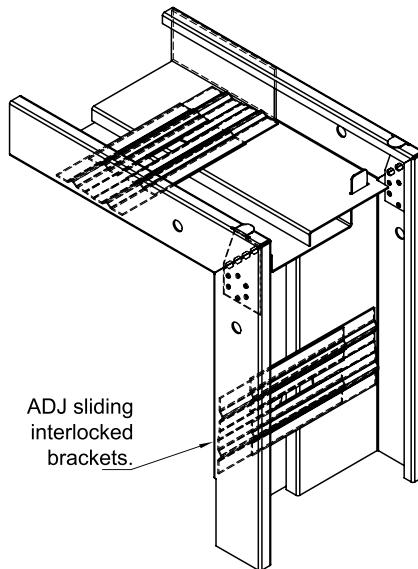

Typical KD (Knocked Down) corner section includes sliding interlocked brackets.

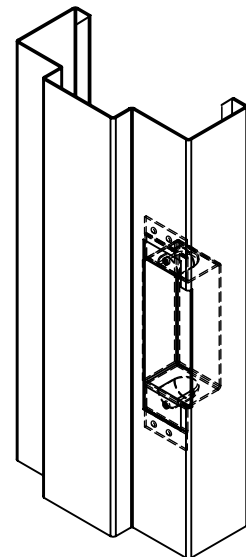

ANSI 1 1/4" x 4 7/8" Strike Assembly with optional Deadbolt punch out complete with tabs.

ROUGH OPENING FOR DRYWALL INSTALLATION

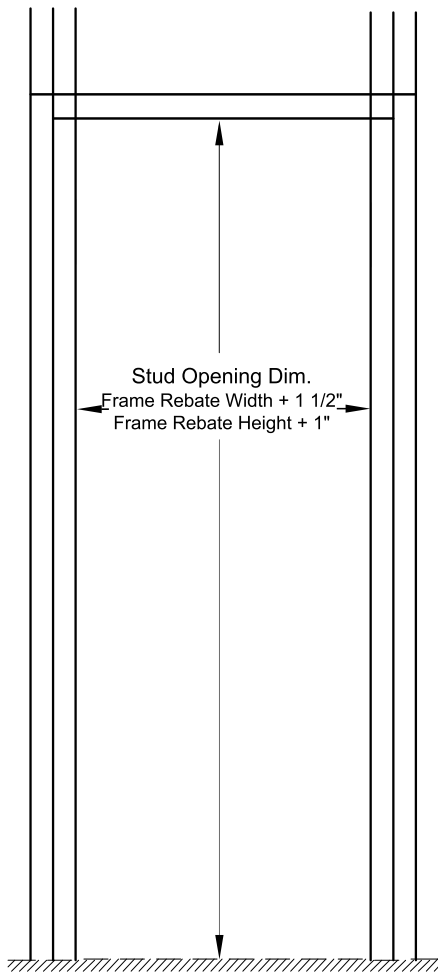

MASONRY INSTALLATION

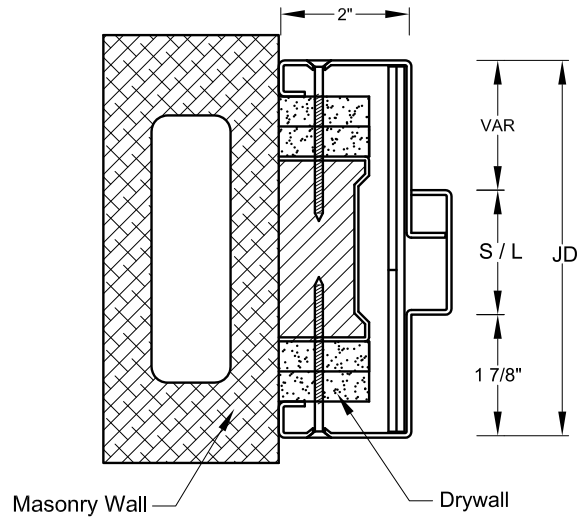

NOTE: Do not fill jamb with mortar.

DRYWALL INSTALLATION

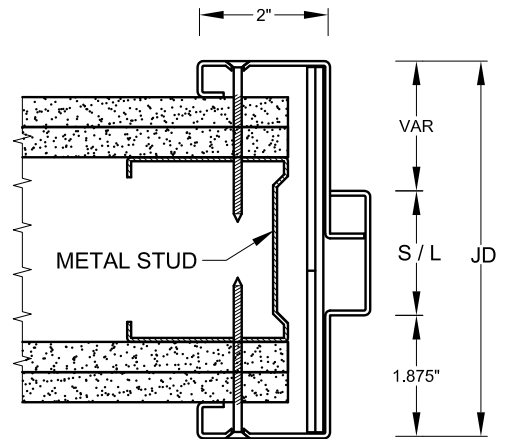

INSTALLATION DETAILS

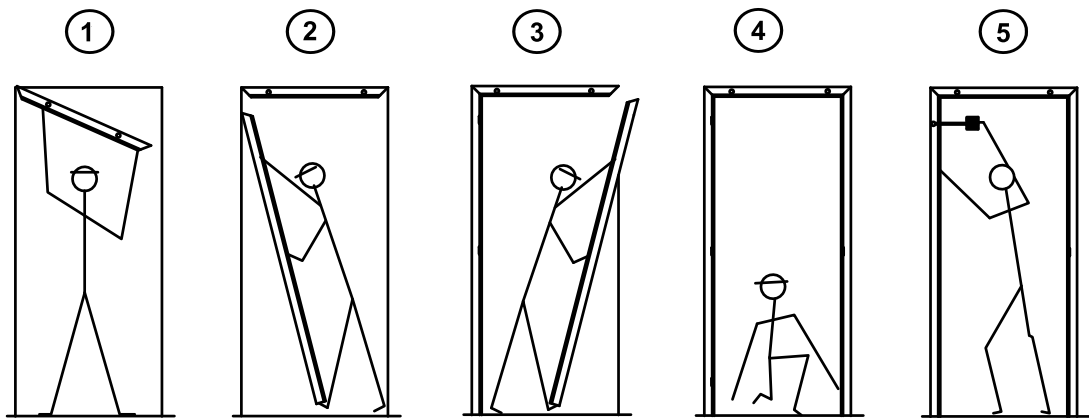

1 Install header.

2 Install hinge jamb at top, engage corner and slide into position.

3 Install strike jamb in same manner as hinge jamb.

4 Adjust frame for proper clearances plumb and level.

5 Secure with #7 x 2 1/2 countersunk screws.