



SPECIAL THERMO INSULATED TRAILER UPGRADES FOR LIVING

SSP
Marktstraße 15-17, 46045 Oberhausen, Germany
office@sspfilm.com sspgermany@gmail.com
Pho +49-208-30998235
Cell +49-176-95352460



TWO WAY MODEL

TWO WAY MODEL - TYPE 2016

Overall length: 11825 mm
Overall width: 2540 mm
Interior height: 2300 mm
Fresh water: 500l
Waste water: 500l
Tyre size: 245/70 R17,5

FRAME

Chassis structure "U" steel profiles - painted
Chassis color according to customer's wish
Quality of the material, construction steel, label S355
"I" frame homologated drawbar - type 2016 UNIACT 9
Dual 5500 kg axle with pneumatic suspension
Mudguards with anti-spray suppression
Static load support legs (corner steadies) x4
Entrance fold-up stairs with three steps, electric operated
Manual operated slides x2
Rear side mounted spare tyre

CONSTRUCTION

Fully laminated composite panels
Fiberglass windows on each side x2, on the front and rear side x1
High quality entrance door with fiberglass window on it - Dometic
Roof mounted fiberglass windows for each apartment - Dometic
Roof mounted ventilation, for the toilet of each apartment - Fiamma

ELECTRICAL

Electrical distribution cabinet 12V and 220V/380V which has additional electronic control unit with displays.
Electronic control unit controls and turn on the lights, recharge the batteries and maintain a stable voltage.
220V fuse box for all consumers inside the apartment (water heater, TV, air conditioning, refrigerator, sockets)
Switches 12V for additional tank heaters, water pipe heaters, electric stairs, outdoor lighting, water pump, water heater and apartment lighting.
Particular fuses for each apartment (lights, sockets, water heaters, air conditioning).

OPTIONAL

Solar panels
Webasto - air type / water type
Hydraulic support legs
Electronic operated slides
Bathroom ceramic floor with heating

Floor heating in entire trailer
SAT TV
Smart TV, WiFi...

AIR CONDITION

Air condition multisplit with two internal units;
inverter type, capacity 28.000 BTU

BATHROOM

Shower - tempered glass 8mm
Toilet mug - ceramic / plastic
Washbasin - ceramic
Water heater - ceramic
Floor - vinyl trim

FURNITURE

Per Apartment:
Sofa
Desk table with chair
Armchair
Wooden shelves

BRAKING SYSTEM ACCORDING TO ECE R13

Electro-pneumatic braking system operated by main control unit - TEBS (Knorr Bremse Trailer Electronic Braking System with 7-PIN connectors)
Type of braking system 2S/2M (2 sensors and 2 modulators)
Two-line pneumatic braking system with quick connection coupling heads
Safety systems ABS (Anti-lock Braking System), RSP (Roll Stability Program) ... additional safety systems according to customer's demand
Axles GIGANT with drum brakes
Pneumatic suspension (air bellows)



gigant trailer axles **KNORR-BREMSE**





Picture 1 - front left side view



Picture 2 - rear left side view



Picture 3 - front right side view



Picture 4 - rear right side view

SSP
Marktstraße 15-17, 46045 Oberhausen, Germany
office@sspfilm.com sspgermany@gmail.com
Pho +49-208-30998235
Cell +49-176-95352460

APARTMANT INTERIOR



BATHROOM



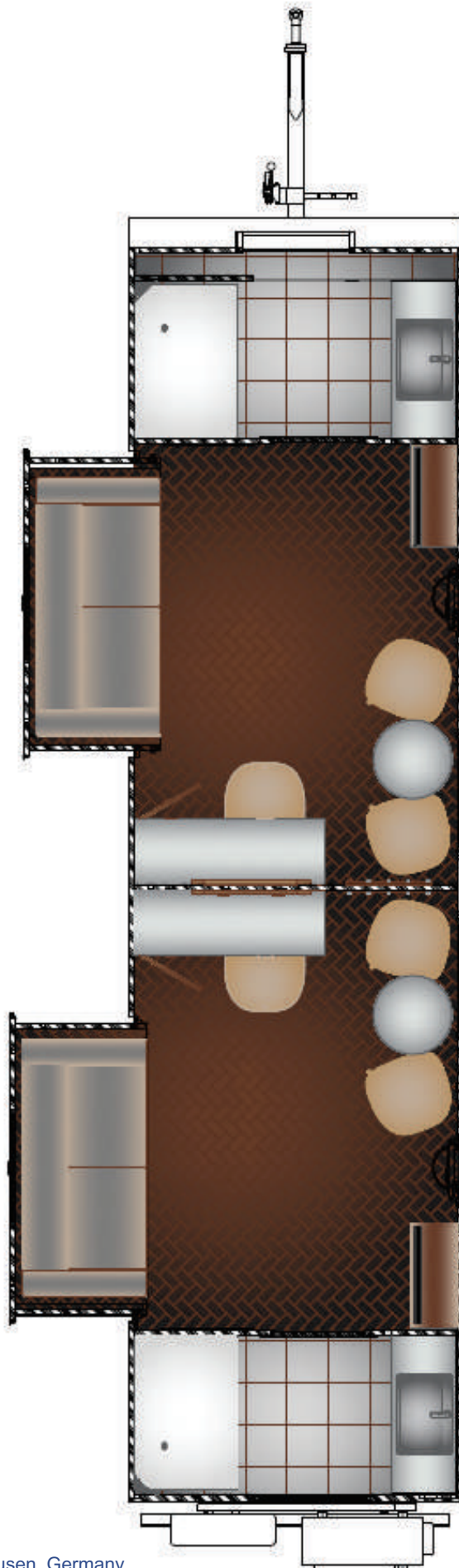

SSP
Marktstraße 15-17, 46045 Oberhausen, Germany
office@sspfilm.com sspgermany@gmail.com
Pho +49-208-30998235
Cell +49-176-95352460

TWO WAY MODEL

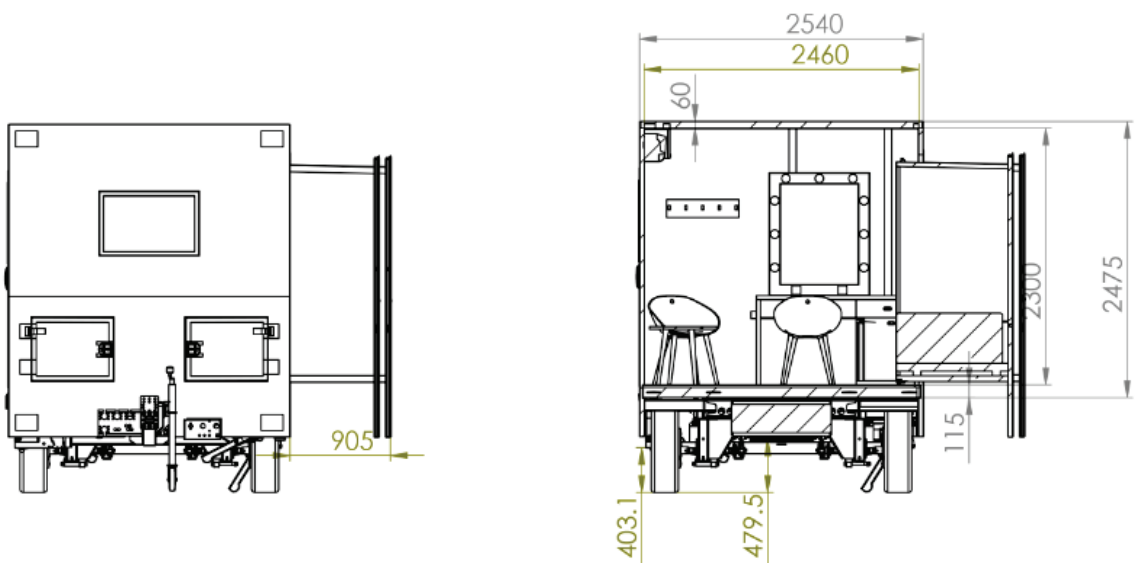
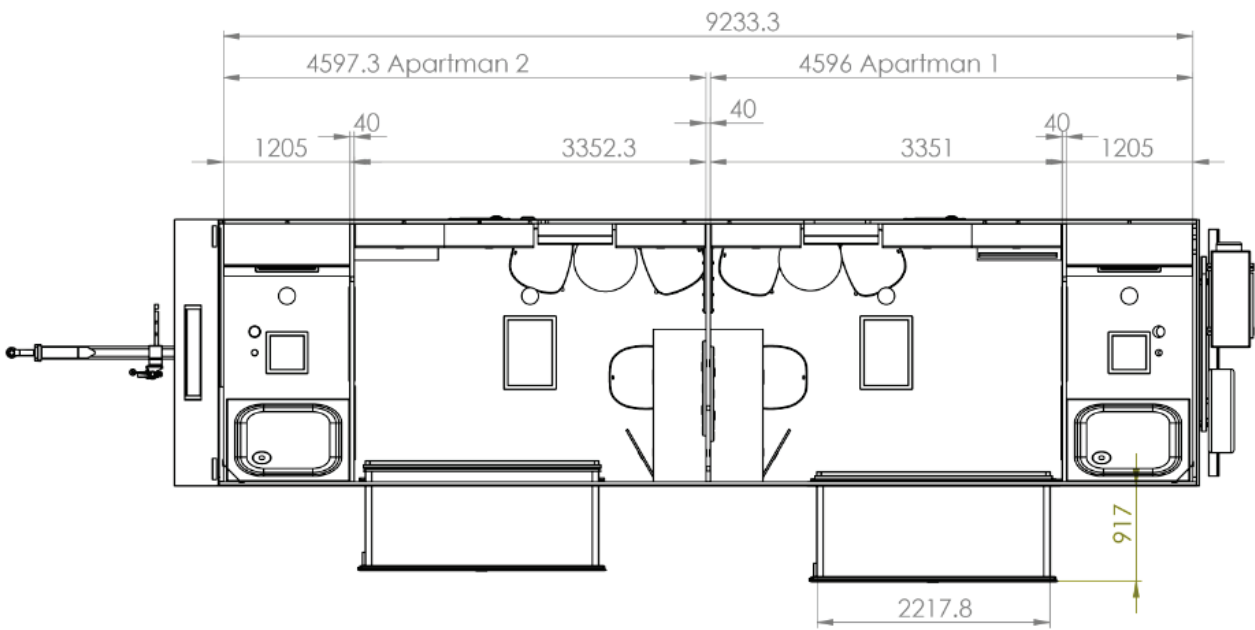
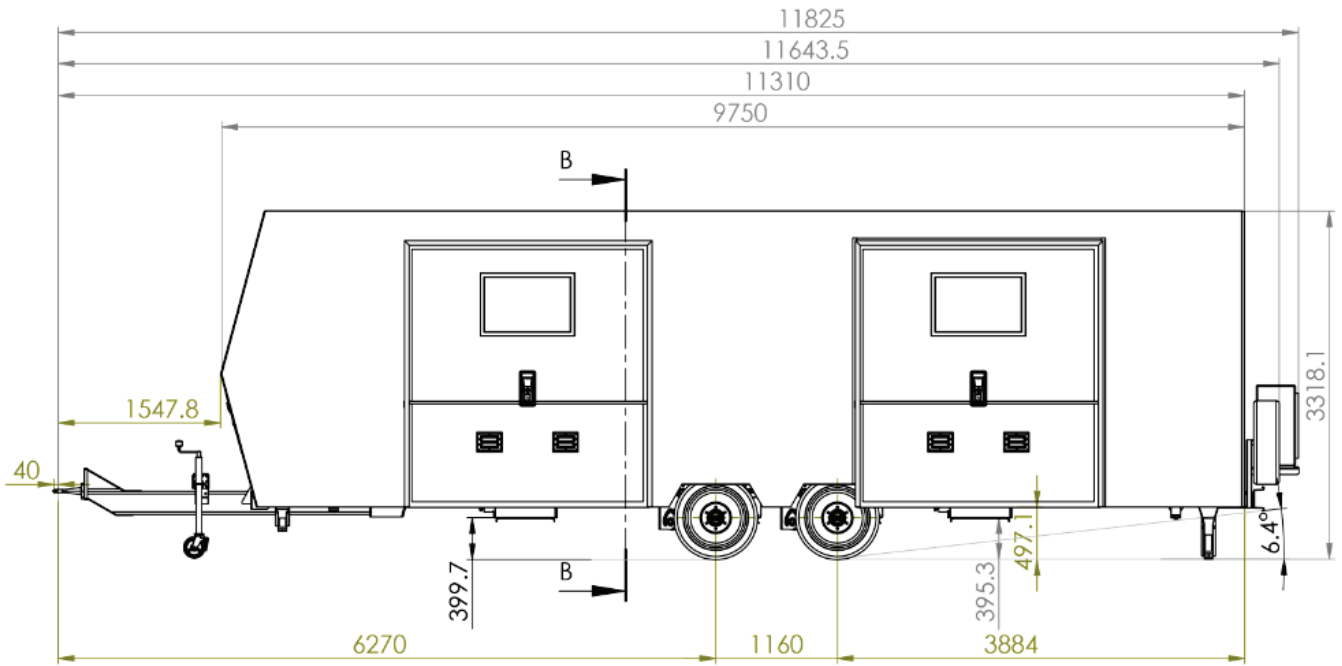

SECTION B-B

TWO WAY MODEL - TYPE 2016 - DIMENSIONS



TWO WAY MODEL - TYPE 2016 - 3D VIEW - 01

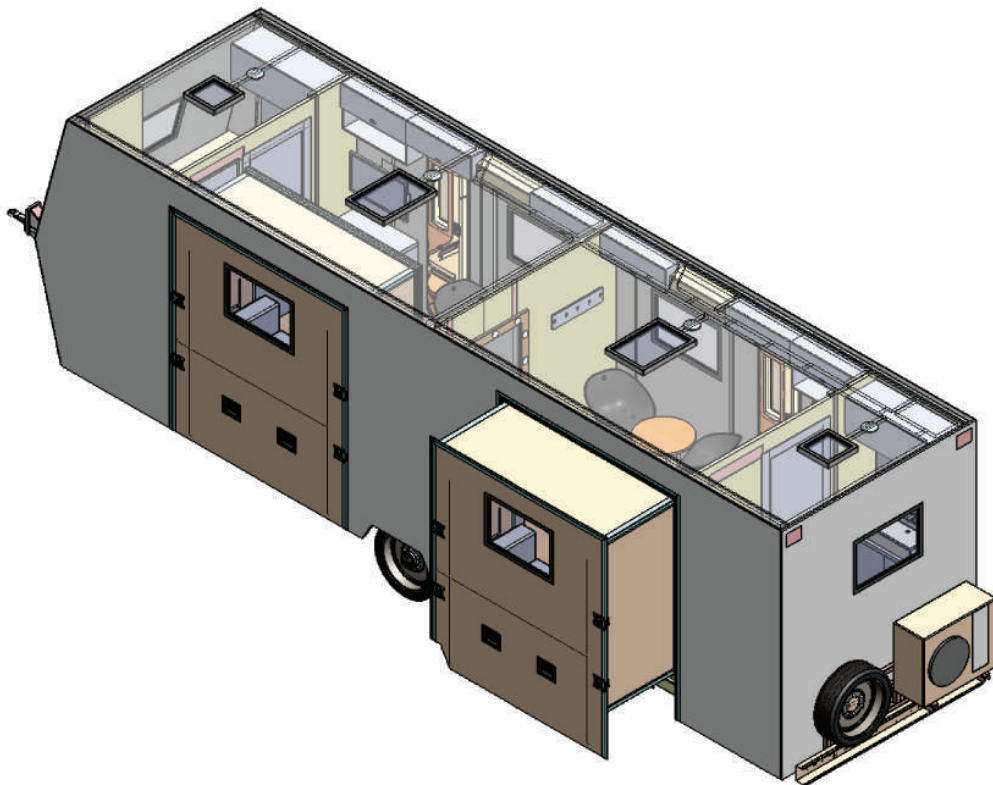

TWO WAY MODEL - TYPE 2016 - 3D VIEW - 02

SSP
Marktstraße 15-17, 46045 Oberhausen, Germany
office@sspfilm.com sspgermany@gmail.com
Pho +49-208-30998235
Cell +49-176-95352460

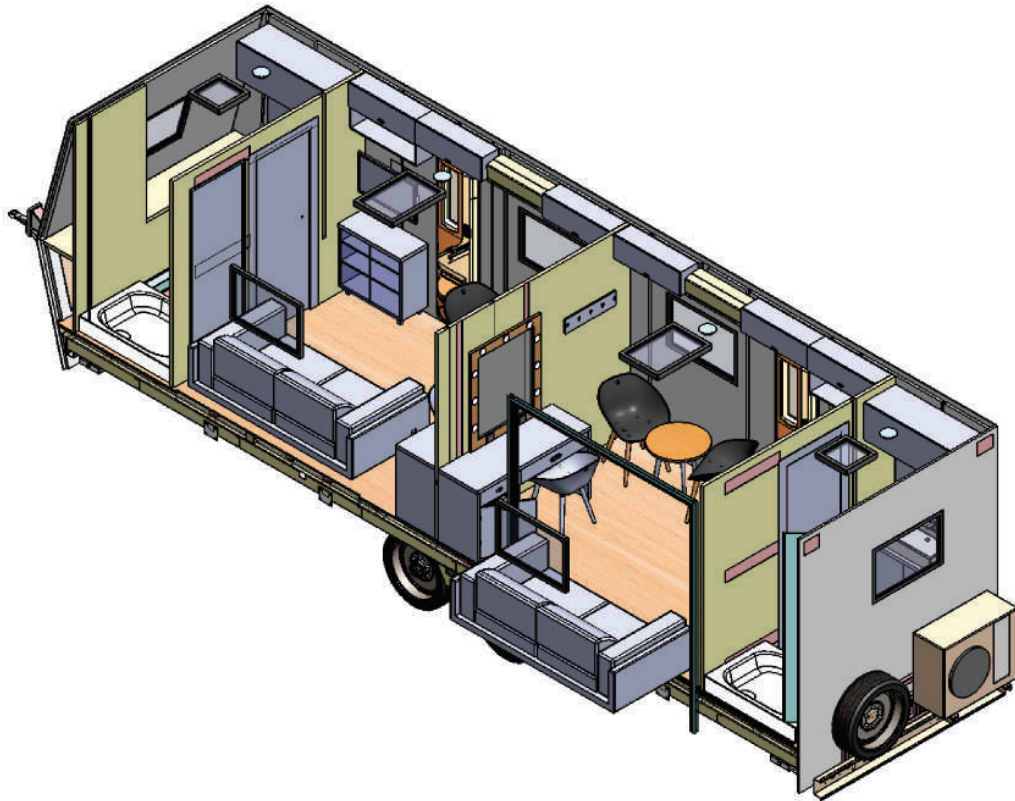

TWO WAY MODEL - TYPE 2016 - 3D VIEW - 03

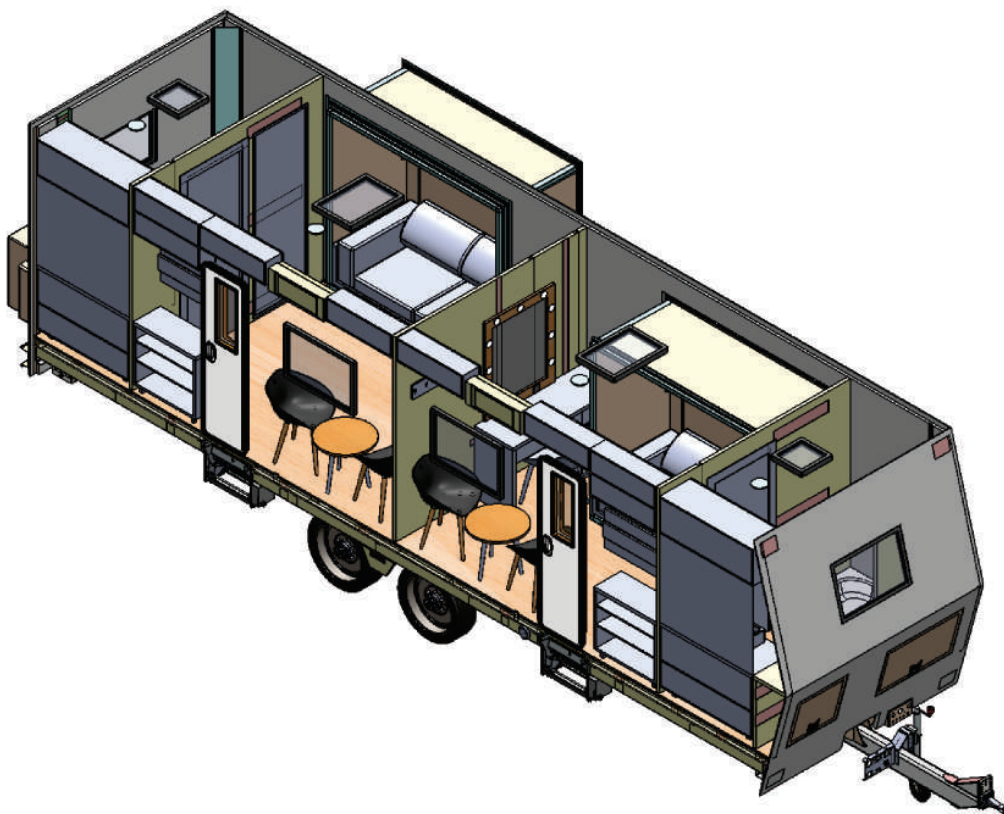

TWO WAY MODEL - TYPE 2016 - 3D VIEW - 04

SSP
Marktstraße 15-17, 46045 Oberhausen, Germany
office@sspfilm.com sspgermany@gmail.com
Pho +49-208-30998235
Cell +49-176-95352460



THREE WAY MODEL

THREE WAY MODEL - TYPE 2016

Overall length: 11722 mm
Overall width: 2540 mm
Interior height: 2300 mm
Fresh water: 500l
Waste water: 500l
Tyre size: 245/70 R17,5

FRAME

Chassis structure "U" steel profiles - painted
Chassis color according to customer's wish
Quality of the material, construction steel, label S355
"I" frame homologated drawbar - type 2016 UNIACT 9
Dual 5500 kg axle with pneumatic suspension
Mudguards with anti-spray suppression
Static load support legs (corner steadies) x4
Entrance fold-up stairs with three steps, electric operated
Manual operated slides x3
Rear side mounted spare tyre

CONSTRUCTION

Fully laminated composite panels
Fiberglass windows on each side x3, on the front and rear side x1
High quality entrance door with fiberglass window on it - Dometic
Roof mounted fiberglass windows for each apartment - Dometic
Roof mounted ventilation, for the toilet of each apartment - Fiamma

ELECTRICAL

Electrical distribution cabinet 12V and 220V/380V which has additional electronic control unit with displays.
Electronic control unit controls and turn on the lights, recharge the batteries and maintain a stable voltage.
220V fuse box for all consumers inside the apartment (water heater, TV, air conditioning, refrigerator, sockets)
Switches 12V for additional tank heaters, water pipe heaters, electric stairs, outdoor lighting, water pump, water heater and apartment lighting.
Particular fuses for each apartment (lights, sockets, water heaters, air conditioning).

OPTIONAL

Solar panels
Webasto - air type / water type
Hydraulic support legs
Electronic operated slides
Bathroom ceramic floor with heating

Floor heating in entire trailer
SAT TV
Smart TV, WiFi...

AIR CONDITION

Air condition multisplit with three internal units;
inverter type, capacity 28.000 BTU

BATHROOM

Shower - tempered glass 8mm
Toilet mug - ceramic / plastic
Washbasin - ceramic
Water heater - ceramic
Floor - vinyl trim

FURNITURE

Per Apartment:
Sofa
Desk table with chair
Armchair
Wooden shelves

BRAKING SYSTEM ACCORDING TO ECE R13

Electro-pneumatic braking system operated by main control unit - TEBS (Knorr Bremse Trailer Electronic Braking System with 7-PIN connectors)
Type of braking system 2S/2M (2 sensors and 2 modulators)
Two-line pneumatic braking system with quick connection coupling heads
Safety systems ABS (Anti-lock Braking System), RSP (Roll Stability Program) ... additional safety systems according to customer's demand
Axles GIGANT with drum brakes
Pneumatic suspension (air bellows)



gigant trailer axles **KNORR-BREMSE**





Picture 1 - front left side view



Picture 2 - rear left side view



Picture 3 - front right side view



Picture 4 - rear right side view

APARTMANT INTERIOR



BATHROOM



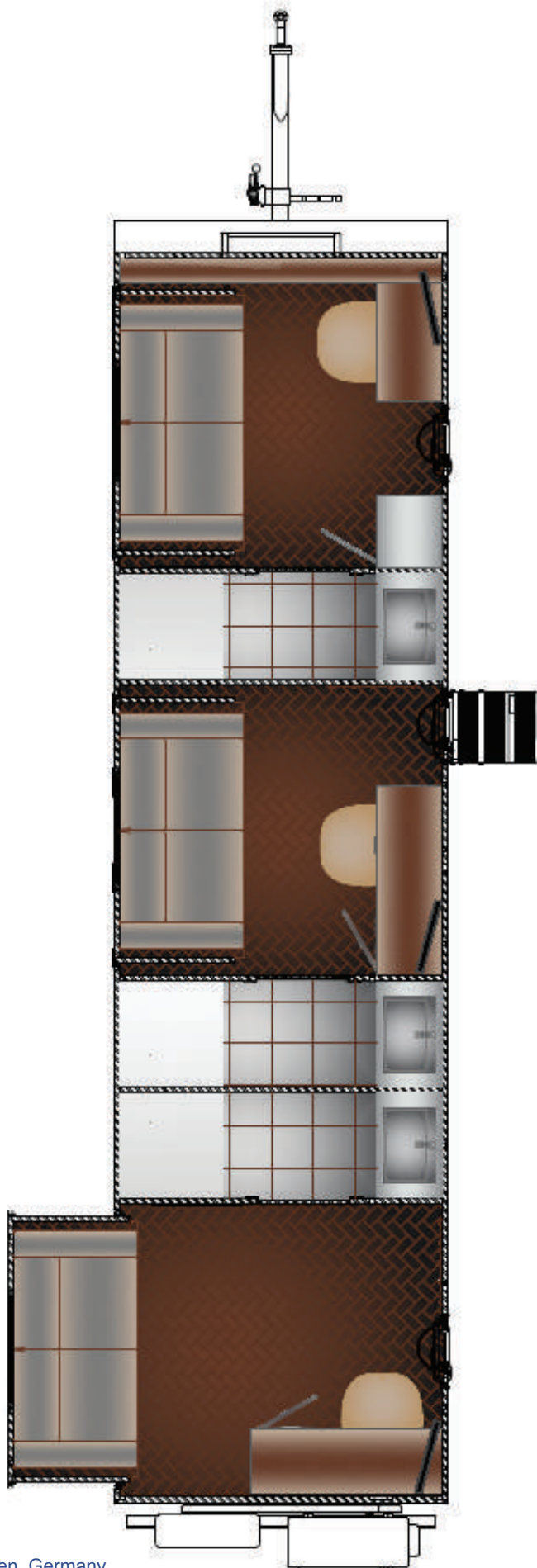

SSP
Marktstraße 15-17, 46045 Oberhausen, Germany
office@sspfilm.com sspgermany@gmail.com
Pho +49-208-30998235
Cell +49-176-95352460

THREE WAY MODEL

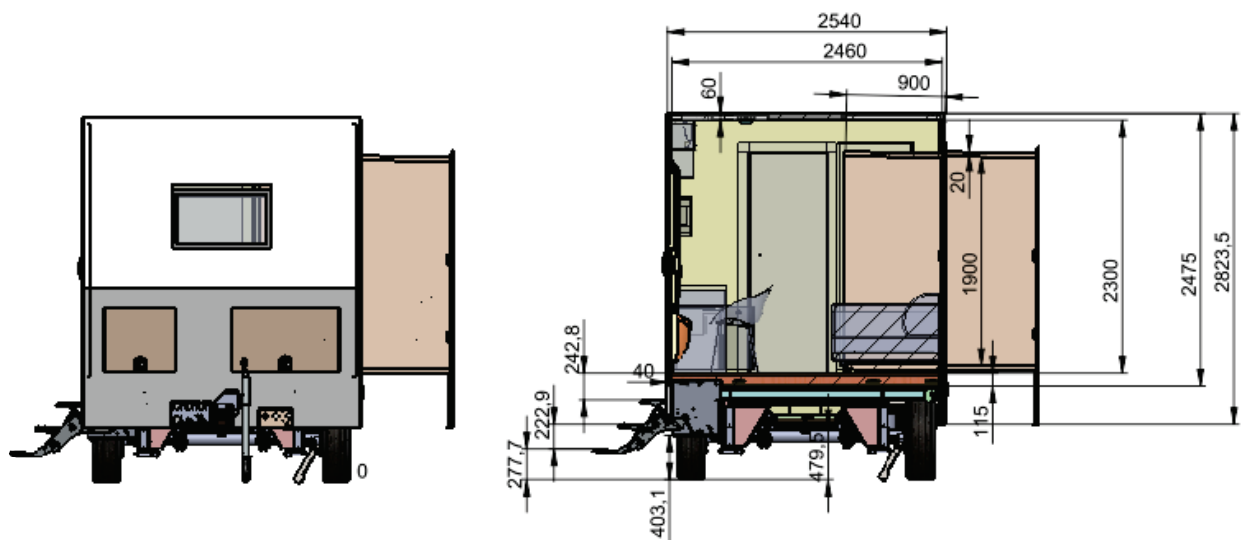
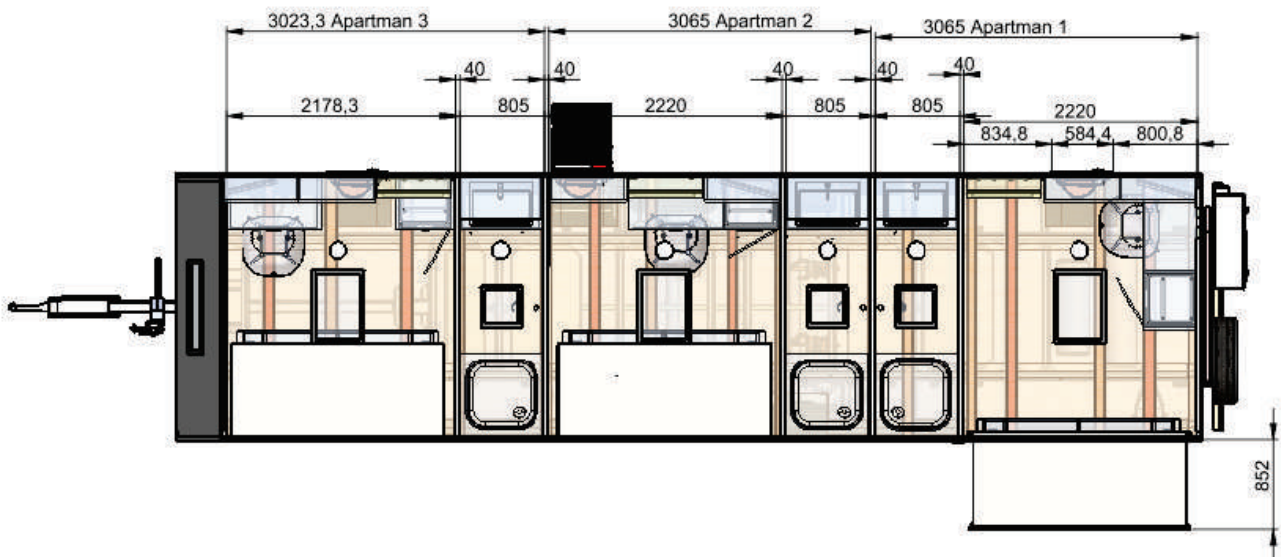
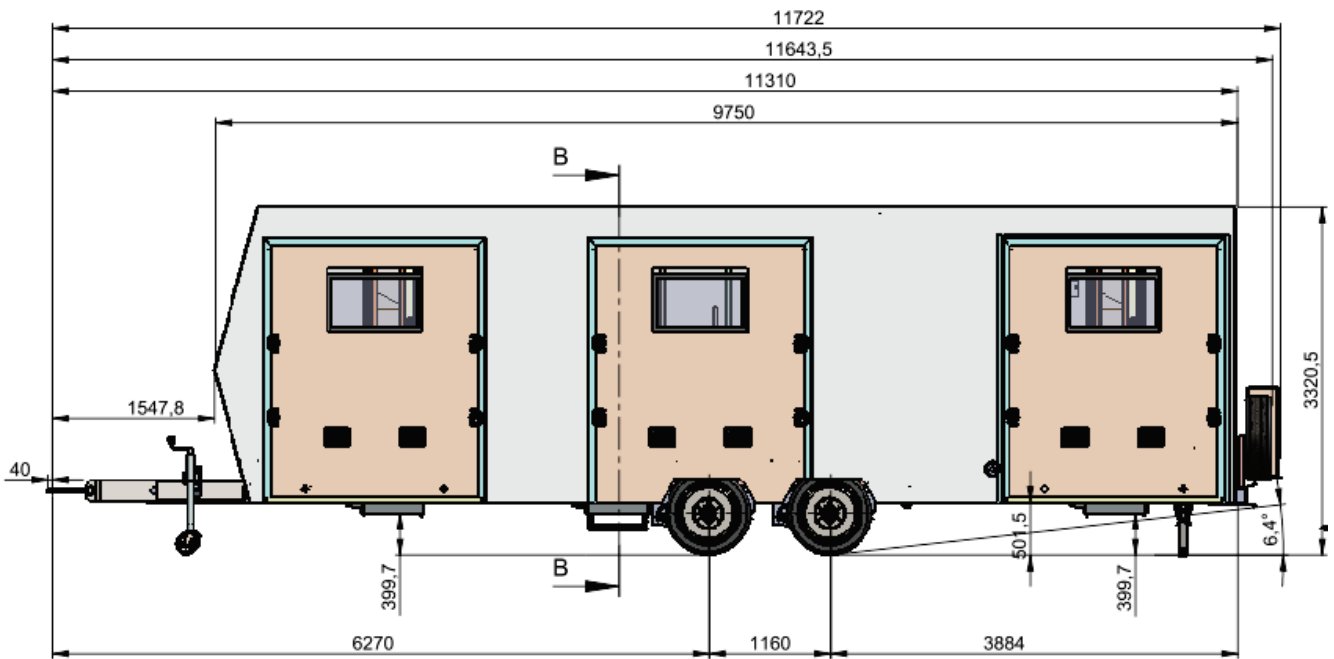

SECTION B-B

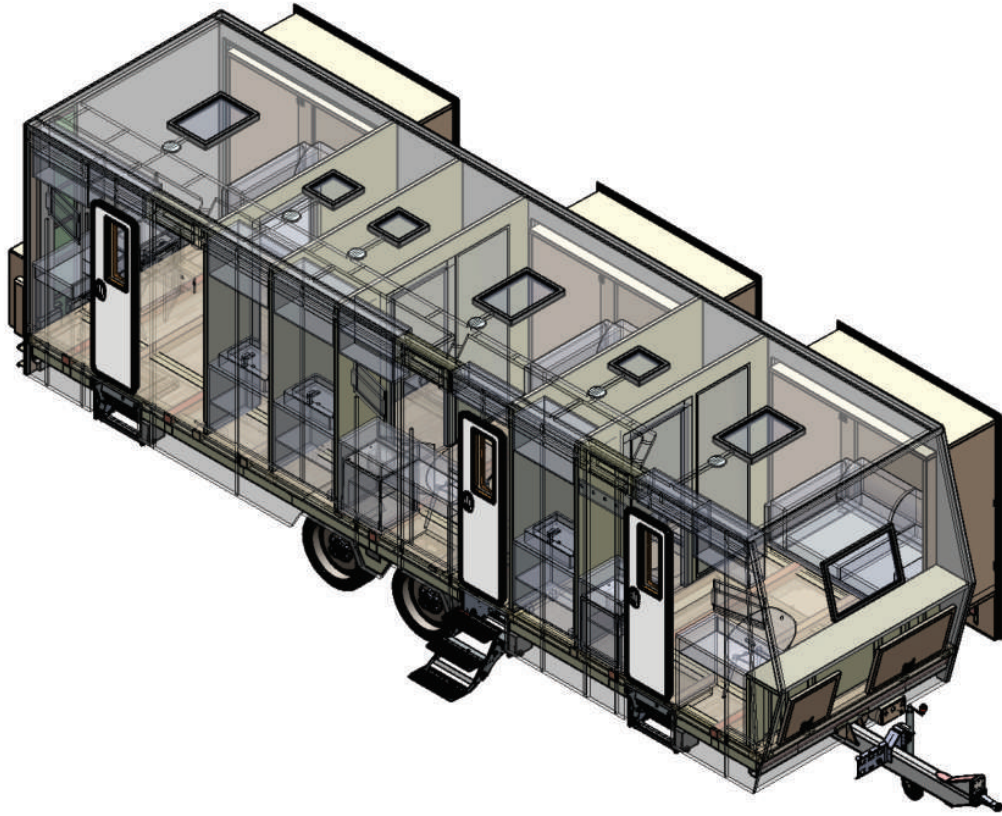

THREE WAY MODEL - TYPE 2016 - 3D VIEW - 01

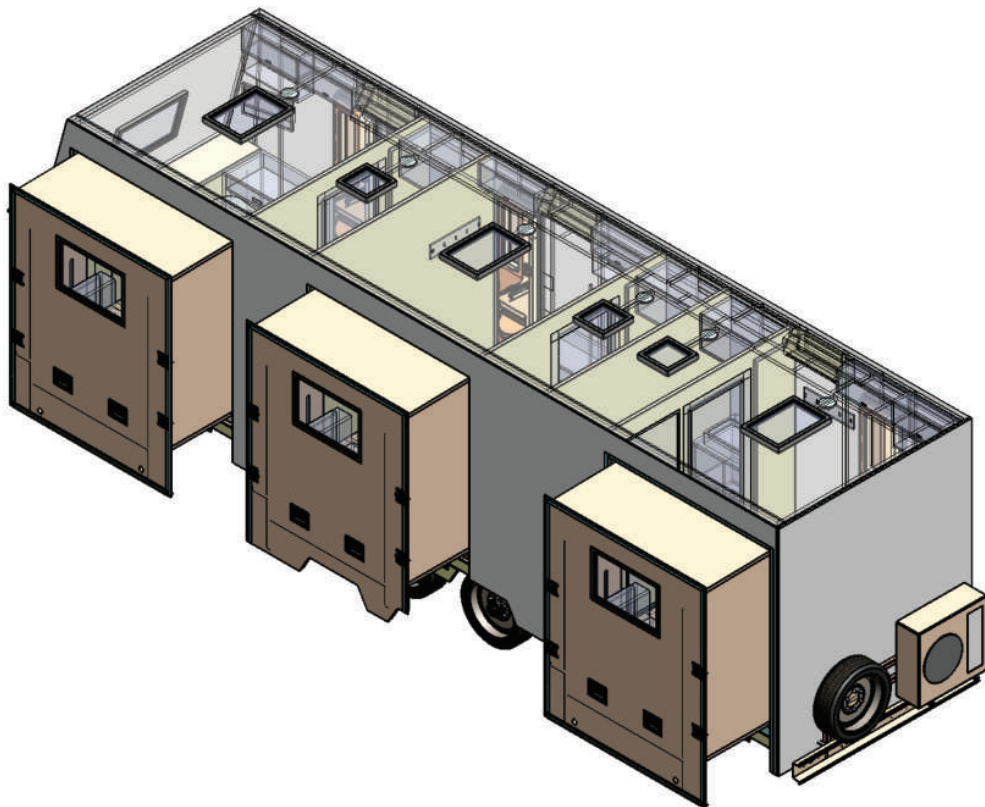

THREE WAY MODEL - TYPE 2016 - 3D VIEW - 02

SSP
Marktstraße 15-17, 46045 Oberhausen, Germany
office@sspfilm.com sspgermany@gmail.com
Pho +49-208-30998235
Cell +49-176-95352460

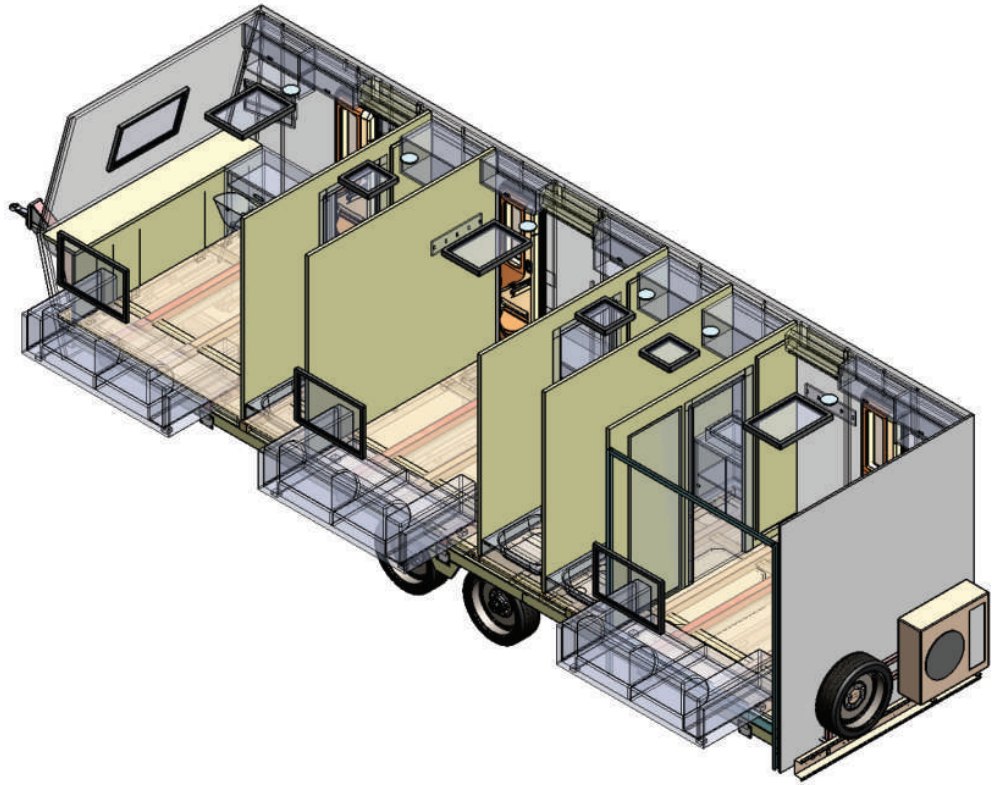

THREE WAY MODEL - TYPE 2016 - 3D VIEW - 03

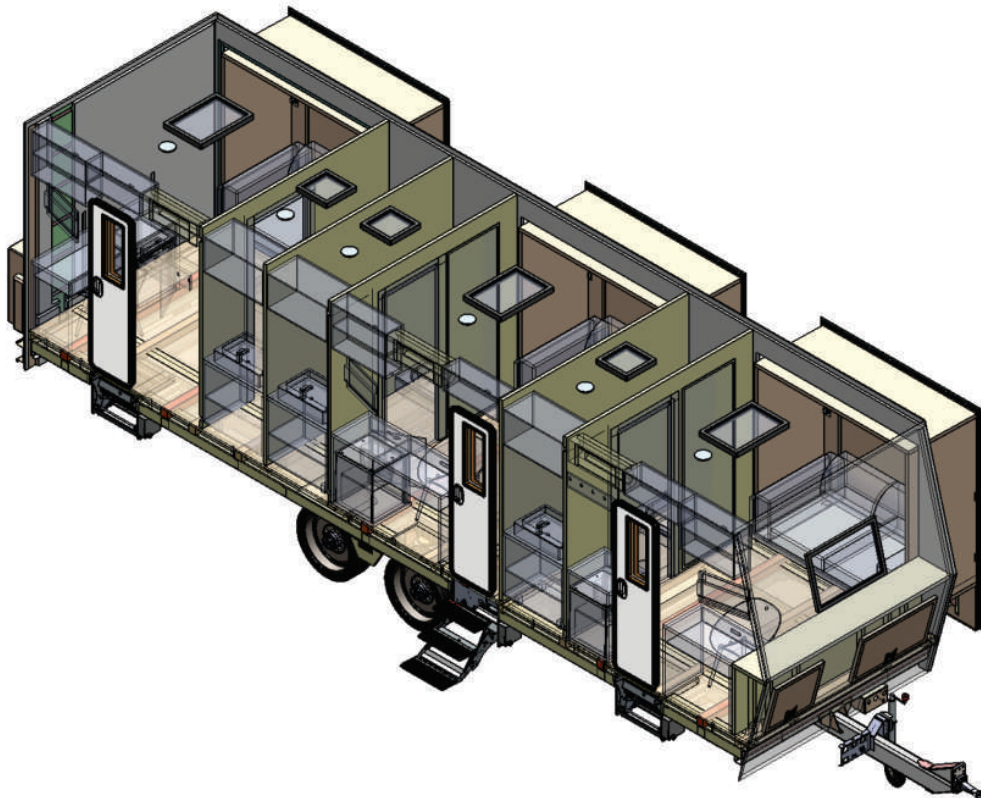

THREE WAY MODEL - TYPE 2016 - 3D VIEW - 04

SSP
Marktstraße 15-17, 46045 Oberhausen, Germany
office@sspfilm.com sspgermany@gmail.com
Pho +49-208-30998235
Cell +49-176-95352460