

## RESIDENTIAL FENCE APPLICATION

### APPLICATION:

Any owner or authorized agent who intends to construct, enlarge, alter, repair, move, demolish, or change the occupancy of a building or structure, or to erect, install, enlarge, alter, repair, remove, convert or replace any electrical, gas, mechanical or plumbing system, the installation of which is regulated by codes and ordinances adopted by the city, or to cause any such work to be done, shall first make application to the building official and obtain the required permit.

A building permit is required for any fence or screening structure construction

The following section of the Lakeway Code of Ordinances applies to the construction of fences:

- Section 24.02.443

The City of Lakeway has adopted the following codes:

- International Building Code – 2009 Edition, including all appendices except for appendices A, B, H and J
- International Residential Code for One- and Two-Family Dwellings – 2009 Edition, with the exception of chapters 25 to 32 (plumbing), including all appendices except for appendices E and L
- International Energy Conservation Code – 2009 Edition
- International Mechanical Code – 2009 Edition, including all appendices except for appendix B
- International Fire Code – 2009 Edition as amended by Travis County Emergency Service District No. 6
- International Gas Code – 2009 Edition, including all appendices
- National Electrical Code 2008
- Uniform Plumbing Code – 2009 Edition or as adopted by the service provider

### CHECKLIST:

This list has been prepared as a tool for submitting a complete fence permit application package. In no way does this list represent all submittal documents that may be required to demonstrate compliance with local codes and ordinances. Delays in the permit issuance process will occur as a result of incomplete or inadequate submittal information.

### ATTACHMENTS:

- Project Information Sheet
- Submittal Documents
- Exhibits (click on links below)
  - ❖ [Permitted Fence Locations](#)
  - ❖ [Masonry column requirements](#)
- Applications



Building & Development Services  
 1102 Lohmans Crossing, Lakeway, TX 78734  
 Phone: (512) 314-7540 Fax: (512) 314-7541  
[www.lakeway-tx.gov](http://www.lakeway-tx.gov)

## FENCE PROJECT INFORMATION SHEET

<b>General Contractor:</b>		<b>Phone:</b>	
<b>Address:</b>		<b>Fax:</b>	
<b>City:</b>	<b>State:</b>	<b>Zip:</b>	
<b>E-mail:</b>			

★ This information sheet must be submitted with the permit application for the fence.

### QUESTIONNAIRE:

What is the estimated project valuation? \$ \_\_\_\_\_.

Is there an active Architectural Control Board (ACB) over the subject property? Yes  or No ? If yes, provide evidence of plan submission to the ACB.

Is this a pool barrier?  Yes or  No?

Is this a golf course property?  Yes or  No?

Will the fence attach to any neighboring fences?  Yes or  No?

What materials will be used to construct the fence? Check applicable box below:

Wood (constructed so that it is identical on both sides)

Wrought iron

Masonry

Pre-cast concrete

What is the height of the fence above grade?  4 feet  5 feet  6 feet  Other \_\_\_\_\_ feet \*

\* Staff is only able to approve fence structures up to 6' in height, fence up to 8 feet must be approved by the City Building Commission.

Wastewater:  Public or  Private? \*

\*If wastewater is collected through a private sewage system (septic), will need to obtain fence placement approval from Lower Colorado River Authority (LCRA) and provide approval verification to the City. LCRA recognizes that on certain occasions, especially with pool barriers, it may be necessary to construct a fence over a septic field but they have indicated to us that there are certain methods that they want implemented and want to be involved in the inspection process.

**BUILDER  
COPY**

REVIEWED FOR  
CODE COMPLIANCE

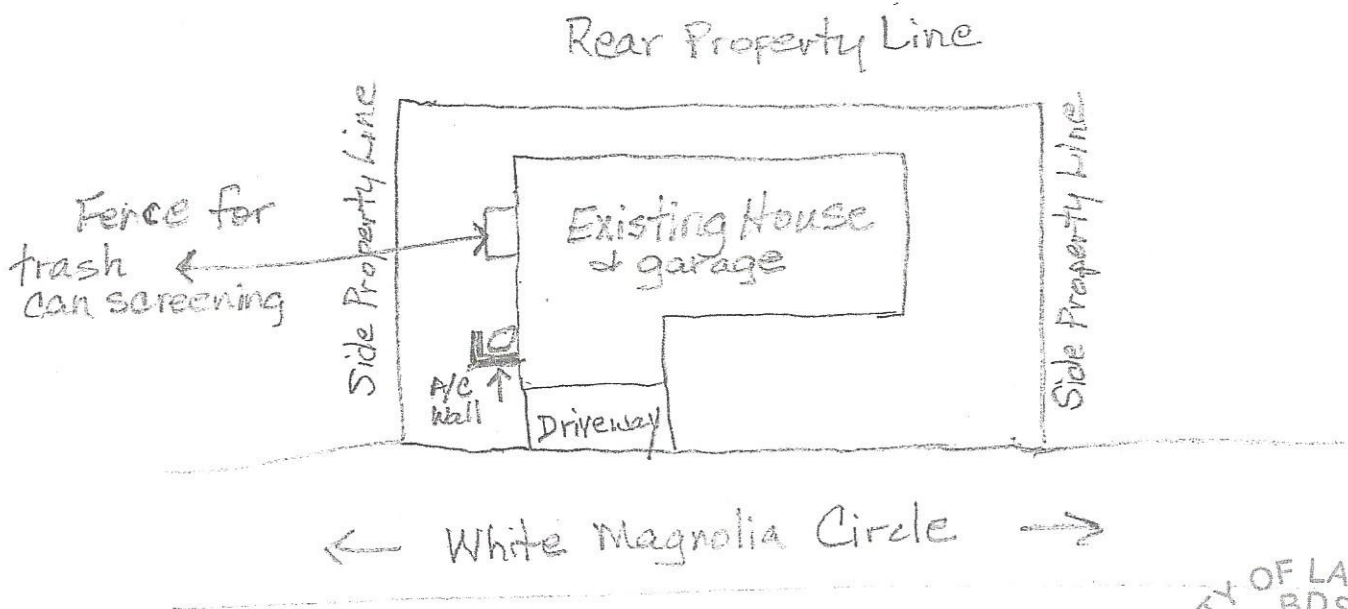

CITY OF LAKEWAY  
BDS  
RECEIVED

OCT 13 2016

BUILDER COPY



October 12, 2016

City of Lakeway  
Building & Development Services  
1102 Lohmans Crossing  
Lakeway, TX 78734

RE: Permit for Courtyard at the Preserve Homeowners Association fence for screening trash cans

Dimensions of fence for trash can screening: 6' 2" wide x 4' 2" depth x 4' 4" height

Materials to be used:

Cedar boards and or pickets to go horizontal (approx. 1" x 6" ea)

4 ea. 4x4 wormanized wood posts

4 ea. 6x6 concrete footing

4 ea. Metal brackets to secure posts to concrete footings

4 ea. Hinges for two gates to open in the center of the width of the fence enclosure

1 ea. Metal fence holder to secure one side of gate in ground

1 ea. Latch to secure gate closure

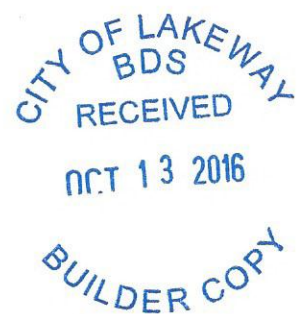



CITY OF LAKEWAY  
BDS  
RECEIVED  
OCT 13 2016  
CITY COPY

2016

Have cans out by 7:00 A.M. on day of pick-up  
Place with arrows toward street.  
To prevent spillage make sure lid is closed completely  
Place no more than 2 feet from street.

Trash Can

Recycle Can

15 inches

CITY OF LAKEWAY  
BDS  
RECEIVED  
OCT 13 2016  
CITY COPY

2016

CITY OF LAKEWAY  
BDS  
RECEIVED

OCT 13 2016

CITY COPY

12 inches

Trash Can

2016