

# For Sale

5601 Helen St  
Cincinnati OH 45216

- Municipality:  
Elmwood PI
- Parcel ID's:  
661.0004.0155  
661.0004.0119  
582.0001.0170
- Zoning: M1
- Land Area: 8.173 Ac
- Year Built: 1902
- Building Size:  
104,741 SF
- Construction: Brick
- Cranes: 15 & 20 Ton,  
Multiple Smaller
- Dry Sprinkler System
- 13' - 36' 10" Clear
- Drive In Doors: Three  
18' x 18'  
24' x 15'  
14' x 13'
- Exhaust Fans
- Floor Drains
- Heavy Power
- Steam Boiler Heat
- Outdoor Storage
- Office has been  
demoed
- Flood Zone Overlay
- Outbldg: 3,000 SF
  
- Asking Price:  
\$2,600,000



**DWYER**  
COMMERCIAL REAL ESTATE LLC

2928 Colerain Ave Ste 100  
Cincinnati OH 45225

**Contact:**  
**John or Kevin**

513.784.1776  
www.dwyercre.com

*The information contained herein  
has been obtained from sources  
we deem reliable. We have no  
reason to doubt but don't  
guarantee its accuracy*

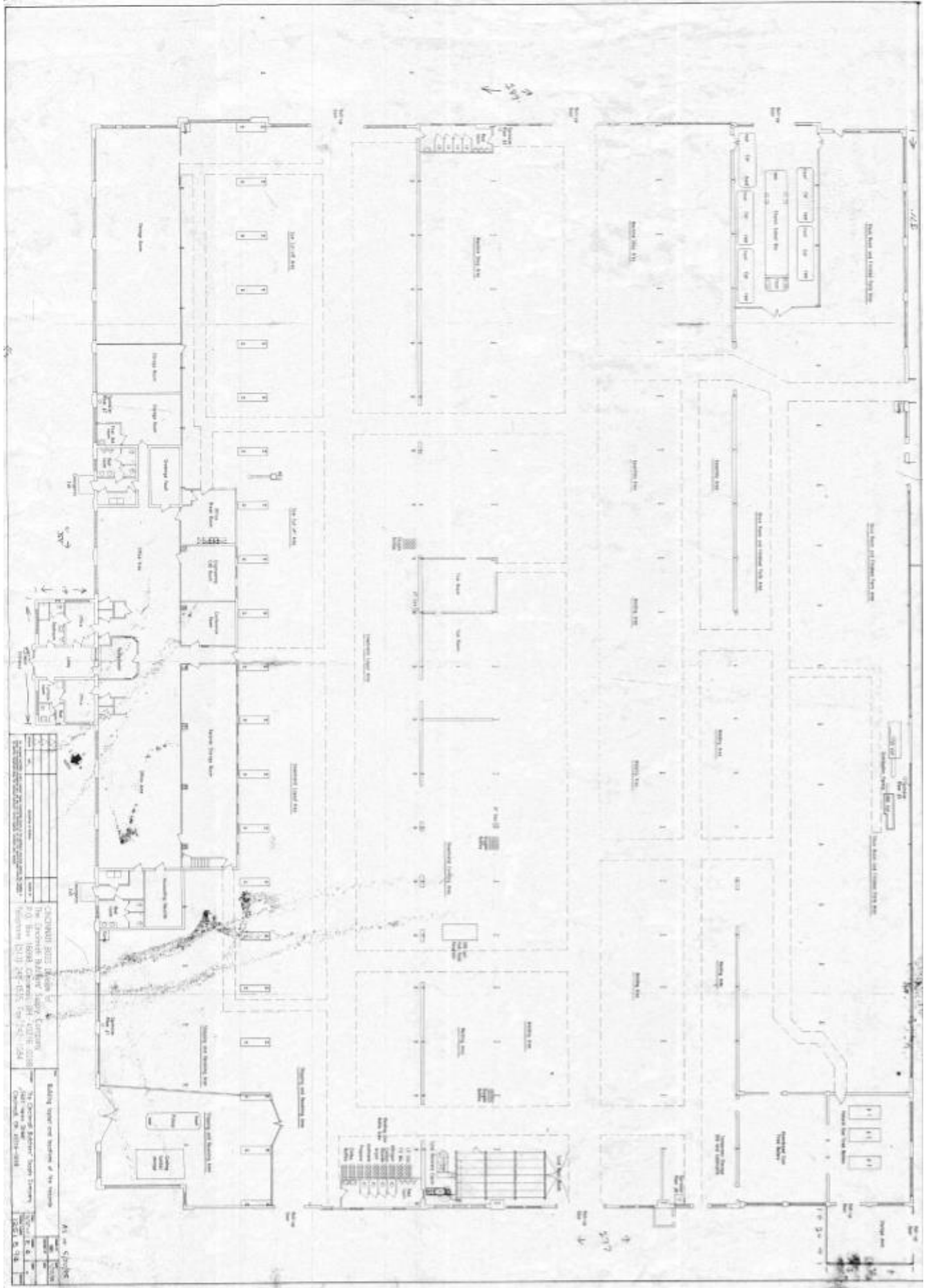

ARCHITECTURAL FLOOR PLAN  
 PROJECT NO. 100-1000  
 SHEET NO. 100-1000-1  
 DATE: 10/1/2000  
 DRAWN BY: J. SMITH  
 CHECKED BY: M. JONES  
 APPROVED BY: K. BROWN  
 PROJECT: 100-1000  
 CLIENT: ABC COMPANY  
 ADDRESS: 123 MAIN ST., SUITE 100, NEW YORK, NY 10001  
 PHONE: (212) 555-1234  
 FAX: (212) 555-5678  
 E-MAIL: ARCH@ABC.COM  
 SCALE: 1/8" = 1'-0"  
 TITLE: FLOOR PLAN - 100-1000-1

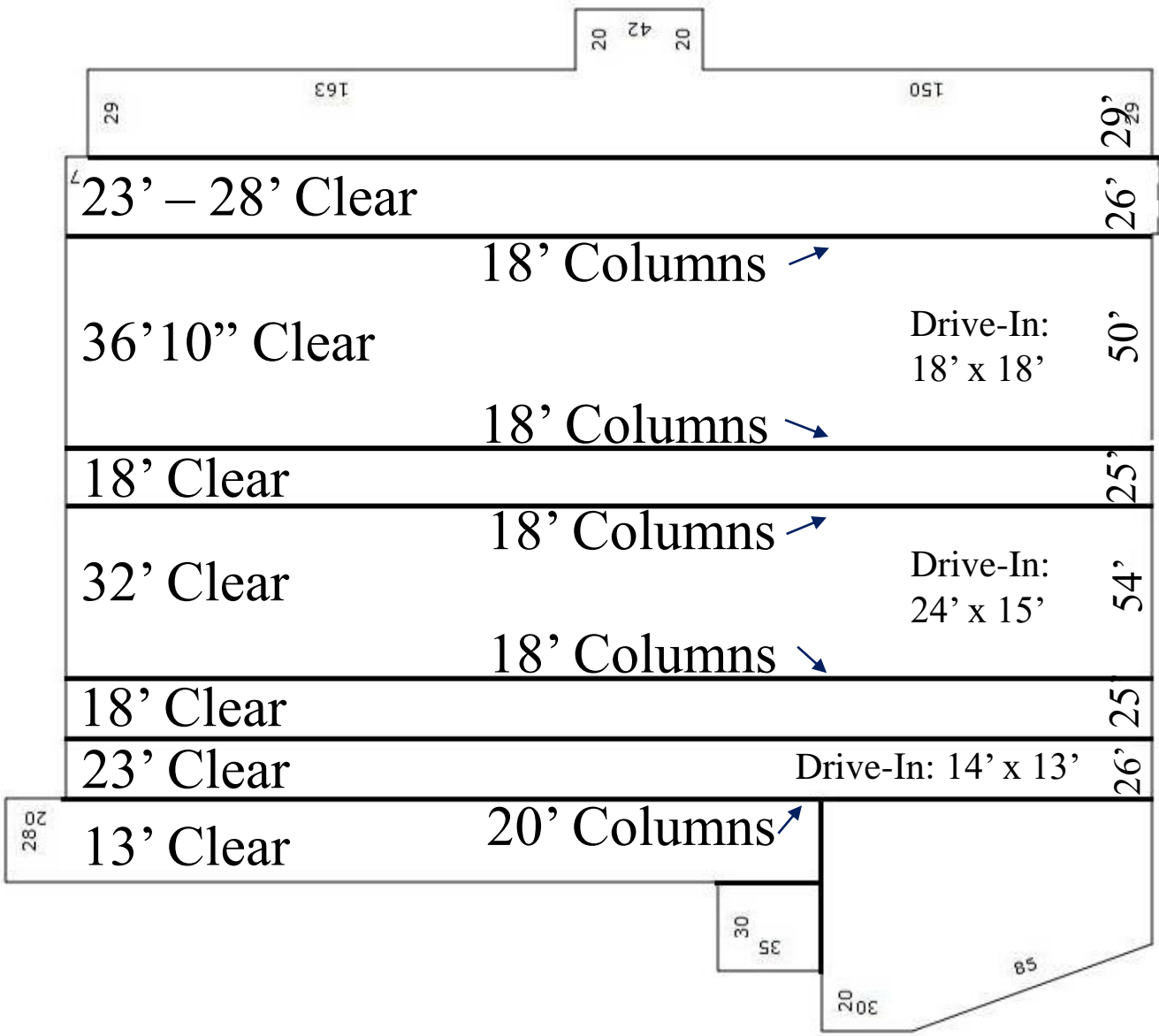

Bay Width

23' - 28' Clear			26'
36' 10" Clear	18' Columns ↗	Drive-In: 18' x 18'	50'
18' Clear	18' Columns ↘		25'
32' Clear	18' Columns ↗	Drive-In: 24' x 15'	54'
18' Clear	18' Columns ↘		25'
23' Clear		Drive-In: 14' x 13'	26'

