

Photoluminescent Egress Markings -- Platform, Handrail and Obstruction markings, Final and Non-Final Exit Door Marking, Floor ID and Running Man Directional Signs.  
Section 101443

TYPICAL LANDING

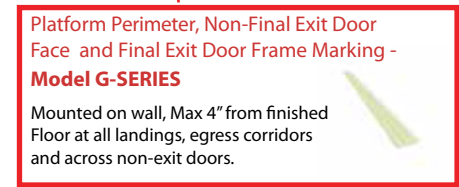

LUMINOUS markings at wall transition to floor to keep obstructions out of the delineating path of travel and transition back to wall on other side of non-final exit doors.

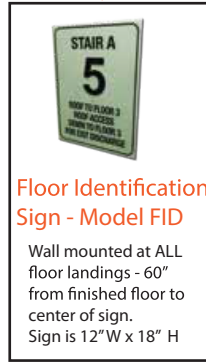
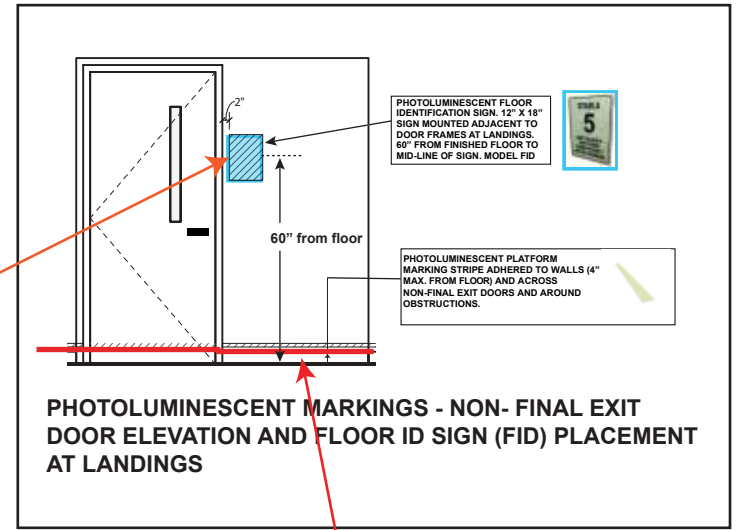
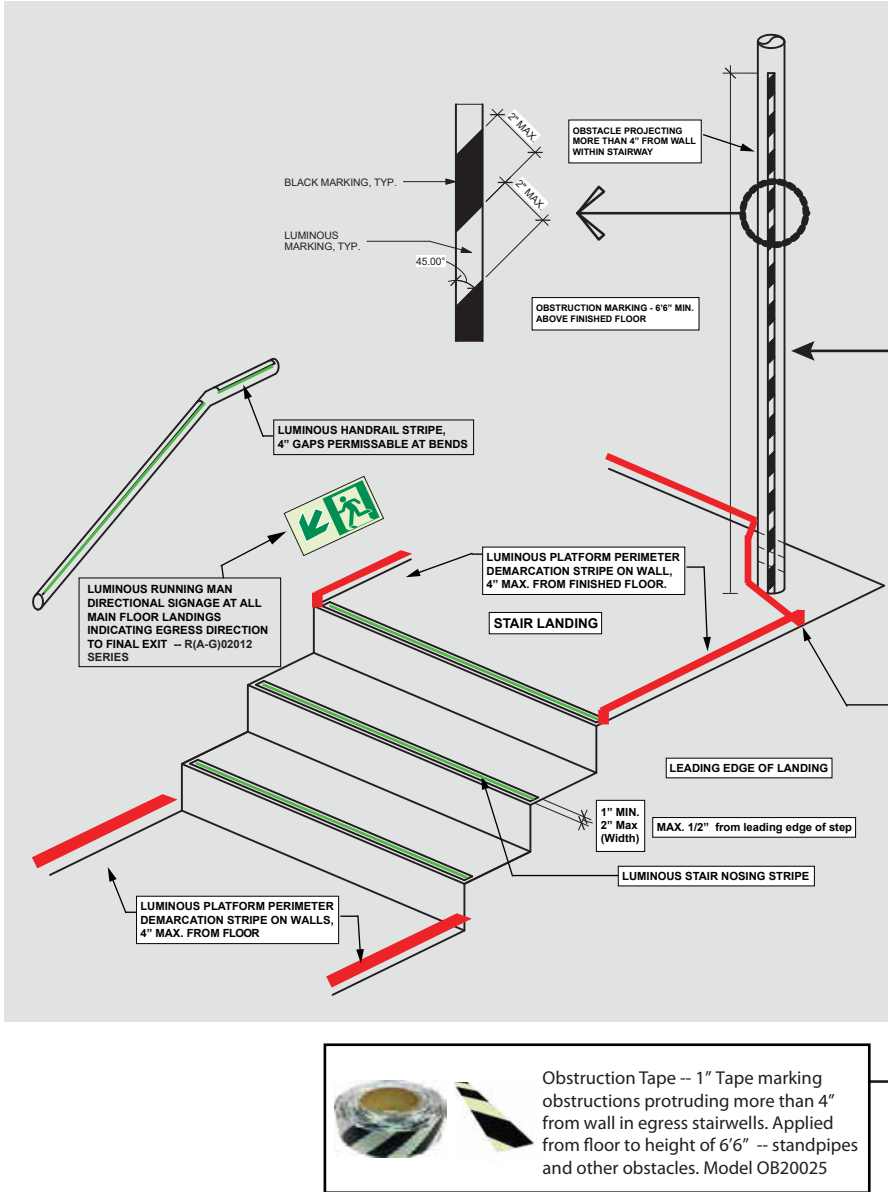
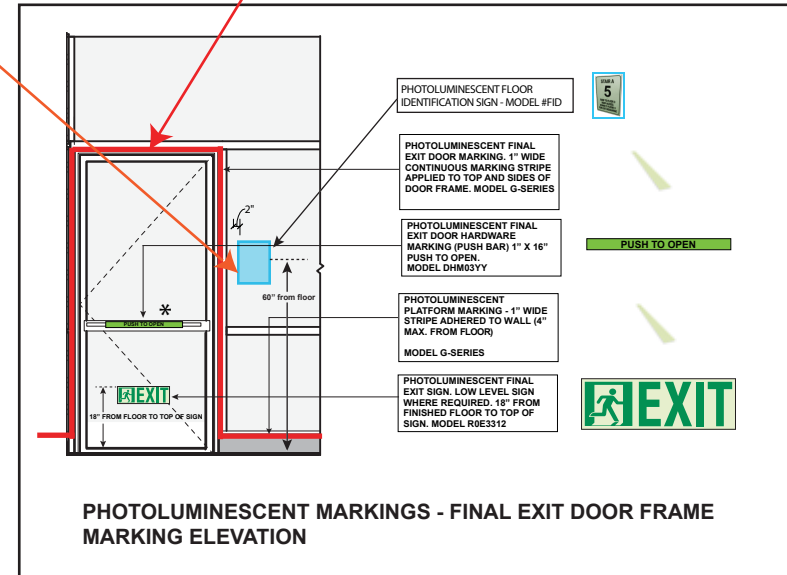

4" x 4" \* If final exit door has handle and not PUSH BAR, Apply 4" x 4" PL Marker behind handle