



High-Pressure King Koba

Code: KK1300-10

A powerful high-pressure pump matched with a tough certified tank makes the ideal solution for high-pressure sewer mains. Available with a float switch or a sensor.

1300L 'King Koba' Certified Tank



- AS/NZ 4766 Approved
- 2070mmx1020mm . 75kg
- Ribbed Tank for strength and anchoring in-ground
- Rounded Base collects sediment for effective removal
- Smooth Internal Finish for easy cleaning
- Tough construction
- Plastic lid (steel lid available upon request)
- Hydraulic uplift anchoring drawings available
- Undrilled for plumber convenience

Inlet, outlet and pump chain supplied. Plumber to supply ball-type non-return valve and pipework to suit application.



1.5HP 'Growler' High-Pressure Pump

Code: 240-GRP150M

Switch Genie Pump Controller

Code: 228-SG-30 SF

Single pump controller panel. Provides power surge and run-dry protection.



High-Level Alarm

Code: 228LSKIT

Light and buzzer sounds when pre-set height reached.



Two-year warranty on pump, alarm and controller
www.gorillapumpstations.co.nz



High-Pressure King Koba

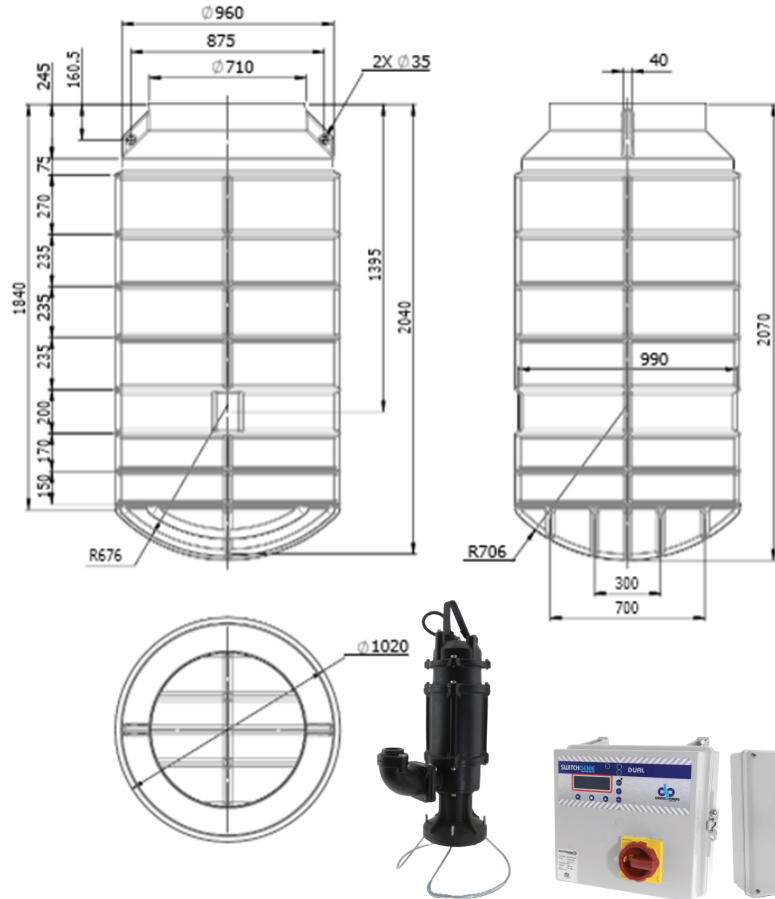

Options Available:

With Automatic Float-Switch (Code: 228-TRDF-710)



With Hydrostatic Sensor (Code: 228-PRW-05)



Extra: Battery Pack Timer System (228-SG20-2)

Two-year warranty on pump, alarm and controller

Visit website for full warranty information.

www.gorillapumpstations.co.nz



High-Pressure Pump System



1.5HP High-Pressure Pump

Code: 240-GRP150M

- Up to 90m head
- 1.1KW motor

Switch Genie Single Pump Controller

Code: 228-SG-30 SF



- With audible alert for blockages
- Power surge and dry-running protection

Hydrostatic Sensor

Code: 228-PRW-05



- Can be set for custom specifications

High-Level Alarm

Code: 228LSKIT



- Complete with float and power lead

Two-year warranty on all components

www.gorillapumpstations.co.nz



High-Pressure Pump System



Single Pump Control Unit

228-SG-30 SF

- Adjustable start-stop times
- Includes a 'run-dry' alert.

Two-year warranty on all components

www.gorillapumpstations.co.nz



Eco Water Solutions

PO Box 18 Foxton Beach

021 745 335

www.gorillapumpstations.co.nz

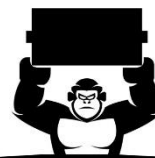

GORILLA PUMP STATIONS

Further and Faster

'The King Koba' High Pressure 1300 Litre Sewage Pump Station

Installation Instructions

Thank you for purchasing an Eco Water Solutions 'King Koba' high-pressure sewage tank and pump unit.

Connections are supplied undrilled so that they can be positioned anywhere on the top half of the tank to suit site conditions. Extra pipe is included for different setouts.

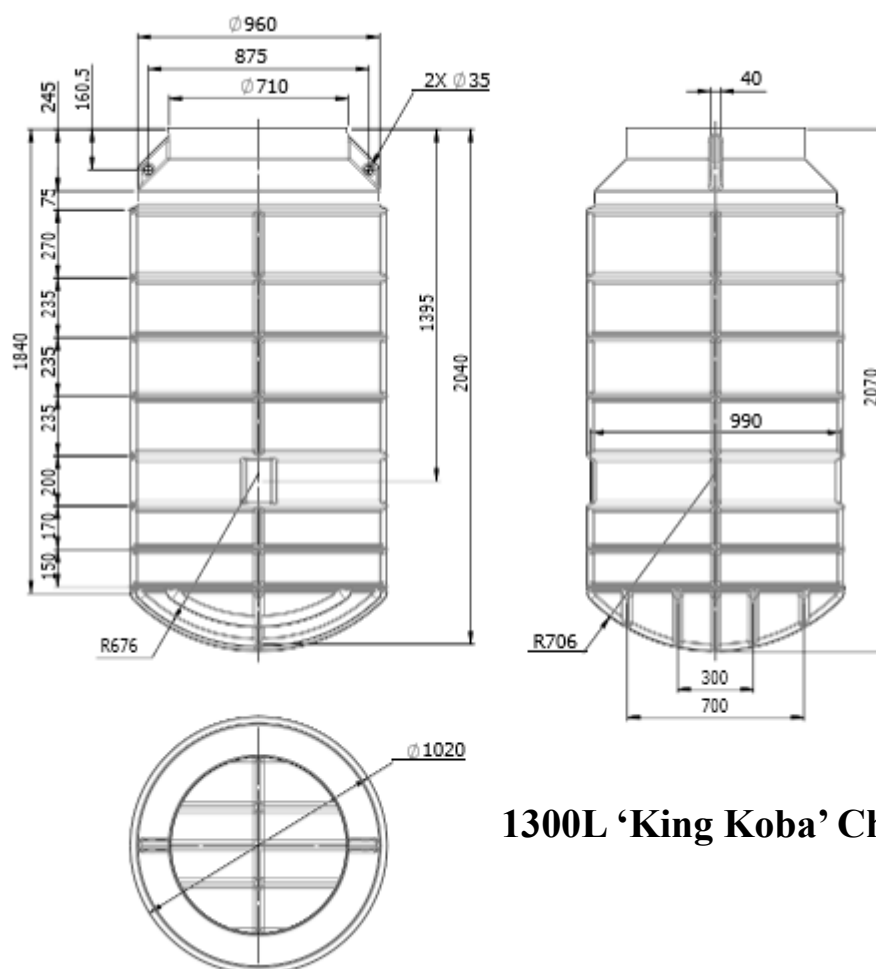

1300L 'King Koba' Chamber

Minimum of 600mm of Concrete Anchor Required for Ballast. Concrete should be 1300mm diameter.

Unpacking

The tank is made of 'virgin plastic' polypropylene. It is supplied with one carton containing valve pipework with hose for easy customer setup.

The pump is supplied loose packed in a separate carton.

Check that the pump is the required unit and inspect for any damage to tank and fittings.

Visit www.gorillapumpstations.co.nz for a range of pump configurations

Outlet connection

Using a holesaw, cut hole for outlet tank connector to suit your requirements.

Inlet Connection

Using a 120mm holesaw, cut hole for inlet at a height that suits your plumbing requirements.

Assembly

When fitting the 110mm o.d. sewer pipe into the sealing ring, it is best to apply soapy water to the ring, to ease insertion of the pipe.

Screw the discharge pipe and non-return valve assembly into the pump outlet.

Lower the pump into the tank using the chain, and then Hang the chain on the tek screw provided to side of tank

Do not use the power cable to lift the pump.

After placing the pump and pipe in the tank, connect the Pipe union to the outlet pipe.

Connect the isolating ball valve to the outlet pipe outside the tank.

Ensure that the pump is centred in the tank, and that the float switch is free to move up and down without obstruction.

Read the pump instruction manual supplied with the pump.

Please refer to the tank manufacturer's installation instructions attached for full installation details

For high water tables or soft soil substrates strapping should be attached from dead weight over the top of the tank from the two tie-down points as per manufacturer's instructions. For this information, visit www.promax.co.nz

Venting Installation.

Vent in accordance with Local Council Regulations

Cable Installation

An RCD (residual current device) must be used with this product!

All pumps and alarms must be installed by a certified electrician in accordance with New Zealand standards.

50mm conduit ducting pipe must be used as conduit for electrical cable to ensure ease of installation and maintenance.

*>> Never lift the pump by the cable, as that will damage the pump.
Always lift using the handle and/or chain on top of the pump.*

Maintenance

- Tank requires regular checks to ensure no fat or oils have formed at the top of the chamber. **If not regularly checked the float may malfunction which will invalidate warranty.**
- Tank requires checking for solids build-up. Installation is required by a registered plumber.
- Check regularly for build-up of solids or any other matter in pump chambers.
- Periodically wash down the inner walls of the chamber with a high pressure hose to activate pump and thus flush out the chamber.
- Check that the vent pipe is also clean and free of any obstruction.
- A 24-litre grease trap is recommended between kitchen waste pipe and gulley trap.

Please check on our website (www.gorillapumpstations.co.nz) for warranty conditions.

Read the pump instruction manual supplied with the pump.

DAVIES GRP GROWLER High Pressure Pump



Data Sheet

DAVIES GRP GROWLER

Dear Client

Congratulations on your purchase of a quality pump from the Davies range of pumping products.

Like all Davies products, quality and reliability is first and foremost, carefully chosen from manufacturers worldwide to carry this proven brand name and deliver years of service. Please check your pump for any physical damage during transit and advise your supplier if so. Check the name plate to make sure the pump is what you ordered.

The longevity of your pump largely depends on the application and the environment it is working in, make sure it is the correct type of pump for the application and it has been sized correctly to meet your required duty.

Specification

Model	Output		Outlet		Max	LPM Flow@Head					Dimension	Weight
	HP	KW	mm	inch	Flow (LPM)	10m	20m	30m	40m	50m	LxWxH (mm)	Kg
GHP150	1.5	1.1	32	1 1/4	50	45	37	32	25	20	407x316x720	40

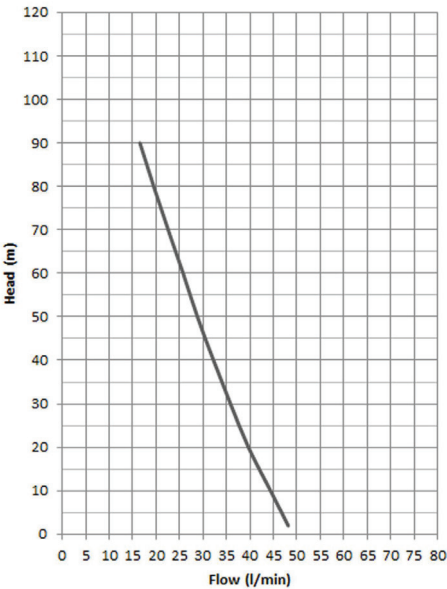

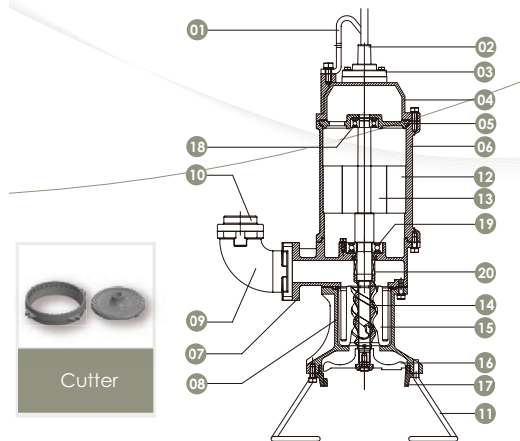
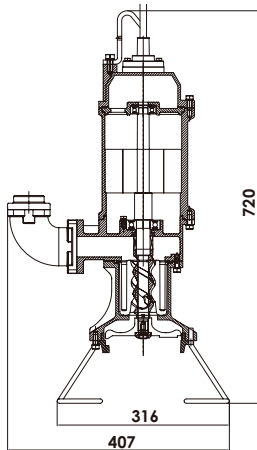

All solids can grind into fine pieces to pass easily through the pump

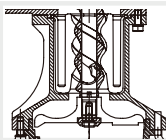

Non-jamming grinder: low-speed & high torque



50Hz: 1450RPM
60Hz: 1750RPM



High Head

Construction

No.	Description	Material	No.	Description	Material
1	Handle	Steel Plated	11	Base	SUS 304
2	Cable Gland	NBR	12	Stator	Laminated Steel
3	Cable Cover	FC200	13	Rotor	SUS 410
4	Top Cover	FC200	14	Screw Rotor	SUS 304
5	Bearing Cover	FC200	15	Bastomer Stator	NBR
6	Motor Housing	FC200	16	Cutter	SUS 440
7	Pump Casing	FC200	17	Cutter Ring	SUS 440
8	Cutter Seat	FC200	18	Bearing	
9	Elbow	FC200	19	Bearing	
10	Flange	FC200	20	Mechanical Seal	SIC/SIC

ARGON
DISTRIBUTORS LTD



argondistributors.co.nz