

NOTE: EXCEPT AS SPECIFICALLY STATED OR SHOWN ON THIS PLAT, THIS SURVEY DOES NOT PURPORT TO REFLECT ANY OF THE FOLLOWING WHICH MAY BE APPLICABLE TO THE SUBJECT REAL ESTATE: RIGHTS-OF-WAY, EASEMENTS, OTHER THAN POSSIBLE EASEMENTS THAT WERE VISIBLE AT THE TIME OF MAKING THIS SURVEY; BUILDING SETBACK LINES; RESTRICTIVE COVENANTS; SUBDIVISION RESTRICTIONS; ZONING OR OTHER LAND USE REGULATIONS AND ANY OTHER FACTS THAT AN ACCURATE AND CURRENT TITLE SEARCH MAY DISCLOSE; THIS SURVEY DOES NOT CONSTITUTE A TITLE SEARCH, FLOOD STUDY, WETLAND DELINEATION OR ENVIRONMENTAL INSPECTION BY SURVEYOR. SUBSURFACE AND ENVIRONMENTAL CONDITIONS WERE NOT SURVEYED OR EXAMINED OR CONSIDERED AS PART OF THIS SURVEY. NO EVIDENCE OR STATEMENT IS MADE CONCERNING THE EXISTENCE OF UNDERGROUND OR OVERHEAD CONDITIONS, CONTAINERS OR FACILITIES THAT MAY AFFECT THE USE OR DEVELOPMENT OF THIS PROPERTY.

2007056103 PLRT/LG 1 PG
 June 05 2007 02:55:57 PM Book:PLL 1040 Page:08-08
 Rec:\$10.00 City Tax:\$0.00 State Tax:\$0.00
 FILED IN GREENVILLE COUNTY, SC

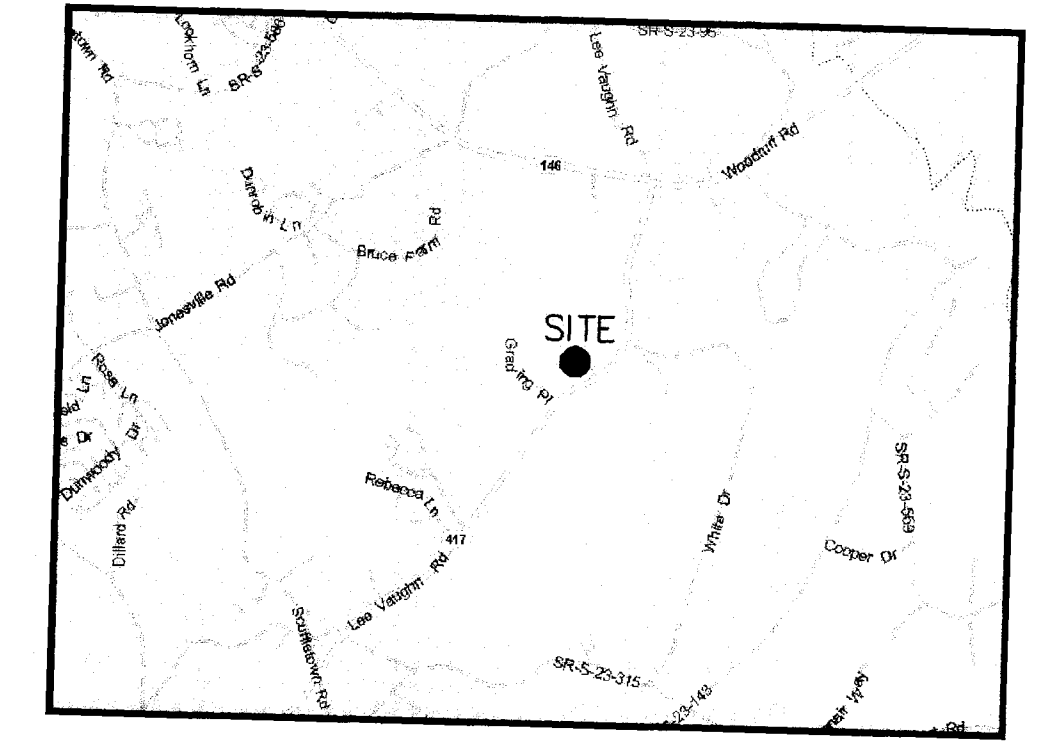

CERTIFICATE OF OWNERSHIP AND DEDICATION
 "THE UNDERSIGNED HEREBY ACKNOWLEDGE THAT I AM (WE ARE) THE OWNER(S) OF THE PROPERTY SHOWN AND DESCRIBED HEREON AND THAT I (WE) HEREBY ADOPT THIS PLAN OF SUBDIVISION WITH MY (OUR) FREE CONSENT AND THAT I (WE) ESTABLISH THE MINIMUM BUILDING RESTRICTION LINES AND HEREBY DEDICATE TO PUBLIC USE AS ROADS, STREETS, AND EASEMENTS, FOREVER ALL AREAS SO SHOWN OR INDICATED ON SAID PLAT."
 DATE 6-5-07 SIGNED [Signature]
 DATE _____ SIGNED _____
 DATE _____ SIGNED _____
 DATE _____ SIGNED _____

CERTIFICATE OF APPROVAL FOR RECORDING
 "I HEREBY CERTIFY THAT THE SUBDIVISION PLAN SHOWN HEREON HAS BEEN FOUND TO COMPLY WITH THE SUBDIVISION REGULATIONS FOR GREENVILLE COUNTY, WITH THE EXCEPTION OF SUCH VARIANCES, IF ANY, AS ARE NOTED IN THE MINUTES OF THE GREENVILLE COUNTY PLANNING COMMISSION OF GREENVILLE COUNTY, SOUTH CAROLINA, AND THAT IT HAS BEEN APPROVED FOR RECORDING IN THE OFFICE OF THE COUNTY R.O.D."
 DATE 6-5-07 SIGNED [Signature]
 AUTHORIZED REPRESENTATIVE
 GREENVILLE COUNTY PLANNING COMMISSION

FINAL 04-2009B

SHELLBROOK PLANTATION PHASE II

OWNER
 SHELLBROOK DEVELOPMENT GROUP, L.L.C.
 1530 SOUTH HWY. 14
 GREER, SC 29650

NO. OF ACRES: 21.210 MILES OF NEW ROAD: 0.59
 NO. OF LOTS: 77 DATE: 02-2-07
 ERROR OF CLOSURE: 1:10,000
 CURRENT ZONING: R-15 (CLUSTER)

SCALE: 1" = 60'

CERTIFICATE OF ACCURACY
 I HEREBY STATE THAT TO THE BEST OF MY KNOWLEDGE, INFORMATION, AND BELIEF, THE SURVEY SHOWN HEREON WAS MADE IN ACCORDANCE WITH THE REQUIREMENTS OF THE MINIMUM STANDARDS MANUAL FOR THE PRACTICE OF LAND SURVEYING IN SOUTH CAROLINA AND MEETS OR EXCEEDS THE REQUIREMENTS FOR A CLASS "A" SURVEY AS SPECIFIED THEREIN.

3D LAND SURVEYING, INC.
 No. 22746
 3-20-07
 GREENVILLE, SC 29604
 (803) 430-9995
 JCD@3DLANDSURVEYING.COM

SOUTH CAROLINA SURVEYING, INC.
 No. 03019
 GREENVILLE, SC 29604
 (803) 430-9995
 JCD@3DLANDSURVEYING.COM

FILED FOR RECORD IN GREENVILLE COUNTY, SC ROD
 2007056103 Book:PLL 1040 Page:08-08
 June 05 2007 02:55:57 PM
 County of Greenville