

# Technical Bulletin 11

Copyright 2018 by Air Options, Inc.

## How to Identify a Two-Stage Air Compressor

by Brian S. Elliott

If you know what to look for, determining whether your pump is a single- or two-stage is a fairly simple matter. Referencing the illustrations below, along with the bullet points, you can easily determine what type of pump you're operating.

Of course the easiest way to determine what type of pump you're using is to simply look up the compressor's model number on the manufacturer's web site.

- One Cylinder is Noticeably Larger than the Other
- Two-Stage Pumps Always Have an Intercooler
- The Output of the First Stage Cylinder (Larger) Always Feeds the Input of the Second Stage Cylinder (Smaller)
- The Combined Output of Two Cylinders Feeds the Input of the Third Cylinder (Three Cylinder Pumps)

Single Cylinder Pump

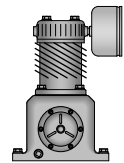

Both Cylinders are the Same Size and Both Carry Separate Air Cleaners

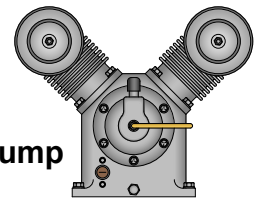

Single-Stage Pumps

"V" Pump

Both Cylinders are the Same Size and Carry a Common Air Cleaner

In-Line Pump

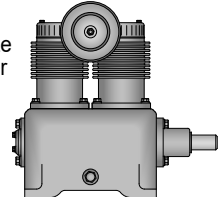

All Three Cylinders Carry Separate Air Cleaners

Three Cylinder Pump

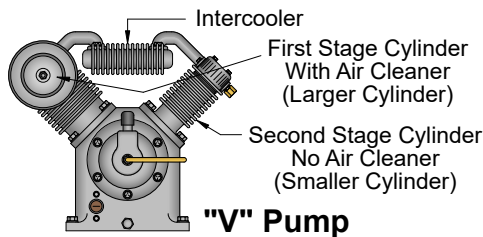
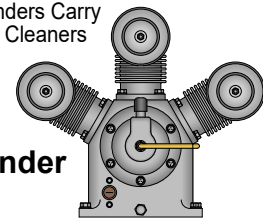

"V" Pump

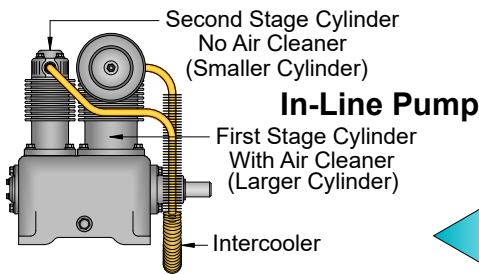

In-Line Pump

Two-Stage Pumps

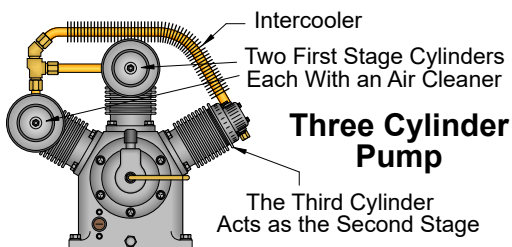

Three Cylinder Pump

Air Options, Inc.  
P.O. Box 35984  
Houston, Texas 77235-5984  
Ph.: 713-721-9619  
E-Mail: Info@Air-Options.com

JTDryers.com

A complete bound copy of Air Options Technical Bulletins can be purchased on our web site at: [JTDryers.com/jt-order-now](http://JTDryers.com/jt-order-now)



# AIR-OPTIONS, INC.

Advanced Technologies for Compressed Air