



ATLAS LIFTING & RIGGING



STRENGTH • SAFETY • RELIABILITY



We are committed to building the

ATLAS LIFTING & RIGGING IS A GLOBAL LEADER IN INNOVATION AND MANUFACTURING OF CHAIN HOISTS WITH ITS CORPORATE HEADQUARTERS BASED IN THE UNITED STATES. WE HAVE DISTRIBUTION CENTERS AND REPAIR CENTERS STRATEGICALLY LOCATED ACROSS THE US AND HAVE EXCLUSIVE PARTNERS IN EVERY CONTINENT OF THE WORLD.

Atlas Lifting & Rigging with over 270,000 sq. ft. of manufacturing, has one of the most advanced manual hoist manufacturing facilities in the world. Our manufacturing principles and philosophies are based on European and American standards.

The origins of our engineering, manufacturing and strict quality control processes trace back to centuries of German engineered and production techniques. We have blended hundreds of years of European and American hoist manufacturing expertise with today's cutting-edge engineering technology and advanced manufacturing to create a hoist that is designed to be the Strongest, Safest and Most Reliable hoist possible.



OUR COMPANIES HAVE A PROVEN TRACK RECORD OF PROVIDING THE HIGHEST QUALITY AND MOST RELIABLE MANUAL HOISTS IN THE WORLD. FOR DECADES OUR COMPANIES HAVE SUPPLIED MANUAL HOISTS TO SOME OF THE MOST WELL-KNOWN AND RESPECTED COMPANIES AROUND THE GLOBE.



Many years ago, the founder of ALR had a vision of how his companies could change the future of the global hoist industry. He saw that the world was becoming much more connected and there was an opportunity to do something that had never been done before.

He envisioned building a line of hoists that would be unmatched in the industry. He would then deliver his products direct to local distributors around the globe. He could deliver the best technology the industry has to offer at an affordable price to every job site in the world.

ATLAS LIFTING & RIGGING

STRONGEST, SAFEST, and MOST RELIABLE hoists in the world.

BUILT TO HANDLE THE TOUGHEST JOBS

- Atlas Lifting & Rigging Premium hoists are designed for pulling, lifting and positioning loads on the toughest job site. Whether your job site is an oil rig, a construction site, a fab shop, a shipyard or any other tough workplace, we have you covered.
- Our Premium chain hoists are engineered for the harshest of environments and deliver exceptional durability to meet your toughest demands.
- Packed with a patented US-Made EXTREME APPLICATION lubricant that will keep you working in the harshest environments and extreme temperatures.
- Our ultimate strength is more than 4 times Workload Limit (WLL) meeting structural requirements for use in tough applications. Every hoist is tested and certified to 150% of rated capacity.
- The Load Carrying Side Plates carry most of the load on a hoist. Our side-plates are 20% stronger because we upgraded to alloy steel rather than carbon steel like all the competition. This gives our product the strongest structure in the industry.
- Unlike most manufacturers, our hoists have a drop forged and then welded pinion shaft with Titanium for ultimate strength to give another layer of structural integrity that other competitor don't offer.
- We are committed to building the strongest hoist in the world.

BUILT TO KEEP YOU SAFE

- Every Atlas hoist is tested manually and by machine to meet our strict manufacturing requirements. Most manufactures test randomly.
- Loaded with industry leading safety features to keep you safe on the job site.
- Compact design to be light weight and durable for confined spaces and heavy loads.
- Heavy duty cast hook latches designed to allow user to actuate the latch easily without putting a finger into the hook opening which will keep your fingers from being injured and will keep your load in place and keep you safe.
- We are one of the only manufacturers to have all our manufacturing and batch identification marking on our hooks to give you complete traceability
- We are committed to building the safest hoist in the world.

BUILT TO LAST

- Atlas Lifting & Rigging Premium hoists are built to the highest tolerances and with the best materials so you know it will last. We are committed to building the best hoists in the world.
- We upgraded everything on our hoists — US-made Extreme Grease, Gears, Bearings, Braking System, Load Carrying Side Plates, Chrome Plated Corrosive Resistant Internal Parts, Welded Pinion Shafts, Handle Grips, Hooks, Safety Latches, Chain.. You name it and we have upgraded it.
- We are committed to building the most reliable hoist in the world.

Every ALR Hoist meets or exceeds OSHA and ANSI / ASME HST-3 Standards

BUILT TOUGH



We are committed to building the

ALR PREMIUM HOISTS



STRENGTH • SAFETY • RELIABILITY

STRONGEST, SAFEST, and MOST RELIABLE hoists in the world.



HEAVY DUTY

“We deliver it everyday”



Top reasons why Atlas Lifting & the **STRONGEST, SAFEST,**



High-Performance USA Blue Grease

This Premium American-Made blue grease is specifically formulated to excel in extreme conditions, such as: High operating temperatures, Contaminated environments (water, dust), Heavy loading, Extended re-lubrication intervals.

- RELIABILITY



Zinc "Flake" Coating

We are one of the only manufacturers to use "Zinc Flake" coating on crucial parts. The use of this type of coating gives our hoist the ability to last in extreme environments such as in or around saltwater. In extensive Salt Spray testing, our hoists last more than 200 hours before rusting appears. Most of our competitors will only last 30 hours before rusting appears.

- RELIABILITY



Upgraded High- Strength Alloy Side Plates

The Load Carrying Side Plates carry most of the load on a hoist. Our side plates are 20% stronger because we upgraded to alloy steel rather than carbon steel like most competitors. This gives our product the strongest structure in the industry.

- STRENGTH



Welded Structural Stay Bolts

Our Lever Hoists have structural stay bolts welded directly to the side plate instead of simply fastening them like most competitors. This is a crucial upgrade to the lever hoist that increases strength and safety by a large factor.

- STRENGTH



Sintered Brake System on all ALR Hoists

We have upgraded all our hoist to come standard with a Sintered Braking System. The design starts with applying high heat and pressure to copper, a high-performance metal. Other materials and metallic particles are then fused together to give the brake pad its extraordinary strength. The result is a brake system that won't crack, shatter or absorb moisture and holds up to the heaviest hoist loads.

- SAFETY



Quick-Adjust Free Spool Feature

Engineered to allow for quick hoist positioning, our lever hoists have a new and innovative way to adjust without accidentally freewheeling under load. Our hoist does not have to be under load to adjust with the ratchet unlike our competitors hoists which must have a load on the hoist in order to adjust the length of the chain with the ratchet.

- SAFETY



Drop Forged Pinion Shaft

Our lever hoist pinion shafts and washers are drop forged with Titanium embedded into the metal creating a single strong shaft for ultimate strength. Most manufacturers simply add a washer onto their pinion shafts.

- STRENGTH



Caged & Sealed Roller Bearings

Caged and Sealed Roller bearings provides smooth, controlled operation of the gears and shafts. This ensures maintenance-free lubrication and increased efficiency

- STRENGTH

HOIST BODY

Rigging is one of and **MOST RELIABLE** hoists in the world.



Quick Hook Replacement Design

The top hook of our chain hoist is easy to remove from the body of the hoist, making it easier to replace hooks that have been stretched or otherwise damaged due to an overload condition. The bolt holding the hook in place can be removed without disassembling the hoist body. This new configuration minimizes the hoist's headroom; plus, it makes the ALR hoist the better choice as a dedicated trolley-mounted hoist.

- RELIABILITY



Forged Identity Markings

We are one of the only manufacturers to have our manufacturing identifying marks and production date codes, plus the hook's rated capacity, embedded on the sides of the hook during the drop forge operation. Traceability is a key component of being an ISO certified manufacturer of hoists.

- SAFETY



Heavy-Duty Cast Steel Safety Latch

This new Heavy-Duty cast-steel safety latch design bulks up the base of the latch where the torque and side load stresses are greatest, this is where ordinary stamped latches fail and will bend out of compliance. The latch also has a bolt-and-lock nut connection which simplifies changing latches in the field.

- STRENGTH - SAFETY
- RELIABILITY



Hook Strength Pads

Small Raised Pads - At the base and tip of each hook are permanent measuring points to check the hook's throat opening for signs of "stretching" - an indication that the hoist has been overloaded and that the hook should be replaced.

- STRENGTH

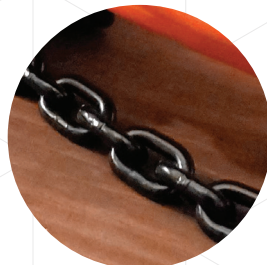

Heavy-Duty Black Phosphate Chain

We manufacture our own hardened link type steel load chain. It is 100% load tested and has an industry leading Black Phosphate Finish which delivers Maximum Corrosion protection compared to ordinary black oxide and nickel plating. Our load chain has smaller, more compact links that are 20% stronger than Grade 80 load chain.

- STRENGTH



Chain Stop Grip

The ergonomically designed and black phosphate coated cast chain stop used in our level hoists is more comfortable to grasp than the ordinary O-Ring. The design prevents the load chain from feeding through the hoist body and has the same highly corrosion resistant and scratch resistant coating that's applied to the Load Chain.

- SAFETY

HOOK & CHAIN

Every ALR Hoist meets or exceeds OSHA and ANSI / ASME HST-3 Standards



We are committed to building the

LEVER HOIST

All-Steel Construction

Impact resistant all-steel construction ensures added durability and protection while providing a long and dependable service life in toughest environments.

— **STRENGTH**

Compact Handle Design

Built to last new handle design allows for maximum power and lower head room for those tight quarter jobs.

— **RELIABILITY**

High-Performance USA Blue Grease

This Premium American Made blue grease is specifically formulated to excel in extreme conditions, such as: High operating temperatures, Contaminated environments (water, dust), Heavy loading, Extended re-lubrication intervals.

— **RELIABILITY**

Quick-Adjust Free Spool Feature

Engineered to allow for quick hoist positioning, our hoists have a new and innovative way to adjust without accidentally freewheeling under load. Our hoist does not have to be under load to adjust with the ratchet unlike our competitors hoists which must have a load on the hoist in order to adjust the length of the chain with the ratchet.

— **SAFETY**

Welded Structural Stay Bolts

Our Lever Hoists have structural stay bolts welded directly to the side plate instead of simply fastening them like most competitors. This is a crucial upgrade to the lever hoist that increases strength and safety by a large factor.

— **STRENGTH**

Sintered Brake System On All ALR Hoists

We have upgraded all our hoist to come standard with a Sintered Braking System. The design starts with applying high heat and pressure to copper, a high-performance metal. Other materials and metallic particles are then fused together to give the brake pad its extraordinary strength. The result is a brake system that won't crack, shatter or absorb moisture and holds up to the heaviest hoist loads.

— **SAFETY**

Weston-Style Brake System

Weston-Style load brake system has a Chrome Plated twin ratchet pawl brake design to reduce rusting. Fusing one brake disc to each side of the pawl allows the load to be divided between two disc and helps eliminates premature brake-disc failure.

— **RELIABILITY**

Upgraded High-Strength Alloy Side Plates

The Load Carrying Side Plates carry most of the load on a hoist. Our side-plates are 20% stronger because we upgraded to alloy steel rather than carbon steel like most competitors. This gives our product the strongest structure in the industry.

— **STRENGTH**

Drop Forged Pinion Shaft

Our lever hoist pinion shafts and washers are drop forged with Titanium embedded into the metal creating a single strong shaft for ultimate strength. Most manufacturers simply add a washer onto their pinion shafts.

— **STRENGTH**

Caged & Sealed Roller Bearings

Caged and Sealed Roller bearings provides smooth, controlled operation of the gears and shafts. This ensures maintenance-free lubrication and increased efficiency.

— **STRENGTH**

Relaxed Grip Handle Design

Our new lever handle grip features an ergonomic non-slip hilt at the base that guards against losing your grip on the tool.

Molded from a unique engineered thermoplastic, this new grip provides a soft, tactile surface that "relaxes the grip" to reduce fatigue, yet durable enough to survive years of use and exposure to the elements.

— **SAFETY**



STRONGEST, SAFEST, and MOST RELIABLE hoists in the world.

Premium Powder Coated Finish

Featuring a specifically designed long lasting powder coat finish for harsh environments.
— RELIABILITY

Overload Protection

Optional Overload Protection prevents lifting or pulling damaging loads beyond the rated capacity of the hoist and when triggered, as well as injury to personnel. Overload Protection is set at approximately 150% of rated and can be reset on site.
— SAFETY

Forged Identity Markings

We are one of the only manufacturers to have our manufacturing identifying marks and production date codes, plus the hook's rated capacity, embedded on the sides of the hook during the drop forge operation. Traceability is a key component of being an ISO certified manufacturer of hoists.
— SAFETY

Heavy-Duty Cast Steel Safety Latch

This new Heavy-Duty cast-steel safety latch design bulks up the base of the latch where the torque and side load stresses are greatest, this is where ordinary stamped latches fail and will bend out of compliance. The latch also has a bolt-and-lock nut connection which simplifies changing latches in the field.
— STRENGTH — SAFETY — RELIABILITY

Heavy-Duty Black Phosphate Chain

We manufacture our own hardened link type steel load chain. It is 100% load tested and has an industry leading Black Phosphate Finish which delivers Maximum Corrosion protection compared to ordinary black oxide and nickel plating. Our load chain has smaller, more compact links that are 20% stronger than Grade 80 load chain.
— STRENGTH

Chain Stop Grip

The ergonomically designed and black phosphate coated cast chain stop used in our level hoists is more comfortable to grasp than the ordinary O-Ring. The design prevents the load chain from feeding through the hoist body and has the same highly corrosion resistant and scratch resistant coating that's applied to the Load Chain.
— SAFETY

Hook Strength Pads

Small Raised Pads - At the base and tip of each hook are permanent measuring points to check the hook's throat opening for signs of "stretching"—an indication that the hoist has been overloaded and that the hook should be replaced.
— STRENGTH

360-Degree Hook Rotation

The 360 Degree swivel hook design allows the operator to work in confined spaces with quick and easy positioning of the hoist in any directions.
— RELIABILITY

Optional Shipyard Hook

Shipyard Hooks are designed with blunt tips for point loading and engineered to help eliminate stretched hooks.
— SAFETY

Quick Hook Replacement Design

The top hook of our chain hoist is easy to remove from the body of the hoist, making it easier to replace hooks that have been stretched or otherwise damaged due to an overload condition.

The bolt holding the hook in place can be removed without disassembling the hoist body. This new configuration minimizes the hoist's headroom; plus, it makes the ALR hoist the better choice as a dedicated trolley-mounted hoist.
— RELIABILITY



LEVER
HOIST

Every ALR Hoist meets or exceeds OSHA and ANSI / ASME HST-3 Standards



We are committed to building the

STRENGTH

- Atlas Lifting & Rigging Premium hoists are designed for pulling, lifting and positioning loads on the toughest job site.
- Engineered for the harshest of environments and delivering exceptional durability to meet your toughest demands.

SAFETY

- Loaded with industry leading safety features to keep you safe on the job site.
- Compact design is light weight and durable for confined spaces and heavy loads.

RELIABILITY

- Built to the highest tolerances and with the best materials so you know it will last.
- We Upgraded everything on our hoists — US-made Extreme Grease, Gears, Bearings, Braking System, Load Carrying Side Plates, Chrome Plated Corrosive Resistant Internal Parts, Welded Pinion Shafts, Handle Grips, Hooks, Safety Latches, Chain.. You name it and we have upgraded it.



OVERLOAD PROTECTION ADDS AN EXTENDED LAYER OF PROTECTION TO THE USER OF THE HOIST AND THE HOIST ITSELF.

It's not uncommon for a worker to rig a load without knowing the exact weight of what they are lifting. Overload protection prevents lifting or pulling damaging loads beyond the rated capacity of the hoist and when triggered, as well as injury to personnel.

OVERLOAD PROTECTION WILL ACTIVATE AT APPROXIMATELY 150% OF RATED LOAD.



LEVER HOIST

STRONGEST, SAFEST, and MOST RELIABLE hoists in the world.

WITH Overload Protection

Product Number	Capacity (ton)	Capacity (lbs)	Chain (ft)
ALH-008-5-OP	3/4	1,500	5
ALH-008-10-OP	3/4	1,500	10
ALH-008-15-OP	3/4	1,500	15
ALH-008-20-OP	3/4	1,500	20
ALH-010-5-OP	1	2,200	5
ALH-010-10-OP	1	2,200	10
ALH-010-15-OP	1	2,200	15
ALH-010-20-OP	1	2,200	20
ALH-016-5-OP	1.6	3,500	5
ALH-016-10-OP	1.6	3,500	10
ALH-016-15-OP	1.6	3,500	15
ALH-016-20-OP	1.6	3,500	20
ALH-025-5-OP	2.5	5,511	5
ALH-025-10-OP	2.5	5,511	10
ALH-025-15-OP	2.5	5,511	15
ALH-025-20-OP	2.5	5,511	20
ALH-032-5-OP	3.2	7,050	5
ALH-032-10-OP	3.2	7,050	10
ALH-032-15-OP	3.2	7,050	15
ALH-032-20-OP	3.2	7,050	20
ALH-063-5-OP	6.3	13,890	5
ALH-063-10-OP	6.3	13,890	10
ALH-063-15-OP	6.3	13,890	15
ALH-063-20-OP	6.3	13,890	20
ALH-090-5-OP	9	19,800	5
ALH-090-10-OP	9	19,800	10
ALH-090-15-OP	9	19,800	15
ALH-090-20-OP	9	19,800	20

WITH-OUT Overload Protection

Product Number	Capacity (ton)	Capacity (lbs)	Chain (ft)
ALH-008-5	3/4	1,500	5
ALH-008-10	3/4	1,500	10
ALH-008-15	3/4	1,500	15
ALH-008-20	3/4	1,500	20
ALH-010-5	1	2,200	5
ALH-010-10	1	2,200	10
ALH-010-15	1	2,200	15
ALH-010-20	1	2,200	20
ALH-016-5	1.6	3,500	5
ALH-016-10	1.6	3,500	10
ALH-016-15	1.6	3,500	15
ALH-016-20	1.6	3,500	20
ALH-025-5	2.5	5,511	5
ALH-025-10	2.5	5,511	10
ALH-025-15	2.5	5,511	15
ALH-025-20	2.5	5,511	20
ALH-032-5	3.2	7,050	5
ALH-032-10	3.2	7,050	10
ALH-032-15	3.2	7,050	15
ALH-032-20	3.2	7,050	20
ALH-063-5	6.3	13,890	5
ALH-063-10	6.3	13,890	10
ALH-063-15	6.3	13,890	15
ALH-063-20	6.3	13,890	20
ALH-090-5	9	19,800	5
ALH-090-10	9	19,800	10
ALH-090-15	9	19,800	15
ALH-090-20	9	19,800	20



LEVER HOIST

Custom Chain Lengths and Shipyard Hooks Available



We are committed to building the

LEVER HOIST

ALR LEVER HOIST SPECIFICATIONS & DIMENSIONS

Product Number Capacity		Ton	ALH-008 3/4	ALH-010 1	ALH-016 1.6	ALH-025 2.5	ALH-032 3.2	ALH-063 6.3	ALH-090 9
Number of Falls			1	1	1	1	1	2	3
Capacity		(lbs)	1,760	2,200	3,500	5,500	7,000	13,890	19,800
Capacity Test Load		(lbs)	2,640	3,300	5,290	8,260	10,580	20,940	29,760
Capacity Test Load		(ton)	1.2	1.5	2.4	3.75	4.8	9.5	13.5
Load Chain		(mm)	5.6x15.7	5.6x15.7	7.1x19.9	8.8x24.6	10x28	10x28	10x28
Standard Lift		(ft)	5	5	5	5	5	5	5
Height	h	(in)	11.81	11.81	13.19	14.76	15.55	21.26	26.77
Length	a	(in)	5.75	5.75	6.5	7.05	7.71	7.72	7.72
Width	b	(in)	4.69	4.69	4.97	5.9	6.26	8.58	11.73
Net Weight		(lbs)	13.23	13.23	17.86	24.69	29.32	56.22	90.39
Gross Weight		(lbs)	13.89	13.89	18.74	25.57	31.31	58.64	102.52
Pull to Rated Load		(lbs)	67.67	67.67	76.21	86.78	87.23	89.48	88.13
Dimensions	a	(mm)	146	146	164	179	196	196	196
	b	(mm)	119	119	126	150	159	218	298
	c	(mm)	245	245	265	265	415	415	415
	d	(mm)	96	96	100	103	114	114	114
	e	(mm)	26.5	31.5	35.5	41	43	53	64
	f	(mm)	35.5	42.5	42.5	47	50	60	85
	g	(mm)	41.5	49.4	52	58.6	61.9	84.3	
	h	(mm)	280	300	335	375	395	540	680
	t	(mm)	14	15	19	21	24.5	34	40



STRONGEST, SAFEST, and MOST RELIABLE hoists in the world.

MANUAL OPERATED LEVER HOIST

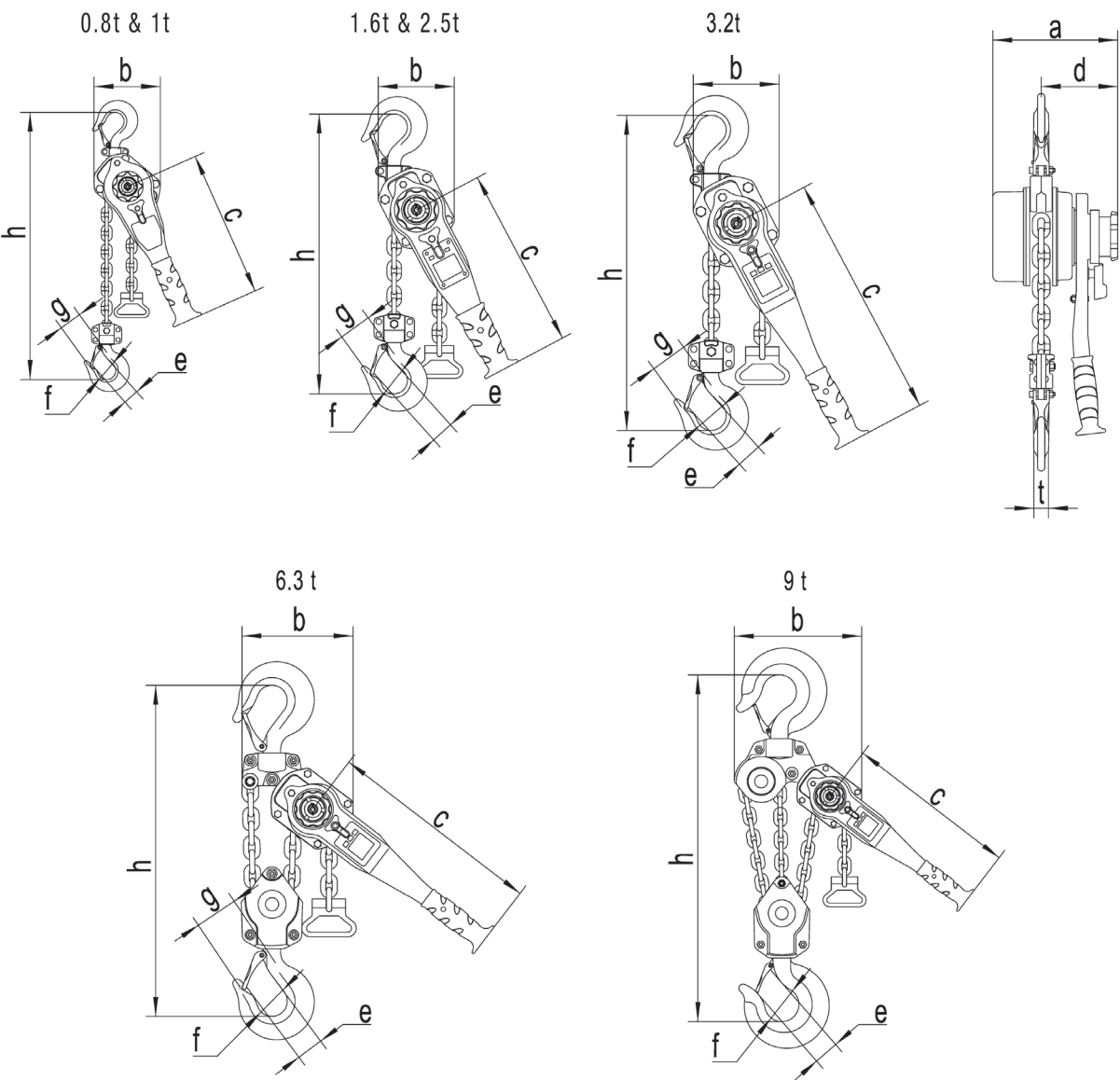

3
YEAR*
WARRANTY

LEVER HOIST





We are committed to building the

COMPACT LEVER HOIST

The ALHC Series compact hoist is built tough and will fit in a toolbox.

A great hoist for construction, plumbing, HVAC, electrical work and ATV use.

Available in ¼, ½ and ¾ Ton capacities and will easily handle most applications where weights are under 1 ton. This is a must have tool for any toolbox. When you have something that needs to be lifted quick and easily, there is no better tool to have by your side.

All-Steel Construction

Impact resistant all-steel construction ensures added durability and protection while providing a long and dependable service life in toughest environments - **STRENGTH**

Compact Handle Design

Built to last new handle design allows for maximum power and lower head room for those tight quarter jobs - **RELIABILITY**

360-Degree Hook Rotation

The 360 Degree swivel hook design allows the operator to work in confined spaces with quick and easy positioning of the hoist in any directions - **RELIABILITY**

Weston-Style Brake System

Weston-Style load brake system has a twin ratchet pawl brake design. Fusing one brake disc to each side of the pawl allows the load to be divided between two disc and helps eliminates premature brake-disc failure - **RELIABILITY**



Heavy-Duty Cast Steel Latch

This new Heavy-Duty cast-steel safety latch design bulks up the base of the latch where the torque and side load stresses are greatest, this is where ordinary stamped latches fail and will bend out of compliance. The latch also has a bolt-and-lock nut connection which simplifies changing latches in the field - **STRENGTH**

Relaxed Grip Handle Design

Molded from a unique engineered thermoplastic, this new grip provides a soft, tactile surface that "relaxes the grip" to reduce fatigue, yet durable enough to survive years of use and exposure to the elements - **SAFETY**

- Every unit is inspected and tested to 150% of rated capacity before leaving the factory in accordance with ASME B30.21 requirements.

MANUAL OPERATED COMPACT LEVER HOIST

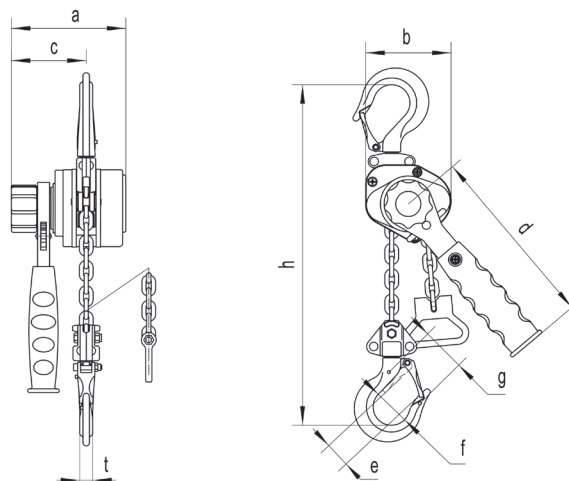

Every ALR Hoist meets or exceeds OSHA and ANSI / ASME HST-3 Standards

STRONGEST, SAFEST, and MOST RELIABLE hoists in the world.

ALHC SERIES COMPACT LEVER HOIST

Product Number	Description	Capacity (lbs)
ALHC-0025-5	1/4 Ton Lever Hoist with 5 ft. Chain Fall	550
ALHC-0025-10	1/4 Ton Lever Hoist with 10 ft. Chain Fall	550
ALHC-0025-15	1/4 Ton Lever Hoist with 15 ft. Chain Fall	550
ALHC-005-5	1/2 Ton Lever Hoist with 5 ft. Chain Fall	1,100
ALHC-005-10	1/2 Ton Lever Hoist with 10 ft. Chain Fall	1,100
ALHC-005-15	1/2 Ton Lever Hoist with 15 ft. Chain Fall	1,100
ALHC-0075-5	3/4 Ton Lever Hoist with 5 ft. Chain Fall	1,650
ALHC-0075-10	3/4 Ton Lever Hoist with 10 ft. Chain Fall	1,650
ALHC-0075-15	3/4 Ton Lever Hoist with 15 ft. Chain Fall	1,650

Custom Chain Lengths Available

ALHC COMPACT LEVER HOIST SPECIFICATIONS

Capacity	(ton)	1/4	1/2	3/4
Capacity	(lbs)	550	1,100	1,650
Load Chain	(mm)	3.2x9	4.3x12	5.0x15.0
Pull to Rated Load	(lbs)	40	72.8	83.85
Proof Load	(lbs)	825	1,650	2,475
Standard Lift	(ft)	5	5	5
Weight	(lbs)	3.31	4.85	7.5
Headroom	h (in)	7.87	9.84	10.23
Handle Length	d (in)	5.51	7.09	7.09
Dimensions	a (mm)	87	100.5	105
	b (mm)	76	81	92
	c (mm)	55.5	62.5	64
	d (mm)	140	160	180
	e (mm)	21	24.5	28.5
	f (mm)	32	34.5	35.5
	g (mm)	35.5	42	42
	h (mm)	200	250	260
	t (mm)	11	12	14



COMPACT LEVER HOIST



We are committed to building the

HOIST BODY

All-Steel Construction

Impact resistant all-steel construction ensures added durability and protection while providing a long and dependable service life in toughest environments.

— **STRENGTH**

Premium Powder Coated Finish

Featuring a specifically designed long lasting powder coat finish for harsh environments. — **RELIABILITY**

Overload Protection

Optional Overload Protection prevents lifting or pulling damaging loads beyond the rated capacity of the hoist and when triggered, as well as injury to personnel. Overload Protection is set at approximately 150% of rated and can be reset on site.

— **SAFETY**

High-Performance USA Blue Grease

This Premium American Made blue grease is specifically formulated to excel in extreme conditions, such as: High operating temperatures, Contaminated environments (water, dust), Heavy loading, Extended re-lubrication intervals. — **RELIABILITY**

Sintered Brake System On All ALR Hoists

We have upgraded all our hoist to come standard with a Sintered Braking System. The design starts with applying high heat and pressure to copper, a high-performance metal. Other materials and metallic particles are then fused together to give the brake pad its extraordinary strength. The result is a brake system that won't crack, shatter or absorb moisture and holds up to the heaviest hoist loads.

— **SAFETY**

Oversized Sintered Brake System

All of our chain hoist 5 ton and larger come with an oversized "Sintered Brake System" is specifically engineered for "Heavy Loads". If the contact area of the braking system is too small, it will cause overheating and failure. We have oversized the crucial components to create more contact area for braking. — **SAFETY**

Weston-Style Brake System

Weston-Style load brake system has a Chrome Plated twin ratchet pawl brake design to reduce rusting. Fusing one brake disc to each side of the pawl allows the load to be divided between two disc and helps eliminates premature brake-disc failure. — **RELIABILITY**

Upgraded High-Strength Alloy Side Plates

The Load Carrying Side Plates carry most of the load on a hoist. Our side-plates are 20% stronger because we upgraded to alloy steel rather than carbon steel like most competitors. This gives our product the strongest structure in the industry. — **STRENGTH**



STRONGEST, SAFEST, and MOST RELIABLE hoists in the world.

Quick Hook Replacement Design

The top hook of our chain hoist is easy to remove from the body of the hoist, making it easier to replace hooks that have been stretched or otherwise damaged due to an overload condition.

The bolt holding the hook in place can be removed without disassembling the hoist body. This new configuration minimizes the hoist's headroom; plus, it makes the ALR hoist the better choice as a dedicated trolley-mounted hoist.

— *RELIABILITY*

Caged & Sealed Roller Bearings

Caged and Sealed Roller bearings provides smooth, controlled operation of the gears and shafts. This ensures maintenance-free lubrication and increased efficiency. — *STRENGTH*

Forged Identity Markings

We are one of the only manufacturers to have our manufacturing identifying marks and production date codes, plus the hook's rated capacity, embedded on the sides of the hook during the drop forge operation. Traceability is a key component of being an ISO certified manufacturer of hoists. — *SAFETY*

Heavy-Duty Cast Steel Safety Latch

This new Heavy-Duty cast-steel safety latch design bulks up the base of the latch where the torque and side load stresses are greatest, this is where ordinary stamped latches fail and will bend out of compliance. The latch also has a bolt-and-lock nut connection which simplifies changing latches in the field.

— *STRENGTH — SAFETY — RELIABILITY*

Heavy-Duty Black Phosphate Chain

We manufacture our own hardened link type steel load chain. It is 100% load tested and has an industry leading Black Phosphate Finish which delivers Maximum Corrosion protection compared to ordinary black oxide and nickel plating. Our load chain has smaller, more compact links that are 20% stronger than Grade 80 load chain. — *STRENGTH*

Hook Strength Pads

Small Raised Pads - At the base and tip of each hook are permanent measuring points to check the hook's throat opening for signs of "stretching"—an indication that the hoist has been overloaded and that the hook should be replaced. — *STRENGTH*

360-Degree Hook Rotation

The 360 Degree swivel hook design allows the operator to work in confined spaces with quick and easy positioning of the hoist in any directions. — *RELIABILITY*

Optional Shipyard Hook

Shipyard Hooks are designed with blunt tips for point loading and engineered to help eliminate stretched hooks. — *SAFETY*

Every ALR Hoist meets or exceeds OSHA and ANSI / ASME HST-3 Standards

3

YEAR*
WARRANTY

HOOK & CHAIN



We are committed to building the

STRENGTH

- Atlas Lifting & Rigging Premium hoists are designed for pulling, lifting and positioning loads on the toughest job site.
- Engineered for the harshest of environments and delivering exceptional durability to meet your toughest demands.

SAFETY

- Loaded with industry leading safety features to keep you safe on the job site.
- Compact design is light weight and durable for confined spaces and heavy loads.

RELIABILITY

- Built to the highest tolerances and with the best materials so you know it will last.
- We Upgraded everything on our hoists - US-made Extreme Grease, Gears, Bearings, Braking System, Load Carrying Side Plates, Chrome Plated Corrosive Resistant Internal Parts, Welded Pinion Shafts, Handle Grips, Hooks, Safety Latches, Chain.. You name it and we have upgraded it.



CHAIN HOIST



OVERLOAD PROTECTION ADDS AN EXTENDED LAYER OF PROTECTION TO THE USER OF THE HOIST AND THE HOIST ITSELF.

It's not uncommon for a worker to rig a load without knowing the exact weight of what they are lifting. Overload protection prevents lifting or pulling damaging loads beyond the rated capacity of the hoist and when triggered, as well as injury to personnel.

OVERLOAD PROTECTION WILL ACTIVATE AT APPROXIMATELY 150% OF RATED LOAD.

STRONGEST, SAFEST, and MOST RELIABLE hoists in the world.

WITH Overload Protection

Product Number	Capacity (ton)	Capacity (lbs)	Chain (ft)
ACH-0025-10-OP	1/4	550	10
ACH-0025-15-OP	1/4	550	15
ACH-0025-20-OP	1/4	550	20
ACH-0025-30-OP	1/4	550	30
ACH-005-10-OP	1/2	1,100	10
ACH-005-15-OP	1/2	1,100	15
ACH-005-20-OP	1/2	1,100	20
ACH-005-30-OP	1/2	1,100	30
ACH-010-10-OP	1	2,200	10
ACH-010-15-OP	1	2,200	15
ACH-010-20-OP	1	2,200	20
ACH-010-30-OP	1	2,200	30
ACH-015-10-OP	1.5	3,300	10
ACH-015-15-OP	1.5	3,300	15
ACH-015-20-OP	1.5	3,300	20
ACH-015-30-OP	1.5	3,300	30
ACH-020-10-OP	2	4,400	10
ACH-020-15-OP	2	4,400	15
ACH-020-20-OP	2	4,400	20
ACH-020-30-OP	2	4,400	30
ACH-030-10-OP	3	6,600	10
ACH-030-15-OP	3	6,600	15
ACH-030-20-OP	3	6,600	20
ACH-030-30-OP	3	6,600	30
ACH-032-10-OP	3.2	7,050	10
ACH-032-15-OP	3.2	7,050	15
ACH-032-20-OP	3.2	7,050	20
ACH-032-30-OP	3.2	7,050	30
ACH-050-10-OP	5	11,000	10
ACH-050-15-OP	5	11,000	15
ACH-050-20-OP	5	11,000	20
ACH-050-30-OP	5	11,000	30
ACH-100-10-OP	10	22,000	10
ACH-100-15-OP	10	22,000	15
ACH-100-20-OP	10	22,000	20
ACH-100-30-OP	10	22,000	30
ACH-150-10-OP	15	33,000	10
ACH-150-15-OP	15	33,000	15
ACH-150-20-OP	15	33,000	20
ACH-150-30-OP	15	33,000	30
ACH-200-10-OP	20	44,000	10
ACH-200-15-OP	20	44,000	15
ACH-200-20-OP	20	44,000	20
ACH-200-30-OP	20	44,000	30

WITH-OUT Overload Protection

Product Number	Capacity (ton)	Capacity (lbs)	Chain (ft)
ACH-0025-10	1/4	550	10
ACH-0025-15	1/4	550	15
ACH-0025-20	1/4	550	20
ACH-0025-30	1/4	550	30
ACH-005-10	1/2	1,100	10
ACH-005-15	1/2	1,100	15
ACH-005-20	1/2	1,100	20
ACH-005-30	1/2	1,100	30
ACH-010-10	1	2,200	10
ACH-010-15	1	2,200	15
ACH-010-20	1	2,200	20
ACH-010-30	1	2,200	30
ACH-015-10	1.5	3,300	10
ACH-015-15	1.5	3,300	15
ACH-015-20	1.5	3,300	20
ACH-015-30	1.5	3,300	30
ACH-020-10	2	4,400	10
ACH-020-15	2	4,400	15
ACH-020-20	2	4,400	20
ACH-020-30	2	4,400	30
ACH-030-10	3	6,600	10
ACH-030-15	3	6,600	15
ACH-030-20	3	6,600	20
ACH-030-30	3	6,600	30
ACH-032-10	3.2	7,050	10
ACH-032-15	3.2	7,050	15
ACH-032-20	3.2	7,050	20
ACH-032-30	3.2	7,050	30
ACH-050-10	5	11,000	10
ACH-050-15	5	11,000	15
ACH-050-20	5	11,000	20
ACH-050-30	5	11,000	30
ACH-100-10	10	22,000	10
ACH-100-15	10	22,000	15
ACH-100-20	10	22,000	20
ACH-100-30	10	22,000	30
ACH-150-10	15	33,000	10
ACH-150-15	15	33,000	15
ACH-150-20	15	33,000	20
ACH-150-30	15	33,000	30
ACH-200-10	20	44,000	10
ACH-200-15	20	44,000	15
ACH-200-20	20	44,000	20
ACH-200-30	20	44,000	30



CHAIN HOIST

30 - 50 - 80 Ton Chain Hoists Available Upon Request | Custom Chain Lengths and Shipyard Hooks Available

Every ALR Hoist meets or exceeds OSHA and ANSI / ASME HST-3 Standards

ACH SERIES CHAIN HOIST SPECIFICATION & DIMENSIONS

Product Number		ACH-0025	ACH-005	ACH-010	ACH-015	ACH-020	ACH-030	ACH-032	ACH-050	ACH-100	ACH-150	ACH-200
Capacity	(ton)	0.25	0.5	1	1.5	2	3	3.2	5	10	15	20
No. of Falls		1	1	1	1	1	2	1	2	4	6	8
Capacity	(lbs)	550	1,100	2,200	3,300	4,400	6,600	7,050	11,000	22,000	33,000	44,000
Capacity Test Load	(lbs)	825	1,650	3,300	4,950	6,600	9,900	10,575	16,500	33,000	49,500	66,000
Capacity Test Load	(ton)	0.375	0.75	1.5	2.25	3	4.5	4.8	7.5	15	22.5	25
Load Chain	(mm)	4x12	5x15	6.3x19	7.1x21	8x24	7.1x21	10x30	10x30	10x30	10x30	10x30
Standard Lift	(ft)	10	10	10	10	10	10	10	10	10	10	10
Hand Chain	(mm)	3x15x10	5x25x18									
Overhaul Ratio	per 1 ft	4.74	7.66	12.97	17.15	21.02	34.31	33.45	69.48	138.96	208.45	277.93
Height	h (in)	9.84	11.22	13.39	14.76	16.33	20.28	19.09	26.38	34.06	39.37	45.28
Length	a (in)	3.78	5.12	6.34	6.7	7.2	6.69	7.5	7.56	7.48	8.66	9.06
Width	b (in)	4.29	5.47	6.34	7.17	7.95	9.25	9.25	11.1	14.02	19.37	25.79
Net Weight	(lbs)	8.6	23.81	27.34	34.39	44.09	52.91	60.41	90.39	218.53	337.31	451.95
Gross Weight	(lbs)	9.48	24.91	28.44	35.16	46.3	54.67	63.71	93.72	231.49	365.97	482.81
Pull to Rated Load	(N)	220	260	308	348	379	363	381	353	379	409	445
Dimensions	a (mm)	96	130	161	170	183.5	170	190.5	192	192	220	230
	b (mm)	109	139.5	161	182	202.5	235	235	282	360	492	655
	c (mm)	29.5	43	51	64	64	106	68.5	133	263	110	286
	d (mm)	21	25	30	34	34	53	38.6	64	95	170	123
	e (mm)	27	27	33	33.5	37	43.5	43	51	64	80	82
	f (mm)	32	32	40	42	46	52	49.5	60	85	100	110
	g (mm)	35.5	35	45	47	52	62.5	62	79			
	h (mm)	250	285	295	350	375	510	485	600	760	1000	1150

MANUAL CHAIN HOIST

0.25 t, 0.5 t, 1 t, 1.5 t, 2 t & 3.2 t

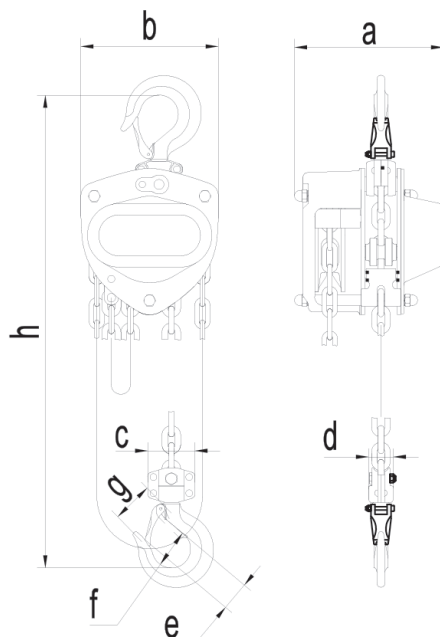

3t & 5 t

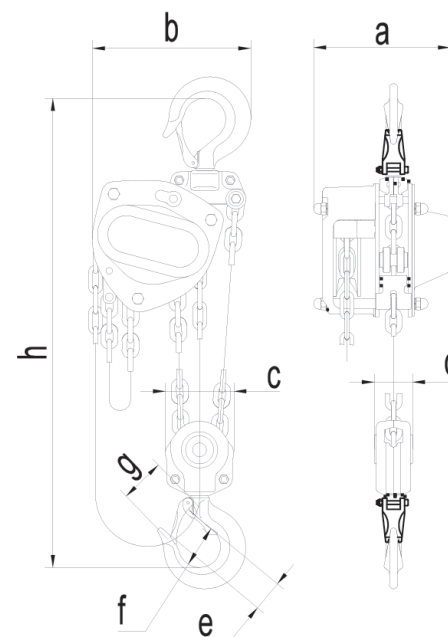

STRONGEST, SAFEST, and MOST RELIABLE hoists in the world.

MANUAL CHAIN HOIST (cont.)

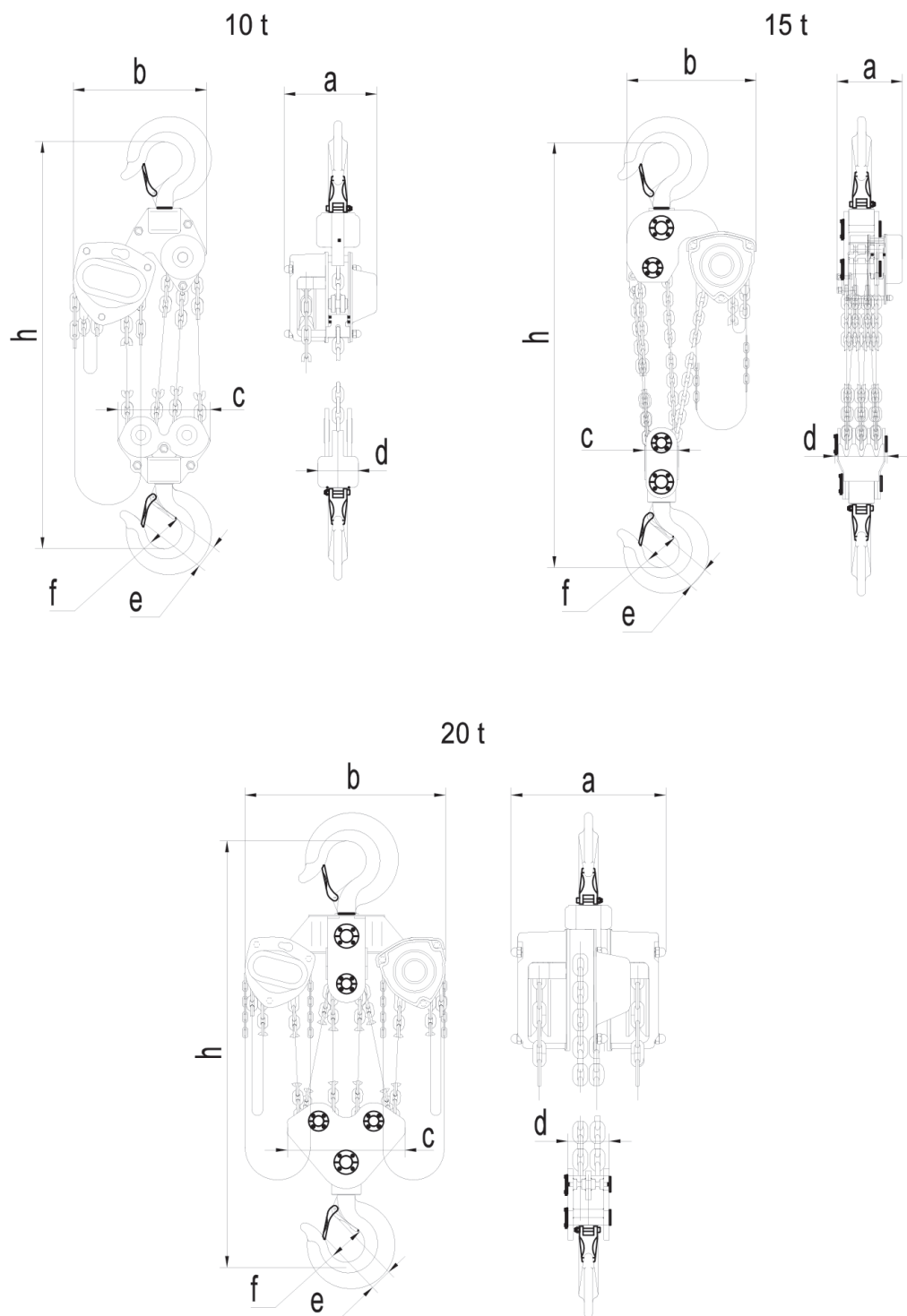

3
YEAR*
WARRANTY

CHAIN HOIST

Every ALR Hoist meets or exceeds OSHA and ANSI / ASME HST-3 Standards





We are committed to building the

This revolutionary patented dual speed chain hoist is equipped with Load Sensing Automatic Speed Transmission which is the first in this industry.

The hoist can lift and lower the load chain 5 times faster than a regular chain hoist when it does not have a load.

When the hoist is loaded, the lifting and lowering speed will be the same as a regular chain hoist. Smooth speed transmissions between high and standard speed without neutral position, which is reliable and safe. The Dual Speed Chain Hoist is equipped with an overload limiter ensuring safe operation.

Automatic Speed Transmission

Equipped with Load Sensing "Automatic Speed Transmission" which is the first in this field.

Dual Speed

When the hoist is loaded, the lifting and lowering speed will be the same as a regular chain hoist.

5 Times Faster

When the hoist is not loaded, the lifting and lowering speed are geared for quick load adjustment, making the hoist 5 times faster than a standard hoist.

Reliable and Safe

Smooth speed transmission between high and standard speed without neutral position.

Overload Protection

Equipped with an overload limiter ensuring safe operation.

Double Pawl

Reinforced double pawl brake system and larger diameter pawl springs ensure reliable brake

Meet and Exceeds Standards

EN13157, ASNE B30.16 and JIS B8802 standards.

Patented

USA, Canada, Germany, Australia, China, S. Korea and Taiwan China.

Quick Safety Inspection Indicator

The dual speed chain hoist top and bottom hooks have overload indicator marks on the hook throat that can be quickly measured for possible overloading.



DUAL SPEED

STRONGEST, SAFEST, and MOST RELIABLE hoists in the world.

Product Number	Capacity (ton)	Capacity (lbs)	Chain (ft)
ADSCH-032-10	3.2	7,040	10
ADSCH-032-20	3.2	7,040	20
ADSCH-050-10	5	11,000	10
ADSCH-050-20	5	11,000	20
ADSCH-075-10	7.5	15,400	10
ADSCH-075-20	7.5	15,400	20
ADSCH-100-10	10	22,000	10
ADSCH-100-20	10	22,000	20
ADSCH-150-10	15	33,000	10
ADSCH-150-20	15	33,000	20
ADSCH-200-10	20	44,000	10
ADSCH-200-20	20	44,000	20

Custom Chain Lengths Available



5X FASTER

ADSCH SERIES CHAIN HOIST SPECIFICATIONS & DIMENSIONS

Product Number			ADSCH-032	ADSCH-050	ADSCH-075	ADSCH-100	ADSCH-150	ADSCH-200
Capacity		(ton)	3.2	5	7.5	10	15	20
No. of Falls			1	2	3	3	5	6
Capacity		(lbs)	7,040	11,000	15,400	22,000	33,000	44,000
Capacity Test Load		(lbs)	10,560	16,500	24,750	33,000	49,500	55,000
Capacity Test Load		(ton)	4.8	7.5	11.25	15	22.5	25
Load Chain Grade			100	100	100	100	100	100
Load Chain		(mm)	10×30					
Hand Chain		(mm)	5x25x18					
Standard Lift		(ft)	10	10	15	15	15	15
High Speed to Low		(lbs)	>121	>242	>363	>363	>606	>727
Low Speed to High		(lbs)	<55	<110	<165	<165	<275	<330
Pull to Rated Load		(N)	360	296	312	328	345	328x2
Weight		(lbs)	68.34	99.21	168.66	190.7	318.57	405.65
Height	h	(in)	18.31	23.62	29.13	29.92	39.37	45.28
Length	b	(in)	9.72	10.83	14.41	14.41	19.09	9.06
Width	a	(in)	9.72	9.72	9.72	9.72	10.83	25.79
Dimensions	a	(mm)	247	247	247	247	275	285
	b	(mm)	227	275	366	366	485	648
	c	(mm)	68.5	133	120	263	110	286
	d	(mm)	38.5	64	70	95	168	123
	e	(mm)	43	51	64	64	80	82
	f	(mm)	49.5	60	85	85	100	110
	g	(mm)	62	79				
	h	(mm)	465	600	740	760	1000	1150



We are committed to building the

BEAM TROLLEY



ABT BEAM TROLLEY

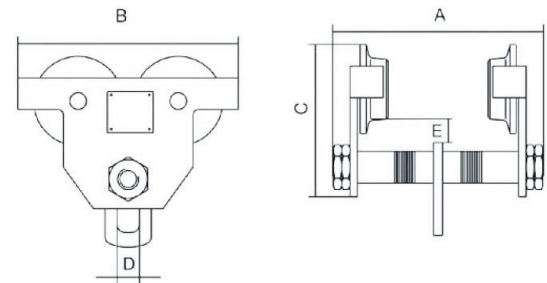

ABT BEAM TROLLEY SPECIFICATIONS

Product Number		ABT-005A	ABT-010A	ABT-020A	ABT-030A	ABT-050A	ABT-100A
Capacity	(t)	0.5	1	2	3	5	10
Proof Load	(t)	0.75	1.5	3	4.5	7.5	15
I-Beam Width	(mm)	50-152	64-203	88-203	100-203	114-203	125-210
Dimensions (mm)	A	230	296	313	334	363	410
	B	218	257	300	340	380	389
	C	155	181	214.5	252	290	364.5
	D	24	30	36	45	60	80
	E	21.7	23.5	23.5	32.5	28	48
Min. Radius Curve	(m)	1	1	1.1	1.3	1.4	1.7
Net Weight	(kg)	7.1	12.8	18.8	33.7	50.7	88

STRONGEST, SAFEST, and MOST RELIABLE hoists in the world.



ABT GEARED TROLLEY

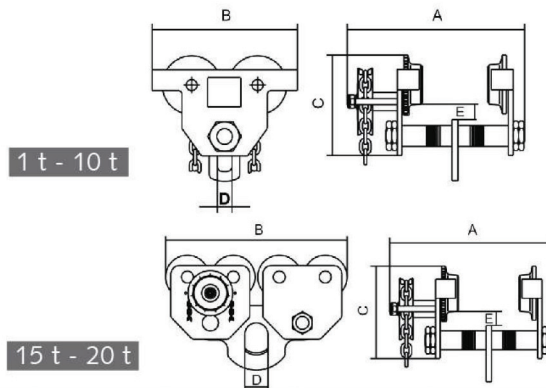

3

YEAR*
WARRANTY

GEARED TROLLEY

ABT GEARED TROLLEY SPECIFICATIONS

Product Number		ABT-010B	ABT-020B	ABT-030B	ABT-050B	ABT-100B	ABT-150B	ABT-200B
Capacity	(t)	1	2	3	5	10	15	20
Proof Load	(t)	1.5	3	4.5	7.5	15	22.5	30
I-Beam Width	(mm)	64-203	88-203	100-203	114-203	125-210	125-210	125-210
Dimensions (mm)	A	344	362	383	416	461	480	480
	B	257	300	340	380	389	789	789
	C	181	214.5	252	290	364.5	364.5	364.5
	D	30	36	45	60	80	100	100
	E	23.5	23.5	32.5	28	48	48	48
Min. Radius Curve	(m)	1	1.1	1.3	1.4	1.7	1.7	1.7
Net Weight	(kg)	17	23.5	38.7	55.7	93	176	191



We are committed to building the

BEAM CLAMP

BEAM CLAMP SPECIFICATIONS

Product Number		ABC-1	ABC-2	ABC-3	ABC-5	ABC-10
Capacity	(ton)	1	2	3	5	10
Proof Load	(ton)	1.5	3	4.5	7.5	15
I-Beam Width	(mm)	75-230	75-230	90-320	90-320	90-320
Dimensions (mm)	A	265	280	375	373	356
	B	185	175	225	225	250
	B	370	385	500	500	520
	C	65	75	100	112	120
	D	4	5	7	10	12
	E	215	220	280	280	285
	F	150	145	230	230	230
	F	90	80	135	135	160
	G	34	32	55	56	51
	H	22	24	26	32	42
Net Weight	(kg)	4	5	10	12	16.3

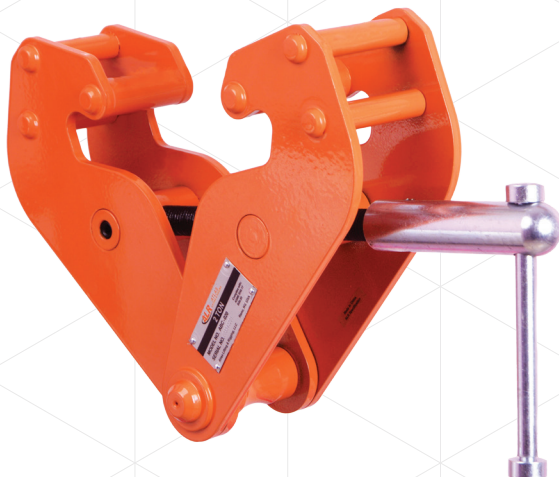

ABT BEAM TROLLEY

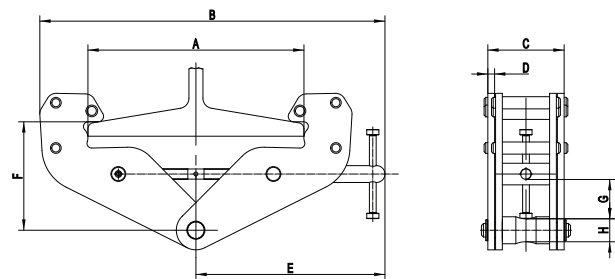

STRONGEST, SAFEST, and MOST RELIABLE hoists in the world.

Backward & Forward lever

placed in tandem providing a slim design and assuring power transfer along the center

Built-in shearing pin

prevent overload
It functions at approx. 25% overload
The pins can be replaced without removing the load

Safety pin

fastens the anchor bolt

Anchor bolt

Offers numerous and versatile connection possibilities with load hooks, sling ropes and sling chains

Spare shear pins

Two pieces of spare shear pins located in the carrying handle

Rope clamp system

Easily disengaged with a lever allowing smooth installation of the wire rope

High strength cast aluminium alloy body

Light weight
Simple to operate
Smooth contour
Design with large, flat bottom surface for increased stability in horizontal as well as vertical working position

Stamped serial number
for easy identification



GRIP PULLER

HAND HOIST SPECIFICATIONS

Product Number		AGP-008	AGP-016	AGP-032	AGP-054
Lifting Capacity (Rated Load)	(tonnes)	0.8	1.6	3.2	5.4
*Pulling Capacity	(tonnes)	1.2	2.4	4	8.1
Lever Pull at Rated Load	(N)	284	412	441	850
Forward Travel	(mm)	52	55	28	25
Wire Rope Diameter	(mm)	8.3	11	16	20
Net Weight (Body)	(kg)	6.4	12.4	23.3	58
Net Weight (20 meter Wire Rope)	(kg)	7	11.5	23.5	36
Net Weight (Lever Handle)	(kg)	1.15	2.5	2.5	3.7
Dimensions (Body) L x W x H	(mm)	440 x 70 x 255	560 x 100 x 295	675 x 120 x 350	940 x 170 x 440

Every ALR Hoist meets or exceeds OSHA and ANSI / ASME HST-3 Standards



We are committed to building the

TITON Series

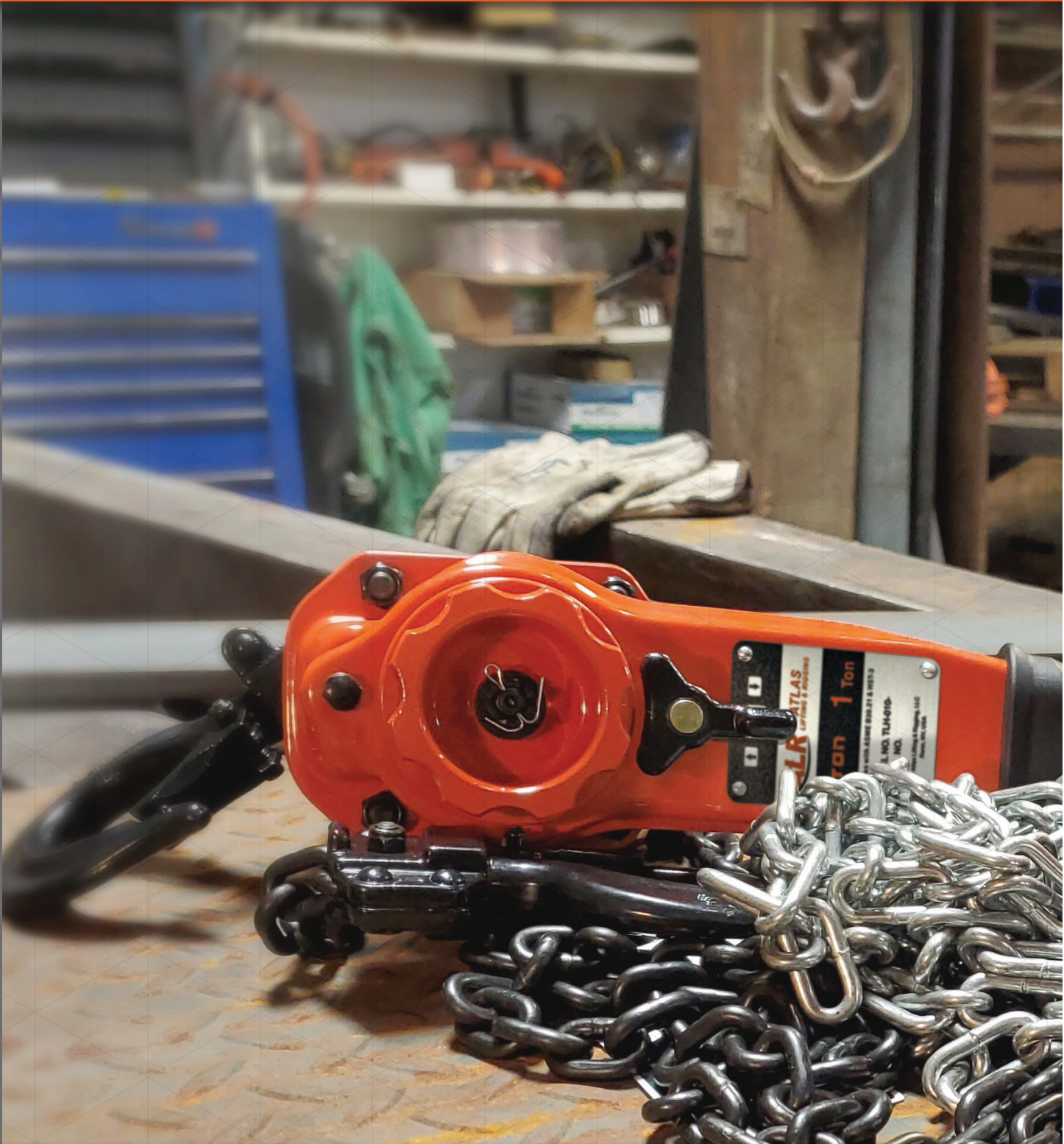

STRENGTH • SAFETY • RELIABILITY

STRONGEST, SAFEST, and MOST RELIABLE hoists in the world.



STANDARD DUTY

“We deliver it everyday”



We are committed to building the

INDUSTRY LEADING FEATURES

Zinc Flake Coating

We are one of the only manufacturers to use "Zinc Flake" coating on crucial parts. The use of this type of coating gives our hoist the ability to last in extreme environments such as in or around saltwater. In extensive Salt Spray testing, our hoists last more than 200 hours before rusting appears. Most of our competitors will only last 30 hours before rusting appears. — **RELIABILITY**

Drop Forged Pinion Shaft

Our lever hoist pinion shafts and washers are drop forged with Titanium embedded into the metal creating a single strong shaft for ultimate strength. Most manufacturers simply add a washer onto their pinion shafts. — **STRENGTH**

Caged & Sealed Roller Bearings

Caged and Sealed Roller bearings provides smooth, controlled operation of the gears and shafts. This ensures maintenance-free lubrication and increased efficiency. — **STRENGTH**

Forged Identity Markings

We are one of the only manufacturers to have our manufacturing identifying marks and production date codes, plus the hook's rated capacity, embedded on the sides of the hook during the drop forge operation. Traceability is a key component of being an ISO certified manufacturer of hoists. — **SAFETY**

Heavy Duty Cast Steel Safety Latch

This new Heavy-Duty cast-steel safety latch design bulks up the base of the latch where the torque and side load stresses are greatest, this is where ordinary stamped latches fail and will bend out of compliance. The latch also has a bolt-and-lock nut connection which simplifies changing latches in the field. — **STRENGTH — SAFETY — RELIABILITY**

Heavy Duty Chain Stop Grip

The ergonomically designed and black phosphate coated cast chain stop used in our level hoists is more comfortable to grasp than the ordinary O-Ring. The design prevents the load chain from feeding through the hoist body and has the same highly corrosion resistant and scratch resistant coating that's applied to the Load Chain. — **SAFETY**

Hook Strength Pads

Small Raised Pads - At the base and tip of each hook are permanent measuring points to check the hook's throat opening for signs of "stretching"—an indication that the hoist has been overloaded and that the hook should be replaced. — **STRENGTH**

STANDARD FEATURES

All-Steel Construction

Impact resistant all-steel construction ensures added durability and protection while providing a long and dependable service life in toughest environments. — **STRENGTH**

Premium Powder Coated Finish

Featuring a specifically designed long lasting powder coat finish for harsh environments. — **RELIABILITY**

Heavy Duty Black Oxide Chain

We manufacture and test 100% of our Grade 100 Equivalent load chain. — **STRENGTH**

Weston-Style Brake System

Weston-Style load brake system has a Chrome Plated twin ratchet pawl brake design to reduce rusting. Fusing one brake disc to each side of the paw allows the load to be divided between two disc and helps eliminates premature brake-disc failure. — **RELIABILITY**



TITON Series

STRONGEST, SAFEST, and MOST RELIABLE hoists in the world.



LEVER HOIST

Product Number	Capacity (ton)	Capacity (lbs)	Chain (ft)
TLH-008-05	3/4	1,760	5
TLH-008-10	3/4	1,760	10
TLH-008-15	3/4	1,760	15
TLH-008-20	3/4	1,760	20
TLH-010-05	1	2,200	5
TLH-010-10	1	2,200	10
TLH-010-15	1	2,200	15
TLH-010-20	1	2,200	20
TLH-016-05	1.6	3,520	5
TLH-016-10	1.6	3,520	10
TLH-016-15	1.6	3,520	15
TLH-016-20	1.6	3,520	20
TLH-032-05	3.2	7,040	5
TLH-032-10	3.2	7,040	10
TLH-032-15	3.2	7,040	15
TLH-032-20	3.2	7,040	20
TLH-063-05	6.3	13,860	5
TLH-063-10	6.3	13,860	10
TLH-063-15	6.3	13,860	15
TLH-063-20	6.3	13,860	20

Custom Chain Lengths and Shipyard Hooks Available

Every ALR Hoist meets or exceeds OSHA and ANSI / ASME HST-3 Standards



We are committed to building the

TITON Series

TITON SERIES LEVER HOIST SPECIFICATIONS & DIMENSIONS

Product Number Capacity		Ton	TLH-008 3/4	TLH-010 1	TLH-016 1.6	TLH-032 3.2	TLH-063 6.3
Number of Falls			1	1	1	1	2
Capacity		(lbs)	1,760	2,200	3,520	7,040	13,860
Capacity Test Load		(lbs)	2,640	3,300	5,280	10,560	20,790
Capacity Test Load		(ton)	1.2	1.5	2.4	4.8	9.5
Load Chain		(mm)	5.6x17	5.6x17	7.1x21	10x30	10x30
Standard Lift		(ft)	5	5	5	5	5
Height	h	(in)	11.02	11.81	13.19	15.55	21.26
Length	a	(in)	5.83	5.83	6.52	7.66	7.66
Width	b	(in)	3.46	3.46	4.21	4.45	4.45
Net Weight		(lbs)	13.67	14.11	21.16	34.17	59.52
Gross Weight		(lbs)	14.53	14.97	22.2	35.52	60.87
Pull to Rated Load		(N)	258	346	342	350	375
Dimensions	a	(mm)	148	148	165.5	194.5	194.5
	b	(mm)	88	88	107	113	113
	c	(mm)	355	355	355	433	433
	d	(mm)	98	98	107	112	112
	e	(mm)	26.5	31.5	35.5	43	53
	f	(mm)	35.5	42.5	42.5	50	60
	g	(mm)	41.5	49.4	52	61.9	84.3
	h	(mm)	280	300	335	395	540
	t	(mm)	14	15	19	24.5	34



STRONGEST, SAFEST, and MOST RELIABLE hoists in the world.

MANUAL OPERATED LEVER HOIST - TLH Series

3
YEAR*
WARRANTY

LEVER HOIST

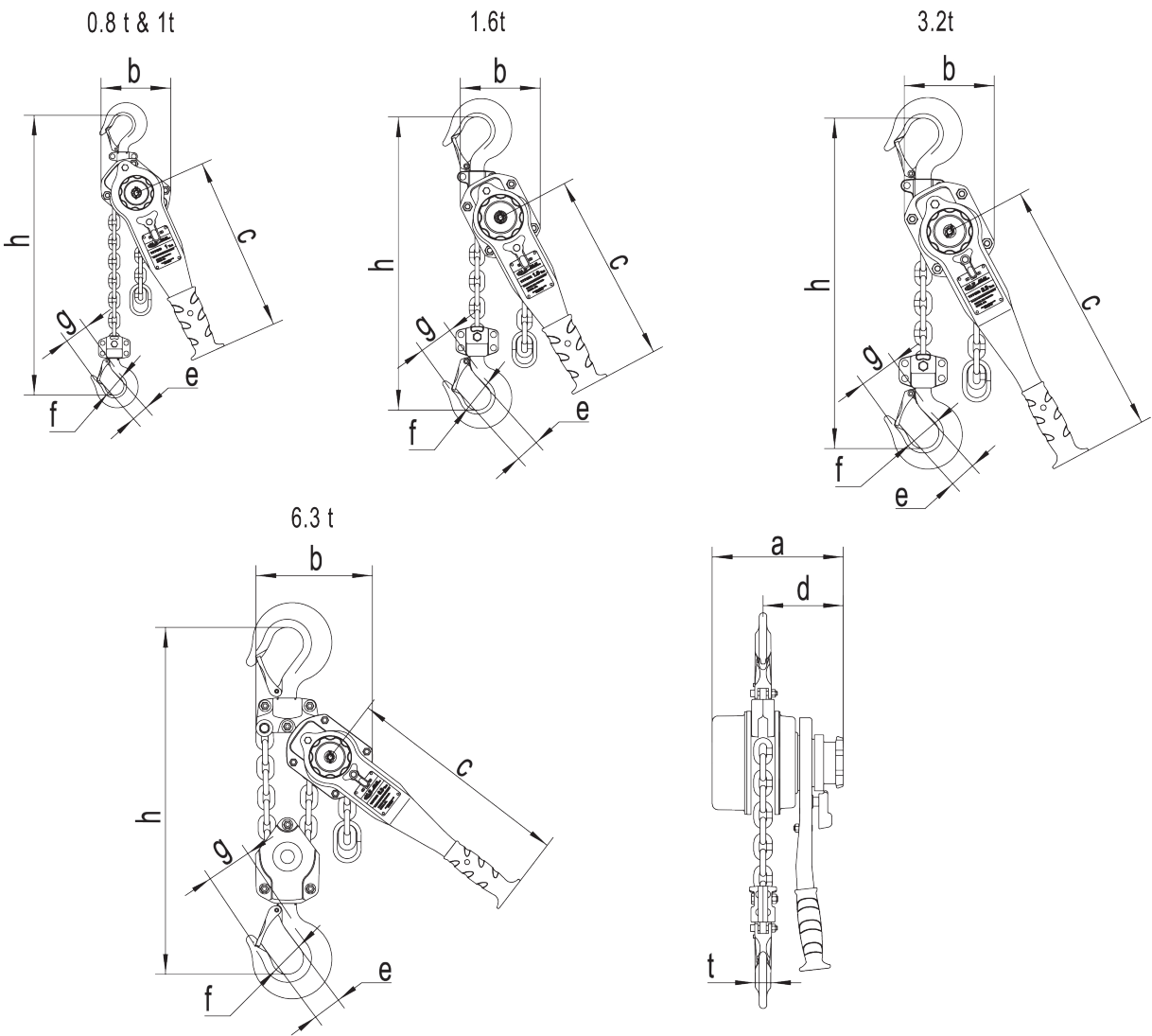



We are committed to building the

Series

TITON

All-Steel Construction

Impact resistant all-steel construction ensures added durability and protection while providing a long and dependable service life in toughest environments.

— **STRENGTH**

Premium Powder Coated Finish

Featuring a specifically designed long lasting powder coat finish for harsh environments. — **RELIABILITY**

Caged & Sealed Roller Bearings

Caged and Sealed Roller bearings provides smooth, controlled operation of the gears and shafts. This ensures maintenance-free lubrication and increased efficiency. — **STRENGTH**

Forged Identity Markings

We are one of the only manufacturers to have our manufacturing identifying marks and production date codes, plus the hook's rated capacity, embedded on the sides of the hook during the drop forge operation. Traceability is a key component of being an ISO-certified manufacturer of hoists.

— **SAFETY**

Heavy Duty Cast Steel Safety Latch

This new Heavy-Duty cast-steel safety latch design bulks up the base of the latch where the torque and side load stresses are greatest, this is where ordinary stamped latches fail and will bend out of compliance. The latch also has a bolt-and-lock nut connection which simplifies changing latches in the field.

— **STRENGTH — SAFETY — RELIABILITY**

Hook Strength Pads

Small Raised Pads - At the base and tip of each hook are permanent measuring points to check the hook's throat opening for signs of "stretching"—an indication that the hoist has been overloaded and that the hook should be replaced. — **STRENGTH**

360-Degree Hook Rotation

The 360-Degree swivel hook design allows the operator to work in confined spaces with quick and easy positioning of the hoist in any directions. — **RELIABILITY**

Weston-Style Brake System

Weston-Style load brake system has a Chrome Plated twin ratchet pawl brake design to reduce rusting. Fusing one brake disc to each side of the pawl allows the load to be divided between two disc and helps eliminates premature brake-disc failure. — **RELIABILITY**



STRONGEST, SAFEST, and MOST RELIABLE hoists in the world.



CHAIN HOIST

Product Number	Capacity (ton)	Capacity (lbs)	Chain (ft)
TCH-005-10	1/2	1,100	10
TCH-005-15	1/2	1,100	15
TCH-005-20	1/2	1,100	20
TCH-010-5	1	2,200	5
TCH-010-10	1	2,200	10
TCH-010-15	1	2,200	15
TCH-010-20	1	2,200	20
TCH-010-30	1	2,200	30
TCH-015-10	1.5	3,300	10
TCH-015-15	1.5	3,300	15
TCH-015-20	1.5	3,300	20
TCH-020-10	2	4,400	10
TCH-020-15	2	4,400	15
TCH-020-20	2	4,400	20
TCH-020-30	2	4,400	30
TCH-030-10	3	6,600	10
TCH-030-15	3	6,600	15
TCH-030-20	3	6,600	20
TCH-030-30	3	6,600	30
TCH-050-10	5	11,000	10
TCH-050-15	5	11,000	15
TCH-050-20	5	11,000	20
TCH-050-30	5	11,000	30
TCH-100-10	10	22,000	10
TCH-100-15	10	22,000	15
TCH-100-20	10	22,000	20
TCH-100-30	10	22,000	30

Every ALR Hoist meets or exceeds OSHA and ANSI / ASME HST-3 Standards



We are committed to building the

TITON Series

TITON SERIES CHAIN HOIST SPECIFICATION & DIMENSIONS

Product Number Capacity			TCH-005 0.5	TCH-010 1	TCH-015 1.5	TCH-020 2	TCH-030 3	TCH-050 5	TCH-100 10
No. of Falls			1	1	1	1	2	2	4
Capacity		(lbs)	1,100	2,200	3,300	4,400	6,600	11,000	22,000
Capacity Test Load		(lbs)	1,650	3,300	4,950	6,600	9,900	16,500	33,000
Capacity Test Load		(ton)	0.75	1.5	2.25	3	4.5	7.5	15
Load Chain		(mm)	5x15	6x18	8x24	8x24	8x24	10x30	10x30
Standard Lift		(ft)	10	10	10	10	10	10	10
Hand Chain		(mm)	5x25x17						
Height	h	(in)	11.02	12.05	14.49	17.51	20.47	23.62	29.92
Length	a	(in)	4.92	5.28	5.49	6.18	6.18	7.09	7.09
Width	b	(in)	5.12	6.1	6.81	7.28	9.25	10.32	14.37
Net Weight		(lbs)	17.2	24.69	34.83	37.04	53.35	87.74	197.75
Gross Weight		(lbs)	18.08	25.57	34.48	37.7	54.45	88.63	215.39
Pull to Rated Load		(N)	219	254	351	405	366	385	426
Dimensions	a	(mm)	125	134	151	157	157	180	180
	b	(mm)	130	155	173	185	235	262	365
	c	(mm)	43	51	64	64	100	126	260
	d	(mm)	25	30	34	34	56	74	107
	e	(mm)	28.8	31.5	35.5	38.5	43	53	64
	f	(mm)	34.6	42.5	42.5	44.5	49.5	60	85
	g	(mm)	41.7	49.4	52	55	61.9	84.3	90
	h	(mm)	280	306	368	445	520	600	760

STRONGEST, SAFEST, and MOST RELIABLE hoists in the world.

TCH SERIES CHAIN HOIST

3
YEAR*
WARRANTY

CHAIN HOIST

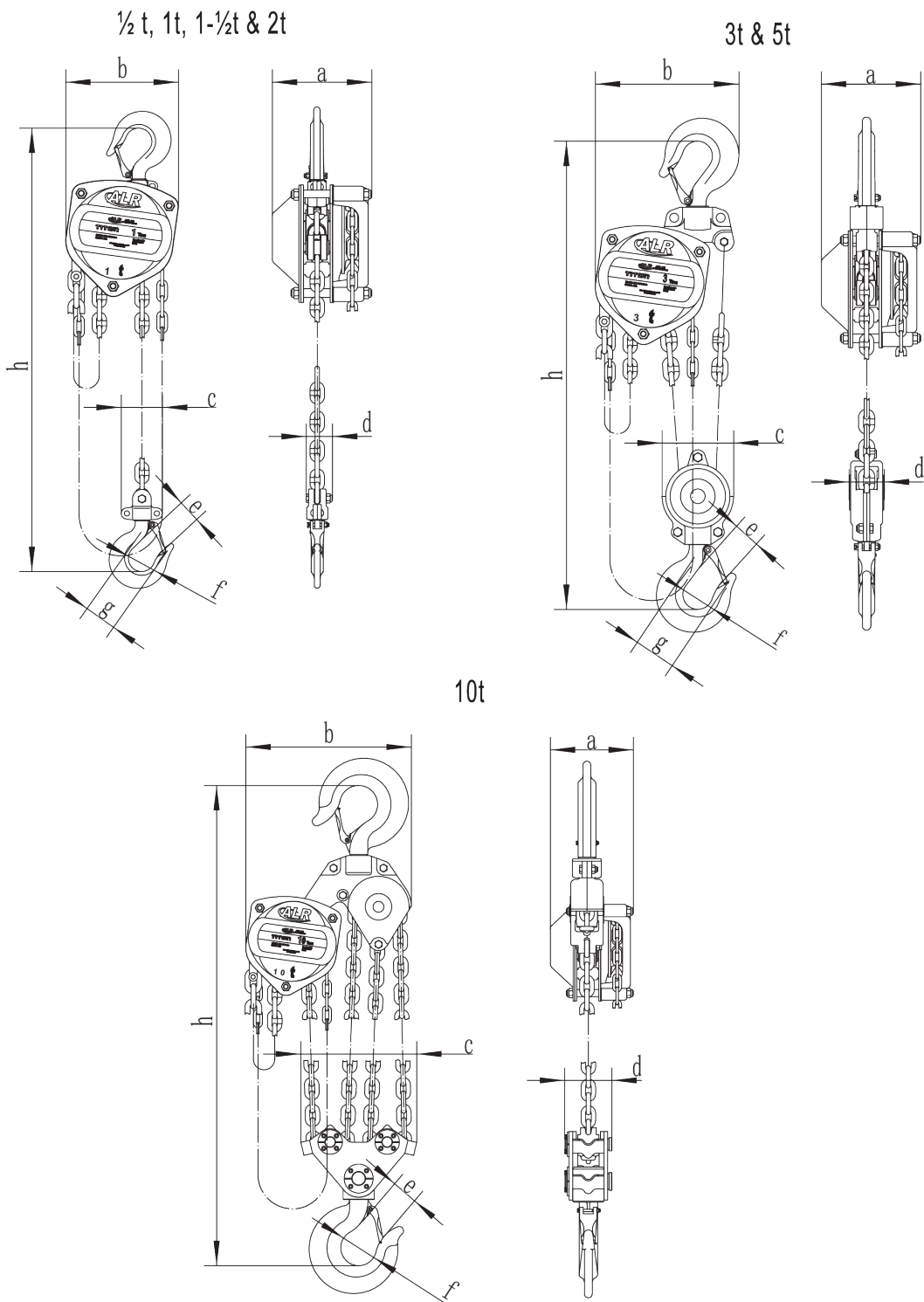

Every ALR Hoist meets or exceeds OSHA and ANSI / ASME HST-3 Standards



We are committed to building the

Powerful Performance In A Hard Working Design

The Titon Series Electric Chain Hoists are easy to operate, service, require minimal maintenance, and offer excellent headroom for every lifting application.

Standard overload device protects the hoist, operator, and surrounding structure from damaging overloads.

The Titon Series of Electric Hoists are:

Strong

- Electromagnetic brake holds a load even if power is interrupted
- Upper and lower limit switches prevent over-travel
- Built-in chain bag keeps chain out of the way during operation
- Ventilated heavy-duty motor shuts down to prevent overheating

Safe

- Handheld remote control with emergency stop switch can be controlled up to 20 feet away.
- Can be easily attached to most trolleys or beam clamps.
- Heat-treated, drop-forged hooks swivel 360° for easy rigging.

Reliable

- Quick-connect wiring connects power with pushbutton controls for smooth operation.
- Permanently lubricated gear train delivers a long life with low maintenance.
- Offered in single phase and three phase units.
- Integrated slip clutch ensures continuous duty and tension control and protects transmission from overload
- Gear trains are permanently lubricated for long life and minimal maintenance



US and EU Standards ASME HST-1, ASME B30.16, EN14492-2, EN60204-32
2 Year Warranty, Service and Parts Available in Stock in the USA

TITON Series

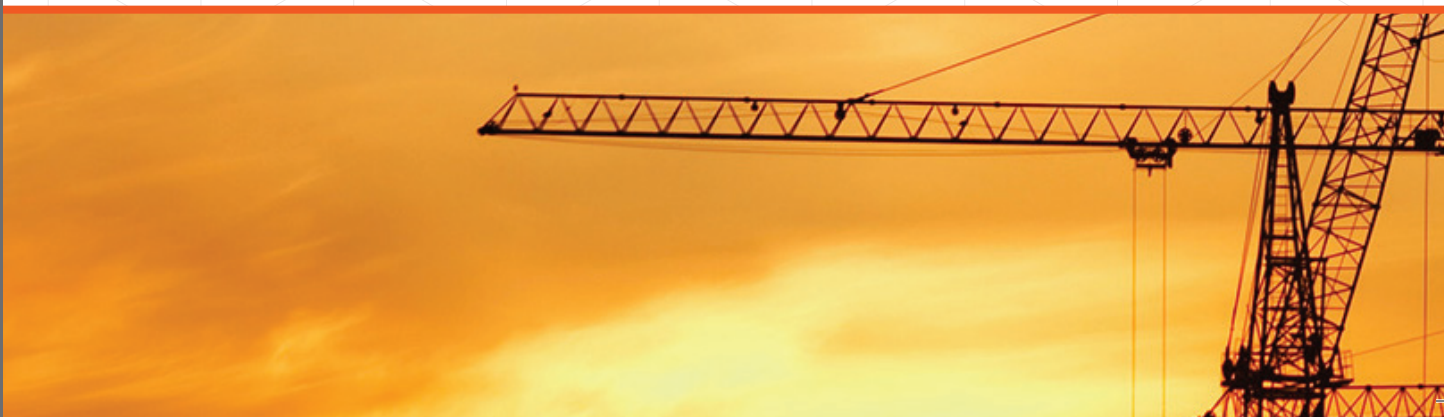

STRONGEST, SAFEST, and MOST RELIABLE hoists in the world.



Product Number	Capacity (ton)	Capacity (lbs)	Phase	Chain Falls	Chain (ft)
TEH-1-005-10	1/2	1,100	1	1	10
TEH-1-005-15	1/2	1,100	1	1	15
TEH-1-005-20	1/2	1,100	1	1	20
TEH-1-005-30	1/2	1,100	1	1	30
TEH-3-005-10	1/2	1,100	3	1	10
TEH-3-005-15	1/2	1,100	3	1	15
TEH-3-005-20	1/2	1,100	3	1	20
TEH-3-005-30	1/2	1,100	3	1	30
TEH-1-010-10	1	2,200	1	1	10
TEH-1-010-15	1	2,200	1	1	15
TEH-1-010-20	1	2,200	1	1	20
TEH-1-010-30	1	2,200	1	1	30
TEH-3-010-10	1	2,200	3	1	10
TEH-3-010-15	1	2,200	3	1	15
TEH-3-010-20	1	2,200	3	1	20
TEH-3-010-30	1	2,200	3	1	30
TEH-1-020-10	2	4,400	1	2	10
TEH-1-020-15	2	4,400	1	2	15
TEH-1-020-20	2	4,400	1	2	20
TEH-1-020-30	2	4,400	1	2	30
TEH-3-020-10	2	4,400	3	1	10
TEH-3-020-15	2	4,400	3	1	15
TEH-3-020-20	2	4,400	3	1	20
TEH-3-020-30	2	4,400	3	1	30

ELECTRIC HOIST





We are committed to building the

TITON Series

TITON ELECTRIC CHAIN HOIST SPECIFICATION & DIMENSIONS (1-Phase Dual Voltage)

Product Number		TEH-1-005	TEH-1-010	TEH-1-020
Capacity	(ton)	0.5	1	2
No. of Falls		1	1	2
Capacity	(lbs)	1,100	2,200	4,400
Capacity Test Load	(lbs)	1,375	2,750	5,500
Capacity Test Load	(ton)	0.625	1.25	2.5
Lifting Speed	ft/min	23	19.7	9.8
Motor Power	hp	1.61		
Power Supply		1-Phase 115v/230v 60Hz		
Duty Class		M4		
Control Voltage	v	24		
Insulation Class		F		
Duty Rating		30%		
Load Chain	(mm)	Ø7.1 x 21		
Standard Lift	(ft)	20	20	20
Cable Length	(ft)	8.2		
Height	h (in)	16.1	16.1	16.1
Length	a (in)	22	22	22
Width	b (in)	18.9	18.9	18.9
Net Weight	(lbs)	121.3	121.3	136.7
Gross Weight	(lbs)	125.7	125.7	141.1
Extra weight per foot of extra lift	(lbs)	0.74	0.74	1.48
Minimum headroom Hmin	H (mm)	520	550	630
Dimensions	A (mm)	245	245	245
	B (mm)	245	245	245
	C (mm)	158	158	124
	D (mm)	142	142	176
	E (mm)	350	350	350
	F (mm)	600	600	610

TITON ELECTRIC CHAIN HOIST SPECIFICATION & DIMENSIONS (3-Phase)

Product Number		TEH-3-005-D	TEH-3-010-D	TEH-3-020
Capacity	(ton)	0.5	1	2
No. of Falls		1	1	1
Capacity	(lbs)	1,100	2,200	4,400
Capacity Test Load	(lbs)	1,375	2,750	5,500
Capacity Test Load	(ton)	0.625	1.25	2.5
Lifting Speed	ft/min	23/7.5	19.7/6.6	26.2
Motor Power	hp	1.07/0.36	1.61/0.54	4
Power Supply		3-Phase 240v-480v 60Hz		
Duty Class		M4		
Control Voltage	v	24		
Insulation Class		F		
Duty Rating		30%		
Load Chain	(mm)	Ø7.1 x 21		Ø9 x 27
Standard Lift	(ft)	20	20	20
Cable Length	(ft)	8.2		
Height	h (in)	16.1	16.1	18.5
Length	a (in)	22	22	24.8
Width	b (in)	18.9	18.9	23.6
Net Weight	(lbs)	121.3	121.3	198.4
Gross Weight	(lbs)	125.7	125.7	231.5
Extra weight per foot of extra lift	(lbs)	0.74	0.74	1.21
Minimum headroom Hmin	H (mm)	520	550	630
Dimensions	A (mm)	245	245	265
	B (mm)	245	245	265
	C (mm)	158	158	127
	D (mm)	142	142	205
	E (mm)	350	350	393
	F (mm)	600	600	738

STRONGEST, SAFEST, and MOST RELIABLE hoists in the world.

ELECTRIC HOIST

3

YEAR*

WARRANTY

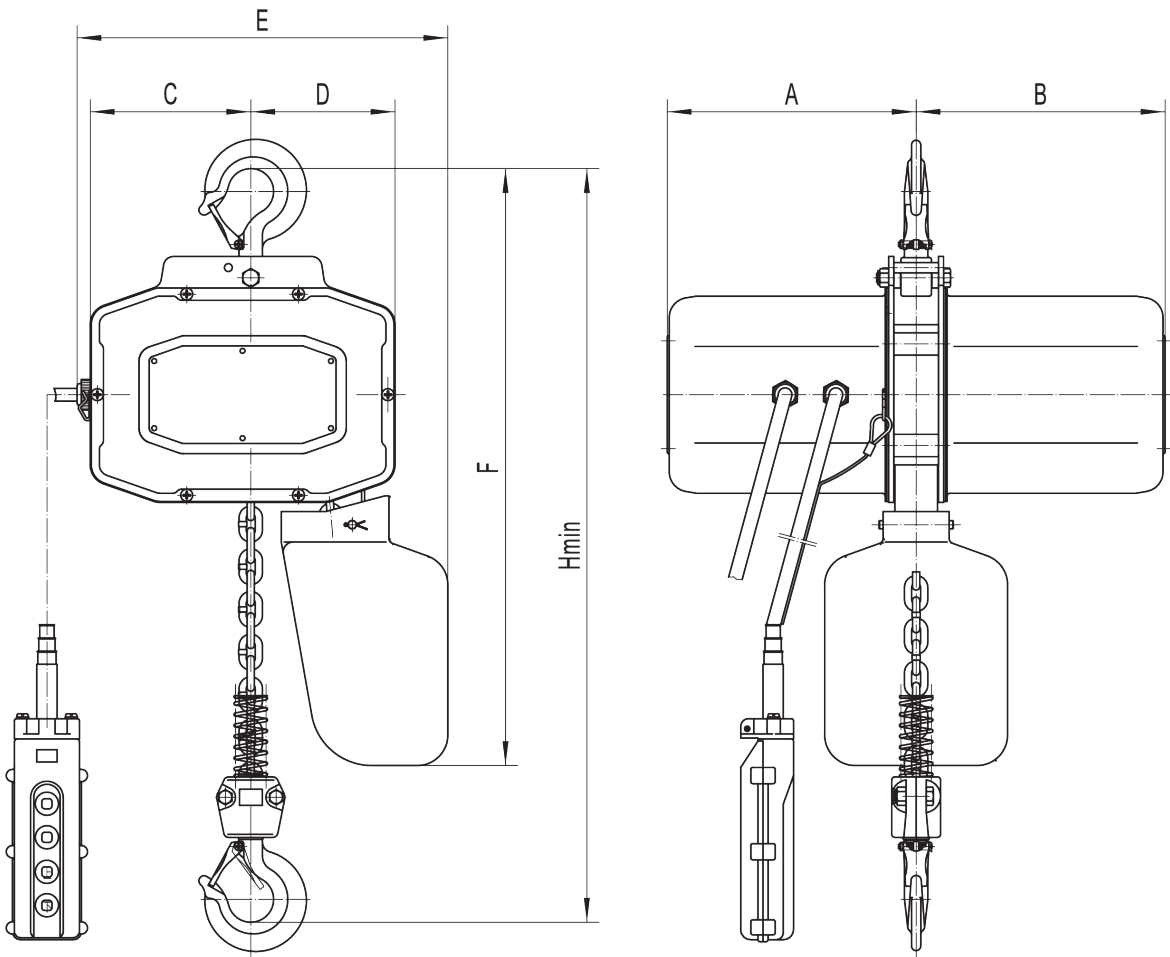

ELECTRIC HOIST

Every ALR Hoist meets or exceeds OSHA and ANSI / ASME HST-3 Standards



We are committed to building the



WARRANTY

WARRANTY INFORMATION AND TECHNICAL SERVICE

All products sold by Atlas Rigging & Lifting, LLC. are warranted to be free of defects in material and workmanship from date of shipment by Atlas Rigging & Lifting, LLC. If one of our products needs repair of service, please contact Technical Service at 1-833-ALR-LIFT, 8AM to 5PM Anywhere in the US, Monday through Friday.

Warranty Period and Coverage

- **ALR products have a 3 YEAR WARRANTY**, the products carry a standard limited warranty of 2 years and if the product is registered through our website (www.alrlift.com), ALR will add an additional 1 year to the warranty period.
- **Accessories carry a limited warranty of one year from the date of receipt.**
- **This warranty covers only the initial purchaser of the product from the date of delivery.**
- **This warranty covers any defects in workmanship or materials subject to the limitations stated below.**
- **This warranty does not cover failures due directly or indirectly to misuse, abuse, negligence or accidents, normal wear-and-tear, improper repair, alterations or lack of maintenance.**

See your owner's manual or visit our website for detailed information on the warranty of your ALR product. Every ALR lever hoist is tested and meets or exceeds OSHA and ANSI / ASME HST - 3 standards. Test certificate verifies that every hoist has been factory load tested to 150% of rated capacity.

Warranty Center

Atlas Lifting & Rigging
1-833-ALR-LIFT
1-833-257-5438
www.ALRLift.com

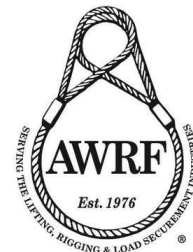

STRONGEST, SAFEST, and MOST RELIABLE hoists in the world.

NOTES

STRENGTH • SAFETY • RELIABILITY

“We deliver it everyday”



**ATLAS
LIFTING & RIGGING**

**1-833-ALR-LIFT
1-833-257-5438
www.ALRLift.com**