

TOCL Road Committee

Road Prioritization Tool & Project Recommendations

Initial Release 7/13/23

TOCL Road Policy: Overall Development Approach

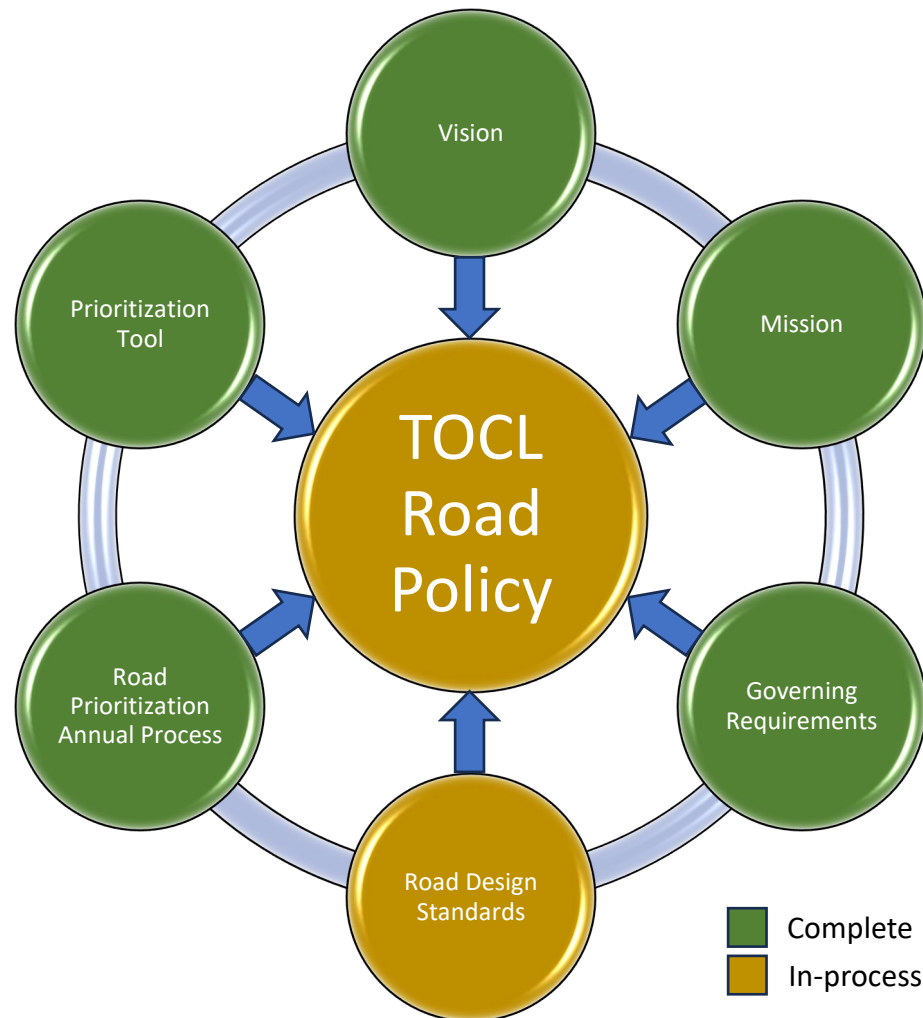

Status as of 7/13/23

- ✓ Road Vision Statement: Overarching objectives for our roads
- ✓ Road Mission Statement: Roadmap to achieve the vision's objectives
- ✓ Road Governing Requirements: Detailed features, specifications, and constraints that a road engineer must consider when creating a design
 - Road Design Standards: Specifications for determining compliance to the Governing Requirements
- ✓ Road Prioritization Annual Process: Series of actions taken annually to achieve the road objectives
- ✓ Road Prioritization Tool: Analytic model used to determine the order of road projects based on a common set of criteria
- TOCL Road Policy: A framework of guidelines used to achieve the objectives outlined in the road vision & mission statements

Road Prioritization Tool

Analytic model used to determine the order of road projects based on a common set of criteria

- All 47 Road segments evaluated by common set of criteria & rating scale
- Model results verified by two visual observations
 - Drainage following rain event on 5/7/23
 - Comparison between model segment priorities & actual road conditions on 6/01/23
- Initial release completed on 7/13/23
- Short length segments combined with adjacent longer length segments for construction efficiency
- Yearly projects limited by total length ensuring affordability within current tax levy

Ref #	Designation
1	West Clear Lake Drive-6
2	West Clear Lake Drive-5
3	West Clear Lake Drive-4
4	West Clear Lake Drive-3
5	West Clear Lake Drive-1
6	West Clear Lake Drive-2
7	Penner Drive-1
8	Penner Drive-2
9	John Court
10	Joann Court
11	Penny Court
12	Powhattan Court
13	Lakeview Drive-1
14	Lakeview Drive-2
15	Lakeview Drive-3
16	Prospect Street
17	Maple Street
18	East Clear Lake Drive-7
19	East Clear Lake Drive-6
20	East Clear Lake Drive-5
21	East Clear Lake Drive-4
22	Point Park Drive
23	East Clear Lake Drive-3
24	East Clear Lake Drive-2
25	East Clear Lake Drive-1
26	Outer Drive
27	Lakeside Court
28	Terrace Drive
29	Chapel Drive
30	Buck Point Drive
31	South Clear Lake Drive-5
32	South Clear Lake Drive-4
33	South Clear Lake Drive-3
34	South Clear Lake Drive-2
35	South Clear Lake Drive-1
36	Fountain Beach Drive
37	Paradise Point
38	Elm Street
39	South Clear Lake Drive-9
40	South Clear Lake Drive-8
41	Geowets Drive
42	South Clear Lake Drive-7
43	South Clear Lake Drive-6
44	Clear Lake Cove
45	Quiet Harbor Drive
46	Rieke Drive
47	Sand Point Road

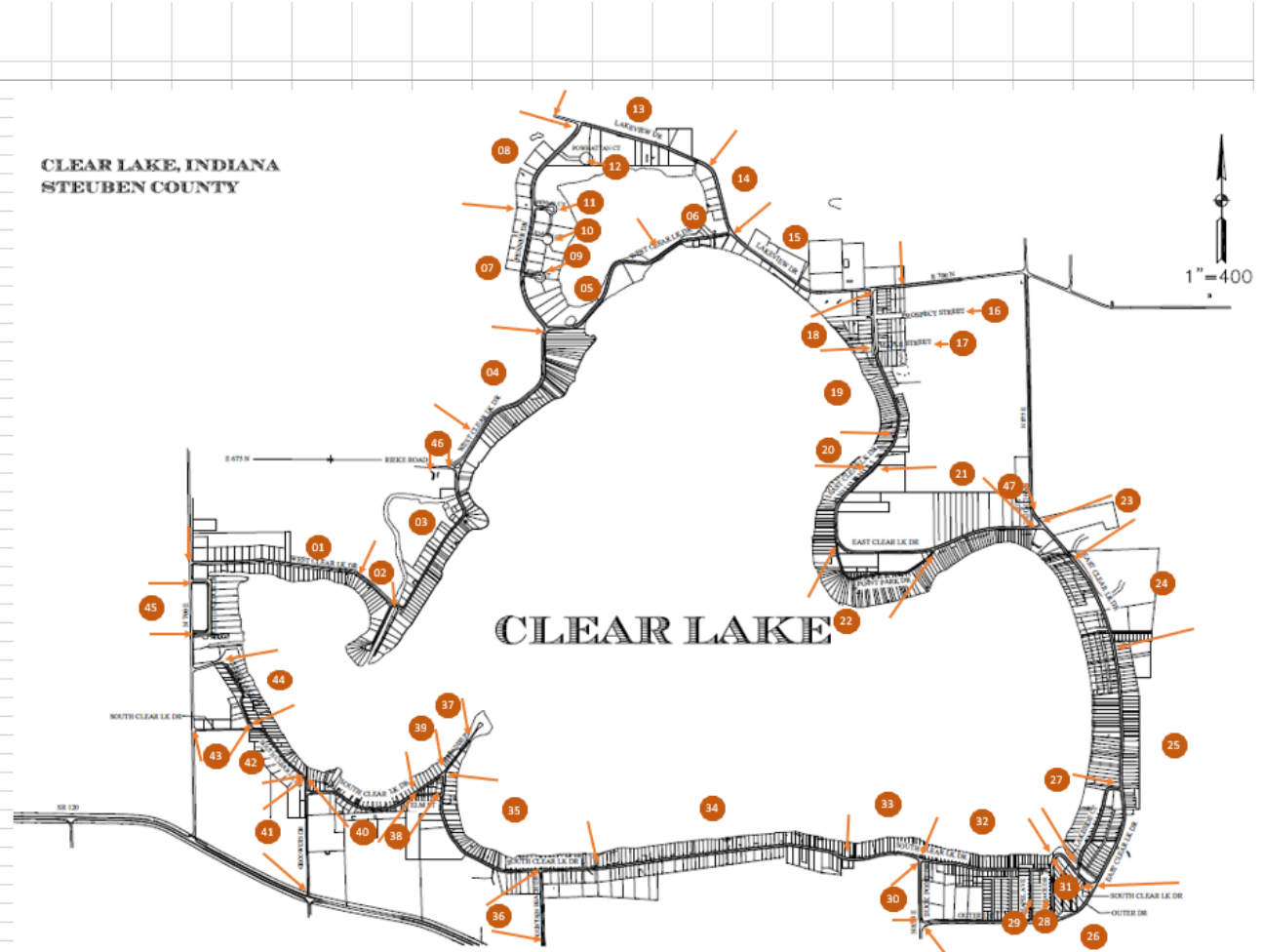

Road Prioritization Tool Criteria & Rating Scale

- Prioritization Criteria
 - Current year PASER
 - PASER 5-yr Trend
 - Unique Considerations (safety risk, deficiency, or issue)
- Weighted importance assigned to each prioritization criteria
 - Current Year PASER – most important
 - Unique Consideration – moderate importance
 - PASER 5-yr trend – least important
- Rating Scale (1-5) used to establish grade within each Prioritization Criteria
- Score for each prioritization criteria is added together for a grand total score
- Grand total scores for each road segment establish the segments priority largest score is highest priority
- Traffic volume (radar metrics) is used as the tie breaker between segments with the same grand total score

Road Segment Description	Prioritization Criteria	Rating (1-5)	Weighting Factor	Sub Total	Grand Total	# of Vehicles	Rating Criteria (1-5)				
							1	2	3	4	5
Buck Point Drive	"YEAR" PASER Score	2	5	10	16	1	9 - 8	7-6	5 - 4	3	<3
	PASER Score 5-yr Trend	3	1	3			<1 per 5 years	1 per 5 years	2 per 5 years	3 per 5 years	>3 per 5 years
	Unique Consideration	1	3	3			No Concern, Cosmetic, or Slight Risk to Residents	Minor Risk to Residents	Moderate Risk to Residents	Moderate Deficiency/Issue	Severe Deficiency/Issue

Example: Buck Point Drive (Ref. ID #30)

5-Yr Recommendations for Planning Purposes

- 2023: QH (45), WCLD (1,2 & 6)
- 2024: Lakeview (13,14,15)
- 2025: WCLD (3) & Sand Point (47)
- 2026: ECLD (25)
- 2027: ECLD (24) & (19) & SCLD (34)



1-Yr Recommendation for 2024 Budgeting & CCMG Application

2024: Lakeview (Ref. #
13,14,15)
Current PASER Rating –
3 (Poor)

**CLEAR LAKE, INDIANA
STEBEN COUNTY**



CCMG Year/ *Recom mended	Ref #	Priority	# of Vehicles	Designation	Roadway	From	To	Length In Miles
2024*	13	27	5	Lakeview Drive-1	Lakeview Drive	Town Limits	132 Lakeview Drive	0.325
2024*	14	26	5	Lakeview Drive-2	Lakeview Drive	132 Lakeview Drive	West Clear Lake Drive	0.167
2024*	15	26	5	Lakeview Drive-3	Lakeview Drive	West Clear Lake Drive	Town Limits	0.463

Designation	2022 PASER Rating	2021 PASER Rating	2018 PASER Rating	2017 PASER Rating
Lakeview Drive-1	3	3	6	4
Lakeview Drive-2	3	3	5	6
Lakeview Drive-3	3	3	5	5