

BEYBLADE X

バイブレードエックス

What is Beyblade?

Three! Two! One! Go Shoot! Bladers launch their tops (or 'beys') into the stadium and you win by outlasting your opponent or knocking them out of the arena.

You've probably heard of beyblade. If you grew up in the early 2000s, you might've played with Dragoon and Dranzer, In the early 2010s Pegasus and L-Drago from Metal Fusion. Or more recently Valkyrie and Spriggan from Burst.



Today we're in the fourth generation of beyblade, Beyblade X! The new gimmick of this generation is the Xtreme line, a line of gears that circle the stadium, which the beys lock on to and accelerate to insane speeds. X is the ultimate fusion of all generations that came before!

Beyblade Parts (BX & UX)



A BX & UX bey is made of three parts, the blade, the ratchet, and the bit. The blade is the metal top of the bey. It will have a name like 'Dran Sword'. Jagged blades will hit hard, while rounder blades will deflect hits and spin for longer.

The ratchet is the middle of the bey, it will have a name like '3-60'. Where 3 refers to the number of corners it has, and 60 refers to its height. This part can affect burst resistance and balance.

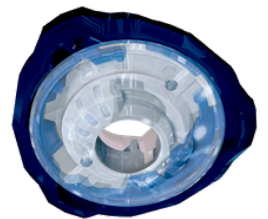

The bit is the bottom of the bey, it will have a name like F, which stands for Flat. This will affect how the bey moves around the stadium.

What's new on the CX System?

The main difference between Beyblade X's BX, UX, and CX lines is the design and customization of their blades, which affects their performance characteristics.

Beyblade CX tops feature a construction system that reimagines and expands upon the “Blade” component. Blades in the Custom Line are split into three parts: **the Lock Chip, Main Blade, and Assist Blade.**



This builds upon the existing construction system for Beyblade X introduced in the Basic Line (BX) and Unique Line (UX) while deepening customization possibilities.

Feature 	BX (Basic Line)	UX (Unique Line)	CX (Custom Line)
Target User	Beginners	Competitive players	Advanced strategists
Packaging	Blue band	Orange band	Purple band
Design	Reliable and well-balanced	Unique designs, often with more weight on the outside	Modular blades with assist blades for strategic customization
Customization	Limited customization	Limited customization	High customization with 5-part modular system (Lock Chip, Main Blade, Assist Blade, Ratchet, Bit)

How to play Beyblade X?

The basics are simple; you and your opponent launch your beys into the stadium and whoever spins longer or knocks their opponent out is the winner. However, a match of beyblade takes place over multiple battles, where you need to get 4 points to win. Depending on how you win a battle, you get different amounts of points:



- If your opponent's bey stops spinning it is a Spin Finish, worth **1 point**.
- If your opponent's bey comes apart, it is a Burst Finish, worth **2 points**.
- If your opponent's bey is knocked into the over zone it is an Over Finish, worth **2 points**.
- If your opponent's bey is knocked into the Xtreme zone, it is an Xtreme Finish, worth **3 points**.

3G Battle (3on3)

3G battle (3on3) is the most popular way to play competitive Beyblade, and is what we use at most of our tournaments.

In a 3G Tournament, you construct a deck of 3 beys with no repeating parts between them (e.g, you can't use 2 Dran Swords). You then put them in order from first to third, and battle with them in that order. If no one has won after 3 battles, you re-order your beys and start again.

Strategy

There are three main strategies in beyblade:

Knock out your opponent A.K.A. **Attack** - Move fast, hit hard. This strategy can get you some big points, especially if you get an xtreme finish, but you'll lose stamina quickly, or worse you might end up flying out of the stadium yourself.

Don't get knocked out A.K.A. **Defense** - Heavy and round beys, avoid or deflect hits. If you can survive the onslaught of a bey on the attack and outlast it, you've got the win.

Just keep spinning A.K.A. **Stamina** - Outer weight distribution and Life After Death are the names of the game here. LAD (Life After Death is the term used to describe a bey's ability to keep spinning at low speeds, mainly relying on wide bits.

Some combination A.K.A. **Balance** - Often the most effective strategies combine two of the above, defense and stamina almost always go together, but attack stamina combos are also very strong.

To execute these strategies you have two main tools:

Building combos - Find a combination of parts that complement each other for your strategy. A flat fast bit with a heavy hitter blade will help you knock out your opponent. A heavy blade with a slowly moving round bit will help you avoid hits while outspinning your opponent.

Launch technique - You can have the best combo and still lose if you don't know how to use it. Power, angle and position all play a role in how your launch will play out in battle. A flat launch might give you more attack power, but it may also lead to you launching into the pockets. Practice is the best way to hone your skills.

Join in the fun!

You can find beyblade events in Indonesia by going to our website:
www.beyjaxel.com

BJX weekly gathering is every Thursday night, mostly at Blok M, South Jakarta, Indonesia.

There are many events around Jakarta right now! Beyblade is exploding in popularity at the moment so keep an eye out for events near you (who knows? Maybe you'll be the one to start a community where you live).

Where can I buy Beyblades?

You can get beyblades from any toy store in malls i.e Toys Kingdom, Kidz Station, Toys City. They're also available on Tokopedia/Shopee. However, to get the full range of beys, you've got to ship them from overseas (Japan/Singapore).



もう、遊びじゃない。

GEAR  **SPORTS**

BEYBLADE X
ベィブレードエックス