

ishtika

HOMES



*Vyasa*  
Blissful Living

2 & 3 BHK Premium Apartments @ Cantonment, Bellary

[www.ishtikahomes.com](http://www.ishtikahomes.com)

About

# Ishtika Homes

Ishtika is a Sanskrit word for Ittige (brick).

We create user centric spaces through contemporary architecture and by adopting eco-friendly practices using the natural materials from mother earth to create sustainable livelihoods.

The philosophy of Ishtika Homes' is reflected in every aspect of work – Attention to detail, Use of the best materials and User centric architecture.

About

# Vyasa

Vyasa is a residential project located in the heart of Bellary city. At Vyasa, everything is well within reach. The home buyers can enjoy a balance between luxury and convenience. Vyasa is a project where nature and modern infrastructure are beautifully balanced.

You get the best of both Worlds. On one hand, you are just a stone's throw away from the Govt. offices, schools, hospitals and entertainment centers. On the other, you will be living closer to parks and lush greenery despite being present in the middle of the developed part of Bellary.



*Vyasa*  
Blissful Living



## Salient Features

-  No Common Walls
-  100% Vaasthu Compliant
-  Generous spatial floor plan
-  Natural Sunlight & Cross Air Ventilation
-  Broad & Wider Balconies
-  Prime Residential Area
-  Finest Architectural Design
-  Round-the-clock Security CCTV Surveillance
-  Generator Power Backup

## Amenities

-  Gymnasium
-  Party Hall
-  Landscape Garden
-  Indoor Games



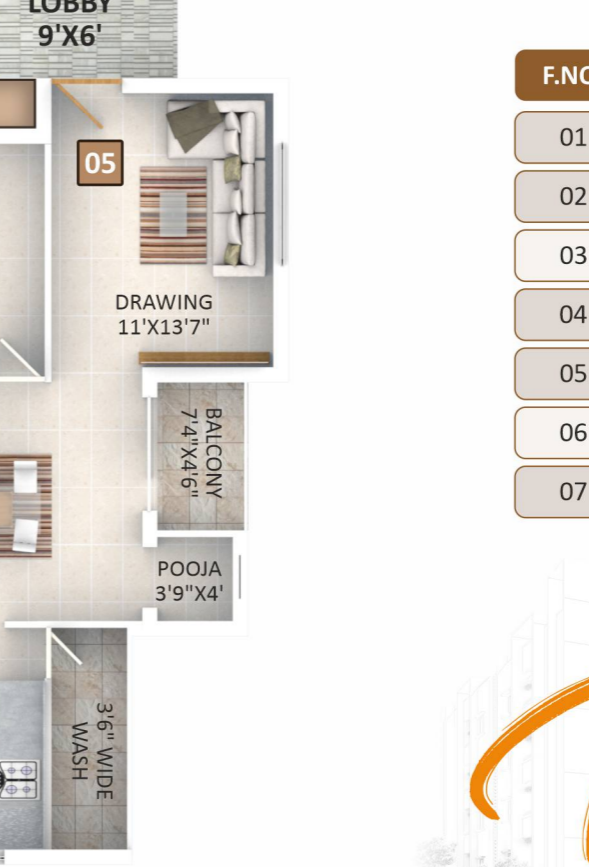
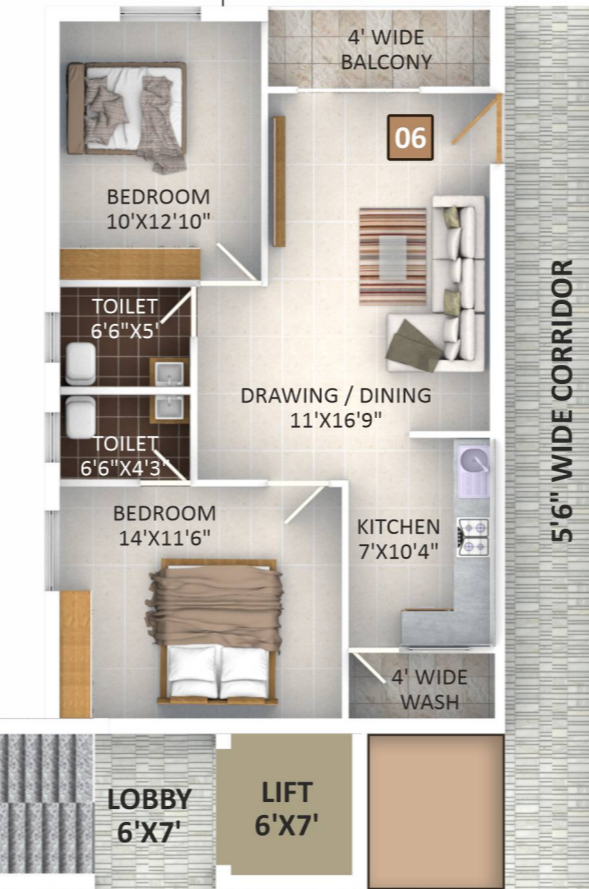

Typical Floor Plan  
Area Statement in SFT.

F.NO.	AREA	TYPE	FACING
01	1568	EAST	3 BHK
02	1589	EAST	3 BHK
03	1010	WEST	2 BHK
04	1513	NORTH	3 BHK
05	1545	NORTH	3 BHK
06	1030	EAST	2 BHK
07	1531	WEST	3 BHK



# Vyasa

Blissful Living



# Specifications

## STRUCTURE:

RCC framed structure.

## FLOORING:

Superior quality vitrified tiles for kitchen, dining, living area, bedrooms and foyer. Anti-skid ceramic / vitrified tiles for toilets, utility & balcony.

## PAINTING

All internal walls with premium emulsion paint. Exterior with premium paint.

## WINDOWS

UPVC sliding windows with mosquito mesh.

## ELECTRICAL & COMMUNICATION:

Fire resistant PVC insulated copper wires Havells / Salzer / VGuard or equivalent switches.

## LIFTS:

Lift of adequate capacity

## DOORS:

Main door: Teak wood frame. Hardwood shutter with teak veneer finish, hardware of reputed make.

Internal door: Hard wood door frame. Hard wood shutter

## KITCHEN:

Polished granite kitchen platform, stainless steel sink. Provision for water purifier. 2 feet wall dado of premium tiles above the kitchen platform.

## PLUMBING & SANITARY:

Hindware / Cera or equivalent sanitary fittings.  
Hindware / Cera or equivalent bath fittings

## SECURITY

CCTV surveillance.

## POWER BACKUP

Generator for lift, common areas  
0.5kva to each flat.



# Experience Blissful Living

## Our Recently Completed Projects - Bengaluru



Agastya @ Tumkur Road



Advaita @ Yeshwanthpur



White Pearl @ Mysore Road

### Office Address

Ishtika Homes Pvt Ltd.  
#937, 3rd Floor, S.N. Arcade, 21st Main, 9th Cross,  
J.P.Nagar 2nd Phase, Bengaluru - 560 078.

### Site Address

Plot No. 13, Opposite St.Philomena's School,  
HLC Colony Road, Contonment, Bellary- 583 104.

### Call for more details

+ 91 96867 69606

E: bellary@ishtikahomes.com

W: www.ishtikahomes.com

### Architect & Engineers



**S'n'S Associates**  
ARCHITECT & ENGINEERS

H.O: Vidya Nagar, Hyderabad. Ph: +91 98480 16269

B.O Jubilee Hills, Hyderabad. Ph: +91 98480 16269

B.O: Horamavu, Bengaluru. Ph: +91 73535 59202

E-mail: info@snsassociates.co.in

ishtika  
HOMES

RERA NO