



# R.DC HOUSES

Address: Queensland Acacia Ridge QLD 4110  
Monday-Friday 8:30am-4:30pm Saturday 9am-2pm  
PH: +610434429709  
Call for appointment to discuss & plan for your new House

# CONTENTS



## 01 COMPANY PROFILE



## 02 QUALIFICATION DOCUMENTS



## 03 EXPANDABLE CONTAINER HOUSE



## 04 PRODUCTION WORKSHOP AND EQUIPMENT



## 05 FLAT PACKING CONTAINER HOUSE



## 06 FOLDING CONTAINER HOUSE



# 01 COMPANY PROFILE

With the dual capabilities of "design /construction" and "project operation", the company provides comprehensive creative design and construction services for urban construction, tourism and vacation industry, creative business services, private customization and other fields. Committed to the new integrated housing and supporting products R & D, design, production, processing, sales, transportation, installation and construction, after-sales service and a series of complete supporting services, with 8 years of R & D production experience, and has import and export rights.

Most of the materials used in the products have passed CECNAS, BV, iso9001 and other certifications. Pre-sales design consulting services, technical guidance services, after-sales tracking services have won the trust of customers. The company has a complete new modular residential R & D system, technical system, manufacturing system and operation and maintenance system.

Product parts have been highly integrated, highly integrated modular, with sealing insulation, advanced fire prevention, installation efficiency, structural stability, energy saving

and emission reduction, long service cycle, resistance to harsh environmental climate and other characteristics.

"Accurate, reliable, professional" is our company's production spirit and service concept. Gradually establish the company's good brand. Established and improved the after-sales service system, to provide guidance and help for a large number of customers encountered difficulties and problems.



02

# QUALIFICATION DOCUMENTS





# 03 EXPANDABLE CONTAINER HOUSE

Container modular house and prefab houses that can be used as a granny flat, spare room, rental investment, first home, downsizing, deluxe mining camp accommodation, crib room, training room, office and accommodation for caravan & holiday parks, bed and breakfasts and more!

It looks like a home, not a container, and they are strong and durable. Plug them into your mains or install solar with an eco-septic system and go completely off grid. Taking them down is a reverse process of installing and they fold down to the size of a container. Our plans can be modified and additions made to suit individual requirements. Move them with a tilt tray, they can be relocatable or permanent.

## Advantage

- Fast installation: 4 hours/set, save labor cost;
- Anti-rust: all material use hot galvanized steel;
- Waterproof: without wood ceiling, wall;
- Fireproof: Fire rating A grade;
- Simple foundation: just need 12 pcs concrete block foundation;
- Wind-resistant (11 level) and anti-seismic (9 grade).





## Product Custom Size

<b>720 wide External standard size</b>	5900mm*4830mm*2530mm	<b>Folded standard size</b>	5900mm*720mm*2530mm	<b>Weight</b>	1800KG
<b>20FT External standard size</b>	5900mm*6420mm*2530mm	<b>Folded standard size</b>	5900mm*2250mm*2530mm	<b>Weight</b>	3800KG
<b>30FT External standard size</b>	9000mm*6420mm*2530mm	<b>Folded standard size</b>	9000mm*2250mm*2530mm	<b>Weight</b>	5600KG
<b>40FT External standard size</b>	11800mm*6420mm*2510mm	<b>Folded standard size</b>	11800mm*2250mm*2510mm	<b>Weight</b>	7200KG
<b>2.4m height within 20 feet External standard size</b>	5900mm*6420mm*2560mm	<b>Folded standard size</b>	5900mm*2250mm*2560mm	<b>Weight</b>	3500KG
<b>usage</b>	Houses, offices, dormitories, shops, bars, emergency rooms, disaster rooms, etc.				
<b>Advantage</b>	1. Large space, large-sized windows and doors. 20 feet and 40 feet are available, and can also be customized according to your needs				
	2. Installation is simple and quick. 4 hours/set, saving labor costs				
	3. Prefabricated water, electricity and bathroom accessories				
	4. Integrated design of waterproof wall panels				
<b>Main material</b>	Galvanized steel structure with sandwich panel walls and doors, windows, etc.				
<b>Service life</b>	30-40 years				
<b>color</b>	White, charcoal or as per customer request.				
<b>steel structure</b>	3mm hot-dip galvanized steel structure with 4 corner castings and 18mm fiber cement panels; 1.8mm PVC flooring; 50mm Rock Wall, EPS or polyurethane				
	sandwich panels; Galvanized steel base plate.				
<b>roof</b>	3-4mm hot-dip galvanized steel structure with 4 corner castings and 50mm-70mm EPS or PU sandwich panels; galvanized steel roof covering.				
<b>List</b>	3mm hot-dip galvanized steel structure				
<b>wall</b>	50/75/100mm EPS/Rock wall/PU sandwich panel				
<b>Door</b>	Made of steel/aluminum frame, broken bridge aluminum. Size w 1930mm*2100mm glass double glazing, thickness 5/8/5mm.				
	Can be customized according to needs.				
<b>window</b>	Made of PVC/aluminium, broken bridge aluminum. Dimensions w1125mm*h1100mm, double-glazed glass, thickness 5/8/5mm.				
	Size W800*H1100mm, double-glazed glass, thickness 5/8/5mm.				
<b>Connection kit</b>	PVC connection kit for floors, ceilings, walls.				
<b>electricity</b>	3C/CE/CL/SAA standard, with distribution box, lights, switches, sockets, etc.				
<b>Optional accessories</b>	Air conditioners, offices, dormitories, toilets, kitchens, bathrooms, showers, steel roofs, accommodation appliances, decorative panels, decorative materials, furniture, sanitation, kitchens, etc.				



## Model for choose

- Color pattern, roof, wooden platform, solar power supply system, etc. can be customized on demand;
- The size of the house can be customized according to customer needs, and the height can be increased to 3000mm;



## Exterior Decoration Optional

- There can be a roof;
- There can be a decking;
- There can be a stairs;
- The wall can be decorated by the metal sheet claddingb.



## Layout Diagram Of 20ft Expandable House

- One living room
- one bedrooms+one toilet+open kitchen and living room
- two bedrooms+one toilet+open kitchen and Living room
- two bedrooms+one toilet+open kitchen and living room
- three bedrooms+one toilet+open kitchen and living room
- four bedrooms+one toilet
- Any other layouts you want to make

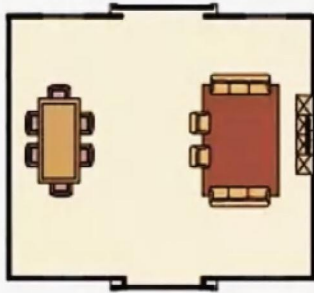

One Living room



One Living room  
One Bedroom  
One Restroom



One Living room  
One Bedroom  
One Restroom



One Living room  
Two Bedroom  
One Restroom



One Living room  
Two Bedroom  
One Restroom



One Living room  
Three Bedroom  
One Restroom



Four Bedroom  
One Restroom

## 20ft Expandable Container



## 40ft Expandable Container

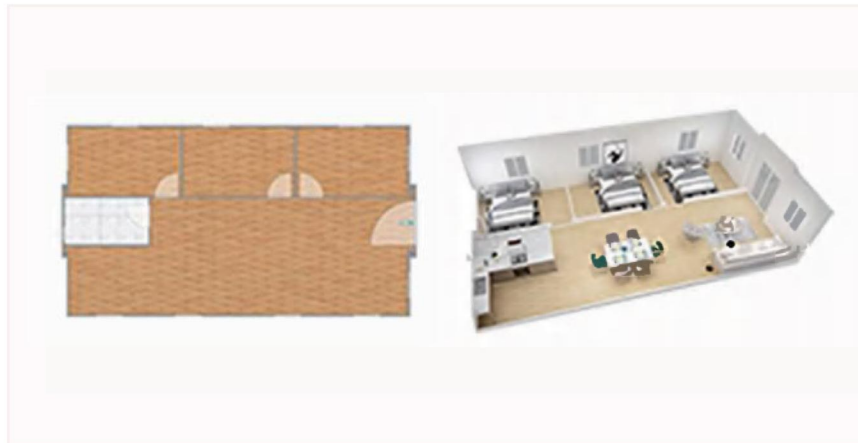

# Main Frame Materials



Entry Door



Steel Frame



Bracing Piece



Window



Corner Fitting



Floor



Galvanized Square Steel

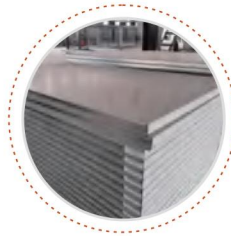

High-end Cleaning Board



## Floor

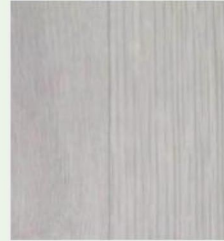

## Power



## Kitchen



Bathroom



Framework





## ENGINEERING CASES















# 04

# PRODUCTION WORKSHOP AND EQUIPMENT





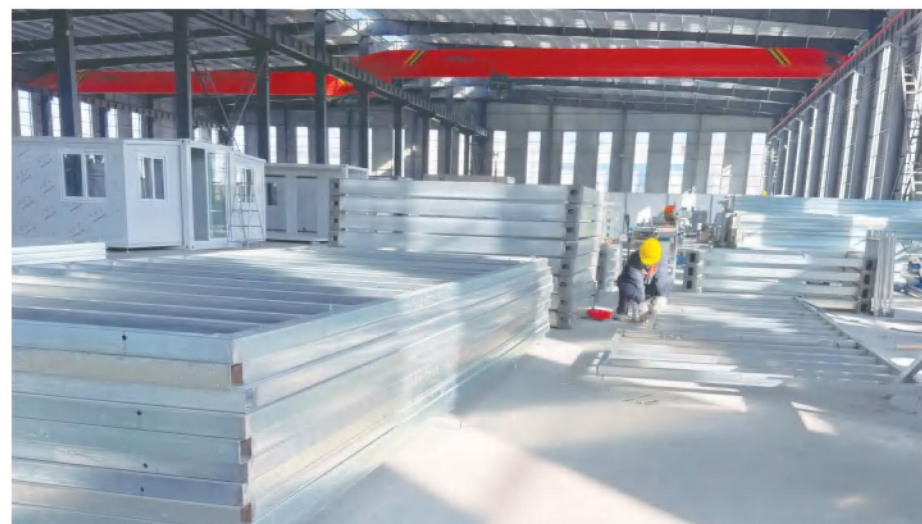









# 05

## FLAT PACKING CONTAINER HOUSE

The Flat Pack Container House is composed of top frame components, bottom frame components, corner columns and several interchangeable wallboards. Modular design concept and production technology are adopted to modularize a box house into standard parts, which can be assembled or hoisted on site at the site. The product takes the box as the basic unit, the box structure adopts special cold-formed galvanized steel components, the enclosure and thermal insulation materials are all made of non combustible materials, and the plumbing, electrical, decoration and supporting functions are all prefabricated in the project without secondary construction. Now you can move in after assembly or overall hoisting. It can be used alone, or spacious use space and lamination can be formed through different combinations of horizontal and vertical directions.





The packed box house has simple and safe structure and low requirements for foundation. It has the characteristics of fast installation, convenient movement and relocation, many turnover times and long service life. The modified products are disassembled without loss and construction waste. It can be used as a large space for office, accommodation, restaurant, bathroom, entertainment and combination, and can meet the requirements of construction engineering camp, municipal temporary house, field operation camp The demand for emergency resettlement houses, schools, hospitals, tourist stations and various commercial houses.



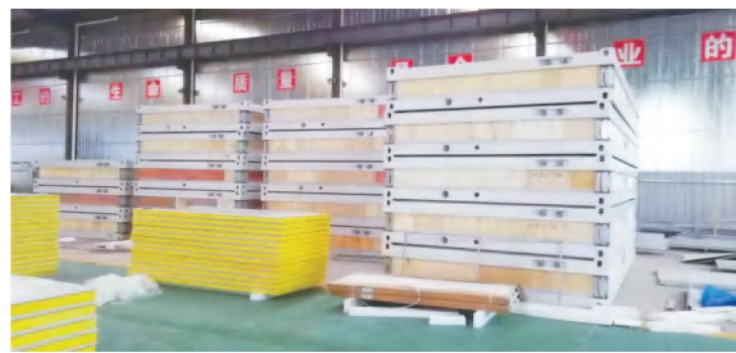



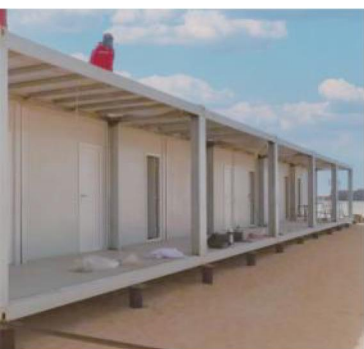



Product Custom Size

Standard house	size	5800mm*2400mm*2896mm		
index	Insulation	0.043W/m·K	Wind resistance	0.50kN/m <sup>2</sup>
	sound insulation	≥30dB	Fire performance	A级
	waterproof	2级	Seismic performance	8级
	Ground live load	2.0kN/m <sup>2</sup>	Roof live load	0.5kN/m <sup>2</sup>
Main structure	main section bar	The thickness of galvanized ground frame beam is 3.0mm; The thickness of galvanized roof frame beam is 3.0mm; The thickness of galvanized column is 3.0mm; Zinc content: 80g.		
	Structural	M12*40 high strength bolt		
	Spraying process	Galvanized process, polyester finish		
Wall panel	Glass wool core material	The thickness of color steel composite plate is 75mm, the thickness of color steel plate is 0.45, PE coating, white color, orange peel pattern on the outer plate and flat inner plate: No side steel strip S-shaped socket, no cold bridge for splicing; Glass wool unit weight 70kg/m <sup>3</sup> The combustion performance is class a non combustible.		
Roof system	Roof waterproof	Roof tile: color steel veneer bite thickness 0.5mm, 360°bite		
	Insulation layer	Glass wool roll feK, thickness 100mm, unit weight 14kg/m <sup>3</sup> The combustion performance is class a non combustible. (double layer layout)		
	Damp proof course	PE resin film		
	Decorative layer	Yx28-277-831 strip ceiling board, 0.5mm, white gray		
Ground system	Bottom panel	910 type white corrugated board, 0.3mm thick		
	Thermal insulation material	Glass wool roll felt thickness 100mm, volume weight 14kg/m <sup>3</sup> , The combustion performance is class a non combustible		
	Damp proof course	PE resin film		
	Structural plate	Cement fiber board, 18mm thick		
	Ground treatment	PVC environment-friendly plastic floor, 2.0mm thick, blue		
door	Entrance doors	Steel door, size ≥ w845*h2035, stainless steel door lock		
window	Outer window	Size: w1120*H1100 (two sides)		
decorate	Interior decorative	Color steel profiled corner piece, thickness 0.5mm, color Xinyu white		
electrical system	3C/CE/CL / SAA Standard,with distribution box, lights, switch, sockets, etc.			
Optional facilities	Outdoor single running stairs	4650*1100mm, checkered steel plate anti-skid step, square tube steel railing		
	Outdoor walkway board	2990*1050mm, steel cantilever beam, checkered steel plate, anti-skid walkway plate, square tube steel railing		
	Outdoor canopy	2990*1180mm, steel cantilever beam, 50mm color steel composite plate canopy panel		
	Indoor corridor box	Size 5800*1800*2896mm		

## ENGINEERING CASES



# 06

## FOLDING CONTAINER HOUSE

### **Stretch freely and pull into shape**

The folding house adopts the way that the base and the lower end of each wall are connected by hinges, so that it can be retracted and put freely.

### **Repeated folding is not easy to deform**

It is constructed with galvanized steel, and the overall design is designed according to the architectural weighing.

### **Good material and stable structure**

The structure is stable and adopts galvanized steel plate, which is composed of structural beam, corner piece, side beam and bottom joist, with strong resistance.





