



PERMIT TO CONSTRUCT Onsite Wastewater System

File Nbr: **2020120183**
County: **Spartanburg**

Name: PALMETTO LEADERSHIP INSTITUTE

Program Code: 360

Type Facility: MOBILE SHIPPING OFFI

Address: 2435 FAIRFOREST CLEVEDALE RD
SPARTANBURG, SC 29336

System Code: 100

Subdivision:

Site: 2040 S CHURCH STREET EXT
SPARTANBURG, SC

TM No.: 7-16-14-010.04

Block: Lot:

Water Supply: PUBLIC

PERMIT TO CONSTRUCT SYSTEM SPECIFICATIONS

Daily Flow (gpd): 120

Tank Sizes (gal): Septic Tank: 1000

Pump Chamber:

Grease Trap:

LTAR: .30

Trenches: Length (ft): 134 Width (in): 36 Max. Depth (in): 48

Agg. Depth (in): 14

Min Pump Capacity:

gpm at ft. of head Alternative Product:

SPECIAL INSTRUCTIONS/CONDITIONS

THIS PERMIT IS SITE SPECIFIC. ANY CHANGES TO THE SYSTEM MUST BE APPROVED BY DHEC. ALTERNATIVE TRENCH PRODUCTS APPROVED UNDER STATE RULES AND REGULATIONS MAY BE SUBSTITUTED. ANY UNAPPROVED CHANGES WILL VOID THIS PERMIT.

Installers must contact the local Environmental Affairs office by 10:00 AM on the day prior to installation in order to schedule a time for the final inspection. If a Department representative does not arrive within 30 minutes of the scheduled time, the installer may conduct the final inspection.

When a contractor self-inspection occurs, the installer must complete the DHEC form 3978, Approval to Operate Contractor Self-Inspection.

The installer must submit DHEC form 3978 within 2 business days of the completion of the installation.

THIS SYSTEM IS DESIGNED TO SERVE AN OFFICE WITH 2 OCCUPANTS BUILT WITHOUT A BASEMENT. MAINTAIN A 15' OFFSET TO CUT BANK.

INSTALL LINES UNDER 22" OF FILL MATERIAL. FOLLOW NATURAL CONTOUR WHEN INSTALLING DRAINLINES. DO NOT PARK OR DRIVE ON SYSTEM. DRAINFIELD SHOWN INCLUDES 50% REPAIR LINES. NO GRADING CUTS >2' WITHIN 15' DOWNSLOPE OF SYSTEM OR ITS REPAIR AREA. NO GRADING IN DRAINFIELD AREA.

PERMIT TO CONSTRUCT SYSTEM DIAGRAM

(NTS)

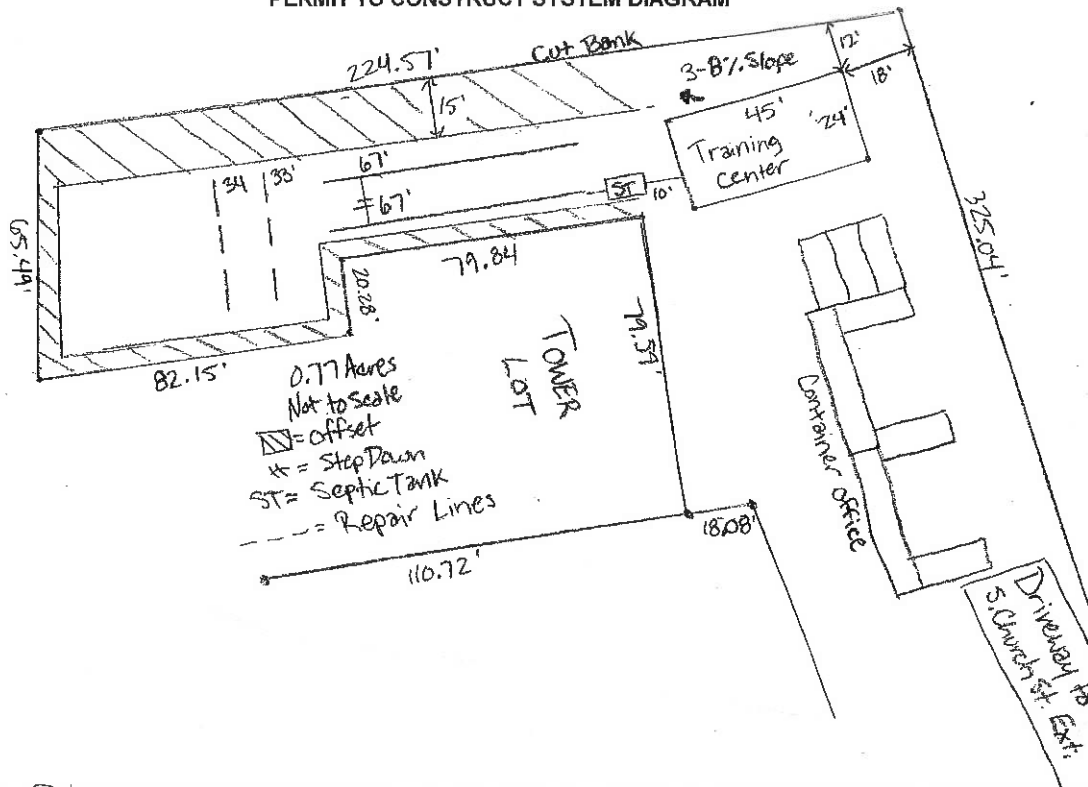

Issued/Revised By: *[Signature]* Lucy DeLeon

Date: 1/14/2021

This Permit is Appealable Under the Administrative Procedures Act.
This permit will expire and become null and void five (5) years from the issuance date.
There may be an Additional Fee for Changes in this Permit that Require a Site Reevaluation.