

# LEGACY REAL ESTATE HARBOR POINT SIDE B (DAN)

Quote #: 7PU8TZ2

A Proposal for Window and Door Products prepared for:

**Shipping Address:**

LS BUILDING PRODUCTS-SPRINGFIELD  
3441 LUMBER LN  
SPRINGFIELD, IL 62707-8847



KEITH CONDON  
LS BUILDING PRODUCTS-SPRINGFIELD  
300 PINECREST DR  
EAST PEORIA, IL 61611-4853  
Phone: (217) 965-4019  
Fax: (217) 965-5767  
Email: [kcondon@ls-usa.com](mailto:kcondon@ls-usa.com)

This report was generated on 8/30/2024 10:56:49 AM using the Marvin Order Management System, version 0004.11.00 (Current). Price in USD. Unit availability and price are subject to change. Dealer terms and conditions may apply.

Featuring products from:





15	SIDE B - LIVING ROOM	Essential	Entered as CN 3068 Essential Assembly RO 72" X 96"	2,954.85	1	2,954.85
16	SIDE B - LIVING ROOM	Essential	Entered as Size by Units Essential Assembly RO 72" X 96"	2,954.85	1	2,954.85
17	B-Mull Kit Line 15 LIVING	Essential	Entered as Size by Units Parts: 11850699 WINDOW MRF MULL KIT, EBONY/STONE WHITE, 96"	182.60	1	182.60
18	SIDE B - FOYER	Essential	Essential Assembly RO 90" X 48"	1,524.92	1	1,524.92
19	SIDE B - BEDROOM 3	Essential	Entered as Size by Units Essential Assembly RO 30" X 96"	1,316.21	1	1,316.21
20	SIDE B - BEDROOM 2	Essential	Entered as Size by Units Essential Assembly RO 72" X 36"	1,195.39	1	1,195.39
21	SIDE B - BEDROOM 2	Essential	Entered as Size by Units Essential Assembly RO 72" X 36"	1,195.39	1	1,195.39
22	B-Mull Kit Line 20 BED2	Essential	Entered as Size by Units Parts: 11842030 WINDOW ESSENTIAL MULL KIT CN30,EBONY/STONE WHITE	52.95	1	52.95

## LINE ITEM QUOTES

The following is a schedule of the windows and doors for this project. For additional unit details, please see Line Item Quotes. Additional charges, tax or Terms and Conditions may apply. Detail pricing is per unit.

Line #1	Mark Unit: SIDE B - BASEMENT-FAMILY	Net Price:		1,975.12
Qty: 1		Ext. Net Price:	USD	1,975.12

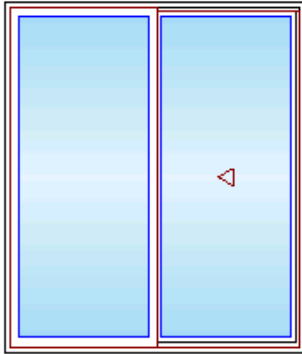

As Viewed From The Exterior

Entered As: CN  
 CN 60610  
 FS 71 1/2" X 81 1/2"  
 RO 72" X 82"  
**Egress Information**  
 Width: 30 1/16" Height: 77 17/64"  
 Net Clear Opening: 16.14 SqFt

Ebony Exterior  
 Stone White Interior  
 Essential Sliding Patio Door OX  
 CN 60610  
 Rough Opening 72" X 82"  
 Left Panel  
 IG - 1 Lite  
 Tempered Low E3 w/Argon  
 Stainless Perimeter Bar  
 Right Panel  
 IG - 1 Lite  
 Tempered Low E3 w/Argon  
 Stainless Perimeter Bar  
 Cambridge Handle Matte Black Keyed Exterior Handle set  
 Cambridge Handle Matte Black Interior Handle set  
 Keyed  
 Keyed Alike - Keyed Alike Group 1  
 Ebony Sliding Screen  
 Bright View Mesh  
 \*\*\*Screen/Combo Ship Loose  
 Bronze Ultrex Sill / Black Weather Strip  
 6 9/16" Jamb  
 Jamb Extension from 3 3/8" to 6 9/16"  
 Nailing Fin  
**\*\*\*Note: Unit Availability and Price is Subject to Change**

Initials required  
 Seller: \_\_\_\_\_  
 Buyer: \_\_\_\_\_

Line #2	Mark Unit: SIDE B - BASEMENT-FAMILY	Net Price:		1,451.97
Qty: 1		Ext. Net Price:	USD	1,451.97

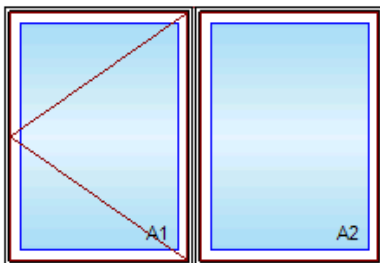

As Viewed From The Exterior

Entered As: Size by Units  
 FS 71 1/2" X 47 1/2"  
 RO 72" X 48"  
**Egress Information A1**  
 Width: 26 43/64" Height: 42 5/16"  
 Net Clear Opening: 7.84 SqFt  
**Egress Information A2**

Ebony Exterior  
 Stone White Interior  
 2W1H - Rectangle Assembly  
 Assembly Rough Opening  
 72" X 48"  
 Unit: A1  
 Essential Casement - Left Hand  
 CN 3040  
 Rough Opening 36" X 48"  
 Residential Rated  
 IG - 1 Lite  
 Low E3 w/Argon  
 Black Perimeter Bar  
 White Folding Handle  
 Interior Aluminum Screen  
 Bright View Mesh  
 Stone White Surround  
 Unit: A2  
 Essential Casement - Stationary  
 CN 3040

No Egress Information available.

Rough Opening 36" X 48"  
 Residential Rated  
 IG - 1 Lite  
 Low E3 w/Argon  
 Black Perimeter Bar  
 Vertical Standard 1/2"  
 6 9/16" Jamb  
 Jamb Extension from 2" to 6 9/16"  
 Nailing Fin with 6" Structural Brackets  
 \*\*\*Note: Mull Certified to AAMA 450 and rated to LC-25  
**\*\*\*Note: Unit Availability and Price is Subject to Change**

Initials required

Seller: \_\_\_\_\_

Buyer: \_\_\_\_\_

Line #3	Mark Unit: SIDE B - BASEMENT-FAMILY	Net Price:		1,451.97
Qty: 1		Ext. Net Price:	USD	1,451.97

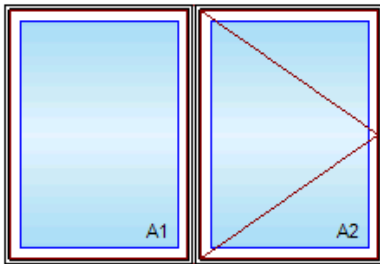

As Viewed From The Exterior

**Entered As:** Size by Units

**FS** 71 1/2" X 47 1/2"

**RO** 72" X 48"

**Egress Information A1**

No Egress Information available.

**Egress Information A2**

Width: 26 43/64" Height: 42 5/16"

Net Clear Opening: 7.84 SqFt

Ebony Exterior  
 Stone White Interior  
 2W1H - Rectangle Assembly  
 Assembly Rough Opening  
 72" X 48"

Unit: A1  
 Essential Casement - Stationary  
 CN 3040  
 Rough Opening 36" X 48"  
 Residential Rated  
 IG - 1 Lite  
 Low E3 w/Argon  
 Black Perimeter Bar

Unit: A2  
 Essential Casement - Right Hand  
 CN 3040  
 Rough Opening 36" X 48"  
 Residential Rated  
 IG - 1 Lite  
 Low E3 w/Argon  
 Black Perimeter Bar  
 White Folding Handle  
 Interior Aluminum Screen  
 Bright View Mesh  
 Stone White Surround  
 Vertical Standard 1/2"  
 6 9/16" Jamb  
 Jamb Extension from 2" to 6 9/16"  
 Nailing Fin with 6" Structural Brackets  
 \*\*\*Note: Mull Certified to AAMA 450 and rated to LC-25  
**\*\*\*Note: Unit Availability and Price is Subject to Change**

Initials required

Seller: \_\_\_\_\_

Buyer: \_\_\_\_\_

Line #4	Mark Unit: B - Mull Kit Line 2-BSMT FAM	Net Price:		52.95
Qty: 1		Ext. Net Price:	USD	52.95

## Marvin Parts

11842060 WINDOW ESSENTIAL 6-0 MULL KIT,EBONY/STONE WHITE

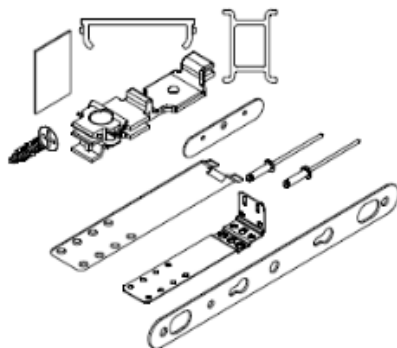

Initials required

Seller: \_\_\_\_\_

Buyer: \_\_\_\_\_

Line #5 Qty: 1	Mark Unit: SIDE B - BASEMENT FAMILY	Net Price:		2,434.20
		Ext. Net Price:	USD	2,434.20

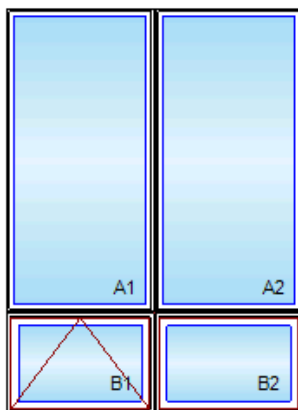

As Viewed From The Exterior

**Entered As:** Size by Units

**FS** 71 1/2" X 95 1/2"

**RO** 72" X 96"

**Egress Information A1, A2, B1, B2**

No Egress Information available.

Ebony Exterior  
 Stone White Interior  
 Window Frame  
 2W2H - Rectangle Assembly  
 Assembly Rough Opening  
 72" X 96"

Unit: A1  
 Essential Direct Glaze Rectangle  
 Basic Frame 35 1/2" X 71 1/2"  
 Rough Opening 36" X 72"  
 IG - 1 Lite  
 Low E3 w/Argon  
 Black Perimeter Bar

Unit: A2  
 Essential Direct Glaze Rectangle  
 Basic Frame 35 1/2" X 71 1/2"  
 Rough Opening 36" X 72"  
 IG - 1 Lite  
 Low E3 w/Argon  
 Black Perimeter Bar

Unit: B1  
 Essential Awning - Roto Operating  
 CN 3020  
 Rough Opening 36" X 24"  
 IG - 1 Lite  
 Low E3 w/Argon  
 Black Perimeter Bar  
 White Folding Handle  
 Interior Aluminum Screen  
 Bright View Mesh  
 Stone White Surround

Unit: B2  
 Essential Awning - Stationary  
 CN 3020  
 Rough Opening 36" X 24"  
 IG - 1 Lite  
 Low E3 w/Argon  
 Black Perimeter Bar  
 Horizontal Standard 1/2"  
 Vertical Standard 1/2"  
 4 9/16" Jamb  
 Jamb Extension from 2" to 4 9/16"  
 Nailing Fin with 4" Structural Brackets

**\*\*\*Note: Unit Availability and Price is Subject to Change**

Initials required

Seller: \_\_\_\_\_

Buyer: \_\_\_\_\_

Line #6	Mark Unit: SIDE B - BASEMENT FAMILY	Net Price:		2,434.20
Qty: 1		Ext. Net Price:	USD	2,434.20

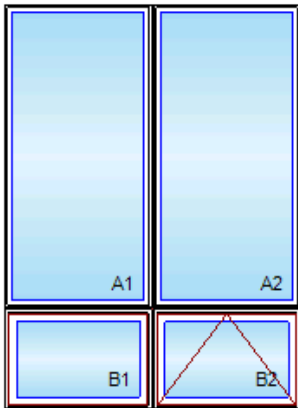

As Viewed From The Exterior

**Entered As:** Size by Units  
**FS** 71 1/2" X 95 1/2"  
**RO** 72" X 96"  
**Egress Information A1, A2, B1, B2**  
 No Egress Information available.

Ebony Exterior  
 Stone White Interior  
 Window Frame  
 2W2H - Rectangle Assembly  
 Assembly Rough Opening  
 72" X 96"

Unit: A1  
 Essential Direct Glaze Rectangle  
 Basic Frame 35 1/2" X 71 1/2"  
 Rough Opening 36" X 72"  
 IG - 1 Lite  
 Low E3 w/Argon  
 Black Perimeter Bar

Unit: A2  
 Essential Direct Glaze Rectangle  
 Basic Frame 35 1/2" X 71 1/2"  
 Rough Opening 36" X 72"  
 IG - 1 Lite  
 Low E3 w/Argon  
 Black Perimeter Bar

Unit: B1  
 Essential Awning - Stationary  
 CN 3020  
 Rough Opening 36" X 24"  
 IG - 1 Lite  
 Low E3 w/Argon  
 Black Perimeter Bar

Unit: B2  
 Essential Awning - Roto Operating  
 CN 3020  
 Rough Opening 36" X 24"  
 IG - 1 Lite  
 Low E3 w/Argon  
 Black Perimeter Bar  
 White Folding Handle  
 Interior Aluminum Screen  
 Bright View Mesh  
 Stone White Surround  
 Horizontal Standard 1/2"  
 Vertical Standard 1/2"  
 4 9/16" Jamb  
 Jamb Extension from 2" to 4 9/16"  
 Nailing Fin with 4" Structural Brackets

**\*\*\*Note: Unit Availability and Price is Subject to Change**

Initials required

Seller: \_\_\_\_\_

Buyer: \_\_\_\_\_

Line #7	Mark Unit: B-Mull Kit Line 5 BSMT FAM	Net Price:		182.60
Qty: 1		Ext. Net Price:	USD	182.60

**Marvin Parts**  
 11850699 WINDOW MRF MULL KIT, EBONY/STONE WHITE, 96"

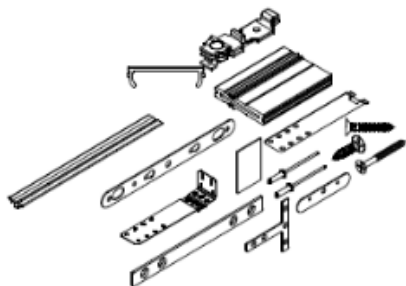

Initials required  
 Seller: \_\_\_\_\_  
 Buyer: \_\_\_\_\_

Line #8	Mark Unit: SIDE B - BASEMENT BEDROOM 4	Net Price:		572.66
Qty: 1		Ext. Net Price:	USD	572.66

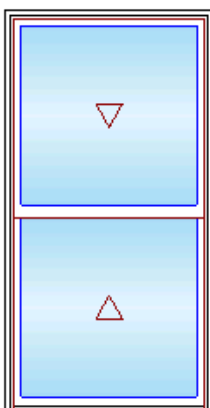

As Viewed From The Exterior

Entered As: CN  
 CN 2850  
 FS 31 1/2" X 59 1/2"  
 RO 32" X 60"  
**Egress Information**  
 Width: 28 9/16" Height: 25 13/64"  
 Net Clear Opening: 5.00 SqFt

- Ebony Exterior
- Stone White Interior
- Essential Double Hung
- CN 2850
- Rough Opening 32" X 60"
- Glass Add For All Sash
- Top Sash
  - IG - 1 Lite
  - Low E3 w/Argon
  - Black Perimeter Bar
- Bottom Sash
  - IG - 1 Lite
  - Low E3 w/Argon
  - Black Perimeter Bar
- 2 White Sash Lock
- White Sash Lift
- Exterior Aluminum Screen
- Ebony Surround
- Bright View Mesh
- 2" Jambs
- Nailing Fin

**\*\*\*Note: Unit Availability and Price is Subject to Change**

Initials required  
 Seller: \_\_\_\_\_  
 Buyer: \_\_\_\_\_

Line #9	Mark Unit: SIDE B - MASTER BATHROOM	Net Price:		1,209.63
Qty: 1		Ext. Net Price:	USD	1,209.63



- Ebony Exterior
- Stone White Interior
- Window Frame
- 1W2H - Rectangle Assembly
- Assembly Rough Opening
- 28" X 96"

Unit: A1





As Viewed From The Exterior

**Entered As:** Size by Units  
**FS** 27 1/2" X 95 1/2"  
**RO** 28" X 96"  
**Egress Information A1, B1**  
 No Egress Information available.

Essential Direct Glaze Rectangle  
 Basic Frame 27 1/2" X 71 1/2"  
 Rough Opening 28" X 72"  
 IG - 1 Lite  
 Low E3 w/Argon  
 Black Perimeter Bar

Unit: B1  
 Essential Awning - Roto Operating  
 Basic Frame 27 1/2" X Call Number 20  
 Rough Opening 28" X 24"  
 IG - 1 Lite  
 Low E3 w/Argon  
 Black Perimeter Bar  
 White Folding Handle  
 Interior Aluminum Screen  
 Bright View Mesh  
 Stone White Surround  
 Horizontal Standard 1/2"  
 4 9/16" Jamb  
 Jamb Extension from 2" to 4 9/16"  
 Nailing Fin with 4" Structural Brackets  
 \*\*\*Note: Mull Certified to AAMA 450 and rated to LC-25  
 \*\*\*Note: Unit Availability and Price is Subject to Change

Initials required  
 Seller: \_\_\_\_\_  
 Buyer: \_\_\_\_\_

Line #11	Mark Unit: SIDE B - MASTER BEDROOM	Net Price:		3,177.50
Qty: 1		Ext. Net Price:	USD	3,177.50

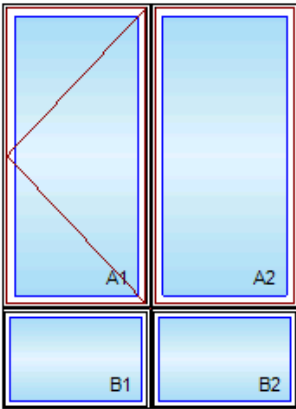

As Viewed From The Exterior

**Entered As:** Size by Units  
**FS** 71 1/2" X 95 1/2"  
**RO** 72" X 96"  
**Egress Information A1**  
 Width: 26 43/64" Height: 66 5/16"  
 Net Clear Opening: 12.28 SqFt  
**Egress Information A2, B1, B2**  
 No Egress Information available.

Ebony Exterior  
 Stone White Interior  
 Window Frame  
 2W2H - Rectangle Assembly  
 Assembly Rough Opening  
 72" X 96"

Unit: A1  
 Essential Casement - Left Hand  
 CN 3060  
 Rough Opening 36" X 72"  
 Residential Rated  
 IG - 1 Lite  
 Low E3 w/Argon  
 Black Perimeter Bar  
 White Folding Handle  
 Interior Aluminum Screen  
 Bright View Mesh  
 Stone White Surround

Unit: A2  
 Essential Casement - Stationary  
 CN 3060  
 Rough Opening 36" X 72"  
 Residential Rated  
 IG - 1 Lite  
 Low E3 w/Argon  
 Black Perimeter Bar

Unit: B1  
 Essential Direct Glaze Rectangle  
 Basic Frame 35 1/2" X 23 1/2"  
 Rough Opening 36" X 24"  
 IG - 1 Lite  
 Tempered Low E3 w/Argon

Black Perimeter Bar

Unit: B2  
 Essential Direct Glaze Rectangle  
 Basic Frame 35 1/2" X 23 1/2"  
 Rough Opening 36" X 24"  
 IG - 1 Lite  
 Tempered Low E3 w/Argon  
 Black Perimeter Bar  
 Horizontal 1/2" MRF  
 Vertical 1/2" MRF  
 4 9/16" Jamb  
 Jamb Extension from 2" to 4 9/16"  
 Nailing Fin with 4" Structural Brackets  
 \*\*\*Note: Mull Certified to AAMA 450 and rated to LC-40  
 \*\*\*Note: This configuration is certified to AAMA 450.  
 \*\*\*Note: **Unit Availability and Price is Subject to Change**

Initials required

Seller: \_\_\_\_\_

Buyer: \_\_\_\_\_

Line #12	Mark Unit: SIDE B - MASTER BEDROOM	Net Price:		1,554.47
Qty: 1		Ext. Net Price:	USD	1,554.47

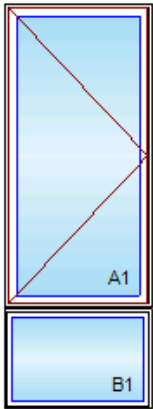

As Viewed From The Exterior

Entered As: Size by Units  
**FS** 35 1/2" X 95 1/2"  
**RO** 36" X 96"  
**Egress Information A1**  
 Width: 26 43/64" Height: 66 5/16"  
 Net Clear Opening: 12.28 SqFt  
**Egress Information B1**  
 No Egress Information available.

Ebony Exterior  
 Stone White Interior  
 Window Frame  
 1W2H - Rectangle Assembly  
 Assembly Rough Opening  
 36" X 96"  
 Unit: A1  
 Essential Casement - Right Hand  
 CN 3060  
 Rough Opening 36" X 72"  
 Residential Rated  
 IG - 1 Lite  
 Low E3 w/Argon  
 Black Perimeter Bar  
 White Folding Handle  
 Interior Aluminum Screen  
 Bright View Mesh  
 Stone White Surround

Unit: B1  
 Essential Direct Glaze Rectangle  
 Basic Frame 35 1/2" X 23 1/2"  
 Rough Opening 36" X 24"  
 IG - 1 Lite  
 Tempered Low E3 w/Argon  
 Black Perimeter Bar  
 Horizontal 1/2" MRF  
 4 9/16" Jamb  
 Jamb Extension from 2" to 4 9/16"  
 Nailing Fin with 4" Structural Brackets  
 \*\*\*Note: This configuration is certified to AAMA 450.  
 \*\*\*Note: Mull Certified to AAMA 450 and rated to LC-40  
 \*\*\*Note: **Unit Availability and Price is Subject to Change**

Initials required

Seller: \_\_\_\_\_

Buyer: \_\_\_\_\_

Line #13	Mark Unit: B-Mull Kit Line 10 MBED	Net Price:		182.60
Qty: 1		Ext. Net Price:	USD	182.60

### Marvin Parts

11850699 WINDOW MRF MULL KIT, EBONY/STONE WHITE, 96"

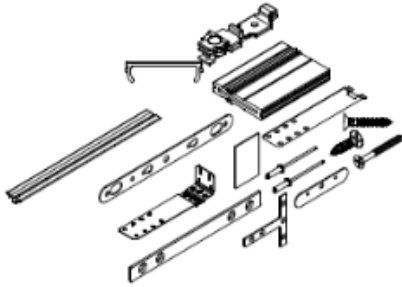

Initials required

Seller: \_\_\_\_\_

Buyer: \_\_\_\_\_

Line #14	Mark Unit: RIGHT-LIVING ROOM	Net Price:		2,334.61
Qty: 1		Ext. Net Price:	USD	2,334.61

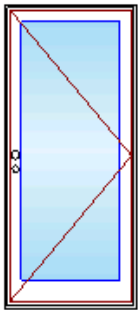

Active

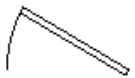

As Viewed From The Exterior

Entered As: CN

CN 3068

FS 36 5/16" X 82"

RO 37 5/16" X 82 1/2"

Egress Information

Width: 31 21/64" Height: 78 1/4"

Net Clear Opening: 17.02 SqFt

- Ebony Exterior
  - White Interior
  - Elevate Inswing French Door 4 9/16" - X Right Hand
  - CN 3068
  - Rough Opening 37 5/16" X 82 1/2"
  - Ebony Exterior
  - White Interior
  - IG - 1 Lite
  - Tempered Low E3 w/Argon
  - Black Perimeter Bar
  - Multi-Point Lock
  - Northfield Handle Matte Black Keyed Exterior Primary Handle Set
  - Northfield Handle Matte Black Interior Primary Handle Set
  - Keyed
  - Keyed Alike - Keyed Alike Group 1
  - Ebony Adjustable Hinges
  - Exterior Swinging Screen
  - Ebony Surround
  - Bright View Mesh
  - \*\*\*Screen/Combo Ship Loose
  - Bronze Ultrex Sill / Black Weather Strip
  - 4 9/16" Jamb
  - Nailing Fin
- \*\*\*Note: Unit Availability and Price is Subject to Change**

Initials required

Seller: \_\_\_\_\_

Buyer: \_\_\_\_\_

Line #15	Mark Unit: SIDE B - LIVING ROOM	Net Price:		2,954.85
Qty: 1		Ext. Net Price:	USD	2,954.85



- Ebony Exterior
- Stone White Interior
- Window Frame

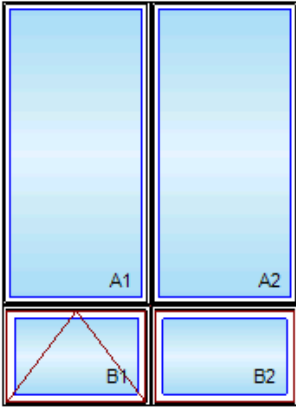

As Viewed From The Exterior

**Entered As:** Size by Units  
**FS** 71 1/2" X 95 1/2"  
**RO** 72" X 96"  
**Egress Information A1, A2, B1, B2**  
 No Egress Information available.

2W2H - Rectangle Assembly  
 Assembly Rough Opening  
 72" X 96"

Unit: A1  
 Essential Direct Glaze Rectangle  
 Basic Frame 35 1/2" X 71 1/2"  
 Rough Opening 36" X 72"  
 IG - 1 Lite  
 Low E3 w/Argon  
 Black Perimeter Bar

Unit: A2  
 Essential Direct Glaze Rectangle  
 Basic Frame 35 1/2" X 71 1/2"  
 Rough Opening 36" X 72"  
 IG - 1 Lite  
 Low E3 w/Argon  
 Black Perimeter Bar

Unit: B1  
 Essential Awning - Roto Operating  
 CN 3020  
 Rough Opening 36" X 24"  
 IG - 1 Lite  
 Tempered Low E3 w/Argon  
 Black Perimeter Bar  
 White Folding Handle  
 Interior Aluminum Screen  
 Bright View Mesh  
 Stone White Surround

Unit: B2  
 Essential Awning - Stationary  
 CN 3020  
 Rough Opening 36" X 24"  
 IG - 1 Lite  
 Tempered Low E3 w/Argon  
 Black Perimeter Bar  
 Horizontal 1/2" MRF  
 Vertical 1/2" MRF  
 4 9/16" Jamb  
 Jamb Extension from 2" to 4 9/16"  
 Nailing Fin with 4" Structural Brackets  
 \*\*\*Note: Mull Certified to AAMA 450 and rated to LC-40  
 \*\*\*Note: This configuration is certified to AAMA 450.  
 \*\*\*Note: **Unit Availability and Price is Subject to Change**

Initials required

Seller: \_\_\_\_\_

Buyer: \_\_\_\_\_

Line #16	Mark Unit: SIDE B - LIVING ROOM	Net Price:	2,954.85
Qty: 1		Ext. Net Price:	2,954.85
		USD	



Ebony Exterior  
 Stone White Interior  
 Window Frame  
 2W2H - Rectangle Assembly  
 Assembly Rough Opening  
 72" X 96"

Unit: A1  
 Essential Direct Glaze Rectangle  
 Basic Frame 35 1/2" X 71 1/2"  
 Rough Opening 36" X 72"  
 IG - 1 Lite

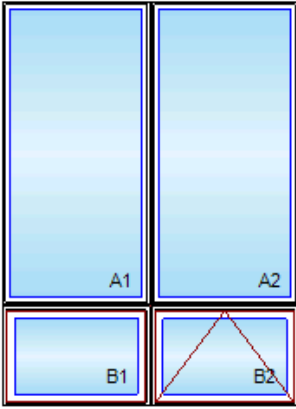

As Viewed From The Exterior

**Entered As:** Size by Units  
**FS** 71 1/2" X 95 1/2"  
**RO** 72" X 96"  
**Egress Information A1, A2, B1, B2**  
 No Egress Information available.

Low E3 w/Argon  
 Black Perimeter Bar

Unit: A2  
 Essential Direct Glaze Rectangle  
 Basic Frame 35 1/2" X 71 1/2"  
 Rough Opening 36" X 72"  
 IG - 1 Lite  
 Low E3 w/Argon  
 Black Perimeter Bar

Unit: B1  
 Essential Awning - Stationary  
 CN 3020  
 Rough Opening 36" X 24"  
 IG - 1 Lite  
 Tempered Low E3 w/Argon  
 Black Perimeter Bar

Unit: B2  
 Essential Awning - Roto Operating  
 CN 3020  
 Rough Opening 36" X 24"  
 IG - 1 Lite  
 Tempered Low E3 w/Argon  
 Black Perimeter Bar  
 White Folding Handle  
 Interior Aluminum Screen  
 Bright View Mesh  
 Stone White Surround  
 Horizontal 1/2" MRF  
 Vertical 1/2" MRF  
 4 9/16" Jamb  
 Jamb Extension from 2" to 4 9/16"  
 Nailing Fin with 4" Structural Brackets

\*\*\*Note: Mull Certified to AAMA 450 and rated to LC-40  
 \*\*\*Note: This configuration is certified to AAMA 450.  
 \*\*\*Note: **Unit Availability and Price is Subject to Change**

Initials required

Seller: \_\_\_\_\_

Buyer: \_\_\_\_\_

Line #17	Mark Unit: B-Mull Kit Line 15 LIVING	Net Price:	182.60
Qty: 1		Ext. Net Price:	182.60
		USD	

**Marvin Parts**

11850699 WINDOW MRF MULL KIT, EBONY/STONE WHITE, 96"

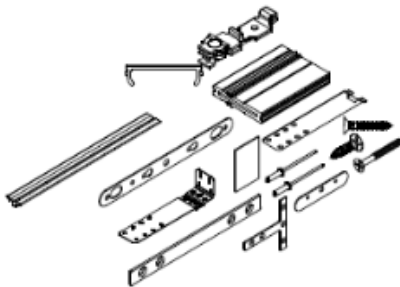

Initials required

Seller: \_\_\_\_\_

Buyer: \_\_\_\_\_

Line #18	Mark Unit: SIDE B - FOYER	Net Price:		1,524.92
Qty: 1		Ext. Net Price:	USD	1,524.92



As Viewed From The Exterior

**Entered As:** Size by Units  
**FS** 89 1/2" X 47 1/2"  
**RO** 90" X 48"  
**Egress Information A1, A2, A3**  
 No Egress Information available.

Ebony Exterior  
 Stone White Interior  
 Window Frame  
 3W1H - Rectangle Assembly  
 Assembly Rough Opening  
 90" X 48"

Unit: A1  
 Essential Direct Glaze Rectangle  
 Basic Frame 29 1/2" X 47 1/2"  
 Rough Opening 30" X 48"  
 IG - 1 Lite  
 Low E3 w/Argon  
 Black Perimeter Bar

Unit: A2  
 Essential Direct Glaze Rectangle  
 Basic Frame 29 1/2" X 47 1/2"  
 Rough Opening 30" X 48"  
 IG - 1 Lite  
 Low E3 w/Argon  
 Black Perimeter Bar

Unit: A3  
 Essential Direct Glaze Rectangle  
 Basic Frame 29 1/2" X 47 1/2"  
 Rough Opening 30" X 48"  
 IG - 1 Lite  
 Low E3 w/Argon  
 Black Perimeter Bar  
 Vertical Standard 1/2"  
 4 9/16" Jamb  
 Jamb Extension from 2" to 4 9/16"  
 Nailing Fin with 4" Structural Brackets

\*\*\*Note: Mull Certified to AAMA 450 and rated to LC-25  
**\*\*\*Note: Unit Availability and Price is Subject to Change**

Initials required

Seller: \_\_\_\_\_

Buyer: \_\_\_\_\_

Line #19	Mark Unit: SIDE B - BEDROOM 3	Net Price:		1,316.21
Qty: 1		Ext. Net Price:	USD	1,316.21



Ebony Exterior  
 Stone White Interior  
 Window Frame  
 1W2H - Rectangle Assembly  
 Assembly Rough Opening  
 30" X 96"

Unit: A1  
 Essential Casement - Right Hand  
 CN 2660  
 Rough Opening 30" X 72"  
 Residential Rated  
 IG - 1 Lite  
 Low E3 w/Argon  
 Black Perimeter Bar  
 White Folding Handle  
 Interior Aluminum Screen  
 Bright View Mesh

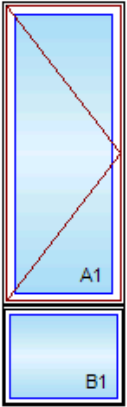

As Viewed From The Exterior

Stone White Surround

Unit: B1  
 Essential Direct Glaze Rectangle  
 Basic Frame 29 1/2" X 23 1/2"  
 Rough Opening 30" X 24"  
 IG - 1 Lite  
 Tempered Low E3 w/Argon  
 Black Perimeter Bar  
 Horizontal Standard 1/2"  
 4 9/16" Jamb  
 Jamb Extension from 2" to 4 9/16"  
 Nailing Fin with 4" Structural Brackets  
 \*\*\*Note: Mull Certified to AAMA 450 and rated to LC-25  
**\*\*\*Note: Unit Availability and Price is Subject to Change**

Initials required

Seller: \_\_\_\_\_

Buyer: \_\_\_\_\_

Entered As: Size by Units

FS 29 1/2" X 95 1/2"

RO 30" X 96"

Egress Information A1

Width: 20 43/64" Height: 66 5/16"

Net Clear Opening: 9.52 SqFt

Egress Information B1

No Egress Information available.

Line #20	Mark Unit: SIDE B - BEDROOM 2	Net Price:		1,195.39
Qty: 1		Ext. Net Price:	USD	1,195.39

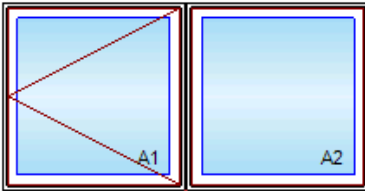

As Viewed From The Exterior

Ebony Exterior  
 Stone White Interior  
 2W1H - Rectangle Assembly  
 Assembly Rough Opening  
 72" X 36"

Unit: A1  
 Essential Casement - Left Hand  
 CN 3030  
 Rough Opening 36" X 36"  
 Residential Rated  
 IG - 1 Lite  
 Low E3 w/Argon  
 Black Perimeter Bar  
 White Folding Handle  
 Interior Aluminum Screen  
 Bright View Mesh  
 Stone White Surround

Entered As: Size by Units

FS 71 1/2" X 35 1/2"

RO 72" X 36"

Egress Information A1

Width: 26 43/64" Height: 30 5/16"

Net Clear Opening: 5.62 SqFt

Egress Information A2

No Egress Information available.

Unit: A2  
 Essential Casement - Stationary  
 CN 3030  
 Rough Opening 36" X 36"  
 Residential Rated  
 IG - 1 Lite  
 Low E3 w/Argon  
 Black Perimeter Bar  
 Vertical Standard 1/2"  
 4 9/16" Jamb  
 Jamb Extension from 2" to 4 9/16"  
 Nailing Fin with 4" Structural Brackets  
 \*\*\*Note: Mull Certified to AAMA 450 and rated to LC-25  
**\*\*\*Note: Unit Availability and Price is Subject to Change**

Initials required

Seller: \_\_\_\_\_

Buyer: \_\_\_\_\_

Line #21	Mark Unit: SIDE B - BEDROOM 2	Net Price:		1,195.39
Qty: 1		Ext. Net Price:	USD	1,195.39

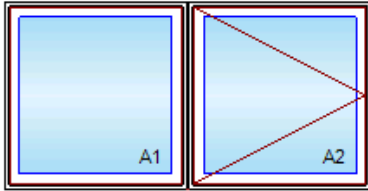

As Viewed From The Exterior

**Entered As:** Size by Units

**FS** 71 1/2" X 35 1/2"

**RO** 72" X 36"

**Egress Information A1**

No Egress Information available.

**Egress Information A2**

Width: 26 43/64" Height: 30 5/16"

Net Clear Opening: 5.62 SqFt

Ebony Exterior  
 Stone White Interior  
 2W1H - Rectangle Assembly  
 Assembly Rough Opening  
 72" X 36"

Unit: A1  
 Essential Casement - Stationary  
 CN 3030  
 Rough Opening 36" X 36"  
 Residential Rated  
 IG - 1 Lite  
 Low E3 w/Argon  
 Black Perimeter Bar

Unit: A2  
 Essential Casement - Right Hand  
 CN 3030  
 Rough Opening 36" X 36"  
 Residential Rated  
 IG - 1 Lite  
 Low E3 w/Argon  
 Black Perimeter Bar  
 White Folding Handle  
 Interior Aluminum Screen  
 Bright View Mesh  
 Stone White Surround  
 Vertical Standard 1/2"  
 4 9/16" Jambs  
 Jamb Extension from 2" to 4 9/16"  
 Nailing Fin with 4" Structural Brackets

\*\*\*Note: Mull Certified to AAMA 450 and rated to LC-25

\*\*\*Note: Unit Availability and Price is Subject to Change

Initials required

Seller: \_\_\_\_\_

Buyer: \_\_\_\_\_

Line #22	Mark Unit: B-Mull Kit Line 20 BED2	Net Price:		52.95
Qty: 1		Ext. Net Price:	USD	52.95

**Marvin Parts**

11842030 WINDOW ESSENTIAL MULL KIT CN30,EBONY/STONE WHITE

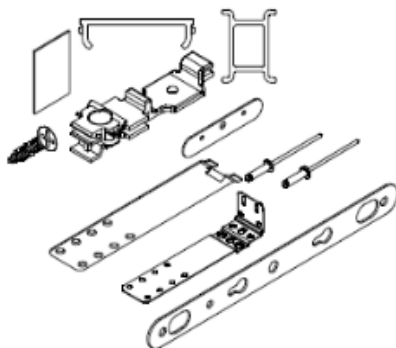

Initials required

Seller: \_\_\_\_\_

Buyer: \_\_\_\_\_



Project Subtotal Net Price: USD	30,391.64
9.750% Sales Tax: USD	2,963.18
Project Total Net Price: USD	33,354.82