

LEGACY REAL ESTATE  
52 FIRE FLY  
THE HIGHLANDS

MASTER SHOWER

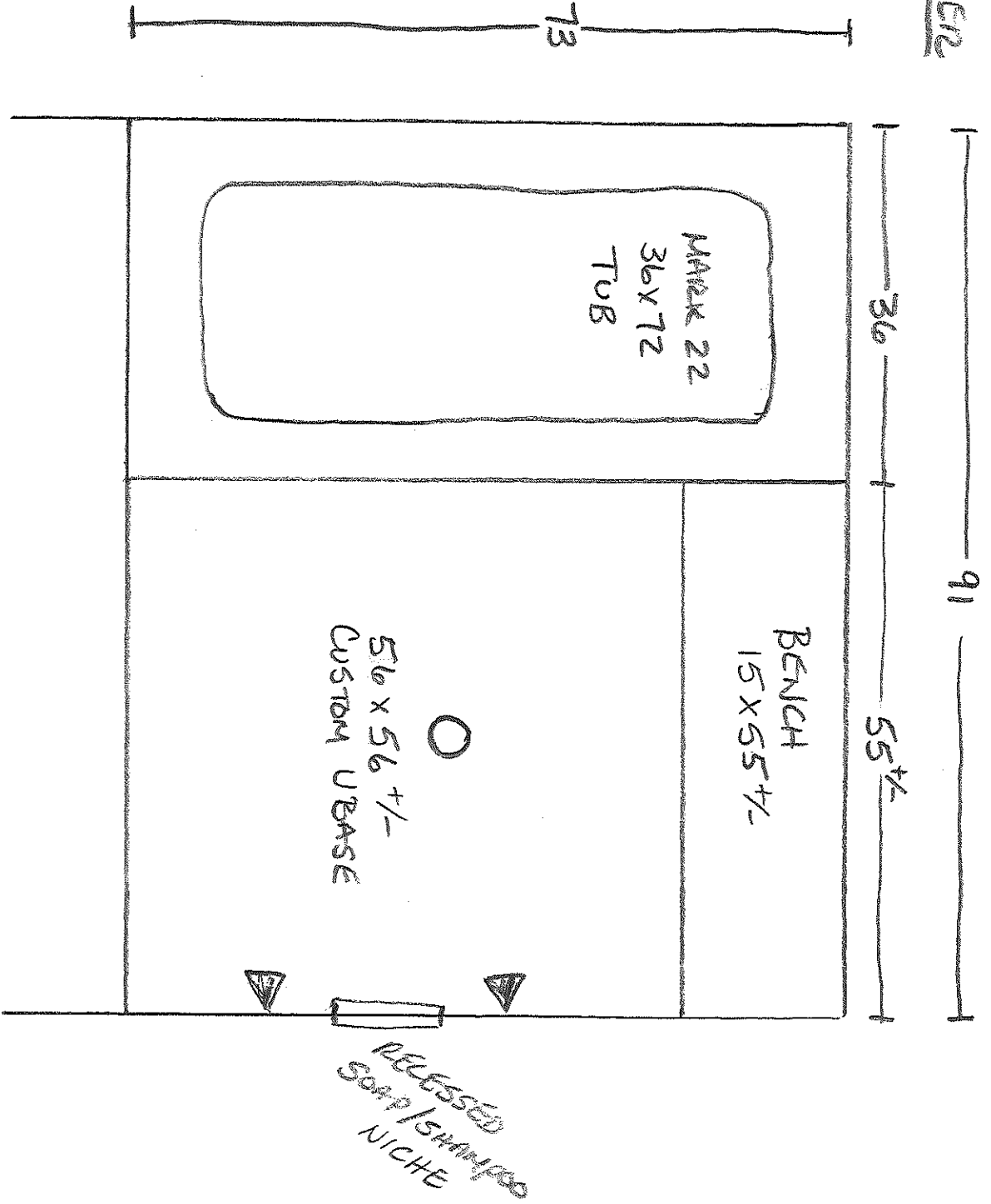

2-21-24

LEGACY REAL ESTATE  
52 FIFEAVY  
THE HIGHLANDS

MASTER SHOWER DOOR

91X84  
1000 SERIES BAKEN STYRE  
SHOWER DOOR

2-21-24

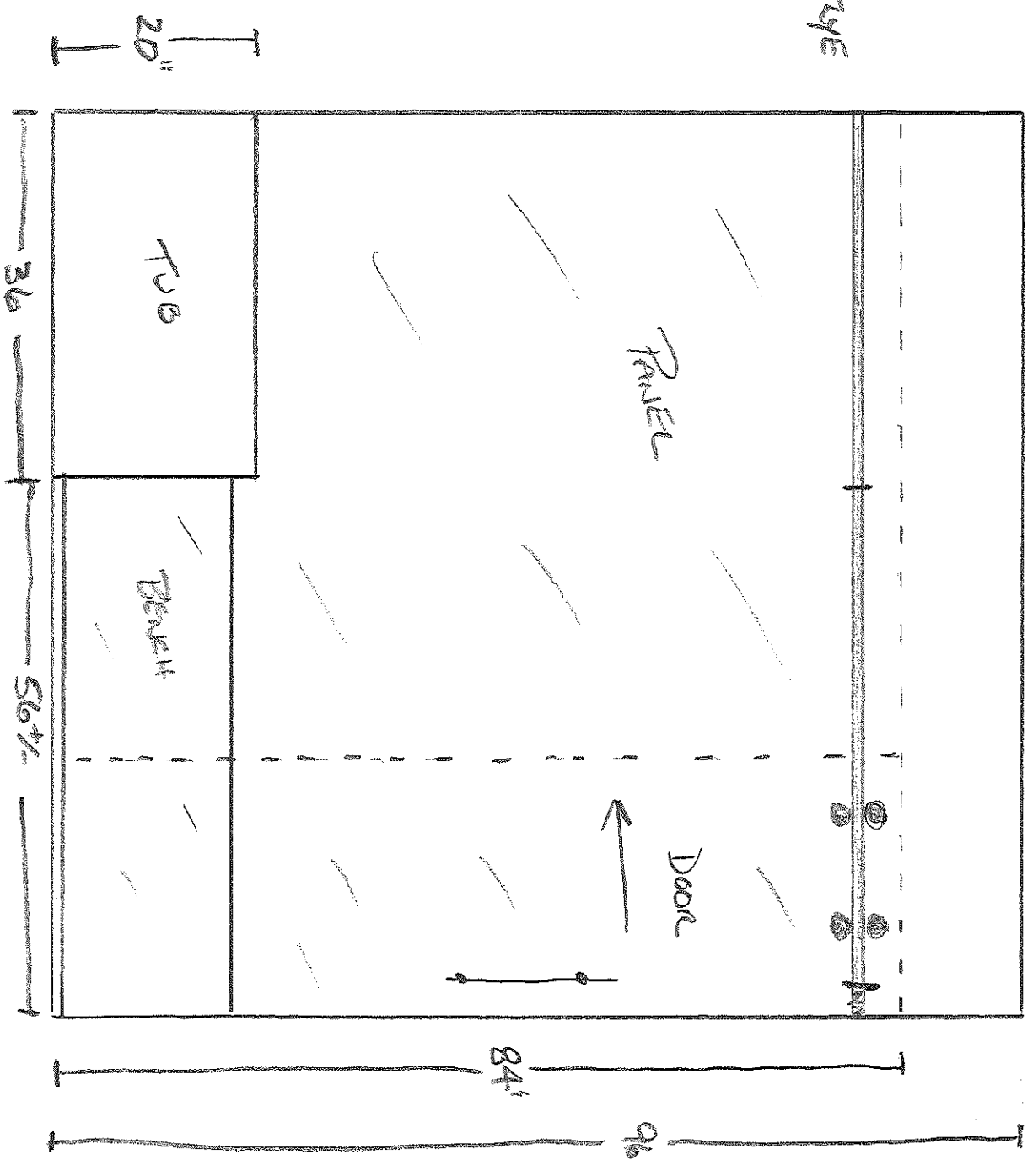



3000 Great Northern Ave.  
 Springfield, IL. 62707  
 Office (217) 726-9300  
 Fax (217) 726-9322  
 Chris Wyler – Branch Manager

CULTURED MARBLE TUBS, SHOWER BASES, FLAT STOCK, VANITY TOPS, SHOWER DOORS, MIRRORS & SHELVING

PROPOSAL DATE:		2/22/24					
LEGENCY REAL ESTATE				52 FIREFLY			
ATTN: DAN				THE HIGHLANDS			
				RE:MASTER SHOWER			
	QTY	COLOR					PRICE
OPTION A	1	TRADITIONAL		36 X 73 MARK 22 MARBLE TUB			
				56 X 56 CUSTOM U BASE			
				96" SHOWER PANELS			
				16 X 54 BENCH			
				16 X 24 CUSTOM SOAP/SHAMPOO NICHE			
				4" THRESHOLD			
				INSTALLED			\$9,899.77
OPTION B	1	TYVARIAN SUBWAY		36 X 73 MARK 22 MARBLE TUB			
				56 X 56 CUSTOM U BASE			
				96" SHOWER PANELS			
				16 X 54 BENCH			
				16 X 24 CUSTOM SOAP/SHAMPOO NICHE			
				4" THRESHOLD			
				INSTALLED			\$13,426.09
				TOTAL			

WATER LEAKAGE: FRAMELESS/ SEMI-FRAMELESS SHOWER DOORS ARE NOT DESIGNED TO BE 100% LEAK FREE OR WATER TIGHT LIKE A STANDARD ALL FRAME UNIT. BY ITS NATURE, THERE IS A MINIMAL AMOUNT OF METAL AND SEALS USED TO CREATE THE FRAMELESS APPEARANCE. THEREFORE, IT IS IMPOSSIBLE TO CREATE A FRAMELESS LOOK WITHOUT HAVING SOME MINOR SEEPAGE AROUND HINGES, DOOR SWEEPS, AND VINYL. IN ADDITION, SOME CONFIGURATIONS INCREASE THE POSSIBILITY OF WATER LEAKAGE DEPENDING ON THE NUMBER & PLACEMENT OF SHOWER HEADS IN RELATION TO THE DOOR & OTHER VINYL SEALED OPENINGS. SUPERIOR TAKES EVERY STEP NECESSARY TO CONTROL THIS TYPE OF LEAKAGE, BUT CAN NOT GUARANTEE THAT THERE WILL NOT BE SOME MIGRATION & COLLECTION OF WATER AROUND HINGES, SEALS, THRESHOLDS & DOOR SWEEPS

UNITS WITHOUT HEADERS: Certain Frameless units can be installed without a header across the top of the unit. That determination is based on the design, size, and style of unit. Superior ensures all designs are approved by its supplier and safe for installation, but unless additional support is added, units without a header do not have as much overall stability as units that incorporate a header. Therefore, there may be some minor movement noticed during operation of the door

## PROPOSAL





