

Building Lot 62 Tenth St. Dover DE.

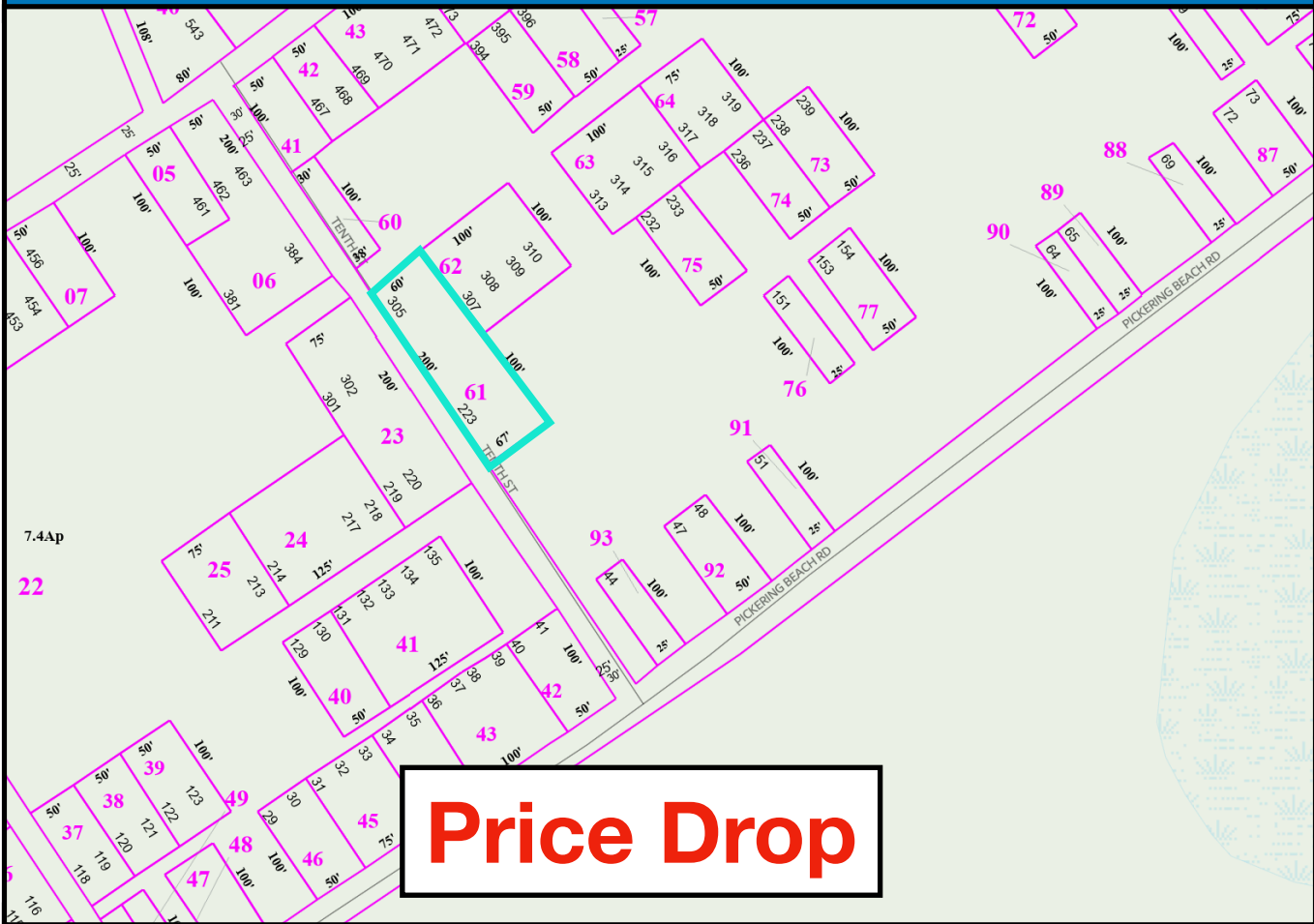

Price Drop

\$29,000

Building Lot 200' road frontage, 67' deep, County sewer available, City Of Dover electric, private well. Less than a mile from the white sands of the public beach and public parking at Pickering beach Delaware. Surrounded by public lands all the beauty and nature Delaware has to offer. Zoning allows mobil, doublewide, manufactured, or new construction.

Tom Antoniou 302-670-0406



144 Kings HWY. Suite 301
Dover De. 19901 888-543-4829