



SALES@SP1FITTINGS.COM

SP1FITTINGS.COM

HDPE SPECIALTY VALVE PRODUCTS

HDPE CHECK VALVE

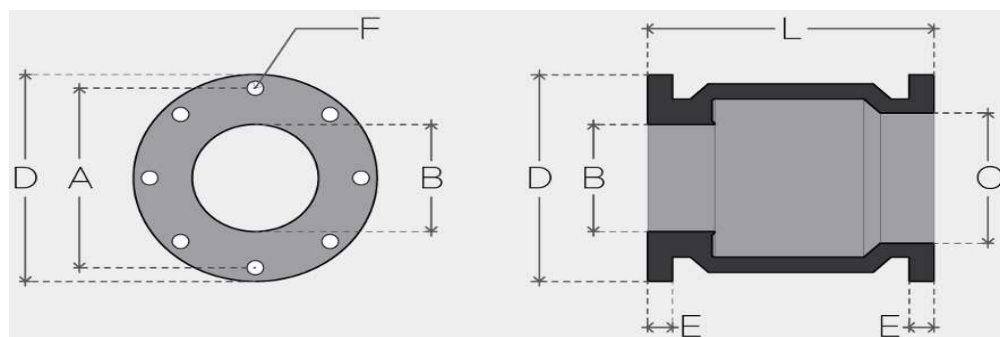

Fluid Control Valve

Allows flow in only one direction and prevents backflow.

Applications: Irrigation, Waterworks, Agriculture, Aquaculture, Mining, Industrial.

Nominal Valve Size	D DIM	A DIM	B DIM	C DIM	L DIM	E DIM	F DIM	Bolt Holes	Weight lbs.	Part Number
3"	7.5"	6"	3"	4"	10"	1"	0.7	4	6	FCV030
4"	9"	7.5"	3.9"	5"	11"	1"	0.7	8	9.3	FCV040
6"	11"	9.5"	5.7"	6.7"	14.2"	1.2"	0.9	8	18.3	FCV060
8"	13.5"	11.7"	7.5"	8.8"	15.7"	1.4"	0.9	8	28.7	FCV080
10"	16"	14.3"	9.3"	10.2"	17.3"	1.5"	1"	12	32.4	FCV100
12"	19"	17"	11"	11"	18.1"	2"	1"	12	60.2	FCV120
14"	21"	18.7"	10.7"	11.4"	20.9"	2.2"	1.1"	12	83.8	FCV140
16"	23.5"	21.3"	13.9"	14.6"	23.6"	2.4"	1.1"	16	119.1	FCV160

COMPONENTS

- PE4710 HDPE body & flapper
- 316 Stainless Steel mechanism, springs, bolts & washers
- Rubber Seals

OPERATING CONDITIONS:

- 5psi to 150psi Operating Range
- -85°F (-65°C) to 160°F (70°C)

CORROSION RESISTANCE

- Supports sulphuric acid and most common fluids per HDPE PE3608/PE4710 Specifications.

FEATURES

- Fast, easy, and lightweight.
- Flanged ANSI Class 150 (150#) connections.
- Easy on-site maintenance kits available.
- Extremely low flow resistance.
- Very low opening pressure of only 5psi.
- No noisy hammering makes it great for aquaculture.
- Operates in any installed configuration.
- Also available in DIN and Class D per special request.