

# TECHNICAL SPECIFICATION

PORTAFILL MJ-9



\* All drawings dimensions approximate and in millimetres and feet and inches. Portafill International reserves the right to alter the specification of the machines without notice. Images may show some optional equipment. E & OE.



## JAW CRUSHER

1. Sidewall
2. Front Face
3. Rear Face
4. Fixed Jaw
5. Movable Jaw
6. Wear Plates
7. Flywheel
8. Eccentric Shaft
9. Jaw Stock
10. Supporting Shell
11. Plain-Collar Bearing
12. Toggle Plate
13. Adjusting Wedges
14. Hydraulic Cylinder
15. Spacing Tube

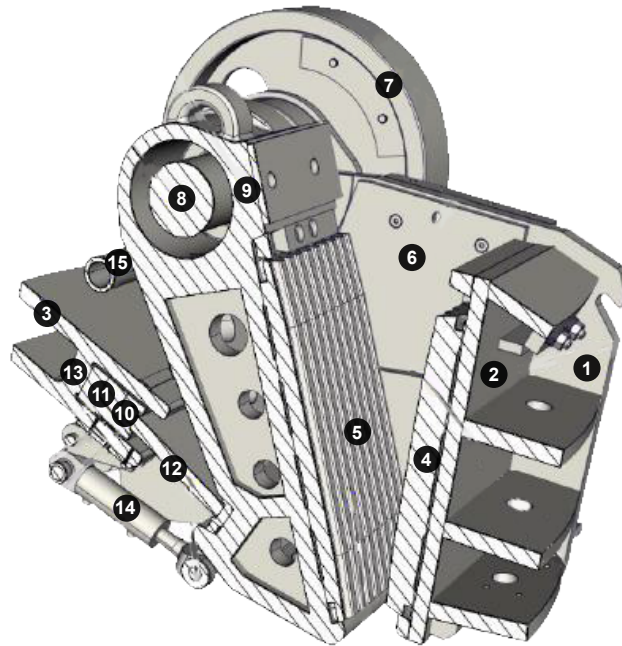

<b>Crusher Type</b>	Single Toggle
<b>Crusher Opening</b>	850 x 500 (34" x 20")
<b>Crusher Drive</b>	Reversible hydraulic drive through V belts
<b>CSS Adjustment</b>	Hydraulic via wedge
<b>Crusher Overload Protection</b>	Yes
<b>CSS Range (Long Toggle Plate)</b>	40mm (1½") - 85mm (3½")
<b>CSS Range (Short Toggle Plate)</b>	55mm (2") - 100mm (4")
<b>Maximum Lump Size</b>	600 x 400mm (24" x 16") depending on material
<b>Maximum Feed Strength</b>	280 MPa
<b>Minimum CSS (concrete)</b>	40mm (1½")
<b>Minimum CSS (hard stone)</b>	55mm (2")
<b>CSS Adjustment</b>	Hydraulic adjustment via a wedge system
<b>Deflector Plate</b>	Hydraulic adjusting deflector plate under crusher as standard.
<b>Jaw Plates</b>	Choose between jaw plates suitable for recycling or hard rock.
<b>Jaw Weight</b>	8,100kgs (17,850lbs)

## HOPPER

<b>Hopper Sides</b>	Hydraulic folding of sides and rear hopper doors. All controls on ground level with hydraulic locking as standard.
<b>Hopper Length and Width</b>	4100mm x 2000mm (13'5" x 6'6")
<b>Hopper Capacity</b>	4m <sup>3</sup> (5 cu yd) or 7m <sup>3</sup> heaped (5.2 cu. yd. or 9 cu. yd. heaped)
<b>Feed Height</b>	3300mm (10'9")
<b>Vibrating Feeder including grizzly</b>	3660mm x 810mm (12' x 12'8")
<b>Pre-screening Grid Length</b>	1160mm (46")
<b>Pre-screening Grid Spacing</b>	30mm to 40mm (12 to 1.5") taper
<b>Pre-screening Discharge</b>	Onto main conveyor or optional side conveyor
<b>Vibration Source</b>	Vibrating pan feeder
<b>Feed to Crusher Control</b>	Load management on feeder
<b>Chute</b>	Bypass chute as standard, directing material onto main belt or onto optional side dirt belt.



## MAIN CONVEYOR

<b>Belt Width</b>	900mm (36")
<b>Discharge Height</b>	3015mm (9'10")
<b>Folding Mechanism</b>	Hydraulic Folding for Transport
<b>Construction</b>	Impact Bed Under Crusher
<b>Belt Type</b>	Smooth

## POWER

<b>Engine</b>	Volvo Penta D5 129kw (172HP), EU Stage IV or V, EPA Tier 3 or 4F
<b>Engine</b>	CAT C4.4 129kw (172HP) EU Stage IV or V, EPA Tier 3 or 4F
<b>Typical Fuel Consumption</b>	18-22 litres per hour (5-6 US Gallons per hour)
<b>Fuel Tank Capacity</b>	200 litres (52 US gallon)
<b>Hydraulic Tank Capacity</b>	600 litres (156 US gallon)
<b>Air Filter</b>	Scavenger Air Filter

## MACHINE

<b>Colour</b>	RAL 2000 Orange and RAL 7015 Grey
<b>Guards</b>	CE Guards
<b>Tracking Control</b>	Via Cabled Remote Control (Dog Lead)
<b>Greasing</b>	Remote greasing at centralised position as standard with optional automatic greasing

## OPTIONAL MAGNET

<b>Magnet Block Width and Length</b>	800mm x 785mm (32" x 31")
<b>Magnet Belt Width and Length</b>	850mm x 1800mm (34" x 70")
<b>Power</b>	610 Gauss at 200mm (8") 480 Gauss at 250mm (10") 360 Gauss at 300mm (12")
<b>Discharge Direction</b>	To left hand side of machine

## OPTIONAL SIDE CONVEYOR

<b>Belt Width</b>	500mm (36")
<b>Discharge Height</b>	2830mm (9'3")
<b>Folding Mechanism</b>	Hydraulic Folding for Transport
<b>Belt Type</b>	Smooth

## OTHER OPTIONS

1. Dust suppression. Hydraulic water pump for fine misting water spray. Located at crusher inlet and main conveyor head section.
2. Dust covers on main conveyor.
3. Radio tracking remote.
4. Digital belt scales.
5. Recirculation closed loop system. Adjustable to side for stockpile as standard.

**WORKING DIMENSIONS MJ-9**

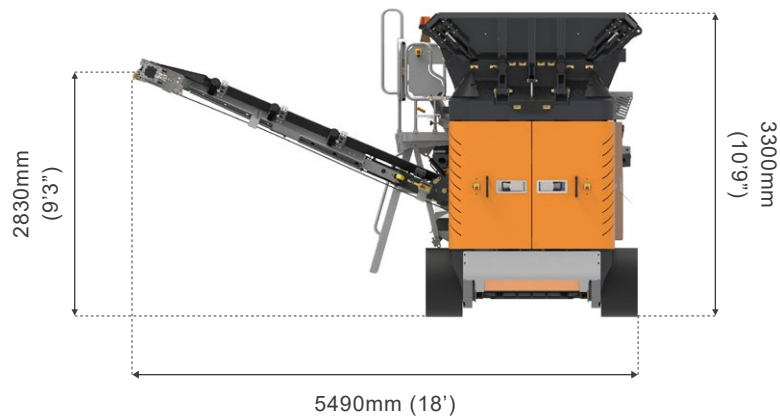
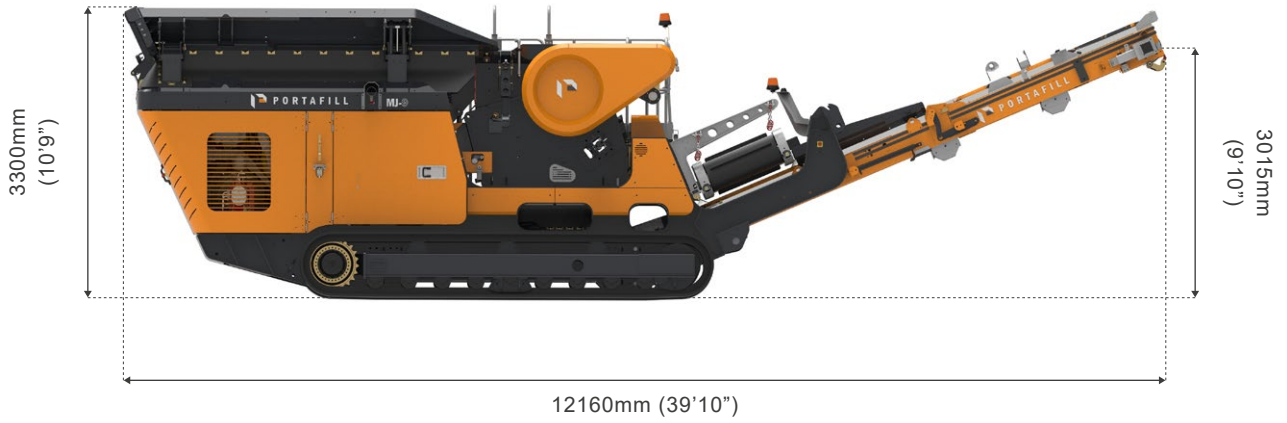

\* All drawings dimensions approximate and in millimetres and feet and inches. Portafill International reserves the right to alter the specification of the machines without notice. Images may show some optional equipment. E & OE.

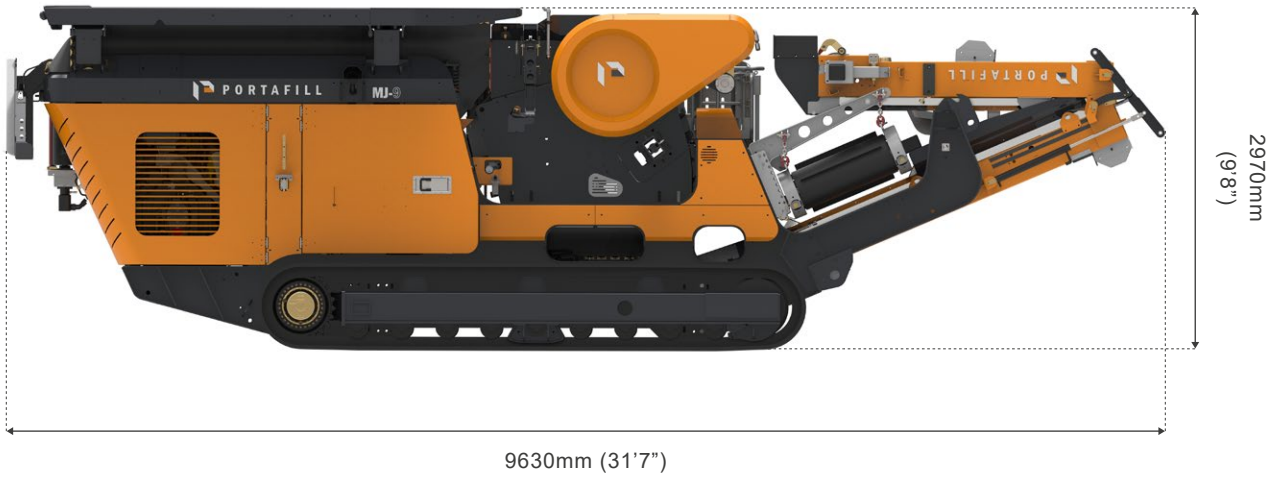
**TRANSPORT DIMENSIONS MJ-9**

<b>MJ-9 WEIGHT</b>	
<b>Base machine, no options</b>	29,250kgs (64,485lbs) <i>(approx.)</i>
<b>Belt Magnet</b>	1,500kgs (3,300lbs)
<b>Side Conveyor</b>	800kgs (1,760lbs)

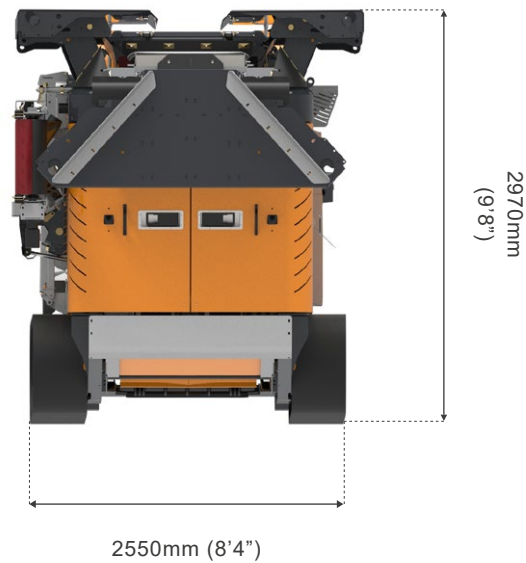

## OPTIONAL RECIRCULATING CLOSED LOOP SYSTEM

<b>Screen Box Type</b>	Bolted, Single Deck, 2 Bearing Screen
<b>Overall Screen Box Size</b>	3340mm x 1000mm (10'11" x 3'3")
<b>Transfer Conveyor Width</b>	600mm (24")
<b>Returns Conveyor Width</b>	500mm (20")
<b>Returns Conveyor Discharge Height</b>	3575mm (11'8")
<b>Fines Conveyor Width</b>	900mm (36")
<b>Fines Conveyor Discharge Height</b>	2830mm (9'3")
<b>Folding Mechanism</b>	Hydraulic Folding for Transport
<b>Returns Conveyor Position</b>	Returns Conveyor can return oversize materials to feeder or stockpile to side of machine
<b>Transport Option</b>	Complete closed loop system can be removed in one piece and transported on hook lift frame or folded hydraulically for transport and remain with the crusher chassis

## WORKING DIMENSIONS MJ-9R

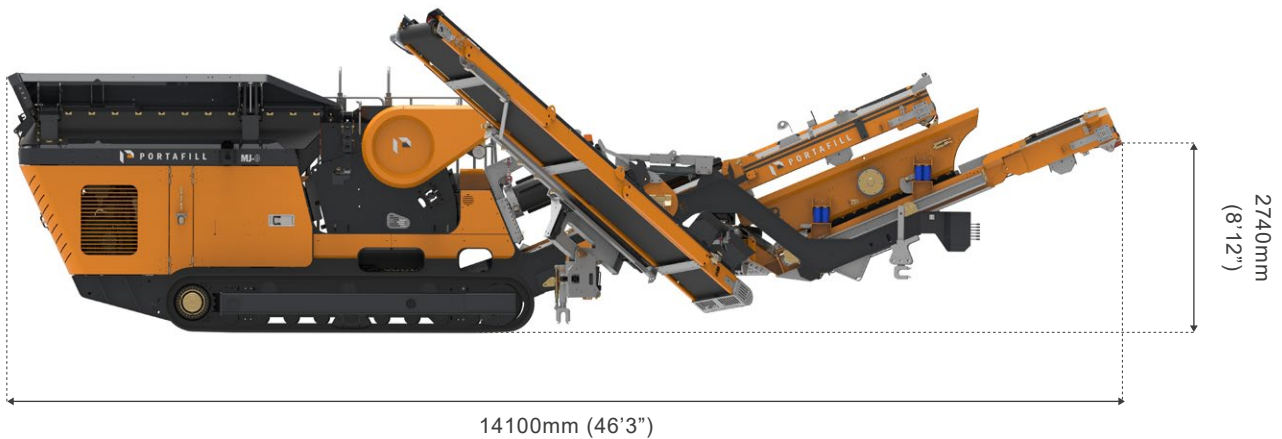



**WORKING POSITION (STOCKPILE) MJ-9R**

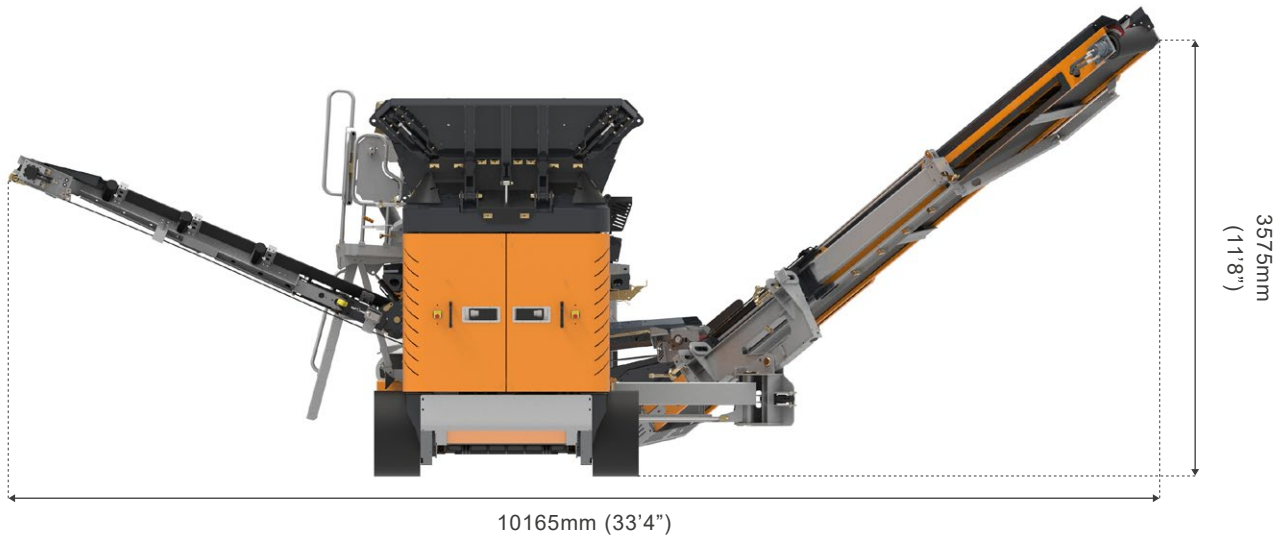

**WORKING POSITION (RETURN TO FEEDER) MJ-9R**

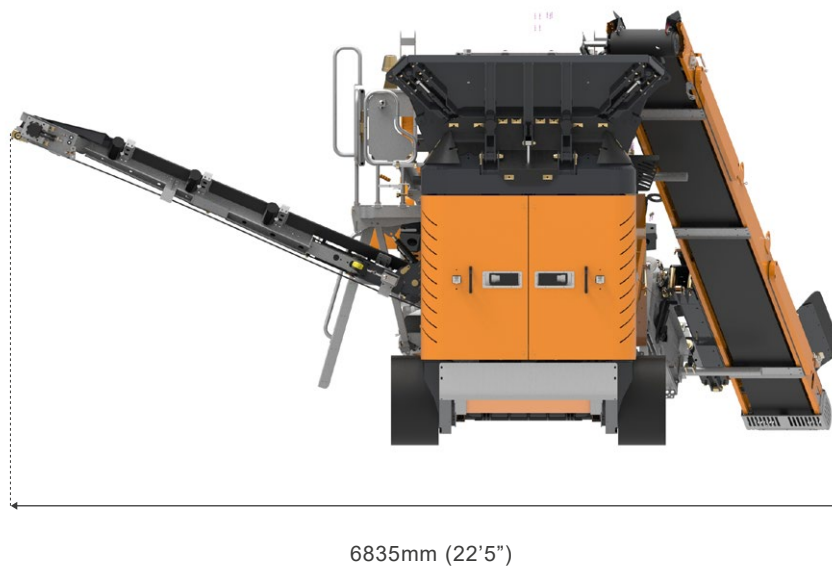



TRANSPORT POSITION MJ-9

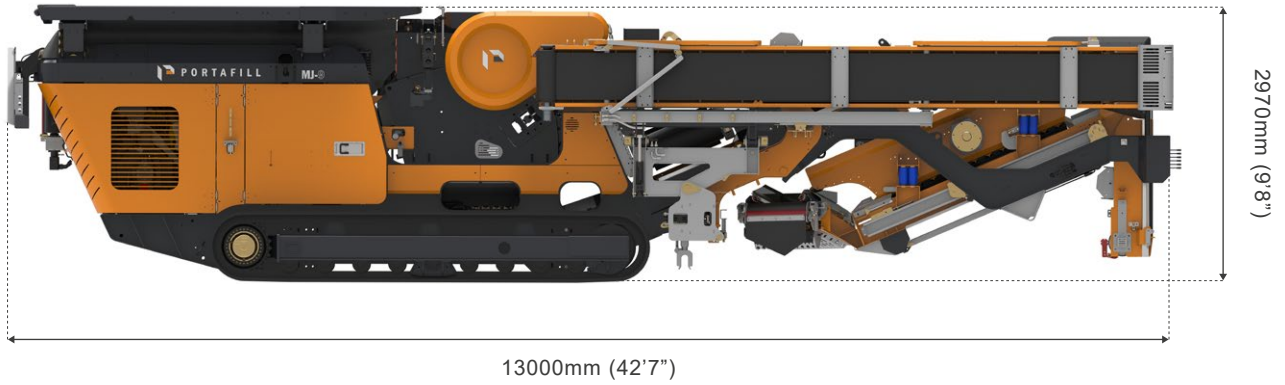

**MJ-9R WEIGHT**

**Base machine, no options**  
35,500kgs (78,264lbs)  
*(approx.)*

**Belt Magnet**  
1,500kgs (3,300lbs)

**Side Conveyor**  
800kgs (1,760lbs)

European Patent Application  
NO. 17275013.5  
NO. 13197036.0

\* All drawings dimensions approximate and in millimetres and feet and inches. Portafill International reserves the right to alter the specification of the machines without notice. Images may show some optional equipment. E & OE.