

# UNDERCUT TECHNOLOGY FOR STONE FIXING/CLADDING

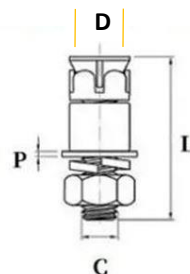

#ELITE \*\*\*



## Stone Undercut Anchors Stainless Steel A4 \*\*\*

ART. NO.	CODE	SIZE MM	C MM	D MM	EMBEDMENT DEPTH MM	T FIX. MAX. MM	NUT DIA (SW) MM	SAFE RECOMMENDED TENSION LOAD KN	SAFE RECOMMENDED SHEAR LOAD KN
6301030	SUA-SR-06020/13	M6x13/7	6	10-11	13	2	10	5.0	6.0
6301031	SUA-SR-06025/13	M6x13/12	6	10-11	13	7	10	5.0	6.0
6301032	SUA-SR-06030/13	M6x13/17	6	10-11	13	12	10	5.0	6.0
6301033	SUA-SR-06025/15	M6x15/10	6	10-11	15	5	10	5.0	6.0
6301034	SUA-SR-06030/15	M6x15/15	6	10-11	15	10	10	5.0	6.0
6301035	SUA-SR-06035/15	M6x15/20	6	10-11	15	15	10	5.0	6.0
6301036	SUA-SR-08025/15	M8x15/10	8	12-13	15	3	13	7.5	8.0
6301037	SUA-SR-08030/15	M8x15/15	8	12-13	15	8	13	7.5	8.0
6301038	SUA-SR-08035/15	M8x15/20	8	12-13	15	13	13	7.5	8.0
6301039	SUA-SR-08040/15	M8x15/25	8	12-13	15	18	13	7.5	8.0
6301030	SUA-SR-08035/21	M8x21/14	8	12-13	21	7	13	7.5	8.0
6301031	SUA-SR-08040/21	M8x21/19	8	12-13	21	12	13	7.5	8.0
6301032	SUA-SR-08045/21	M8x21/24	8	12-13	21	17	13	7.5	8.0

**NOTE:**

\*ALL LOAD TOLERANCES CAN BE ACHIEVED IN ACCORDANCE WITH THE SPECIFIED DIMENSIONS MENTIONED ABOVE.  
 \*ANY MODIFICATIONS TO THE PRODUCT PORTFOLIO CAN BE IMPLEMENTED WITHOUT PRIOR NOTIFICATION TO THE STAKEHOLDERS.  
 \*SPECIAL LENGTHS CAN BE PROVIDED UPON REQUEST, SUBJECT TO A MINIMUM ORDER QUANTITY REQUIREMENT.