

The logo for DYNALASE is centered within a white hexagonal field. The word "DYNALASE" is written in a bold, blue, sans-serif typeface. The letters are closely spaced, with the "Y" and "N" being particularly prominent. The entire logo is framed by a series of concentric, slightly offset purple hexagonal lines that create a sense of depth and movement.

DYNALASE

Dynamic. Aesthetic. Lasers.

About Us

Dynalase Aesthetic is a biomedically led and biomedically driven organization that focuses on novel, upgraded and class-apart aesthetic devices and technology.

Dynalase's mission has always been "service first". Driving our mission statement through our work, we ensure that all associations made with us are in primary focus of serving our patrons with best of our efforts.

Dynalase envisions a technological future in dermatology, plastic surgery and overall aesthetic skin industry, striving to improve lives of the people in lieu with our patrons. Dynalase works towards creating an ecosystem of bettering technology making us a dynamic choice for aesthetic lasers and technology.



Call Now.
+91 9768634974



www.dynalase.com
hello@dynalase.com



S-07-48, 2nd floor, Haware's
Centurion Mall, Plot 88 to 91,
Sector - 19A, Nerul East, Navi
Mumbai - 400706

DYNALASE APP

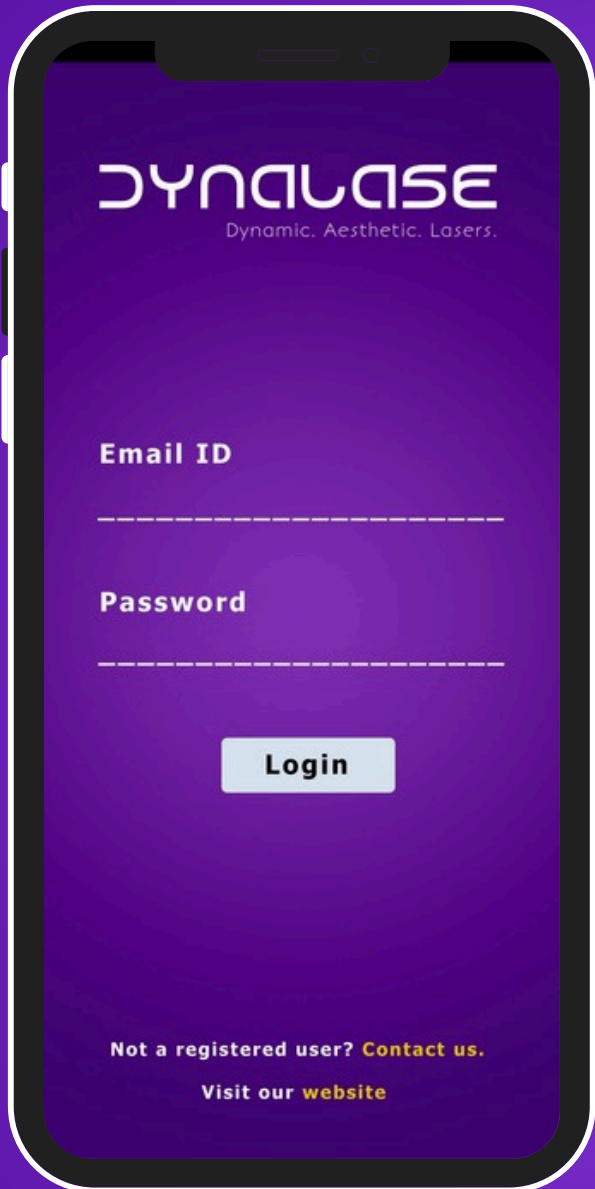

WHAT IS DYNALASE APP?

Dynalase user app is a one stop tech solution for all single point user requirements. Dynalase App is a Dynalase owned IP, completely homegrown and foreseeing a high technological future in skin/dermatology segment.

KEY FEATURES

- ◆ **Service request:** The app allows our users to call/email directly for any service requirement for the device
- ◆ **Clinical SOP:** A complete solution for documented clinical SOP for the device along with training videos for references
- ◆ **Patient data record:** Users can maintain their patient records with us, allowing a single point reference and in case of any focussed clinical case, allows our clinical team to oversee the data for better results
- ◆ **Consumable order:** Our users enjoy the privilege of ordering consumables of our devices at a rebated price
- ◆ **Marketing support:** Dynalase offers online and offline marketing inputs tailor-made for our patrons, shared and updated regularly to allow our users to keep up with the right patient communication
- ◆ **AI inputs:** AI integrations can help you collate and take gather information from global database and help you with an overall dermatology and skin specific AI support
- ◆ **Whatsapp support:** Whatsapp chat support allows you to speak with our representative at your own convenience making Dynalase app a single point of contact



Download on the
App Store



GET IT ON
Google Play

FLEXIPAY



WHAT IS FLEXIPAY?

Dynalase FlexiPay is a financial support arm for making investments with us a smooth and easy process. Designed in a meticulous way that allows you to invest with financial ease and comfort

KEY FEATURES

- ◆ **0% Downpayment:** No initial investment helps in ensuring a burden free investment for
- ◆ **Minimal paperwork:** FlexiPay can be executed with minimal documentation required to process the finance
- ◆ **Credit cards accepted:** Credit cards can now be processed for your orders with us, allowing to gain benefits from your credit line
- ◆ **Affordable price range:** The structured payment plan allows you to make the maximum utilisation of your assets
- ◆ **Instant approvals:** The approvals are instant based on your credit report, this allows quickest turnaround to start the purchase process
- ◆ **Complete financial plan:** The financial framework is catering to your investment plan and meticulous return on your investment





DYNAMOS



MICRO FILTER FOR PURE GAS DELIVERY

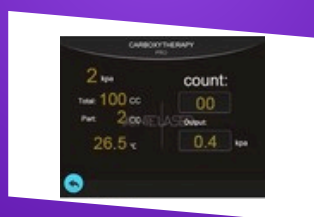

PRESSURE AND VOLUME CONTROL FOR ENHANCED RESULTS

What is DynaMOS?

Dynalase Meta Oxygenation System or DynaMOS is a carboxytherapy that involves injecting carbon dioxide gas under the skin. The treatment is believed to improve skin quality and elasticity by increasing oxygen flow to the tissue. It is used for cellulite reduction, stretch mark and scar treatment, and addressing dark under-eye circles. Carboxytherapy is generally considered safe as carbon dioxide is a naturally occurring gas in the body.

| | |
|----------------------------|---------------------------------------|
| NEEDLE TYPES | 30G x 0.5 or 27G x 0.5 needles |
| BIOSAFETY FILTER | 0.22µm |
| PRESSURE CONTROL | 0.1KPa step control |
| TEMPERATURE CONTROL | YES |
| VOLUME CONTROL | 1cc step control |
| WEIGHT | 5kgs |
| DIMENSION | 56 x 46 x 41 cms |

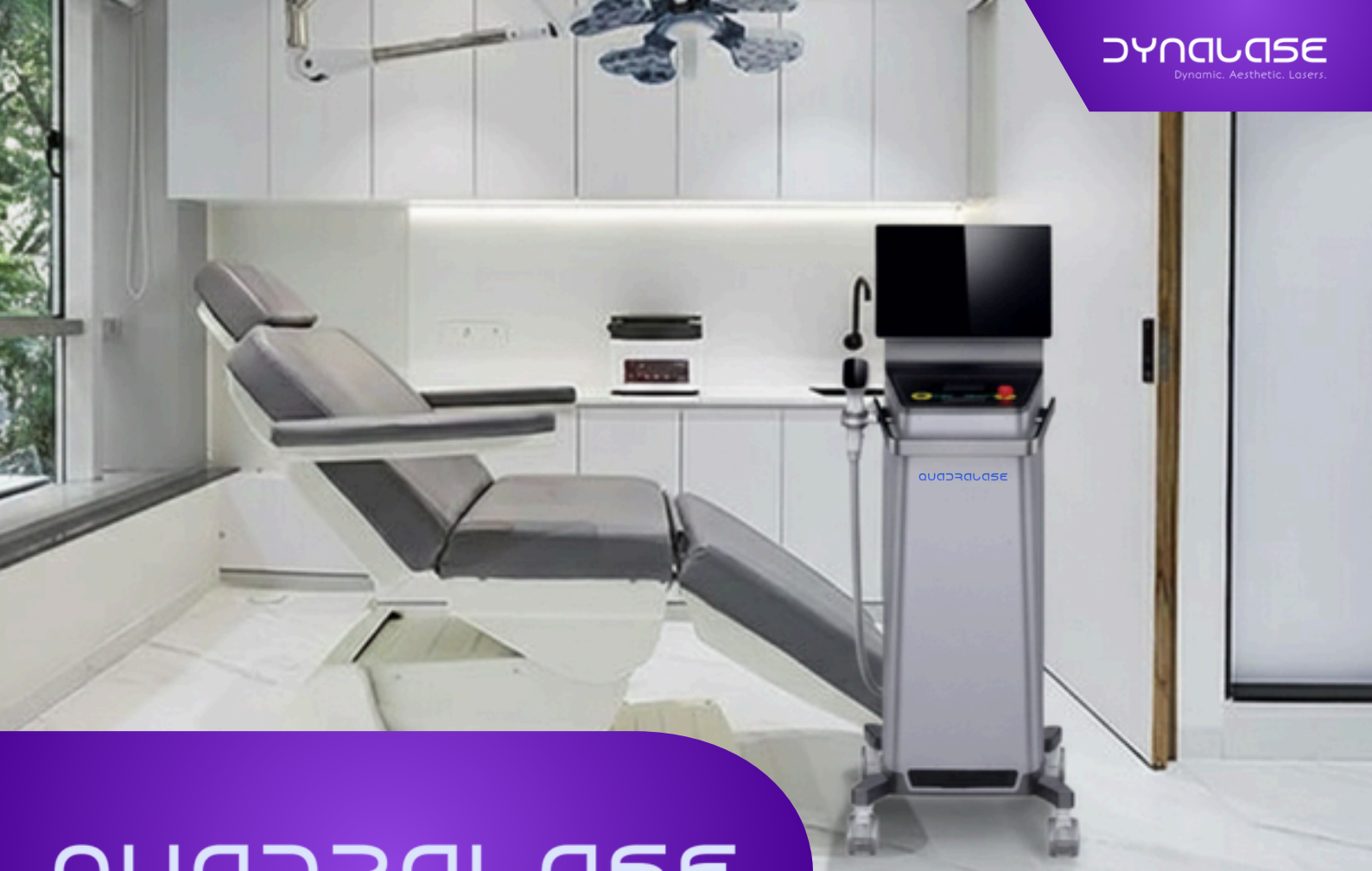

QUADRALASE



**HAND PIECE ACTIVE CONTROLLER
FOR EASY OPERATION**



**TAPERING TIP FOR SMALLER AREA
AND EYEBROW SHAPING**

What is Quadralase?

Quadralase is a 4 wavelength USFDA approved semiconductor diode laser for hair reduction. Equipped with latest technology, tapering tip and touchscreen hand piece access for easy operation and precise clinical results

| | |
|--|---|
| WAVELENGTH | 755NM, 808NM, 940NM, 1064NM |
| BAR POWER | 1600W (160W X 10 BARS) |
| OUTPUT POWER | 2500W |
| ENERGY | 2 - 100J/CM2 VARIABLE |
| PULSE WIDTH | 1 - 150MS VARIABLE |
| SPOT SIZE | 12 X 12MM AND 12 X 23MM |
| FREQUENCY | 1-10HZ |
| COOLING SYSTEM | CLOSED CYCLE WATER COOLING. WATWR, AIR AND SEMICONDUCTOR COOLING COMBINATION |
| DIMENSIONS AND WEIGHT | 110(H)*50(L)*45(W) / 57KG |
| MINIMUM CONTACT TEMPERATURE | - 10°C |



DYNAFRAC



**360° AND 90° FIRING PROBE
FOR LVT AND SUI TREATMENTS**



**50mm AND 100mm TIPS FOR
CUTTING AND COAGULATION
APPLICATION**

What is DynaFrac?

DynaFrac is a combination laser for scar management with the best of both worlds of ablative and non-ablative categories of CO2 laser and Erbium glass laser in the same unit.

| | |
|-------------------------------|--|
| WAVELENGTH | 10600nm AND 1540nm |
| LASER TYPE | RF METAL TUBE / TEMO MODE |
| POWER | 60W |
| MAX POWER INTENSITY | 75,000W / CM ² |
| RADIATION TIME | 0.011 SEC |
| CONDENSOR FOCUS LENGTH | 100 mm |
| PULSE ENERGY | 10mJ TO 100mJ FOR INDIVIDUAL SPOT |
| LASER WORKING MODE | ULTRA PULSE, FRACTIONAL, CW |
| LASER OUTPUT MODE | FRACTIONAL AND SCANNING BEAM |
| SCAN GRAPHICS | RANDOM, SEQUENCE, CONVERGENCE, DIAGONAL, EVEN/ODD |
| AIMING BEAM | 635nm |
| SCAN GRAPHICS | SQUARE, CIRCLE, RECTANGLE, TRIANGLE, LINE, CUSTOM SHAPES |
| SPOT DISTANCE | 0.12 - 1.25mm (variable) |



DYNA MIQ PRO

What is DynamiQ Pro?

The DynamiQ pro picosecond laser is a USFDA approved device equipped with best of technological elements that allow you to target pigmented lesions, tattoos and perform lightening treatments with ease and clinical supremacy



**GERMAN ARM FOR PRECISE
POWER TO TISSUE DELIVERY**



**585NM AND 650NM FOR
COLORED PIGMENTATION AND
TATTOOS**

| | |
|------------------------------|--|
| WAVELENGTH | 1064NM /532NM/585NM/650NM |
| LENS ARRAYS | FOCUSSED, FRACTIONAL (TOP HAT BEAMS) |
| PULSE DURATION | 450PS |
| ENERGY | 1500MJ FOR 1064NM 800MJ FOR 532NM 500MJ FOR 650NM AND 585NM |
| SPOT SIZE | 2-10MM ADJUSTABLE |
| FREQUENCY | 1-10HZ FOR 1064NM 1-10HZ FOR 532NM |
| ELECTRICAL POWER | 200-240VAC; 50/60 HZ |
| DIMENSIONS AND WEIGHT | 110(H)*114(L)*55(W) 155KG |
| AIMING BEAM | 635NM |



DYNAMIQ

What is DynamiQ?

The DynamiQ picosecond laser is equipped with best of technological elements that allow you to target pigmented lesions, tattoos and perform lightening treatments with ease and clinical supremacy



**KOREAN ARM FOR PRECISE
POWER TO TISSUE DELIVERY**



**585NM AND 650NM FOR
COLORED PIGMENTATION
AND TATTOOS**

| | |
|------------------------------|--|
| WAVELENGTH | 755NM/1064NM /532NM/585NM/650NM |
| LENS ARRAYS | FOCUSSED, COLLIMATED, FRACTIONAL |
| PULSE DURATION | 500PS-750PS |
| ENERGY | 2000MJ FOR 755NM, 1064NM 1000MJ FOR 532NM 500MJ FOR 650NM AND 585NM |
| SPOT SIZE | 1-10MM ADJUSTABLE |
| FREQUENCY | 1-10HZ FOR 755NM AND 1064NM 1-5HZ FOR 523NM |
| ELECTRICAL POWER | 200-240VAC; 50/60 HZ |
| DIMENSIONS AND WEIGHT | 110(H)*114(L)*55(W) 155KG |
| AIMING BEAM | 635NM |



DYNAMIQ
mini



**1064nm and
532nm TIPS**



**Fractional and
collimated tips**

What is DynamiQ mini?

The DynamiQ mini is a nanosecond laser is equipped with best of technological elements that allow you to target pigmented lesions, tattoos and perform lightening treatments with ease and clinical supremacy

| | |
|------------------------------|---------------------------------|
| WAVELENGTH | 1064nm, 532nm |
| LENS ARRAYS | FOCUSSED, FRACTIONAL |
| PULSE DURATION | 200-400ns |
| ENERGY | 2000mJ |
| SPOT SIZE | 6mm focus tip |
| FREQUENCY | 1-10Hz |
| ELECTRICAL POWER | 200-240VAC; 50/60 HZ |
| DIMENSIONS AND WEIGHT | 55(H)*60(L)*30(W) / 18KG |
| AIMING BEAM | 635NM |



CRYSTALASE

What is Crystalase?

Crystalase is a high power, high intensity microneedling RF device that comes with unique Pulsed and step-firing functions that can cater to multiple indications from dermal to epidermal levels with high accuracy.



**12PIN, 24PIN AND 40PIN
NEEDLES FOR CONVENIENT
AREA COVERAGE**

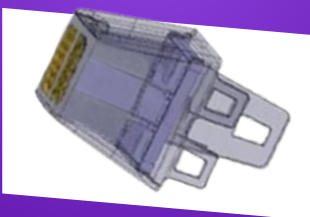

**NANO CRYSTALLINE PIN
FOR NO DOWNTIME SCAR
TREATMENT**

| NEEDLE TYPES | 12 PIN, 24 PIN, 40PIN, NANOCRYSTALLINE |
|--------------|--|
| DEPTH | 0.5-7mm |
| FREQUENCY | 4MHz |
| POWER | 10-300W |
| FIRING MODES | SINGLE PULSE, STEP PULSE |
| TOUCH SCREEN | 10.4 INCHES |
| GROSS WEIGHT | 28.5KG |



CRYSTALASE mini

What is Crystalase Mini?

Crystalase mini is a high power, high intensity microneedling RF device that comes with unique Pulse firing functions that can cater to multiple indications from dermal to epidermal levels with high accuracy.



**10PIN, 25PIN AND 64PIN
NEEDLES FOR CONVENIENT
AREA COVERAGE**



**NANO NEEDLE PIN FOR NO
DOWNTIME SCAR
TREATMENT**

| NEEDLE TYPES | 10 PIN, 25 PIN, 64PIN, NANO NEEDLE |
|--------------|------------------------------------|
| DEPTH | 0.5-4mm |
| FREQUENCY | 2MHz |
| POWER | 10-200W |
| FIRING MODES | SINGLE PULSE, COLD HAMMER |
| TOUCH SCREEN | 7.8 INCHES |
| GROSS WEIGHT | 3KG |

DYNADUO



Q SWITCH STANDARD 1064 AND 532NM TIPS WITH FRACTIONAL AND CARBON HEAD



TRIPLE WAVELENGTH LHR DIODE WITH -10°C COOLING

What is DynaDuo?

The 2 in 1 combination of triple wavelength diode and q switch at affordable pricing enables you to kickstart your derma practice with two of the highest enquired treatments in the market for LHR and pigmentation

| | |
|-----------------------|---|
| WAVELENGTH | Diode LHR: 808nm, 755nm, 1064nm Q-Switch: 1064nm, 532nm |
| ENERGY DENSITY | Diode: Maximum 100J/cm ² Q switch: Maximum 2000mJ/cm ² |
| FREQUENCY | 10Hz |
| POWER | DIODE: 2000W |
| SPOT SIZE | Diode: 15 x 20mm Q switch: 6mm focussed and defocussed |
| TOUCH SCREEN | 10.4 INCHES |
| GROSS WEIGHT | 45KG |



DYNAMIGHT

What is DynaMight?

DynaMight is a high power high intensity focussed ultrasound technology that helps in muscle targeting for lifting, firming and tightening of the face and body areas.



**7 DEPTH OPTIONS FOR
TREATING DIFFERENT FACE
AND BODY AREAS**



**EASY USE APPLICATOR FOR
QUICK FUNCTION WITH DUAL
OPERATING MODE**

| | |
|------------------------|---|
| CARTRIDGE TYPES | 1.5mm, 2mm, 3.5mm, 4.5mm, 6mm, 9mm, 13mm |
| DELIVERY MODE | Linear fractional |
| FREQUENCY | Upto 7MHz |
| POWER | 0.5-3J |
| FIRING MODES | SINGLE PULSE, REPEAT PULSE |
| TOUCH SCREEN | 10.4 INCHES |
| GROSS WEIGHT | 4.5KG |



DYNALASE



**EASY APPLICATOR FUNCTION
FOR BETTER ACCESS FOR
TREATMENT AREAS**

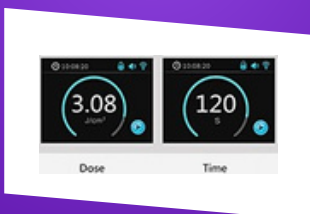

**DOSE AND TIME CONTROL
MECHANISM FOR CONTROLLED
DELIVERY**

What is Dyna308?

Dyna308 is a portable, high power stable delivery, narrowband Excimer light used to treat Vitiligo, psoriasis, Lichen planus and Alopecia Areata. Dyna308 is enabled with irradiation intensity calibration system.

| | |
|---------------------|----------------------------|
| LIGHT SOURCE | 308nm Excimer light |
| SPOT SIZE | 20cm² |
| LIFESPAN | >500 hours |
| INTENSITY | 50mW/cm² |
| WEIGHT | 12Kgs |
| TOUCH SCREEN | 8 INCHES |
| POWER SUPPLY | 250VAC / 50Hz |



DYNAMIST PRO



**HIGH INTENSITY
TRANSEPIDERMAL
INFUSIONS**



**APPLICATORS FOR CONTOURING,
SHAPING AND ULTRASONIC
CLEANSING**

What is Dynamist pro?

DynaMist Pro is a 7 in 1 combination for a complete solution for hydrated facial. The well crafted SOP for ensuring the results are immediate and lasting, makes it a desirable choice for the clinic practice

| | |
|----------------------|--|
| SERUM OPTIONS | LACTIC, SALICYLIC AND HYALURONIC ACID INFUSIONS / 96KPa PRESSURE |
| OXYJET SPRAY | DIGITALLY CONTROLLED, 20ML/40ML CAPACITY |
| ULTRASONIC BLADE | 26 - 30MHZ |
| POWER | 200W |
| RAFIOfREQUENCY | 0.2-0.5MHZ |
| EMS LIFTING | 4 x 4mm / 250µm |
| HOT/COLD HAMMER | 0° to 40° RANGE |
| OPTICAL DERMABRASION | HD RESOLUTION SIMULTANEOUS DERMABRADOR |
| MICROCURRENT | 200HZ / 50-800µA |
| WI-FI | ENABLED |
| SUCTION CONTROL | DIGITAL |
| SUCTION TIP OPTIONS | FIBRE AND SILICON |
| DISPLAY | 10.1 INCHES |



DYNAMIST



**HIGH INTENSITY
TRANSEPIDERMAL
INFUSIONS**



**APPLICATORS FOR CONTOURING,
SHAPING AND ULTRASONIC
CLEANSING**

What is Dynamist?

DynaMist is an 8 in 1 combination for a complete solution for hydrated facial. The well crafted SOP for ensuring the results are immediate and lasting, makes it a desirable choice for the clinic practice

| | |
|---------------------|---|
| SERUM OPTIONS | LACTIC, SALICYLIC AND HYALURONIC ACID INFUSIONS |
| OXYJET SPRAY | DIGITALLY CONTROLLED, 20ML/40ML CAPACITY |
| ULTRASONIC BLADE | SHEAR WAVE ULTRASONIC EXPULSION |
| ULTRASOUND INFUSION | GUIDED WAVE FOR FACE AND UNDEREYE |
| RAFIOfREQUENCY | 1.2MHZ |
| MICROCURRENT | FRENCH CURVE APPLICATOR FOR JOWLS |
| HOT/COLD HAMMER | 0° to 30° RANGE |
| POWER INPUT | 220VAC, 50HZ |
| WEIGHT | 18KGS |
| WASTE TANK | 2L CAPACITY |
| SUCTION CONTROL | ANALOG |
| SUCTION TIP OPTIONS | FIBRE AND SILICON |
| DIMENSIONS | 200cm x 60cm x 45cm |



4.2 MHZ CAUTERY



**WOODEN HANDLE TO AVOID
RESIDUAL CURRENT AND
EASY OPERATION**



**VARIABLE ATTACHMENTS FOR
EASY ACCESS AND BETTER
TREATMENT**

What is 4.2MHz Cautery?

4.2Mhz frequency of RF cautery allows a high cycle allowing a clean cut with all dermatological indications. The different attachments allow access to different contours and tags.

| | |
|------------------------------|---|
| NEEDLE TYPES | ANGULAR, CIRCULAR, SPHERICAL, STRAIGHT |
| MODES | CUT, COAGULATE, HEMO |
| FREQUENCY | 4.2MHz |
| POWER CONSUMPTION | 150W MAX |
| TYPES | MONOPOLAR |
| POWER OUTPUT | 80-120W WITH STEEPLE CONTROL |
| WEIGHT AND DIMENSIONS | 2.5KGS / 21 X 26 X 24 cms |



DYNADVIEW



**3D SKIN STRUCTURE
WITH SPATIAL VIEW**



**FACE FILTERS WITH EDGE
DETECTION , MOISTURE AND
PORE ANALYSIS**

What is DynaView?

DynaView is an AI powered skin analyzer with advance 3D mapping features to report skin attributes and give a complete analysis with various onboarded filters and image processing tools

| | |
|----------------------|----------------------------|
| RAM | 6GB |
| STORAGE | 64GB |
| RESOLUTION | 2800MP |
| SYSTEM | ANDROID |
| CPU | E3950 |
| SCREEN | 11.6 inches |
| RATED CURRENT | 0.8A |
| SHARING | BLUETOOTH, INTERNET |
| WEIGHT | 7KGS |

DYNALASE

Dynamic. Aesthetic. Lasers.



Call Now.

+91 9768634974



www.dynalase.com

hello@dynalase.com



S-07-48, 2nd floor, Haware's
Centurion Mall, Plot 88 to 91,
Sector - 19A, Nerul East, Navi
Mumbai - 400706