SIXTH GLOBAL SUMMIT ON

SPIRITUALITY, RELIGION & MENTAL HEALTH

MAY 14–15, 2026

Joseph B. Martin Conference Center · Boston, Massachusetts, USA

▪ **PSYCHIATRY**

▪ **PSYCHOLOGY**

▪ **CHAPLAINCY & FAITH
LEADERSHIP**



**WORLD
PSYCHIATRIC
ASSOCIATION**



Society for the
Psychology of Religion and Spirituality
Division 36

CONTENTS

1 Welcome from the Summit Chairs

2 Sponsors & Hosts

3 Summit Schedule

16 Site Map

18 Local Information

19 Allied Programming

20 Organizing Committees

23 Feedback Form

• **Need help?** Look for a volunteer wearing a yellow lanyard.

Dear Colleagues and Friends,

Welcome to the 6th Global Summit on Spirituality, Religion & Mental Health!

It is our great pleasure to welcome you to Boston – among hundreds of other attendees from over 20 countries around the world. This remarkable international gathering reflects a shared recognition that spirituality and/or religion are essential dimensions of human experience and deserve thoughtful integration into mental health research, clinical care, and public discourse.

Officially co-sponsored by the World Psychiatric Association (WPA), this Summit is the sixth global conference in the field of spirituality/religion and mental health that the WPA Section on Religion, Spirituality and Psychiatry has hosted. Over the years, these global conferences have fostered a global community dedicated to advancing rigorous science, meaningful dialogue, and culturally responsive care.

The year 2026 marks an important step forward for this global conference – in that interdisciplinary collaborations have been significantly strengthened through partnerships with the American Psychological Association's Society for the Psychology of Religion and Spirituality (Division 36), and the Harvard Initiative on Health, Spirituality & Religion. Together with other our sponsors – including the LINKS Network, John Templeton Foundation, American Psychiatric Association Foundation, Divine Mercy University, Association for Clinical Pastoral Education (ACPE), and the Solihden Institute – this broader coalition reflects growing engagement across disciplines and professional communities, strengthening our shared mission to bring spirituality into mainstream mental health practice.

We are grateful to our distinguished plenary speakers and presenters for their leadership in advancing the field. Special thanks go to members of the International Organizing Committee, Scientific Committee (especially the Co-Chairs, Dr. Alexander Moreira-Almeida and Esther Kim), Local Organizing Committee (especially Charlotte McAdams), and the team of volunteers – who have made the Summit possible. We are especially excited in having numerous trainee attendees from multiple disciplines across the globe – they are the future torchbearers of this field, bringing the fresh perspectives pivotal to our continued advancement. Last but not least, we are grateful to McLean Hospital, a major affiliate of Harvard Medical School, for their significant support.

Above all, we thank you, our colleagues, for being part of this global effort. Your presence reflects a commitment not only to scientific excellence, but also to understanding the deeper dimensions of human life that shape resilience, meaning, and healing. We hope this Summit fosters new ideas, meaningful collaborations, and lasting connections.

Warm regards,

Alan Fung, MD, ScD, FRCPC, DFAPA
Co-Chair (Psychiatry), 6th Global Summit on Spirituality, Religion & Mental Health
Chair, WPA Section on Religion, Spirituality and Psychiatry

David H. Rosmarin, PhD
Co-Chair (Psychology), 6th Global Summit on Spirituality, Religion & Mental Health
Director, Spirituality & Mental Health Program, McLean Hospital/Harvard Medical School

THANK YOU TO OUR HOSTS & SPONSORS



NORMS OF ENGAGEMENT

The 6th Global Summit on Spirituality, Religion, and Mental Health brings together scholars, clinicians, faith leaders, and practitioners from across disciplines and around the world. The richness of this gathering depends on our collective commitment to respectful, open, and generative dialogue.

Engage with curiosity. The Summit will host a wide range of perspectives, beliefs, and professional viewpoints. Disagreement is a natural and valuable part of intellectual exchange. We ask that you enter conversations with a spirit of curiosity, even when your views differ.

Respect the space and the schedule. Please silence your devices during sessions, be mindful of others when entering or exiting a room, and honor the time allotted to speakers and presenters.

Connect with us. If at any point you feel uncomfortable, witness behavior that concerns you, or have a question or issue that needs attention, please approach any volunteer wearing a yellow lanyard. They are here to help and will connect you with the appropriate person.

We trust that the spirit of this Summit, one of learning and shared purpose, will guide how we treat one another. In the rare event that an attendee's behavior is disruptive to the experience of others, they may be asked to leave the session or the event.

Thank you for being part of this community and building this experience alongside us.

Schedule

6th Global Summit on Spirituality, Religion, and Mental Health

May 14-15, 2026

Joseph B. Martin Conference Center

Boston, Massachusetts

Color Key:

PSYCHIATRY

PSYCHOLOGY

CHAPLAINCY / FAITH LEADERSHIP

DAY 1

Thursday, May 14, 2026

Joseph B. Martin Conference Center, Boston, MA

8:00-8:40 AM	Registration & Badge Pick-up Lobby
8:40-9:00 AM	Spiritual Offering & Opening Remarks <i>Angelika Zollfrank · David H. Rosmarin · Alan Fung</i> Amphitheater
9:00-9:50 AM	Spirituality and Psychiatry: Challenges and Perspectives - Insights from Global Leaders <i>Alan Fung · Thomas Schulze · Paul Summergard · Alexander Moreira-Almeida</i>

10:00-10:50 AM BREAKOUT SESSION 1

Amphitheater	Panel: Integrating Spirituality into Clinical Practice: Evidence-Based Approaches for the Modern Psychiatrist <i>Marc Potenza · Helen Lavretsky · Calvin Chatlos · Anna Yusim</i>
Room 214	Panel: When Faith and OCD Collide: Interdisciplinary Care for Scrupulosity <i>Katie O'Dunne · Leslie Shapiro · Emily Bailey · Michelle Witkin · Kaiser Aslam</i>
Room 216	P1: Personality and Demographic Correlates of Clinician Orientation Toward Spiritually Integrated Care <i>Brien Culhane</i> P2: Minding God and Meaning in Life: A Clinical-Theoretical Integration of Psychology of Religion and Evidence-Based Psychotherapy for Personality Disorders <i>Brandon Unruh · Angelika Zollfrank · Nathan van der Velde</i>
Room 217	P1: Out-of-Body Experiences and Mental Health: Rethinking Pathology, Meaning, and Spiritual Transformation <i>Marina Weiler · Martin Monti · Alexander Moreira-Almeida</i> P2: Visitation, Memory, and Journey: How Extraordinary Experiences around the Life/Death Boundary Can Affect Existential Beliefs and Mental Health <i>Julie Exline</i>
Bray Room	P1: Scientific Exploration of Life After Death <i>Alexander Moreira-Almeida</i> P2: Charting New Pathways in Global Mental Health: Developing a Spiritually Integrated Interpersonal Psychotherapy (IPT-S) Model for Primary Care in Brazil <i>Bruno Paz Mosqueiro · Marcelo Fleck</i>

Pechet Room **Panel: End-of-Life Mental States: A Phenomenological and Neurobiological Comparative Analysis Through the Brain Filter Theory**
Tais Oliveira Silva · Henrique Goncalves Ribeiro · Marianna de Abreu Costa

11:00-11:50 AM BREAKOUT SESSION 2

Amphitheater **P1: Practicing Pluralism: A Framework for Engaging Religious/Spiritual Identity as a Determinant of Mental Health**
Suzanne Henderson

P2: Building Bridges, Restoring Trust: Enhancing Collaboration Between Spiritual Leaders and Mental Health Professionals through a Psychospiritual Care Competency Training Program
Andrew Sharp · Hannah Bayne

Room 214 **P1: Equipping Faith Communities to Address Mental Health Concerns**
Ben Odell

P2: Spiritual Struggle in Community Mental Health: Relationships to Symptoms and Attachment
Cheri Marmarosh · Suzanne Hollman

Room 216 **P1: Faith, Culture, and Diversity: Spiritual Expressions in the Brazilian Population and Global Relevance**
Juliana Megale · Mario Peres

P2: Coping With Religiosity in Clinical Contexts: Perceptions and Experiences of Psychotherapists
Alexander Moreira-Almeida

Room 217 **P1: The Impact of Religiosity on the Quality of Life of Psychotic Patients During Psychiatric Hospitalization**
Joao Antonio Fortunatti · Paulo Henrique Goncalves Dutra · Marianna Costa · Neusa Sica da Rocha

P2: Psychiatry and Religion: Knowledge Gap and Conceptual Competences
Peter J. Verhagen

Bray Room **Panel: The Science of Contemplation: Pathways of Healing and Transformation**
Jesse Fox · Daniel Gutierrez · Stephanie Dorais · Joseph Currier · Esther Kim

Pechet Room **Panel: Psyche Iatria, Spirit Medicine, in Brazil's Spiritual Cauldron**
Sidney Greenfield · Ottorino Bonvini · Vitor Pordeus · Vitor Nina de Lima

Lunch & Affinity Group Meetings

12:00-12:50 PM
 Meals available in the lobby

Students & Trainees (Hosted by APA Division 36 Student Committee)
Bray Room

Psychologists (Hosted by APA Division 36)
Lobby

Psychiatrists (Hosted by WPA Section on Religion, Spirituality & Psychiatry)
Pechet Room

Faith Leaders & Chaplains
2nd Floor Lounge

1:00-1:50 PM

BREAKOUT SESSION 3**Amphitheater****Panel:Religion, Spirituality and Faith in Mental Health: Collaborative Lived Experiences of Clergy, Clinicians and People Who Engage Care***Glen Milstein · Alan Fung · Eric Brown · Agatha Chong · Sarah Eagger · Amy Porfiri***Pechet Room****P1:Integrating Religious and Spiritual Concerns in Psychotherapy Process***Kristin Hansen · P. Scott Richards***P2:Training Therapists in Spiritual and Religious Competency: Outcomes from a Case-Based Evaluation Framework***Jennifer Ripley · Zhuo Job Chen · Logan Battaglini · Sarah Haught · James Sells***Room 216****P1:Chaplain as Accomplice: Lessons from Abolitionist, Disability Justice, and Mad Movements***Cyrus Jordan · Caitlin Kim***P2:The Role of a Solo Chaplain in a Freestanding Behavioral Health Hospital: Lessons Learned and Illustrative Case Studies***Jo Hirschmann · Eva Bogino · Carisa Kymissis***Room 217****P1:Psychology of Religion and Spirituality in Jewish Contexts: A Synthetic Review of New Considerations for a Minority Religion***Laura Stein · Steven Sandage***P2:'Free to be me' - Freedom from Suffering: A Treatment Protocol for Mental Wellness***Lana Tiersky · Zalman Abraham***Bray Room****Panel:Beyond Pathology - Religion/Spirituality as a Catalyst for Flourishing and Wellbeing***Crystal Park · Patty Van Cappellen · Amy Wachholtz · Matthew Lee · Ward Davis · Jenna Faith McClear · Megan Edwards***Room 214****Panel:Guidelines on Clinical Approaches to Past-Life Memory Claims***Eric Avila-Pires · Marieta Pehlivanova*

2:00-2:50 PM

Poster Session

Lobby

3:00-3:50 PM

BREAKOUT SESSION 4

Amphitheater

P1: From Anomalous Experiences to a Non-Materialist Psychology: C. G. Jung's Contribution

Pedro Resende · Anahy Fonseca · Angelica Oliveira · Lionel Corbett

P2: Do Different Types of Religious Cognition Relate Differently to Mental Health? How to Compare Religious 'Beliefs' to 'Beliefless' Alternatives

T. Ryan Byerly · Laura Ekstrom · Julie Exline · Daniel Howard-Snyder · Elizabeth Jackson · Jonathan Jong · Shieva Kleinschmidt · Elizabeth Krumrei-Mancuso · Daniel McKaughan

Room 214

Panel: Going Beyond the Pathological - New Avenues in the Study of Anomalous or Non-Ordinary Experiences and Mental Health

Everton Maraldi · Amanda Cafezeiro

Room 216

P1: Reconciliation With God as a Pathway to Spiritual and Psychological Health: Development and Cross-Cultural Validation of the Reconciliation with God Scale (RWGS)

Kaye V. Cook · Carmen Callizo · Ni Made Taganing Kurniati · Patrick Nyamaruze · Zuhail Agilkaya Sahin · Maria Calatrava · Martino Rodriguez-Gonzalez · Katelyn N. G. Long · Tyler J. VanderWeele · Richard G. Cowden

P2: Integrating Religion and Spirituality in Spanish-Speaking Populations: Competencies, Clinical Care, and Identity Formation

Ezequiel Cruz-Gutierrez · Maria Cristina Cruza-Guet · Humberto Cruz-Esparra · Yenny Delgado · Orlando Pagan-Torres

Room 217

P1: Coherence-Based Clinical Innovation: Integrating Spirituality, Neurocardiology, and Expressive Healing in Mental Health Care

Katelyn Lehman

P2: ADAPT-FAITH(TM): Bridging Spirituality and Mental Health Through Meaning-Making, Purpose and Cognitive Reframing

Tiwalola Osunfisan

Bray Room

Panel: Radical Empiricism Exploring Spiritual Experiences - The Experience of NUPES/UFJF

Alexander Moreira-Almeida · Caio S. Almeida · Eric V. A. Pires · Marianna A. Costa · Tais O. Silva · Victoria A. S. Almeida

4:00-4:50 PM

Charting the Future of Spirituality, Religion, and Mental Health

David H. Rosmarin

Amphitheater

5:00-6:00 PM

Welcome Reception

Lobby

Friday, May 15, 2026

Joseph B. Martin Conference Center, Boston, MA

8:00-9:00 AM	Registration & Badge Pick-up Lobby
9:00-9:50 AM Amphitheater	Spiritual Offering I <i>Rabbi Avi Bukiet</i> Opening Remarks I <i>Maurizio Fava</i> Keynote: The Role of Faith Communities in Supporting Mental Health I <i>Ben O'Dell</i>

10:00-10:50 AM BREAKOUT SESSION 1

Amphitheater	Panel: Collaborating With Spiritual Leaders Across the Care Spectrum: Innovations From Inpatient Psychiatry and Community Mental Health <i>Angelika Zollfrank · David Sutton · Mary Wessel · Rick Peter · Fritz Wolthusen</i>
Room 214	P1: When Faith Delays Healing: Introducing the Bishri Hafi Effect as a Psycho-Spiritual Barrier in Addiction Counseling <i>Hasan Kaplan · Nihal Isbilen · Ali Ulvi Mehmedoglu</i> P2: The Role of Religiosity and Spirituality in Suicidal Behavior: Findings from a Multicenter Study in Brazil <i>Victoria A. S. de Almeida · Ana Luisa Barquette · Isis Terzi · Gabriela Santos · Augusto Shintani · Alexander Moreira-Almeida · Ives Cavalcante Passos</i>
Room 216	P1: Meaning-Centered Approaches in Mental Health Care: Impact Across Psychiatry, Academia, Innovation, and Community <i>Rodrigo Bravo · Anna Yusim · Chris Pittenger · Chris Koenemann</i> P2: Human Dignity, Meaning, and Mental Health Across the Life Span: Baha'i-Inspired Perspectives from Psychiatry, Psychotherapy, and Pediatrics <i>Hamid Peseschkian · Muni N. Tahzib</i>
Room 217	P1: Healing through Writing <i>Linyan Zheng</i> P2: Grace and Flourishing: Theological Contributions to Frameworks in Spirituality and Mental Health <i>Edwin Odhiambo</i>
Bray Room	Panel: Psychedelics at the Intersection of Spirituality, Religion, and Mental Health <i>Roman Palitsky · Zac Kamenetz · Deanna M. Kaplan · Ali John Zarrabi</i>
Pechet Room	Panel: Spiritual/Religious Struggle, Coping, and Deidentification: Impact on Mental Health and Clinical Relevance <i>Ann Marie Yali · Julie Exline · Jessica Peters · Yehudis Keller · Crystal Park · Yossi David · Mariel Emrich</i>

11:00-11:50 AM

BREAKOUT SESSION 2

Amphitheater

Panel: Spiritual Competency Training in Mental Health Professions - A State-of-the-Art Overview in 2026*Alan Fung · Glen Milstein · Francis Lu · John Peteet · Alexander Moreira-Almeida*

Room 214

P1: Qualitative Insights into Religious Exits Using the Relational Spirituality Framework*Lindsey Chou · Jesse Ojeda · Annette Mahoney***P2: Spiritual, Existential, Religious, and Theological Concerns in Couple Therapy: A Relational Spirituality Approach***Sarah Crabtree · Judith Gerstenblith · Lauren Zaeske*

Room 216

P1: Religion and Spirituality in Integrated Perinatal Care: Associations with Psychiatric and Obstetric Outcomes in a High-Risk Sample*Micheline Anderson · Mallory Go***P2: Faith, Stress, and Coping: Understanding Mental Health in Families Experiencing Complex Pregnancies***Gina Brelsford · Jennifer Stoner · Patrick Possel*

Room 217

P1: Spirituality and Meaning in the Transplant Journey: Patients' Perspectives*Karin Posegger · Marcelo Linhares · Jose Medina Pestana***P2: Essence Breathing: An Integrative Meditation for Pain Alleviation and Curtailing Tension (EB-IMPACT) in a Biopsychospiritual Framework***Chrysantha Davis · Kevin Masters · Krista Ranby · Amy Wachholtz*

Bray Room

P1: Global and Local Partnerships with the Catholic Church to Address the Mental Health Crisis*Victor Pereira-Sanchez***P2: Human Beings as a 'Mine Rich in Gems': Clinical Insights from Positive Psychotherapy and Baha'i Perspectives on Human Nature and Mental Health***Hamid Peseschkian*

Pechet Room

P1: The Relationship Is the Intervention: Psychodynamic Informed Approaches to Ambulatory and Digital Spiritual Care*Alex Beth Schapiro · Joe Chapman***P2: Sacred Encounters: Systems-Centered Existential Care as Decolonial Praxis***Anthony Cruz Pantojas*

12:00-12:50 PM

Lunch served in the Lobby I Optional discussion groups in breakout spaces

Discussion Groups

- New frontiers in mental health chaplaincy (hosted by the Transforming Chaplaincy Mental Health Research Network) | Room 214
- Scientific investigation of spiritual experiences led by Dr. Alexander Moreira-Almeida | Room 216
- Collaborations between mental health professionals and faith communities | Room 217
- The role of spirituality in child and adolescent mental health | Bray Room
- Spiritually-integrated psychotherapies and other mental health treatments | Pechet Room
- Career development in spirituality/religion and psychiatry for psychiatric trainees and early career psychiatrists | Elements cafe dining area

1:00-1:50 PM

BREAKOUT SESSION 3

Amphitheater

P1: Religion and Spirituality Committees in Child and Adolescent Psychiatry Guilds: The AACAP Experience, 25+ Years and Going Strong

Mary Lynn Dell · Kelly Hill · Margaret Stuber

P2: Investigation of Anomalous Experiences from the Perspective of Carl Gustav Jung's Complex Psychology

Anahy Fagundes Dias Fonseca · Carolina Fagundes Dias Fonseca · Angelica Salatino de Oliveira · Pedro Henrique Costa de Resende

Room 214

P1: Inclusivity Myth and Fragile Reality: A Case-Based Study of Interfaith Spiritual Care in American Hospitals

Hatice Koc Kanca

P2: The Connection Between Religious and Spiritual Struggle (R/S Struggle) and Depression and Anxiety in Adolescents Admitted to Inpatient Psychiatry Units

Salvador Leavitt-Alcantara

Room 216

P1: Stressors, Religion and Spirituality, and Sleep Quality

Eric Shattuck · Leela McKinnon · Christopher Ellison · Bradley Wright

P2: Honoring Inner Experiences at Life's End: Validating Dreams and Visions to Support Mental Health

Tais Oliveira Silva · Kathryn Levy · Christopher Kerr

Room 217

P1: Research-Based Insights for Cultural Competence and Resilience-Building: Identity, Relationships, and Mental Health of Jehovah's Witnesses

Donna Couper · Gerhard Besier · Valens N Kurikiyinka

P2: The Armenian Revival Journey: A Psycho-Spiritual Model for Recovering from the Individual Consequences of Collective Trauma

Hovhannes Nikoghosyan · Nazeli Kirakosyan

Bray Room

P1: Muslim Lived Experiences with Psychedelics: A Mixed Methods Study of Understanding and Integration

Zainab Salako · Fayzan Rab · Salman Shaheen Ahmed · Anusha Kak · Layla Dhabaan · Janvi Choksi · Roman Palitsky

P2: Spirituality and Harmful or Hazardous Alcohol and Other Drug Use: A Meta-Analysis of Longitudinal Studies

Howard K. Koh · Donald E. Frederick · Tracy A. Balboni · Samantha M. O'Reilly · John F. Kelly · Keith Humphreys · Michael Botticelli · Maya B. Mathur · Constantine S. Psimopoulos · Katelyn N. G. Long · Tyler J. VanderWeele

Pechet Room

P1: Adverse Childhood Experiences, Religious Coping, and Congregational Support Among Clergy and Religious Leaders

Eric Brown

P2: Contemplation, A Long Loving Look at the Real: How Christian Contemplation Informs Psychological Wellbeing through Lectio Divina

Jesse Fox

2:00-2:50 PM

Poster Session

Lobby

3:00-3:50 PM

BREAKOUT SESSION 4

Amphitheater

Panel: The 2024 DSM-5-TR Z Code 'Moral, Religious, or Spiritual Problem': What is New

Francis Lu · James Griffith · John Peteet

Room 214

P1: Religion, Spirituality, and Mental Health: A Systematic Review of Evidence from Attachment Theory and the Psychology of Religion

Emily Purcell · Daniel Waldheim · Wen Ting Cheong · Benjamin Doan · Victor Counted

P2: Perceived Threat To Life, Anxiety, and Depression: Does Hope Buffer Psychological Distress Across 22 Countries?

David Netz · Daniel Waldheim · Benjamin Doan · Emily Purcell · Charlotte Cheong · Victor Counted

Room 216

P1: The Psychology of Sacred Rest: Shabbat's Effects in Experimental Studies and in the Wake of Collective Trauma

Aaron D. Cherniak · Pehr Granqvist · Mario Mikulincer

P2: Research Study on How People Integrate Challenging Spiritual Experiences: Integration of Spiritually Transformative Experiences Inventory (ISTEI)

Marie Grace Brook

Room 217

P1: Reframing Mental Health Through the Chakra System: A Hindu Philosophical Framework for Integrating Spirituality and Psychological Care

Himabindu Lanka · Witek Nowosiad

P2: Pentecostal Humanism amid Humanistic Spiritual Care in Hospital Chaplaincy: A Foray for a Model

L. William (Bill) Oliverio

Bray Room

P1: Reframing the Caregiver Experience Beyond the Medical Model

Hannah Rachiele · Kathryn Levy

P2: Inedia in Humans: A Case Report of a Brazilian Woman With Six Decades of Claimed Food, Water, and Sleep Abstinence

Alexander Moreira-Almeida · Caio Silva de Almeida · Julio Maria Fonseca Chebli

Pechet Room

Panel: When Organized Religion is Harmful or Simply Not Working: Mental Health Perspectives on Adverse Religious/Spiritual Experiences, Religious Deidentification, and Self-Determination

Yehudis Keller · Rebekah Monroe · Bridger Lisonbee · Joel Engelman · Julie Exline · William O'Brien · Kenneth Pargament · Sam Hardy · Daryl Van Tongeren

4:00-4:50 PM

BREAKOUT SESSION 5

Amphitheater

P1: Mapping Recovery: Insights into Existential and Clinical Dimensions from Network Analyses on Religion, Spirituality, and Mental Health in the Netherlands

Hanneke Schaap-Jonker · Marieke van der Maten-Abbink · Bart van den Brink

Room 216

P1: Psychological Distress, Spiritual Well-Being, Quality of Life, and Spiritual Care Needs in Irritable Bowel Syndrome (IBS): Implications for Holistic and Integrative Health Care

Sema Yilmaz · Hilmi Ataseven · Engin Altinkaya · Mehmet Yildiz · Elif Alici Biyik

P2: The 100-Year Background and Current Status of Spiritual Counseling and Guidance Services Officially Offered by the Presidency of Religious Affairs in Turkiye

Sevde Duzguner

Room 217

P1: Neuroscience and Logotherapy in Dialogue: Theoretical Contributions to Mental Health and Spiritual Care among U.S. Military Chaplains

Antonio de Jesus Silveira Leite · Hamilton Matheus Moreira Ribeiro

P2: Integrative Chaplaincy Training Programs in the US Veterans Health Administration: Innovative Integration of Spiritual and Mental Health Care

Jennifer Wortmann · James Cooke · Jason Nieuwsma · Keith Meador

Bray Room

Panel: Legacy as Spiritually-Integrated Pediatric Psychosocial Care

Amanda Borchik · Jessika Boles · Amanda Thompson

Pechet Room

P1: Specialized Mental Health Clinical Pastoral Education: A Program to Address the Need for Mental Health Competencies in Spiritual and Religious Leaders

Angelika A. Zollfrank

P2: Introduction to the SOUL (Science of Unitive Love)

John Calvin Chatlos

5:00-5:30 PM

Closing Remarks

David H Rosmarin · Alan Fung

Amphitheater

POSTER PRESENTATIONS

DAY 1 POSTER SESSION

Thursday, May 14, 2026 · 2:00 PM · Lobby

- Thursday, May 14, 2026 · 2:00 PM · Lobby
- 01 Religious Coping as a Moderator Between Cognitive Reserve and Mental Health in Older Adults**
EmilyPurcell · KarinGeerdes · KimberleyCoddington
 - 02 Pseudoscience or Spiritual Practice? Reframing Astrology through a Spiritual, Ethical, and Multicultural Lens**
ShannonBrowning
 - 03 Are Certain Types of Moral Transgressions More Egregious Than Others?**
JasonKwan · CrystalPark · ZacharyMagin · JoshuaWilt
 - 04 Spiritual but Not Religious? Identity Differences in Mystical Experience, Interconnectedness, and Relational Self-Construal**
ChristianIshak · EmilyMeyer
 - 05 Early-Life Predictors of Experiencing Divine Punishment in Adulthood Across 22 Countries**
Richard G.Cowden · JunitaHenry · CooperHarris · KathrynA.Johnson · BrendanCase · R.NoahPadgett · Byron R. Johnson · Tyler J. VanderWeele
 - 06 Beyond Talk Therapy for Bereavement: A Case Study on Therapeutic Alliance Enhancement through Nonverbal Engagement and Spiritually Aligned Care**
RodrigoBravo · AlexandraBravo
 - 07 Impact of Christian Nationalist Beliefs on Out-Group Aggression: A Longitudinal Proposal**
JesseOjeda · LindseyChou · ChristianIshak · AvivaSatz-Kojis · EmilyMeyer
 - 08 Spirituality and Psychological Well-being: A Cross-Cultural Research Study**
Timothy Smith
 - 09 Between Two Worlds: Acculturation, Enculturation, and the Self in the Disaffiliation from Ultra Orthodox Judaism**
GittyGordon · EliTarlow · PhilipS.Wong · SaraChiaraHaden · MatthewJ.Morrison
 - 10 Assessing Medium-Term Effects of an Intervention to Promote Flourishing and Spirituality in Depression**
JulianeGoncalves · WillyaneAlvarenga · GiancarloLucchetti · HomeroVallada
 - 11 Religiosity and Spirituality in Coping with Suicide Grief: A Review**
VictoriaAlexandreSilvadeAlmeida · AugustoOssamuShintani · PedritaReis Vargas · Ives Cavalcante Passos · Alexander Moreira-Almeida
 - 12 Do Not Forget the Spirit: Exploring Pastoral Care Pedagogies in Medical Education**
Audrey Zhou
 - 13 The Spiritual Fitness Protocol: A Paradigm to Strengthen Your Spirit**
J. Philip Antinone
 - 14 The Theo-Bio-Psycho-Social Relational Model of Flourishing in Christ: Integrating Biblical Christian Theology with Positive Psychology**
WilliamStallard
 - 15 Integrating Spiritual Care into Behavioral Health: Practical Approaches and Outcomes from Hospital-Based Chaplaincy at Riverside Methodist Hospital**
YollandeYambo
 - 16 The Pancha Kosha Model (Five Sheaths of Human Existence) as a Holistic Spiritual Assessment Tool in Pediatric and Family-Centered Healthcare**
HimabinduLanka · WitekNowosiad
 - 17 My Help for the Helpers: Translating Spirituality and Mental Health into Sustainable Care**
Minister Robert Wiseman
 - 18 A Qualitative Pilot Study Exploring Spiritual Care within Public State Psychiatric Hospitals**
LauriSwann · GeorgeFitchett
 - 19 Incorporating a Biopsychosocial Spiritual Model of Care into Psychiatry for Underserved Populations**
KavitaPrasad

-
- 20 **From Fear to Meaning: The Psychosocial Dynamics of Non-Ordinary Experiences Across the Lifespan**
EvertonMaraldi · MariaEduardaElpidio · AnaLuciaCunha · AmandaCafezeiro · RicardoOliveira-Souza · JorgeMoll
-
- 21 **Bridging Psychiatry, Spirituality, and Lived Experience: Lessons from a Community-Based Model of Resilience**
RouidaSiddiqui · AliSyed
-
- 22 **Acute Effects of Personal Prayer on Pressure Pain Thresholds in Adults with and without Migraine: A Randomized Single-Blind Crossover Study**
GeorgiaWestenhofen · GiancarloLucchetti · GianlucaCoppola · HomeroVallada · IdaFortini · MarioF.P.Peres
-
- 23 **Belief Modification as a Clinical Mechanism of Action in Spirituality-Informed Medicine: A Theoretical and Philosophical Perspective**
Rodrigo Bravo
-
- 24 **Uncanny Coincidences and Telepathic Dreams: Integrating Spirituality, Intuition, and Synchronicity into Psychiatric Clinical Practice**
Anna Yusim
-
- 25 **Electroencephalogram-Informed Exploration of Self-Transcendence in Empathic Listening Assessment and Care: A Collaborative Study by Psychiatrists and Chaplains**
Parameshwaran Ramakrishnan
-
- 26 **Development of Spiritual and Religious Competencies from a Global Perspective: A Feasibility Study of the SPIRIT Protocol in the Context of Brazilian Psychiatric Hospitalizations**
MariannaCosta · BrunoMosqueiro · NeusaRocha
-
- 27 **Toward an Evidence-Based Chaplaincy Informed Spiritual Psychiatry Fellowship: EEG Validated Empathic Listening**
PaulBenz · ParameshwaranRamakrishnan
-
- 28 **Prevalence of Depression: Spirituality as a Protective Factor in Rio Grande Do Sul after the 2024 Floods**
PauloHenriqueDutra · JoaoAntonioFortunatti · MariannaCosta · NeusaRocha
-
- 29 **The Farbrengen: A Psychodynamic Group Therapy with Song and Meaning**
ZalmanAbraham
-
- 30 **The Theatre of Death: Visionary Experience, Trauma, and Spiritual Transformation**
Jesus Quintero

DAY 2 POSTER SESSION

Friday, May 15, 2026 · 2:00 PM · Lobby

-
- 31 **Religion and Spirituality's Roles in Queer Lives: Well-Being, Distress, and Reconciliation**
Tatianna Dugue
-
- 32 **Balancing Help and Harm: The Dual Influence of Religion on Mental Health**
Ashlyn Mildenhall
-
- 33 **Treating Religious OCD/Scrupulosity: Integrating Acceptance and Commitment Therapy and Restoration Therapy**
Bonnie Young
-
- 34 **Spiritual Intelligence: A New Frontier**
AzinNasseri
-
- 35 **Attention, Enlightenment, Cure**
Coryna Ogunseitán
-
- 36 **Beyond Fortune-Telling: Tarot's Evidence-Based Role in Psychological Exploration**
Emily McGill
-
- 37 **Minimizing Burnout for School Mental Health Professionals: The Spirituality-Based Self-Care Model**
IndyHurunEin · UbaidillahMarsan
-
- 38 **Spiritual Intimacy and Relationship Satisfaction: A Systematic Review with Meta-Analytic Synthesis**
AvivaSatz-Kojis · EmilyMeyer · HannahThomson
-
- 39 **Dimensions of Religiosity Predict Flourishing in Religiously Affiliated Adults in Puerto Rico**
MariaF.Fernandez-Velez · IsisCollazo-Rivera · OrlandoM.Pagan-Torres
-
- 40 **Spirituality, Emotional Regulation, and Mental Health: A Theoretical-Practical Reflection**
JulioCezarAdam · ClairtonPuntel · ChristianHaagKristensen

-
- 41 **Existential Well-Being Buffers Distress Linked to Ambivalence Among Asian Indian Americans**
Monson Varghese
-
- 42 **Character Strengths in Pope Francis' Speeches to Young People: A Positive Psychology Analysis**
AlmirBrito · JonasCury
-
- 43 **Islamic Religiosity Dimensions and the University Stress-Depression Relationship: Evidence for a Protective Role of Religious Exclusivity**
LinaChihoub · NeshwaRajeh · RaniaAwaad
-
- 44 **Divine Coping After Religious Exit: Associations with Psychological Adjustment in ex-Evangelical Christians**
JesseOjeda · AnnetteMahoney
-
- 45 **Spiritual Stories: Evaluation of a Novel Protocol in an Acute Psychiatric Setting**
Angelika A. Zollfrank
-
- 46 **Curvilinear Associations Between Salvation Beliefs and Mental Health: Implications for Chaplaincy and Spiritually Integrated Care**
CindySmith · NiyeliHerrera · TimSmith
-
- 47 **Barriers and Facilitators to Spiritual Care Integration in the Veterans Health Administration**
TimothyUsset · AnneKlee · SophiaFantus · BrandonGriffin · J.IreneHarris · KristenGolden
-
- 48 **Spirituality Groups on Specialized Behavioral Health Units: A Research-Informed Approach**
Leanne Dodge
-
- 49 **Poetic Medicine: Integrating Arts-Based Reflective Practices into Clinical, Pastoral, and Community Mental Health Care**
HimabinduLanka · WitekNowosiad
-
- 50 **The Phenomenology of Non-Ordinary Experiences during Spiritualist Seances**
EvertonMaraldi · AnaLuciaCunha · MariaEduardaElpidio · AmandaCafezeiro · RicardoOliveira-Souza · Jorge Moll
-
- 51 **Meaning, Peace, and Faith: Spiritual Predictors of Depression and Anxiety Symptoms in Migraineurs**
GeorgiaWestenhofen · IdaFortini · HomeroVallada · MarioF.P.Peres
-
- 52 **Spirituality as Predictor of Better Quality of Life After the 2024 Floods in Southern Brazil**
PauloHenriqueDutra · JoaoAntonioFortunatti · MariannaCosta · NeusaRocha
-
- 53 **How Religion and Spirituality Promote Well-Being: Insights Through the Lens of the Predostatic Mind Model**
SofiaMoreiraFerraó · FelixHenriquePaimKessler
-
- 54 **Recognition of the Patient's Spiritual Dimension as an Ethical Requirement in Healthcare Practice**
AssisCristianeRibeiro · MoraesAlexandreRochaAlmeidade
-
- 55 **Bridging Comparative Theology and the 'Living Human Document': The Medical Model of Studying Scriptures (MMSS) as a Pedagogy for Spiritual Psychiatry and Clinical Chaplaincy**
ParameshwaranRamakrishnan · CarlDavidOnofrio · BinduLanka · PaulBenz · CalebLewis
-
- 56 **The Approach to Spirituality and Religiosity in Medical Education in Brazil to Meet the Challenges of Mental Health Care**
Maria Lucia Machado Salomao · ManuelaSalomaoDel'Arco · PedroHenriqueSalgueiroPinheiro · GabrielaGouveiaSilva · Carlos Dario da Silva Costa · Gerardo Maria Araujo
-
- 57 **Evidence-Based Spiritual Structures of the Mind: Translating Chaplaincy-Informed Research into a Spiritual-Psychiatry Fellowship**
CarlDavidOnofrio · ParameshwaranRamakrishnan
-
- 58 **Two Journeys Intertwined: Co-Creating a Resource to Support Christians Experiencing Eating Disorders and Those Walking Alongside Them**
HayleyThomas · ClareO'Callaghan · MeganBest · MichaelBrautigam · ThomasKimber · TraceyWade · NancySturman
-
- 59 **Meaning-Making in the Classroom: Effects of a Psychology of Religion Course on Student Well-Being**
Nuran E. Korkmaz
-

GROUND FLOOR VENUE MAP:

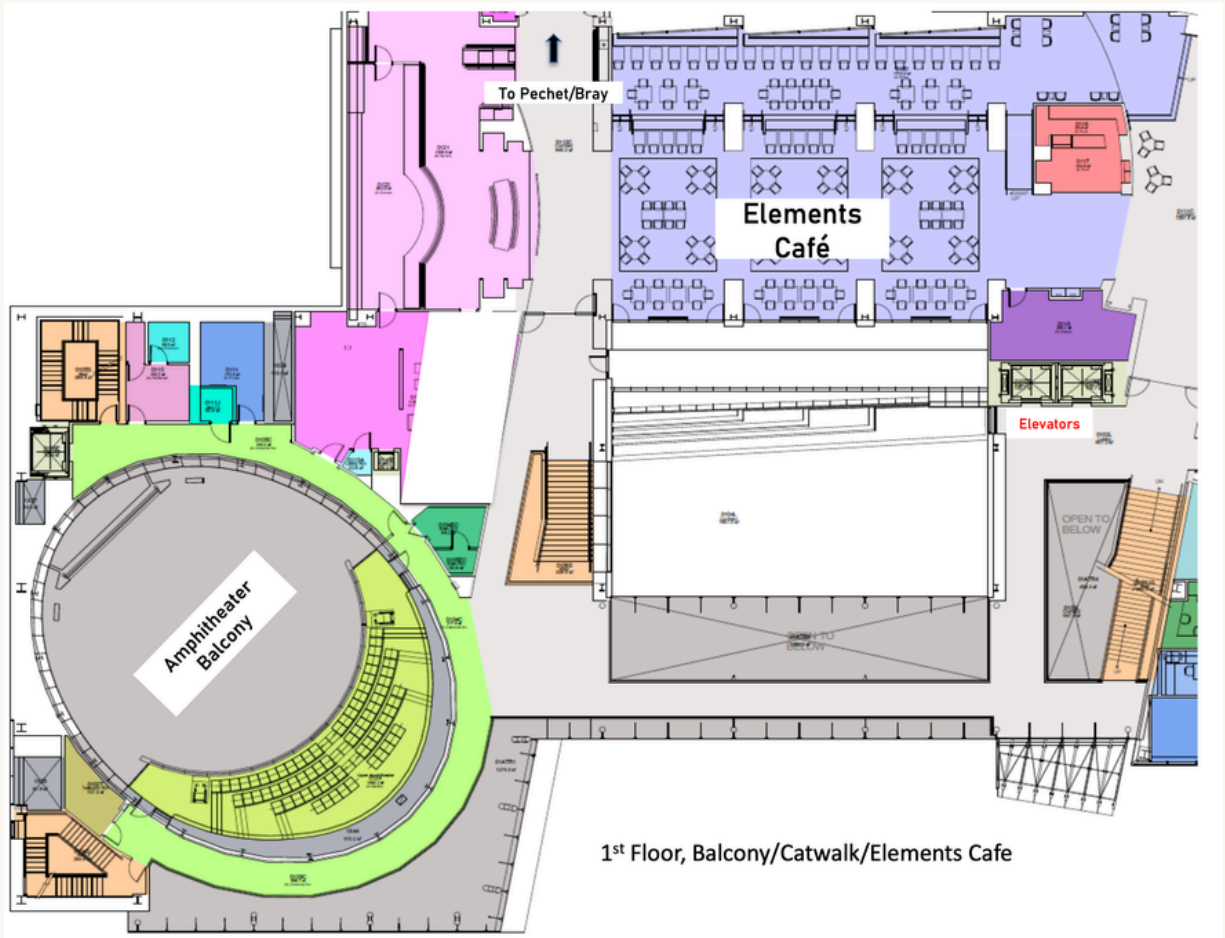
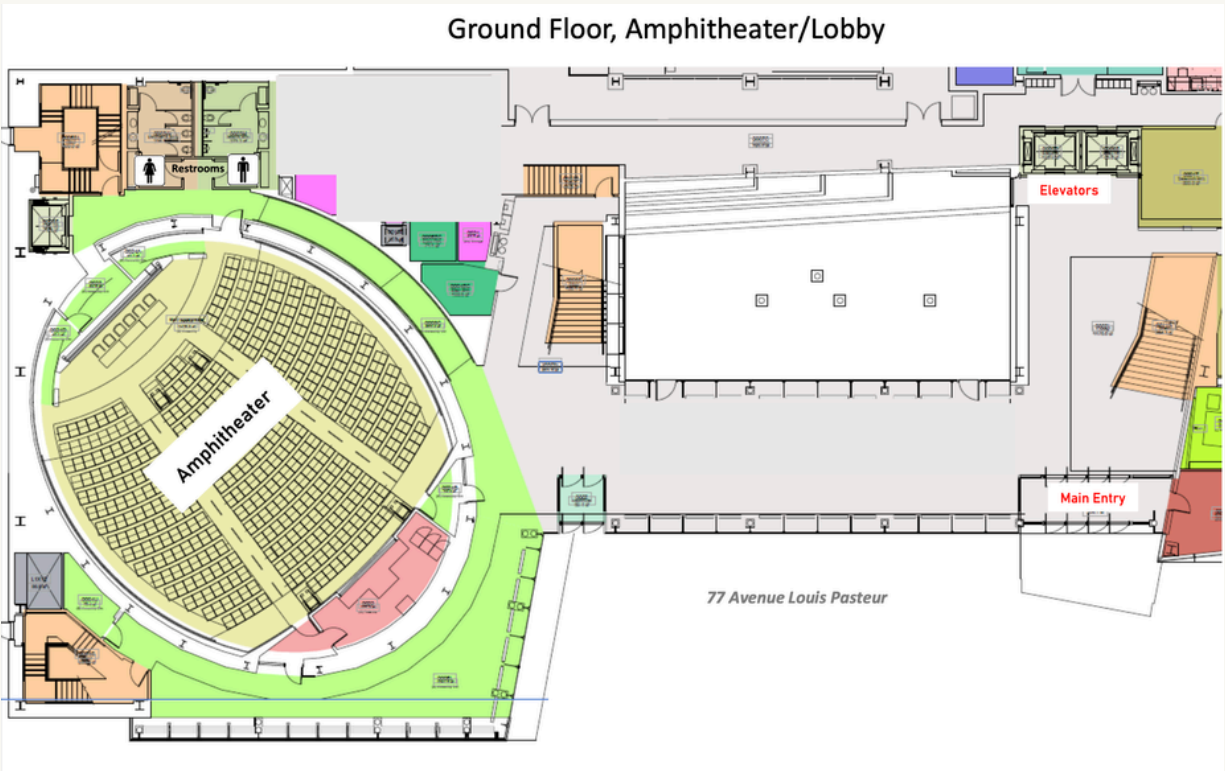

BREAKOUT SPACE VENUE MAP:

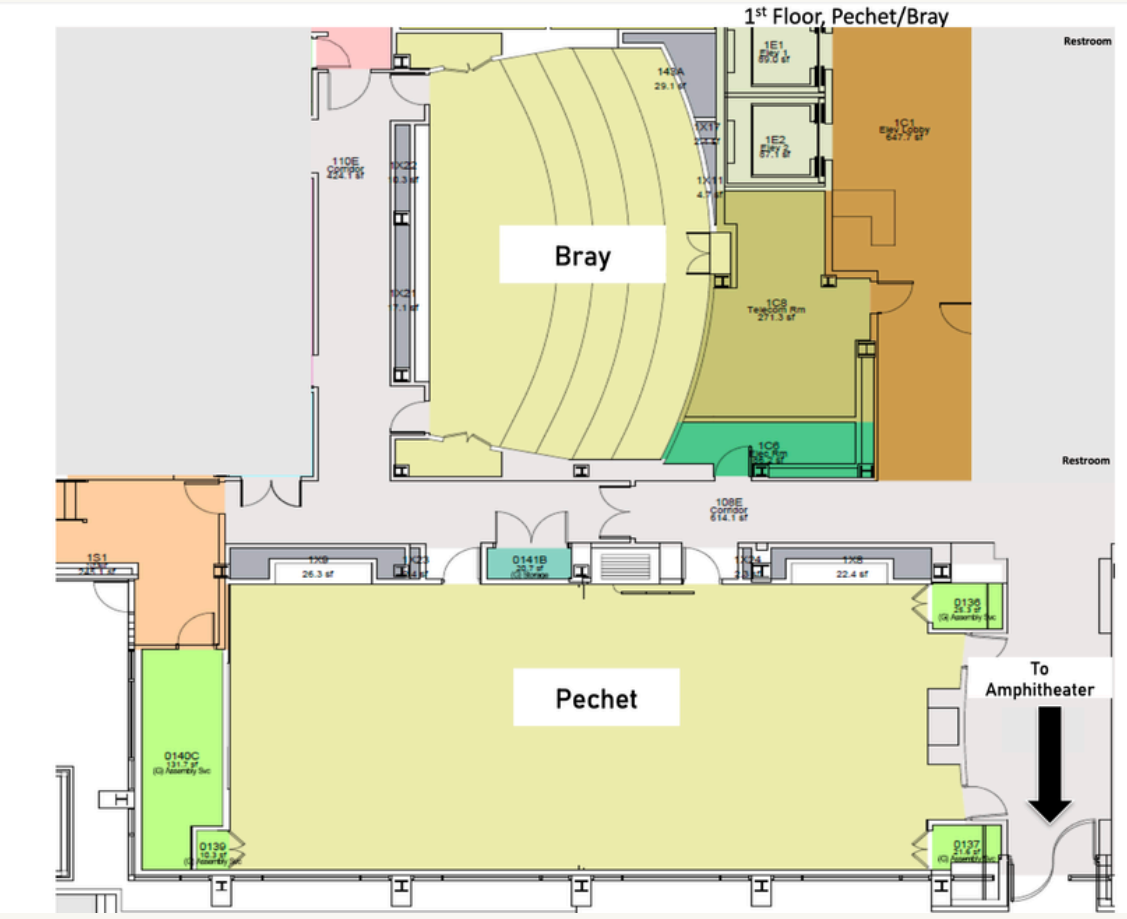
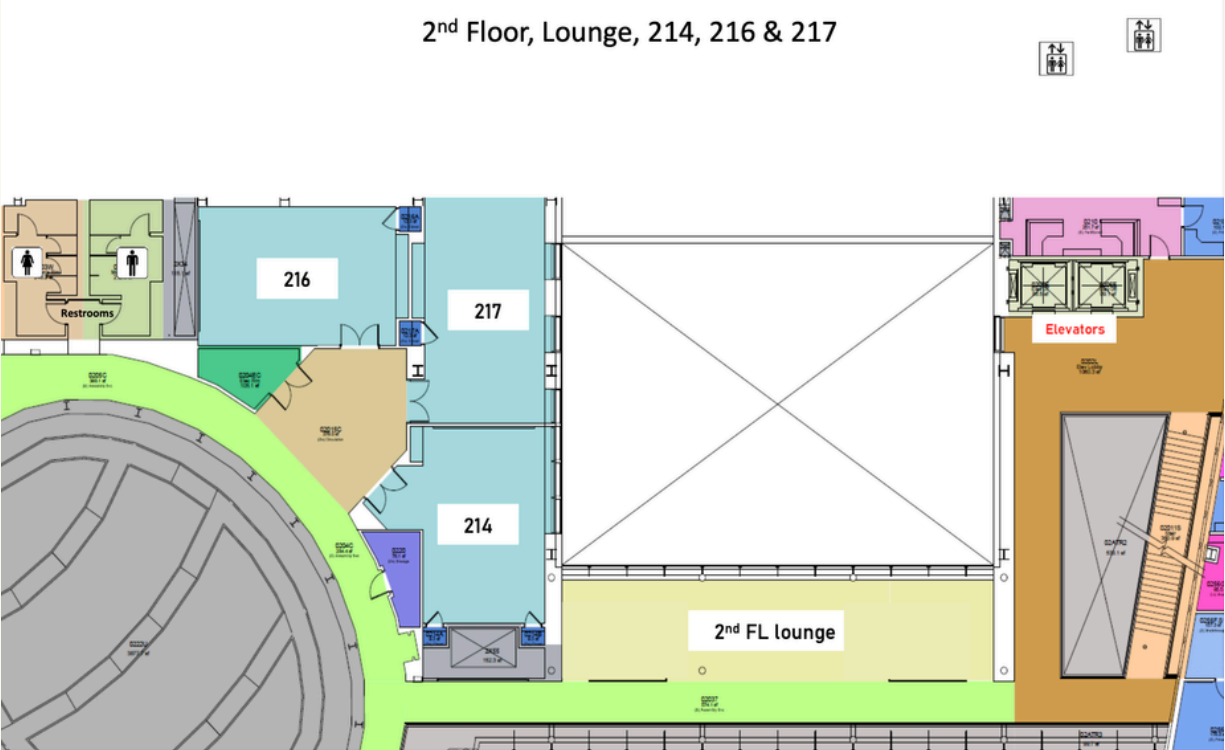

LOCAL INFORMATION

VENUE & GETTING HERE

The Global Summit will be hosted at the Joseph B. Martin Conference Center, located in the heart of Boston's Longwood Medical Area at 77 Avenue Louis Pasteur, Boston, MA 02115.

Public Transit

The venue is conveniently accessible by public transit — no car needed.

- MBTA Green Line — alight at the Longwood Medical Area station
- MBTA Route 39 Bus — stops directly in the Longwood Medical Area
- Rideshare (Uber/Lyft) — drop-off directly at the Conference Center

Parking

Three parking garages are located within easy walking distance of the Conference Center:

- 333 Longwood Garage — 93 Binney St
- Longwood Galleria Garage / Pilgrim Parking — 350 Longwood Ave
- MASCO Parking Garage — 375 Longwood Ave

DINING NEAR THE VENUE

Right in the Longwood Medical Area

These options are a short walk from the Conference Center — ideal for a quick lunch or dinner without venturing far.

Restaurant	Cuisine	Notes
Longwood Grille & Bar	American	342 Longwood Ave — casual burgers, salads, and drinks; great for a relaxed meal
The Mission Bar & Grill	American Bar	Huntington Ave — well-loved neighborhood spot with a lively atmosphere
Longwood Galleria Food Court	Various	350 Longwood Ave — 15 eateries including Bourbon Street Café, Charley's Philly Steaks, Wow!! Tikka, and more
Milkweed	Café / Brunch	Popular local café — great for coffee and a bite in the morning
Solid Ground Cafe	Café	Friendly neighborhood café well-loved by the Longwood community
Elements Café	Café	Convenient café option in the medical area
Istanbul Doner Burrito	Turkish / Fast Casual	Quick and flavorful — a local favorite for lunch
The Puddingstone Tavern	American Bar	Relaxed pub atmosphere, great for unwinding after a full day

EXPLORING BOSTON

Right Around the Corner

- Fenway Victory Gardens — the only continuously operating WWII Victory Gardens in the US, just a short stroll away. A lovely spot for a morning or evening walk.
- James P. Kelleher Rose Garden — a beautiful hidden gem in the Back Bay Fens, just adjacent to the Victory Gardens.
- Fenway Park — home of the Boston Red Sox, just up the road. Even if there's no game, the neighborhood around the park is lively and fun to explore.

Culture & Museums (10–15 min)

- Museum of Fine Arts — 10-minute walk from the venue. An encyclopedic collection spanning ancient Egypt to contemporary art.
- Isabella Stewart Gardner Museum — a serene Venetian-style palazzo housing a world-class private collection, with a stunning courtyard at its center.

22nd Annual Research Workshop on *Spirituality & Health*

**AUGUST 10-14,
2026**

Durham, North Carolina

The only program in the world offering specialized training in religion, spirituality, and health research, taught by faculty with over 40 years of active research in the field. The course compresses two years of post-doctoral content into five intensive days, covering study design, measurement, funding, and career development. Faculty draw from NIH, Yale, and Duke University, spanning psychiatry, theology, nursing, psychology, and chaplaincy.

TOPICS COVERED

- Previous research: strengths, weaknesses, and mechanisms
- Designing cross-sectional, prospective, experimental & qualitative studies
- Spiritually-integrated therapy for moral injury and PTSD
- Theological considerations for researchers
- Healthcare professional burnout and clergy well-being
- Statistics, modeling, and managing a research project
- NIH funding opportunities (RSH-SIG) and non-NIH sources
- Publishing research and working with the media
- Building an academic career in spirituality and health

FACULTY

Dan G. Blazer, MD, PhD

Psychiatry & Epidemiology, Duke

Benjamin Doolittle, MD, MDiv

Pediatrics; Clergy Burnout, Yale

Warren Kinghorn, MD, ThD

Theology & Psychiatry, Duke

Keisha O'Garro, PsyD

Spiritual-Integrated CPT, Moral Injury

Allison Lewinski, RN, PhD

Nursing; Qualitative Research

Harold G. Koenig, MD

Psychiatry, Medicine & Nursing, Duke

John P. Oliver, BCC, DMin

Chaplain Research & PTSD

Joan Romaine, MPH, MS

NIH/NIAAA, Research Funding

Open to all levels: researchers, graduate students, clinicians, chaplains, clergy, and laypersons. Partial tuition scholarships available for those with financial difficulties; full scholarships are available for graduate students (PhD or MD) from low-resource settings (third-world countries). Discounts for APC members and group registrations. No CME/CEU is being offered; however, the program in the past had been approved for 32.0 CME/CEU hours. Participants may submit the schedule and 500-page syllabus to their credentialing organization and request CME/CEU (but it is not guaranteed). One-on-one mentorship sessions with Dr. Koenig or other faculty members is available (but early registration is required).

Register at: spiritualityandhealth.duke.edu/index.php/5-day-summer-research-course/

Questions? Harold.Koenig@duke.edu

GLOBAL SUMMIT ORGANIZING COMMITTEES

International Organizing Committee

(Listed in alphabetical order by surname)

Co-Chairs:

Dr. Alan Fung, MD, ScD, FRCPC, DFAPA (Canada; Chair, WPA Section on Religion, Spirituality and Psychiatry)

Dr. David H. Rosmarin, PhD, ABPP (USA; President, APA Division 36)

Members:

Dr. Farha Abbasi, MD (USA; Executive Committee Member, WPA Section on Religion, Spirituality and Psychiatry)

Dr. King-Yee Agatha Chong, MBChB, FHKCPsych, FHKAM(Psychiatry) (Hong Kong SAR, China; Executive Committee Member, WPA Section on Religion, Spirituality and Psychiatry)

Dr. Marta Helena de Freitas, PhD (Brazil; President of the International Association for the Psychology of Religion- IAPR)

Dr. Sarah Egger, MBBS, FRCPsych (United Kingdom; Executive Committee Member, WPA Section on Religion, Spirituality and Psychiatry)

Dr. Leihua Edstrom, PhD (USA; Program Chair, APA Division 36)

Dr. Anahy Fonseca, MD (Brazil; Executive Committee Member, WPA Section on Religion, Spirituality and Psychiatry)

Dr. Hasan Kaplan, PhD (Turkey; Dean, Faculty of Human and Social Sciences, Yalova University)

Esther Kim, MA, MDiv (USA; Program Chair, APA Division 36)

Dr. Glen Milstein, PhD (USA; President Elect, APA Division 36)

Dr. Alexander Moreira-Almeida, MD, PhD (Brazil; Past Chair, WPA Section on Religion, Spirituality and Psychiatry)

Dr. Bruno Paz Mosqueiro, MD, PhD (Brazil; Co-Chair, WPA Section on Religion, Spirituality and Psychiatry)

Dr. Constantine Psimopoulos, MBE, Dr.Bioethics (USA; Instructor on Bioethics and Human Flourishing/Senior Program Admin, Harvard T.H. Chan School of Public Health)

Dr. Rajashree Ray, MD, FRCPsych (India; Secretary, WPA Section on Religion, Spirituality and Psychiatry)

Dr. Hanneke Schaap-Jonker, PhD (The Netherlands; Full Professor in Clinical Psychology of Religion, Vrije Universiteit)

Dr. Peter Verhagen, MD, PhD (The Netherlands; Past Chair, WPA Section on Religion, Spirituality and Psychiatry)

GLOBAL SUMMIT ORGANIZING COMMITTEES

Scientific Organizing Committee

(Listed in alphabetical order by surname)

Co-Chairs:

Esther Kim, MS (USA; Program Chair, APA Division 36)

Dr. Alexander Moreira-Almeida, MD, PhD (Brazil; Past Chair, WPA Section on Religion, Spirituality and Psychiatry)

Members (Psychiatry):

Dr. Mary Lynn Dell, MD, DMin, MHA (USA; Chair, Child and Adolescent Psychiatry, Associate Medical Director, Institute of Living/Hartford Healthcare; Professor of Psychiatry, UConn School of Medicine & Frank H. Netter School of Medicine at Quinnipiac University)

Dr. Alan Fung, MD, ScD, FRCPC, DFAPA (Canada; Chair, WPA Section on Religion, Spirituality and Psychiatry)

Dr. Bruno Paz Mosqueiro, MD, PhD (Brazil; Co-Chair, WPA Section on Religion, Spirituality and Psychiatry)

Dr. John R. Peteet, MD (USA; Professor of Clinical Psychiatry, Harvard Medical School)

Dr. Peter Verhagen, MD, PhD (The Netherlands; Past Chair, WPA Section on Religion, Spirituality and Psychiatry)

Members (Psychology):

Dr. Joseph Carrier, PhD (USA; Member-at-large, APA Division 36)

Dr. Marta Helena de Freitas, PhD (Brazil; President of the International Association for the Psychology of Religion-IAPR)

Dr. Leihua Edstrom, PhD (USA; Program Chair, APA Division 36)

Dr. Hasan Kaplan, PhD (Turkey; Dean, Faculty of Human and Social Sciences, Yalova University)

Dr. Glen Milstein, PhD (USA; President Elect, APA Division 36)

Dr. P. Scott Richards, PhD (USA; President, Bridges Institute for Spiritually Integrated Psychotherapies)

Dr. Jennifer Ripley, PhD (USA; Hughes Endowed Chair, Regent University)

Dr. Sarah Salcone, PhD (USA; Clinical Psychology Postdoctoral Fellow, NewYork Presbyterian/ Weill Cornell Medicine)

Dr. Theresa Clement Tisdale, PhD (USA; Professor of Clinical Psychology, Azusa Pacific University)

Dr. Craig Warlick, PhD (USA; Assistant Professor of Counseling, Texas Tech University)

Members (Chaplaincy):

Natasha Dachos, MSSW, MAPCC, BCC (USA; Chaplain, New York Presbyterian Hospital)

Allison Kestenbaum, MA, MPA, BCC-PCHAC, ACPE Certified Educator (USA; Associate Clinical Professor, UC San Diego Health Sciences)

Kerry Maloney, MDiv (USA; Chaplain and Director of Religious and Spiritual Life, Harvard Divinity School)

Alex Beth Schapiro, MAPCC, BCC (USA; Manager of Spiritual Services, ACO Spiritual Health, Atlantic Health System)

Csaba Szilagy, MDiv, MLA, MS, ACPE, FACHE (USA; Director, Transforming Chaplaincy)

Angelika A. Zollfrank, MDiv, BCC (USA; Chaplain, McLean Hospital)

GLOBAL SUMMIT ORGANIZING COMMITTEES

Local Organizing Committee

(Listed in alphabetical order by surname)

Kerry Maloney, MDiv (Chaplain and Director of Religious and Spiritual Life, Harvard Divinity School)

Laura Tuach, MDiv (Assistant Dean for Ministry Studies and Field Education, Harvard Divinity School)

Audrey Zhou (MDiv Candidate, Harvard Divinity School)

Angelika A. Zollfrank, MDiv, BCC (Chaplain, McLean Hospital)

Program Director

Charlotte McAdams, MDiv (Program Manager, McLean Hospital/Harvard Medical School)

FEEDBACK SURVEY: HELP US IMPROVE

Please take 3-5 minutes to share your experience at the Global Summit so we can continue to improve the event experience.



Scan this QR code to access the survey or go to
<https://forms.gle/8z4Lc5XsBcS71AxaA>