

**We don't build homes or decks  
with poles in the ground.**

**Why continue building sheds  
this way?**



**Poles are rotting and buildings  
are collapsing.**

**Traditional pole construction is  
a thing of the past.**



**DESIGNED TO LAST FOR  
GENERATIONS**



48227 State Hwy 19  
Fairfax, MN 55332  
(507) 426-6132

414 East Bridge St  
Redwood Falls, MN 56283  
(507) 627-6132



**TRADITIONAL CONSTRUCTION DESIGN**

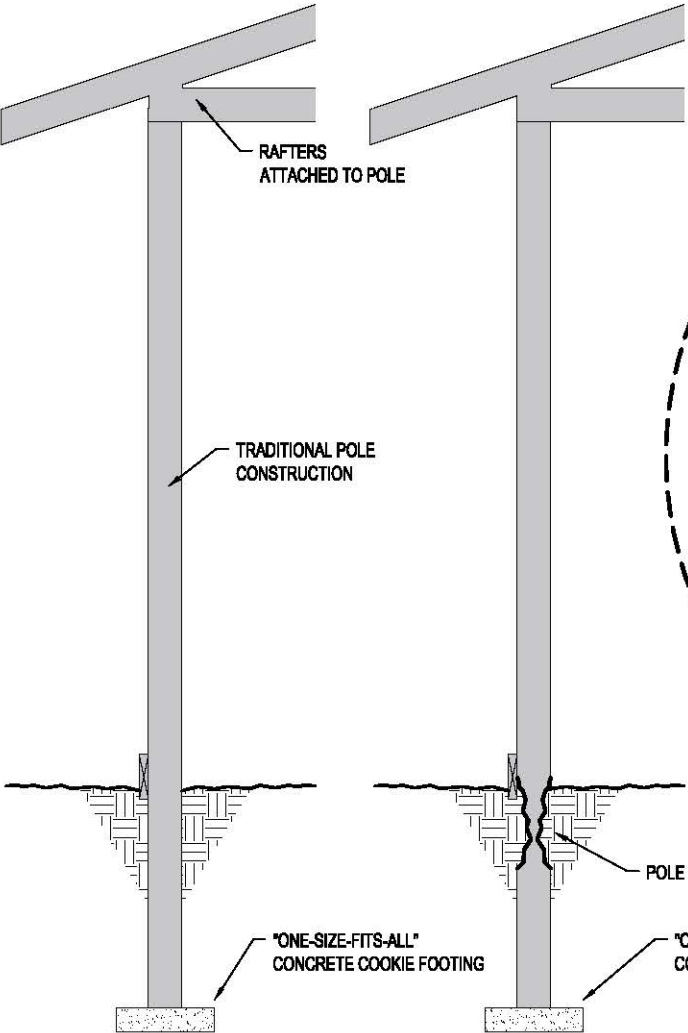

**"NO BULL" CONSTRUCTION**

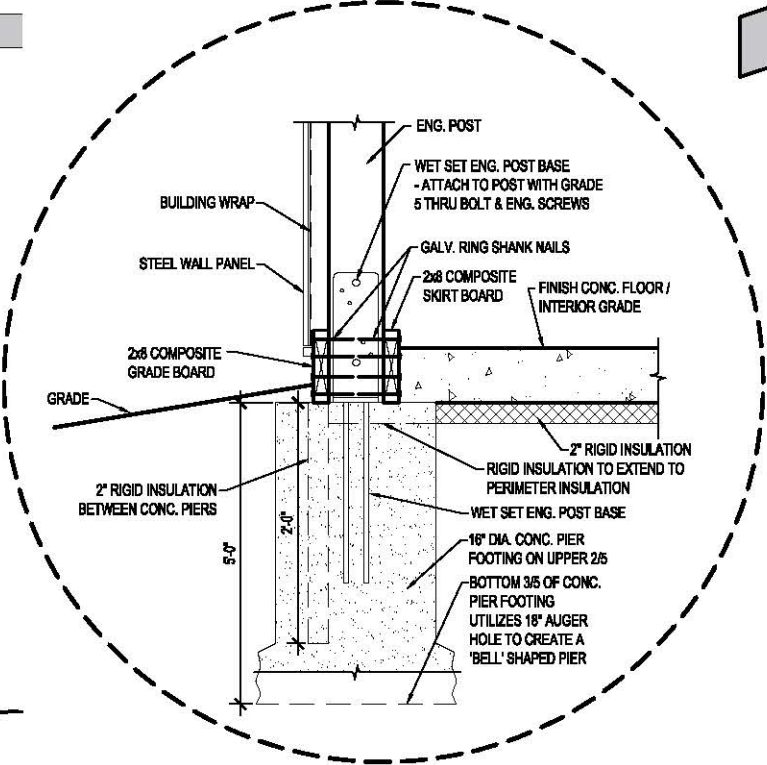

COMPOSITE GRADE BOARD ENGINEERED TO BE INSTALLED IN THE GROUND - KEEPING ALL SOIL OR LANDSCAPING SEPARATED FROM THE WOOD POST SO POST DETERIORATION CANNOT OCCUR

**"NO BULL" DESIGN**

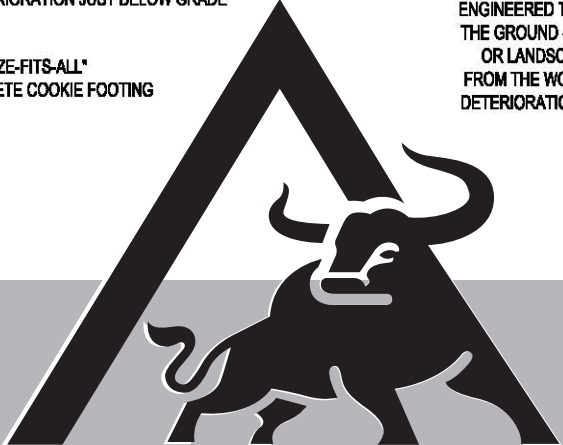
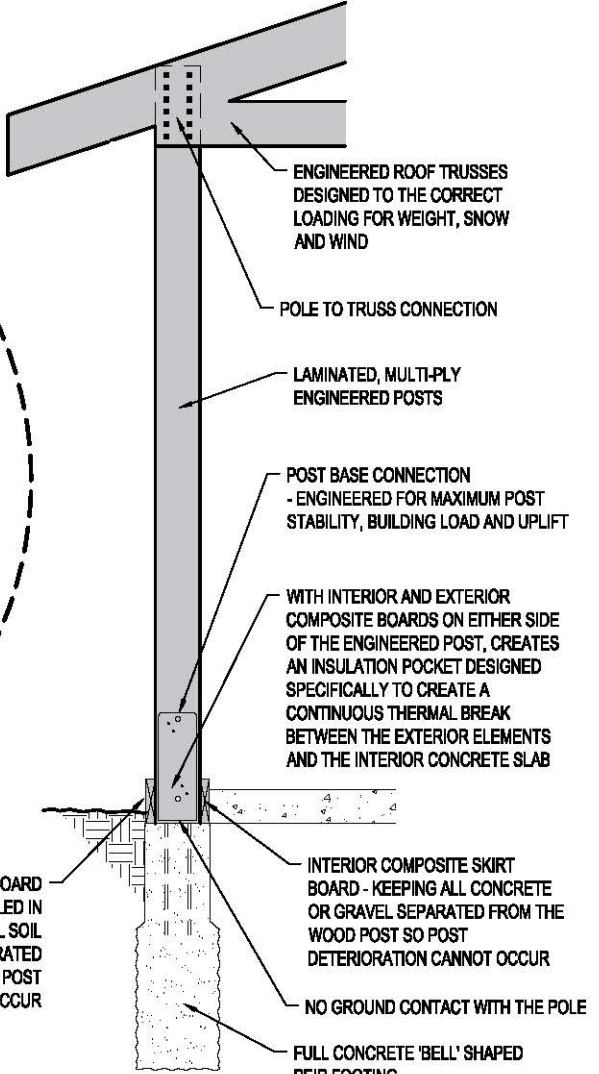

**BULL BUILDINGS**