

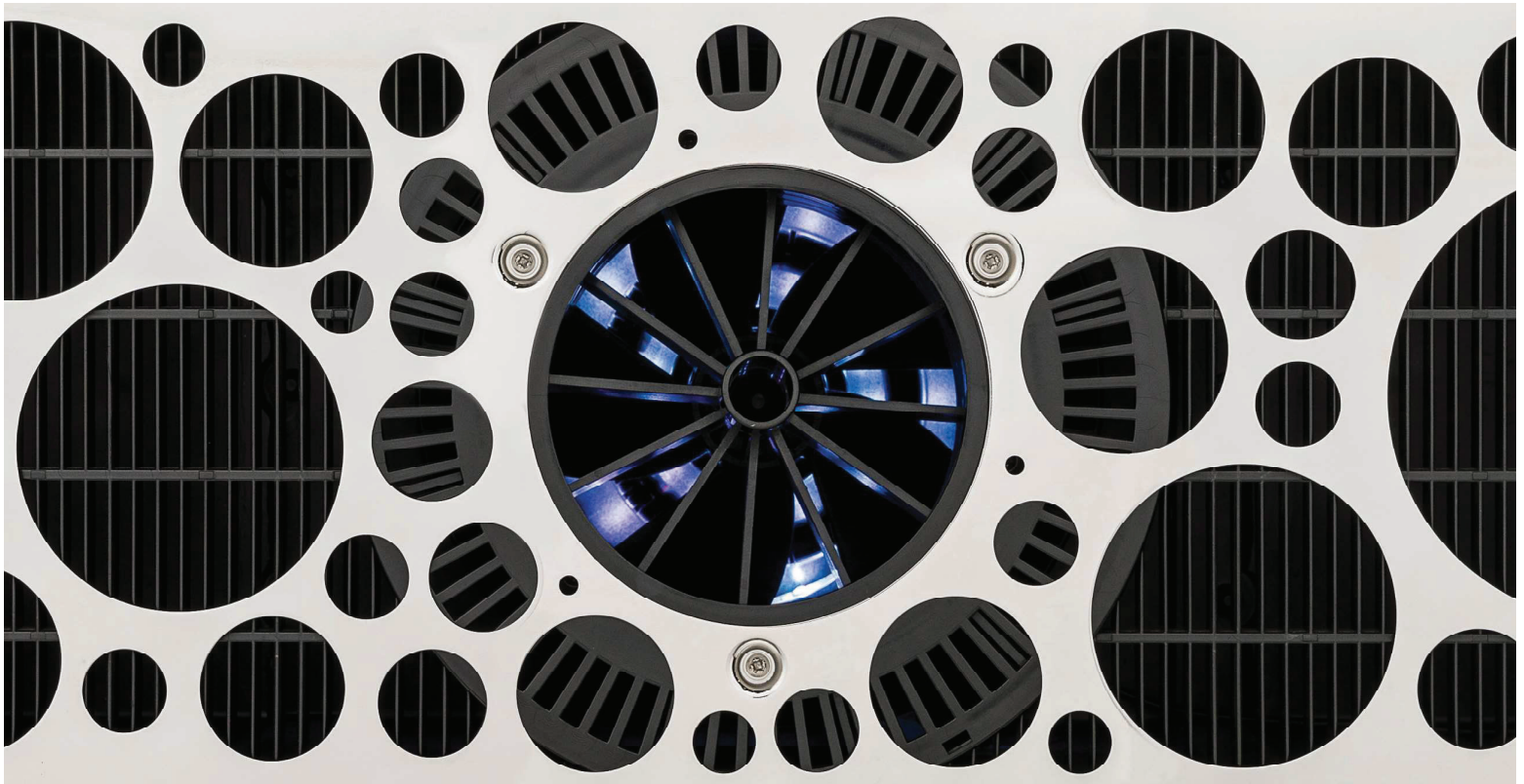

2023

Commercial & Residential Catalog



WE BRING **WATER** TO LIFE!®



Celebrating 40 Years of American Manufacturing.



U.S. office and distribution center, Jacksonville, Florida

113 years and five generations ago, Daniel Speck brought his first pump to market in Germany.

Since 1983, SPECK Pumps has continued that legacy in the United States, blending German technical prowess with reliable American manufacturing.

SPECK North America services the Western Hemisphere out of our Jacksonville, Florida manufacturing facility. With more than 70 employees and salesmen across multiple countries, we work hard to bring the dedicated touch of a family business to the entire territory.



A Family Business with a Personal Touch.

Our commitment to excellence
in product design and customer
service spans over 40 years.



At Speck Pumps, the service is personal.

Being a smaller business than many of our
competitors, we have this luxury.

It's something you'll notice the instant you call us.
No voicemail directory, no nonsense, just helpful
people picking up the phone.

Some might see our smaller size as a liability,
but here at Speck Pumps, we know it gives us the
flexibility and reactivity to give you the service
you deserve.







BADU[®]
Swimjet
Systems

Product Overview



Badu®Stream II

Mounted In-the-Wall
Gallons Per Minute: 200-700
Page 28



Badu®Jet super-sport II

Mounted In-the-Wall
Gallons Per Minute: 400
Page 30



Badu®Jet Imperial

Mounted In-the-Wall
Gallons Per Minute: 400
Page 32



Badu®Jet Inspiration

Mounted Over-the-Wall
Gallons Per Minute: 420
Page 34

NEW PRODUCT

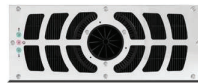

Badu®Jet Turbo

Mounted In-the-Wall
Gallons Per Minute: 1,100
Page 36



Badu®Jet Turbo Pro

Mounted In-the-Wall
Gallons Per Minute: 1,500
Page 38

Badu®Stream II

SwimJet System



With a BaduStream II SwimJet system there is something for everyone. This versatile swimjet system is available in several different packages to satisfy a variety of exercise styles and budgets. The BaduStream can be configured with one, two or three jets. Its compact low profile swimjets fit flush against your pool wall.

Features

- Patented flush mounted jet housing for minimum visibility.
- Anti-entrapment cover (8-1/4" x 8-1/4") provides undetectable suction. (Round or Square covers available)
- Adjust the flow with a simple turn of the jet nozzles, and quickly adapt to any swimmer's pace.
- Air regulator venturi allows for exhilarating white-water effect.
- Underwater LED Touch Button with 50 ft. cable installs in a standard 1.5" return fitting, and allows for easy control from inside the pool.
- Control from outside the water with our intuitive BADUConnect App via WiFi.
- Utilizes the DOE Compliant SPECK Model 21-80 5.0 THP SwimJet Pump.
- Requires a single phase, 40 amp service; does not require a motor starter.
- System includes nozzle adjustment tools to help set the jet nozzles in position for optimum performance.
- Optional pulsating massage hose that can be attached to jet nozzle.
- Optional winter cover kit.

Installation Specifications

The BaduStream is normally incorporated into the design, but it can be added to any pool at a later date. The BaduStream has no protruding parts, ensuring pool users' safety. All BaduStream systems include an LED touch button with 50' cable (mounts in all standard 1.5" return fitting), Speck controller, and Speck 5 THP pump. 4" or 6" plumbing is required, depending upon the package chosen.

- The BaduStream requires a clear unobstructed area within the swimming pool that is 8 ft wide x 15 ft long x 3 ft deep to work effectively.
- The BaduStream should be installed within 30 ft. of the pump with 4" pipe and minimal fittings for optimum performance. If the distance to the pump is greater than 30 ft., then 6" pipe should be used.

All BaduStreams are provided with installation instructions for various pool construction types: new and existing guinte or concrete pools, pools with liners, steel wall pools, and fiberglass pools.

Read all instructions before installing.

Consult your physician before attempting any strenuous exercise. This product may not be challenging or satisfying for all levels of exercise.



Package A (with square cover)

Color Options



Round covers are available in black, gray and white.

Trademarks and Certifications



Complies with UL 1563
CSA C22.2 No. 218.1-M89
Swimming Pool Equipment
Listing #E212148



VGBA 2017

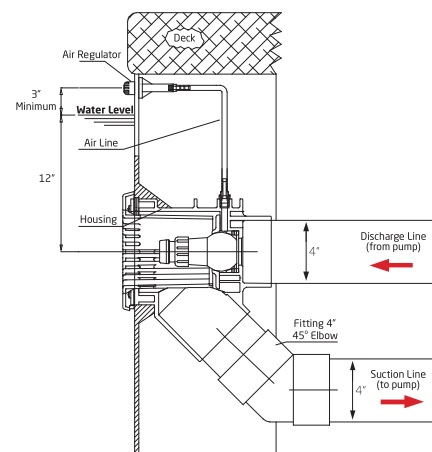

Side View

NOTE: Patented combined suction and discharge fitting does not require main drains.

Badu®Stream //

SwimJet System



Part Numbers

Single Phase System with GFCI

Order #	Package	Description
Square Cover		
SS484-2400M-1SW	A	BaduStream SwimJet System (400 GPM) - Two Jet Housings, One 5.0 THP pump the Model 21-80/33GS and Control Box with WIFI
SS484-1400M-1SW	B	BaduStream SwimJet System (270 GPM) - One Jet Housing, One 5.0 THP pump the Model 21-80/33GS and Control Box with WIFI
SS484-3400M-1SW	D	BaduStream SwimJet System (700 GPM) - Three Jet Housings, Two 5.0 THP pumps the Model 21-80/33GS, Control Box with WIFI & two 4" Check Valves
Round Cover		
SS484-2400M-1RW	A	BaduStream SwimJet System (400 GPM) - Two Jet Housings, One 5.0 THP pump the Model 21-80/33GS and Control Box with WIFI
SS484-1400M-1RW	B	BaduStream SwimJet System (270 GPM) - One Jet Housing, One 5.0 THP pump the Model 21-80/33GS and Control Box with WIFI
SS484-3400M-1RW	D	BaduStream SwimJet System (700 GPM) - Three Jet Housings, Two 5.0 THP pumps the Model 21-80/33GS, Control Box with WIFI & two 4" Check Valves

(Please call Speck Customer Service at (800) 223-8538 for Three Phase Systems)



5' Massage Hose with Pulsator & Hand Grip

Nozzle Adjustment Tool



Accessories

Order #	Description
2308760004G	Round Gray Cover (One per housing)
2308760004B	Round Black Cover (One per housing)
2308750003B	Square Black Cover (One per housing)
2308752006K	Winter Cover Kit (One per housing)
2308750006	Butterfly Gasket (Steel Wall Option)
2301002000B	Black Air Regulator
2336002800B	LED Touch Button with 100 ft. Cable
2300003010	5' Massage Hose with Pulsator & Hand Grip
2300003310	15' Massage Hose with Pulsator & Hand Grip
2300022010	Cap with Hand Grip to Close one Nozzle
2300011200	BADU Swim Mirror - 24" x 32" polished stainless steel with PVC backing

See pages 110-111 for replacement parts

Badu[®]Jet super-sport II

SwimJet System



The BaduJet super-sport II gives you the power and control you want from a swimjet system. Everything is right at your fingertips. This full featured swimjet offers suction and discharge in a unique, patented, one-piece housing.

Features

- Rectangular anti-entrapment cover (20" x 17") provides undetectable suction.
- Flush mounted, plastic housing with recessed jet nozzles, all controls are conveniently located on the face of the jet housing.
- Water volume control knob adjusts force of water leaving jet nozzles.
- Air regulator controls amount of air bubbles in water flow.
- LED touch button turns low voltage light ON/OFF.
- SPECK Controller with GFCI and built-in WiFi.
- Control from outside the water with our intuitive BADUConnect App via WiFi.
- Utilizes the DOE Compliant SPECK Model 21-80 5.0 THP SwimJet Pump.
- Requires a single phase, 40 amp service; does not require a motor starter.
- The system comes with a 5 ft. pulsating massage hose that can be attached to jet nozzle.
- System includes nozzle adjustment tools to help set the jet nozzles in position for optimum performance.
- Optional winter cover kit.



Trademarks and Certifications



Complies with UL 1563
CSA C22.2 No. 218.1-M89
Swimming Pool Equipment
Listing #E212148



VGBA 2017

Installation Specifications

The BaduJet is normally incorporated into the design, but it can be added to any pool at a later date. The BaduJet has no protruding parts ensuring pool users' safety. All BaduJet systems include LED touch button with 50' cable, SPECK controller, and our SPECK Model 21-80 5.0 THP SwimJet Pump.

- The BaduJet requires a clear unobstructed area within the swimming pool that is 8 ft wide x 15 ft long x 3 ft deep to work effectively.
- The BaduJet should be installed within 30 ft. of the pump with 4" pipe and minimal fittings for optimum performance. If the distance to the pump is greater than 30 ft., then 6" pipe should be used.

All BaduJet systems are provided with installation instructions for various pool construction types: new and existing guinte or concrete pools, pools with liners, steel wall pools, and fiberglass pools.

Read all instructions before installing.

Consult your physician before attempting any strenuous exercise. This product may not be challenging or satisfying for all levels of exercise.

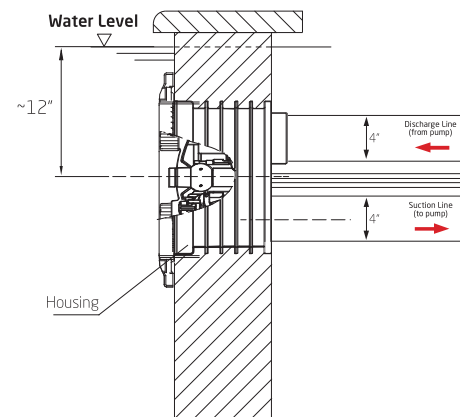

Side View

NOTE: Patented combined suction and discharge fitting does not require main drains.

Badu® Jet super-sport //

SwimJet System



Part Numbers

Single Phase System with GFCI

Order #	Description
JS414-2400M-1SW	BaduJet super-sport SwimJet System (400 GPM) - One Dual Nozzle Jet Housing, LED Light, Massage Hose, 5.0 THP Pump Model 21-80/33GS and Control Box with WIFI

(Please call Speck Customer Service at (800) 223-8538 for Three Phase Systems)



Winter Cover

Nozzle Adjustment Tool



Accessories

Order #	Description
2302005002	Round Cover Kit
2326000039K	Jet Nozzle Upgrade Kit (Adds 10% more flow to systems sold between 1/2015-6/2016)
2300003310	Massage Hose with Pulsator 15' & Hand Grip
2300022010	Cap with Hand Grip to Close one Nozzle
2326000010K	Winter Cover Kit
2336002899B	LED Touch Button with 100 ft. Cable
2326000036	Multi-color LED light
2326000038	Blue LED light
2300011200	BADU Swim Mirror - 24" x 32" polished stainless steel with a PVC backing

See pages 112-113 for replacement parts

Badu[®]Jet Imperial

SwimJet System



Made of Marine-Grade 316 stainless steel, the BaduJet Imperial swimjet system offers a sleek and flawless design. This elegant swimjet adds style and functionality to any new pool. The BaduJet Imperial has two adjustable swivel jet nozzles, allowing you to tailor it's flow rate to your specific needs.

Features

- Flush mounted, patented plastic housing with recessed jet nozzles, all controls are conveniently located on the face of the jet housing.
- Stainless steel corrosion-proof anti-entrapment cover provides undetectable suction.
- Stainless steel handles make it easier to adjust the settings while the unit is running.
- Water volume control knob adjusts force of water leaving jet nozzles.
- Air regulator controls amount of air bubbles in water flow.
- LED touch button turns low voltage light ON/OFF.
- SPECK Controller with GFCI and built-in WiFi.
- Control from outside the water with our intuitive BADUConnect App via WiFi.
- Utilizes the DOE Compliant SPECK Model 21-80 5.0 THP SwimJet Pump.
- Requires a single phase, 40 amp service; does not require a motor starter.
- The system comes with a 5 ft. pulsating massage hose that can be attached to jet nozzle.
- System includes nozzle adjustment tools to help set the jet nozzles in position for optimum performance.
- Winter cover kit. (Optional - Not Shown)

Installation Specifications

The BaduJet is normally incorporated into the design, but it can be added to any pool at a later date. The BaduJet has no protruding parts ensuring pool users' safety. All BaduJet systems include LED touch button with 50' cable, SPECK controller, and our SPECK Model 21-80 5.0 THP SwimJet Pump.

- The BaduJet requires a clear unobstructed area within the swimming pool that is 8 ft wide x 15 ft long x 3 ft deep to work effectively.
- The BaduJet should be installed within 30 ft. of the pump with 4" pipe and minimal fittings for optimum performance. If the distance to the pump is greater than 30 ft., then 6" pipe should be used.

All BaduJet systems are provided with installation instructions for various pool construction types: new and existing guinte or concrete pools, pools with liners, steel wall pools, and fiberglass pools.

Read all instructions before installing.

Consult your physician before attempting any strenuous exercise. This product may not be challenging or satisfying for all levels of exercise.



BaduJet Imperial Deluxe

Trademarks and Certifications



VGBA 2017

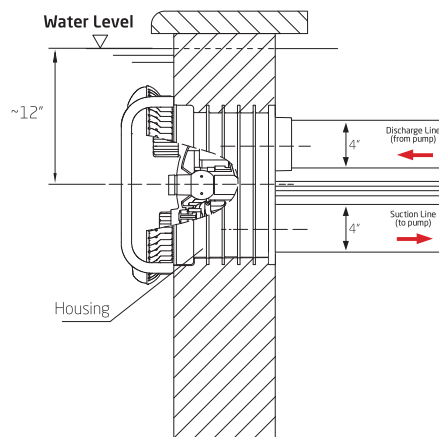

Side View

NOTE: Patented combined suction and discharge fitting does not require main drains.

Badu® Jet Imperial

SwimJet System



Part Numbers

Single Phase System with GFCI

Order #	Description
JS421-2411F-100	BaduJet Imperial SwimJet System (400 GPM) - One Dual Nozzle Jet Housing, LED Light, Stainless Steel Ring Cover and Hand Rail, Massage Hose, Control Box, and 5.0 THP Pump Model 21-80/33GS
JS421-2411F-1SS	BaduJet Imperial Deluxe SwimJet System (400 GPM) - One Dual Nozzle Jet Housing. All Stainless Steel dual jet nozzles, controls, buttons, ring cover and hand rail. LED Light, Massage Hose, 5.0 THP Pump Model 21-80/33GS and Control Box

(Please call Speck Customer Service at (800) 223-8538 for Three Phase Systems)



Winter Cover

Nozzle Adjustment Tool



Accessories

Order #	Description
2326000039K	Jet Nozzle Upgrade Kit (<i>Adds 10% more flow to systems sold between 1/2015-6/2016</i>)
2300003310	Massage Hose with Pulsator 15' & Hand Grip
2300022010	Cap with Hand Grip to Close one Nozzle
2326000010K	Winter Cover Kit
2336002899B	LED Touch Button with 100 ft. Cable
2326000036	Multi-color LED light
2326000038	Blue LED light
2300011200	BADU Swim Mirror - 24" x 32" polished stainless steel with a PVC backing

See pages 114-115 for replacement parts

Badu[®]Jet Inspiration

SwimJet System



The BaduJet Inspiration is perfect for existing pools. This system features dual jets for optimal swim against the current action, no-impact aquatic exercise, water massage and fun for the entire family.

Features

- Two-piece body molded of a heavy duty ABS plastic immune to chemicals and environmental abuse, to provide a rugged and attractively styled water treadmill.
- Adjustable recessed jet nozzles.
- Light (ON/OFF) button turns low voltage light ON/OFF.
- Pump (ON/OFF) pneumatic button guarantees complete separation between pool water and pump motor control.
- Air regulator (OPEN/CLOSE) knob permits a controlled mixture of air into the water flow and creates a unique, invigorating, bubble effect. It will also add additional resistance to swim against.
- Includes approximately 14 ft. GFCI twist-lock cord.
- Speck 5.0 THP self-priming plastic pump. Single phase with thermal overload (*no motor start required*). (*Not Shown*)
- The system comes with a 5 ft. pulsating massage hose that can be attached to jet nozzle.
- System includes nozzle adjustment tools to help set the jet nozzles in position for optimum performance.
- Packed in one box on a pallet and shipped via truck line. Shipping weight is 115 lbs.

Installation Specifications

The BaduJet can be mounted over the wall of most pools with little installation, effort or cost.

This self-contained unit comes complete with pump, control box, electrical cord with GFCI and mounting hardware. The BaduJet Inspiration requires no additional equipment for installation. Just supply pool, water and electricity. Pump and control are also available in 3 phase. Read all instructions before installing.

Consult your physician before attempting any strenuous exercise. This product may not be challenging or satisfying for all levels of exercise.



Trademarks and Certifications



Complies with UL 1563
CSA C22.2 No. 218.1-M89
Swimming Pool Equipment
Listing #E212148



VGBA 2017

Dimensional Drawing

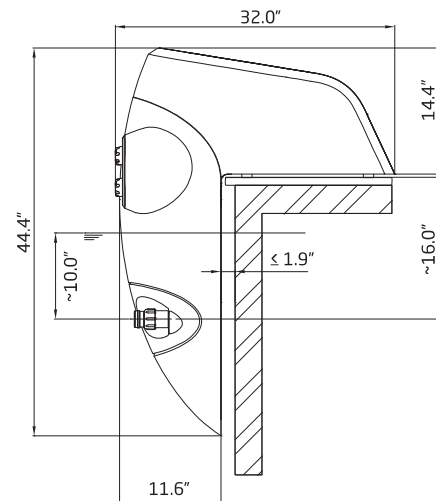

Badu[®]Jet Inspiration

SwimJet System



Part Numbers

Single Phase System with GFCI

Order #	Description
JS431-2411F-10W	BaduJet Inspiration SwimJet System (420 GPM) - comes with built-in LED Light, 5.0 THP Pump Model 21-80/33 GI. Unit comes complete with GFCI Control Box, Deck Mounting Hardware and GFCI protected cord.

Nozzle Adjustment Tool



Accessories

Order #	Description
2300003310	Massage Hose with Pulsator 15' & Hand Grip
2300022010	Cap with Hand Grip to Close one Nozzle
0319851000	Telescopic Support Kit (Above-Ground Pools)
2319800861	Multi-color LED light
2300011200	BADU Swim Mirror - 24" x 32" polished stainless steel with a PVC backing



The BaduJet Inspiration with telescopic support for above-ground pools.

See pages 116-117 for replacement parts



Next Level Resistance Swimming in a manageable package for any style pool. Delivers massive flow while minimizing plumbing, visibility and noise.

Features

- 1,100 Gallons per Minute for Serious Performance.
- Propeller-Driven Design for Clean, Turbulence-Free Flow.
- Multiple Speeds for Any Level of Swimmer.
- Intuitive Controls both Underwater and on Your Phone.
- Permanent Magnet Motor for Extremely Quiet Operation.
- Innovative Direct-in-wall Design Eliminates Costly Plumbing.
- Large Anti-Entrapment Cover for Safety and Peace of Mind,

Installation Specifications

The BaduJet Turbo should be incorporated into the design phase of the pool.

- It requires a clear unobstructed area within the swimming pool that is 8 ft wide x 15 ft long x 3 ft deep to be used to its full potential. *(Call us if you think it's close.)*
- BaduJet Turbo Housing measures 40" x 17" x 16"
- A vault measuring 24" x 24" x 32" should be built behind the BaduJet Turbo, allowing access to the motor and proper drainage. We recommend using a 26" x 26" HIDE Access Cover Kit (HAC26-0.8) over the vault.
- BaduJet Turbo draws 13 Amps and requires a 20 Amp service.

The BaduJet Turbo system is provided with installation instructions for various pool construction types. They can be installed on either new or existing pools, and on any style; from gunite and fiberglass through vinyl-liner steel and polymer builds.

Read all instructions before installing.

Consult your physician before attempting any strenuous exercise. This product may not be challenging or satisfying for all levels of exercise.

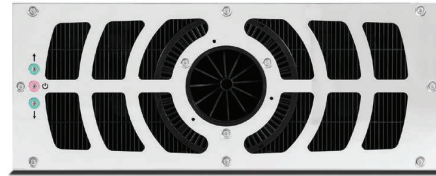
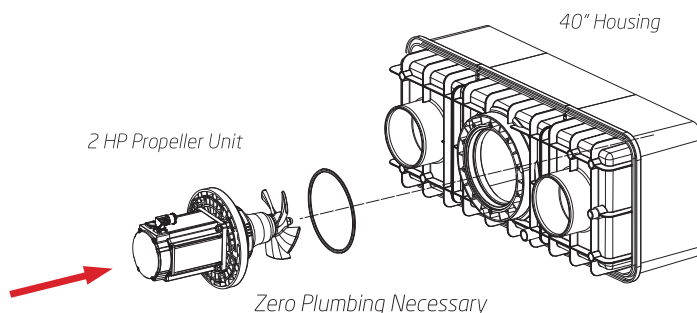

(shown with optional stainless steel cover)



Trademarks and Certifications



Complies with UL 1563
CSA C22.2 No. 218.1-M89
Swimming Pool Equipment
Listing #E212148

VGBA 2017

Vault Drawing

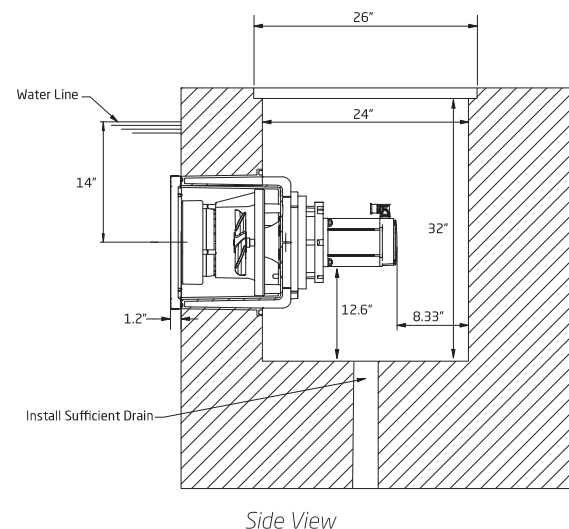

NOTE: Patented combined suction and discharge fitting does not require main drains.



Part Numbers

Order #	Description
JS453-9211T-10P	BaduJet Turbo SwimJet System (1,100 GPM) - Jet Housing with Plastic Cover , Control Box with WIFI, 2 HP Motor, and Variable Frequency Drive
JS453-9211T-100	BaduJet Turbo SwimJet System (1,100 GPM) - Jet Housing with Stainless Steel Cover , Control Box with WIFI, 2 HP Motor, and Variable Frequency Drive

NOTE: The BaduJet Turbo is packed in two boxes on a pallet and shipped via truck line.



Accessories

Order #	Description
2328009311	Alternate Stainless Steel Bubble Design Cover
2328120050K	Winter Cover Kit
2325000014	VFD Motor Cable, 80 ft.
2325000015	VFD Motor Cable, 150 ft.
2336002869A	LED Touch Button with 100 ft. Cable



The system includes the following items along with the jet housing.



Variable Frequency Drive

Motor Unit with 30 ft. Cable

SPECK Control Box

See pages 118-119 for replacement parts

Badu[®]Jet Turbo Pro

SwimJet System



The ultimate resistance swimming system, the BaduJet Turbo Pro is built for the highest level of swimmer. Delivers the absolute maximum flow while minimizing plumbing, visibility and noise.

Features

- 1,500 Gallons per Minute for Professional Performance.
- Propeller-Driven Design for Clean, Turbulence-Free Flow.
- Multiple Speeds for Any Level of Swimmer.
- Intuitive Controls both Underwater and on Your Phone.
- Permanent Magnet Motor for Extremely Quiet Operation.
- Innovative Direct-in-wall Design Eliminates Costly Plumbing.
- Large Anti-Entrapment Cover for Safety and Peace of Mind, Made of Durable Marine Grade 316 Stainless Steel.

Installation Specifications

The BaduJet Turbo Pro should ideally be incorporated into the design phase of the pool.

- Requires a straight wall within the pool for installation with a clear unobstructed area in front of it measuring 10 ft wide x 20 ft long x 3 ft deep for it to be used to its full potential. *(Call us if you think it's close.)*
- BaduJet Turbo Pro Housing measures 60" x 17" x 16"
- A vault measuring 24" x 24" x 32" should be built behind the BaduJet Turbo Pro, allowing access to the motor and proper drainage. We recommend using a 26" x 26" HIDE Access Cover Kit (HAC26-0.8) over the vault.
- BaduJet Turbo Pro draws 29 Amps and requires a 40 Amp service.

The BaduJet Turbo Pro system is provided with installation instructions for various pool construction types. They can be installed on either new or existing pools, and on any style; but are intended for gunite or fiberglass builds.

Read all instructions before installing.

Consult your physician before attempting any strenuous exercise. This product may not be challenging or satisfying for all levels of exercise.

Drawing

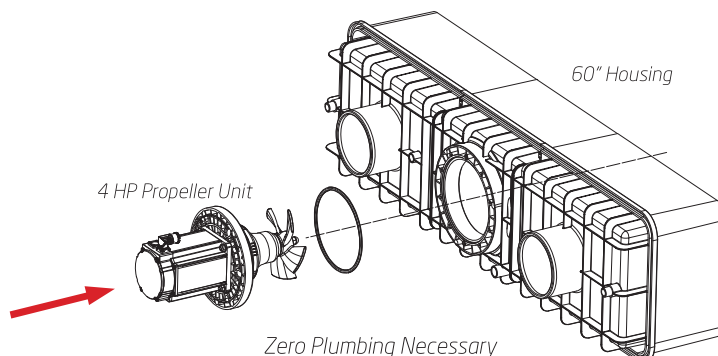

Trademarks and Certifications



Complies with UL 1563
CSA C22.2 No. 218.1-M89
Swimming Pool Equipment
Listing #E212148

VGBA 2017

Vault Drawing

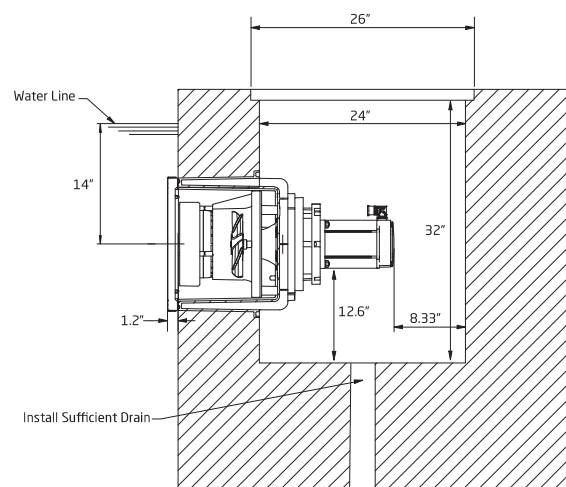

NOTE: Patented combined suction and discharge fitting does not require main drains.

Badu® Jet Turbo Pro

SwimJet System

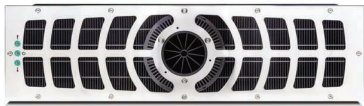

Part Numbers

Order #	Description
JS443-9411T-100	BaduJet Turbo SwimJet System (1,500 GPM) - Jet Housing, Control Box with WIFI, 4 HP Motor, and Variable Frequency Drive

NOTE: The BaduJet Turbo Pro is packed in two boxes on a pallet and shipped via truck line.



Accessories

Order #	Description
2325009315	Alternate Plastic Design Cover
2325009311	Alternate Stainless Steel Bubble Design Cover
2325150050K	Winter Cover Kit
2325000014	VFD Motor Cable, 80 ft.
2325000015	VFD Motor Cable, 150 ft.
2336002869A	LED Touch Button with 100 ft. Cable

The system includes the following items along with the jet housing.



See pages 120-121 for replacement parts