

Aluminum Rigid Conduit (ARC) Couplings & Elbows

Aluminum Rigid Conduit (ARC) Couplings

Listed to UL Safety Standard 6A

Manufactured in accordance with ANSI C80.1



Trade Size	Metric Designator	Nominal Outside Dimensions (A)		Minimal Acceptable Length (B)		Threads Per Inch	Approximate Weight Per 100 Pieces		Standard Package
		(in)	(mm)	(in)	(mm)		(lb)	(kg)	
1/2	16	1.078	27.38	1 5/8	41.3	14	6	2.7	100
3/4	21	1.328	33.73	1 41/64	41.7	14	9	4.1	50
1	27	1.562	39.67	1 31/32	50.0	11 1/2	13	5.9	30
1 1/4	35	1.953	49.61	2 1/32	51.6	11 1/2	19	8.6	25
1 1/2	41	2.219	56.36	2 1/16	52.4	11 1/2	23	10.4	25
2	53	2.750	69.85	2 1/8	54.4	11 1/2	35	15.9	15
2 1/2	63	3.281	83.34	3 3/16	81.0	8	68	30.8	20
3	78	3.812	96.84	3 5/16	84.1	8	91	41.3	15
3 1/2	91	4.438	112.71	3 13/32	86.5	8	108	49.0	12
4	103	5.000	127.00	3 33/64	89.3	8	142	64.4	12
5	129	6.219	157.96	3 61/64	100.4	8	242	109.8	8
6	155	7.312	185.74	4 1/4	108.0	8	320	145.2	6

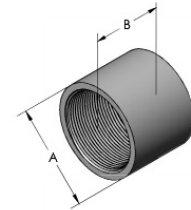

Aluminum Rigid Conduit (ARC) 90° Elbows

Listed to UL Safety Standard 6A

Manufactured in accordance with ANSI C80.1



Trade Size	Metric Designator	Nominal						Approximate Weight Per 100 Pieces		Standard Package
		Radius (A)		Offset (B)		Straight (D)				
		(in)	(mm)	(in)	(mm)	(in)	(mm)	(lb)	(kg)	
1/2	16	4	102	5 7/8	149	1 1/2	38	22	10.0	25
3/4	21	4 1/2	114	7	178	1 1/2	38	32	14.5	40
1	27	5 3/4	146	8 3/4	222	1 7/8	48	62	28.1	25
1 1/4	35	7 1/4	184	10 1/2	267	2	51	99	44.9	10
1 1/2	41	8 1/4	210	11 3/4	298	2	51	137	62.1	10
2	53	9 1/2	241	14 1/2	268	2	51	228	103.4	5
2 1/2	63	10 1/2	267	17 1/4	438	3	76	427	193.7	80
3	78	13	330	22 3/4	578	3 1/8	79	752	341.1	50
3 1/2	91	15	381	23 1/4	591	3 1/4	83	889	403.3	50
4	103	16	406	23 3/8	594	3 3/8	86	1049	475.8	36
5	129	24	610	34 7/8	886	3 5/8	92	2125	963.9	1
6	155	30	762	45 1/2	1156	3 3/4	95	3738	1695.6	1

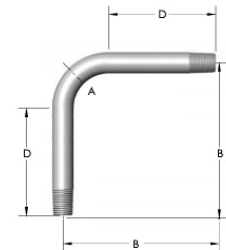

Aluminum Rigid Conduit (ARC) 45° Elbows

Listed to UL Safety Standard 6A

Manufactured in accordance with ANSI C80.1



Trade Size	Metric Designator	Nominal								Approximate Weight Per 100 Pieces		Standard Package
		Radius (A)		Offset (B)		Offset (C)		Straight (D)				
		(in)	(mm)	(in)	(mm)	(in)	(mm)	(in)	(mm)	(lb)	(kg)	
1/2	16	4	102	7	178	2 7/8	73	1 1/2	38	18	8.2	25
3/4	21	4 1/2	114	7 7/8	200	3 1/4	83	1 1/2	38	23	10.4	40
1	27	5 3/4	146	8 3/4	222	3 5/8	92	1 7/8	48	40	18.1	25
1 1/4	35	7 1/4	184	10 1/2	267	4 3/8	111	2	51	65	29.5	10
1 1/2	41	8 1/4	210	13 3/8	333	5 3/8	137	2	51	102	46.3	10
2	53	9 1/2	241	14 1/2	368	6	152	2	51	150	68.0	5
2 1/2	63	10 1/2	267	17 1/2	445	7 1/4	184	3	76	278	126.1	80
3	78	13	330	21	533	8 5/8	219	3 3/8	79	442	200.5	50
3 1/2	91	15	381	26 7/8	664	10 7/8	276	3 1/4	83	659	298.9	50
4	103	16	406	26 1/4	667	10 7/8	276	3 3/8	86	777	352.4	36
5	129	24	610	35 3/8	911	14 7/8	378	3 3/8	92	1446	655.9	1
6	155	30	762	43 3/8	1102	18	457	3 3/4	95	2347	1064.6	1

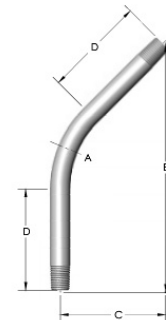

NOTE: Special orders are non-cancelable, non-returnable and non-refundable.

alliedeg.com