

HYLUG™ Terminals, Type YCA-RL-2N

For AAC (Stranded, Compressed, Compact), ACSR, AAAC

Material: Aluminum

Aluminum compression HYLUG™ for terminating overhead conductors to switch pads and other substation or switch yard apparatus. NEMA standard mounting holes. Installed with same die as equivalent full tension UNISPLICE™. Prefilled with PENETROX™ joint compound, stripsealed, and capped to limit oxide growth and increase the life of the connection.

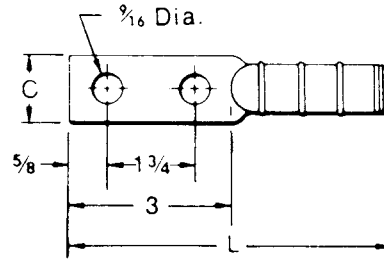
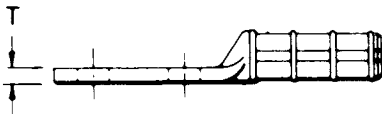

Catalog Number	Conductor	C	L	T	Die Index	Tools, Die Set Catalog Number, & (Number of Crimps)		
						MD7, MD6	35, 750, Y45†, 46‡	
YCA4RL2N	4 ACSR (6-1, 7-1) 4 6201 (7) 4 AAC (7)	7/8	6	3/8	BG, 243, 687	WBG (8) Fixed BG (8) W687 (4)	U243	
YCA2RL2N	2 ACSR (6-1, 7-1) 2 6201 (7) 2 AAC (7)							
YCA25RL2N	1/0 ACSR (6-1) 1/0 6201 (7) 1/0 AAC (7) 1/0 5005 (7)	1-1/8	7		C, 247, 702	WC (12) W702 (4)**	U247 (3)	
YCA26RL2N	2/0 ACSR (6-1) 2/0 6201 (7) 2/0 AAC (7) 2/0 5005 (7)				6-1/2	6-1/2	659	—
YCA27RL2N	3/0 ACSR (6-1) 3/0 6201 (7) 3/0 AAC (7)	1-1/4	658				—	U658 (3)
YCA28RL2N	4/0 ACSR (6-1) 4/0 6201 (7) 4/0 AAC (7) 4/0 5005 (7)	1-1/2	654				—	U654 (3)
YCA321RL2N	336.4 ACSR (18-1) 336.4 AAC (19) 500 AAC	1-5/8	655				—	U655 (3)

† U Die with adapter PT6515.

‡ U Die with adapter PUADP1.

** MD6 NON-BOW Dies produce straight sleeves without rotating tool.
For faster installations use BURNDY® PATRIOT® family of battery tools.

HYLUG™ Terminals, Types YCA-R-N, YCAK-R-N
 For AAC (Stranded, Compressed, Compact), ACSR, AAAC

Material: Aluminum

Aluminum compression HYLUG™ for terminating jumper loops and equipment taps at switchpads and other substation apparatus, or to Type YDW-R deadends. NEMA standard mounting holes. Installed with same dies as equivalent full-tension sleeves. Prefilled with PENETROX™ joint compound, stripealed, and capped to limit oxide growth and increase the life of the connection.

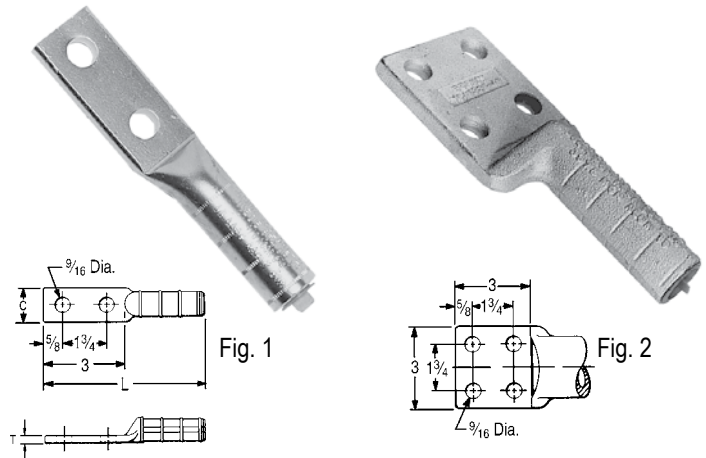

Catalog Number	Conductor		Fig No.	C	L	T	Die Index	Die Set, Tool Series Catalog Number, & (Number of Crimps)				
	ACSR, 6201, 5005	Aluminum						MD7, MD6 Series	35, 750	Y45	46	60
YCA4R2N	4	4 (7)	1	1-1/4	5-5/8	1/4	237	W237 (3)	U237 (2)	†	‡	—
YCA2R2N	2	2 (7)		239	W239 (3)		U239 (2)	†	‡	—		
YCA25R2N	1/0	1/0 (7,19)	2	7/8	6-1/4	3/8	KS18 243 BG or 8A	BG (8) WBG (4)* U243 (2)	U-BG (4)	†	‡	—
YCAK25R4N				3	6-7/8			BG (8) WBG (4)* U243 (2)	U243 (2)	†	‡	L243 (1)
YCA26R2N	2/0	2/0 (7,19)	1	1	6-3/8	1/4	245AA	W245 (4)	U245 (2)	†	‡	L245 (1)
YCA27R2N	3/0 - 110.8 (12-7)	3/0 (7,19)		1-1/8	6-3/4		247	W247 (6)	U247 (3)	†	‡	L247 (2)
YCA28R2N	4/0 (6-1, 6-7)	4/0 (7,19)	2	1-1/4	6-7/8	3/8	249	K840 249 11A	U249 (3)	†	‡	L249 (2)
YCAK28R4N				3	7-3/8					†	‡	
YCA30R2N	266.8 (18-1, 6-7 26-7)	266.8 (7,19)	2	1	1-1/2	3/8	251	—	U251 (4)	†	‡	L251 (2)
YCAK30R4N				3	7-3/8					†	‡	
YCA321R2N	336.4 (18-1)	336.4 (19) - 350 (19, 37, 61)	2	1	1-1/2	7/16	321	—	U321 (4)	†	‡	L321 (2)
YCAK321R4N				3	7-1/8					†	‡	
YCA33R2N	336.4 (26-7, 30-7) 397.5 (18-1)	397.5 (19)	2	1	1-5/8	3/8	316	—	U316 (4)	†	‡	L316 (2)
YCAK33R4N				3	7-3/8					†	‡	
YCA35R2N	397.5 (26-7, 30-7)	477 (19, 37) - 500 (37, 61)	2	1	1-7/8	7/16	317	—	U317 (4)	†	‡	L317 (2)
YCAK35R4N				3	7-3/8					†	‡	
YCA361R2N	477 (18-1)	500 (37, 61)	2	1	1-7/8	3/8	327	—	U327 (4)	†	‡	L327 (2)
YCAK361R4N				3	7-5/8					†	‡	
YCA37R2N	556.5 (18-1) 477 (24-7, 26-7, 30-7)	556.5 (19, 37)	2	1	2	1/2	261	—	U261 (5)	†	‡	L261 (2)
YCAK37R4N				3	8-1/8					†	‡	
YCA39R2N	556.5 (24-7, 26-7)	—	2	1	2-1/8	3/8	608	—	U608 (6)	†	‡	L608 (2)
YCAK39R4N				3	8-1/8					†	‡	
YCAK361A4N	—	636 (37)	2	3	8-1/8	1/2	469	—	—	—	P469 (6)	L469 (2)

* Multiple crimp die set; makes more than one crimp per tool compression. Figure indicates number of compressions.
 † U Die with adapter PT6515.
 ‡ U Die with adapter PUADP1.

YCA HYLUGS™ are made from heavy walled tubing. YCA4R-2N, YCA2R-2N and all YCAK HYLUGS™ are cast aluminum alloy. For faster installations use BURNDY® PATRIOT® family of battery tools.

(Table continued on next page.)

HYLUG™ Terminals, Types YCA-R-N, YCAK-R-N For AAC (Stranded, Compressed, Compact), ACSR, AAAC (Continued)

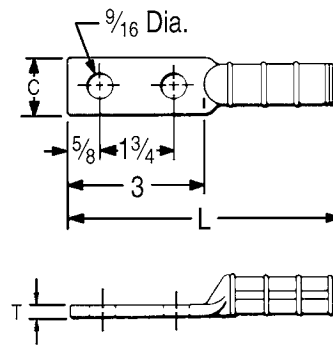

Fig. 1

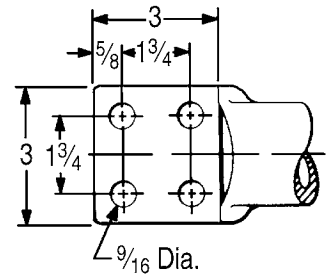

Fig. 2

Catalog Number	Conductor		Fig No.	C	L	T	Die Index	Die Set, Tools Catalog Number, & (Number of Crimps)		
	ACSR, 6201, 5005	Aluminum						Y45	46	60
YCA43R2N	605 (30-19)	795 (37, 61)	1	2-1/2	10-1/4	3/4	292 or 319	S292 (6) S319 (6)	P292 (6) P319 (6)	L292 (3) L319 (3)
YCAK43R4N	636 (24-7, 26-7, 30-19) 666.6 (24-7)	700 (61) 750 (61)	2	3	9-5/8					
YCA391A2N	—	795 (37)	1	2-3/8	10-1/8	5/8	342	S342 (6)	P342 (6)	L342 (3)
YCAK391A4N	—	750 (61)			9-7/8					
YCAK453R4N	795 (36-1) 715.5 (26-7) 795 (45-7)	—	2	3	9-5/8	5/8	292*, 578	S292 (6)	P292 (6)	L292 (3)
YCA44A2NG2	—	1000	1	2-3/8	11	5/8	342	S342 (6)	P342 (6)	L342 (3)
YCA45R2N	795 (26-7, 54-7)	900 (61, 91) 954 (37, 61)			2-1/2					
YCAK45R4N		1000 (61)	9-5/8							
YCA48R4N	900 (54-7) 954 (54-7) (45-7) 1033.5 (45-7) (36-1)	—	2	3	10	3/4	575	—	—	L575 (3)
YCA441A4N	—	1033.5 (37, 61) - 113 (61)								
YCA451A4N	1113 (54-19)	1272 (61)			10-1/4	5/8	422	—	—	L422 (3)

* Multiple crimp die set; makes more than one crimp per tool compression.
Figure indicates number of compressions.
YCA HYLUGS™ are made from heavy walled tubing.
YCA4R-2N, YCA2R-2N and all YCAK HYLUGS™ are cast aluminum alloy.
For faster installations use BURNDY® PATRIOT® family of battery tools.

Stacking HYLUG™ Terminals, Type YAK-A-2G
For AAC (Stranded, Compressed)

Material: Aluminum

Cast aluminum HYLUG™ with a special tongue configuration for stacking of conductors on two and four hole NEMA transformer or equipment terminal pads. Up to eight conductors may be staked on one four hole NEMA pad. These stackable HYLUG™ terminals are prefilled with PENETROX™ joint compound, stripsealed, and capped to limit oxide growth and increase the life of the connection.

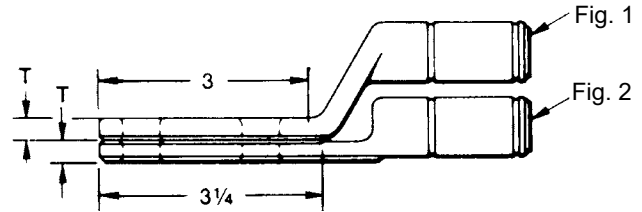
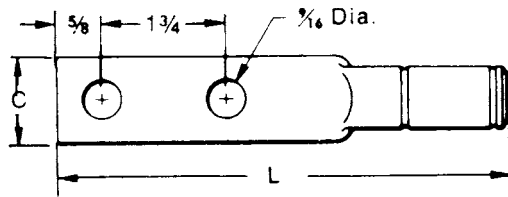
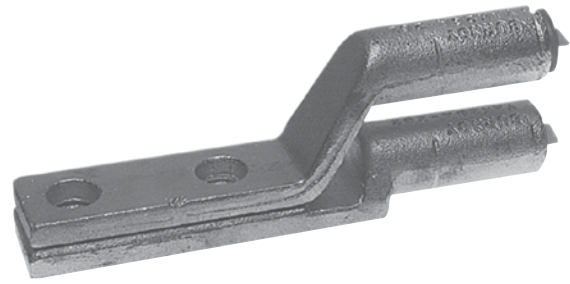

Catalog Number	Fig No.	Conductor	C	L	T	Die Index	Tool Series, Die Set & (Number of Crimps)			
							MD7, MD6 Series	35, 750	Y45	46
YAK2CA2G1	1	2 Str.	7/8	5-5/8	1/4	BG K-5/8 243	BG (3) WBG (1) W243 (1)	UBG (1) UK581T (3) U243 (1)	†	‡
YAK2CA2G2	2									
YAK25A2G1	1	1/0 Str.	1-1/8	6-1/4	5/16	249 K-840	W249* WK840*	U249*	†	‡
YAK25A2G2	2									
YAK28A2G1	1	4/0 Str.**	1-1/8	6-1/4	5/16	249 K-840	W249* WK840*	U249*	†	‡
YAK28A2G2	2									
YAK29A2G1	1	250	1-5/8	6-7/8	3/8	299 705	—	U31ART* U705	†	‡
YAK31A2G1	1	350								
YAK31A2G2	2									
YAK311A2G1	1	397.5		7-3/4	7/16	317 705	—	U317* U705*	†	‡
YAK311A2G2	2									
YAK34A2G1	1	500		8-1/4	5/8	608 722 786	—	U608* U786*	† S786* S722*	‡ P786* P722*
YAK34A2G2	2									
YAK361A2G1	1	600 636		8-1/4	5/8	608 722 786	—	U608* U786*	† S786* S722*	‡ P786* P722*
YAK361A2G2	2									
YAK39A2G1	1	700 750		8-1/4	5/8	608 722 786	—	U608* U786*	† S786* S722*	‡ P786* P722*
YAK39A2G2	2									
YAK44A2NG8	1	1000		8-7/8	5/8	302	—	—	S44ART*	†
YAK44A2NG7	2									

* Overlap crimps.

** Accommodates 4/0 Str., Al or Cu.

† U Die with adapter PT6515.

‡ U Die with adapter PUADP1.

For faster installations use BURNDY® PATRIOT® family of battery tools.

Aluminum HYLUG™ Terminals, Types YCAK-A, YRA For AAC (Stranded, Compressed), ACSR, Copper

Material: Aluminum

Aluminum HYLUG™ terminals for joining aluminum and copper cable to transformer and equipment pads. HYLUG™ terminals are prefilled with PENETROX™ joint compound, stripsealed, and capped to limit oxide growth and increase the life of the connection. Installed with standard tooling, five die sets install fourteen terminal sizes.

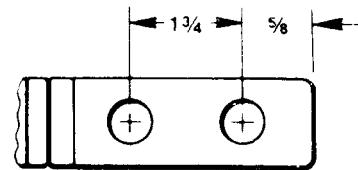
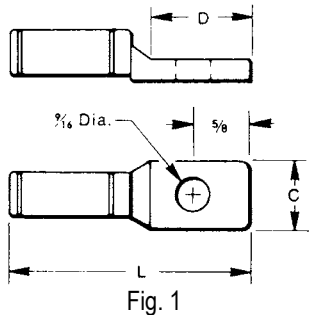
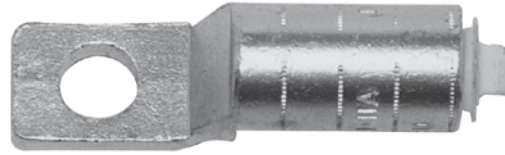

Fig. 2

Catalog Number	Fig No.	Conductor			C	D	L	Die Index	Die Set, Tool Catalog Number & (Number of Crimps)			
		Copper	Aluminum Conc.& Compact	ACSR					MD7, MD6 Series	35, 750	Y45	46
YRA8CU1	1	6 Sol. - 8 Sol.	8 Str.	—	15/16	1-1/16	2-9/16	BG 243	BG (3) K 5/8 243 (1)	UBG (1) UK5/81T (3) U243 (1)	†	‡
YRA6CU1		4 Sol. - 6 Str.	4 Sol. - 6 Str.	6 (6-1)								
YRA4CU1		2 Sol. - 4 Str.	2 Sol. - 4 Str.	4 (6-1, 7-1)								
YRA1CU1		1 Str. - 2 Str.	1 Str. - 2 Str.**	2 (6-1, 7-1)								
YRA25A1		—	1/0 Str.	—								
YRAL4CU		2 Sol. - 4 Str.	2 Sol. - 4 Str.	4 (6-1, 7-1)		1-1/4	3-1/4	249 K840	W249* WK840*	U249* UK840	†	‡
YRAL1CU		1 Str. - 2 Str.	1 Str. - 2 Str.	2 (6-1, 7-1)								
YRA25U		1/0 Str.	1/0 Str.	1/0 (6-1)								
YRA26U		2/0 Str.	2/0 Str.	2/0 (6-1)								
YRA27U		3/0 Str.	3/0 Str.	—								
YRA28U		4/0 Str.	4/0 Str.	—		1-1/4	3	5-5/8	317 705	—	U317* U705*	† S705*
YCAK28A2G1*	4/0 Str.	4/0 Str.	—									
YCAK29A2G1*	250	250	4/0 (6-1)									
YCAK31AG1*	350	350	—									
YCAK31A2G1*			—									
YCAK34A2G3*	500	500	—	1-1/2	3	6-1/2	608 786	—	U608* U786*	† S786*	‡ P786*	
YCAK36A2G1*	—	600	—									
YCAK39A2G2*	—	750	—									
YCAK44A2G2*	—	1000	—									
YCAK44A2G2*	—	—	—									1-11/16

* Overlap crimps.

** YRA1CU-1 not recommended for 2 comp. conductor.

† U Die with adapter PT6515.

‡ U Die with adapter PUADP1.

For faster installations use BURNDY® PATRIOT® family of battery tools.