

TYPE YAV-M

HYLUG™

Uninsulated Copper Compression Terminal
Rated for 90° C, Up to 35 kV ◆

Made from electrolytic copper tube and is electro-tin plated. Wire range is from 2.5 mm² to 630 mm² Class 2. Compatible to **IEC61238-1**.

NOTE: Field bending straight lugs to achieve an angular connection will void UL Listing / CSA Certifications and BURNDY will not be liable for the connection.

Features & Benefits

- Inspection window allows for visual verification that the wire has been fully inserted prior to crimping the lug
- Barrel is designed with an internal chamfer at the wire entry to ensure smooth insertion of the wire, preventing possible damaging of the wire strands during installation
- Short/standard length barrel is recommended for installation with limited space requirements
- Electro-tin plated unless specified to reduce galvanic corrosion (bimetallic) and resist corrosive elements
- Compatible Standards: IEC61238-1, UL 486A-486B, CSA-C22.2 No. 65-03
- Connectors are clearly marked with stamping
- Terminals and splices accommodating code wire: Accommodates Code Class B (Concentric, Compressed, Compact) and Class C wire

Accessories

- Hardware - Section F
- PENETROX™ Oxide Inhibitor - Section F
- Heat and Cold Shrink Tubing - Section D
- WIREMIKE™ Wire Micrometer - Section F
- Wire Management (Cable Ties) - Section G

Electro-Tin
Plated

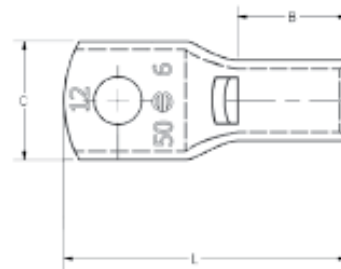
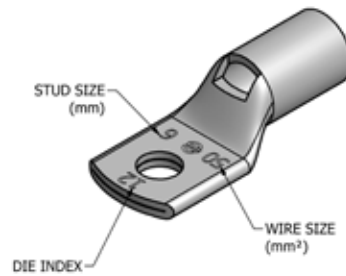

TYPE YAV-M (Continued)

Electro-Tin
Plated



NOTE: Field bending straight lugs to achieve an angular connection will void UL Listing / CSA Certifications and BURNDY will not be liable for the connection.

Catalog Number	Copper		Stud Size	Dimensions (mm)				Installation Tooling					Wire Strip Length
	Wire Range mm ² (AWG)	Class		(B)	(C)	(L)	Tongue Thickness	Dieless	MD6, OUR840, MD734R	500 Series	35, 750, 46** Series	Die Index	
YAV025M3	1.5 - 2.5 (20 - 14)	2, 5	M3	6.7	7.9	19.1	1.0	Y10D (1) Y1022 (1) MR8G98 (1) MR89Q (1) Y8MRB1 (1) MR20 (1)	—	—	—	—	7
YAV025M4			M4	6.7	7.9	19.1	1.0						
YAV025M5			M5	6.7	7.9	19.1	1.0						
YAV025M6			M6	6.7	10.7	24.2	0.8						
YAV025M8			M8	6.7	11.0	24.2	0.8						
YAV06M35	4 - 6 (12 - 10)	2, 5	M3.5	10.5	7.6	23.7	1.8	Y1MRTC (1) MY2911 (1) MRC840 (1) 81K Series (1)	—	—	—	—	11
YAV06M4			M4	10.4	9.5	23.9	1.5						
YAV06M5			M5	10.4	9.5	23.9	1.5						
YAV06M6			M6	10.4	11.9	26.9	1.3						
YAV06M8			M8	10.4	13.5	28.7	1.0						
YAV06M10			M10	9.5	14.2	31.0	1.0						
YAV10M4	10 (8)	2, 5	M4	11.2	10.4	29.1	2.0	Y1MRTC (1) MY2911 (1) MRC840 (1) 81K Series (1)	W8CVT (1) W8CRT (1) X8CRT (1)	W8CVT (1) W8CRT (1) X8CRT (1)	U8CRT (1)	49	11
YAV10M5			M5	11.2	10.4	28.5	1.8						
YAV10M6			M6	11.2	1.0	31.0	1.8						
YAV10M8			M8	11.2	13.2	33.0	1.5						
YAV10M10			M10	11.2	14.5	33.0	1.3						
YAV10M12			M12	11.2	18.5	38.6	1.3						
YAV16M4	16 (6)	2, 5	M4	12.7	12.2	31.5	2.3	Y1MRTC (1) MY2911 (1) MRC840 (1) 81K Series (1)	W5CVT (1) W5CRT (1) X5CRT (1)	W5CVT (1) W5CRT (1) X5CRT (1)	U5CRT (1)	7	13
YAV16M5			M5	12.7	12.2	33.0	2.0						
YAV16M6			M6	12.7	12.2	33.0	2.0						
YAV16M8			M8	12.7	15.2	36.3	1.5						
YAV16M10			M10	12.7	14.7	40.9	1.5						
YAV16M12			M12	12.7	18.8	41.6	1.3						
YAV25M5	25 (4)	2, 5	M5	12.7	14.0	33.5	2.3	Y1MRTC (2) MY2911 (1) MRC840 (1) 644 Series (1) 444 Series (1) 81K Series (1)	W3CRT (1)	W3CRT (1)	U3CRT (1)	9	13
YAV25M6			M6	12.7	12.7	34.5	2.0						
YAV25M8			M8	12.7	16.0	37.6	2.0						
YAV25M10			M10	12.7	14.7	41.4	2.0						
YAV25M12			M12	12.7	18.5	42.7	1.5						
YAV35M5	35 (2)	2, 5	M5	16.0	17.3	38.1	2.5	MY2911 (1) MRC840 (2) 644 Series (1) 444 Series (1) 81K Series (1)	W2CVT (1) W2CRT (1) X2CRT (1)	W2CVT (1) W2CRT (1) X2CRT (1)	U2CRT (1)	10	17
YAV35M6			M6	11.7	17.3	43.7	2.5						
YAV35M8			M8	11.7	17.3	43.7	2.5						
YAV35M10			M10	11.7	17.3	45.9	2.5						
YAV35M12			M12	11.7	19.6	47.5	2.3						
YAV35M16			M16	11.7	21.1	58.7	3.0						
YAV50M5	50 (2)	2	M5	16.0	17.3	38.1	2.5	MY2911 (1) MRC840 (2) 644 Series (1) 444 Series (1) 81K Series (1)	W25VT (2) W25RT (2) X25RT (2)	W25VT (2) W25RT (2) X25RT (2)	U25RT (1)	12	17
YAV50M6			M6	16.0	17.3	38.1	2.5						
YAV50M8			M8	16.0	17.3	42.9	2.5						
YAV50M10			M10	16.0	17.3	45.9	2.5						
YAV50M12			M12	16.0	18.5	52.3	2.5						
YAV50M14			M14	16.0	21.1	53.3	3.0						
YAV50M16	M16	16.0	25.9	58.7	3.6								

* Use equivalent AWG setting on tool for installation

** PUADP1 Adaptor is required to use U Dies in 46 Series

† P-RT Die sets for use in 46 Series tools only, PUADP1 Adaptor not required

Compression Connections

Copper Compression — Code — One Hole
Standard Barrel — Metric Lugs

TYPE YAV-M (Continued)

Electro-Tin
Plated



NOTE: Field bending straight lugs to achieve an angular connection will void UL Listing / CSA Certifications and BURNDY will not be liable for the connection.

Catalog Number	Copper		Stud Size	Dimensions (mm)				Installation Tooling					Wire Strip Length
	Wire Range mm ² (AWG)	Class		(B)	(C)	(L)	Tongue Thickness	Dieless	MD6, OUR840, MD734R	500 Series	35, 750, 46** Series	Die Index	
YAV70M5	70 (1/0)	2	M5	17.5	21.1	41.4	3.0	MY2911 (1) MRC840 (2) 644 Series (1) 444 Series (1) 81K Series (1)	W26VT (2) W26RT (2) X26RT (2)	W26VT (2) W26RT (2) X26RT (2)	U26RT (1)	13	19
YAV70M6			M6	17.5	21.1	44.5	3.0						
YAV70M8			M8	17.5	21.1	46.0	3.0						
YAV70M10			M10	17.5	21.1	49.3	3.0						
YAV70M12			M12	17.5	21.1	55.6	3.0						
YAV70M14			M14	17.5	22.4	56.6	2.8						
YAV70M16	M16	17.5	22.4	62.0	2.8								
YAV95M6	95 (2/0)	2	M6	20.6	23.6	45.8	3.3	MY2911 (1) MRC840 (2) 644 Series (1) 444 Series (1) 81K Series (2)	W27VT (2) W27RT (2) X27RT (3)	W27VT (2) W27RT (2) X27RT (3)	U27RT (1)	14	22
YAV95M8			M8	20.6	23.6	50.3	3.3						
YAV95M10			M10	20.6	23.6	53.6	3.3						
YAV95M12			M12	20.6	23.6	59.9	3.3						
YAV95M14			M14	20.6	23.6	61.0	3.3						
YAV95M16			M16	20.6	23.6	66.3	3.3						
YAV95M20	M20	20.6	30.5	77.4	4.1								
YAV120M6	120 (4/0)	2	M6	26.2	29.0	53.6	3.8	MY2911 (1) MRC840 (2) 644 Series (1) 444 Series (1) 81K Series (2)	W28VT (2) W28RT (2) X28RT (2)	W28VT (2) W28RT (2) X28RT (2)	U28RT (1)	15	27
YAV120M8			M8	26.2	29.0	58.2	3.8						
YAV120M10			M10	26.2	29.0	61.5	3.8						
YAV120M12			M12	26.2	29.0	67.8	3.8						
YAV120M14			M14	26.2	29.0	68.8	3.8						
YAV120M16			M16	26.2	29.0	74.2	3.8						
YAV120M20	M20	26.2	29.0	85.2	3.8								
YAV150M8	150 (300)	2	M8	26.2	30.5	58.7	4.1	MY2911 (1) MRC840 (2) 644 Series (1) 444 Series (1) 81K Series (2)	W30VT (2)	W30VT (2) W30RT (2)	U30RT (2)	17	27
YAV150M10			M10	26.2	30.5	62.0	4.1						
YAV150M12			M12	26.2	30.5	68.3	4.1						
YAV150M14			M14	26.2	30.5	69.2	4.1						
YAV150M16			M16	26.2	30.5	74.7	4.1						
YAV150M20			M20	26.2	30.5	85.7	4.1						
YAV185M8	185 (350)	2	M8	26.9	32.8	60.2	4.6	644 Series (1) 444 Series (1) 81K Series (2)	W31VT (2)	W31VT (2) W31RT (2)	U31RT (2)	18	29
YAV185M10			M10	26.9	32.8	63.5	4.3						
YAV185M12			M12	26.9	32.8	69.9	4.3						
YAV185M14			M14	26.9	32.8	70.8	4.6						
YAV185M16			M16	26.9	32.8	76.2	4.6						
YAV185M20			M20	26.9	32.8	87.3	4.6						
YAV240M10	240 (500)	2	M10	32.3	39.4	72.9	5.8	MY2911 (1) MRC840 (2) 644 Series (1) 444 Series (1) 81K Series (2)	W34VT (2)	W34VT (2) W34RT (2)	U34RT (2)	20	33
YAV240M12			M12	32.3	39.4	80.2	5.6						
YAV240M14			M14	32.3	39.4	81.3	5.8						
YAV240M16			M16	32.3	39.4	85.6	5.8						
YAV240M20			M20	32.3	39.4	96.6	5.8						
YAV300M10			300 (600)	2	M10	35.1	44.2						
YAV300M12	M12	35.1			44.2	83.6	6.6						
YAV300M14	M14	35.1			44.2	84.6	6.9						
YAV300M16	M16	35.1			44.2	89.9	6.9						
YAV300M20	M20	35.1			44.2	100.9	6.9						

* Use equivalent AWG setting on tool for installation.

** PUADP1 Adaptor is required to use U Dies in 46 Series tools.

† P-RT Die sets for use in 46 Series only, PUADP1 Adaptor not required.

TYPE YAV-M (Continued)

Electro-Tin
Plated

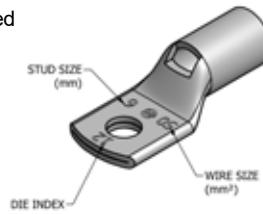

NOTE: Field bending straight lugs to achieve an angular connection will void UL Listing / CSA Certifications and BURNDY will not be liable for the connection.

Catalog Number	Copper		Stud Size	Dimensions (mm)				Installation Tooling					Wire Strip Length
	Wire Range mm ² (AWG)	Class		(B)	(C)	(L)	Tongue Thickness	Dieless	MD6, OUR840, MD734R	500 Series	35, 750, 46** Series	Die Index	
YAV400M12	400 (800)	2	M12	36.1	50.3	87.1	7.6	644 Series (1) 444 Series (1) 81K Series (3)	—	—	U39RT (3)	24	37
YAV400M14			M14	36.1	50.3	88.1	7.6						
YAV400M16			M16	36.1	50.3	93.5	7.6						
YAV400M20			M20	36.1	50.3	104.5	7.6						
YAV500M12	500 (1000)	2	M12	41.9	55.6	96.2	8.1	—	—	U44XRT (3) •P44XRT (3)	L115	43	
YAV500M16			M16	41.9	55.6	102.6	8.4						
YAV500M20			M20	41.9	55.6	113.7	8.4						
YAV630M12	630 (1250)	2	M12	50.8	62.5	107.7	9.7	—	—	P45RT (3)	29	55	
YAV630M16			M16	50.8	62.5	114.0	9.7						
YAV630M20			M20	50.8	62.5	125.2	9.7						

* Use equivalent AWG setting on tool for installation

** PUADP1 Adaptor is required to use U Dies in 46 Series

- P-RT dies for 46 Series Tooling only

TYPE YALB-M

HYLUG™

Rated for 90° C, Up to 35 kV ♦

Made from electrolytic copper tube and is electro-tin plated. Wire range is from 2.5 mm² to 630 mm² Class 2. Compatible to **IEC61238-1**.

NOTE: Field bending straight lugs to achieve an angular connection will void UL Listing / CSA Certifications and BURNDY will not be liable for the connection.

Features & Benefits

- No inspection window is ideal for more corrosive environments as the barrel transition is not open
- Barrel is designed with an internal chamfer at the wire entry to ensure smooth insertion of the wire, preventing possible damaging of the wire strands during installation
- Long barrel allows for an increased number of crimps which will increase the mechanical strength of the connection
- Electro-tin plated unless specified to reduce galvanic corrosion (bimetallic) and resist corrosive elements
- Compatible Standards: IEC61238-1, UL 486A-486B, CSA-C22.2 No. 65-03
- Terminals and splices accommodating code wire: Accommodates Code Class B (Concentric, Compressed, Compact) and Class C wire

Accessories

- Hardware - Section F
- PENETROX™ Oxide Inhibitor - Section F
- Heat and Cold Shrink Tubing - Section D
- WIREMIKE™ Wire Micrometer - Section F
- Wire Management (Cable Ties) - Section G

Electro-Tin
Plated

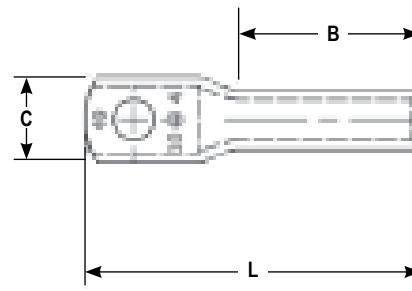
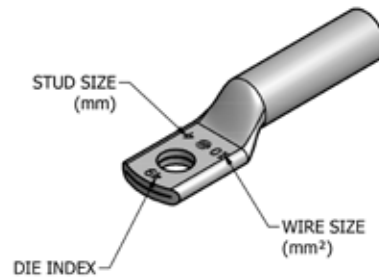

TYPE YALB-M (Continued)

NOTE: Field bending straight lugs to achieve an angular connection will void UL Listing / CSA Certifications and BURNDY will not be liable for the connection.

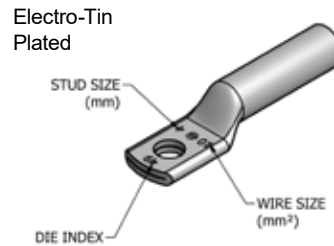

Catalog Number	Wire Range (MM²)	Stud Size	Dimensions (mm)				Installation Tooling					Wire Strip Length
			Tongue Thickness	(B)	(C)	(L)	Dieless	MD6, OUR840, MD734R	500 Series	35, 750, 46** Series	Die Index	
YALB10M4	10	M4	2.3	20.6	9.7	38.1	Y1MRTC (2) MY2911 (1) MRC840 (2) 81K Series (1)	W8CVT (2) W8CRT (2) X8CRT (2)	W8CVT (2) W8CRT (2) X8CRT (2)	U8CRT (2)	49	22
YALB10M5		M5	2	20.6	10.4	39.9						
YALB10M6		M6	2	20.6	11.2	42.9						
YALB10M8		M8	1.5	20.6	13.2	44.5						
YALB10M10		M10	1.5	20.6	14.7	47.8						
YALB10M12		M12	3	20.6	21.1	58.9						
YALB16M4	16	M4	2	28.4	11.4	47.2	Y1MRTC (2) MY2911 (2) MRC840 (2) 81K Series (1)	W5CVT (2) W5CRT (2) X5CRT (2)	W5CVT (2) W5CRT (2) X5CRT (2)	U5CRT (2)	7	30
YALB16M5		M5	2	28.4	11.4	48.8						
YALB16M6		M6	2	28.4	12.2	51.8						
YALB16M8		M8	1.8	28.4	13.2	53.6						
YALB16M10		M10	1.5	28.4	14.7	59.2						
YALB16M12		M12	3	28.4	19.1	63.0						
YALB25M5	25	M5	2.3	31.8	14	53.6	Y1MRTC (2) MY2911 (2) MRC840 (2) 81K Series (1)	W3CRT (2)	W3CRT (2)	U3CRT (2)	9	33
YALB25M6		M6	2.3	31.8	14	56.6						
YALB25M8		M8	2.3	31.8	14	58.4						
YALB25M10		M10	2	31.8	14.7	61.5						
YALB25M12		M12	3	31.8	21.1	67.8						
YALB35M5		35	M5	2.5	35.1	17.3						
YALB35M6	M6		2.5	35.1	17.3	60.7						
YALB35M8	M8		2.5	35.1	17.3	62.2						
YALB35M10	M10		2.5	35.1	17.3	65.5						
YALB35M12	M12		3	35.1	21.1	71.9						
YALB50M6	50		M6	2.5	35.1	17.3	60.7	MY2911 (2) MRC840 (4) 644 Series (1) 444 Series (1) 81K Series (1)	W25VT (4) W25RT (4) X25RT (4)	W25VT (4) W25RT (4) X25RT (4)	U25RT (2)	12
YALB50M8		M8	2.5	35.1	17.3	62.2						
YALB50M10		M10	2.5	35.1	17.3	65.5						
YALB50M12		M12	3	35.1	21.1	71.9						
YALB50M14		M14	3	35.1	21.1	72.9						
YALB50M16		M16	3	35.1	21.1	78.2						
YALB70M6	70	M6	3	38.1	21.1	65.5	MY2911 (2) MRC840 (4) 644 Series (1) 444 Series (1) 81K Series (2)	W26VT (4) W26RT (4) X26RT (4)	W26VT (4) W26RT (4) X26RT (4)	U26RT (2)	13	40
YALB70M8		M8	3	38.1	21.1	67.3						
YALB70M10		M10	3	38.1	21.1	70.4						
YALB70M12		M12	3	38.1	21.1	76.7						
YALB70M14		M14	3	38.1	21.1	77.7						
YALB70M16		M16	3	38.1	21.1	86.4						
YALB95M8	95	M8	3.3	38.1	23.6	68.6	MY2911 (2) MRC840 (4) 644 Series (1) 444 Series (1) 81K Series (2)	W27VT (4) W27RT (4) X27RT (4)	W27VT (4) W27RT (4) X27RT (4)	U27RT (2)	14	40
YALB95M10		M10	3.3	38.1	23.6	71.6						
YALB95M12		M12	3.3	38.1	23.6	78						
YALB95M14		M14	3.3	38.1	23.6	79						
YALB95M16		M16	3.3	38.1	23.6	84.3						
YALB95M20		M20	4.1	38.1	30.5	95.5						

* Use equivalent AWG setting on tool for installation

** PUADP1 Adaptor is required to use U Dies in 46 Series

- P-RT dies for 46 Series Tooling only

Compression Connections

Copper Compression — Code — One Hole
Long Barrel — Metric Lugs

TYPE YALB-M (Continued)

NOTE: Field bending straight lugs to achieve an angular connection will void UL Listing / CSA Certifications and BURNDY will not be liable for the connection.

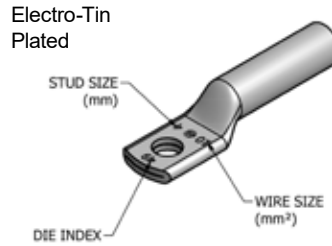

Catalog Number	Wire Range (MM²)	Stud Size	Dimensions (mm)			Installation Tooling					Wire Strip Length	
			Tongue Thickness	(B)	(C)	(L)	Dieless	MD6, OUR840, MD734R	500 Series	35, 750, 46** Series		Die Index
YALB120M8	120	M8	3.6	41.1	29	73.9	MY2911 (2) MRC840 (4) 644 Series (1) 444 Series (1) 81K Series (2)	W28VT (4) W28RT (4) X28RT (6)	W28VT (4) W28RT (4) X28RT (6)	U28RT (2)	15	43
YALB120M10		M10	3.6	41.1	29	77.2						
YALB120M12		M12	3.6	41.1	29	83.6						
YALB120M14		M14	3.6	41.1	29	84.6						
YALB120M16		M16	3.6	41.1	29	89.9						
YALB120M20		M20	4.3	41.1	30.5	101.1						
YALB150M8	150	M8	4.1	50.8	30.5	84.1	644 Series (1) 444 Series (1) 81K Series (3)	W30VT (4)	W30VT (4)	U30RT (4)	17	52
YALB150M10		M10	4.1	50.8	30.5	87.4						
YALB150M12		M12	4.1	50.8	30.5	93.7						
YALB150M14		M14	4.1	50.8	30.5	94.7						
YALB150M16		M16	4.1	50.8	30.5	100.1						
YALB150M20		M20	4.1	50.8	30.5	111.3						
YALB185M8	185	M8	4.3	50.8	32.8	85.1		W31VT (4)	W31VT (4)	U31RT (4)	18	52
YALB185M10		M10	4.3	50.8	32.8	88.4						
YALB185M12		M12	4.3	50.8	32.8	94.7						
YALB185M14		M14	4.3	50.8	32.8	95.3						
YALB185M16		M16	4.3	50.8	32.8	101.1						
YALB185M20		M20	4.3	50.8	32.8	112.3						
YALB240M10	240	M10	5.6	57.2	39.4	98	W34VT (4)	W34VT (4)	U34RT (4)	20	59	
YALB240M12		M12	5.6	57.2	39.4	105.2						
YALB240M14		M14	5.6	57.2	39.4	106.2						
YALB240M16		M16	5.6	57.2	39.4	111.3						
YALB240M20		M20	5.6	57.2	39.4	122.4						
YALB300M10	300	M10	6.6	68.3	44.2	111.8	644 Series (1) 444 Series (1) 81K Series (4)	—	—	U36RT (4)	22	70
YALB300M12		M12	6.6	68.3	44.2	118.1						
YALB300M14		M14	6.6	68.3	44.2	119.1						
YALB300M16		M16	6.6	68.3	44.2	124.5						
YALB300M20		M20	6.6	68.3	44.2	135.4						
YALB400M12	400	M12	7.6	74.7	50.3	127	—	—	U39RT (4)	24	76	
YALB400M14		M14	7.6	74.7	50.3	128						
YALB400M16		M16	7.6	74.7	50.3	133.4						
YALB400M20		M20	7.6	74.7	50.3	144.3						
YALB500M12	500	M12	8.1	76.2	55.6	132.1	—	—	U44XRT (4) P44XRT (4)	L115	78	
YALB500M16		M16	8.1	76.2	55.6	138.4						
YALB500M20		M20	8.1	76.2	55.6	149.4						
YALB630M12	630	M12	9.7	81	62.5	139.4	—	—	P45RT (6)	29	83	
YALB630M16		M16	9.7	81	62.5	145.8						
YALB630M20		M20	9.7	81	62.5	157						

* Use equivalent AWG setting on tool for installation.

** PUADP1 Adaptor is required to use U Dies in 46 Series tools.

† P-RT Die sets for use in 46 Series only, PUADP1 Adaptor not required.

TYPE YAV-2M

HYLUG™

Rated for 90° C, Up to 35 kV ♦

Made from electrolytic copper tube and is electro-tin plated. Wire range is from 2.5 mm² to 630 mm² Class 2. Compatible to IEC61238-1.

NOTE: Field bending straight lugs to achieve an angular connection will void UL Listing / CSA Certifications and BURNDY will not be liable for the connection.

Features & Benefits

- Inspection window allows for visual verification that the wire has been fully inserted prior to crimping the lug; not recommended in highly corrosive environments as the wire in the barrel is exposed to corrosive elements installed
- Barrel is designed with an internal chamfer at the wire entry to ensure smooth insertion of the wire, preventing possible damaging of the wire strands during installation
- Short/standard length barrel is recommended for installations with limited space requirements and meet the exact UL testing requirements as long barrel connectors so performance of the connection is not compromised
- Two hole tongue/tang is recommended when space permits as the 2-hole feature minimizes the terminations from loosening or rotating under vibration, movement, or heat cycling
- Electro-tin plated unless specified to reduce galvanic corrosion (bimetallic) and resist corrosive elements
- Compatible Standards: IEC61238-1, UL 486A-486B, CSA-C22.2 No. 65-03
- Connectors are clearly marked with stamping
- Terminals and splices accommodating code wire: Accommodates Code Class B (Concentric, Compressed, Compact) and Class C wire

Accessories

- Hardware - Section F
- PENETROX™ Oxide Inhibitor - Section F
- Heat and Cold Shrink Tubing - Section D
- WIREMIKE™ Wire Micrometer - Section F
- Wire Management (Cable Ties) - Section G

Electro-Tin
Plated

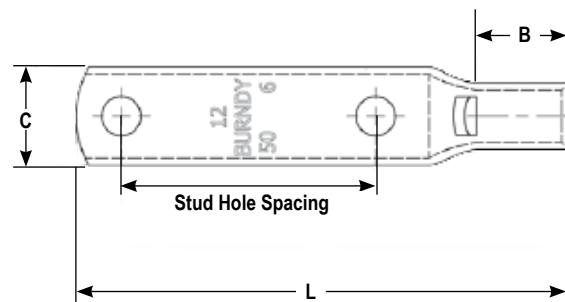

Compression Connections

Copper Compression — Code — Two Hole
Standard Barrel — Metric Lugs

TYPE YAV-2M (Continued)

Electro-Tin
Plated



NOTE: Field bending straight lugs to achieve an angular connection will void UL Listing / CSA Certifications and BURNDY will not be liable for the connection.

Catalog Number	Wire Range (MM ²)	Stud Size	Stud Hole Spacing	Dimensions (mm)				Installation Tooling					Wire Strip Length (mm)	
				Tongue Width	(B)	(C)	(L)	Dieless	MD6, OUR840, MD734R	500 Series	35, 750, 46** Series	Die Index		
YAV0252M3	2.5	M3	25.4	1	170.2	200.7	44.7	Y10D (1)	—	—	—	—	7	
YAV0252M4		M4	25.4	1	170.2	200.7	44.7	Y1022 (1)						
YAV0252M5		M5	25.4	1	170.2	200.7	44.7	MR8G98 (1)						
YAV0252M6		M6	25.4	0.8	170.2	271.8	49.8	MR89Q (1)						
YAV0252M8		M8	25.4	0.8	170.2	279.4	49.8	Y8MRB1 (1)						
YAV062M4	6	M4	25.4	1.5	264.2	241.3	49.5	Y10D (1)	—	—	—	—	11	
YAV062M5		M5	25.4	1.5	264.2	241.3	49.5	Y1022 (1)						
YAV062M6		M6	25.4	1.3	264.2	302.3	52.6	MR8G98 (1)						
YAV062M8		M8	25.4	1	264.2	342.9	53.3	MR89Q (1)						
YAV062M10		M10	25.4	1	302.3	360.7	54.6	Y8MRB1 (1)						
YAV102M4	10	M4	44.5	0	284.5	264.2	73.4	Y1MRTC (1)	W8CVT (1)	W8CVT (1)	U8CRT (1)	49	11	
YAV102M5		M5	44.5	0	284.5	264.2	74.9							MY2911 (1)
YAV102M6		M6	44.5	0	284.5	297.2	78.2							MRC840 (1)
YAV102M8		M8	44.5	0	284.5	335.3	79.8							81K Series (1)
YAV102M10		M10	44.5	0	284.5	348	83.1							
YAV102M12	M12	44.5	0	284.5	469.9	89.4								
YAV162M4	16	M4	44.5	2	322.6	309.9	76.2	Y1MRTC (1)	W5CVT (1)	W5CVT (1)	U5CRT (1)	7	13	
YAV162M5		M5	44.5	2	322.6	309.9	77.7							MY2911 (1)
YAV162M6		M6	44.5	2	322.6	309.9	80.8							MRC840 (1)
YAV162M8		M8	44.5	1.5	322.6	386.1	82.6							81K Series (1)
YAV162M10		M10	44.5	1.5	322.6	373.4	85.6							
YAV162M12	M12	44.5	1.3	322.6	477.5	91.9								
YAV252M5	25	M5	44.5	2	322.6	355.6	78.2	Y1MRTC (2)	W3CRT (1)	W3CRT (1)	U3CRT (1)	9	13	
YAV252M6		M6	44.5	2	322.6	322.6	81.3							MY2911 (1)
YAV252M8		M8	44.5	2	322.6	406.4	83.1							MRC840 (1)
YAV252M10		M10	44.5	2	322.6	373.4	86.1							644 Series (1)
YAV252M12		M12	44.5	1.5	322.6	469.9	92.5							444 Series (1)
YAV352M5	35	M5	44.5	2.5	406.4	439.4	85.9	Y1MRTC (2)	W2CVT (1)	W2CVT (1)	U2CRT (1)	10	17	
YAV352M6		M6	44.5	2.5	406.4	439.4	87.6							MY2911 (1)
YAV352M8		M8	44.5	2.5	406.4	439.4	90.7							MRC840 (1)
YAV352M10		M10	44.5	2.5	406.4	439.4	90.7							644 Series (1)
YAV352M12		M12	44.5	2.5	406.4	439.4	97							444 Series (1)
YAV502M6	50	M6	44.5	2.5	406.4	439.4	85.9	Y1MRTC (2)	W25VT (2)	W25VT (2)	U25RT (1)	12	17	
YAV502M8		M8	44.5	2.5	406.4	439.4	87.6							MY2911 (1)
YAV502M10		M10	44.5	2.5	406.4	439.4	90.7							MRC840 (2)
YAV502M12		M12	44.5	2.5	406.4	469.9	97							644 Series (1)
YAV502M14		M14	44.5	3	406.4	535.9	98							444 Series (1)
YAV502M16	M16	44.5	3	406.4	657.9	103.4	81K Series (1)							
YAV702M6	70	M6	44.5	3	444.5	535.9	89.2	Y1MRTC (2)	W26VT (2)	W26VT (2)	U26RT (1)	13	19	
YAV702M8		M8	44.5	3	444.5	535.9	90.7							MY2911 (1)
YAV702M10		M10	44.5	3	444.5	535.9	94							MRC840 (2)
YAV702M12		M12	44.5	3	444.5	535.9	100.3							644 Series (1)
YAV702M14		M14	44.5	2.8	444.5	569	101.3							444 Series (1)
YAV702M16	M16	44.5	2.8	444.5	569	106.7	81K Series (1)							

* Use equivalent AWG setting on tool for installation.

** PUADP1 Adaptor is required to use U Dies in 46 Series tools.

† P-RT Die sets for use in 46 Series only, PUADP1 Adaptor not required.

TYPE YAV-2M (Continued)

Electro-Tin
Plated



NOTE: Field bending straight lugs to achieve an angular connection will void UL Listing / CSA Certifications and BURNDY will not be liable for the connection.

Catalog Number	Wire Range (MM ²)	Stud Size	Stud Hole Spacing	Dimensions (mm)				Installation Tooling					Wire Strip Length (mm)
				Tongue Width	(B)	(C)	(L)	Dieless	MD6, OUR840, MD734R	500 Series	35, 750, 46** Series	Die Index	
YAV952M8	95	M8	44.5	3.3	523.2	599.4	95	MY2911 (1) MRC840 (2) 644 Series (1) 444 Series (1) 81K Series (2)	W27VT (2) W27RT (2) X27RT (3)	W27VT (2) W27RT (2) X27RT (3)	U27RT (1)	14	22
YAV952M10		M10	44.5	3.3	523.2	599.4	98.3						
YAV952M12		M12	44.5	3.3	523.2	599.4	104.6						
YAV952M14		M14	44.5	3.3	523.2	599.4	105.7						
YAV952M16		M16	44.5	3.3	523.2	599.4	111						
YAV952M20		M20	44.5	4.1	523.2	774.7	122.2						
YAV1202M8	120	M8	44.5	3.6	665.5	736.6	102.9	MY2911 (1) MRC840 (2) 644 Series (1) 444 Series (1) 81K Series (2)	W28VT (3) W28RT (3) X28RT (3)	W28VT (2) W28RT (2) X28RT (3)	U28RT (1)	15	27
YAV1202M10		M10	44.5	3.6	665.5	736.6	106.2						
YAV1202M12		M12	44.5	3.8	665.5	736.6	112.5						
YAV1202M14		M14	44.5	3.6	665.5	736.6	113.5						
YAV1202M16		M16	44.5	3.6	665.5	736.6	118.9						
YAV1202M20		M20	44.5	4.3	665.5	736.6	130						
YAV1502M8	150	M8	44.5	4.1	665.5	774.7	103.4	644 Series (1) 444 Series (1) 81K Series (2)	W30VT (2)	W30VT (2) W30RT (2)	U30RT (2)	17	27
YAV1502M10		M10	44.5	4.1	665.5	774.7	106.7						
YAV1502M12		M12	44.5	4.1	665.5	774.7	113						
YAV1502M14		M14	44.5	4.1	665.5	774.7	114						
YAV1502M16		M16	44.5	4.1	665.5	774.7	119.4						
YAV1502M20		M20	44.5	4.1	665.5	774.7	130.3						
YAV1852M8	185	M8	44.5	4.3	683.3	833.1	104.9	644 Series (1) 444 Series (1) 81K Series (2)	W31VT (2)	W31VT (2) W31RT (2)	U31RT (2)	18	29
YAV1852M10		M10	44.5	4.3	683.3	833.1	108.2						
YAV1852M12		M12	44.5	4.3	683.3	833.1	114.6						
YAV1852M14		M14	44.5	4.3	683.3	833.1	115.6						
YAV1852M16		M16	44.5	4.3	683.3	833.1	120.9						
YAV1852M20		M20	44.5	4.3	683.3	833.1	132.1						
YAV2402M10	240	M10	44.5	5.6	820.4	1000.8	117.6	644 Series (1) 444 Series (1) 81K Series (2)	W34VT (2)	W34VT (2) W34RT (2)	U34RT (2)	20	33
YAV2402M12		M12	44.5	5.6	820.4	1000.8	125						
YAV2402M14		M14	44.5	5.6	820.4	1000.8	125						
YAV2402M16		M16	44.5	5.6	820.4	1000.8	130.3						
YAV2402M20		M20	44.5	5.6	820.4	1000.8	141.2						
YAV3002M10	300	M10	44.5	6.6	175.3	1122.7	121.9	644 Series (1) 444 Series (1) 81K Series (2)	—	—	U36RT (2)	22	35
YAV3002M12		M12	44.5	6.6	167.6	1122.7	128.3						
YAV3002M14		M14	44.5	6.6	175.3	1122.7	129						
YAV3002M16		M16	44.5	6.6	175.3	1122.7	134.6						
YAV3002M20		M20	44.5	6.6	175.3	1122.7	145.5						
YAV4002M14	400	M14	44.5	7.6	193	1277.6	132.8	644 Series (1) 444 Series (1) 81K Series (2)	—	—	U39RT (3)	24	37
YAV4002M16		M16	44.5	7.6	193	1277.6	138.2						
YAV4002M20		M20	44.5	7.6	193	1277.6	149.4						
YAV5002M16	500	M16	44.5	8.1	205.7	1412.2	147.3	644 Series (1) 444 Series (1) 81K Series (2)	—	—	U44XRT (3) † P44XRT (3)	L115	43
YAV5002M20		M20	44.5	8.1	205.7	1412.2	158.5						
YAV6302M16	630	M16	44.5	9.7	246.4	1587.5	158.8	644 Series (1) 444 Series (1) 81K Series (2)	—	—	† P45RT (3)	29	55
YAV6302M20		M20	44.5	9.7	246.4	1587.5	169.9						

* Use equivalent AWG setting on tool for installation

** PUADP1 Adaptor is required to use U Dies in 46 Series

• P-RT dies for 46 Series Tooling only

TYPE YALB-2M

HYLUG™

Rated for 90° C, Up to 35 kV ♦

Made from electrolytic copper tube and is electro-tin plated. Wire range is from 10 mm² to 630 mm² Class 2. Compatible to **IEC61238-1**.

NOTE: Field bending straight lugs to achieve an angular connection will void UL Listing / CSA Certifications and BURNDY will not be liable for the connection.

Electro-Tin
Plated

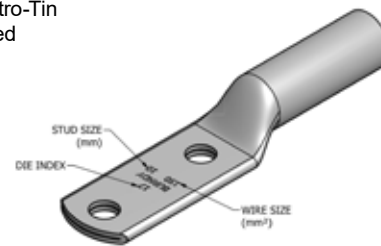

Features & Benefits

- No inspection window is ideal for more corrosive environments as the barrel transition is not open
- Barrel is designed with an internal chamfer at the wire entry to ensure smooth insertion of the wire, preventing possible damaging of the wire strands during installation
- Long barrel allows for an increased number of crimps which will increase the mechanical strength of the connection
- Two hole tongue/tang is recommended when space permits as the 2-hole feature minimizes the terminations from loosening or rotating under vibration, movement, or heat cycling
- Electro-tin plated unless specified to reduce galvanic corrosion (bimetallic) and resist corrosive elements
- Compatible Standards: IEC61238-1, UL 486A-486B, CSA-C22.2 No. 65-03
- Connectors are clearly marked with stamping
- Terminals and splices accommodating code wire: Accommodates Code Class B (Concentric, Compressed, Compact) and Class C wire

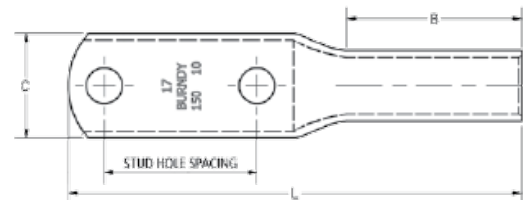

Accessories

- Hardware - Section F
- PENETROX™ Oxide Inhibitor - Section F
- Heat and Cold Shrink Tubing - Section D
- WIREMIKE™ Wire Micrometer - Section F
- Wire Management (Cable Ties) - Section G

TYPE YALB-2M (Continued)

Electro-Tin
Plated



NOTE: Field bending straight lugs to achieve an angular connection will void UL Listing / CSA Certifications and BURNDY will not be liable for the connection.

Catalog Number	Wire Range (MM ²)	Stud Size	Stud Hole Spacing	Dimensions (mm)				Installation Tooling					Wire Strip Length (mm)
				Tongue Thickness	(B)	(C)	(L)	Dieless*	MD6, OUR840, MD734R	500 Series	35, 750, 46** Series	Die Index	
YALB102M4	10	M4	44.5	2.3	20.6	9.9	82.6	Y1MRTC (2) MY2911 (1) MRC840 (2) 81K Series (1)	W8CVT (2) W8CRT (2) X8CRT (2)	W8CVT (2) W8CRT (2) X8CRT (2)	U8CRT (2)	49	22
YALB102M5		M5	44.5	2.0	20.6	10.4	84.3						
YALB102M6		M6	44.5	2.0	20.6	11.2	87.4						
YALB102M8		M8	44.5	1.5	20.6	13.2	88.9						
YALB102M10		M10	44.5	1.5	20.6	14.7	92.2						
YALB102M12		M12	44.5	3.0	20.6	21.1	103.4						
YALB162M4	16	M4	44.5	2.3	28.4	11.4	91.7	Y1MRTC (2) MY2911 (2) MRC840 (2) 81K Series (1)	W5CVT (2) W5CRT (2) X5CRT (2)	W5CVT (2) W5CRT (2) X5CRT (2)	U5CRT (2)	7	30
YALB162M5		M5	44.5	2.3	28.4	11.4	93.2						
YALB162M6		M6	44.5	2.0	28.4	12.2	96.5						
YALB162M8		M8	44.5	1.8	28.4	13.2	98.0						
YALB162M10		M10	44.5	1.5	28.4	14.7	103.6						
YALB162M12		M12	44.5	3.0	28.4	19.1	107.7						
YALB252M5	25	M5	44.5	2.3	31.8	14.0	98.0	81K Series (1)	W3CRT (2)	W3CRT (2)	U3CRT (2)	9	33
YALB252M6		M6	44.5	2.3	31.8	14.0	101.1						
YALB252M8		M8	44.5	2.3	31.8	14.0	102.9						
YALB252M10		M10	44.5	2.0	31.8	14.7	105.9						
YALB252M12		M12	44.5	3.0	31.8	21.1	112.5						
YALB352M5	35	M5	44.5	2.5	35.1	17.3	102.1	Y1MRTC (4) MY2911 (2) MRC840 (2) 644 Series (1) 444 Series (1) 81K Series (1)	W2CVT (2) W2CRT (2) X2CRT (2)	W2CVT (2) W2CRT (2) X2CRT (2)	U2CRT (2)	10	37
YALB352M6		M6	44.5	2.5	35.1	17.3	105.2						
YALB352M8		M8	44.5	2.5	35.1	17.3	106.8						
YALB352M10		M10	44.5	2.5	35.1	17.3	110.0						
YALB352M12		M12	44.5	3.0	35.1	21.1	116.4						
YALB502M6	50	M6	44.5	2.5	35.1	17.3	105.2	MY2911 (2) MRC840 (4) 644 Series (1) 444 Series (1) 81K Series (2)	W25VT (4) W25RT (4) X25RT (4)	W25VT (4) W25RT (4) X25RT (4)	U25RT (2)	12	37
YALB502M8		M8	44.5	2.5	35.1	17.3	106.7						
YALB502M10		M10	44.5	2.5	35.1	17.3	110.0						
YALB502M12		M12	44.5	3.0	35.1	21.1	116.3						
YALB502M14		M14	44.5	3.0	35.1	21.1	117.3						
YALB502M16		M16	44.5	3.0	35.1	21.1	122.7						

* Use equivalent AWG setting on tool for installation

** PUADP1 Adaptor is required to use U Dies in 46 Series

• P-RT dies for 46 Series Tooling only

Compression Connections

Copper Compression — Code — Two Hole
Long Barrel — Metric Lugs

TYPE YALB-2M (Continued)

Electro-Tin
Plated

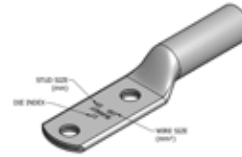

NOTE: Field bending straight lugs to achieve an angular connection will void UL Listing / CSA Certifications and BURNDY will not be liable for the connection.

Catalog Number	Wire Range (MM ²)	Stud Size	Stud Hole Spacing	Dimensions (mm)			Installation Tooling					Wire Strip Length (mm)	
				Tongue Thickness	(B)	(C)	(L)	Dieless*	MD6, OUR840, MD734R	500 Series	35, 750, 46** Series		Die Index
YALB702M6	70	M6	44.5	3.0	38.1	21.1	110.0		W26VT (4) W26RT (4) X26RT (4)	W26VT (4) W26RT (4) X26RT (4)	U26RT (2)	13	40
YALB702M8		M8	44.5	3.0	38.1	21.1	111.8						
YALB702M10		M10	44.5	3.0	38.1	21.1	114.8						
YALB702M12		M12	44.5	3.0	38.1	21.1	121.4						
YALB702M14		M14	44.5	3.0	38.1	21.1	122.2						
YALB702M16		M16	44.5	3.0	38.1	21.1	130.8						
YALB952M8	95	M8	44.5	3.3	38.1	23.6	113.0	MY2911 (2) MRC840 (4) 644 Series (1) 444 Series (1) 81K Series (2)	W27VT (4) W27RT (4) X27RT (6)	W27VT (4) W27RT (4) X27RT (6)	U27RT (2)	14	40
YALB952M10		M10	44.5	3.3	38.1	23.6	116.1						
YALB952M12		M12	44.5	3.3	38.1	23.6	122.4						
YALB952M14		M14	44.5	3.3	38.1	23.6	123.4						
YALB952M16		M16	44.5	3.3	38.1	23.6	128.8						
YALB952M20		M20	44.5	4.1	38.1	30.5	140.0						
YALB1202M8	120	M8	44.5	3.8	41.1	29.0	118.6		W28VT (4) W28RT (4) X28RT (6)	W28VT (4) W28RT (4) X28RT (6)	U28RT (2)	15	43
YALB1202M10		M10	44.5	3.8	41.1	29.0	124.1						
YALB1202M12		M12	44.5	3.8	41.1	29.0	128.0						
YALB1202M14		M14	44.5	3.8	41.1	29.0	129.0						
YALB1202M16		M16	44.5	3.8	41.1	29.0	134.4						
YALB1202M20		M20	44.5	4.3	41.1	30.5	145.5						
YALB1502M8	150	M8	44.5	4.1	50.8	30.5	128.8	644 Series (1) 444 Series (1) 81K Series (3)	W30VT (4)	W30VT (4) W30RT (4)	U30RT (4)	17	52
YALB1502M10		M10	44.5	4.1	50.8	30.5	131.8						
YALB1502M12		M12	44.5	4.1	50.8	30.5	138.2						
YALB1502M14		M14	44.5	4.1	50.8	30.5	139.2						
YALB1502M16		M16	44.5	4.1	50.8	30.5	145.3						
YALB1502M20		M20	44.5	4.1	50.8	30.5	156.2						
YALB1852M8	185	M8	44.5	4.3	50.8	32.8	129.8		W31VT (4)	W31VT (4) W31RT (4)	U31RT (4)	18	52
YALB1852M10		M10	44.5	4.3	50.8	32.8	132.8						
YALB1852M12		M12	44.5	4.3	50.8	32.8	139.2						
YALB1852M14		M14	44.5	4.3	50.8	32.8	139.7						
YALB1852M16		M16	44.5	4.3	50.8	32.8	145.5						
YALB1852M20		M20	44.5	4.3	50.8	32.8	156.7						

* Use equivalent AWG setting on tool for installation.

** PUADP1 Adaptor is required to use U Dies in 46 Series tools.

† P-RT Die sets for use in 46 Series only, PUADP1 Adaptor not required.

TYPE YALB-2M (Continued)

Electro-Tin
Plated

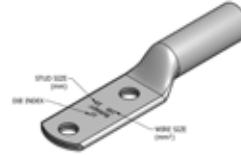

NOTE: Field bending straight lugs to achieve an angular connection will void UL Listing / CSA Certifications and BURNDY will not be liable for the connection.

Catalog Number	Wire Range (MM ²)	Stud Size	Stud Hole Spacing	Dimensions (mm)				Installation Tooling					Wire Strip Length (mm)			
				Tongue Thickness	(B)	(C)	(L)	Dieless*	MD6, OUR840, MD734R	500 Series	35, 750, 46** Series	Die Index				
YALB2402M10	240	M10	44.5	5.6	57.2	39.4	142.5	644 Series (1) 444 Series (1) 81K Series (4)	W34VT (4)	W34VT (4) W34RT (4)	U34RT (4)	20	59			
YALB2402M12		M12	44.5	5.6	57.2	39.4	149.6									
YALB2402M14		M14	44.5	5.6	57.2	39.4	150.6									
YALB2402M16		M16	44.5	5.6	57.2	39.4	156.0									
YALB2402M20		M20	44.5	5.6	57.2	39.4	166.9									
YALB3002M10	300	M10	44.5	6.6	68.3	44.2	156.2		644 Series (1) 444 Series (1) 81K Series (4)			U36RT (4)	22	70		
YALB3002M12		M12	44.5	6.6	68.3	44.2	162.6									
YALB3002M14		M14	44.5	6.6	68.3	44.2	163.6									
YALB3002M16		M16	44.5	6.6	68.3	44.2	168.9									
YALB3002M20		M20	44.5	6.6	68.3	44.2	179.6									
YALB4002M12	400	M12	44.5	7.6	74.7	50.3	171.4			644 Series (1) 444 Series (1) 81K Series (4)	—	—	U39RT (4)	24	76	
YALB4002M14		M14	44.5	7.6	74.7	50.3	172.5									
YALB4002M16		M16	44.5	7.6	74.7	50.3	177.8									
YALB4002M20		M20	44.5	7.6	74.7	50.3	189.0									
YALB5002M12	500	M12	44.5	8.1	76.2	55.6	176.5				644 Series (1) 444 Series (1) 81K Series (4)			U44XRT (4) †P44XRT (4)	L115	78
YALB5002M16		M16	44.5	8.1	76.2	55.6	182.9									
YALB5002M20		M20	44.5	8.1	76.2	55.6	194.1									
YALB6302M12	630	M12	44.5	9.7	81.0	62.5	183.9	644 Series (1) 444 Series (1) 81K Series (4)				—		† P45RT (6)	29	83
YALB6302M16		M16	44.5	9.7	81.0	62.5	190.5									
YALB6302M20		M20	44.5	9.7	81.0	62.5	201.4									

* Use equivalent AWG setting on tool for installation

** PUADP1 Adaptor is required to use U Dies in 46 Series

• P-RT dies for 46 Series Tooling only