

Fiberglass - Covers & Cover Accessories

Covers

Material Thickness: .090" (2.3)

Cover Length: 10' (3m)

Standard Mounting Hardware: (10 each) #10 x 3/4" stainless, self drilling screws provided with each section

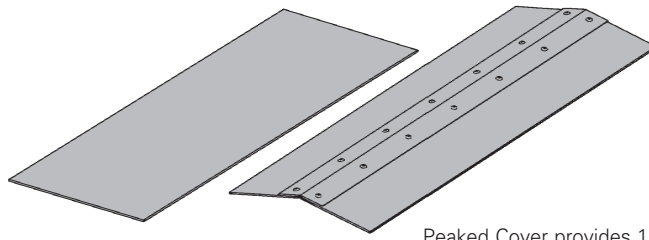

Peaked Cover provides 1 to 3.7 pitch
Peaked covers available for straight sections only.
No Hardware provided.

Covers

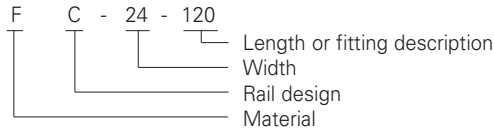

- F C - 24 - 120 = Flat polyester
- FV C - 24 - 120 = Flat vinyl ester
- FP C - 24 - 120 = Peaked polyester
- FVP C - 24 - 120 = Peaked vinyl ester

Quantity of Standard Cover Clamps Required

Straight Section 60" or 72"	4 pcs.
Straight Section 120" or 144"	6 pcs.
Horizontal/Vertical Bends	4 pcs.
Tees	6 pcs.
Crosses	8 pcs.

Note: When using the Heavy Duty Cover Clamp, only one-half the number of clamps stated above is required.

Standard Cover Clamp

- Furnished in pairs with hardware.

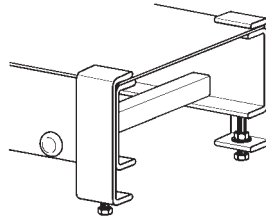

Catalog No.	Side Rail Height	
	in.	(mm)
9(Δ)-9013	3	(76)
9(Δ)-9014	4	(101)
9(Δ)-9016	6	(152)

Heavy Duty Cover Clamp

Recommended for outdoor service.

- W = tray width
- Heavy duty cover clamp available for flat covers only

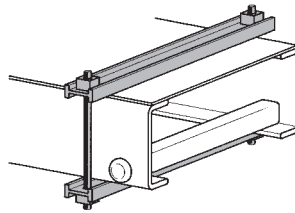

Catalog No.	Side Rail Height	
	in.	(mm)
9F-W-9034	3	(76)
9F-W-9044	4	(101)
9F-W-9064	6	(152)
9F-W-9084	8	(203)

Peaked Cover Clamp

- W = tray width

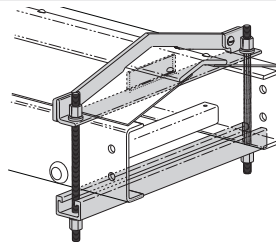

Catalog No.	Side Rail Height	
	in.	(mm)
9F-W-9034P	3	(76)
9F-W-9044P	4	(101)
9F-W-9064P	6	(152)
9F-W-9084P	8	(203)

Thermo Plastic Drive Rivet

- Sold individually.
- Shipped in packages of 25 pcs.

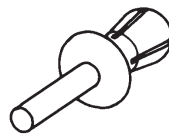

Catalog No.

- TPDR

Material Designations

(Δ) Insert one of the following material designations when required.

- F = Polyester Resin (Example: 9F-9013) available for all side rail heights
- FV = Vinyl Ester Resin (Example: 9FV-9013) available for all side rail heights

● Green = Fastest shipped items ● Black = Normal lead-time items ● Red = Normally long lead-time items

Dimensions shown in parentheses are in millimeters, unless otherwise specified.

Part Number with Hardware Explanation

Note: All hardware is 3/8"

- Example:** 9F-4004 SS6: pair of 4-hole splice plates for 4" (101) system with stainless steel hardware
 9FV-8006 SS6: pair of 8-hole vinyl ester splice plates for 6" (152) system with stainless steel hardware

Hardware Option	316 Stainless Steel
	SS6

Standard Lay-In Splice Plates

- Furnished in pairs with 316 stainless steel hardware
- One pair including hardware provided with straight section. (Expansion splice quantity subtracted)

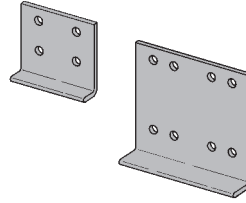

Material	Height in. (mm)	Catalog No.
Fiberglass	3" (76)	9(Δ)-4003SS6
	4" (101)	9(Δ)-4004SS6
	6" (152)	9(Δ)-8006SS6
	8" (203)	9(Δ)-8008SS6

Expansion Lay-In Splice Plates

- Furnished in pairs with 316 stainless steel hardware

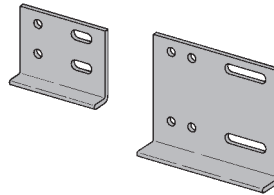

Material	Height in. (mm)	Catalog No.
Fiberglass	3" (76)	9(Δ)-4013SS6
	4" (101)	9(Δ)-4014SS6
	6" (152)	9(Δ)-8016SS6
	8" (203)	9(Δ)-8018SS6

Tray to Box Splice Plates

These plates are used to attach the end of a tray run to a distribution box or control center.

- Furnished in pairs with 316 stainless steel hardware

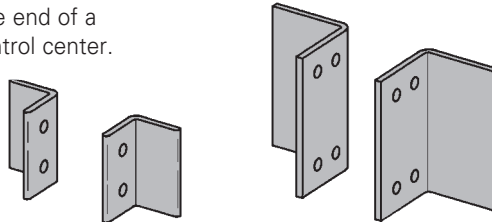

Material	Height in. (mm)	Catalog No.
Fiberglass	3" (76)	9(Δ)-4053SS6
	4" (101)	9(Δ)-4054SS6
	6" (152)	9(Δ)-8056SS6
	8" (203)	9(Δ)-8058SS6

Step Down Splice Plates

These plates are offered for connecting cable tray sections having side rails of different heights.

- Furnished in pairs with 316 stainless steel hardware

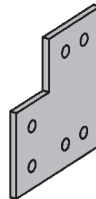

Material	Height in. (mm)	Catalog No.
Fiberglass	8" to 6" (203 to 152)	9(Δ)-8086SS6
	8" to 4" (203 to 101)	9(Δ)-8084SS6
	6" to 3" (152 to 76)	9(Δ)-8063SS6
	6" to 4" (152 to 101)	9(Δ)-8064SS6
	4" to 3" (101 to 76)	9(Δ)-4043SS6

Blind End Plate

This plate forms a closure for any tray that dead ends.

- Furnished as one plate
- W = tray width

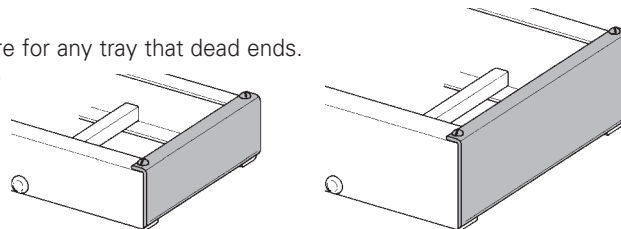

Material	Height in. (mm)	Catalog No.
Fiberglass	3" (76)	9(Δ)-1083-WSS6
	4" (101)	9(Δ)-1084-WSS6
	6" (152)	9(Δ)-1086-WSS6
	8" (203)	9(Δ)-1088-WSS6

Resin Seal Kit

To reseal fiberglass after field modifications.

- 1 pint (473ml)

Contents: Sealant and Applicator.



Catalog No.
RSK-010

Fiberglass - Accessories

Horizontal Adjustable Splice Plates

These plates provide for changes in the horizontal direction that do not conform to standard fittings.

- Furnished in pairs with 316 stainless steel hardware
- Body made from 316 stainless steel
- Used for all material finishes

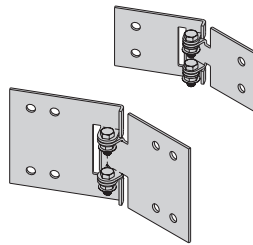

Material	Height in. (mm)	Catalog No.
Fiberglass	3" (76)	9F-403SS6
	4" (101)	9F-4034SS6
	6" (152)	9F-8036SS6
	8" (203)	9F-8038SS6

Horizontal Splice Plates

- Furnished in pairs with 316 stainless steel hardware

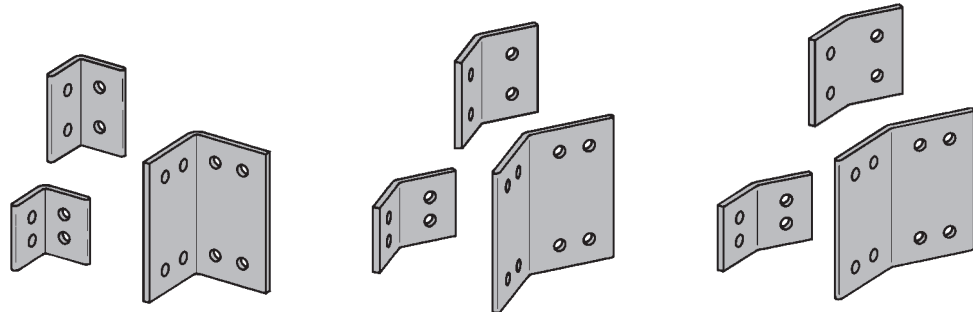

Material	Height in. (mm)	Catalog No.		
		90°	45°	30°
Fiberglass	3" (76)	9(Δ)-4903HSS6	9(Δ)-4453HSS6	9(Δ)-4303HSS6
	4" (101)	9(Δ)-4904HSS6	9(Δ)-4454HSS6	9(Δ)-4304HSS6
	6" (152)	9(Δ)-8906HSS6	9(Δ)-8456HSS6	9(Δ)-8306HSS6
	8" (203)	9(Δ)-8908HSS6	9(Δ)-8458HSS6	9(Δ)-8308HSS6

Vertical Adjustable Splice Plates

These plates provide for changes in elevation that do not conform to standard vertical fittings.

- Furnished in pairs with 316 stainless steel hardware

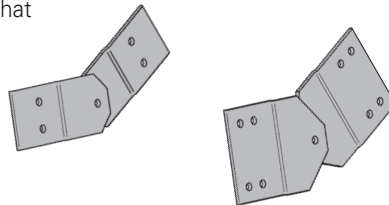

Material	Height in. (mm)	Catalog No.
Fiberglass	3" (76)	9(Δ)-4023SS6
	4" (101)	9(Δ)-4024SS6
	6" (152)	9(Δ)-8026SS6
	8" (203)	9(Δ)-8028SS6

Vertical Splice Plates

- Furnished in pairs with 316 stainless steel hardware

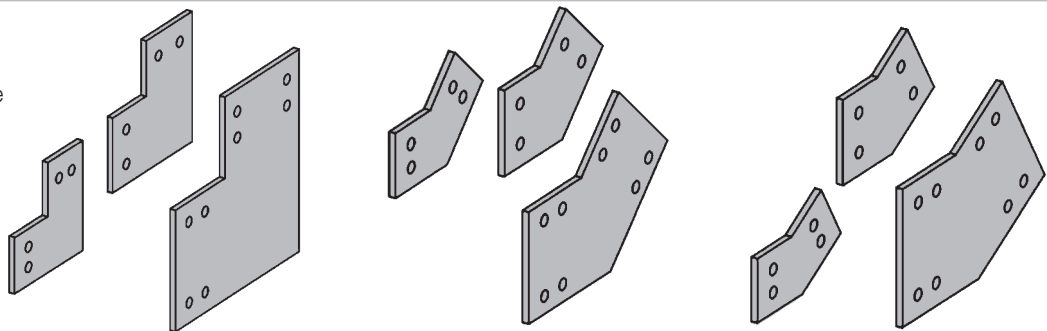

Material	Height in. (mm)	Catalog No.		
		90°	45°	30°
Fiberglass	3" (76)	9(Δ)-4903VSS6	9(Δ)-4453VSS6	9(Δ)-4303VSS6
	4" (101)	9(Δ)-4904VSS6	9(Δ)-4454VSS6	9(Δ)-4304VSS6
	6" (152)	9(Δ)-8906VSS6	9(Δ)-8456VSS6	9(Δ)-8306VSS6
	8" (203)	9(Δ)-8908VSS6	9(Δ)-8458VSS6	9(Δ)-8308VSS6

(Δ) See page M-27 for material selection

Dimensions shown in parentheses are in millimeters, unless otherwise specified.

Ladder Drop-Out

Specially-designed Ladder Drop-Outs provide a rounded surface with adequate radius to protect cable as it exits from the tray, preventing damage to insulation.

- 4" (101) radius
- W = tray width
- Furnished with #10 x 3/4" self-drilling stainless steel screws

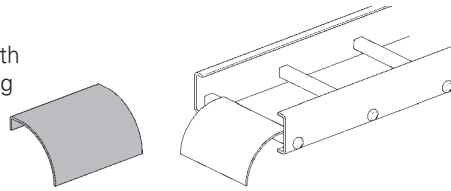

Catalog No.

9(Δ)-1104-W

Barriers

- Furnished with #10 x 3/4" self-drilling stainless steel screws

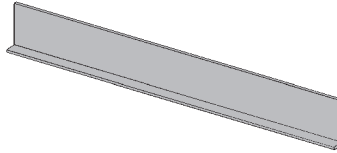

Catalog No.	Side Rail Height in. (mm)
72(Δ)-120	3" (76)
73(Δ)-120	4" (101)
75(Δ)-120	6" (152)
77(Δ)-120	8" (203)

Flexible Horizontal Barrier Kit

One kit allows up to a 36" (914) radius position of the barrier.

Kit Contents:

- 1 pc — 72" (1829) Straight Barrier
 - 4 pc — 9F-9002 Barrier Strip Clip
 - 8 pc — Thermo Plastic Drive Rivet
 - 4 pc — #10 x 3/4" Stainless Steel Self-Drilling Screw
- Assembly required — directions included.

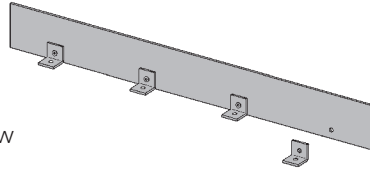

Catalog No.	Side Rail Height in. (mm)
72(Δ)-90HBFL	3" (76)
73(Δ)-90HBFL	4" (101)
75(Δ)-90HBFL	6" (152)
77(Δ)-90HBFL	8" (203)

Vertical Bend Barriers

- Furnished with #10 x 3/4" self-drilling stainless steel screws
- * Insert 2 for 3" (76) siderail height
- 3 for 4" (101) siderail height
- 5 for 6" (152) siderail height

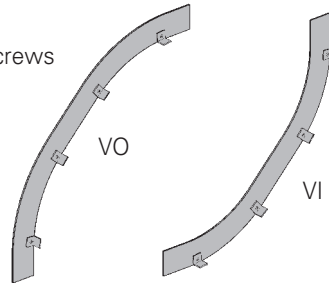

7* (Δ) - 90 VO 24

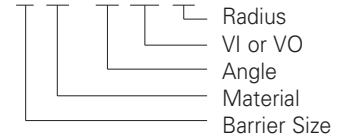

Clamp/Guide - Fiberglass

- Nonmetallic
- Designed for 3/8" hardware - not included
- Combination hold down clamp and guide
- Material: Glass reinforced polyurethane
- Sold in pairs

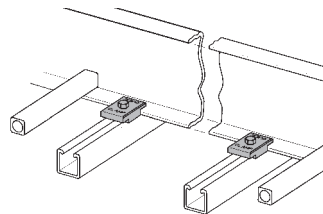

Catalog No.

9F-1208

Fiberglass Conduit to Cable Tray Adapter

- For rigid or PVC conduit
- Furnished in pairs with 316 stainless steel hardware

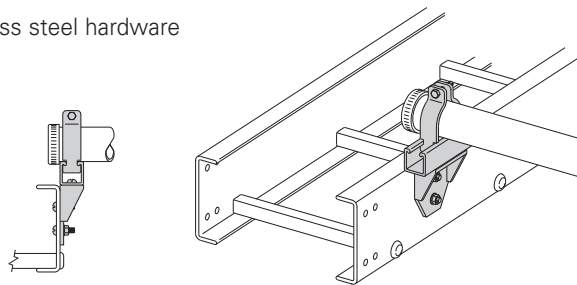

Catalog No.	Conduit Size in. (mm)
9FV-2008	0.50 (15)
9FV-2009	0.75 (20)
9FV-2010	1.00 (25)
9FV-2011	1.25 (32)
9FV-2012	1.50 (40)
9FV-2013	2.00 (50)
9FV-2014	2.50 (65)
9FV-2015	3.00 (80)
9FV-2016	3.50 (90)
9FV-2017	4.00 (100)

(Δ) See page M-27 for material selection

Dimensions shown in parentheses are in millimeters, unless otherwise specified.