

# EMT

## Steel Compression Space Saver and Steel Set

### Features

- Eliminates need to purchase insulated throat steel fittings or conduit bushings in 1/2", 3/4" and 1" trade sizes
- Affords additional wiring room in junction boxes (see illustrations)
- Excellent for low voltage applications
- Heavy steel walls
- Concrete tight when taped
- RoHS compliant

### Standard Materials

- Steel

### Standard Finish

- Zinc plated

### Applicable Third Party Standards

- UL Standard: 514B
- Fed. Spec. W-F-408E
- NEMA: FB-1

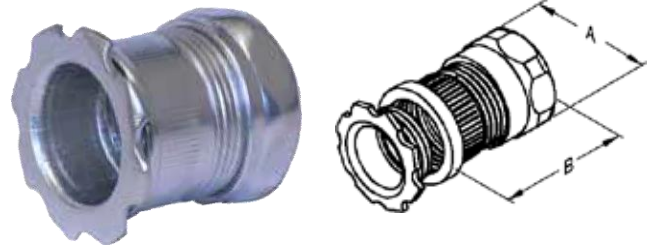

Steel Compression Space Saver

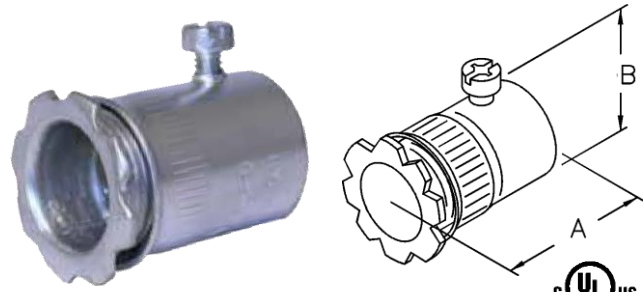

Steel Set Screw Space Saver



### Steel Compression Space Saver

Catalog Number	Trade Size (in)	Dim A (in)	Dim B (in)	Master Pack	Weight Per C (lb)
CSSC-50KON	1/2	1.250	1.125	50	10.7
CSSC-75KON	3/4	1.438	1.375	25	15.6
CSSC-100KON	1	1.875	1.688	25	30.3

CSSC is concrete tight

### Steel Set Screw Space Saver

Catalog Number	Trade Size (in)	Dim A (in)	Dim B (in)	Master Pack	Weight Per C (lb)
SSC-50KON	1/2	0.875	0.875	50	7.8
SSC-75KON	3/4	1.063	1.125	25	10.9
SSC-100KON	1	1.313	1.375	25	15.5

SSC is concrete tight when taped



Wiring room using conventional steel connectors



Wiring room using Space Saver Steel connectors