



## Latch Pin Adjustment

Adjusting the Latch Pin on a Fired Up Kilns Craft Kiln:

1. Ensure all power to the kiln is turned off & unplug.
2. Remove the attachment screws at the base of the controller box cover (two on each side).



3. Open the lid of the kiln.



4. Gently slide the controller box cover upward about 10cm.



5. With hands in the middle at the sides of the controller box cover, gently bow one side to release it from the groove that each side of the controller box cover sits in.
6. Avoid touching or moving any of the wires.
7. Turn the controller box cover over to inspect inside.



8. Find the lid pins contact point in the top right of the controller box cover.

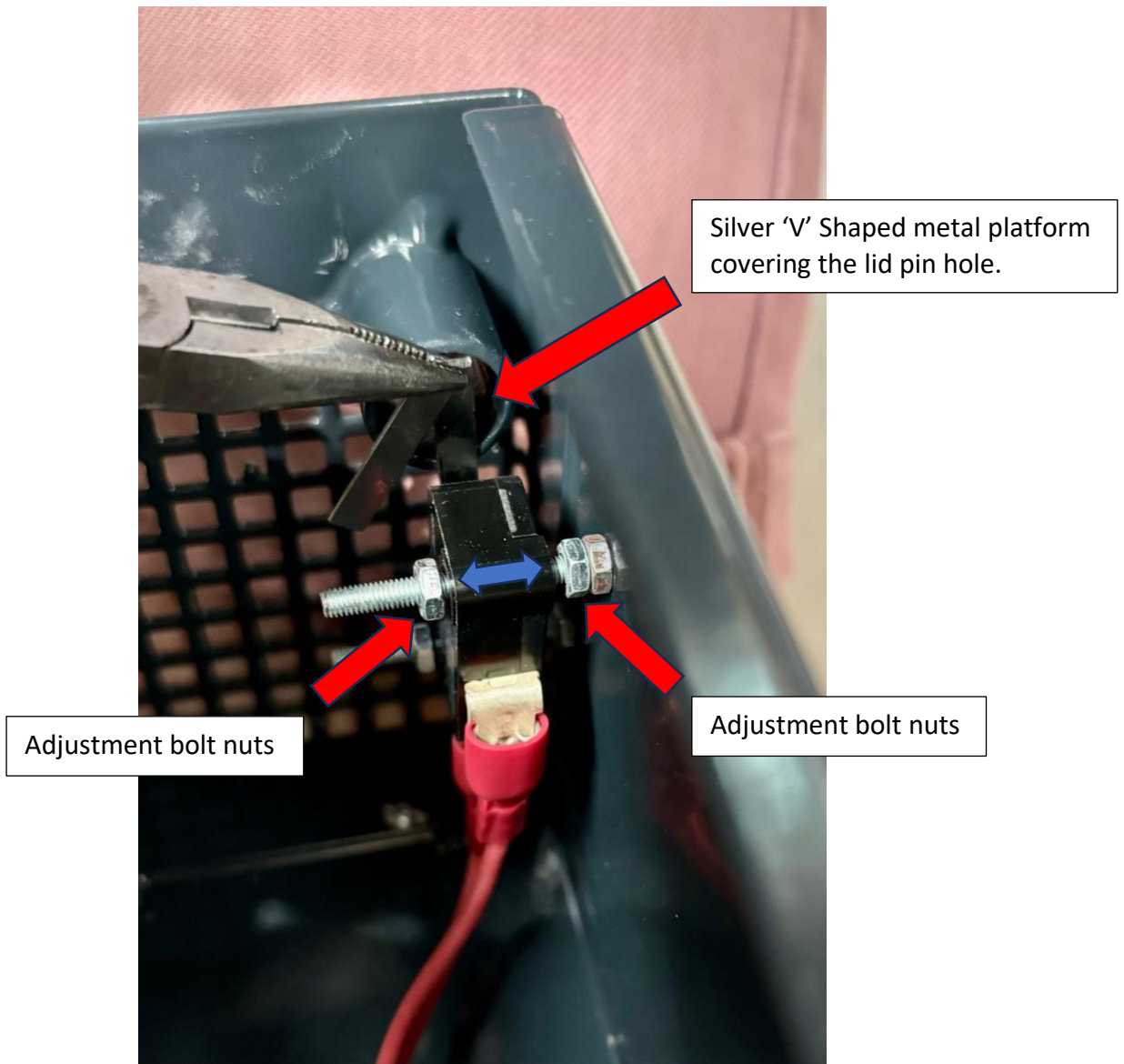

9. Adjust the bolt mechanisms to ensure the silver 'V' shaped metal platform covers the lid pin hole entry.
10. The silver 'V' shaped metal platform should click when pushed down (this is the kiln engaging and allows the power to flow).
11. Once you are comfortable that the silver 'V' shaped metal platform fully covers the hole, replace the controller box cover reversing the above steps.
12. Make sure no wires are trapped or damaged.
13. Gently lower the kiln lid and listen for the pin engaging the silver 'V' shaped metal platform with a 'click'.
14. You can now turn power back on and use your kiln.