



**FIRED UP KILNS**  
*and pottery supplies*



# Fired Up Potters Wheel

Models: 300 & 800

USERS GUIDE



## Overview



## Accessories

- 1 SplashPan
- 2 Wheelhead
- 3 Desktop
- 4 ControlPanel
- 5 Tightenings
- 6 AdjustableLeg
- 7 RubberPad
- 8 FootPedal

## Warnings

---

- This product is designed for, and should only be used for, the throwing of clay to create of ceramic art.
- Do not place any other items (tools, water buckets) on the wheelhead.
- Never allow the water level to exceed the waterproof molded plastic bottom of the wheel tray, as this will result in water entering & damaging the motor and drive mechanisms.
- Only a qualified electrician should undertake repairs or modifications, to remove the risk of electrocution or injury.
- Do not insert hands or any objects into any openings or any moving parts.
- Never leave children unattended or unsupervised near a wheel.
- Stop using the wheel immediately if you smell or see smoke or hear unusual noises. **Shut off the power, unplug the power cable and contact your retailer.**
- Do not plug or unplug from the AC outlet with wet hands.
- Do not move or hold the wheelhead while the wheelhead is turning. The wheel body may start turning and your hand may be caught between the wheelhead and the enclosure.
- Keep loose fitting clothing, jewelry and long hair away from the wheel as this may get caught and causing damage or injury.
- Do not lift, pull or drag the wheel by the wheelhead.
- Place the wheel on a flat, horizontal surface. Vibration may occur if the surface is not level.
- Do not remove the bottom cover. There are electrical parts which need to be protected from hands, water and other materials.

# INSTALLATION STEPS

## Leg Installation

1. Place the wheel vertically on cardboard as displayed in the picture to the right.
2. Remove the rubber caps. (keep them for future use.)

Caution: Wheel is not stable standing vertically.

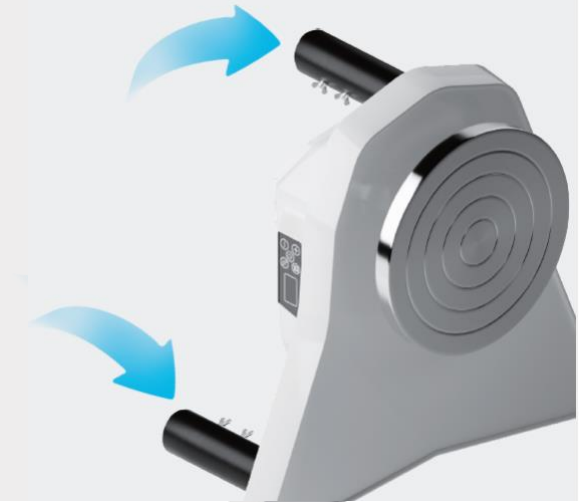

3. Insert each leg as the drawing illustrates. Adjust the height evenly on all three legs. Tighten bolts with allen key.



### 5 different height adjustments

Height 42cm



Height 47cm



Height 52cm



Height 57cm



Height 62cm



Adjust height by changing the bolt position.

4. Place the wheel horizontally after tightening the bolts.



## INSTALLATION STEPS

### Splash Pan Installation

1. Insert splash pan A into the groove under the seal flange.
2. Insert splash pan B into the groove under the seal flange.

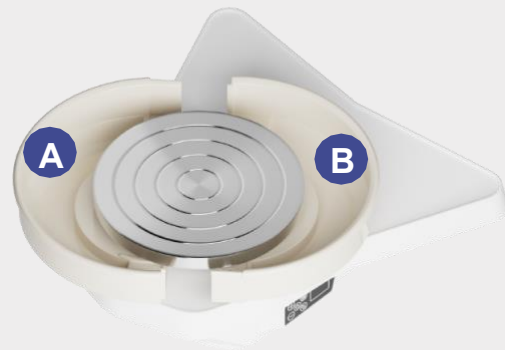

3. Join splash pan A and splash pan B by snapping them together.

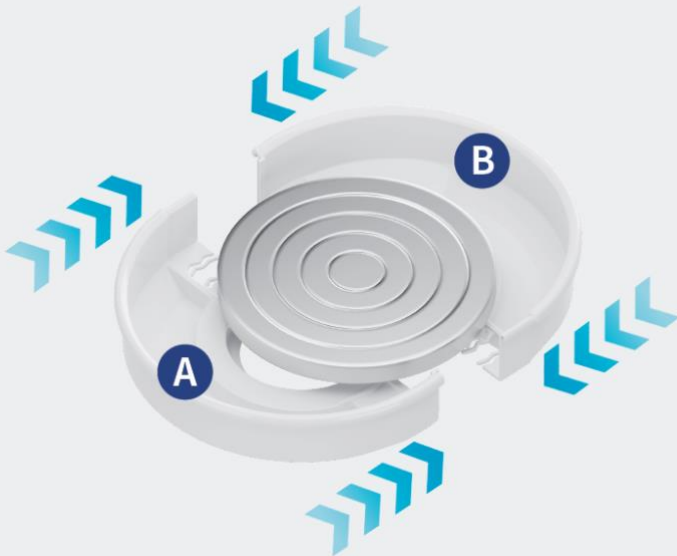

### Power connection

1. Connect the power cable to a 220V (50Hz) single phase AC power outlet only.
2. Do not connect multiple power cables to the same outlet.
3. Make sure the power switch is in the OFF position before plugging the power cable into an AC outlet.

## Operation Starting and Stopping

1. Turn the power switch ON
2. Set the wheelhead direction.  
FW-----Clock wise  
RW-----Counter clock wise



3. Push the pedal forward from the stop position to increase speed. Push backward to reduce speed.



4. Push the pedal all the way back to stop the wheelhead.

## Operation Switching Directions

1. Stop the wheelhead by pushing the foot pedal all the way back to the stop position.



2. Press the FW/RW button

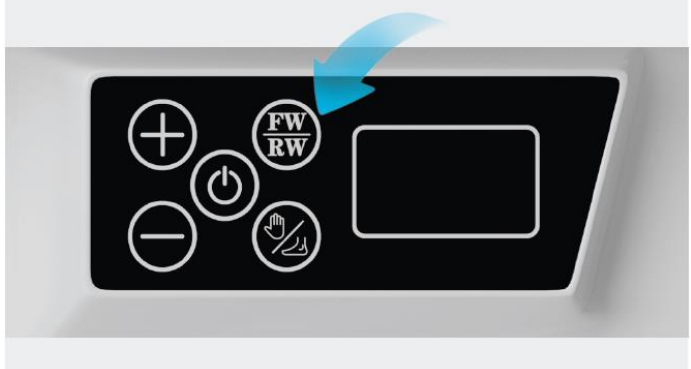

## Warning

- Never change the wheelhead direction while the wheelhead is moving.
- If you do not return the foot pedal to the stop position, the direction will not change even if the **FW/RW** switch is changed.

**You may burn out the circuit board!**

- Push the foot pedal to the stop position before turning the power switch off.
- The wheelhead will not move if the pedal wasn't all way back when it was last powered off.
- Dry your hands before operating any switches!

## Maintenance

---

- Turn the power switch off and unplug the power cord when cleaning, testing or adjusting the Wheel.
- We recommended you unplug the wheel when it's not in use.
- **DON'T POUR WATER ON THE WHEEL TO CLEAN IT!** Wipe the wheel down with a damp sponge or cloth.
- The Splash pan can be soaked in warm water once removed from the wheel.

## Troubleshooting

---

### The Wheelhead Doesn't Turn:

- Is it plugged in and turned on?
- Is the power source working correctly and supplying the correct amount of current?
- Is the pedal in the "stop" position (heel of the foot pedal completely down)?
- Are there several wheels or other equipment/appliances on the same circuit? Check the breaker to see if the circuit has been overloaded.)

### Unusual sounds:

- Is the wheel resting on a solid surface and level?
- Is there too much clay on the wheelhead?
- Is the clay properly centered?
- Are any of the adjustable legs loose?
- Has the wheelhead bolt become loose?

### The wheelhead stops turning:

- Did the wheel stop turning when clay was added to the wheelhead?
- The wheel may be overloaded, resulting in overload protection.
- The power needs to be turned off, remove some clay, waiting for 2 minutes before turning power on again.
- Did an overload cause the breaker/fuse to pop at the main power source?
- Has the power cord become unplugged?

### The wheelhead turns in the opposite direction:

- Allow the wheel to stop turning completely.
- Turn the forward/ reverse switch to the desired direction.

Note: Forward is clockwise; Reverse is counterclockwise.

Specifications

<b>Model</b>	<b>MK-300Y</b>
<b>Motor</b>	300W AC220v. (50Hz)
<b>Drive System</b>	Direct Drive DC Brushless Motor with electric speed control
<b>Wheelhead rotation speed</b>	50~60Hz :0 ~ 300rpm
<b>Speed adjustment</b>	Foot Pedal
<b>Wheelhead Direction</b>	Clockwise/Counter-Clockwise
<b>Wheelhead diameter</b>	Aluminum diecast: 32cm
<b>Dimension</b>	60 x 62.5 x 46cm
<b>Weight</b>	~35kg (77.16lbs)

<b>Model</b>	<b>MK-DD800Y</b>
<b>Motor</b>	800W AC220v. (50Hz)
<b>Drive System</b>	Direct Drive DC Brushless Motor with electric speed control
<b>Wheelhead rotation speed</b>	50~60Hz :0 ~ 300rpm
<b>Speed adjustment</b>	Foot Pedal
<b>Wheelhead Direction</b>	Clockwise/Counter-Clockwise
<b>Wheelhead diameter</b>	Aluminum diecast: 32cm
<b>Dimension</b>	60*62.5*46cm
<b>Weight</b>	~35kg (77.16lbs)



# **FIRED UP KILNS**

*and pottery supplies*

[hello@firedupkilns.com.au](mailto:hello@firedupkilns.com.au)

20 Helen Street, Heidelberg West, Victoria 3081, Australia

[www.firedupkilns.com.au](http://www.firedupkilns.com.au)

ABN: 365 984 307 89

Fired Up Kilns works from the lands of the Wurundjeri Woi Wurrung and Bunurong peoples of the Kulin Nation and pay our respects to their Elders past and present.

We also acknowledge the Elders, Ancestors, cultures and heritage of all Aboriginal and Torres Strait Islander Nations.



Everyone is welcome at Fired Up Kilns.